

I, Frank Cain of Roseburg Oregon, do hereby certify that this map was made from notes taken during an actual survey made by me on April 26th, 1911, and that it correctly represents the works described in the accompanying application, together with the location of streams and other ditches in the immediate vicinity and has written thereon the area in each smallest legal subdivision it is proposed to irrigate

Frank Cain
Surveyor.

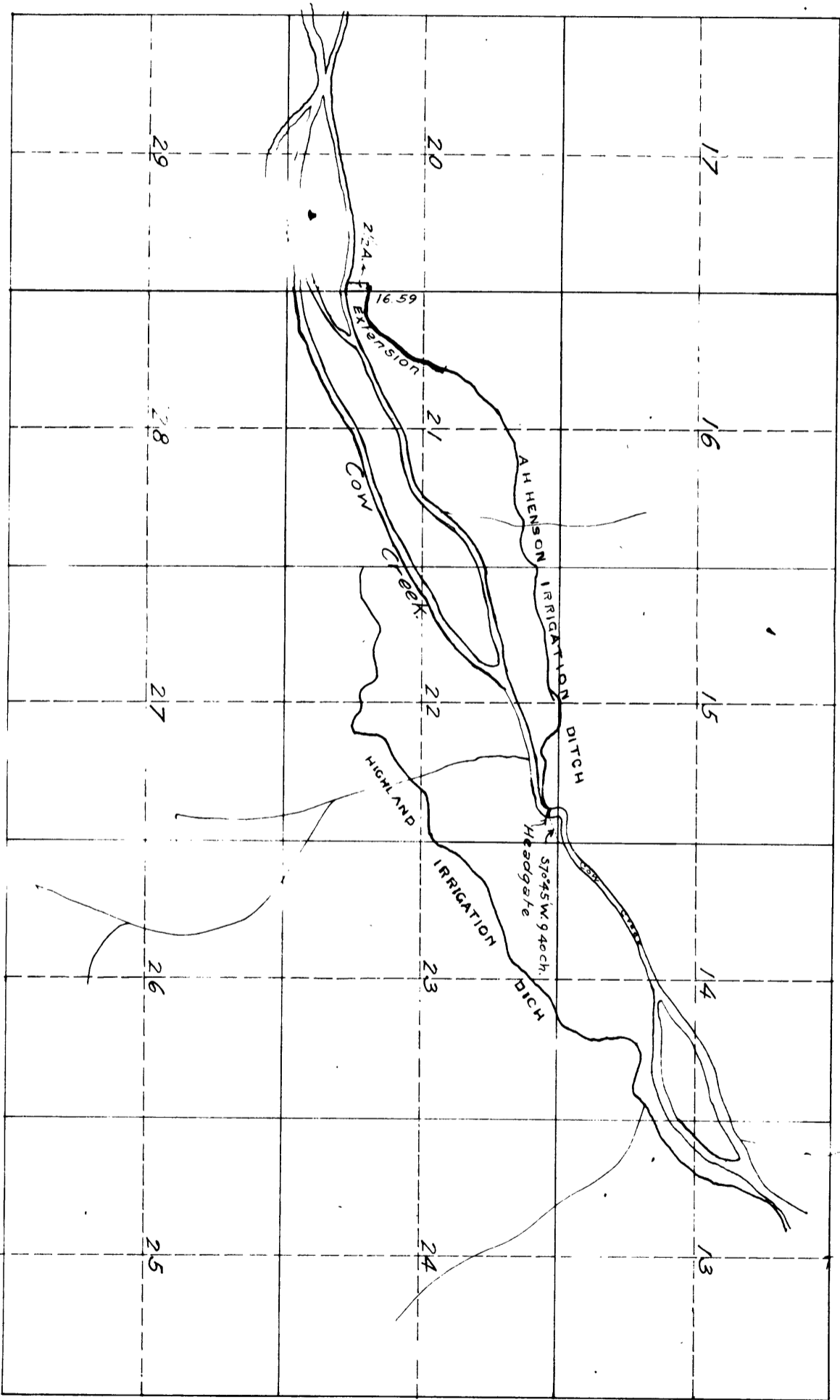

T. 32 S. R. 5 W.

A. H. Henson Irrigation Ditch.
Proposed Extension.

Scale, One Inch to Forty Chains.