

DIETZGEN NO. 385-6

WEEKLY ESTATE
ESTABLISH N, S & S. 29
T 29 S R 6 W

C. S. File No. 47/195

JUNE 17-57

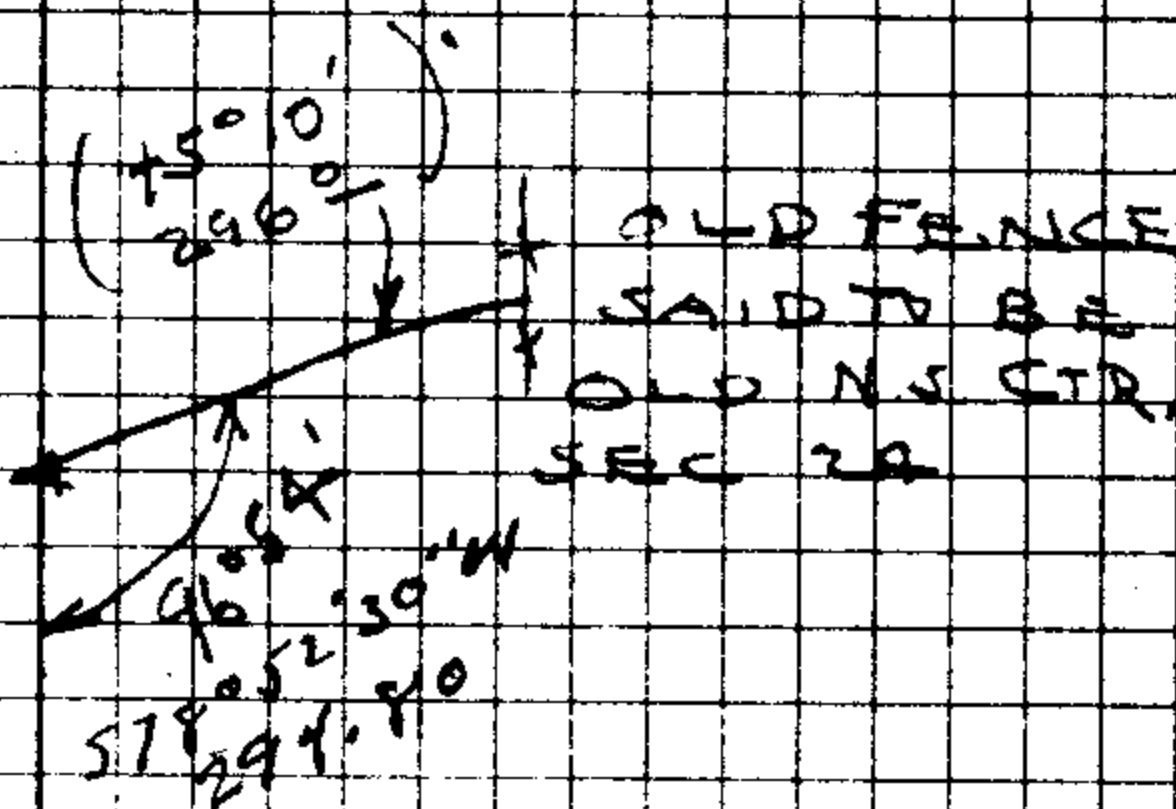

2. APPROX. BLAZED LINE

APPROX. BLAZED LINE

DIETZGEN NO. 385-6

C. S. File No. 47/195

515° W

10

30° 02' R
15° 01' R

2593.2

50° 01' E

SOUTH

9

14° 35' L
7° 18' L

50.30

57° 17' W

-15° 30'
52° 21'

8

8° 28' R
4° 14' R

57° W

78.94

53° 03' W 53° W

-3° 00'
79° 05'

7

4° 35' R
2° 18' R

320.51

50° 45' W

51° W

+14° 40'
300°

6

2° 34 1/2' L
1° 17 1/2' L

487.94

52° 12' 30" W

+14° 00'
194° 30'
-11° 15'
300°

2336 90°25' (2)
L 3000

9°55' 49 59
240° (1) 1113

L 2994

9-4
431947 (4)
107°57'

530.63

10 273°19' (4)

60°50'

44°54' (4)
11013 1/2

9 ON 48" FIR STUMM

1113
53
53
53

DIETZGEN NO. 385-6

C. S. File No. 47/195

S 1/4 Sec
529

87.32

N 81° 06' W

N 81 1/2° W

+ 5° 20'
877

12

89° 33'
44° 46' R

277.15

554° 08' W

S 54° W

+ 11° 10'
2825

11

78° 16'
39° 08' R

164.29

515° W

+ 3° 50'
1692

DIETZGEN NO. 385-6

C. S. File No. 47/195

				582°W	-8°05' 2985
24		14°36' 2°18' L			
				588°50'30"W	
	173.92			589°W	+1°45' 1790
23		19°12' 9°36' L			+8°30' 195'
	695.60			N81°33'30"W	7°20' 88°10'
				N82°W	5°30' 252'
					-4°30' 155'
22		13°53' 6°57' L			
	128.70			N74°36'30"W N75°W	+9°00' 1303'
21		32°11' 16°05' R			
	507.76			589°18'W	+12°00' 176'
					L175°10'
				589°W	+4°55' 161'
20		16°59' L 8°30' R ✓			
	333.97			580°48'W	+19°25' 300'

+ FD. PIPE & BITS.
OK.

DIETZGEN NO. 385-6

2 7 *

3 *

G. S. E. No. AT 195

+10°50'
82°

832.68

N 86° 26' W

+16°00'
137.95
~~8050~~
250°
~~27°40'~~
2788
~~26°35'~~
108°

N 87° W

29

1° 48' ±
0° 54' L

8271

~~8°50'~~
83.7

28

POT

525.84

N 85° 31' 1/2 W

+11°00'
1094
+5°50'
300°

N 86° W

27

4° 38'
2° 19' R

489.24

N 87° 50' 30" W

L 120.10
~~10°35'~~
60.1
31°00'
300°
~~29°06'~~
198°

N 88° W

26

0° 06'
0° 03' L

127.84

N 87° 47' 30" W N 88° W

~~21°30'~~
137.9

25

21° 20'
10° 40' R

295.53

581° 32' 30" W

98218

50

134

150

364

2K 30

96126

98814

88566

89428

98814

98163

99482

150'

SYMBOL
ADDRESS

DIETZGEN NO. 385-6

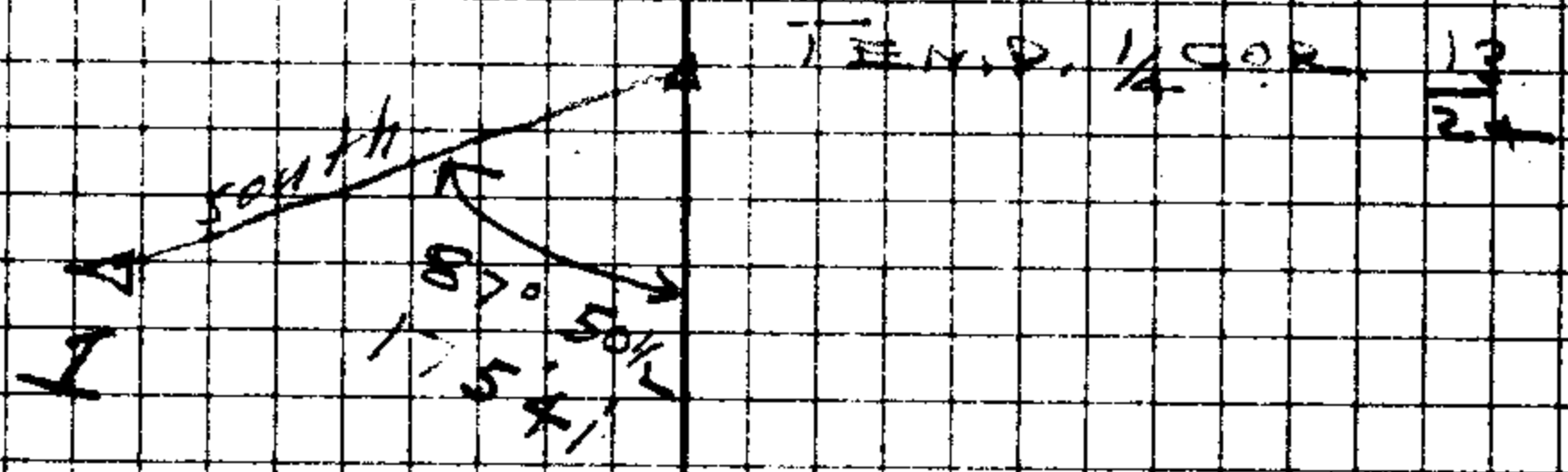

18'

C. S. File No. 47/195

32

26° 38' R

519° 13' W 519° 10'

= 5' 45'

102.48'

103°

151° 55' L

75° 57' L

31

L 9.2'

+ 22° 00'

252°

+ 20° 00'

1161.99

215°

+ 22° 00'

138°

+ 26° 00'

N 84° 49' 1/2 W

136°

= 7.50

N 85° W

300°

- 26° 50'

190°

30

3° 13'

1° 36' 1/2 R

N 85° 26' W

L 29°

DIETZGEN NO. 388-6

99497

92718

93469

92718

84879

99067

89232

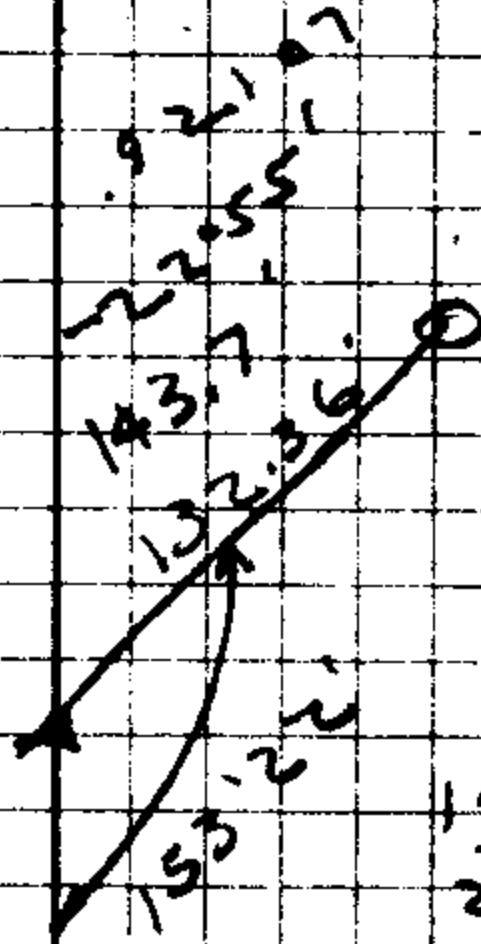

FO 1/4 I.P.
SEC. COR.

N 60° 00' 0.7"
2ND 1/4 I.P.

SEC. COR.

14	13	7298
21	24	250

125'

AS SHOWN

C. S. File No. 47/195

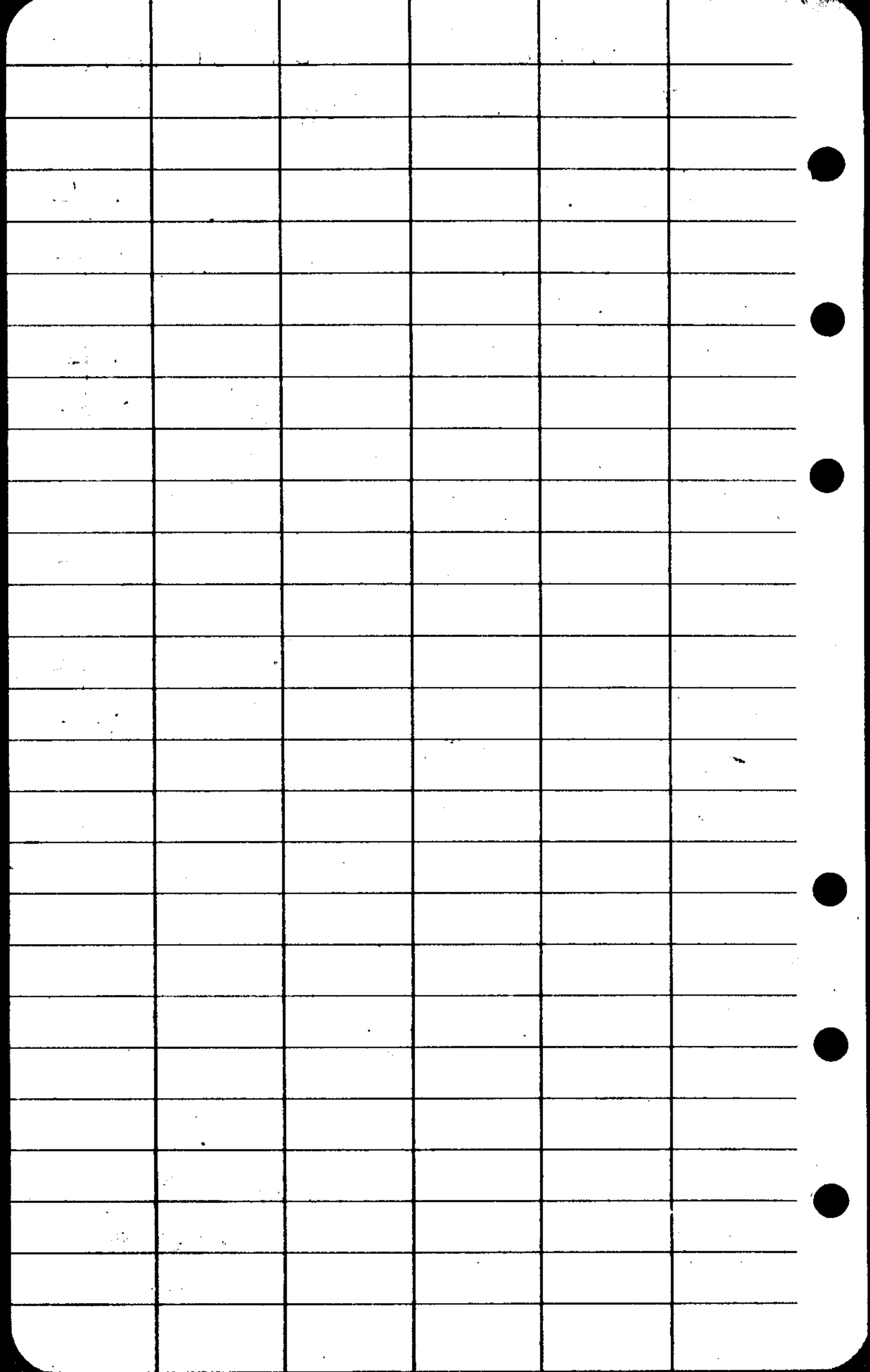

RENEW $\frac{1}{4}$ COR. 13 T 29 S
24 R 6 W

THE POSITION OF $\frac{1}{4}$ COR.
DETERMINED BY RETRACING NORTH
BDY. SEC. 24, $\frac{1}{4}$ COR. SET AT MID
POINT ON TRUE LINE BTWN SEC. COR.

SET BRASS CAP AT COR. MKD
 $\frac{1}{4}$ COR. 13 T 29 S R. 6 W COUNTY
SURVEYORS OFFICE 1957.

FROM WHICH 36" CEDAR
BEARS S 27° E, 12.3' SCRIBED $\frac{1}{4}$ S 24 CS BT
40" FIR STUMP BEARS N 8° E
24.2' SCRIBED $\frac{1}{4}$ S 18 CS BT.

$\frac{1}{4}$ COR. SET BY
27 MARKHAM

SET FROM FD. 36" CEDAR
S 9° E 28.5' SCRIBED

PIPE NOT FD. 40" FIR STUMP N 15° E 5.5'

NO SCRIBING VISIBLE (CUT LOW)

KAR. 20%

JUN 24-57

L. B. M. G. J. F.

RENEW SEC FOR 23 24 1295 R6W

1413

RECORDED - ALL BTD 1 1/2" P. 1919 ALL NOW
EXCEPT 6" P. 1919 ALL NOW
CONDITION IS 2011

15.8' 6" H. 12" R. 1919 R6W
SUB-1

57.5' 6" H. 6" W. 1919 R6W
SUB-1

55.7' 6" H. 6" W. 1919 R6W
SUB-1

VAR 20%
43.8
43.8
110

DIETZEN NO. 385-6

C. S. File No. 47/195

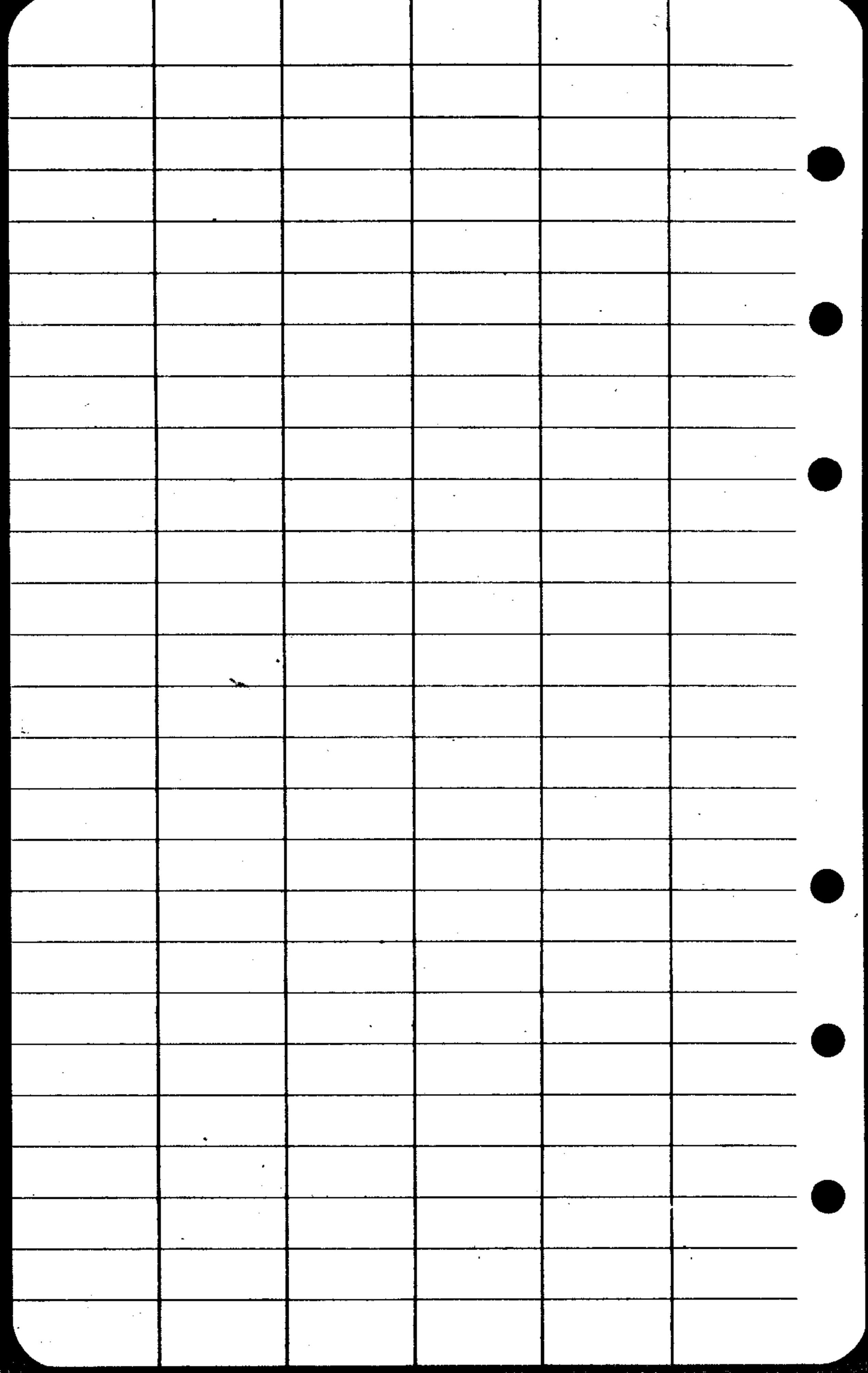

T29S R6W
S 18° W 26.8 FT
E 18° E 33.1 FT

SET I.P. WITH BRASS CAP MARKED
COUNTY SURVEYORS OFFICE 1957

T29S R6W 1/4 S 24 25 "

SET FROM MARKHAM'S B.T.S.

FD - MARKHAM'S B.T.S. AS RENEWED
1951. - POOR CONDITION - BARK
SCRIBED.

JUNE 24-57

J.B.

M.G.

J.F.

VAR 20 1/2°

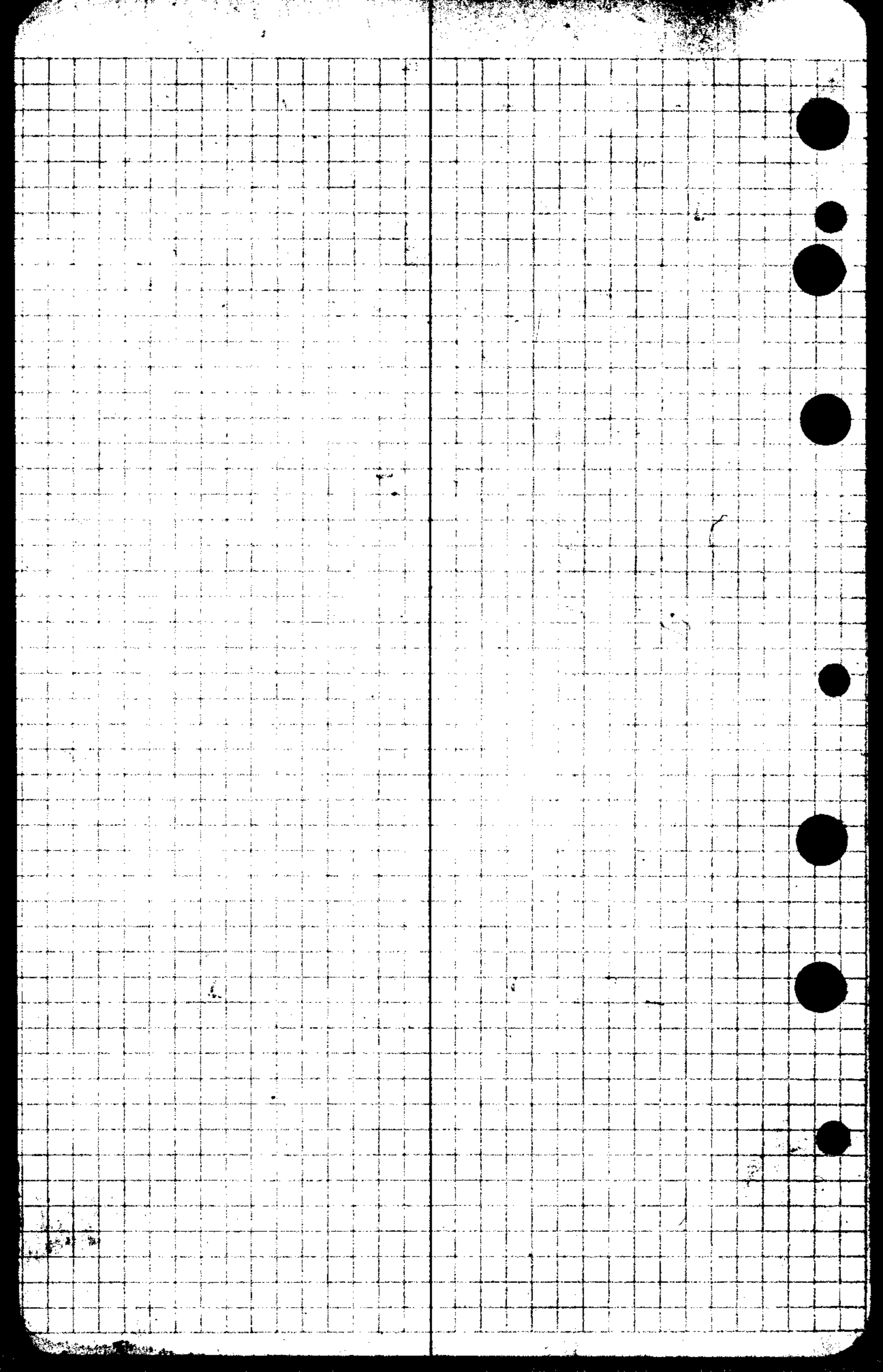

109⁺ +

27 - TOP OF SPUR

83⁷ -

28

108⁰ -

278⁸ - 27° 40'

250⁰ -

BACK 150 FT. CROSS CREEK

137⁹⁵ + 16°

82⁰ +

28⁰ LEV.

29 - TOP OF SPUR

200⁰ -

300⁰ - 7° 50'

CROSS CREEK BACK 125 FT.

136² + 26°

138⁰ +

215⁰ +

252⁰ +

9² LEV.

30

TOP OF RIDGE

103⁰ -

31

143⁷ -

1" IRON PIPE

07

1" IRON PIPE - COR. SECS

$\frac{14}{23} \frac{13}{24}$

