

DIETZSEN NO. 3855-B

RENEW GOV. COR.

C. S. File No. 47/933

RENEW \neq COR. $\frac{12}{13}$ T 25 R 4.

FOUND - ORIG. N.E. BT. BARK SCRIBED

$\frac{1}{4}$ S 12 TOP SCRIBING 5' ABOVE GR.

HAS YELLOW TAG SET BY HAINES 1943

ALSO TAG SET BY BLM 1956

BT IS NOW 42". THE SW BT

IS GONE WOULD BE IN ROADWAY

COR. CHECK CALL TO CRK.

NOTE - NE BT ALIVE & GOOD CONDITION

SET BRASS CAP AT COR. MIKD

COUNTY SURVEYORS OFFICE 1956

$\frac{1}{4}$ S $\frac{12}{13}$ T 255 R 4 W. SET CAP 1"

BELOW SURFACE

FROM WHICH 14" HEMLOCK BEARS

S 17° W 53° SCRIBED $\frac{1}{4}$ S 13 CS BT

VAR 21 $\frac{1}{4}$ °

10" MAPLE S 17° W 33° SCRIBED

$\frac{1}{4}$ S 13 CS BT 20 YEARS \pm (DOWN)

NOV. 21-56

J. B.

G. W.

J. H.

N

BRASS
CAP

PRIVATE
LOG. ROAD

DIETZEN NO. 3856

C. S. File No. 47/133

RENEW $\frac{1}{4}$ COR. $\frac{14}{23}$ T 25 S R 4 W

FOUND ORIG SW BT NOW DOWN

SCRIBING VISIBLE N.E. BT CEDAR

STUMP ONLY NO SCRIBES CHECKS FOR

RECORD BEARING & DIST. ALSO CHECKS

CALL TO GRK.

SET BRASS CAP MKD COUNTY SURVEYORS

OFFICE 1950. $\frac{1}{4}$ S $\frac{14}{23}$ T 25 S R 4 W.

FROM WHICH IS CEDAR BEARS

N 34 $\frac{1}{2}$ E 83 $\frac{1}{2}$ ' SCRIBED $\frac{1}{4}$ S 14 CS BT

10" W. FIR 56 $\frac{1}{2}$ ' W 70 $\frac{1}{2}$ '

SCRIBE $\frac{1}{4}$ S 23 CS BT.

VAR $\frac{1}{4}$ °

NOV. 20-50

J.B.

G.W.

J.F.

~~#83~~
#140 J.R.

RENEW $\frac{1}{2}$ COR 5 23/24 1935 R & W

FOUND - ORIG BT 42' FER S 10' E
5.4' DOWN BARK SCRIBED
ALSO FD 18' CEDAR ORIG BT
SCRIBING VISIBLE CHECKS FOR
BEARING & DIST.

SET BRASS CAP MIND. COUNTY
SURVEYORS OFFICE 15.00 $\frac{1}{4}$ S $\frac{23}{24}$ T 2.5' S
R & W

FROM WHICH 13' CEDAR BEARS
N 85° E 29.5' SCRIBED $\frac{1}{4}$ S 24' E S BT
20' CEDAR S 50' 45' W SCRIBED
S 23' E S BT

VAR 2 1/4°
J. R.
S. W.
J. H.

DIETZEN NO. 385-6

#124

C. S. File No. 47/133

2187
500
2557

286
52
858
400
1236

100
400
100
400

340
5

72
72

95593
2588

515.5
355

300
5

240
100
140

71934
6445

544.0
417

319
5

85
M

258827

515.0
329

251
5

258
200

71325
20017

545.0
264

334
5

518
2

76841
22322

541.0
100

450
5

35
M

59919
08716

500
922
422

370
5

26
M

51499619
08716
308

585.0

RENEW SE COR CL 46 T 25 RA

SEPT 17-56
WALKER
J. FEE

COR. RENEWED AT OLD FENCE
POST N.W. RT. FOUND SHOWS OLD
BLAZE BUT NOT CUT OUT.
B.B.I. USED OLD FENCE POST FOR COR
ON FAIR OAKS CEM. JOB.

SET BRASS CAP AT COR. MKD
SE COR. DMC 46 T 25S RAW
COUNTY SURVEYORS OFFICE 1956

FROM WHICH 32" B.O. BEARS
N 76° 45' W 46.5' SCRIBED SE COR
CL 46 CS BT

34" W.O. BEARS N 51° 15' E 65.0'
SCRIBED SE COR CL 46 CS BT

VAR 2 1/4"

SEE ALSO C.S. 37/13

DIETZEN NO. 385-6

T 25 S R 4 W.

1/4 S 14
23

GASSY C.R. 12

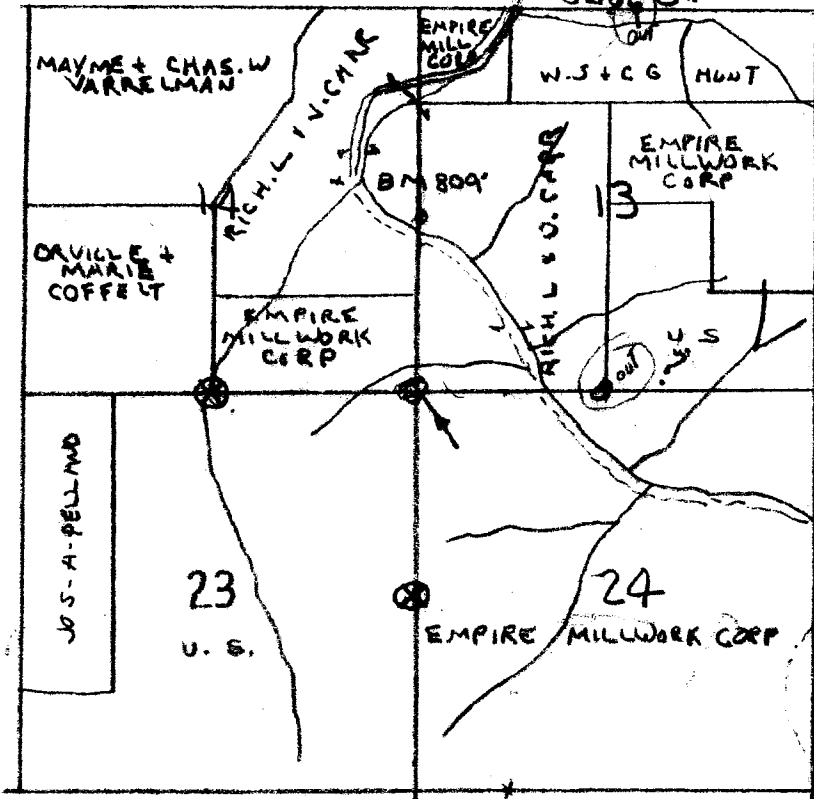

1/4 S 23 + 24

JEC 23 + 24

T 25 S R 4 W

Old B.T.

4 1/2' FIR S 10° 0' E 92#

Blown Down Bark scribe

Visible

Old B.T.

18' CEDER N 50° 0' 990

Cut out with Power Saw

Scribe Visible.

NEW B.T.S.

13' CEDER N 45° 0' E 295 FT

20' CEDER S 50° 45' W 285 FT

SET BRASS CAP

MARKED COUNTY SUR. OFF.

1/4 S 23 + 24 T 25 S R 4 W

T 25 S R 4 W

1/4 Section 23

SET BRASS CAP MARKED 1/4 COUNTY SUR. GASSY CR. RUNS N + S CORNER CR. IS 6# N of GASSY CR.

15' CEDER BEARS N 34° 30' E 83 3/4 FT.

10' W FIR. " S 64° 0' W 70 1/2 FT.

Old B.T. CEDER TREE DOWN ACROSS CRK Scribe Visible BEAR FROM CR S 10° 0' W.

Old B.T. CEDER STAMP NO SCRIBES VISIBLE TIES IN PERFECT DISTANCE + BEARING N 60° 0' E FROM COR.

Se

Q

23

Date 8 Nov. 56

To the County Surveyor
Roseburg, Oregon

Sir:

We have located the government corner noted below and report the following conditions existing as of this date.

T 255 S, R 4 W., W. M.

How was the corner found and identified?

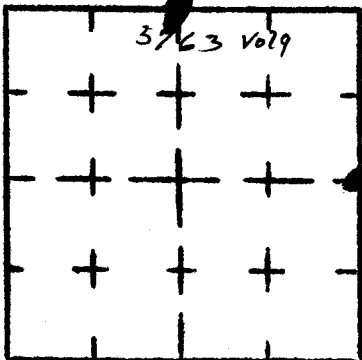

From original BTs.

Section 23

BEARING TREES FOUND

Quadrant	NE	NW	SE	SW
Species & size		WBC		WBC
Dist. & Bearing From Corner		N60E 82ft		S10°W
Condition of Scribe or Scar		Not clipped out		
Original or Resurvey BT				
Appearance of BT				
Tags, Marks, Etc. on BT				BLM BT Tag

Conditions of corner and witnesses NE BT is a stump, no scribes in evidence
SW BT is a blowdown - Both BTs should be
re-established

Best route to reach the corner By way of Gassy Creek Road
Take Right fork at Dick Carrs

Other remarks _____

Signed [Signature]

Date 8 Nov. 56

To the County Surveyor
Roseburg, Oregon

Sir:

We have located the government corner noted below and report the following conditions existing as of this date.

255 S, R 4 W., W. M.

How was the corner found and identified?

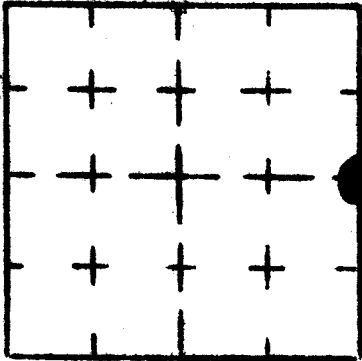

From original BTs

Section 23

BEARING TREES FOUND

Quadrant	NE	NW	SE	SW
Species & size		WBC	D. Fir	
Dist. & Bearing from Corner		N50W-15' 6"	S10°E-14' 6"	
Condition of Scribe or Seal		POOR	Dark scribe POOR	
Original or Resurvey BT				
Appearance of BT		POOR	Blow down	
Tags, Marks, Etc. on BT				

Conditions of corner and witnesses Both BTs should be re-established.

Cedar pole is rotting out. D. Fir is blow down & fell on lead scribe.

Best route to reach the corner Gully Creek Road - take right turn at Dick Carrs

Other remarks _____

Signed B. L. [Signature]