

COUNTY SURVEYORS FILE DATA
DO NOT REMOVE FROM OFFICE

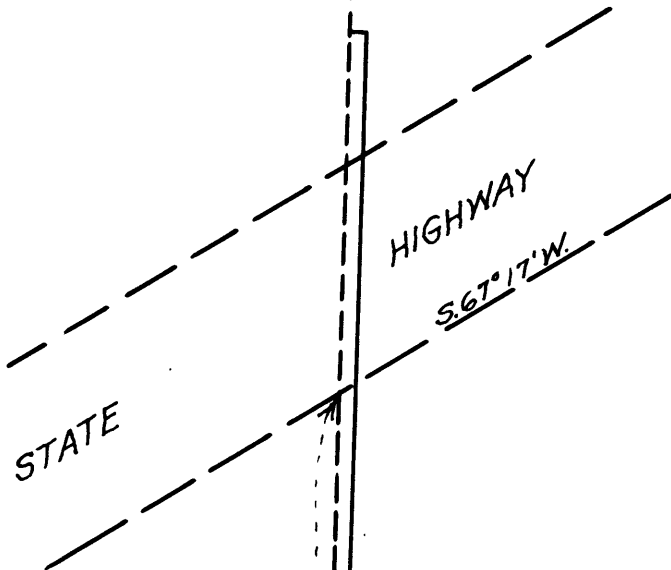

Stumbo property
16.5 ft. wide x 1320.0 ft. long

REGISTERED
OREGON
LAND SURVEYOR

Geo. J. Wenderoth

MARCH 10, 1944
George J. Wenderoth
5

COUNTY SURVEYOR'S OFFICE
DOUGLAS COUNTY, OREGON.
SURVEY SHOWING
S.R. STUMBO PROPERTY IN
SECTION 21, T. 32 S., R. 5 W., W.M.
Geo. J. WENDEROTH, DEPUTY. JULY 1956
SCALE 1" = 200'

20 | 21
29 | 28
Angle Iron
10" Fir N. 74° 45' W. 45.3
34" Pine S. 55° 30' E. 72.1

1347.5

1" I. Pipe
30" Pine S. 29° 30' W. 19.7
12" Madrona N. 66° 06' E. 66.2

S. 89° 55' W. 2695.0

Wagon Axle
8" W. Oak S. 37° 12' W. 46.0
12" B. Oak N. 60° 33' E. 78.4

1347.5