

# STANDLEY PRIVATE ROAD

SECTION 17, T.26S, R.3W., W.M.

SURVEYED APRIL 23, 1941 BY  
**BEN. B. IRVING** ENGINEER & SURVEYOR  
 ROSEBURG OREGON

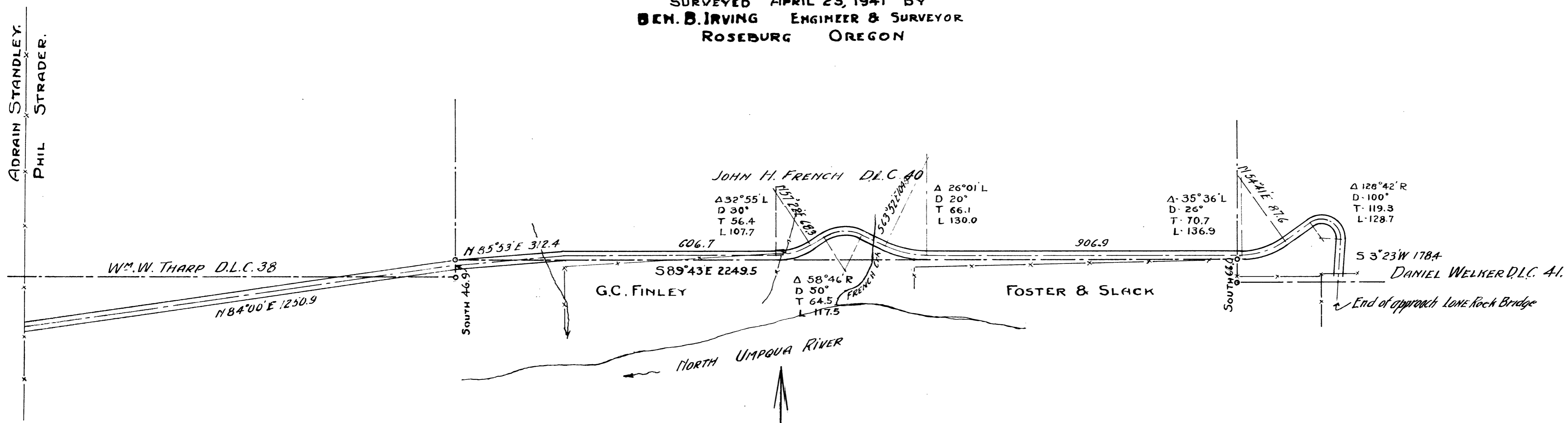

SW Cor. D.L.C. 40. 1" x 48" Iron Pipe driven 16" under ground with Stone 8" x 14" x 18" set 16" in ground on top  
 Orig. B.T. W. Oak 24" diam. bears N 5° E 283.8 ft.  
 Prev. set W. Oak 18" diam. bears S 32 1/4° E 333.2 ft.  
 SE Cor. D.L.C. 38. 10" x 12" x 18" Stone set 14" under ground with two 8" x 8" x 8" boulders set on top.  
 Orig. B.T. W. Oak 24" diam. bears N 4° 30' E 330.7 ft.  
 Prev. set W. Oak 18" diam. bears S 33 3/4° E 289.1 ft.

SE Cor. D.L.C. 40. 1" Iron Pipe at fence corner.  
 Pine 15" diam. bears S 50° 30' E 158 ft.

SW Cor. D.L.C. 41. 3/4" Iron Pipe.  
 Fir 15" diam. bears S 14° 30' W 49 ft.

SCALE 1" = 200'

DIETZGEN NO. 385-B

DR. FINLAY

C. S. File No. 76/154

A

176° 38' (F) 44° 09' 1/2 AV.  
44° 10'

B

5

8° 18' N 4° 09' W  
4° 09' L

409

NORTH

4

~~10784~~  
1077 68

L 699°

NORTH NORTH

+3 1/2°  
300°  
-12° 00'  
810°

3

12° 20'  
6° 10' R

175°

N 6° 10' W

2

24° 40'  
12° 20' L

175°

N 6° 10' E

1

12° 20'  
6° 10' R

1205.3

NORTH

1817  
1920 F D 1 1/2" I.P.

CHECK BEARINGS ONLY TO BOTH B.T.'S.

TREES IN GOOD CONDITION

MAY 26 1951  
L. H. BYRON  
L. H. HAZING

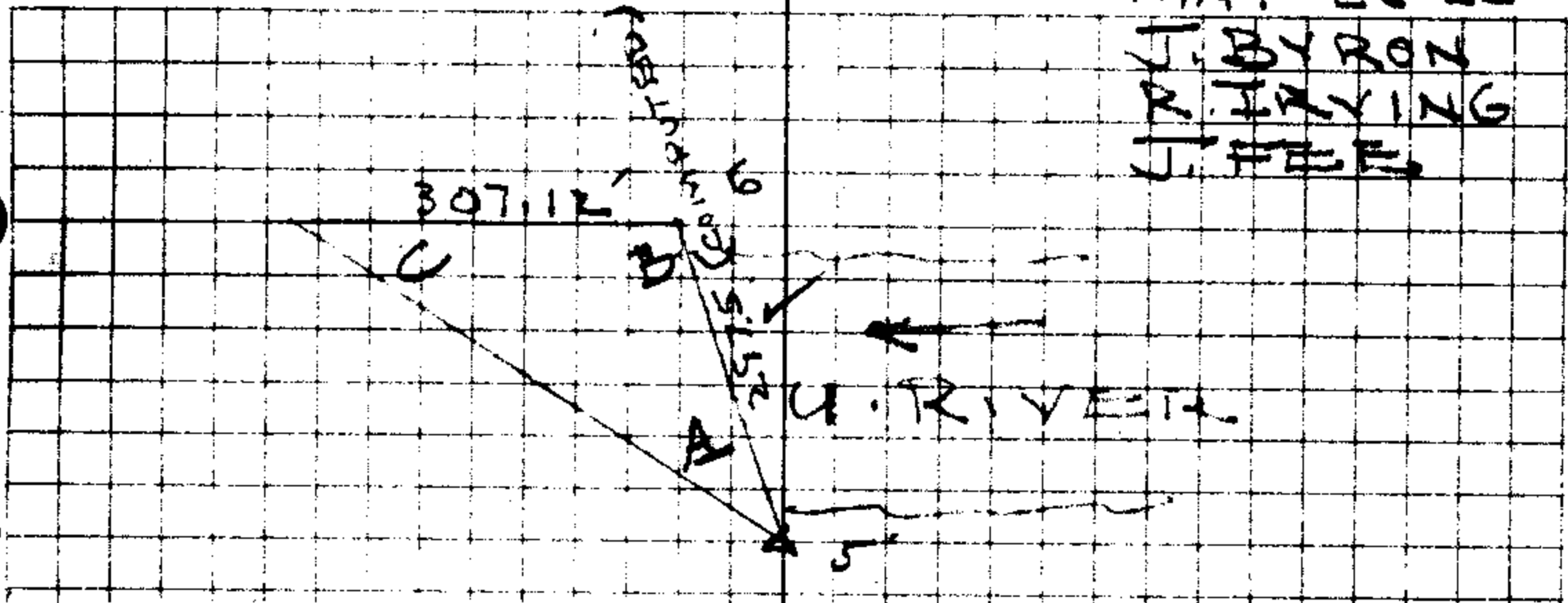

AT SO. EDGE OF R/VV OLD CO. RD.

DIETZGEN NO. 385-6

99813

~~98714~~ 97815

315

G. S. File No. 46/154

378 <sup>67</sup>

55°30'  
300'  
+3°00'  
300'  
300'

N 1°50' 1/2 E N 3° E

9

6°54'  
3°27' R

1037.65

N 1°36' 1/2 W

8

11°31'  
5°45' 1/2 L

297.5

N 4°09' E

7

8°18'  
4°09' R

166.93

75°30'  
167.7

NORTH

6

8°18'  
4°09' R

297.5

N 4°09' W

5

C

169°44'  
42°26'

⊕

42°26'

1:4

B

373°37' 1/2  
93°24' 1/2

⊕

93°24' 1/2

1:4



+15° 25'

N 5° 47 1/2' E

15

11° 35'  
5° 47 1/2' R

711.9

+14° 30'

118°

+7° 50'

300°

(CORRECTED TO) NORTH

L 300°

14

913.9

N 0° 26' W

L 78.3

7° 20'

300°

+6° 15'

300°

+3° 40'

300°

13

0° 22'  
0° 11' R

906.9

+18° 10'

65°

+9° 30'

300°

+8° 20'

NORTH

255°

+2° 50'

300°

N 0° 37' W

12

3° 04'  
1° 32' L

629.5

N 0° 55' E

L 330°

+4° 30'

300°

11

0° 05'  
0° 02 1/2' L

277.12

N 0° 57 1/2' E

+3° 00'

277.5

10

1° 46'  
0° 53' L

971.06

L 72.4

96401

96814

99066

99182

99405

99795

95015

98628

98901

99026

99691

99863

DIETZGEN NO. 385-B

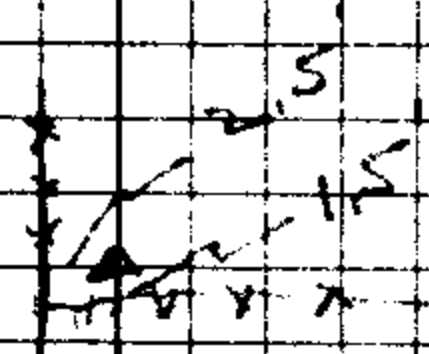
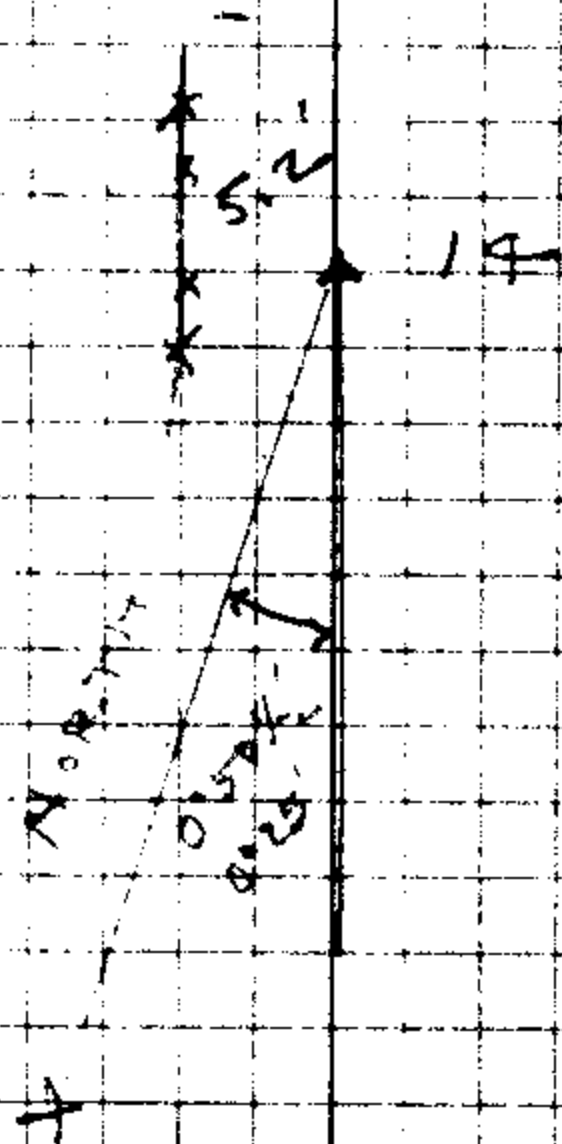

65  
78

L 638 ✓

N 1° 07' W ✓

19

862.8 ✓

1° 27' L ✓

N 0° 20' E ✓

18

416.4 ✓

0° 19' ✓  
0° 09 1/2 R ✓

L 117 0' ✓  
73° 30' ✓  
300 0' ✓

(CORRECTED TO) N 0° 10 1/2 E ✓

17

284.1 ✓

0° 21' ✓  
0° 10 1/2 R ✓

N 3° 35 1/2 W ✓

7 13° 05' ✓  
291 7' ✓

16

174.3 ✓

18° 46' ✓  
9° 23' L ✓

RENEW 6/5  
7/8 T 265 RBW

FOUND - 4" x 4" SQ STAKE  
MIGRATED OFF ALL BTZ AS SET BY  
BOYER 1949

SET 1" I.P. WITH BRASS NAD MKD  
COUNTY SURVEYORS OFFICE 1955

6/5  
7/8 T 265 RBW

BLAZED & SCRIBED 8" CEDAR S 29° E  
81.4' 58 CS BT

MT. SCOTT LOOKOUT BEARS  
N 25 1/2° E

BLAZE & SCRIBE 8" LAUREL S 20 1/2° W  
157.8 57 CS BT

BLAZE & SCRIBE 18" R. FIR N 24° W  
221.0 56 CS BT

DIETZGEN NO. 385-6

99813



97404

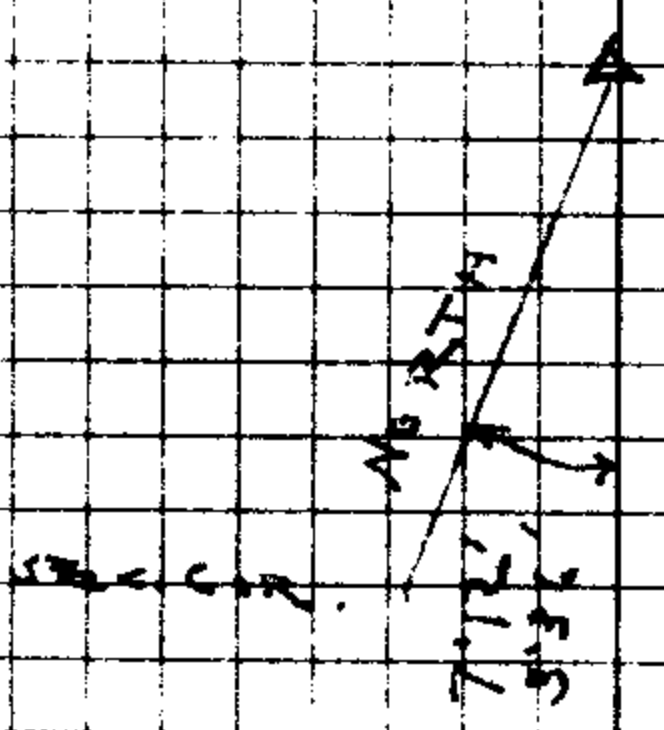

C. S. File No. 46/154

W5

POT

155.6

587°46½ W

+9°15'  
1576

W-4

POT

917.1

POT

+11.6  
+14°52'  
300°  
+8°00'  
300°  
6000  
143°  
+5°30'  
176°

W-3

POT

↓  
940½

+10°45'  
200°  
+10°30'  
200°  
+25°20'  
200°  
+25°20'  
200°

W-2

POT

h  
4465

+9°10'  
1572'  
-8°20'  
300°

W-1

P.O.T

↓  
830½

587°46½ W

87

+15°10'  
250°  
+5°  
300°  
+6°20'  
200°

10

98700 ✓

950.1  
946.5  
830.8

97008 ✓

2279.9

99027 ✓

318.0  
2535.7

99452 ✓

2640.0  
2530.0

99540 ✓

100.0

99657 ✓

90483 ✓

90383 ✓

917030 ✓

919357 ✓

DIETZEN NO. 385-B

97030 ✓

96238 ✓

97619 ✓

1270 ✓

NO. 573E



12/7  
13/18

184.9

N 29° 57 1/2 W

+1° 30'  
18 5°

W-12

S 1° 48' R

N 81° 45 1/2 W

4 33.7

332.5

N 81° W

+5° 10'

300°

W-11

27° 02'  
13° 31' R

429.3

S 84° 43 1/2 W

+7 1/2'

131 1/2

+5° 25'

300°

W-10

22° 19'  
11° 09 1/2 L

239.0

N 84° 07' W N 83 1/2 W

11° 25'

243.8

W-9

11° 16 1/2  
5° 38' R

4  
86.3

(.36)  
(.29)

N 89° 45' W

1° 50'

864'

W-8

4° 57'  
2° 28 1/2 R

162.8

S 87° 46 1/2 W

+9° 15'

1649

7:10 (-)

W-7

P.O.T.

398.9

+6° 30'

300°

+12° 10'

103

W-6

P.O.T.

238.2

+3° 25'

238

RENEW

12.7  
13 18

T 265

7

99966

R 4 W  
R 3 W

FOUND 3 B.T.S AS RECORDED  
 THE NE BT NOW 16" STUMP ONLY  
 99899 SCRIBED BT BEARS N 77° E 251'  
 THE SW BT ALIVE & IN GOOD CONDITION  
 BEARS S 17° W 229' NOW 14" B.O. 229'  
 SHOWS BLAZE IT DO NOT CUT OUT  
 THE SW NOW 20" STUMP ONLY  
 ROTTEN BUT SHOWS BLAZE IT BEARS  
 99200 S 62° E 541'. THE N.W. BT BURNED

99553 I BLAZE & SCRIBE 8" W.O.  
 S 74° E 842' S 18° C S BT

BLAZE & SCRIBE 12" W.O.  
 98021 N 48° E 15.9 R 3 W S 7 C S BT

BLAZE & SCRIBE 13" W.O.  
 N 73° W 15.7 R 4 W S 2 C S BT

99999 SET BRASS CAP AND  
 99878 COUNTY SURVEYORS OFFICE  
 1955

R 4 W  
R 3 W

VAR 2 1/4'

98700

N 45° E 55  
 I. H. H. W.  
 R. H. W. I. N. G.  
 J. F. H.

99357

97754

99822

DIETZSEN NO. 385-6

C. S. File No. 46/154

E-6

109.55

5° 29' E  
4° 15' R

S 74° 41' E

E-5

448.7

28° 43'  
14° 21' R

S 78° 56' E S 79° E

N 81° 42' E N 87' E

E-4

374.7

7° 27'  
3° 43' R

S 89° 34' E S 89° E

L 74.7

+ 10  
300'

E-3

7° 34'  
3° 47' R

1974.7

N 86° 38' E

E-2

348.9

14° 12'  
7° 06' L

S 86° 15' E

S 86° E ~~3000'~~

E-1

929.2

11° 56' E  
5° 58' R

N 87° 46' E

L 629.5

300'

10

DIETZGEN NO. 3886-6

99985 ✓

99905 ✓

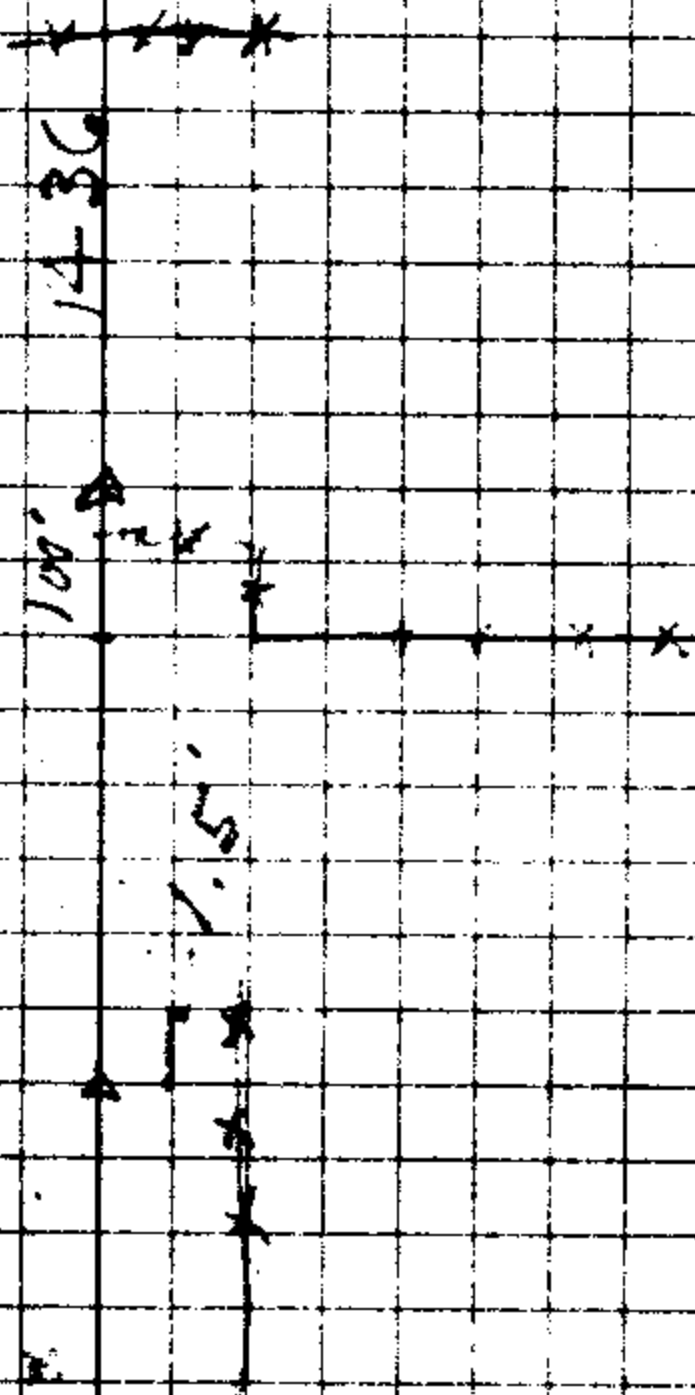

4467  
MAY 7 1955  
8

C. S. File No. 46/154

S-7

L159.2 ✓ N80°31'E

S-6

24°57' ✓  
12°28' R

4042.6 ✓ N68°02' E N69° E

S-5

98°49' ✓  
49°25' L

380.4 ✓

S62°32' E S63° E

L81.5  
-5°00'  
300°

S-4

106°39' ✓  
53°19' R

N64°08' E

297.9 ✓

PK  
S-3

339°58' ✓  
169°54' L

S54°07' W

1176.8 ✓

S55° W

PK  
S-2

25°46' ✓  
12°53' R

954.1 ✓

S41°14' W

S42½' W

S-1

85°28' ✓  
42°44' R

L879.2

1178.1 ✓

S1°29' R S0°30' E

-5°  
300°

8 19  
17 16  
FO. BRASS  
CAP.

146°24' ✓  
73°12' R

240.4 ✓

-3°15'  
240°

S74°41' E

DIETZGEN NO. 3885-6

✓  
99619

NEW HINEBKA  
BRIDGE

FD -- BRASS CAP  
AT C.O.R.

RENEW SEE CON  
8 1/2" THE NW BT  
17 1/2" WHICH CHECKS FOR  
BEARING & DIST IS THE  
ONLY BT LEFT THE  
OTHER B.T.S HAVE BEEN  
CUT & STUMPS ROTTED  
THE NW BT NOW 24"  
SHOWS GOOD BLAZES,  
I DO NOT CUT OUT.

IBLAZE & SCRIBE 8" W/O  
36 1/2" 85° 5 1/2 CS BT

IBLAZE & SCRIBE 10" W/O  
N 72° E 53.8' S 9 CS BT

IBLAZE & SCRIBE 10" W/O  
S 71 1/2° W 31.9' S 17 CS BT

VAR 2 1/4"

✓  
99619

✓  
99839

1/4 COR.

17 | 16

✓  
152  $\Sigma$

S 37° 30' 1/2 E S 36° E

+ 10° 00'  
155  $\Sigma$

S-9

✓  
90  $\Sigma$

19° 59' L

S 17° 31' 1/2 E

+ 12° 50'  
92  $\Sigma$

S-8

✓  
163  $\Sigma$

53° 55'  
76° 56' 1/2 R

N 85° 32' E

S 16° 1/2 E

+ 6° 30'  
164  $\Sigma$

S-7'

10° 02'  
5° 01' R

N 86° E

N 80° 31' E

10  
HARRISON  
MAY 1955

DIETZGEN NO. 3885-B

RENEW 1/4 COR. 1716 TRGS R3W

98461 FOUND - N.W. BT AS PREVIOUSLY  
RENEWED NOW 1/4 R.F. SHOWS GOOD  
BLAZE I DO NOT CUT DGT. ALSO  
FOUND N.E. BT STUMPS ONLY SCRIBED  
BT AT BASE. BOTH WERE CHECK FOR  
BEARINGS & DIST. I DO NOT FIND  
1/4 BOLT AT COR.

97502

I SET 3/4 1/4 COR. (COR IS  
UNDER N.S. FENCE AND IN SMALL  
BROOK)

99367 BLAZE & SCRIBED 8" R.F. 58° W  
170' 1/4 S 1/4 COR. BT

N 15° 14 1/2 W

209  
300

X-5

10° 40'  
5° 20' L

N 9° 54' W N 9° 00'

94

X-4

218° 03' ~~218° 03'~~  
109° 01 1/2 L 109° 01 1/2 L

1150

S 80° 52 1/2 E S 80° E + 5° 45'

1156

X-3

40° 48 1/2  
20° 24 R

348

50

614

5° 50'

N 78° 43 1/2 E

289

N 80° E

X-2

23° 58'  
11° 59' L

596

S 89° 17 1/2 E

7200

296

71° 30'

300

X-1

2° 02'  
1° 01' L

1447

S 88° 16 1/2 E

7600

2497

3 1/2

300

300

300

300

18/17  
19/20

176° 33'  
88° 16 1/2 L

B.S.

SOUTH

1

JUNE 10-55  
J. BROWN  
R. TRYING  
J. FEE

✓✓  
99885 299 <sup>67</sup>

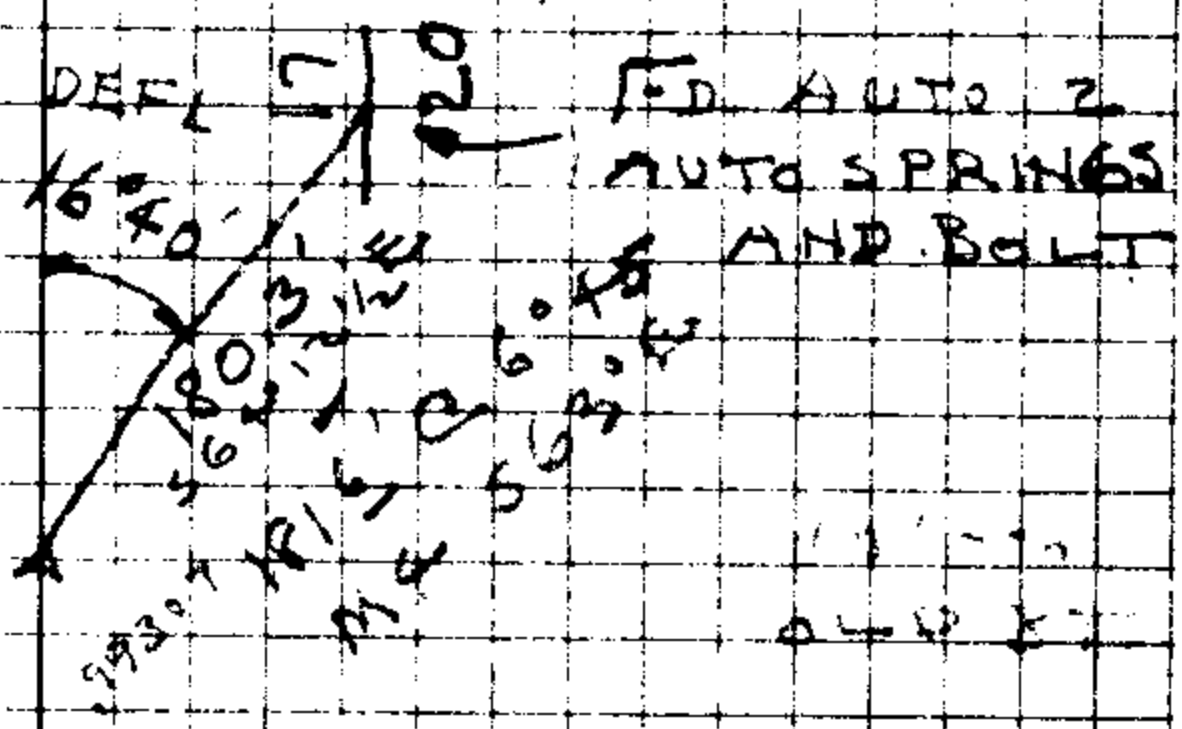

✓✓  
99497

RENEW  $\frac{1}{2}$  COR  $\frac{17}{20}$   
TRA S RW

✓✓  
49619 61 <sup>17</sup>

FOUND - AUTO SPRINGS  
AND BT 24" R. FIR  
N69° W 44' AS RENEWED  
BY BOYER 1949. ALSO  
FOUND 30" B.O. S 30° E  
100' ORIG. BT. A SECT.  
CUT FROM THIS TREE  
SHOWS SCRIBING.

✓✓  
99290 286 <sup>95</sup>

I BLAZE A SCRIBE  
10" R. FIR N68° E 23.5  
 $\frac{1}{2}$  17 CS BT

DIETZGEN NO. 385-6

✓✓  
99939 296 <sup>22</sup>

VAR 21 1/2°

✓✓  
99966 299 <sup>90</sup>

✓✓  
99890 248 <sup>18</sup>

✓✓  
99813 299 <sup>44</sup>

✓✓  
99863 299 <sup>59</sup>

S-2

✓  
N59°07'E

S-3

7°36'  
4°18'

✓  
1386.1'

✓ N59'E  
N58°25'E

S-4

73°07'E  
36°34'R

✓  
1092°'

✓  
N21°51'E

✓  
L 795'

✓  
-8°55'  
300°'

S-5

74°12'  
37°06'R

✓  
935'

✓  
N15°14'W

✓  
L 356'

✓  
400°'  
280°'

DIETZGEN NO. 385-B

JOB ON SO. SHORE OF LGE.

✓  
98791

✓  
99756

279<sup>32</sup>

C. S. File No. 46/154

RENEW  $\frac{1}{4}$  COR. 7/8 T 26 R 3

LOC. OF  $\frac{1}{4}$  COR DETERMINED BY  
PROPORTIONAL MEASUREMENTS

SET 1" I.P. WITH BRASS CAP MKD

$\frac{1}{4}$  S 7/8 T 26 R 3 W COUNTY

SURVEYORS OFFICE 1955

at surface of ground

$\frac{1}{4}$  COR.  
7/8

179.40

56' 4" E

- 24.50  
6" 00'  
200'

14

6' 49" L

15

DIETZGEN NO. 385-6

Mt. Skat  
LOOKOUT

N  
W  
E  
S  
N  
W  
E  
S

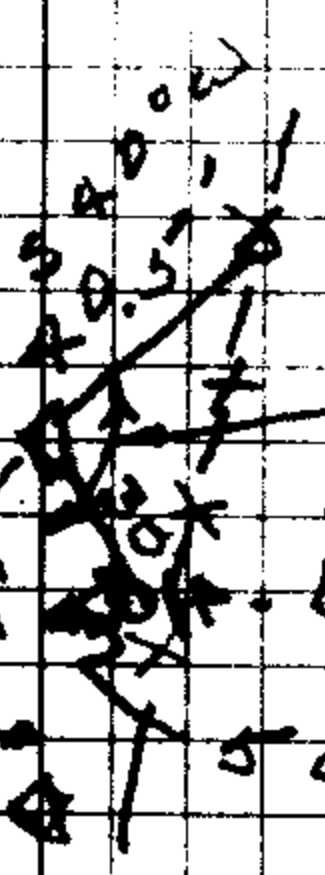

Post & scribed  
B.O. with rod  
on N. side

133° 40'

Post scribed  
B.O. with rod  
on S. side

110° 17'

VINEY  
ST  
ST

C. S. File No. 46/154

W-5

P.O.T.

2382

238.1

-2°30'  
2383

W-6

P.O.T.

3989

398.9

-3°50'  
102.3  
-8°20'  
3000

W-7

P.O.T.

1628

162.8

9°45'  
1652

W-8

4°56'  
2°28' L

863

86.2

+2000  
863

W-9

11°15'  
5°38' L

2390

239.0

+11050  
243.5

W-10

22°18'  
11°09' R

429.3

428.9

+5°45'  
262.7  
-7°30'  
1690

W-11

27°02'  
13°31' L

334.5

332.3

L 33.9  
-5°50'  
3000

W-12

103°42'  
51°51'

184.9

185.0

1217

1518

REMEMBER TO CHECK DISTANCE ONLY

J. BYRON  
R. JAYING

99905

99776

~~98944~~

98556

99939

98113

99497

99144

99482

99966

DIETZGEN NO. 385-6

~~715.00'~~  
179.0'  
~~-14.25'~~  
150.0'

VV-1 P.O.T.

499.9'  
~~717.80'~~  
103.0'  
~~-60.00'~~  
300.0'

446.5 446.0

W-2 P.O.T.

~~244.0'~~  
76.8  
~~25.05'~~  
300.0'

OK  
940.1 940.2

272.4  
67.0  
1.00'

~~300.0'~~  
~~5.20'~~  
300.0'

W 3

113.5  
~~5.40'~~  
300.0'

OK  
609.5

916.9

~~7.30'~~  
300.0'

W-3 A P.O.T.

OK  
307.4

116.5'  
~~14.10'~~  
300.0'

VV-4 P.O.T.

OK  
155.6 155.6

90.2'  
157.6'

77  
637  
~~537~~  
~~700~~

96593

96851

95372

95952

90875

90569

DIETZGEN NO. 385-6

99567

99511

99144

96959

98714

14

OK

9739 973.8

L 300°

L 78.2  
+6°00'  
300°  
+6°30'  
300°  
+4°10'  
300°

~~13~~

OK

9069 906.8

+16°10'  
64.4  
+9°25'  
299.6  
+9°10'  
255°

~~11~~ +8°10'  
300°

12

6295 629.6

+4°30'  
300°

L 330°

11

2771 276.90

+3°45'  
277.5

10

830.8 830.7

-6°50'  
214°  
-4°30'  
300°  
\*

A 2850  
14

99952

99357

99736

96046

98652

98723

98986

99692

99786

99290

99692

DIETZGEN NO. 385-6

6 | 5  
7 | 8

63.8

19

1°27' L

862.8

300°

18

0°20'  
0°10' R

L 117°  
+3°15'  
300°

17

0°21'  
0°10 1/2 R

B.S.  
SOUTH Td SEC. COR.

+13°05'  
291°

16

+15°30'  
180°

15

716.4

715.6

+16°00'  
119°  
+8°00'  
300°

DIETZGEN NO. 385-6

C. S. File No. 46/154

1/4 CIR.

78

181.18

1423'25"W

Δ

92°13' L

L112.75

17°40

1000'

N68°48'E

37°57'

18°58' L

W3-A

N87°46' E

B3.

W4

JUNE 16-55  
J. BYRON  
N. IRVING  
J. FEE

DIETZGEN NO. 385-6

RENEW  $\frac{1}{4}$  COR.  $\frac{1}{8}$   
ORIG. B.T. NOT FOUND  
POSITION OF COR. LOC.  
BY PROPORTIONAL  
MEASUREMENTS.  
SET 1" I.P. WITH BRASS  
CAP MKD. CO. SLIDER  
1955  $\frac{1}{4}$  COR.  $\frac{7}{18}$  TRCS

R.3 W.

⊙

BLAZED & SCRIBED  
12" W.D. 289' W 65.8'  
 $\frac{1}{4}$  S 7 CS BT

BLAZED & SCRIBED  
12" W.D. 50 1/2' W 77 1/2'  
 $\frac{1}{4}$  S 18 CS BT.

9528

YAR 214

C.S. File No. 46/154

✓  
587°21'W 588°W

A-5.  
6'01½'  
3°0½'R

710.5  
584°20½'W

A-4  
35°42'  
17°51'L

418.5  
N77°48½'W  
+8°20'  
120.2'  
-3°10'  
300.0'

A-3  
24°30½'  
12°15½'R

735.8  
589°56'W

A-2  
21°10½'  
10°35½'L

✓  
N79°28½'W

537.7  
1480°W

A-1  
34°23'  
17°11½'R

845.6  
583°20'W

S-2  
84°10½'  
42°05½'R

✓  
541°14½'W

S-I B.S.

DIETZGEN NO. 385-6

NO FENCE  
ANCHOR POST  
ONLY

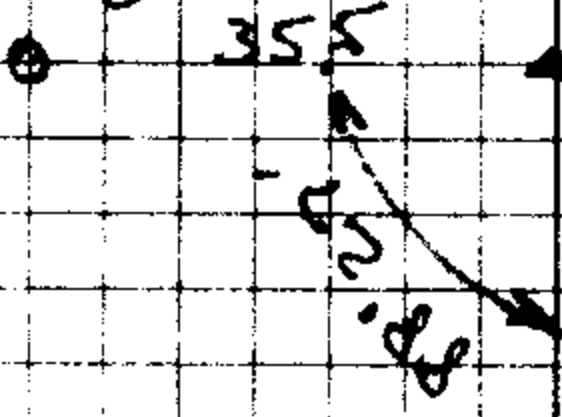

118 93  
279 54

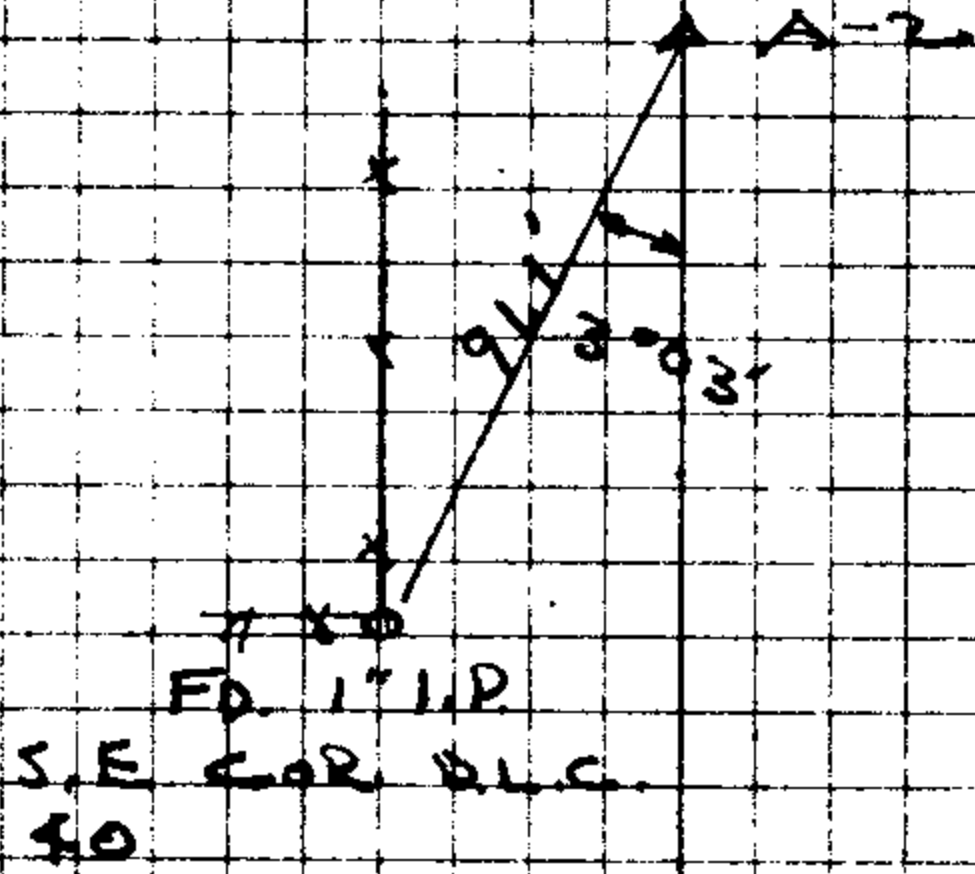
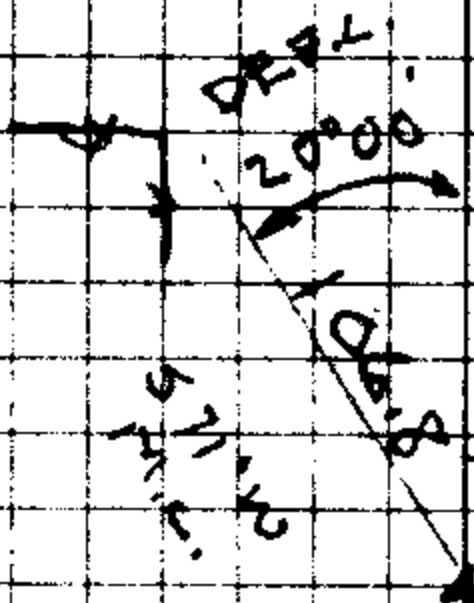

3RT CAP.  
18 | 17 WIT.  
COR.

32.25' N0°23'E

A

179°14'  
89°37' L

17.96

EAST

4

180°00'  
90°00' R

NORTH

B.S.  
3

6

50°01'E

7  
A-7

159°17'  
77°08½ L

1304.0'

577°07½ W

S.W. COR.  
DLC 40  
FD, 1" L.P.  
A-6

20°27'  
10°13½ L

308'

RENEW 1/4 COR 18/17

JUNE 17-55

BTS NOT FOUND. LOCATION OF 1/4 COR. DETERMINED BY SUB DIVISION OF SECTION COR. FALLS ON STEEP BANK OF S. UMPQUAR SET BRASS CAP AT TOP OF BANK FOR WIT. COR.

J. BYRON  
R. IRVING  
H. FREE

BRASS CAP MKD CO. SO. OF 1955 18/17 T 26 S R3W WIT. COR 215' N. TO 1/4 B

BLAZED & SCRIBED 12" W.O. S 59° W 61.8' WIT COR 5/8 C.S. BT.

MIT. SCOTT LOOKOUT BEARS N 63 3/4° E

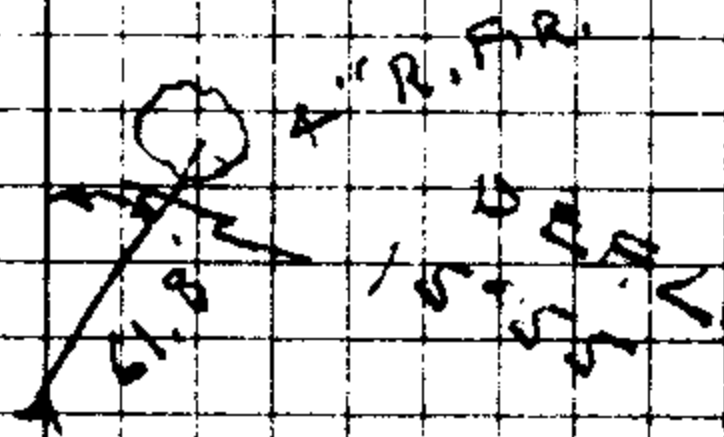

DIETZGEN NO. 3855-6

S. E. COR. D.L.C. 38

S. W. COR. D.L.C. 40

S.E. B.T. SHOWS SCRIBED MKS AT BASE CHECKS FOR DIST. 10" X 12" X 18" STONES NOT FD. ORIG. BT RESCRIBED BY FREEAR

FD 8' X 16' X 18" STONE MKD 40

FD 1" I.P. 16" UNDER

FD 18" W.O. SHOWS SCRIBED MKS AT BASE

FD 3/8" I. R. SET BY FREEAR 1954

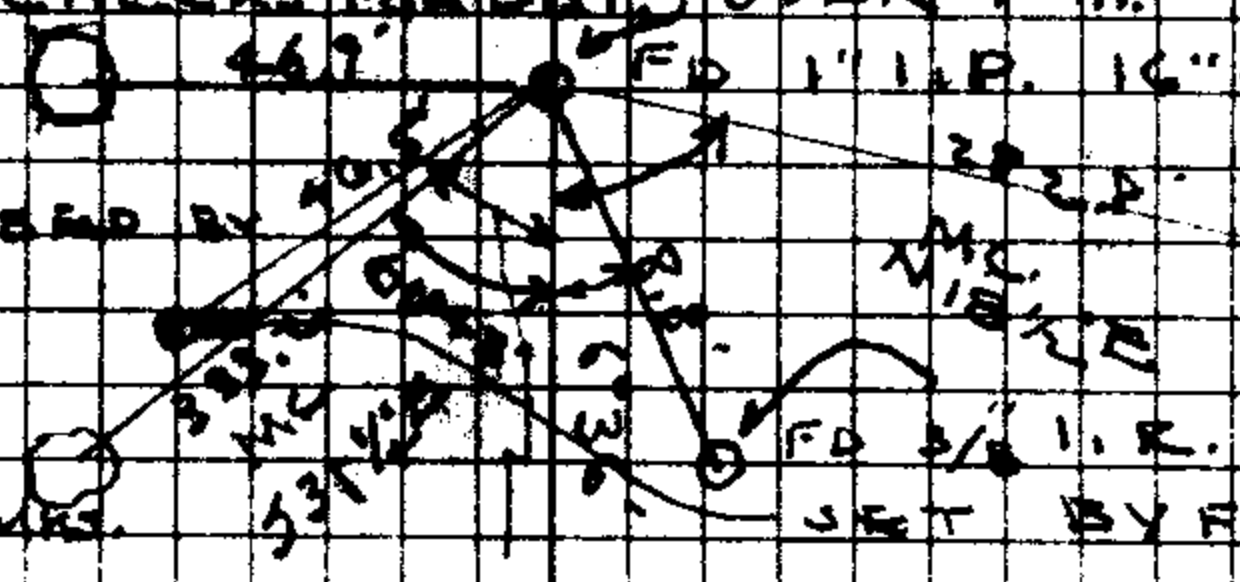

FD 48" W.O. SCRIBED BY FREEAR (FREAR 1954)

B1906

C. S. File No 46/54

577°52½E

577½°E

Z-2

34°50'  
17°00' R

N85°08'E

817.7'

Z-1

17°31½'  
8°45½' L

5290

586°06½E

Δ

7°46'E  
3°53½' R

EAST

4

DIETZGEN NO. 365-B

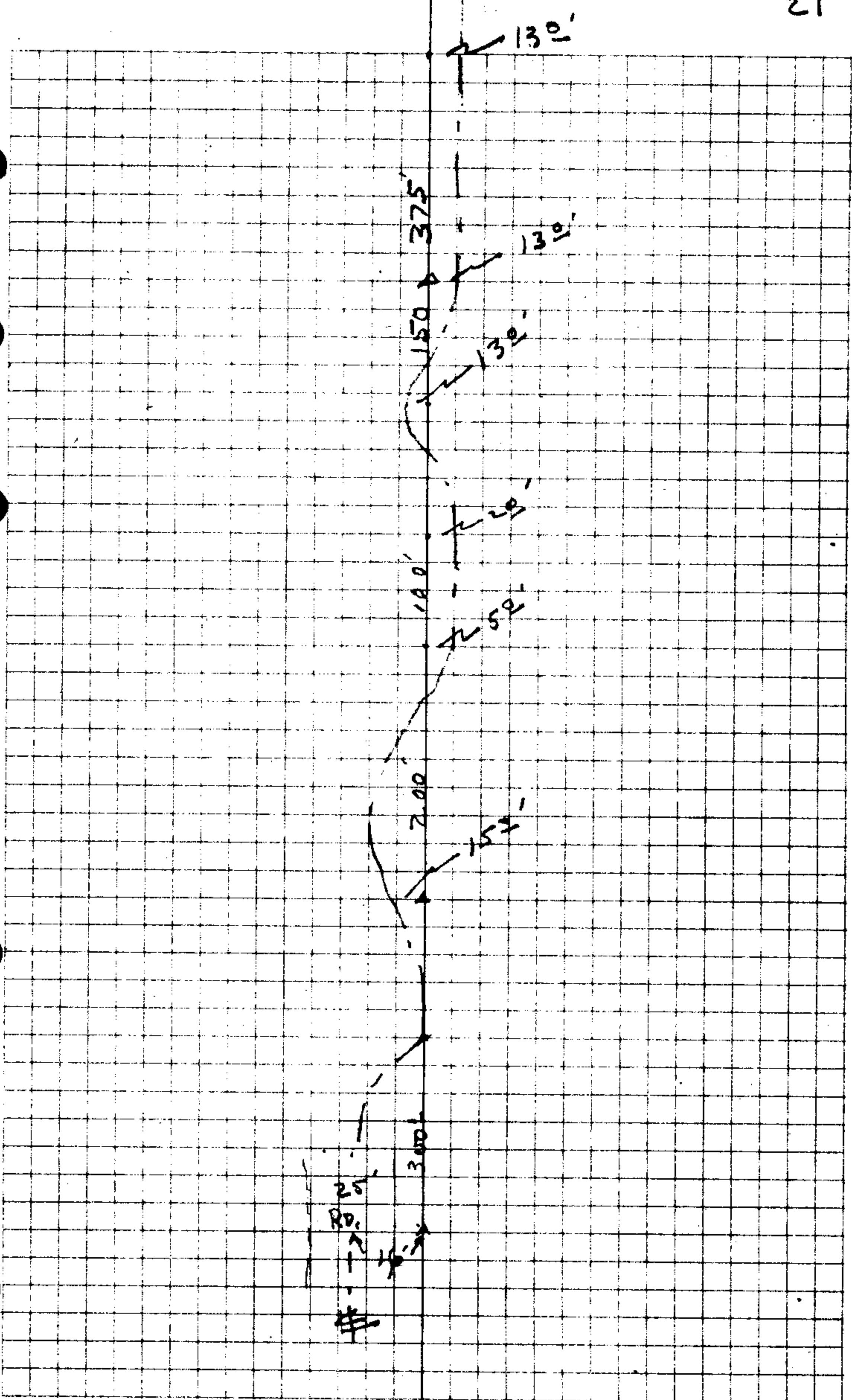

C. S. File No. 46/154

N87°43'E

2-5

19° 33'  
9° 46 1/2'

N77° 56 1/2'E

2649'

2-4

8° 30'  
4° 5'

N82° 11 1/2'E

7030'

2-3

39° 52 1/2'  
19° 56 1/2'

N83° E

5760'

DIETZGEN NO. 385-6

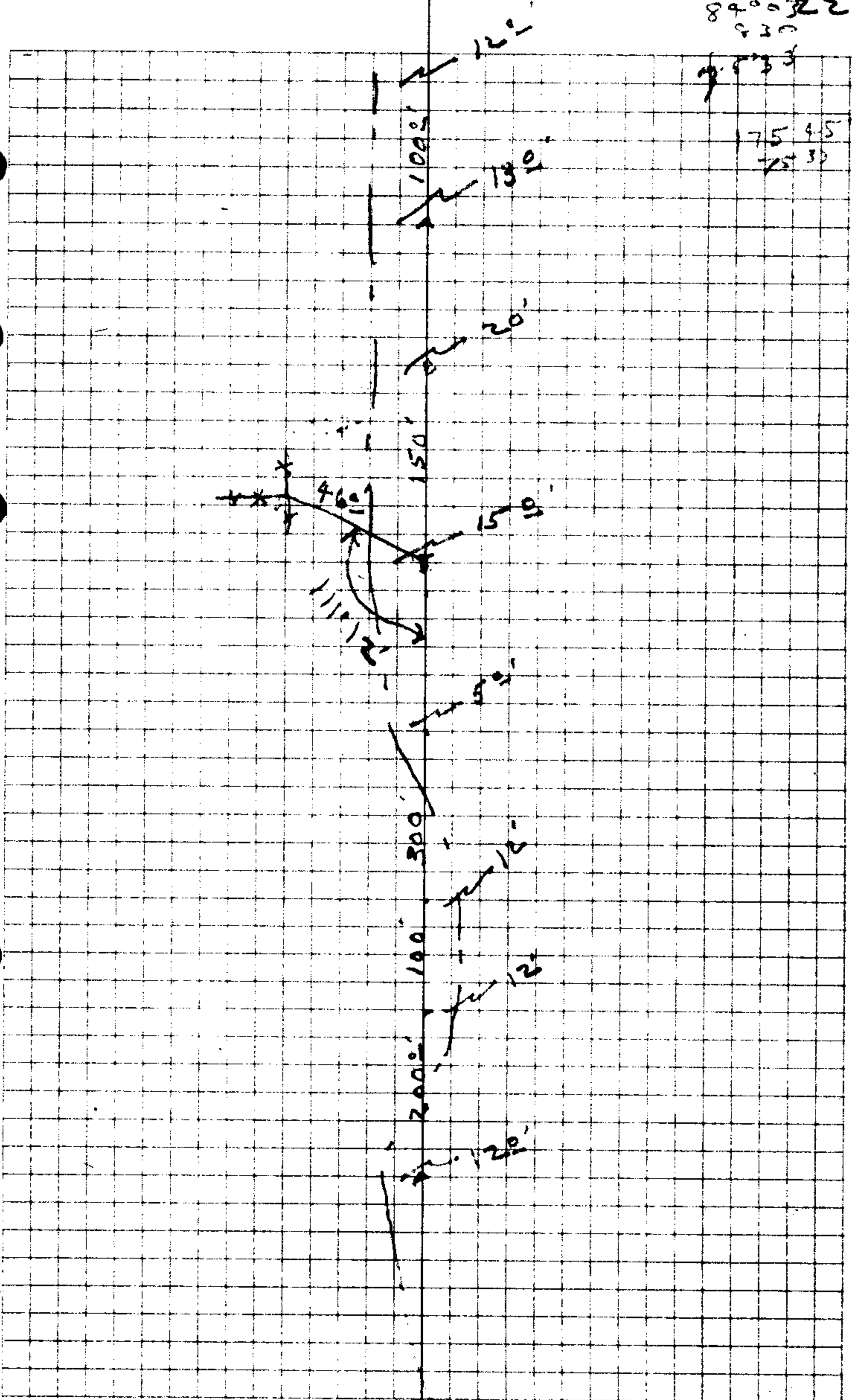

890022  
 230  
 7.5 45  
 25 30

C. S. File No. 46/54

5-2

N54°09'E

5-3  
= 2-6

67°08'  
33°34' L

N88½° E

9449'

N87°43'E

DIETZGEN NO. 3885-B

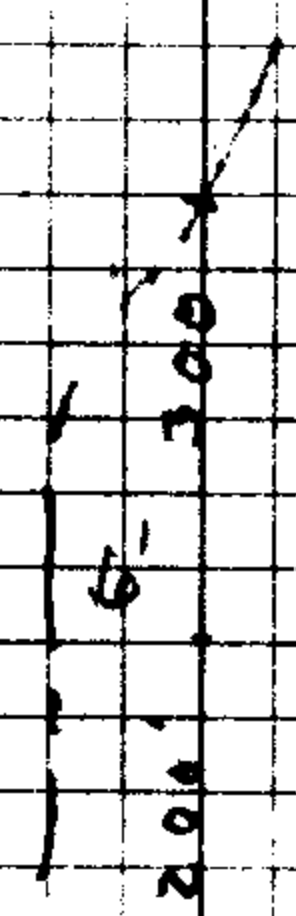
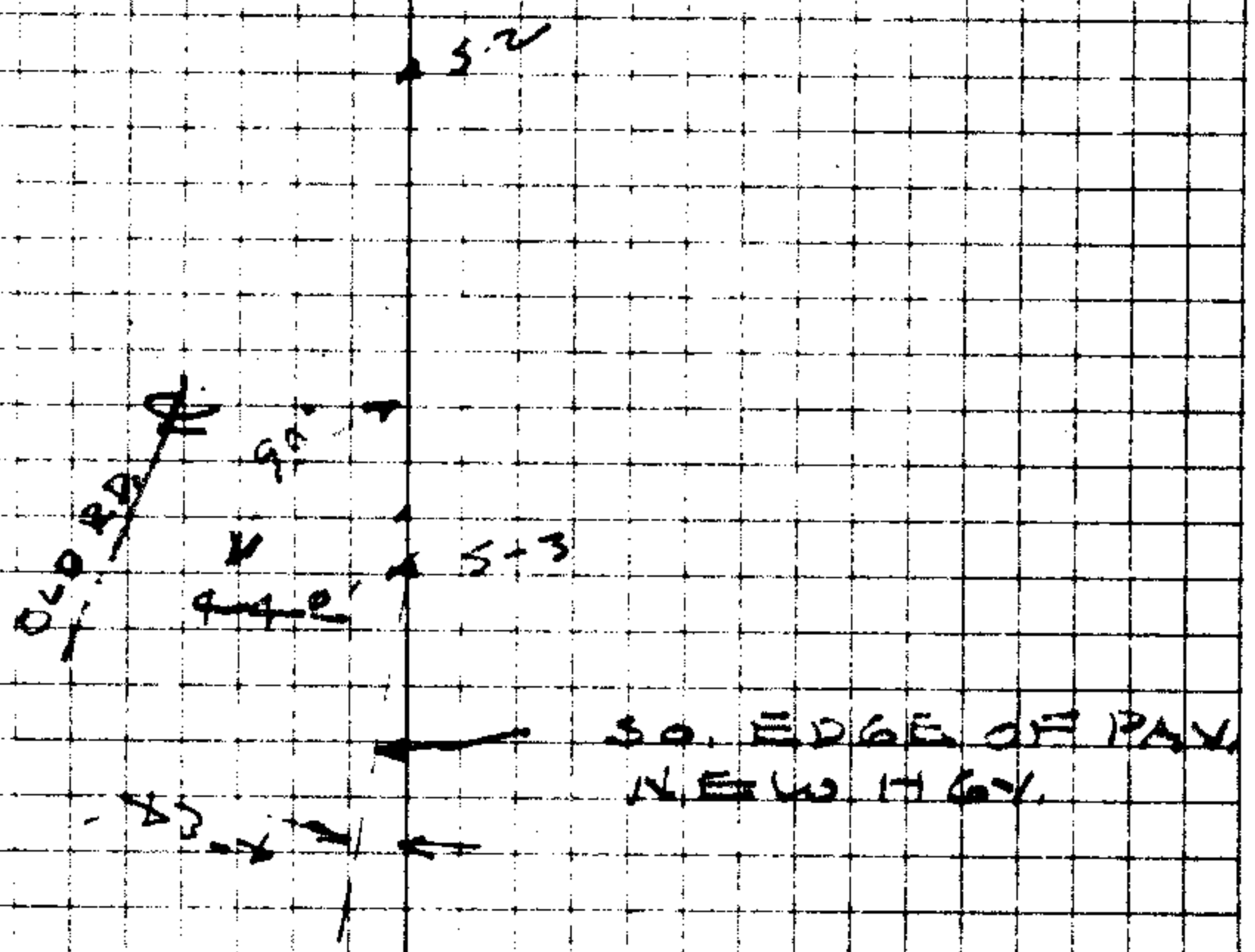

C. S. File No. 46/154

RENEW SEC. COR.  $\frac{718}{1817}$  T26S R3W

LOCATION OF COR. DETERMINED

BY DOUBLE PROPORTION

SET BRASS CAP 2" UNDER SURFACE

MKD. COUNTY SURVEYORS OFFICE 1955

$\frac{718}{1817}$  T26S R3W.

BARK BLAZE & SCRIBE 40" R.F.

N 35° W 1736' S 7 T26S R3W CS BT.

BLAZE & SCRIBE 50" TRIPLE CEDAR

S 22½° W 1733' S 18 T26S R3W CS BT.

NO SUITABLE TREES IN N.E. OR

SE. QUADS.

$\frac{718}{1817}$

78.60

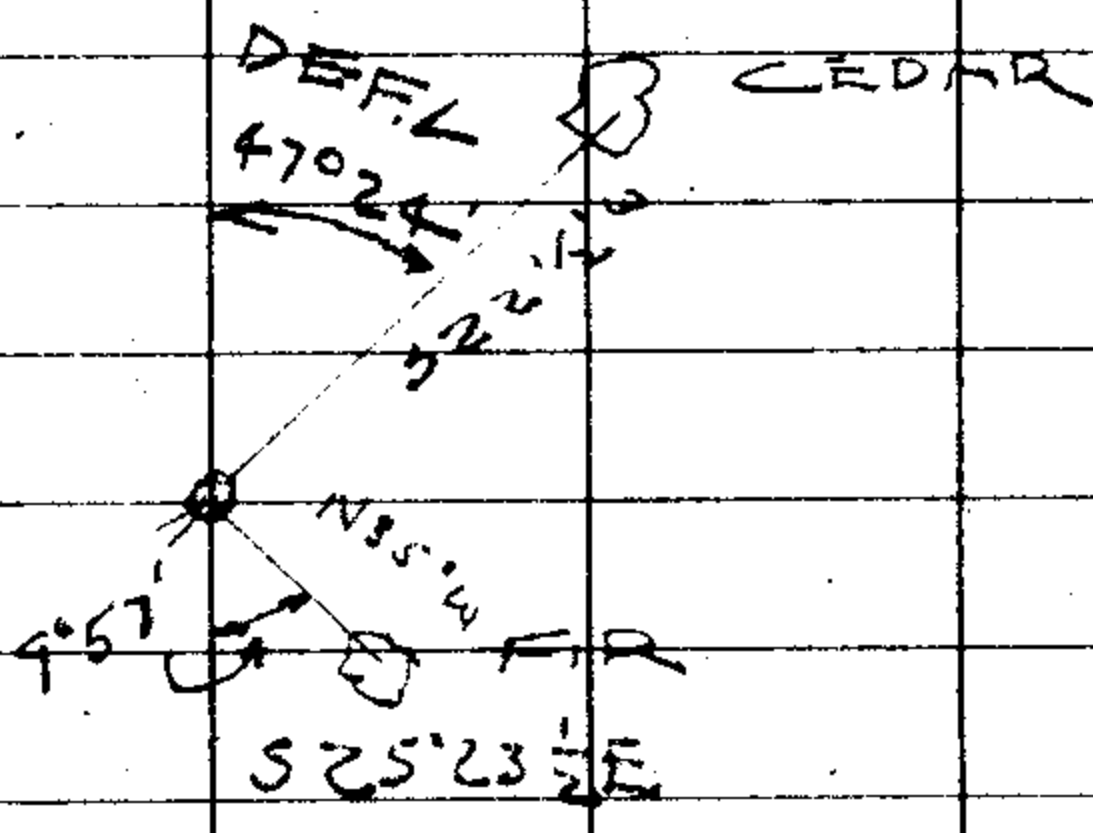

S 24½ E

10

52° 42'  
26° 21' L

S 0° 57½ W

B.S.  
11

DIETZGEN NO. 385-B

C. S. File No. 46/154

RENEW

$\frac{1}{4}$  COR

$\frac{8}{17}$

T26

R3

see Co.

46° 10'

23° 02' R

N 89° 26' W

$\frac{1}{4}$  COR  $\frac{8}{17}$

587 25

567° 26' W

E3

45° 59'

22° 59'  $\frac{1}{2}$  L

N 89 34  $\frac{1}{2}$  W

Set 1" X 36" IP with Brass Cup  
Mld. County Surveyors Office

T. 26 S. R. 3 W. 4 S. 8 1955

from which look out Mt

Scott bears N 12° 1/2' E

18' Apple bears N 21° W 21'

Mld 458 CS BT

DIETZGEN NO. 385-6

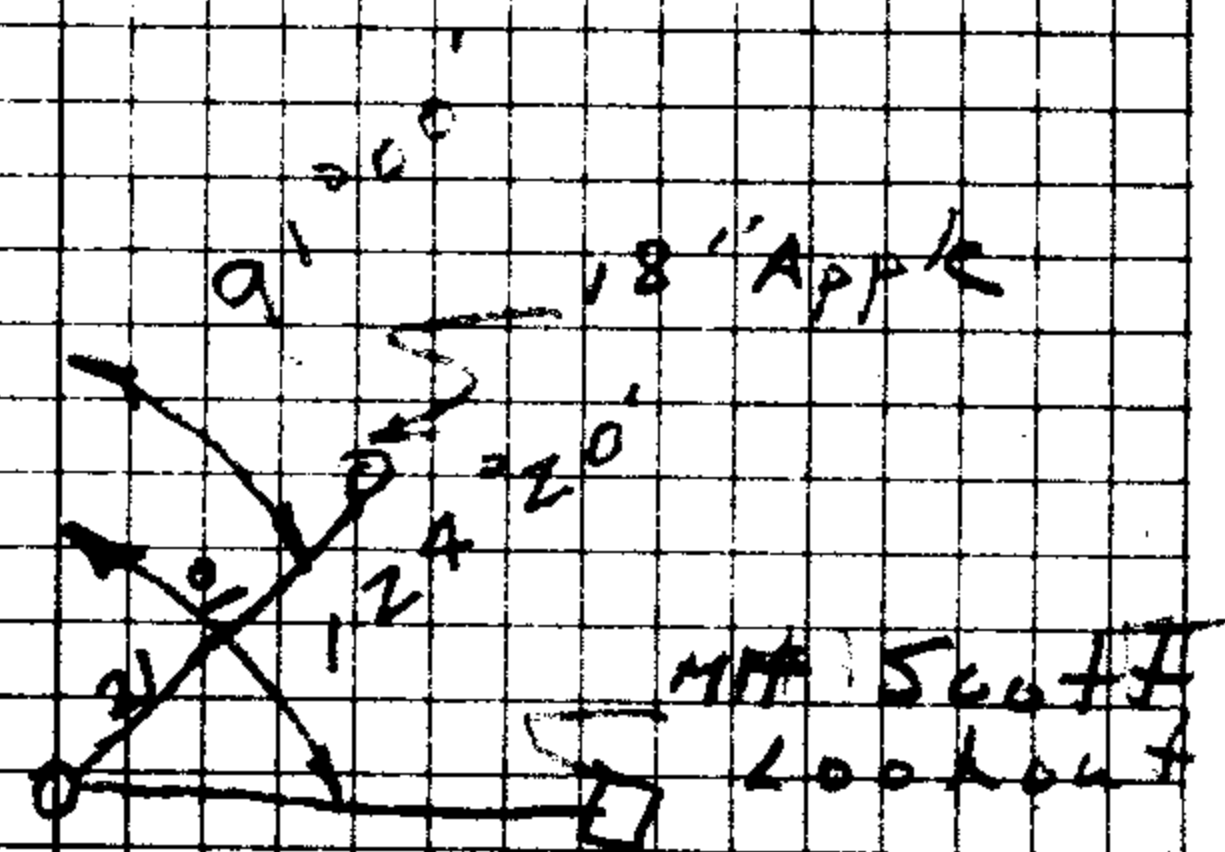

on old N & S Board Fence

A

edge water

130'

set  $\frac{3}{4}$ " R

298'

S 0° 31' W

Set  $\frac{3}{4}$ " R

NW corner

Lot 3

179° 47'

S 9° 53' E R

104.5

S 89° 22' E

A 6

SW corner

DL 40

353° 27'

176° 43' L

S 87° 21' W

A 5

DIETZGEN NO. 385-B

On North or right <sup>High bank</sup> bank N.  
 Umpqua River  
 14' WO Bears S 89° E 6.5'  
 MKL < S BT

In North edge of Standley  
 gateway road

set  $\frac{3}{4}$ " R

10.00

East

A

$90^{\circ}00' L$

11.61

South

A3

$77^{\circ}48\frac{1}{2}' R$

$S 77^{\circ}48\frac{1}{2}' E$

A4

DIETZGEN NO. 385-6

85° R. to High bank  
105° R. to Waters Edge

Mt. Scott  
Lookout

790 ft



WATER

NE of Lot 3 in middle of Rd.

100 ft  
100 ft  
100 ft  
100 ft  
100 ft  
100 ft  
100 ft  
100 ft

1/4 Doug. Fr  
scribed  
CS BT

C. S. File No. 46/154

N0°31'E

CW 1/2

33°09'R

24°7'

N32°38'W

ZZ

90°28'E

45°14 1/2'R

N77°52 1/2'W

DIETZGEN NO. 385-6

CW 1/16 CR

Set 5/8" IRod by Sec. Sub.

From which a;

10" W.O. bears N 24 1/2° E 42.6  
Scribed CW 1/16 CS BT

10" W.O. bears N 29° W 33.8  
Scribed CW 1/16 CS BT

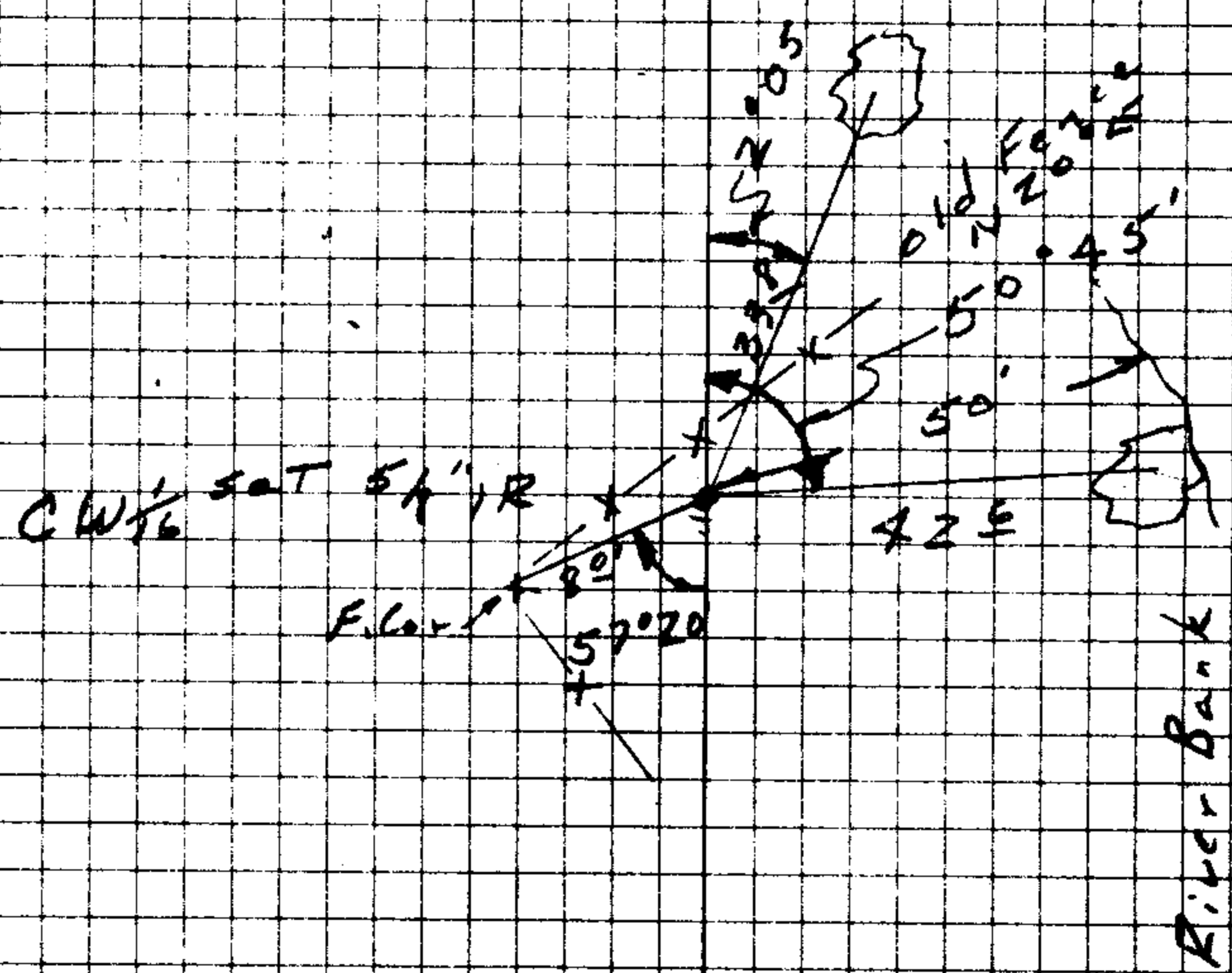

C 1/4 517

73.21

N 51° 08' E

Z 4

53° 37 1/2'  
26° 48 1/2'

N 77° 56 1/2' E

Z 5

Set 5/4 517 by Sec. Sub.  
From which a:

24" W.O. bears N 85° W 35'

Mkd. 5/4 5 CS BT

12" W.O. bears N 85° W 79'

Mkd. 5/4 5 CS BT

DIETZGEN NO. 365-6

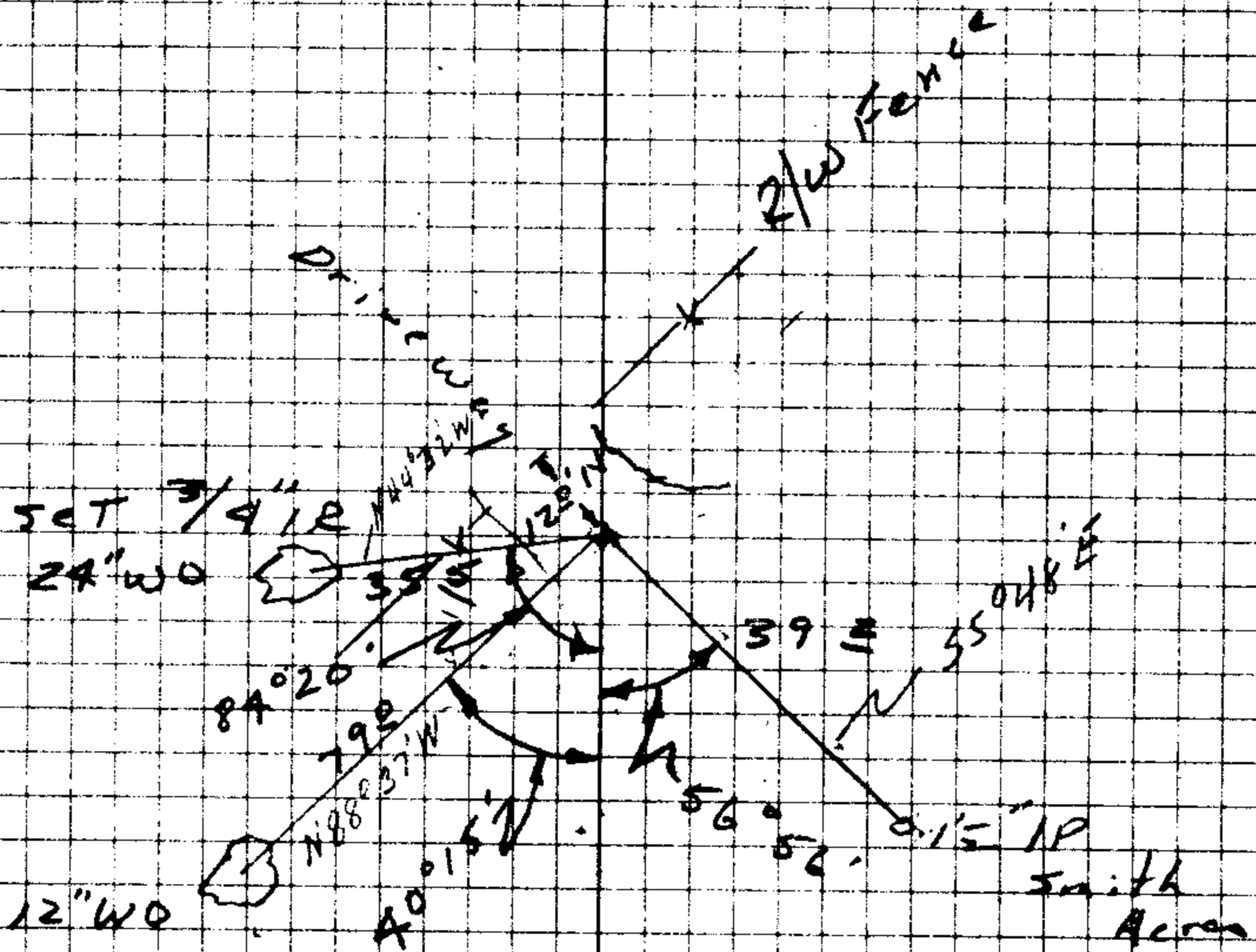

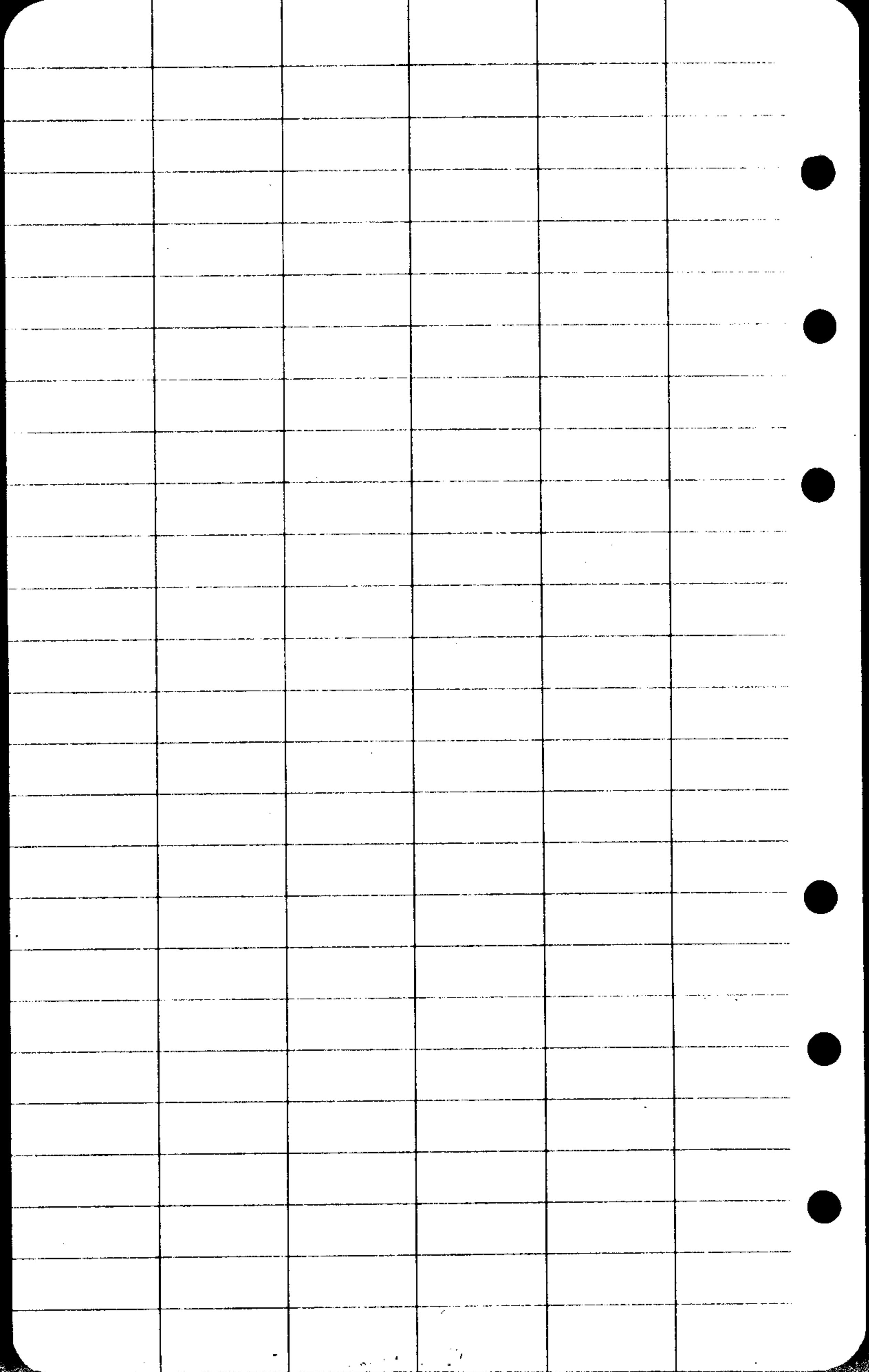

DIETZGEN NO. 385-6

dw 1/6  
set 5/8 IR by sectional sub.  
from which

10" W.O. bears N24 1/2 E 42 1/2

scribed 5/16 CS BT

10" W.O. N 20 1/2 W 33 1/2

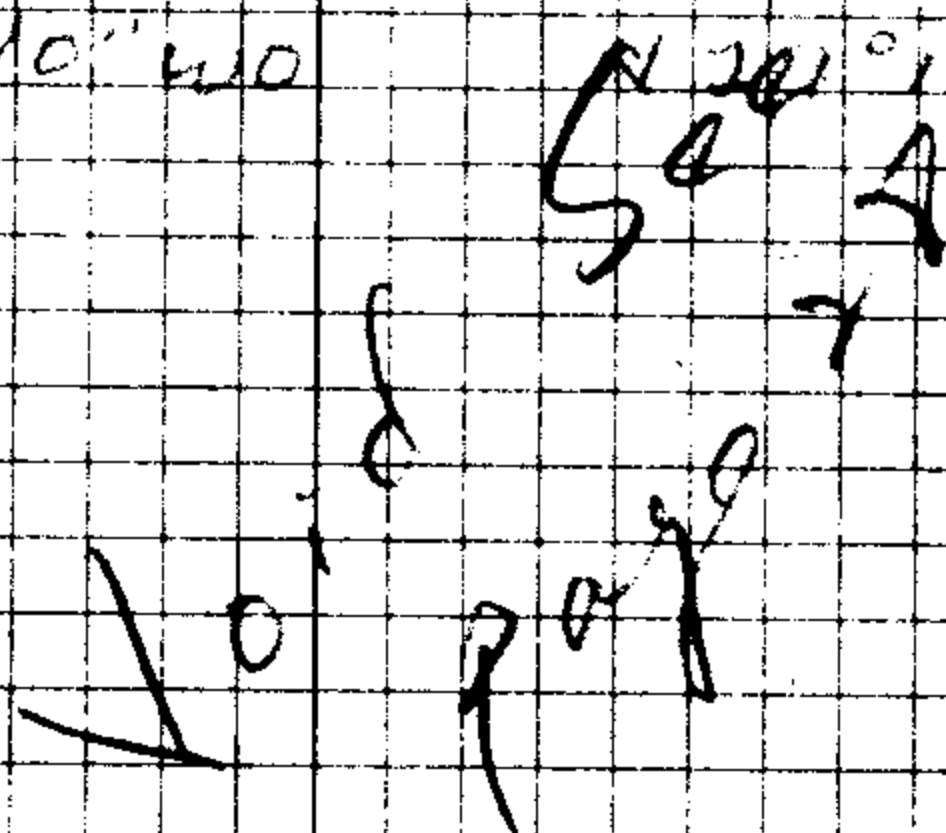

045  
50  
old fence  
N 20 E

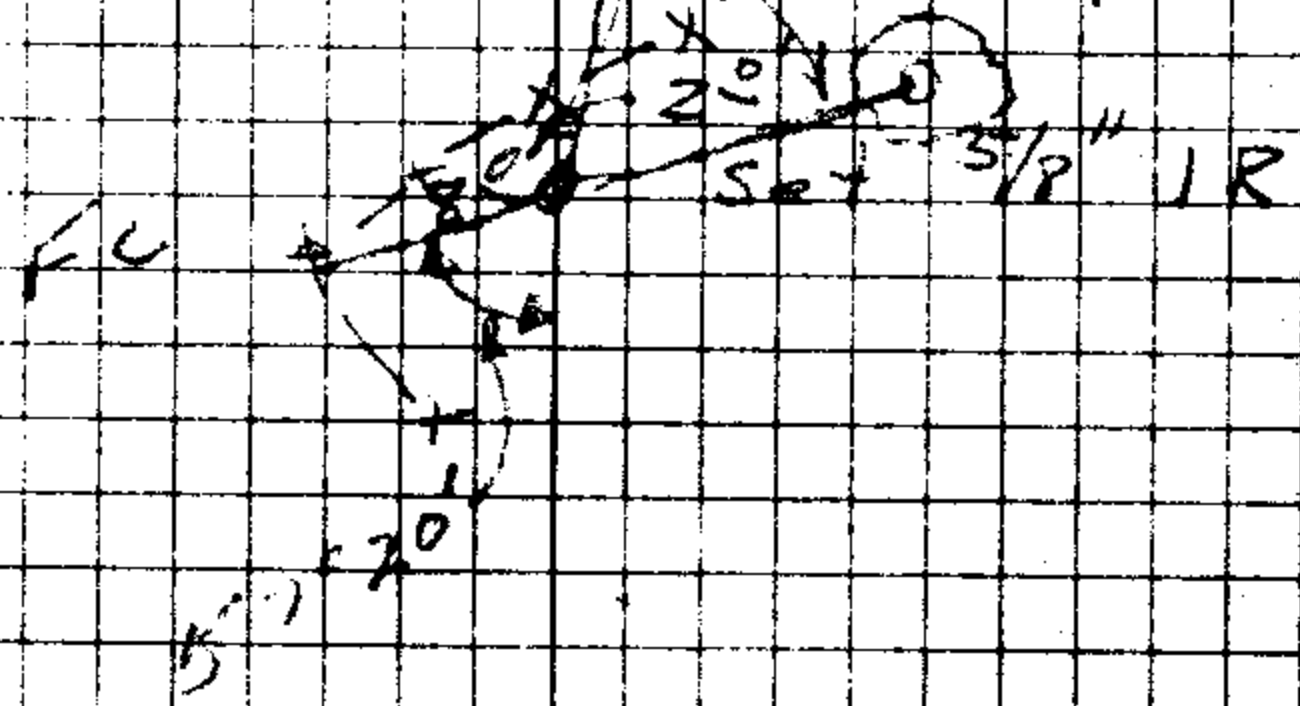

C. S. File No. 46/154

62

360

20' + 12' 10' + 5.5' 9'  
140' N to 100' N bank

Void

no. 100'

C 1/4 cov

W

73.21

N51°08'E

Z 4

53°37'

26°48' 1/2

Z 5

N97°56'E

DIETZEN NO. 385-6

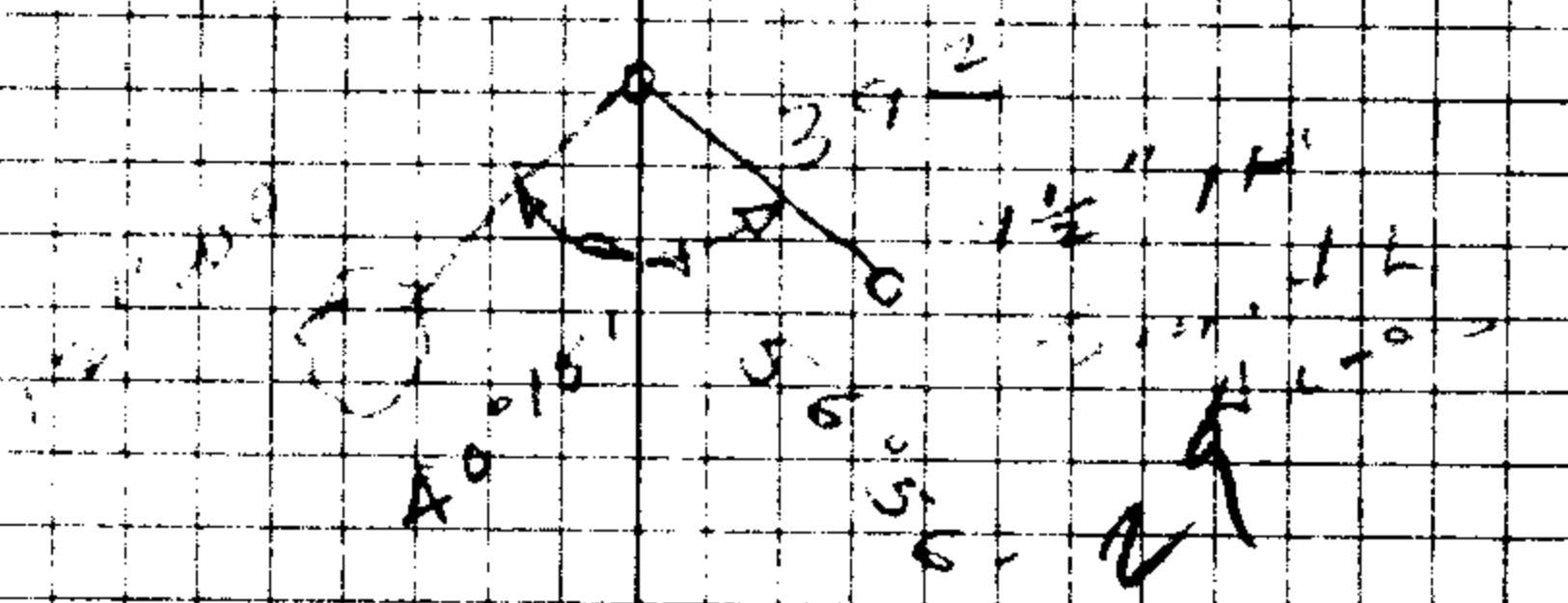

Set  $\frac{1}{4}$  in by  $\frac{1}{4}$  in Sub

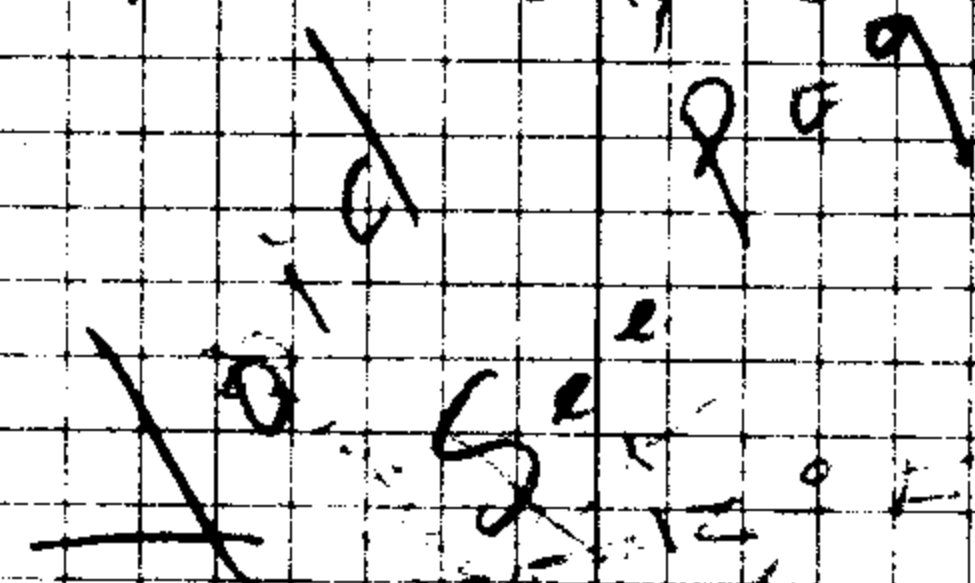

Set  $\frac{3}{4}$  IR

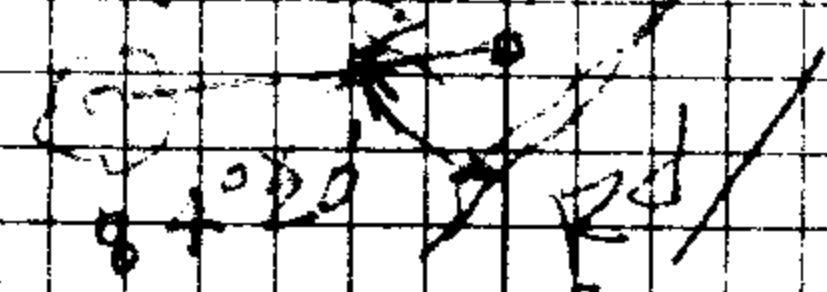

24' W O N 45' W 35' 5'

1/2 in = 1/2 in 105 0 7'

12' W O N 85' W 29' 0

C. S. File No. 46/154



DIETZGEN NO. 385-6

C. S. File No. 46/154

CWT<sub>6</sub>

174° 43' EAST  
57' 22" (INT)

S 32° 38' E

EDGE OF  
WATER

351.69

42540'

-12° 20'  
100'

Δ

128.77

4297

-7° 50'  
100'

1/4 C.R.

101° 15'  
50° 37' 1/2



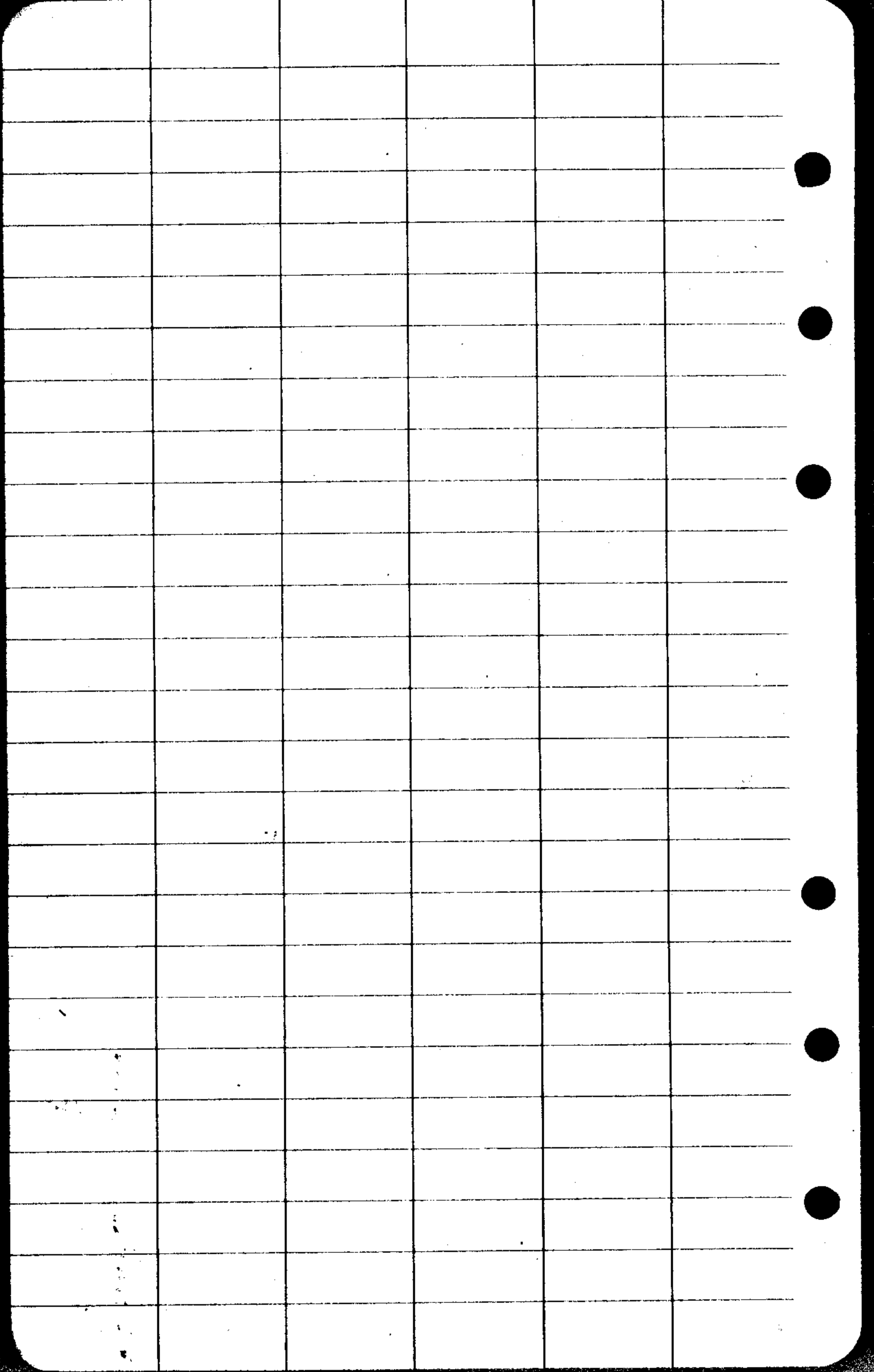

CS FILE FOLDER

CONTAINS

MORE

INFORMATION