

19
 N 89°03' E 2757.4
 1430.9
 Set 1 1/2" x 30" Iron Pipe for Sec Cor
 Location determined from O.B.T's
 20" Laurel, N40E, 33 links
 30" Laurel, S45E, 40 links } alive
 18" Laurel, N50W, 19 links
 14" Laurel, S47W, 36 links - dead
 Blazed and scribed N.B.T's
 10" Chinquapin, N31 1/2°W, 167 ft Both mkd T305, R4W S24, C.S.B.T
 12" Fir S72 1/2°W, 507 ft No suitable trees in Secs. 19-30

W 1/4 Cor, Secs 19-30
 Set 2 1/2" x 36" Iron Pipe
 A 14" Y Laurel, South, 184 ft
 Mkd W 1/4, S-30 C.S.B.T.
 A 22" Laurel N18 1/2°W, 162 ft
 Mkd W 1/4 S-19 C.S.B.T.

1/4 Cor. Secs. 19 & 30. Corner destroyed. Location determined from O.B.T's. Alive & standing. Set 2 1/2" x 36" Iron Pipe for corner.
 O.B.T's
 14" Fir, N53°E, 65 lks.
 30" Fir, S80°E, 39 lks.

T305, R4W
 12807

T305, R3W

LOT 3

Set 2 1/2" x 36" Iron Pipe for N 1/4 Cor West side of Sec 30
 Blazed and scribed B.T's
 14" Black Oak, S35°E, 157 ft
 30" Fir, N20°E, 367 ft.
 Both mkd N 1/4 WS30, C.S.B.T.

Set 1" x 72" Iron Drive Shaft, for NW 1/4 Cor. Sec. 30
 Blazed and scribed B.T's.
 18" Fir, N66°W, 162 ft
 14" Fir, N2°E, 394 ft
 Both mkd NW 1/4 S30, C.S.B.T.

CN 1/4 Cor. & B.T's, as established by Dep. Co. Surveyor, March 1930 destroyed. Reset from prop. corners as shown Set 2 1/2" x 42" Iron Pipe Blazed and scribed B.T's.
 50" Fir N16°W, 315 ft.
 48" Fir S69°E, 205 ft.

N 3°20' E 18397

N 1/4 Cor West side Sec. 30.

14574

S89°21' W

2786.0

1329.4

CN 1/4 Cor. Sec. 30

Found Auto axle for Sec Cor, 24 & 25, T305, R4W Identified from O.B.T's.
 12" Oak, N86°19'W, 547 ft
 20" Fir, S48°39'W, 797 ft.

LOT 4

Sec. Cor, Secs 24 & 25 T305, R4W

Found Mound of Rock & rock with cross set for intersection of North line, DLC #39 and Range line Twp 30S, Rg's 3 & 4 W

Fd Iron Bar set for NE Cor DLC #39 Identified from O.B.T's 16" Fir S20°W, 22 lks, 18" Fir Stump, S73°W 43 lks
 Set Wagon Skein for corner to replace Iron Bar, which was too short.

Set 2 1/2" x 36" Iron Pipe for CW 1/4 Cor
 Blazed & scribed B.T's
 15" Fir, South, 107 ft
 18" Fir N8°W, 319 ft
 Both mkd CW 1/4 S30, C.S.B.T.

Found Rock set for C 1/4 Cor. Sec. 30, by Dep. Co. Surveyor Identified from O.B.T's
 10" Pine, N10°W, 58 lks
 14" Fir, N40°W, 185 lks.

1/4 Cor W. side Sec. 30, Location determined from O.B.T's
 30" Fir, S80°E, 80 lks.
 22" Fir Stump N65°E, 63 lks

Fd Rock with X, for Int'l Cor. DLC #39
 16" Fir N30W, 26 lks.
 12" Fir N00E, 46 lks.

N 89°00' W

2813.4

1329.4

C 1/4 Cor. Sec. 30

Set 2 1/2" x 36" Iron Pipe for 1/4 Cor W. side Sec 30
 Blazed & scribed
 12" Fir N70°E, 38° Mkd 1/4 WS30, C.S.B.T.

Int'l Cor. DLC #39

Set 2 1/2" x 36" Iron Pipe for Cor. at intersection of NW 1/4 line and a north bdy of DLC #39

Ext'l Cor. DLC #39
 Reset by intersection of East line and North line, DLC #39
 Set 2 1/2" x 42" Iron Pipe for Cor.
 Blazed & scribed B.T's
 30" Fir, N10°W, 715 ft.
 12" Fir, N85°W, 987 ft.
 Both mkd Ext'l DLC 39 C.S.B.T.

Set 1 1/4" Iron Pipe for property corner on So. boundary of DLC #39

Fd. Gear with flange for S.E. Cor DLC #39. One B.T. alive & standing 12" Oak, N55°E 2957 ft

Int. DLC & Sec. lines

Fd. Drive Shaft

N 88°01' W, 852.7

Prop. Cor.

Prop. Cor.

Prop. Cor.

SE. Cor. DLC #39

COUNTY SURVEYOR'S OFFICE
 DOUGLAS COUNTY OREGON
 SURVEY TO ESTABLISH CORNERS AND BOUNDARIES, NE 1/4 NW 1/4, SE 1/4 NW 1/4 & LOTS 3 & 4, SECTION 30, T305, R3W, WM.

BEN B. IRVING COUNTY SURVEYOR
 SURVEYED, NOV.-DEC. 1948, BY
 A. R. EVANS, DEP. COUNTY SURVEYOR

SCALE 1" = 200'

J. D. Wright

3 to 7305-RBld -

Nov. Dec. 1948

A. R. Evans - T

M. E. Godfrey H.C.

Frank Smith - R.C.

N. E. Richardson

Sta Dist Dell & C.C. 14.C. Slope ②

515 ✓

2

214L

+6-18

N 3-30 E ✓

N 3 1/4 E

= 3000

512.5 ✓

23° 15'

16° 37' L

1

634 ✓

N 20-07-30 E ✓

N 19° E

36° 23'

18° 11' R

Spade

COY

24405

1305

124.14

N 10 1/2 E

Inter.

DLC

Sec line

N 1° E

11-5-48.

Clouety -

A R Evans T

Milo Godfrey HC

Frank Smith - Flag -

99396 ✓

99888 ✓

299.66

212.81

~~512.47~~

Auto Axle Found, Identified
From B.T.'s.

Mound of Rocks Intersected
By ~~Clinton~~ J. Amster - D.L.C. 39

C. S. File No.

73/6

Sta Dist Defl. & C.C. Mic Slope

126.11

5

250.0

202-30
N 2-32-30 E

N 1 3/4 E

270.8

+22-37

29° 25'
14' 43" R

4

121.5

12-40
N 12-40 W

N 12 3/4 W

122.2

+8-35

35° 18'
17° 39" L

3

314.5

4-59
N 5-29 E

N 4 3/4 E

20-58
10-29 R

2

checked in field.

N 3-30-E

515.5

5

✓
9/23/10

✓
9/23/10

C. S. File No. 73/6

Sta Dist Def. & C.C. M.C. Slope (6)

182 ✓

8

249.0 ✓
-9-23

4-25-30 ✓
~~N 4 1/2 E~~

13° 50'
6° 55' L

N 4 E

7

79.0 ✓
+2-24

11-20-30 ✓
N 11-30-30 E

N 11 1/4 E

6

17-36'
8° 48' R

98.75 ✓
+14-16

2-32-30 ✓
~~N 3-02-30 E~~

N 2 1/4 E

5

10° 00'
0° 30' R

2-002-30 ✓
~~N 2-02-30 E~~

98662 ✓

Logging road 27' ahead

99912 ✓

Top of ridge

96916 ✓

C. S. File No.

43/6

Sta Dist Def & C.C. Mc Slope

1646

85176

Sec

Cor.

19/30

2-24-30 ✓
N 75° 54' 30" W

27°

-22-47

25°

N 2 1/2 W

9048'
4054'

10

46°

85176

-11-31

45°

2-29-30 ✓
N 2-59-30 E

N 1 3/4 E

0° 39'
0° 20' L

9

75°

~~46°~~

2-49 ✓
N 3-49 E

N 1° E

967

+7° 21'

85176

3-10'
1037' L

8

168°

4-25-30
N 4-55-30 E

Sec. Cor Identified from

4 old Laurel B.T.'s

20" Laurel	N 40° E	33/ks	} ^{mine}
30" Laurel	S 45° E	40/ks	
18" "	N 55° W	19/ks	
14" Laurel	S 47° W	36/ks (Dead)	

Reset corner

Set 1 1/2" x 30" Iron Pipe

~~Blazed~~ Blazed and scribed

10" Chinquapiin N 31 1/2° W, 16 7'

Mkd. T 305-R 44 - 5-24 C.S.B.T.

12" Fir S 72 1/2° W - 50 2'

Mkd. T 305-R 44 - 5-78 C.S.B.T.

Witnesses:

Set by A.R. Evans
D.C.S.

M.E. Godfrey

Frank Smith

⑩

Sta Dist Def. & C.C. MC Slope

13

✓
166.3

✓
87-47
~~N86-28 E~~

✓
169.0

+10-14

N87 1/2 E

12

10.17'
0° 39' L

✓
284.4

+14-30

✓
~~88-25-30~~
N87-16-30 E

N88° E

✓
275.2

10.39'
0° 41' R

11

✓
87.4

+17-55

✓
87-36
~~N88-06 E~~

N87 1/4 E

✓
83.2

18.00'
0° 01' R

Sec 6

21/30

2-24-30
N154-30 W

11-8-48

Fair

Same crew

✓ 60484

51896

65156

C. S. File No. 73/

Sta	Dist	Defl	cc	M.C.	Slope
16	241.8		✓		
					+11-56
	246.6		✓	87-51-30	
				N88-34E	N88 3/4 E
		50.53'			
		2056.1			
15	264.8		✓	89-12-E	
				87-34E	268.5
					+9-33
					589 1/4 E
14		6°00'			
		3°00' R			
	295.0		✓	87-48	
				N87-34E	268.1
					+8-20
					N88E
13		0°00'			
		0°01' R			
					N 87-47 E

97839 ✓

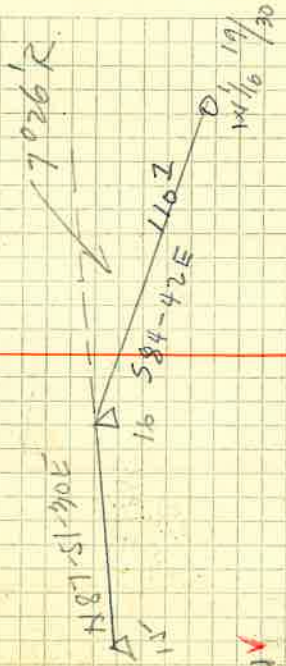

98611 ✓

Set $2\frac{1}{4}$ " X 36° Iron Pipe
 for $W\frac{1}{16}$ Cor $19\frac{1}{30}$ -

Blazed and scribed B.T.

✓ 14" X Laurel South, 184
 Mk'd $W\frac{1}{16}$ S 30° - CS.B.T.
 22" Laurel N $18\frac{1}{2}$ W, 167
 Mk'd $W\frac{1}{16}$ S-19 - CS.B.T.

Sta	Dist	Def'n	cc	H/C	Slope
19		✓			118' ✓ +6-28
	117'	✓	88-24-30	N 87° 10' E	
18			0° 54' 0° 27' L	N 89° E	213' ✓ +20°-31'
	200'	✓	88-51-30	N 87° 45' E	
			0° 21' 0° 10' L	N 89° 15' E	233' ✓ +18-14'
17					
	221'	✓	87-02'	N 87° 55' E	
16			2° 21' 10' 10' R	N 89 1/2° E	

15

99364 ✓

93657 ✓

94979 ✓

C. S. File No. 73/6

Sta Dist Def. & cc MC Slope

22

92 $\frac{4}{1}$

88-40-30

S89°41'E

S88° $\frac{3}{4}$ E

95 $\frac{6}{1}$

-14°58'

21

10°46'
5°23'R

174 $\frac{5}{1}$

85-4-30

N84-48E

N86-15E

175 $\frac{5}{1}$

-6°01'

20

3°18'
1°39'L

79 $\frac{3}{1}$

87-35-30

N86-27E

N88 $\frac{1}{2}$ E

79 $\frac{4}{1}$

+2-38'

19

1°38'
0°49'L

N 88-24-30 E

10

11-9-48

(17)

Fair

Sane crew

✓
96608

Begin steep descent

✓
99449

Top of ridge -

✓
99898

C. S. File No.

43/6

Sta Dist Def. & C.C. M.C. Slope

25

109 $\frac{5}{2}$

129 $\frac{2}{1}$
-32° 07'

~~84-40-30~~
S 84° 41' E

584 $\frac{1}{4}$ E

24

7° 02'
3° 31' R

137 $\frac{4}{2}$
-18° 49'

~~88-11-30~~
S 88° 11' E

130 $\frac{1}{1}$

58 $\frac{1}{1}$ E

23

10° 29'
5° 14' R

300 $\frac{0}{0}$
-28° 45'

~~86-34~~
N 86° 34' E

301 $\frac{60}{0}$

N 87° E

22

9° 31'
4° 45' L

43 $\frac{4}{4}$
-27° 15'

S 88° 40' 30" E

✓
94697

✓
94656

✓
87673

✓
88902
263.02
38.58
301.60

Sta Dist Dept c.f. H.C. Slope

✓

1/4 Cor
19/90

20

232

-29°30'

53134 30E

536 1/2 E

25

49°06 E

584-10-30 E

200

21

Location identified from O.B.T.'s
Corner destroyed -
Reset corner - by driving
2 1/2" x 36" boiler tube -
O.B.T.'s O.K. -

A.R. Evans -

Dep. Co. Surgeon
Witnesses!

A.E. Richardson D.C.S.

Milo Godfrey

Frank Smith.

C. S. File No. 13/6

Sta	Dist	Def #	C.C.	M.C.	Slope
28	55 ² / ₂		✓ 50-16-30N 5000E	South	552 ✓ -7°18'
27	244 ³ / ₃	0°37' 0°18'R	✓ 5-0-02.E. 5-7-71E		2552 ✓ -17°21'
26	390 ⁴ / ₄ 387	3°17' 1°38'R		50°15'E	3000 ✓ -13°40' ✓ 46°-L ✓ 537 ✓ -9°-45'
25		166°00' 83°00'R	1-40-30 52-44E		5224E
24			84-40-30 585-44E		

99189 ✓

95450 ✓

97169 ✓

$$\begin{array}{r} 29151 \\ 4692 \\ \hline 52 \end{array}$$

98556 ✓

$$\begin{array}{r} 390 \\ \hline 43 \end{array}$$

Sta	Dist	Def. #	C.G.	M.C.	Slope
28	284	✓	2.12 50.27 E	53 1/4 E	2.945 ✓ -14° 51'
29	212 ⁰⁰		1.02.30 W 50.35 W.	50 1/2 W	2.176 ✓ -12° 59'
29	106 ⁰⁰		3.058 1.059 R 0.56-30 51.06 E	50 1/4 E	1.084 ✓ -12° 09'
28	284		2.016 1.019 L 59.16.30 W 50.55 E	50 1/4 E	

✓
96660

✓
97844

✓
97760

25

C. S. File No. 43/6

Sta Dist Def# C.C. Mic Slope

D.

130°
+1497

1258

C

P.O.T.

2182
N 53° 45' 16" E x 220.12'

2580

A

90° 03'
45° 01' L

5'

B

N 70° 57' W

57.7 B

96764

Approx 1/6 car

2 RT4 from N rock car 5 each

2, RT4 from S Rock prop car

5.0010

Sta	Dist	Def't	CC.	H.C.	Slope
32	156 ³ / ₂	98° 28' 49° 14' R	✓ 2-22 51-52 E	52 ¹ / ₄ E	156 ³ / ₂ + 1° 26'
A	258 ⁰ / ₂		551-36 E		278 ¹ / ₂ - 22° 10'
C	107 ³ / ₂	48° 24' 24° 12' L	527-24 E	527 ¹ / ₄ E	107 ³ / ₂ - 1° 51'
31		50° 24' 25° 12' L			
			52-42 E		

99969 ✓

CN

1 1/16

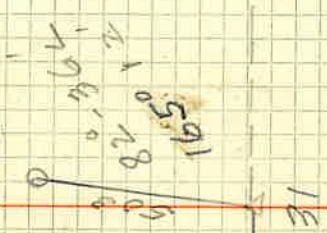

92587 ✓

Set 2 1/2" x 42" Iron Pipe,
for CN 1/16 Cor.

Blazed and scribed B.T.s.

99948 ✓

50" Fir N 16° W, 31.5'

48" Fir S 69° E, 20.5'

Both marked CN 1/16 S 30

C.S. B.T.

Reset from

prop corners

shown on Pg. 27

ARE

M.E.G.

F.D.S.

Sta Dist Def# c.c. H/c Slope

35

460 ~~8~~

10-06-30
S 20° 34' 30" W

300

7305'

161 2'

P-55'

S 19° 30' W

34

12° 18'
609' L

300

-6° 01'

146 2'

-1° 55'

444 ~~5~~

26-15-30
S 46° 45' 30" W

S 25° W

33

41° 46'
20° 50' R

102 2'

-6° 30'

5-25-30
S 55° 30" W

S 4-45' W

32

150 35'
70 48' R

2-22
S 7-52' E

91

$$\begin{array}{r}
 299 \overline{) 57} \\
 \underline{161} \\
 460
 \end{array}$$

99855 ✓

99944 ✓

$$\begin{array}{r}
 298 \overline{) 35} \\
 \underline{146} \\
 444
 \end{array}$$

99449 ✓

99944 ✓



99341 ✓

C.S. File No. 43/6

Sta Dist Dof# cc. HC Slope

Rock

Pass.

c/4

39²

S-31-06-04E.

38^d 98107

-11°10'

35

51°13'L

70-06-30
~~5-20-36-30W.~~

34

Found Rock Corner.
Identified from B.T.'s as
Center $\frac{1}{4}$ Corner, Sec. 30
Set by Deputy Co. Surveyor.

Sta Dist Def: cc. HC Slope (30)

38

73°

+700'

72-57-30

N 72-27-30 W

725

N 73 1/2 W

4950'

2455' R

37

300°

+957'

562' L

82-07-30

S 82-37-30 W

352'

S 82 W

4351'

2138' R

36

300°

+8011'

830'

+17000'

56029 W

670'

S 60 W

8000'

4002R

35

300°

+11010'

185' L

S 60 W

S 70-06-30 W

99255

98496

$$\begin{array}{r}
 295.5 \\
 56.7 \\
 \hline
 1.2 \\
 35
 \end{array}$$

98982

$$\begin{array}{r}
 294.32 \\
 79.37 \\
 \hline
 296.91
 \end{array}$$

95630

$$\begin{array}{r}
 296.91 \\
 \hline
 670.6
 \end{array}$$

98101

30 Slope

M.C.

Defl. & C.C.

Dist

Sta

41

109' ✓
-5'46'

1085

41-03 ✓
N40-33-W

N41 1/2 W

50W'
2097L

40

932 ✓
16011

38-26 ✓
N37-86-W

972

N38 1/2 W

5051'
2058R

39

3000 ✓
+160241' ✓
478' ✓

3343

41-20-30 ✓
N40-54-30W

N41 1/2 W +13°23'

63006
21933R

38

72-57-30
N72-27-30W

Top of ridge

99444 ✓

99418 ✓

95931 ✓

97284 ✓

46.5
287.8
—
34.3
3

Sta Dist Duff. C.C. P.C. (N) Slope

44

108.4
76-33 ✓
577-83 in. ✓
109.0 ✓
-6°06'

576 1/4 in.

43

13024'
6°42' L

190.5 ✓
+10°16'

187.4
83-15 ✓
583-45 in. ✓

580 3/4 in.

42

16009'
13°05' L

113.0 ✓
-29°57' ✓
2072 ✓
-28°02' ✓

83-40-30 ✓
N 83°40-30 W ✓

303.14

N 84 W ✓
219.2 L ✓

41

1515'
42°37' L

41-03
N 40-33-06 ✓

99434

98399

Errek 40' back

80646 ✓

97.91.

88267 ✓

183.33

~~21.90~~

303.14

Sta	Dist	Defl _R	CC	M.C.	Slope
14 Cor	124 ⁰		61-37 ✓	N62°W	124 ³ ✓ +39' ✓
14-side		49°05'	N67-07 -W		
5-30		21°33'R			
46	406 ⁰		83-09-30 ✓ N82-39-30 W	N82'W	300 ⁰ ✓ -2°09' ✓ 106 ⁴ L ✓
45		51°52'			
		25°56'R			
343 ³	343 ³		70-54-30 ✓ 571-24-30 W		300 ⁰ ✓ -15°16' ✓ 539 ✓
44		10'11"			
		5°38'L			
			76-33 577-03 W		

90786 ✓

Location of Corner identified

from D.B.T.'s -

30" Fir 580E - 80 lks

alive & standing -
scribe marks plain -

22" Fir Stump - N65E 63 lks -

scribe MK "B.T. visible.

90899 ✓

Set 2 1/2 x 36" Iron Pipe
for corner.

Blazed & scribed B.T.

12" Fir, N70E 380

Mkd 1/4 530 - C.S.B.T.

90471 ✓

Sta Dist Dept. & C.C. M.C. Slope. (S)

49 / 695 4-25 ✓
N 3-55-11d.
698
+ 5078

48 10° 32'
5° 16' R N 4-15 W
121 = 9-41 ✓
N 4-11-41
128°
+ 18° 49'

47 10° 31'
10° 16' L N 9 1/2 W
716 8-25-30 ✓
N 7-55-30 W.
2415
+ 26000'

1/4 10
5100 106° 23'
53° 11' R N 8 1/4 W.
576 61-37
N 6-07 W

43

✓
असुस

✓
असुस

✓
असुस

C. S. File no. 43/6

Sta 1 Defl. cc. M.C. Slope

Sec 18° 11' R

Cor

2 1/2 S

100 S

R 1/2 W

123'

N 1-51 E

Root

Cor

1 1/2 W

1/2 S

6.58' W

41° 37'

20.48 L

2113'

+ 4° 50'

710 S

22-34-30

N 22-09-30 E

N 93° 15' E

54° 09'

27° 04' R

dg

4-25

N ~~3~~ W.

18

99630

C. S. File No. 73/6

Sta	Dist	∠	C.C.	M.C	Slope
51	390.9 ✓				105.6 +16-36 300.0 +15-02
50		0°01' 0°01'		N89-59-30E E	
Approx	500.9 ✓				250.0 +5°51' 255.3
1/6 lot		83-25 41-42L		S89-54-30E	S89 3/4 E +8-36
1/5 side	193.3			S48-17E	
2		756-26 128°13R			S48 3/4 E
1				N3-30E	

12-9-48

Rain -
some gravel

41

N $\frac{1}{16}$ S30
on Rq line



25°
24'

Set 2 1/2" x 36" Iron Pipe

For N $\frac{1}{16}$ Cor Sec 30 on Rq line

Blazed and scribed BT's

14" B. Oak S 35° E 154

30" Fir N 20° E 384

Both mkd

ARE

MEG

F.D.S.

N $\frac{1}{16}$ W 530 CS BT.

C. S. File No.

43/6

98532

8596

6446

9818

Sta Dist ϕ C.C. M.C. Slope

54

✓

2702

268' ✓

N89-23E

+ 10 - 22

53

300'

1036L

N89E

1513

+ 13 - 36

147' ✓

S89-07E

S89E

52

1640'

0055R

2685

+ 12 - 16

2005' ✓

E

N89-58-30E

51

0002
0001L

N89-59-30E

90358 ✓

91116 ✓

91346 ✓

C. S. File No. 43/4

Sta Dist \pm C.C. H.C. Slope

57

458

+15-11

635 ✓

N 87-28-30 E

N 87 1/4 E

56

11051

5° 56' L

285-

+28-35

2503 ✓

S 86-36 E

S 87 E

55

3052

1° 56' R

990-

+14 67

805 ✓

S 88-32 E

S 88 E

54

4° 10'

2° 05' R

N 89-23 E

C. S. File No. 13/6

96507
70
11
16

87812

94880

66.0
21.0
2.5

Sta	Dust	✓	CC.	M.C	Slope
2276.1			✓		
60					
	1482 ✓		N 88-36 E		183 ± -35-45
				N 88 E	
59	180 33'				
	90' 16 R				97 ± -26.51
			N 74-14-30 E		
	868 ✓			N 79 E	
58	90 55'				
	2058'				
	575 ✓		N 83-17 E		57 ± -700'
				N 89 1/2 E	
57	8023'				
	4011 L				
			N 87-28-30 E		

51

67

67

81/57/8

89/40

99/57

C. S. File No. 43/b

Sta Dist # CC H.C. slope

C

✓
S 27-24 E

104 20
82 10 R

31

600
-29-16

✓
S 23 N 70-26 E N 70 E

37 40
18 5 L

62

308
-37-48
742
-29-54

✓
3018 N 89-17 E

N 88 1/2 E

60 35
39 18 R

61

2553
-38-00

✓
2012 N 85-59-36 E

50 13
29 7 L

60

N 86 1/4 E

✓
N 88-36 E

$$\begin{array}{r} 6736 \\ - 38 \\ \hline 6698 \end{array}$$

12-10-68

Rain
(and how!)

Same trend.

 \checkmark
87235

 \checkmark
79016
~~78537~~
6476 \checkmark ~~32611~~

86640

20127

237.05

64.79

78801 \checkmark

30181

Sta	Dist	β	cc	M.C.	Slope
73	246 $\frac{2}{2}$	S 1° 03' - 26 W 0° 58' 0° 29' R			253 -13-27
72	304 $\frac{6}{2}$	S 0° 32' - 30 W 5-49' 2° 55' L			163 L 300° -1004
71	259 $\frac{3}{2}$	0° 03' 0° 02' L	S-3-27 W	S B.W.	260 L -4-47
70	122 $\frac{2}{2}$	2° 09' 07' 104° 33' L	S-3-18-30 W	S 3 W	1352° -22-13
NW 1/4	147 $\frac{2}{2}$		N 71-58 W		
54					

Sta Dist ϕ CC MC slope

40 548-14-30E

119 40

59° 50' L

792
-1735

753 511-35-30W

511W

2328

110 44R

1223
-3008

1220 50-08-30E

S/E

5:53

20.56 L

940
+12-47

2349 52-48SW

511W

3043

1046 R

1470
-13-49

73

5150 50-30W

Sta Dist \neq CC MC Slope $\textcircled{3}$

78

2160

1980

N 87-54-30 W

-23-24'

77

181° 18'

90° 39' R

N 89 W

600'

-28-22

76

30 09'

10° 35' L

S 1 W

1255

1155

S 3-01 W

-23-13

CW 1/6

17° 00'

8° 35' L

S 3 W

75

S 11-35-30 W

3 4.2

59

91660

57' ahead to fence cor. Approx.

NE cor D.C.C.

87993

1" x 3/8" iron pipe
set cor at intersection of
for cor 1/16" line & Int. D.C.C. line

51-26-30 in

91902

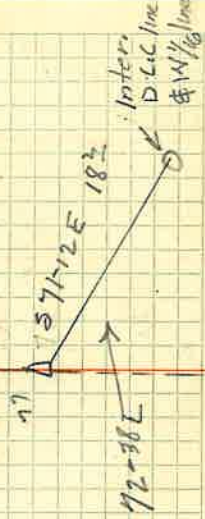

C. S. File No. 43/6

68
Fd Road Wiper X

16" Fir N 30W 261ks-

12" Fir N 60E 261ks-

99744

99019

91534

C. S. File No. 73/6

Sta Dist \$ CC MC Slope

92

N 16-29 W

586-48 E

587 E

91

16° 25'

8° 10' R

728 L

S 85-18-30 W

N 85-00 E

300 E

372 J

N 85 E

+1012 L

90

909'

495 L

S 89-53 W

N 89-34 E

245 J

N 89 1/4 E

Int. 5

line

D.C.

E. Inte

D.C.

line

490'

203 L

N 88-04 W

588-23 E

294 J

Cor 15

POT

588 1/2 E

Cor

14

588-23 E

N 88-04 W

6

0.8
7
0.5

~~0.0478~~
0.0478

Set $1\frac{1}{4}$ " I.P. at intersection of
S. Projection E. line D.L.C. &
S. line D.L.C. 46.85.

C. S. File No. 43/6

Sta Dist # CC M.C. Slope

94

1448

+11-55'

✓ 681E

S107W

3000

+1'00"

N139E

2400

N14E +2006'

SE Cor

181'00"

90'30L

DCC 99

879

N87-33W

587-51E

11-47

588E

97

87-51L

S

N1018-30E

South

468E

1733S

S

97

86-48R

N186-29E

586-48E

✓
97845

27
239.84 ✓
244.96 ✓
141.68 ✓

68.18 ✓

✓
99965

✓
99933

Fd. Gear with flange - buried

16" underground

1-B.T. drive & standing -

1 1/2" Oak - W.S.E. case

⑧ Cape

CC. P.C

Dist #

Sta

S 1-26-30W
N 1-08-30E

76

150°SD
75°25R

112'

S 73-58-30E

109Z

N 74-16-30W

-11-24

N 75W

151.51'
75°55L

96

11923

215°
+28°V

S 1-57W
N 1-39E

189Z

N 1 1/2 E

P.O.T.

95

675-
+16-19'

S 1-57W
N 1-39E

328Z

215°
+12.048'

N 1 E

P.O.T.

114

S 1-57W
N 1-39E

11923

67



Set $2\frac{1}{2} \times 42$ " Iron Pipe
 Mkd BT's
 30" Fir N 10° W - 807
 12" Fir N 85° W - 985 L

89636 ✓
 16817 ✓
 6050 ✓
 6145 ✓
 88101 ✓
 Both MKD EXT "L"
 D L C 39
 C-S-B.T.

