

T. 22 S., R. 7 W.

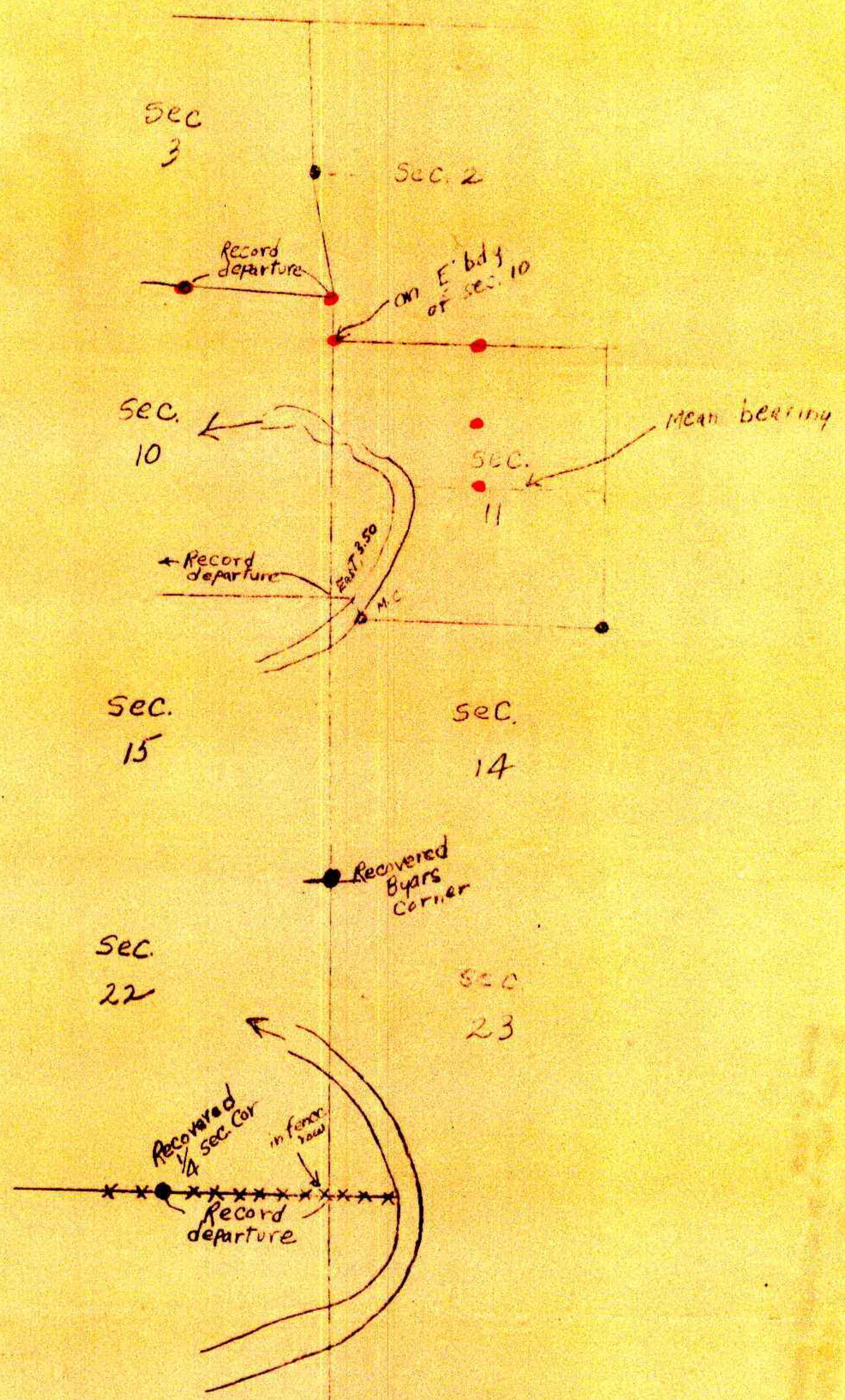

FILED
RECEIVED

MAR 31 1958

COUNTY SURVEYOR
DOUGLAS COUNTY, ORE.

SNELLSTROM LUMBER CO.

Manufacturers
PLYWOOD AND LUMBER
EUGENE, OREGON

March 29, 1958

Mr. Fred M. Darby
Douglas County Surveyor
County Courthouse
Roseburg, Oregon

Dear Fred:

We wish to report to you that in Township 23 South, Range 7 West, the following corners, for which you furnished us 1" iron pipes with brass caps, were set in the field March 28th, 1958:

- (1) $\frac{1}{4}$ corner of 3/10 set from one original B.T.
- (2) Section corner 3/10 only.*
- Handed 1961 #93*
(3) Section corner 2/11 only.*
- Handed 1959 #66*
(4) $\frac{1}{4}$ corner 2/11.*
- (5) North 1/16 on center line of 11 (a 1" iron pipe).*
- (6) The center of Section 11.*

* These corners set by computation as recommended by Berlin in his letter of July 18th, 1957.

Since there are several more corners which remain to be set in the area, we will file one complete map when the job is done. Anyone needing corner data before this filing should contact us.

Very truly yours,

SNELLSTROM LUMBER CO.

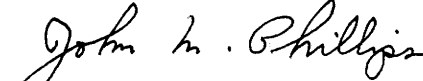

John M. Phillips
Forester
L.S. 307

FILED
RECEIVED

JMP/rw

MAR 31 1958

COUNTY SURVEYOR
DOUGLAS COUNTY, ORE.



Manufacturers of
West Coast
Forest Products

SNELLSTROM LUMBER CO.

TELEPHONE DIAMOND 2-1141 • TELETYPE EG 044-U • ADDRESS 2818 WEST SIXTH AVENUE • P. O. BOX 449 • EUGENE, OREGON

July 1, 1959

County Surveyor
Douglas County Courthouse
Roseburg, Oregon

Attention: Mr. Fred M. Darby

Dear Fred:

I will dig into my records and send you the notes for the corners which we actually set in Township 23 South, Range 7 West.

As you may or may not know, we were stopped from continuing this survey and later the property was sold, so this job will not be completed by us. I will see, however, that you have all the pertinent information on the work we have done.

Very truly yours,

SNELLSTROM LUMBER CO.

John M. Phillips
Forester

JMP/rw

FILED
RECEIVED

JUL 3 1959

COUNTY SURVEYOR
DOUGLAS COUNTY, ORE.

C. S. File No. 42/350



UNITED STATES
DEPARTMENT OF THE INTERIOR
BUREAU OF LAND MANAGEMENT

Area 1
P. O. Box 3861
Portland 8, Oregon

July 18, 1957

John M. Phillips, Forester
Swallstrom Lumber Company
P. O. Box 449
Eugene, Oregon

Dear Mr. Phillips:

Detailed consideration has been given by our staff to the problems involved in the restoration of corners along the second meridional section line in Township 23 South, Range 7 West, of the Willamette Meridian. The following method, while not the only possible one, is in our belief the most practicable, and is most likely to restore the conditions of the original surveys.

First, with regard to the corner of sections 22, 23, 26, and 27: This corner should be restored at record distance easterly along the old line fence from the $\frac{1}{4}$ sec. cor. of secs. 22 and 27. The resulting position falls between the proportionate latitudinal positions based upon the Hutchinson and Byars surveys, respectively, and is based upon the best available evidence of the original survey, particularly if, as you informed Mr. Tillman, you can obtain a statement from a former longtime resident to the effect that the fence was erected along the section line and has remained in substantially the same position.

The situation at the SW cor. of sec. 3 and the SW cor. of sec. 2 is far more complex. You have located the Byars cor. of secs. 1, 13, 22, and 23, the meander cor. set by Byars on the right bank of the river bet. secs. 11 and 14, and the Byars $\frac{1}{4}$ sec. cor. on the W. bdy. of sec. 2, all with good evidence. You also probably have the $\frac{1}{4}$ sec. cor. of secs. 3 and 10, set by Hutchinson, and have located a large forked white fir which you believe may be a bearing tree for the Byars meander cor. on the right bank of the river between secs. 14 and 15. Mr. Tillman states that, other than for its size and variety, there is no evidence to show that this white fir is a bearing tree. Furthermore, the point tentatively located from the tree is not coordinated

well with the two nearest Byars corners, that is, the meander cor. of secs. 11 and 14, and the cor. of secs. 14, 15, 22, and 23. It appears, indeed, that the Byars meander, at least in sec. 14, may have been fictitious and merely for the purpose of closing his own work, since the location of the river, which shows no evidence of material change, is not as shown in the Byars meander. We are, therefore, of the opinion that the evidence of the Byars meander cor. of secs. 14 and 15 is not strong enough to be acceptable, and the following proposed procedure disregards it.

The S.E. cor. of sec. 3 should be restored at record departure easterly from the $\frac{1}{4}$ sec. cor. of secs. 3 and 10, if the evidence at that cor. is acceptable, or otherwise from the SW. cor. of sec. 3, and at proportionate latitudinal position between the cor. of secs. 14, 15, 22, and 23, and the $\frac{1}{4}$ sec. cor. of sec. 2 only. Byars restored the SE. cor. of sec. 3 at a point 31.00 chs. south of the $\frac{1}{4}$ sec. cor. of sec. 2. Therefore, the position of the SE. cor. of sec. 3 would be based on a proportion 31.00 : 200.00 chs. You indicate that the actual difference in latitude is 12,635.04 ft. or 191.44 chs. The proportion would, therefore, be 31.00 : 200.00 :: Y : 191.44, and Y equals 29.673 chs. or 1958.43 ft. The SE. cor. of sec. 3 would then be S. 5° 49' E., 1,968.57 ft. or 29.827 chs. dist. from the $\frac{1}{4}$ sec. cor. of sec. 2 only. This point coordinates well with the recovered cor. of secs. 14, 15, 22, and 23, being 23.66 ft. W. and 10,676.61 ft. N. of the latter.

The cor. of secs. 10, 11, 14, and 15, set as a common cor. by Hutchinson, must be so retained in order to protect the lots of the Hutchinson plat lying on the left side of the river. Since Byars did not cross the river, and made no tie to the cor. of secs. 10, 11, 14, and 15, it should be restored at midpoint in latitude between the cor. of secs. 14, 15, 22, and 23, and the SE. cor. of sec. 3; and at record distance in departure from the nearest regular cor. recovered to the west. The cor. of secs. 9, 10, 15, and 16, was shown on the map you originally sent us as having been recovered if no later mediate cor. is available for control. The line bet. secs. 11 and 14, on the left side of the river, should then be restored according to the Hutchinson record, that is due East, 3.50 chs. to the meander cor., as shown on the accompanying sketch.

The SW. cor. of sec. 2 should be restored at single proportionate latitudinal distance bet. the $\frac{1}{4}$ sec. cor. of sec. 2 only, and the cor. of secs. 14, 15, 22, and 23. The proportion would be 40.00 : 200.00 :: Y : 191.44, this cor. would be located on the east bdy. of sec. 10, as delineated by the restoration of the SE. cor. of sec. 3 and the cor. of secs. 10, 11, 14, and 15. This is necessary in order to keep the later Byars survey from invading the Hutchinson survey. If surveyed, the east and west center line of sec. 11, would be initiated at the $\frac{1}{4}$ sec. cor. of secs. 11 and 12, and run westerly on a mean bearing between the N. bdy. of the sec. and the line from the cor. of secs. 11, 12, 13, and 14, to the Byars meander cor. of secs. 11 and 14, on the right bank of the river, which you have recovered. This center line would not cross the river. The lots in sec. 11 lying on the left side of the river would be controlled by the restored Hutchinson survey as shown on the sketch.

If any more cores are recovered by you in the course of your work, the procedure outlined above may need to be changed. It is again pointed out that this procedure is based upon the evidence as so far developed and upon the methods believed most applicable by this office. As such it is only advisory in nature, and could conceivably become inapplicable due to the recovery of more evidence or development of conditions not known to us at this time.

Very truly yours,

Leonard M. Griffin
Army Central Engineering Officer

Attachment

42/350
5/201

T. 23 S., R. 7 W.
T23S

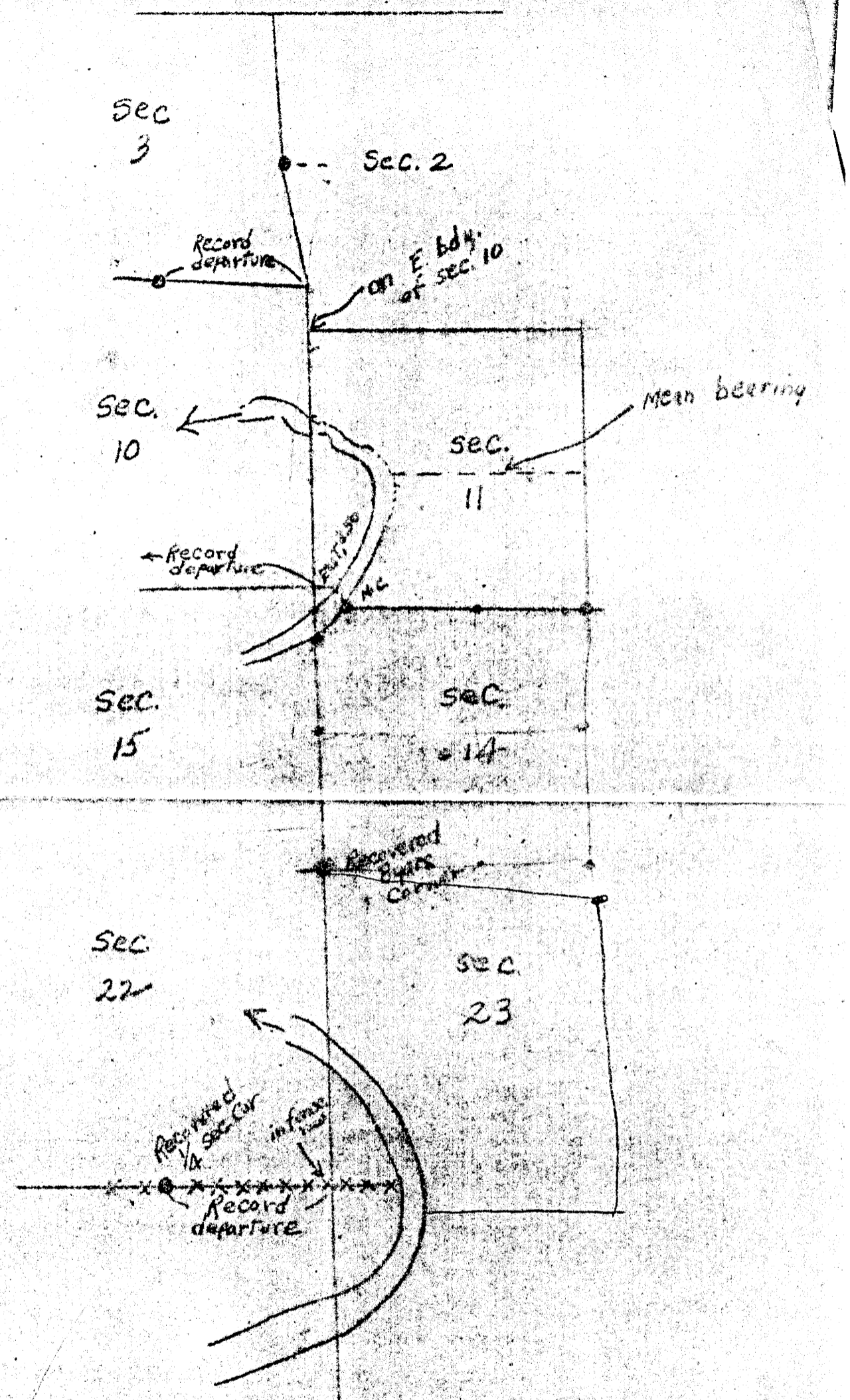

FILED
RECEIVED

JUN 3 1961

COUNTY SURVEYOR
DOUGLAS COUNTY, ORE.

A2/350
C. B. [unclear] 5/20