

Ragged Ridge

Renewal of corner to sections 26, 27, 34, 35
T255, R1E, W1 from reference points set by
Art Evans Mag. bearing Decl. -20°30'

8/12/57
DWP JC
Transit

Marked 40" Fir T255, R1E, S34
2807

Marked 8" Fir T255, R1E, Sec 27

No other trees suitable
for marking

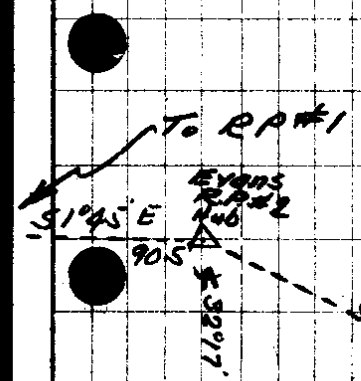

Richard C Grant

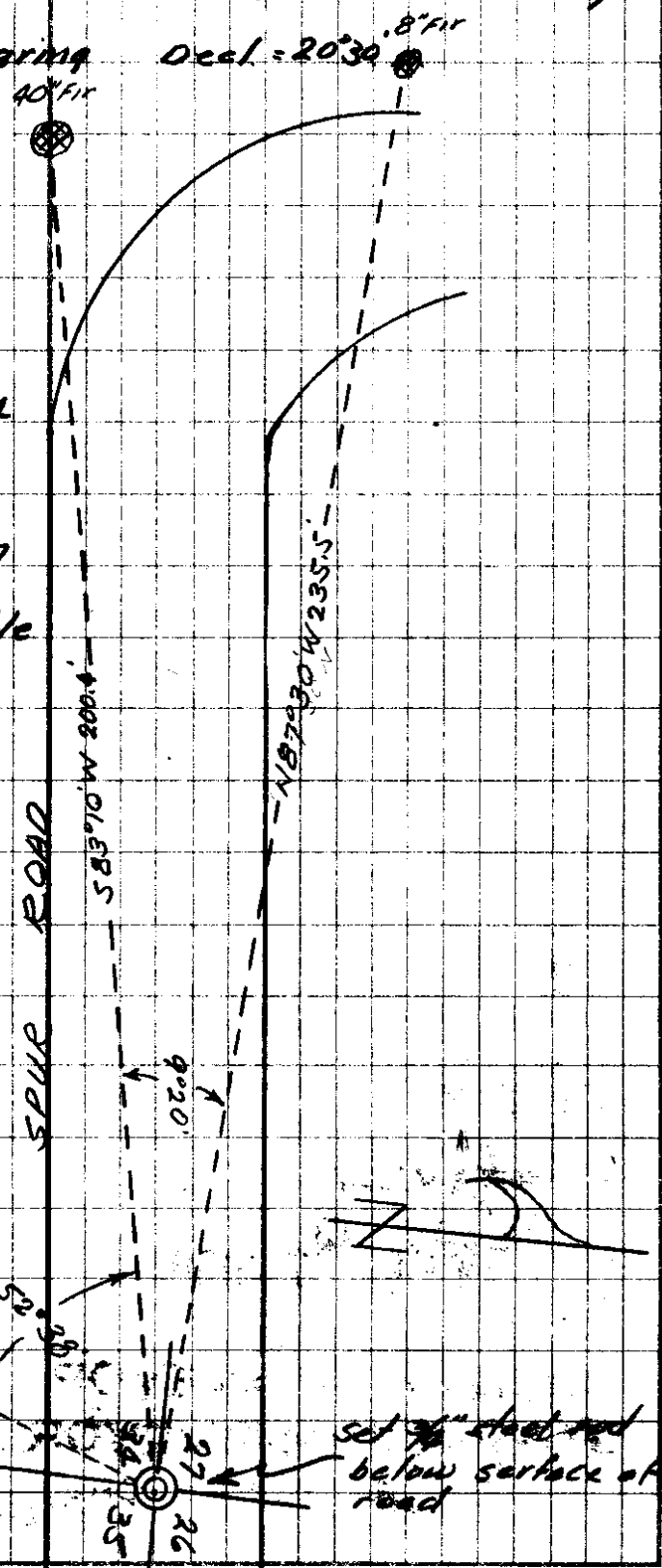

San Carlisle Co.
TACOMA, WASH., U.S.A.
Return the Name

BOOK - FORM 300
FILLER - FORM 301
LOOSE LEAF - FORM 302

42/328