

6-13-57

1/4 Corner Section 17-20, T30S  
R6W, W.M. as det. by O.B.T.

A 36" Pine Stump (Logged) bears  
N5°E 9.2' dist. O.B.T. fd. scribe

A 25" Pine Snag bears S45°W  
54.1' dist. O.B.T. fd. scribe.

At corner point set brass  
cap in concrete marked: T30S  
R6W, 1/4 S. S17. S20 2880 1957.  
from which

A 25" Fir bears S29°W 69.8' dist.  
mkd. 1/4 S 20 B.T.

A 20" Fir bears S56°E 62.0' dist.  
mkd. 1/4 S 20 B.T.

A 20" Cedar bears N73°E 51.6'  
dist. mkd. 1/4 S 17 B.T.

A 13" Pine bears N23°30'W 53.6'  
dist. mkd. 1/4 S 17 B.T.

Road bears South 15.0' dist.

Witness:

Earl D. Jenks

Work done for Hanna Coal & Ore

NORTH

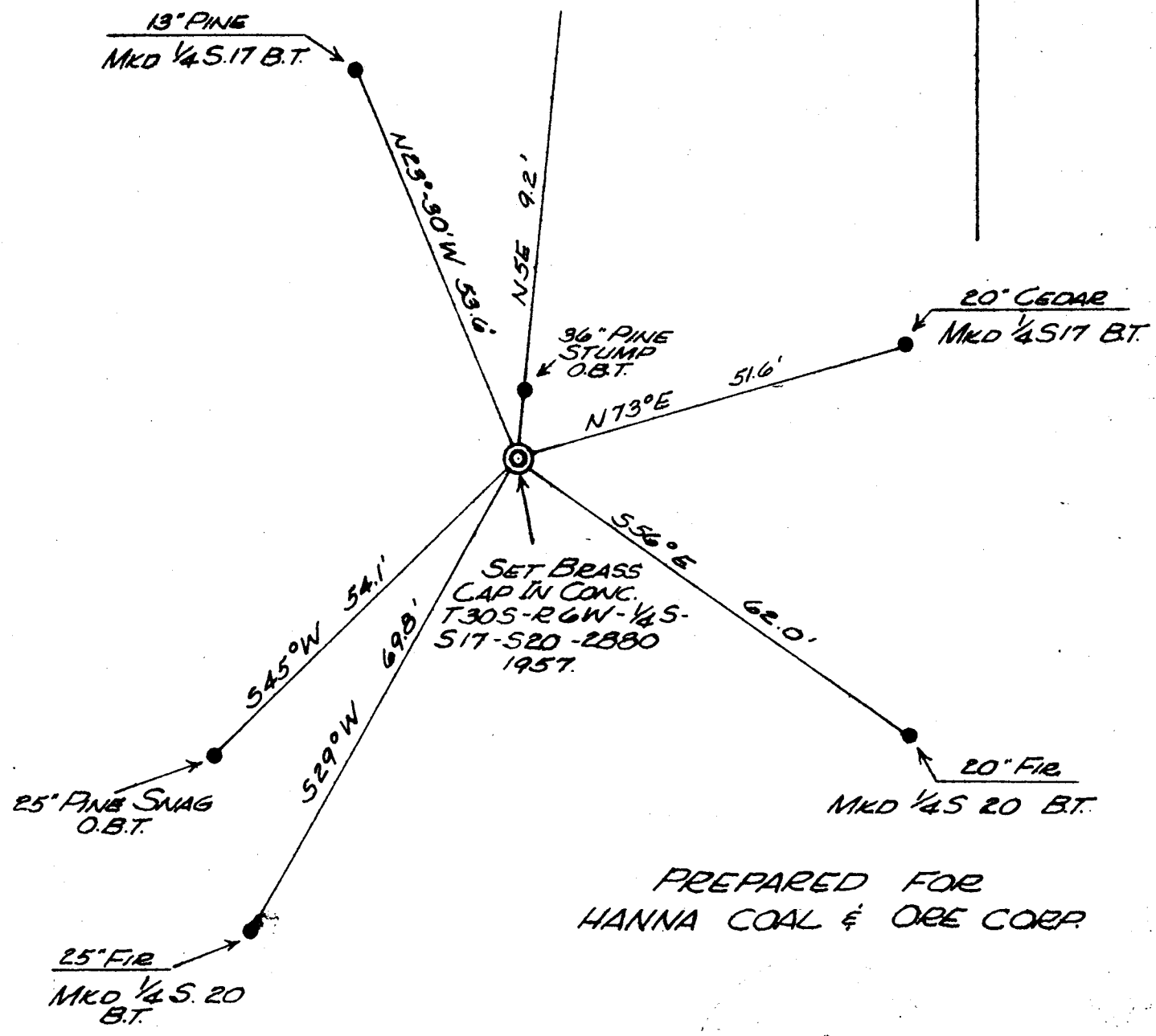

SET BRASS  
 CAP IN CONC.  
 T305-R6W-1/4S-  
 517-S20-2880  
 1957.

PREPARED FOR  
 HANNA COAL & ORE CORP.

*John H. Marshall*