

6-13-57

Section Corner 16-17-20-21, T30S
R6W, W.N. as det. by O.B.T.

A 30" Pine N70°30'W 36.0' O.B.T. fd. scribe

A 36" Pine S11°30'W 22.2' O.B.T. fd. scribe

A 20" Fir N42°E 49.5' O.B.T. fd. bark scribe

At corner point set brass

cap in concrete marked: T30S

R6W, S16-S17-S20-S21, 2880, 1957

from which

14" Pine bears N21°E 44.4' dist.

mkd. S16 B.T.

20" Pine bears N47°W 44.4' dist.

mkd. S17 B.T.

10" Fir bears S56°30'W 56.3' dist.

mkd. S20 B.T.

18" Pine bears S61°E 83.0' dist.

mkd. S21 B.T.

Road bears North 17.0' dist.

Witness:

Earl D. Jenkins

Work done for Hanna Coal & Ore

PREPARED FOR
 HANNA COAL & ORE CORP.

NORTH

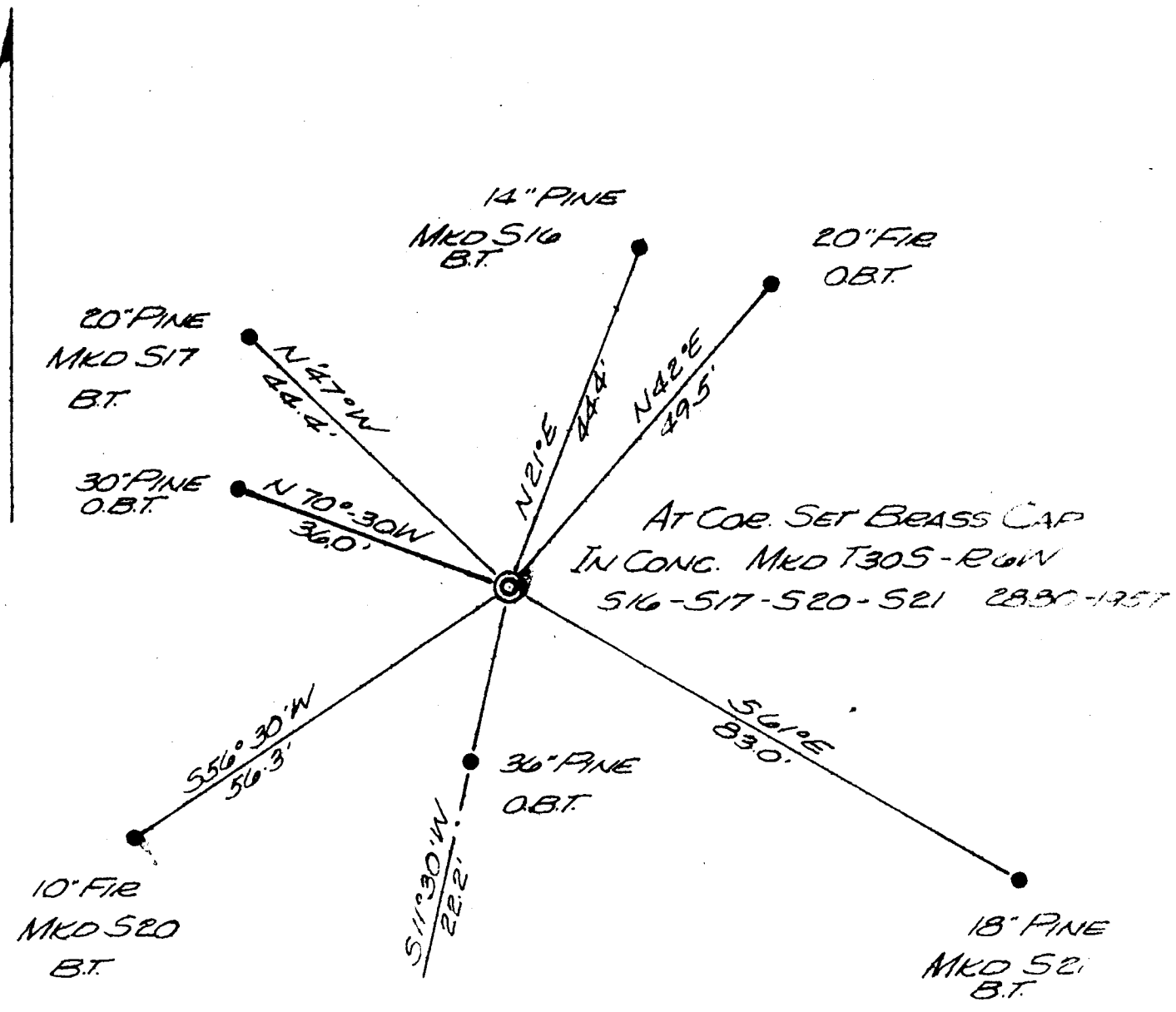

John B. M... ..