

6.14 ACRES

COUNTY SURVEYORS FILE DATA  
DO NOT REMOVE FROM OFFICE

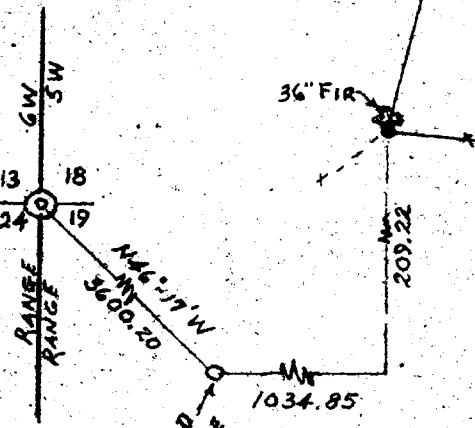

FILED  
RECEIVED

JUN 19 1957

COUNTY SURVEYOR  
DOUGLAS COUNTY, ORE.

● DENOTES SETTING OF 1/2" IRON PIN

C. S. File No. 42/266

SURVEY & PLAT PREPARED FOR  
J. O. LEDGERWOOD  
MYRTLE CREEK, ORE.  
SEC. 19 T29S R5W W.M. DOUGLAS COUNTY, ORE.  
MAY 10, 1957 SCALE: 1" = 100' DON R. MARTIN