

Represented by local residents as the N.W. Cor. D.L.C. 47

Measured to rock at NE Cor, 3502'. (Govt notes, 541 chs. = 3570.6') measures 68.6' shorter

N. Line D.L.C. 47

160/338

132/438

BUNKER HILL SUBDIVISION

1" = 200'

NE COR DLC
This ties to rock. This ties to rock.
 $W. 14.21 ch = 937.9'$ to rock. This ties in ok.
 $E. 8.5 ch = 561'$ to rock. $132/438$ 871.2 to rock. $2.5'$ off.

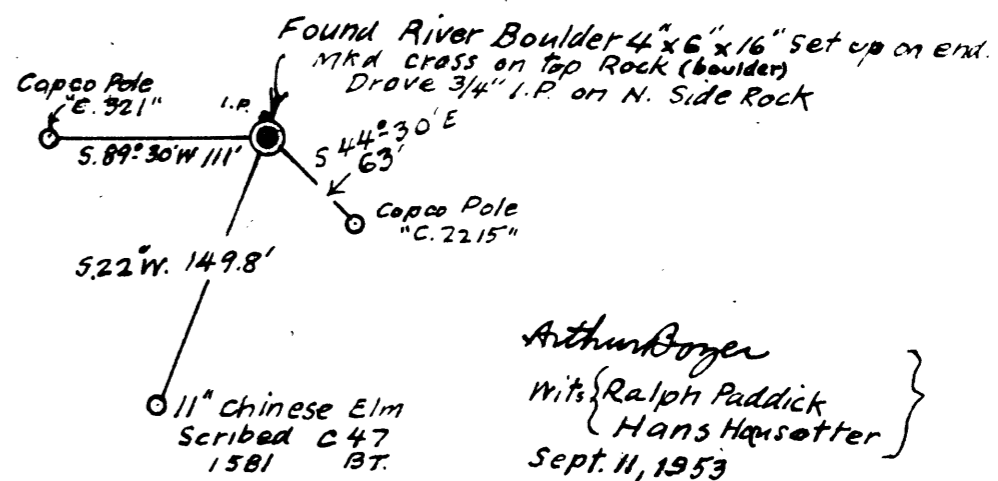

Arthur Boyer
with Ralph Paddock
Hans Hansotter
Sept. 11, 1953

NE COR. D.L.C. 47 (Vanderbosch)
T. 30 S; R. 6 W. (Riddle)

COUNTY SURVEYORS FILE DATA
DO NOT REMOVE FROM OFFICE

FILED
RECEIVED
SEP 29 1953

COUNTY SURVEYOR
DOUGLAS COUNTY, ORE.

NE COR. VANDERBOSCH D.L.C. 47
T. 30 S; R. 6 W., W. M.
Sept. 1953 AB. 1" = 200'