

COUNTY SURVEYORS FILE DATA  
DO NOT REMOVE FROM OFFICE

LULU A. OREY  
ANLAUF ORE.  
SEC. 30, T. 21 S. R. 4 W.

AUGUST 1951 FRED L. DOW

SCALE 1" = 100' CIV. ENGINEER

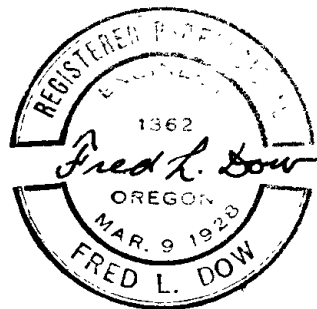

FILED  
INDEXED

MAY 26 1952

COUNTY SURVEYOR  
DOUGLAS COUNTY, ORE.

C. S. File No. 41/47 A

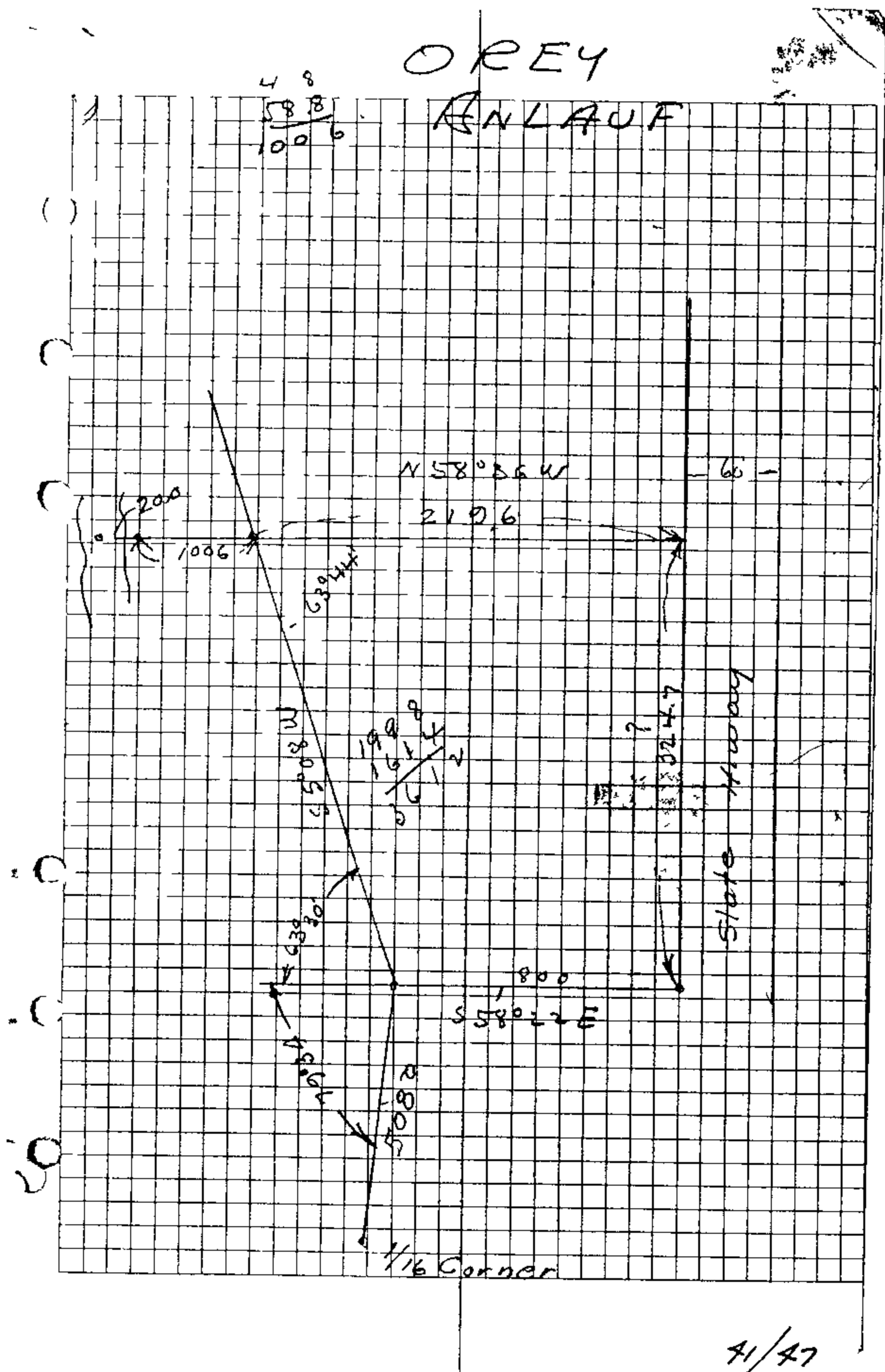

Lula A. Orey.  
Anlauf, Oregon.

Beginning at an iron rod on the Southeasterly line of the Oregon State Highway from which the Southeast corner of the NE $\frac{1}{4}$  of the NW $\frac{1}{4}$  in Section 30, Township 21 South, Range 4 West, W.M. in Douglas County, Or Oregon bears North 27°08' East 223.0 feet and North 65°08' East 334.2 feet and running thence South 27°08' West 325.1 feet along the said Southeasterly line of the Oregon State Highway to an iron pipe, Thence leaving the said Oregon State Highway South 58°36' East 320.2 feet to an iron pipe on the Westerly bank of Pass Creek, Thence continuing S South 58°36' East 20.0 feet to a point in the center of Pass Creek, Thence North 28°51' East 323.1 feet along the center of Pass Creek to a point, Thence leaving Pass Creek North 58°22' West 85.4 feet to an iron pipe on the westerly bank of Pass Creek, Thence continuing North 58°22' West 264.6 feet to the place of beginning, containing 2.57 acres.