

E. E. Church

Secs. 19 & 20 - T 30 S - R 5 W.

June 1948

A. R. Evans T

M. E. Godfrey H. C.

L. E. Kershner R. C.

G. S. No. 39181

Sta Dist \angle CC. M.C. Slope^①

3

60^g

50°27'W

65^g

-22°06'

S

2

P.O.T.

24^gL

2.73⁵

50°27'W

252^e

-9°24'

0°06'

S.

0°03'L

1

178^g

177^e

50°30'W

-6°40'

99324

50°30'W

1/4 Cor

19/20

92653

on S side HWY

98657

Fd Rifle barrel - 4 witness
trees standing - 3 alive -

Oak 5 - 14 $\frac{1}{2}$ W - dead

G. S. File No. 32/181

sta Dist \angle C.C. M.C. slope ⁽³⁾

6

181¹

50°54'W

5

0°09'
0°04'L

50°36'W

36³L

336³

50°58'W

300°
-0°37'
99994

50°45'W

4

10°02'
0°31'R

157²

50°27'W

157⁸
+2°25'

3

P.O.T.

5

50°33'W

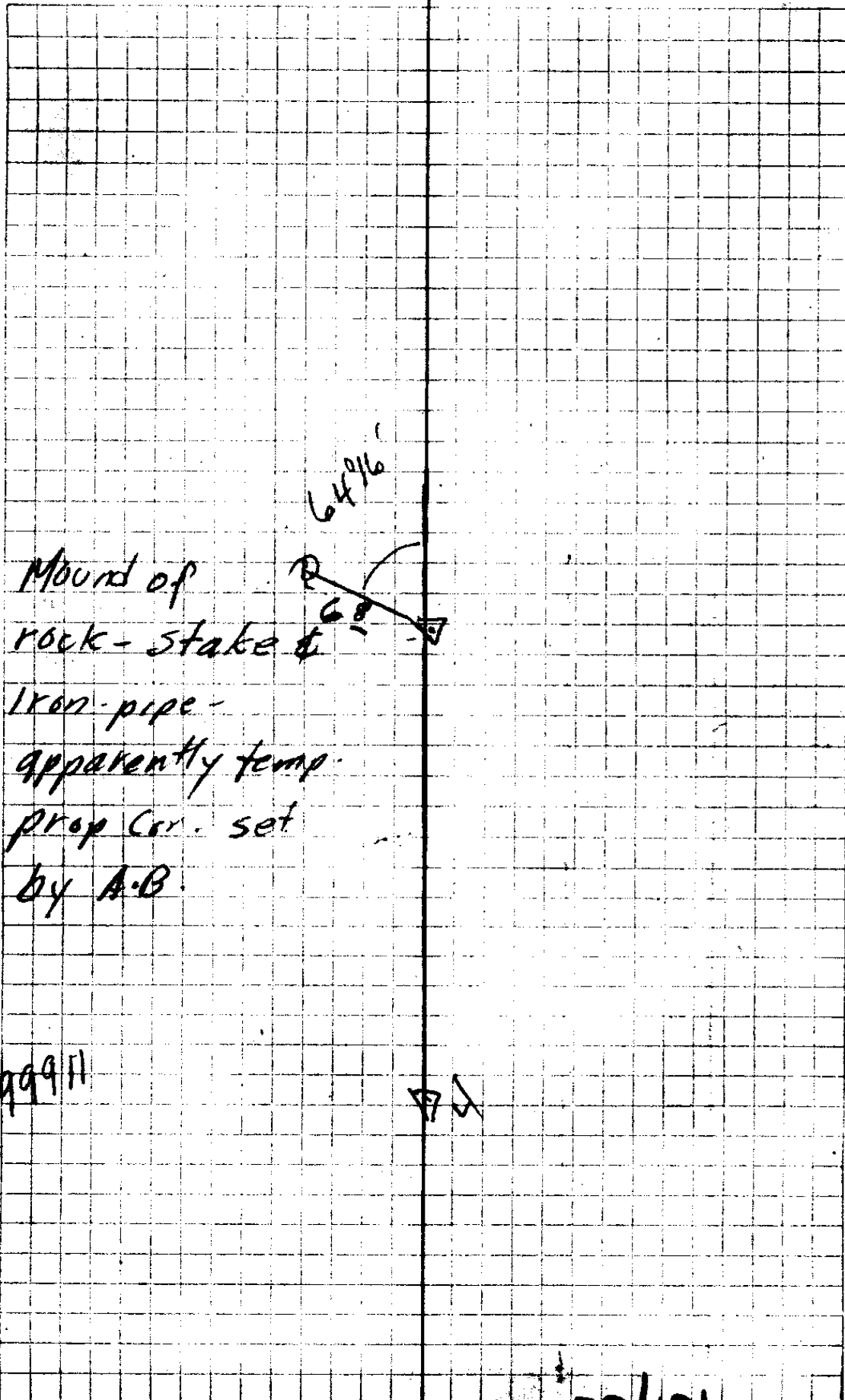

Mound of
rock-stake B
Iron-pipe -
apparently temp.
prop. Cor. set
by A.B.

99911

Sta	Dist	Δ	C.C.	M.C.	Slope (5)
9					1214 +11058'
	1188		5134' W.		
		4032' 2°16' R		51° W.	
8					
	4448		5042' E		
				51° E	
		3°48' 1°54' L			
7					1562 +2045'
	1560		51°12' W.		
		0°35' 0°18' R		51° W	
6					
			50°34' W.		

97827

High bank of river
N side of road.

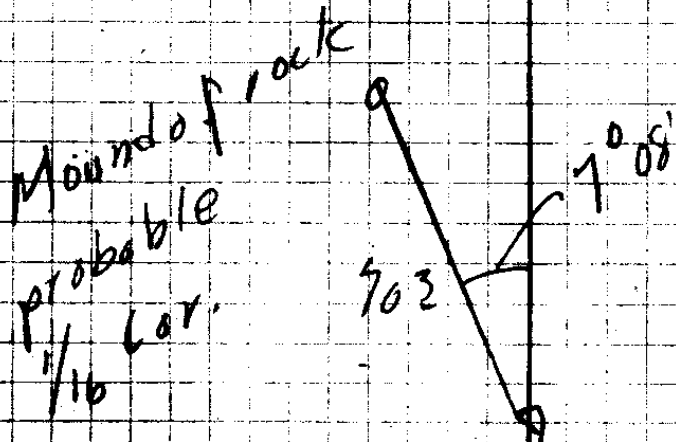

99895

C.S. No. 39/181

Sta	Dist	±	CC.	M.C.	Slope
12					
	76 ¹		50°43'W	S.	83 ⁶ +24°29' 91008
11		0°50' 0°25'L			
	150 ⁶		51°08'W		162 ³ +21°52' 92827
10		0°19' 0°09'L		50°30'W	
	252 ²		51°17'W		260 ⁴ +13°57' 91051
9		0°35' 0°17'L		50°15'W	
			51°34'W		

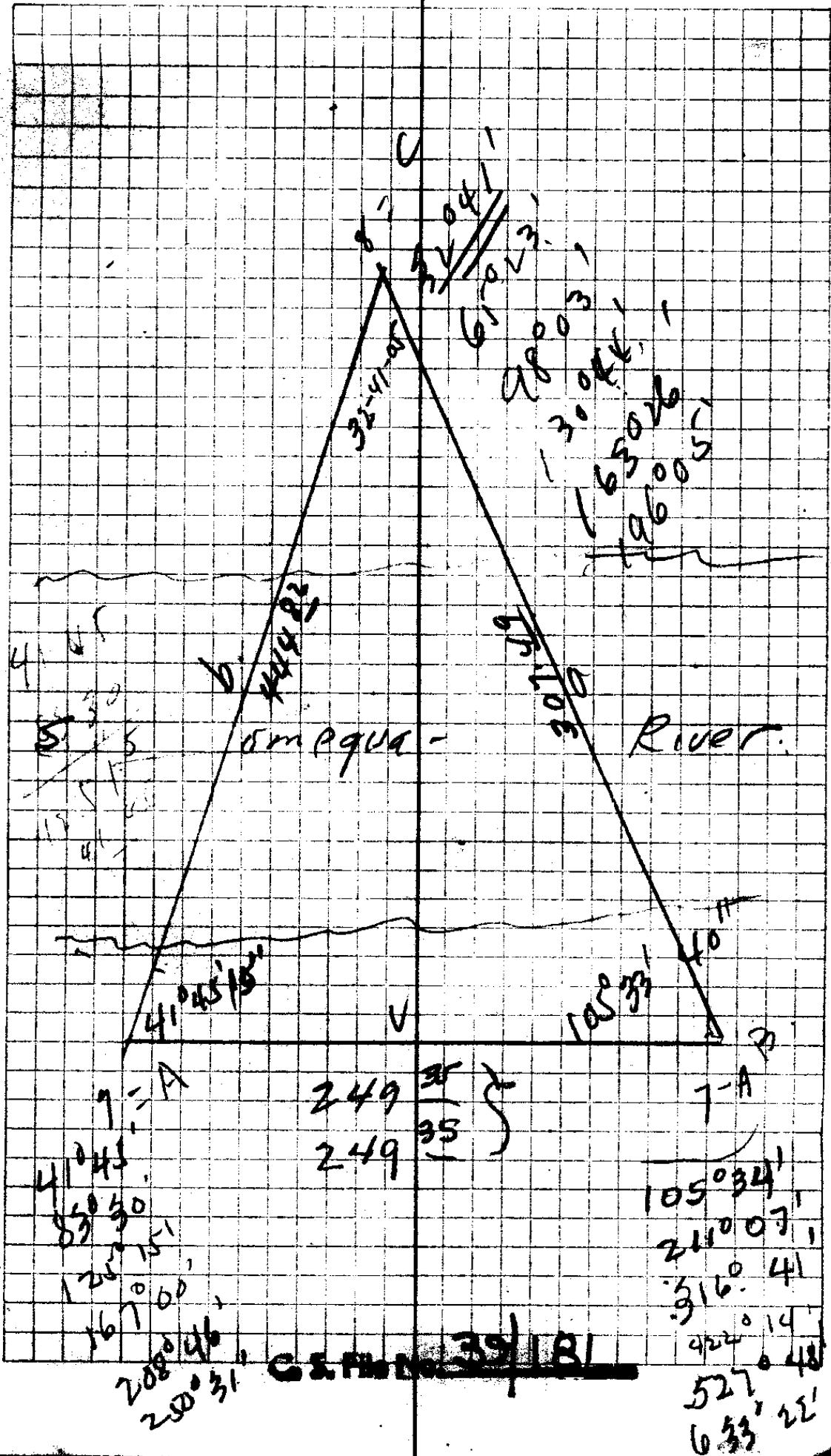

$$A = 41^{\circ}45'15''$$

Triangulation -

$$B = 105^{\circ}33'40''$$

$$C = 32^{\circ}41'05''$$

$$\frac{b}{\sin B} = \frac{a}{\sin A} = \frac{c}{\sin C}$$

$$a = x$$

$$b = y$$

$$c = 249.35$$

$$\frac{b}{\sin 105^{\circ}33'40''} = \frac{249.35}{\sin 32^{\circ}41'05''}$$

$$b = \frac{249.35 \sin 105^{\circ}33'40''}{\sin 32^{\circ}41'05''}$$

$$\log 249.35 = 2.3968094$$

$$\log \sin 105^{\circ}33'40'' = 9.9837818$$

$$\hline 2.3805912$$

$$\log \sin 32^{\circ}41'05'' = 9.7274965$$

$$\log b = 2.6481848$$

$$b = 444.84$$

$$\frac{a}{\sin A} = \frac{b}{\sin B}$$

$$a = \frac{444.84 \sin 32^{\circ}41'05''}{\sin 41^{\circ}45'15''}$$

$$\log 444.84 = 2.6481848$$

$$\log \sin 41^{\circ}45'15'' = 9.8234324$$

$$\hline 2.4716170$$

$$\log \sin 105^{\circ}33'40'' = 9.9837818$$

$$\hline 2.4878352$$

S. File No. 39/181

307.49

sta Dist \angle C.C. M.C Slope

Sec.

Cor
 $\frac{19}{20}$
 $\frac{30}{29}$

498

-22°34'

92343

46°

55910' W.

557 $\frac{1}{2}$ ' W.

106°52'
 53°26'R

14

1585

+9°49'

156°

5344' W.

98536

6°04'
 3°02'E

53°E

15

50°

+9°37'

49°

5042' W.

98594

0°03'
 0°01'L

S.

12

50°43' W.

~~Sec. Cor~~ identified from

1-0 BT alive and standing

30" Laurel - N 5° W - 27.7'

Found stake set by State Hwy
Survey crew - Checks for recorded
bearing and distance -

Use as temp. cor.

Reset corner $\frac{19}{20}$
 $\frac{30}{29}$

Set 1" G.I.P. with brass cap
marked County Surveyor's off

$\frac{19}{20}$ - T30S - R5W - $\frac{30}{29}$

Scribed B.T.S.

S. File No. 39/181

20" Fir. N 19° E - 50 ft
Mkd S-20 - T30S R5W - C.S.B.T. RE 2741

18" Fir S 52 1/2° E 104'
Mkd S-29 - T30S - R5W - C.S.B.T. - RE 2741

20" Fir N 22° W - 22 3/4'
Mkd S-19 - T30S - R5W - C.S.B.T. - RE 2741

18" Maple S 28 3/4° W 71° - 9° 02'
Mkd S-20 - T30S - R5W - C.S.B.T. RE 2741

A. R. Evans Jr
M. E. Godfrey
L. E. Kerstner

Rec'd

Sta Dist \neq C.C. M.C. Slope

17

215⁸
+ 21053'

190²⁴

588⁵² E

589^{3/4} E

16

0²⁵'
0¹²' R

185⁶
+ 24026

169⁰

589⁰⁴ E

15

1034'
0³⁹' L

E

161⁰
+ 21037

149²

588²⁷ E

291¹⁵'
145³⁷' L

589⁰ E

Acc. C.C.
19/20
38/29

557¹⁰ W.

Top of ridge -

92794

91044

92967

C.S. File No. ~~39/181~~

Sta Dist \angle CC. MC. Slope ⁽¹⁵⁾

Ext L

Cor.
DLC 43

66 S

S 88° 00' E

S 86° E

66 E

- 2003'

99936

17

1045'
0° 52' R

S 88° 52' E

Church

6-11-48

A. R. Evans.
M. E. Godfrey.
L. S. Kershner.

Reset Ext "L" corner, D.L.C. #43.
from original B.T. Red Oak
4 1/2" diam, bears N 10° E, 622'
Set 3/4" I.P. with brass cap
marked County Surveyor's Office,
Ext. "L", D.L.C. No 43, T 80 S, R 5 W.
Marked New B.T.'s

18" Fir, S 75° W, 268'
Marked, Ext "L", D.L.C. #43 - C.S. B.T. R.E. 2741

10" Fir, N 32° E, 169'
Marked Ext "L" D.L.C. #43 C.S. B.T.
R.E. 2741

C. S. File No. 39/121

~~Rev~~

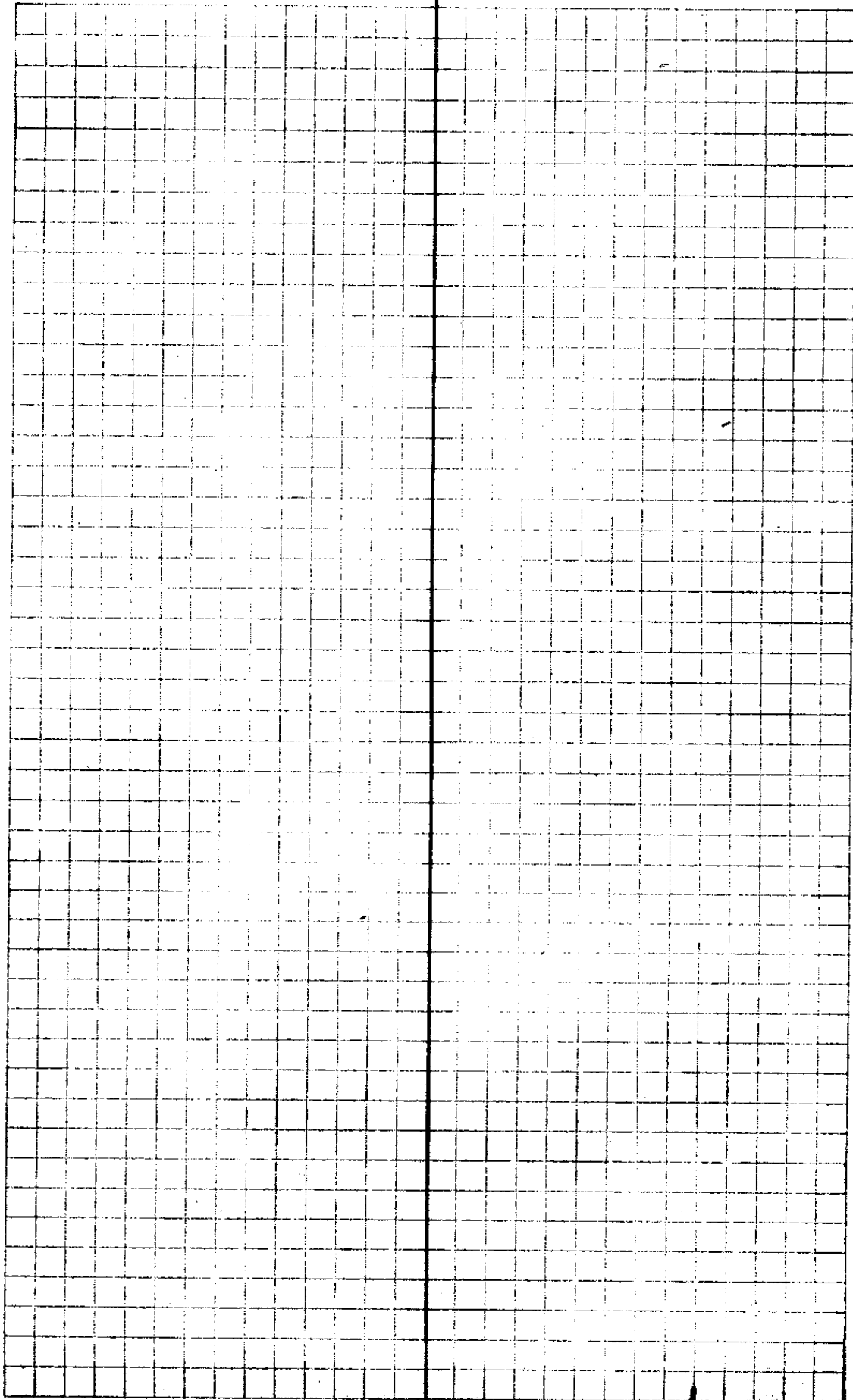

G. & P. No. 39/181

Sta Dist \angle C.C. M.C. ¹⁹ Slope

22

90°

N89-22W

1025
+28°35'

21

10°15'
5°07' L

N89°4'W

75°
-2°29'

75'

N84-15W

2°56'
1°28' L

N85°W

20

112°
-23°40'

1026

N82-47'

8°08'6"
42°03' R

N84°W

19/20
30/29

557°10' W

14

87812

99906

9590

C.S. No. 39/181

Sta	Dist	\angle	CC.	M.C.	²¹ slope
-----	------	----------	-----	------	---------------------

25

84²

589-56 W

87^E
-16°33'

24

10°20'
5°10' L

589° W

48^b
+9°37'

47⁹

N84-54 W

23

19°24'
9°42' R

N86½ W

109⁹

585-24 W

120^E
+23°39'

22

10°27'
5°14' L

584¾ W

N89-22 W

95857

Top of Ridge CO NE

98595

91601

C. S. File No. 32/181

Sta Dist \angle cc. MC

28

27

153°
 $-9^{\circ}35'$

151^b

S83-41

H95¹/₂W.

26

11^o43'
5^o51'R

187°
 $-16^{\circ}00'$

179⁸

S89-42W.

25

0^o28'
0^o14'L

S88¹/₂W

S89-56W.

98604

96/26

C.S. File No. 39/181

CS FILE FOLDER

CONTAINS

MORE

INFORMATION