

321162
G. S. F. No.

Maurice Hallmark

S-15-T255-R2141

Feb. 1948

Ben B. Irving Jr

A. R. EVANS H.C.

Jerry Rogge Axc.

Eldon Harris Axc -

Isom Clinton Axc

Hub	Dist	Δ	CC	MC	Slope
662.75 4	50 ⁹ ✓	0 ¹⁰ 0 ⁰⁵ R	50 ⁰⁵ W ✓✓		+ 19 ⁰⁶ 53 ⁹ ●
	172 ⁹ ✓		S		+ 15 ⁰¹ 179 ⁰ ●
3		0 ¹² L 24'	50 ¹² W		
	203 ⁷ ✓				+ 6 ³⁰ 205 ⁰ ●
2		0 ²⁴ 0 ¹⁴ L			
	193 ⁷ ✓	352 1 ⁵⁷ L	50 ²⁶ W		+ 4 ²⁵ 193 ⁸ ●
1					
	42 ⁰ ✓		52 ²³ W		+ 20 ⁰⁷ 44 ⁷ ●
10/11 15/14 SLL low					
				19 21 ⁰ E	

T 255 R 20

1-28-48 (1)

94595 ✓

BB 1 N
Evans HK

96585 ✓

Roppe
Hargis

99357 ✓

99703 ✓

93899 ✓

Identified from G.I. BT.

Correct for bearing + dist

Sing SE. Cedar No dead

Hemlock New badly rotted

New BT. Cedar 24' N 80° W 58'

Fir 16' N 57° E 33'

Cedar 18' 584 E 51'

Remnant " 9' 5 W

Row
6-5-48

File No. 3-116

set 1' G.I. P. with
brass cap
mkd. G.S. opp.
TSSR
5 1911
1114

Hub	Dist	\angle	CC	MC	Slope
10 1279 ⁰	213 [✓]		✓✓ 58°50E		-21°26'229 ⁰
9	26 ^L	7 26, 343 ^L	55°04 ^E		
8		18 28, 9°14 ^L			
	138 [✓]		54°07 ^W		+28°23' 157 ⁰
7		16 18 8°09 ^R			
	178 [✓]		64°57 ^E		+5°15' 179 ³
6		8 33, 4°17 ^L			
	60 [✓]		60°15 ^W		
662 ⁷ 5		0 21, 0°10 ^E			
			50°05 ^W		

E 1/16 Lw 266 Ahead
E 1/16 Lw 175 Back

93084 ✓

Top Spur

Call for 321169

87979 ✓

99580 ✓

910

Hub	Dist	Δ	CL	MC	Slope
15	227 ⁹	83 11 41°35' L	51031 W	511° W	+31°00' 265° ⁹
14	224 ²	130 50 65°25' R	552° 06 W	553° W	+36°34' 279°
13	251 ⁷	107 0°33' L	513° 19' E		+18°12' 265° 513° E
12	200 ⁷	5 55 T 2°57' L	512° 46' L		- 8°57' 202°
11	157 ³		59° 49' E		- 5°30' 158°
10		1 53 0°57' L			
			58° 50' E		

85717 ✓

80316 ✓

~~4447~~ ✓

+100 + Crack NW ~~✓~~

98782 ✓

99540 ✓

Jan 24 48.

C. & F. No. 351163

20

✓✓

151⁹ ✓

-330' 152²

53°E

51°53'W

19

37⁸ ✓
0°03' L

51²W

14 20 51°56'W

18

7°10' R

+20°40' 94°

87⁹ ✓

55°14' E

55°E

17

3206,
16°03' R

152⁶ ✓

52°17' E

+11°35' 155⁸

16

328.
6°44' R

52⁹ ✓

528°01' E

+25°04' 58¹

15

77.04
88°32' L

528°E

510°31' W

99813

~~38~~ 169

C. S. File No.

On blazed line
~~93524~~ 93565

on blazed line

97963

90582 1

25 ✓
178⁷ 52° 09' E +33° 28' 214²

24 230,
1° 15' L ✓ 52° E L 13¹

308⁶ 60° 54' E 300°
72048
51' 22"

23 0° 51'
0° 25' R +430 255⁶

254⁸ 34, 51' 14" E 51° E
22 0° 17' L

278⁸ 51° 02' E 5 1/2 E L 34⁷
641
321' L +432 245⁶

21 70⁶ 52° 19' W 53 1/2 W

20 51,
0° 26' R 51° 53' W

5

8342
 2142
 166842
 333684
 83421
 166842
 1786877.82
 18483

BBT T
 EUM HE
 Ruffe + Elton Hays
 Snow on ground
 2-5-48

49692

U.S. File No. 39/162

49639

Intigent search fail to 11/15
 find evidence

BBI T
 Evans He
 Ruffe
 Snow on ground
 Feb 4 1948

Hub	Dist	\angle	CC	MC	Slope
31			✓✓ 53°W		L 618 -4°53' 300°
30	360 [?]	0°22' 091' L	53°11'W		
29	29 ⁵⁻	247 1°23' L		53°W	
28	253 [?]	814, 4°07' L	54°34'W		+4°50' 254° 54°2'W
27	83°	1546 7°53' R	58°41'W		+20°30' 88° 58°W
26	214	518, 2°38' R	50°48'W	S	33°32' 257°
25	167 [?]	38 0°19' R	51°50' E		01 51° E 4035220 ¹
			52°09' E		

6

99637

99644

93667

83356

75946

G. S. File No. 321163

541

19
238
753
1050
541
509
209
30

Sec Cot
15 14
22, 23

✓ ✓

44³

576° 04 E

34

3° 38' R

99°

579° 47 E

+ 11° 23' 101°

580° =

33

16° 46'
81° 23' L

166⁶

51° 36' W

- 245'

166⁸

32

1 11'
0° 36' L

51' 20

234²

332²

52° 12' W

52° W

+ 6° 35' 300°

~~500° W~~

31

1 36'
0° 48' L

53° 00' W

①

15714
22 | 203

See Cor

Remarked DBT Pine 18" N 46° E 6 1/2
 " " " 24" N 35° W 18 1/2
 DBT Hemlock 8" S 67° E 31 1/2
 Sharp DBT " S 51° W 22 1/2
 New BT 8" Hemlock S 83° E 38 3/4
 " 16" Pine S 29° W 18 1/2

6.8.25

98033

82° 47'
 3 38

 79 09
 3

 76 09

99885

Top Spar
99341

39/169
U.S. File No.

(B)

Set by proportional measurement

Set 1"x30" pipe 28' in good

16" Pipe N 75° E 123

1/4 S 14 1/2 BT

12" Pipe S 51° W 39 L

1/4 S 15 1/2 BT

Recorded
6-8-48

U. S. File No. 321162

Smewing
2-9-48

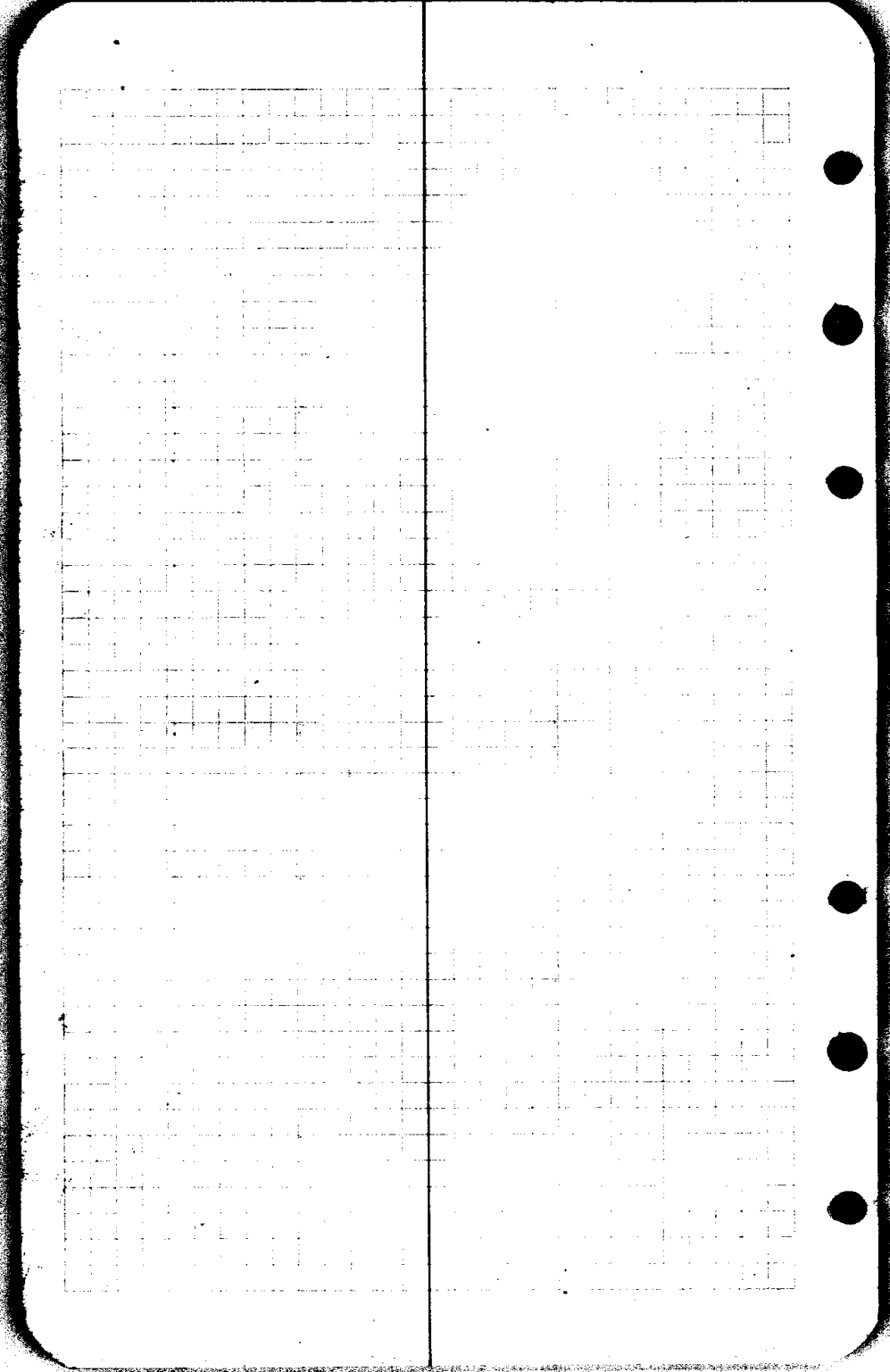

9

C. S. File No. 22-1162

	Dist	X	CC	MC	0510
47	✓ 246	✓	✓ 588°50'W	715 589°W	05 255
41		00°10' 05' L			
40	151	✓			300 1513
39		POT		588°W	
			588°55'W		
	184	✓		588°14'W	2042
		165°49'			25°15'
1/165		82°55' R			
	32	02			
10		81°39'	56°00'W		
		1544 R			
			59°49' EFS		
11					

96555 ✓

99863 ✓

C. S. Elm No. 351169

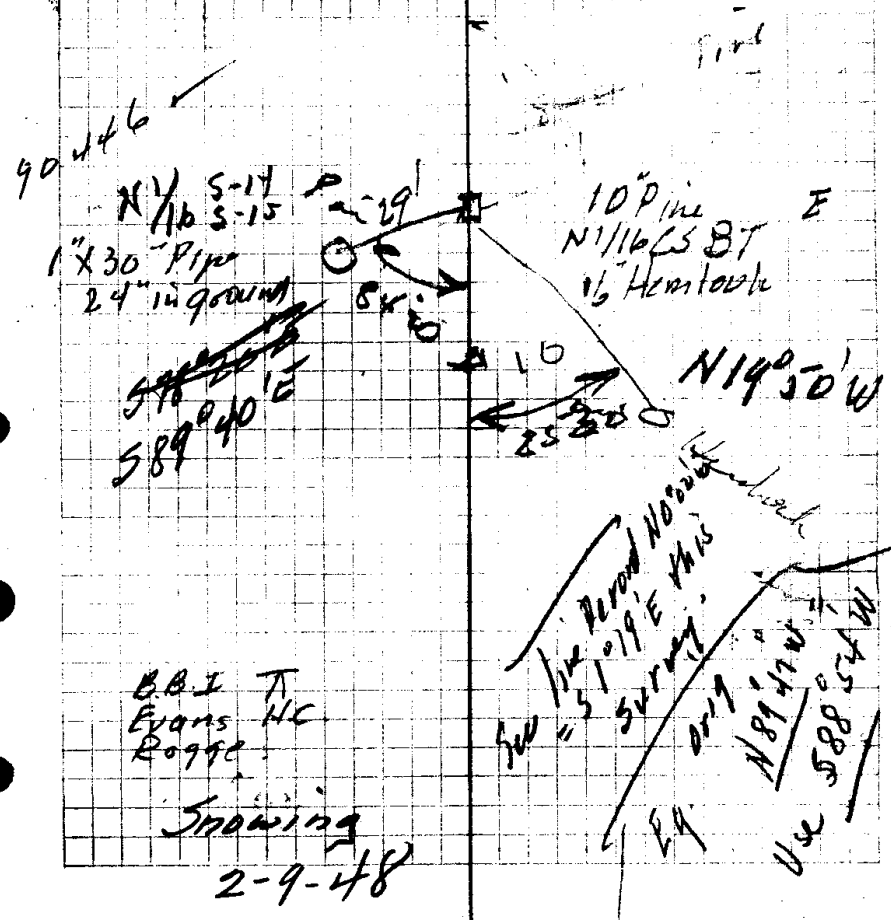

Hub	Dist	A	CC	MC	Slope
47			✓		
1303 ⁰	87 ^L		✓		
46		7.03 3.31 ^R			
	48 ^L				
45		1.55 0°51 ^R			
					+16°45 ^L 159 ^S
44	152 ^L	9.51 4°56 ^R			
10L ^{4.8}	221 ^L				
					+7°32 ^L 223 ^L
					587 ^L W
43		5.18 2°39 ^L			
	210 ^L				
					+1°20 ^L 210 ^S
42		19. 0.10 ^R			
582 ^L					
					589°00 ^W
					589°10 ^W
					588°50 ^W

(11)

9117

10

U. S. File No. 391163

95757

99173 ✓

94973

2105
22

4210
210
846310

99173
273

694211

297519

798346

98346
~~200000~~

221850001

Hub	Dist	Dept ↓	L.C.	M.C.	Slope
51 ^A 52 2060.0	87 [±]		✓ 589°16'W	585°	924 -19°20'
51	197 [±]	0° ³¹ 15' R	589°01'W		-8°20' 200°
50		2° ²³ 12' R	589°W		
	69 [±]		✓ 586°49'W	586°W	+7°30' 698
49	270 [±]	0° ²⁸ 14' R	586°35'W	586°W	+25°15' 2790
13	136 [±]	2° ⁴⁶ 23' L	587°58'W		
17 18 13.03 [±]		15° ³⁸ 49' L		587°W	-9°50' 138°
			184°13'W		

92361

98944

99140

90406

98531

8251

CONFIDENTIAL

7 29

1 23

9 12

8 25

86 44

8 25
93 11

8 4 13 95 19
7 19 88 54

~~11 02 6 53~~

142
87

53
2299[±] 130⁻ ✓
1°02' 587°33'W
0°21' 584[±]W
3136¹ 152⁶

52
105[±] 588°04'W
22^W -2530¹ 116⁸
585^W

51
2064[±] 1°12' Δ
58916^W

13

C.S. File No. ~~321162~~

85264

90259.

Hub	Dist	∠	CC	MC	Slope
58	331.8	9° 29' L	583° 43' W	585° W	31.8° 300°
57	258.1	4° 44' L	588° 28' W		88° 170°
56	413.6	1° 40' 0° 50' R	587° 38' W	N 89° W	116° 7° 53' 300°
55	114.7	0° 05' L	587° 40' W	587° W	19° 34' 121°
54	206.9	18' 09' R	587° 31' W	586° W	29° 26' -237°
53		0° 04' L	587° 33' W	586° W	
				V _n 22° E	

88 28
+ 44
~~174 12~~
93 + 3
83

80' ahead water edge to work
on Lt. Bank Rock Crk.

99055 ✓

94225 ✓

87093 ✓

23
1525
~~3625~~

88 SA

C.S. Eng. No. 321162

Cloudy - Shaws
2-16-48
BB/T
Evans &
Rogge
Cl in doc

Hub Dist \angle CC MC Slope

63 $\frac{34903}{24903}$ ✓
 $588^{\circ}37'W$ $588^{\circ}W$ $+11^{\circ}15'59''$
 $+14^{\circ}10'30''$

62 $\frac{119}{0^{\circ}40'R}$ ✓
 350° $587^{\circ}57'W$ $586^{\circ}4'W$

61 $\frac{103}{0^{\circ}31'L}$

60 453° ✓
 $0^{\circ}01'L$ $588^{\circ}28'W$ $588^{\circ}W$

253° ✓
 $588^{\circ}29'W$

59 $\frac{11617}{5808'L}$ $587^{\circ}1'W$

91^d ✓
 $N33^{\circ}23'W$ $N92^{\circ}1/2'W$

58 $\frac{12546}{62^{\circ}53'R}$

✓
 $583^{\circ}44'W$

(15)

6320

at intersect N45 Blazed Line

98079 ✓

96959 ✓

85) 5
86/60

S. File No. 32162

4400' of Road NE-SW

62 53
58 09

3 44
23 21

87 28

2-17-48

83 44
62 57

33 23
58 05

146 37
58 08

91 31
85 29

84 88 29
83 63 88 20

62 53
83 44
145 97
88 54
27 23

62 53
146 37
148 6

216 37
88 54
37 23

33 23

Hub Dist \checkmark CC MC Slope

68

108[✓]

2°37' N1°24'E
1°19' R

N1½E

+3137' 82°

67

1307

407[✓]

7 36
3°48' L

N003E

N½W

+3328' 148°
+1919' 300°

66

507

505[✓]

4 00
2°02' L

N353E

N4½E

+2045' 272°
+1816' 264°

65

297[✓]

N555E

S5½W

+1000' 300°

64

949
950

4 03
2°02' R

N353E

N63½E

+1253' 97°

63

19033
95°16' R

S83½W

N3¼E

85/57 ✓

2-18-48

83421 ✓ #2388
94380 ✓ 283140

C. S. File No. 39162

93514 ✓
94961 ✓ 3" hemlock
mkd willow
4235'
325'

9848' ✓ 295463
247.0
465

± 50' ahead 10' Rt 20' Fir X N side Blaze
S side

97483
47587

87 47
45 12
182 08

60.64
1750

9/10
TEMP

✓

N 26 25 W

86°

-25° 35' 96°

N 28° W

78

220° L

-9° 50' 71 1/2

70°

N 4° 21' W ✓

N 2 1/2° W

69

8 10
2° 35' L

N 1° 46' W

216° ✓

+14° 40' 223°

N 1 1/4° W

68

6 20
3° 40' L

N 1° 24' E

1377

DBT 40" Fir NE E

DBT 14" Fir N W

30" Fir S 5° W 38°

30" Fir S 45° E 50°

~~U.S. File No. 391162~~

90196 ✓

Top Ridge NE-SW
98531 ✓

Trail 10' back

96742 ✓

27 49
1 24
— 26 35

Hub Dist \angle CC A/C Slope

73

2555 ✓

50°04' E ✓

2557
-2005'

59°16'
29°38' L

Var. 7'

72

386 ✓

47°27' 529°34' W 530° W
23°44' R

71

628 ✓

55°50' W

h 764
L 2570

63

3.5 ✓
1°56' R

54 1/2 W - 10° 00' 300'

64

53°54' W

set 1/4 Cor. 15
1/16 - 20 West of
A73 - identified
Set 1" I.P. with brass cap
marked 1/4 - 5 - 15 - 5 - 16 - Co. Sec.
off. Mkd - new B.T.S.

10" Maple N 49'E, 44.5'
14" Maple West 52'

Rec'd
6.8.48

E. Bank of Channel - 3035

S. Bank of channel 130'

N. Bank of channel + 40'

Trail + 192

On Blazed line 2 Trees mtd X
facing old trail

U.S. File No. 391165

98481 ✓ 295.143
76.4 ✓
257.
628.8

Hdb	Dist	Y	CC	HL	SL
85	191 ⁵				234° 51' 233 ⁴
8 ^v	38 ^v	1 07 0° 33' R	N 4° 17' E	N 4° E	
83	214 ⁴	5 20 2 50 R	N 3° 44' E	N 3° E	28° 57' 239 ⁴
8 ^v	345 ⁰	132° 09' 66° 04' L	N 0° 54' E	N 1/2° E	7 10° 8' 217 ⁴
81	325 ²	68° 51' 34° 25' R	N 66° 58' E	N 65° E	
80	508 ⁴	48 0° 24' L	N 32° 33' E	N 32 1/2° E	252 ² L 300°
59		101 35 50° 47' L	N 32° 57' E	N 33° E	L 217 ⁴ L 291°
58			N 83° 44' E		
				V 21° E	

82065 ✓

87504 ✓

98389 ✓

(19)

C. L. File No. 321162

1 98389
 1 2179

 885501
 688723
 98389
 196778

 214389631
 6 87504
 7 439

 787536
 262512
 350016

 38413256

5111
 3425

 1206
 8300

 6458

125 $\frac{10}{15}$

66 $\frac{1}{2}$

87

59°28' L

N 56° 07' W + 10° 57' 67 $\frac{3}{4}$

N 55° 6' W

163 $\frac{3}{4}$

N 3° 21' E N 3° E

86

1 5' 0° 56' L

+ 36° 02' - 201 $\frac{9}{10}$

N 4° 17' E

~~CSB No. 221162~~

Rock & BTs as per Official Maps

Trees Dead

66" Fir N 58' E 20° ft 1/4 S 10 CSB7

6" Fir S 46' E 37° ft 1/4 S 15 CSB7

Chisled 1/2 of X on Rock

98179 ✓

80867 ✓

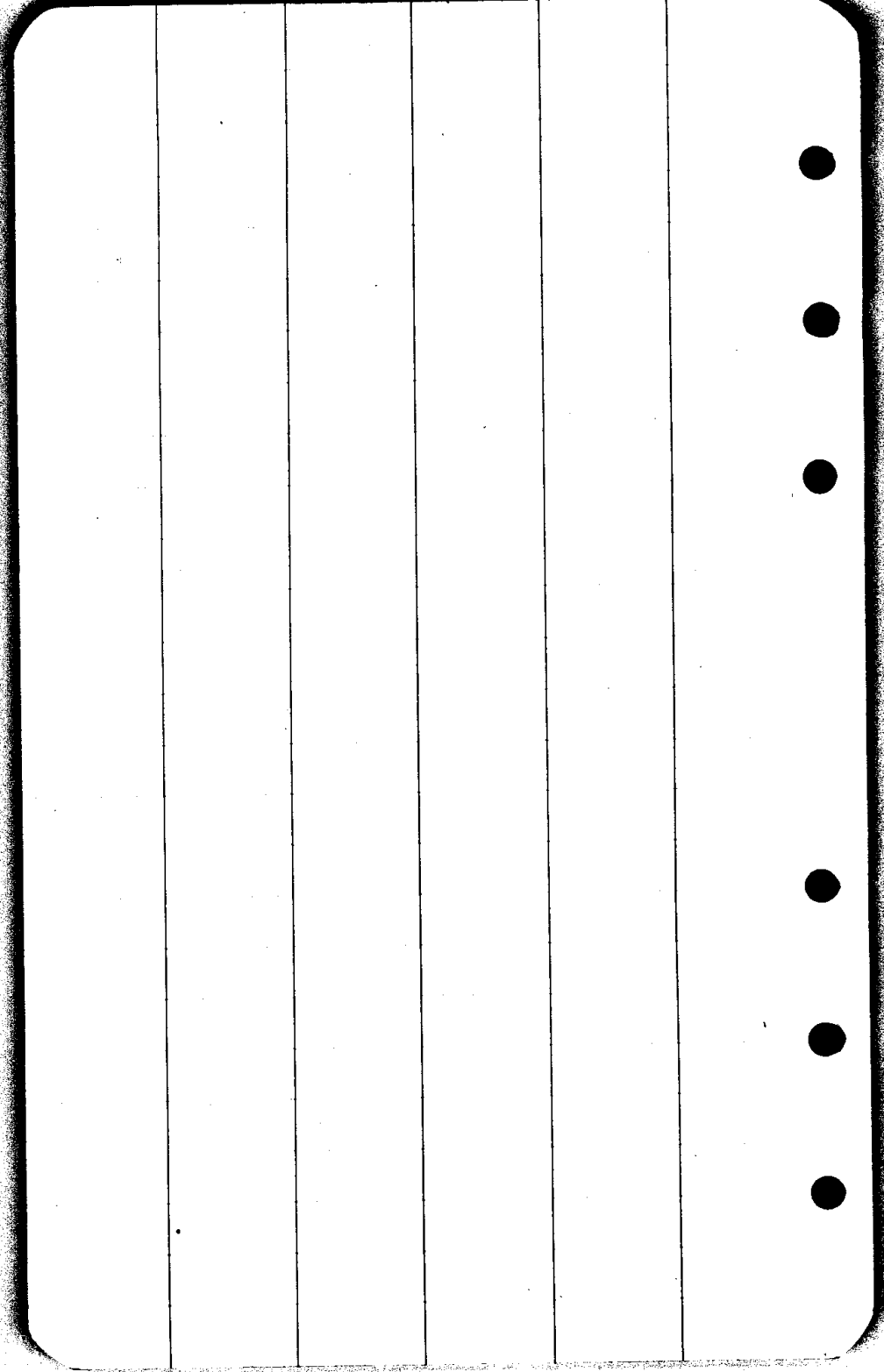

(21)

39/11/69
C. S. P. No. 39/11/69

The image shows a page of graph paper with a vertical line down the center. The grid is mostly empty, with some faint markings. The page is numbered '21' in a circle at the top right. There is a handwritten note '39/11/69' and 'C. S. P. No. 39/11/69' written vertically on the right side of the grid.

Hub	Dist	¢	cc	M.C.	Slope
-----	------	---	----	------	-------

Apr 16 Cor

135⁵

43⁵ L.

P.O.T.

100⁰
- 23° 02'

A

50⁵

151° 50'
71° 55' R

51⁵
- 10° 43'

54

587° 31' W

53

1-20-28 (22)
cloudy - Rain -
Evans T
Clinton H.C.

G.S. File No. 391162

9/25/6.

Hub Dist \angle cc. M.C. Slope.

N 1/10 Cor
S-15-S-16

70⁶

N 73⁵ 9' W N 73⁰ W

1590 48'
790 54'

65

N 55⁰ 55' E

64

1-23-48
Clear -

(2)

Evans T.
Godfrey H.C.
Kershner R.C.

C.S. File No. 391162

Set 1" I.P. for N 1/16 Cor - S-N-S-16-
Marked B T's

24" Cedar - S 1°30' E 115'
8" Cedar S 79° W 90'

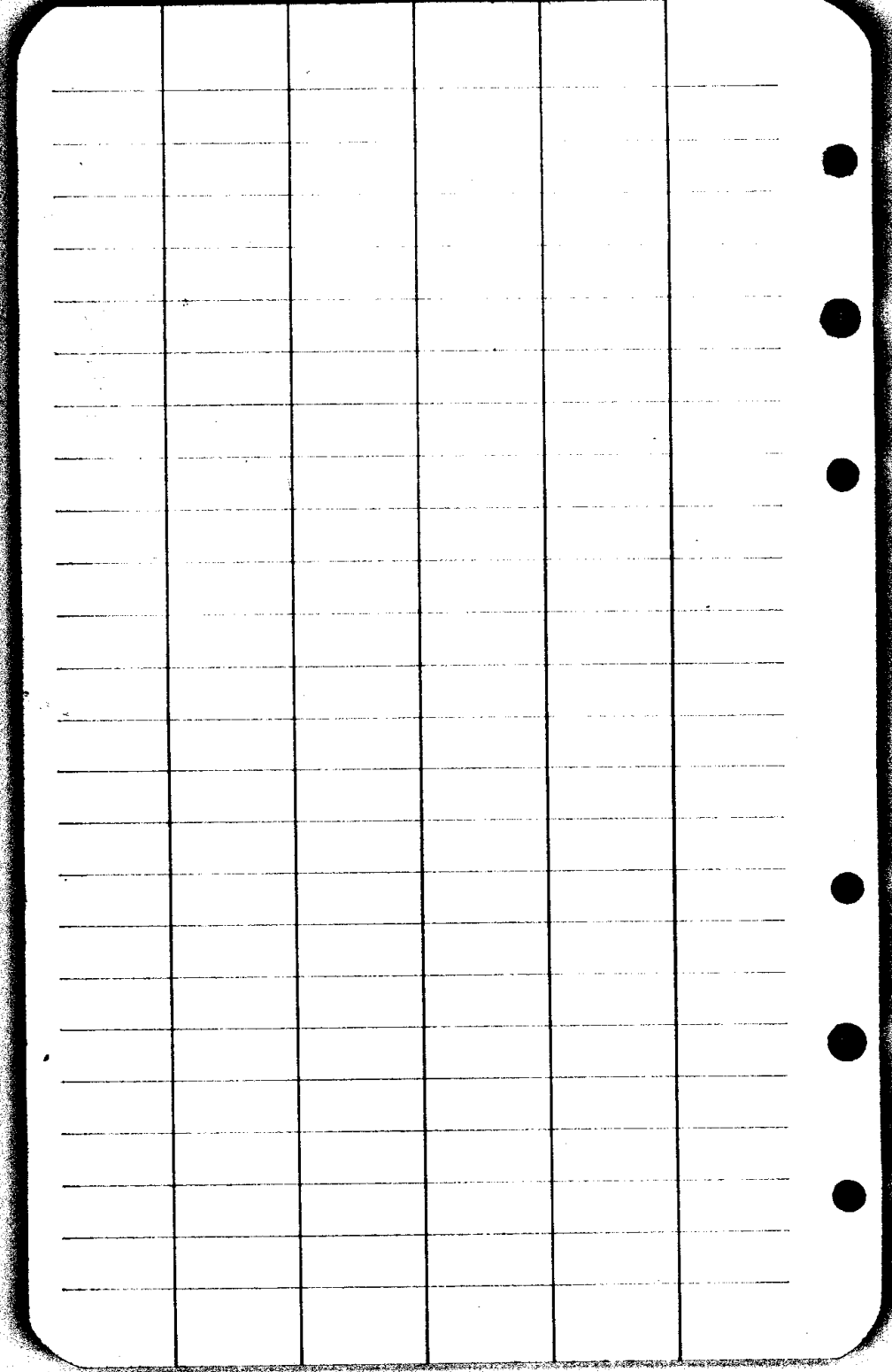

Road

Dominas Lbr. Co.

Sec. 29, T. 25-2W.

M. K. Kershner

W. C. Kershner

Zes Kershner

S. P. No. 32/162

Sta	Dist	Defl	Mag	Mag	Mag
			✓		
	377.5 ✓		N 60° 47' 1/2" E		
		15° 35' L 7° 53' R			
	236 L ✓		N 52° 55' E		
		15° 35' L 8° 25' L		N 55° E	
	135.8 ✓		N 61° 20' E		135° 45'
		12° 50' L 60° 50' R		N 41° E	
	65.2 ✓		N 0° 30' E		100° - 10'
		2° 58' L 1° 29' R		N 1° E	
	187.4 ✓		N 0° 59' W		
		5° 20' L 2° 40' L		N 1° W	191° 2'
	419.7 ✓		N 1° 41' E		192° 5'
				N 1° 45' E	193° 5'
		1° 26' R			
	37.7 ✓			N 0° 15' E	39° 45'
2 Cor. # 29-30			N 0° 15' E		

Office
J. S. Ellis No. 351162

.99870 ✓

77.9 ✓
299.6 ✓

377.5

.99970 ✓

.99897 ✓

5'

10' Right of C of Road

.99922 ✓

10'

Starting Pt. of Road

.98107 ✓

.98079 ✓

.99255 ✓

121.9 ✓
297.8 ✓

419.7

.95222 ✓

Sta	Dist	Defl. & C.C.	M.S.	E.
		✓		
	55'	S 76°32½' E		
10	148 2 ✓	28°55' N N 76°30½' E		
		57°58' 28°55'		
		N 47°31½' E		
		9°33' N		
1	115	N 38°01½' E		
10	400 5 ✓	N 30°50½' E		
9		30°03' E N 60°53½' E		
5		39°21' 19°45' E N 80°34' E		
7		39°33' 19°27' E		

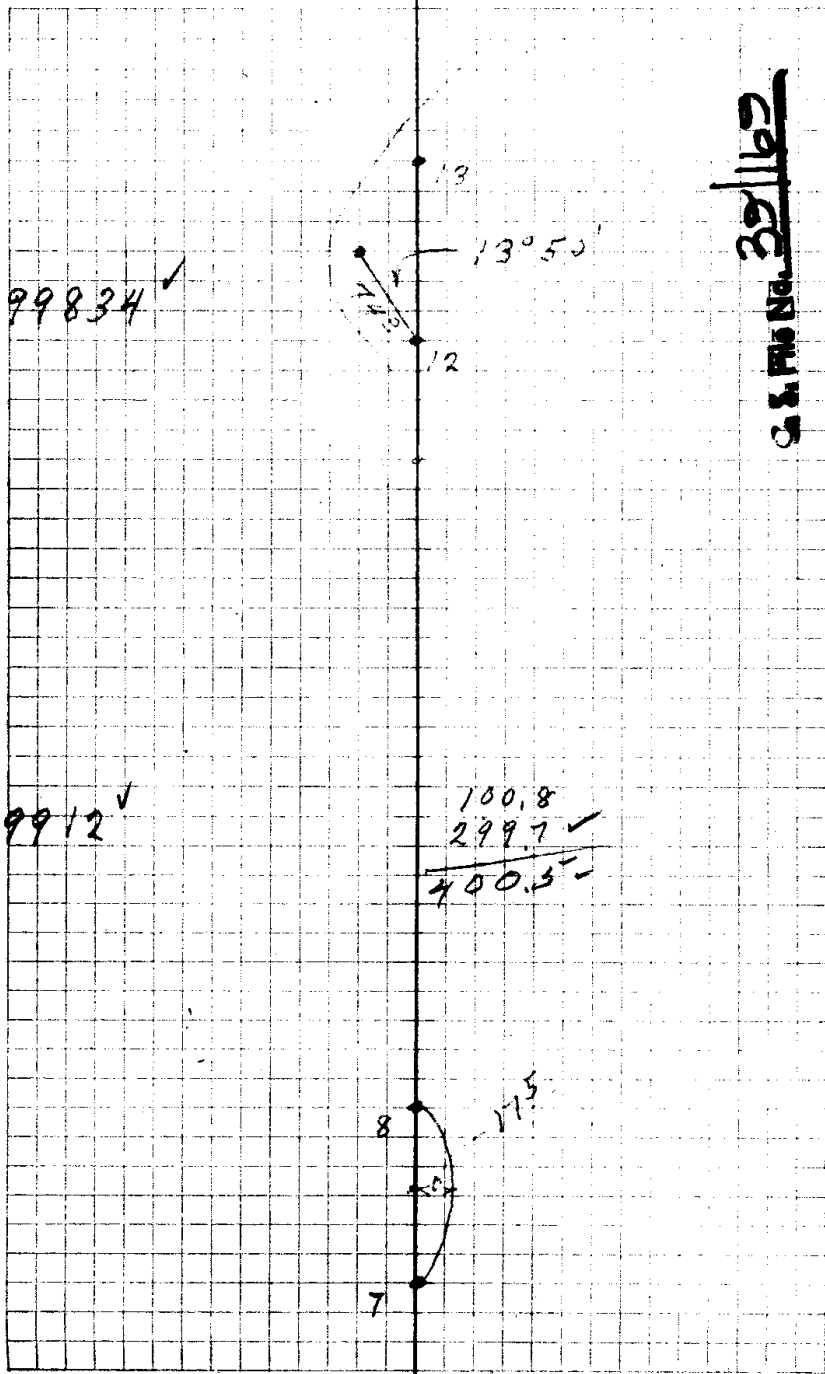

99834 ✓

99912 ✓

100.8
 299.7 ✓
 ———
 400.5 ✓

C. S. PHS No. 32162

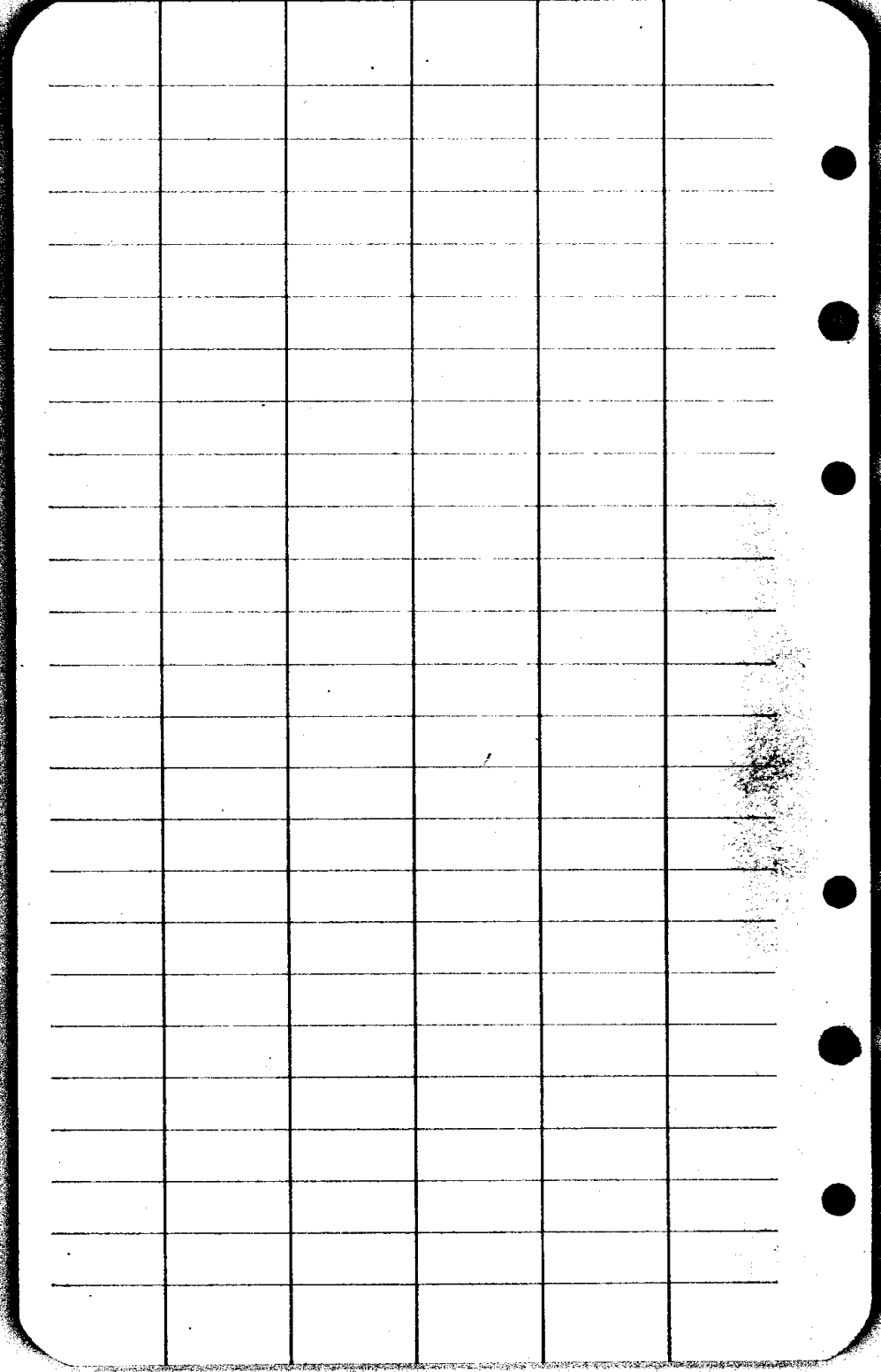

CS FILE FOLDER

CONTAINS

MORE

INFORMATION