

SECTION 19

T29S, R8W

C.D. RAWSON D.L.C. NO 39

J.A. DRYER D.L.C. NO 41

COQUILLE RIVER



UNAMED

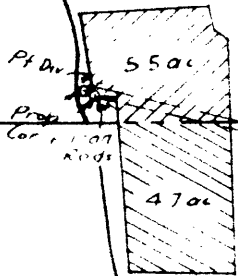

N 76°54' W, 2910.4 (to Point of Diversion)
N 77°31' W, 2884.8 (To Prop. Corner)
South line D.L.C. No 39
North line D.L.C. No 42

S.E. Cor. D.L.C. No. 39
S.W. Cor. D.L.C. No. 41

South line D.L.C. No. 41

A. MARTINDALE D.L.C. NO 42

I, N.E. RICHARDSON, of Roseburg Oregon do hereby certify that this map was made from notes taken during an actual survey made by me on January 5, 1948, that the monuments shown on this map, consisting of Iron Rods at the point of diversion and the south westerly corner of the tract to be irrigated are respectively: N 76°54' W, 2910.4 ft, and N 77°31' W, 2884.8 ft from the Southeast corner of the C.D. Rawson D.L.C. No 39 T29S, R8W W.M.

N.E. Richardson
N.E. Richardson
Deputy County Surveyor

A FEED D.L.C. NO 38

CREEK

MIDDLE FORK

OFFICE OF THE COUNTY SURVEYOR
DOUGLAS COUNTY OREGON
SURVEY FOR WATER RIGHT in SW⁴NW⁴
and NW⁴SW⁴, SECTION 19, T29S, R8W W.M.

BEN B. IRVING COUNTY SURVEYOR
SURVEYED JANUARY 5, 1948, BY
N.E. RICHARDSON DEPUTY
SCALE 8 in. = 1 mile

N.E. Richardson