

Bell Tel Co.

Richardson T

Godfrey HC

Walker RE

Kershner Flag

CS. 39/39

Mon. 6.TI

50
30'
90°

MAIN ST. 246.71

Mon 30'
30'

80.16

HUB

174.33
706.58
89.02

Tack
255.52
28.70

156.54
180.97
103.45

200.26
100.13

JACKSON ST. 114.64

Tack

1" I.P.

179.05
89.05
51.66

130.56

MOSHER

1" I.P.

1" I.P.

50.92
207.36
170.27

1.30
ST.

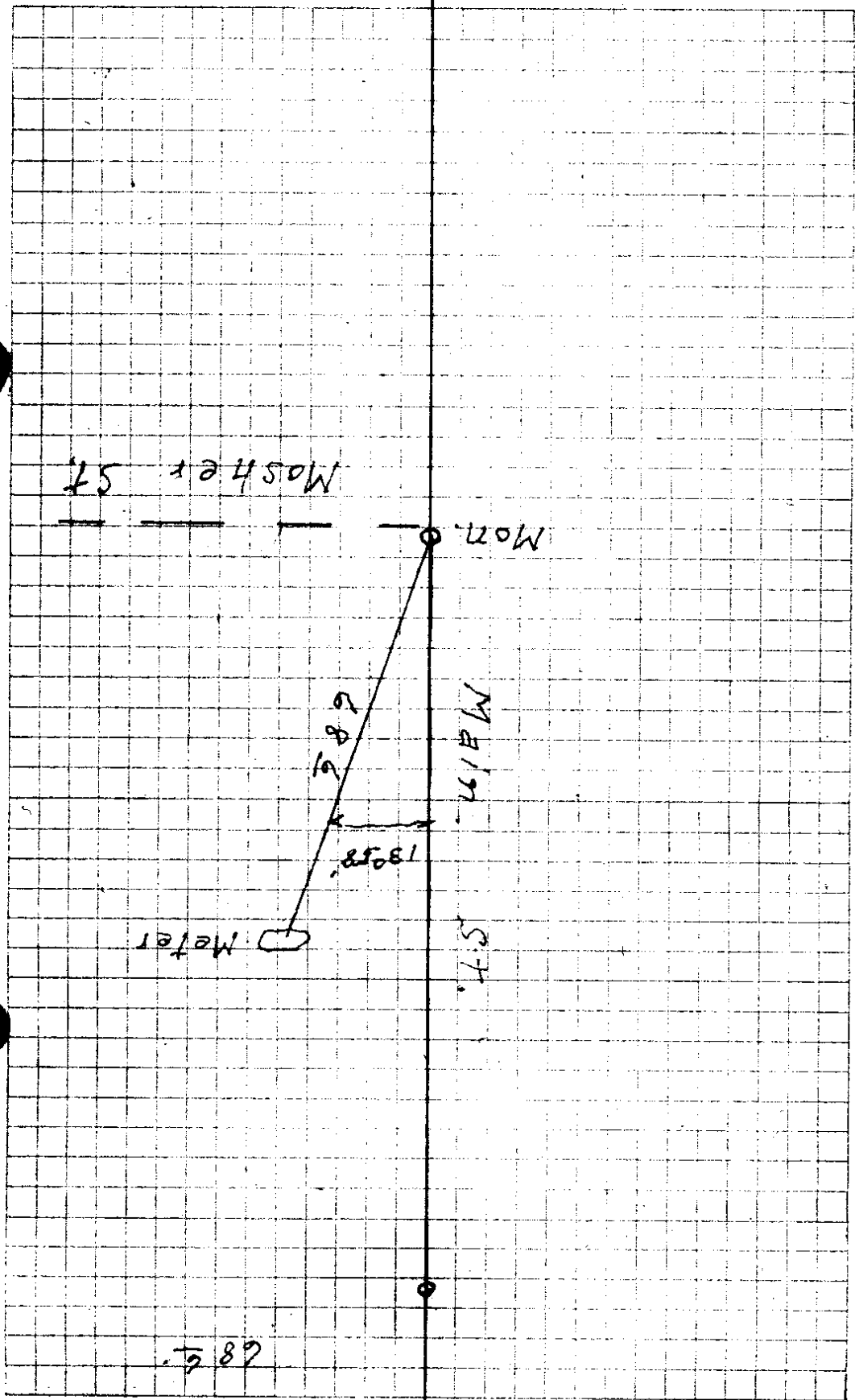

C. S. File No. 30/29

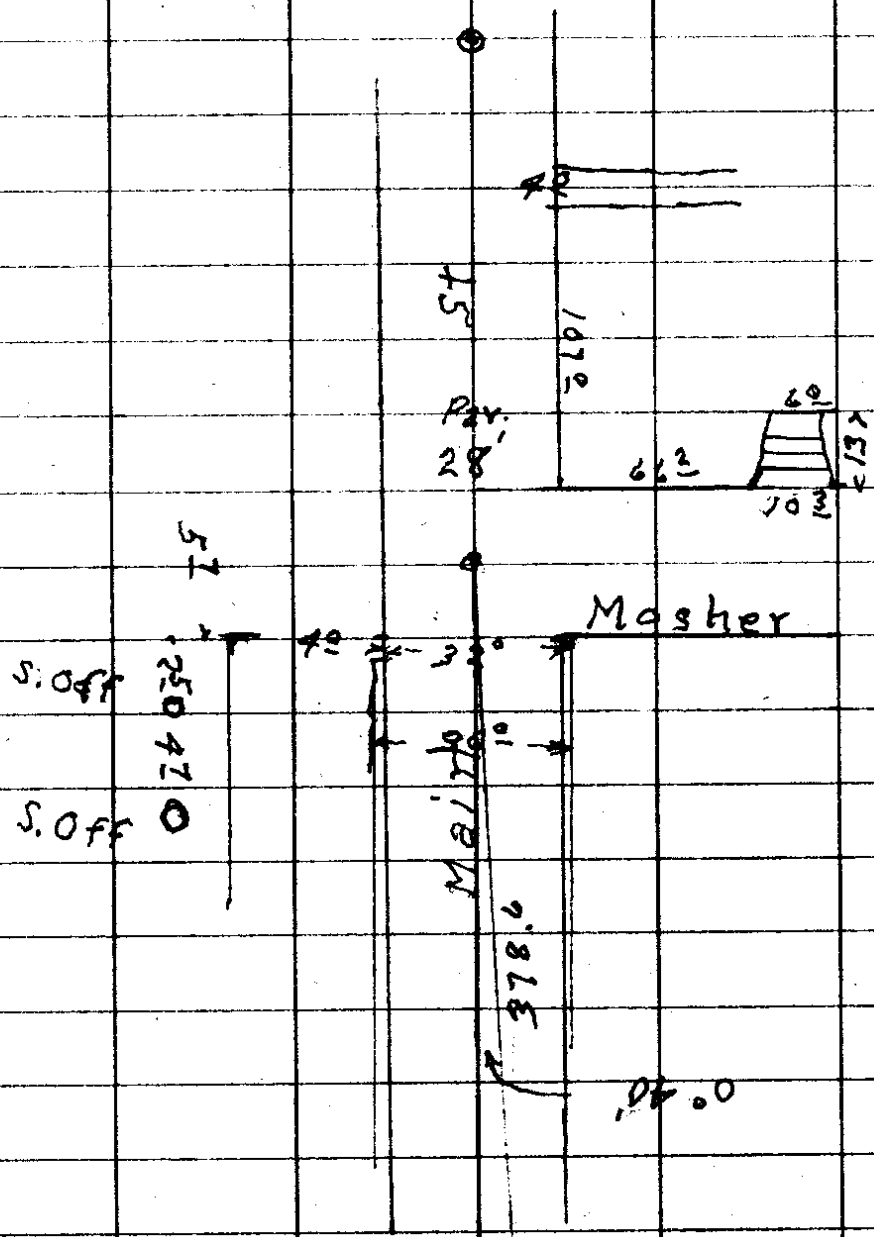

TAP 500.36

TRV. 495.36

M. Hole

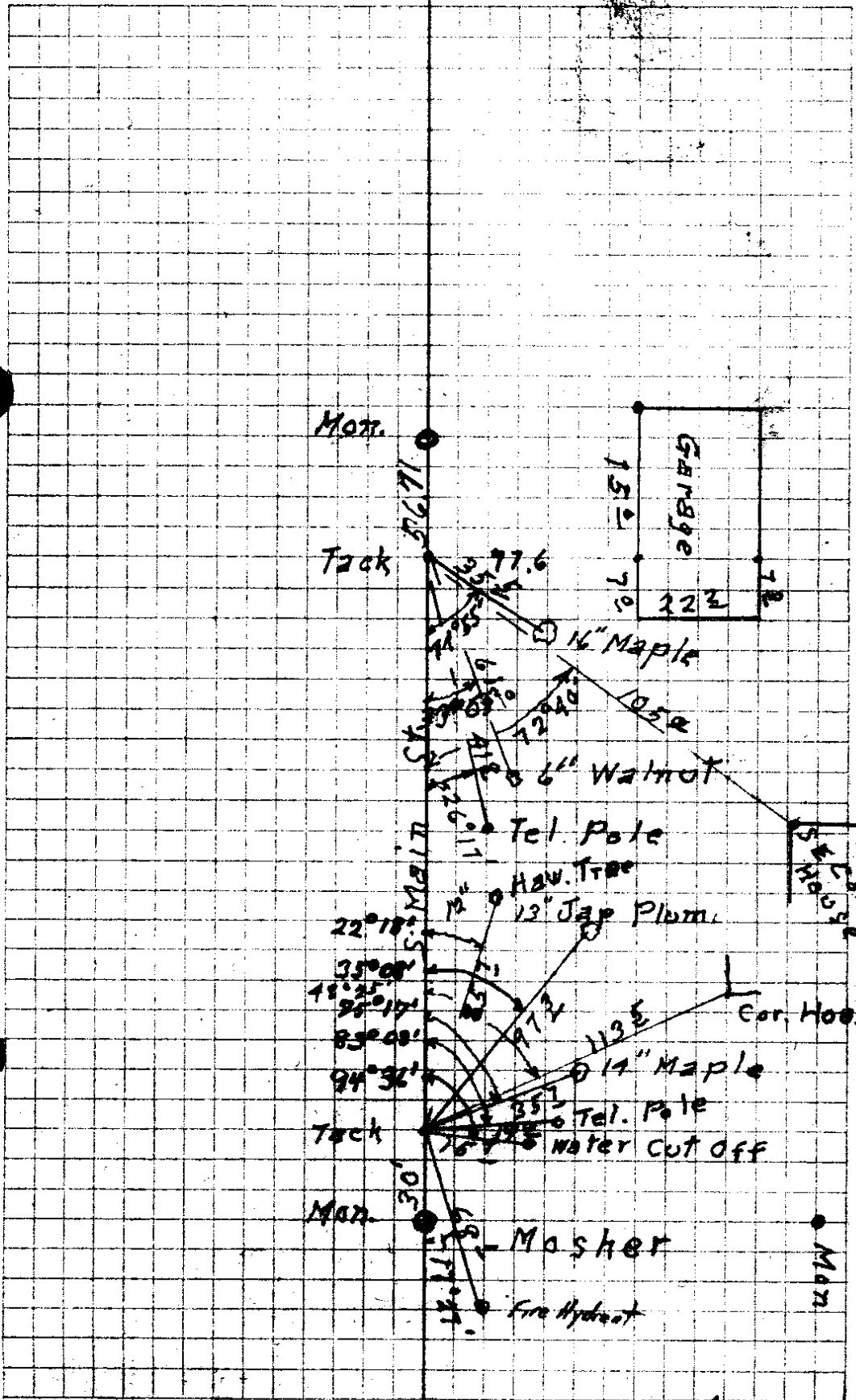

C. S. File No. 39/39

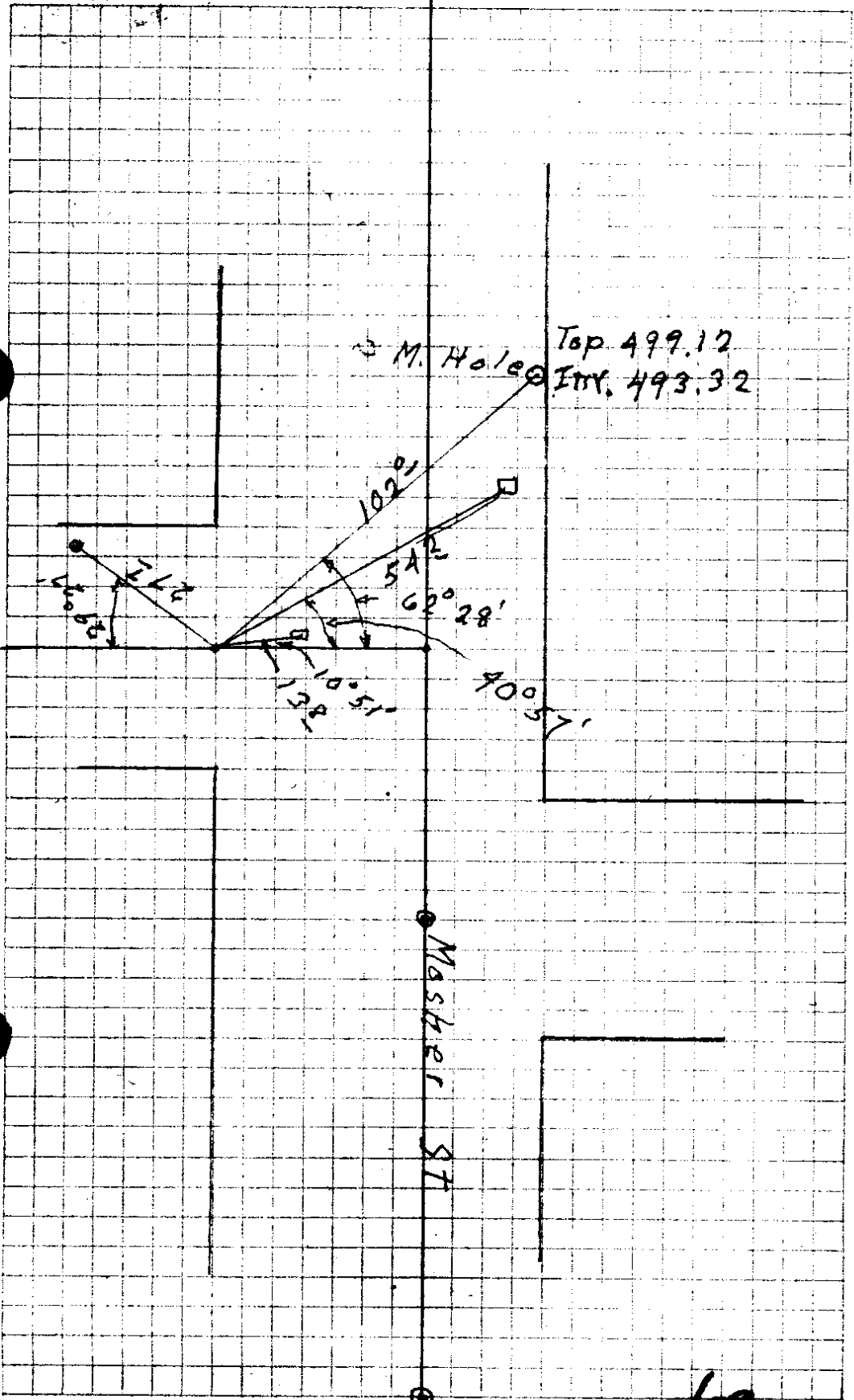

C. S. File No. 59/39

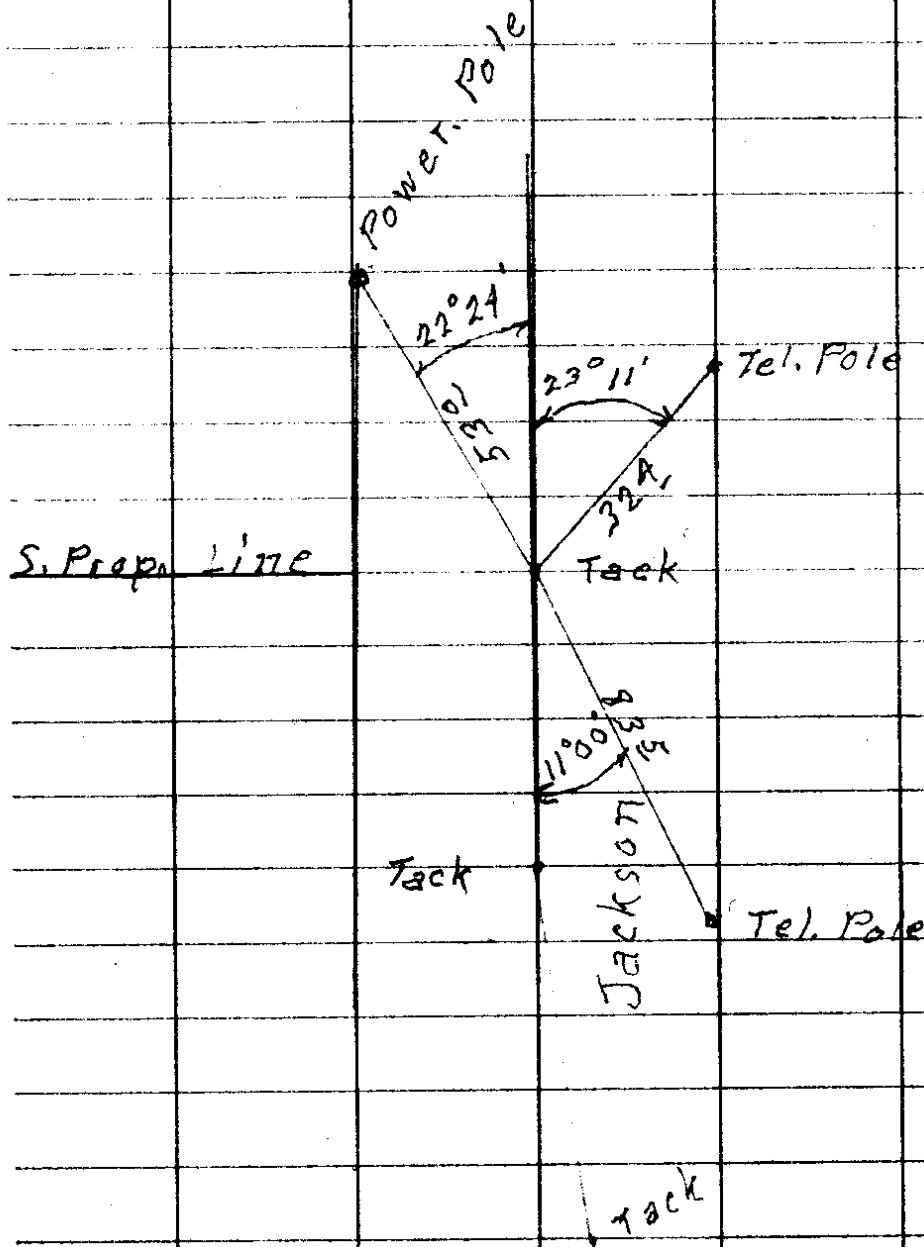

Main & Mosher
NW Cor.

528.35

3.20

525.15

3.31

528.46

11.06

517.40

35.9

520.99

15.66

505.34

8.40

513.74

515.58

7.53

523.11

30

527.81

5.24

528.05

2.18

525.87

5.14

531.01

0.33

530.68

9.23

539.91

11.09

529.82

8.79

537.61

10.10

527.51

0.84

528.35

C. S. File No. 39/39

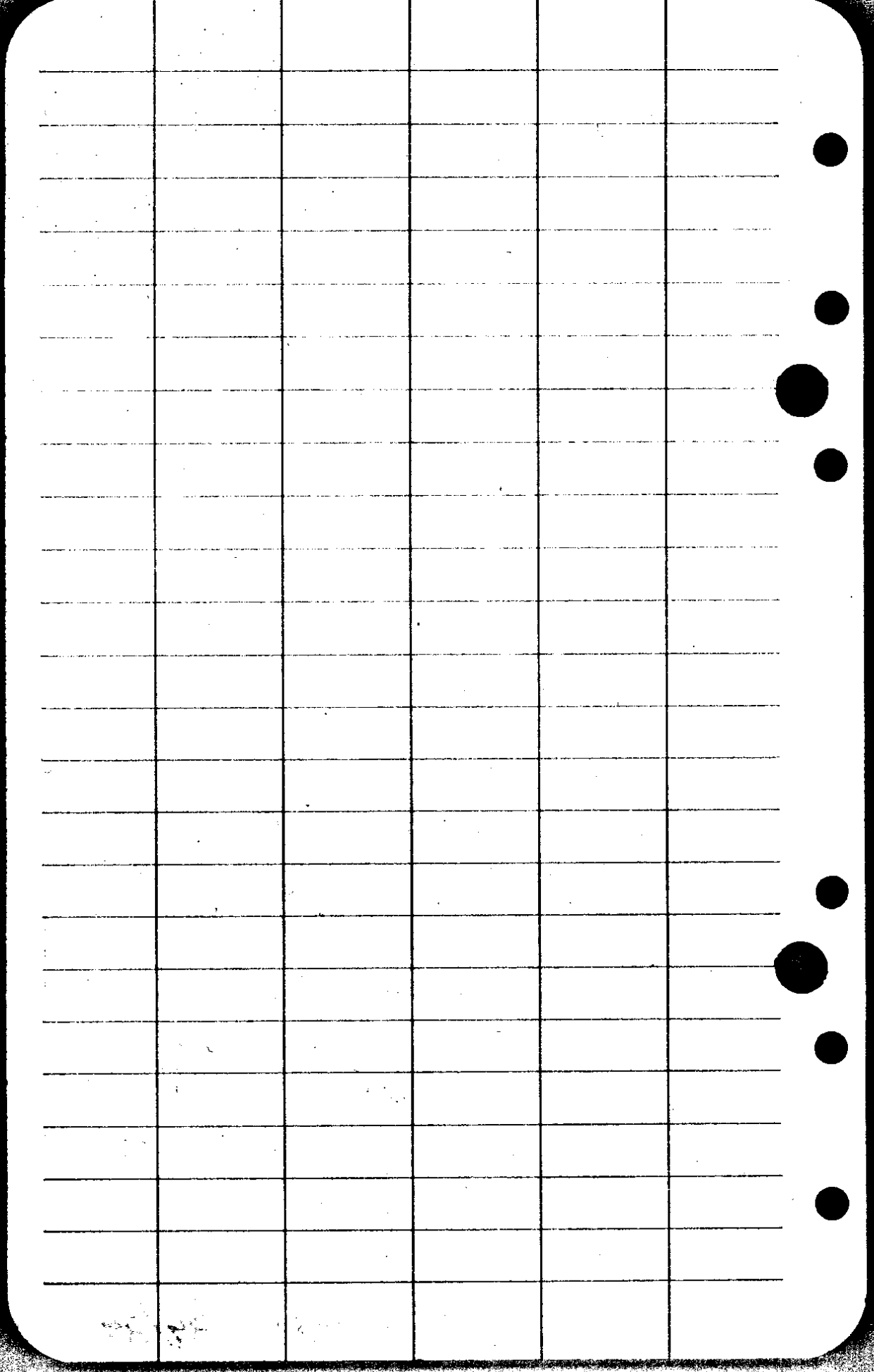

12-20-46

Richardson

Caffrey

Kerstner

N 62° E - S 62° W

Main St.

50°

S 28° W

Jack Young

88

88

N 27° 25' E

50°

con Wall

Fence

C. S. File No.

39/39

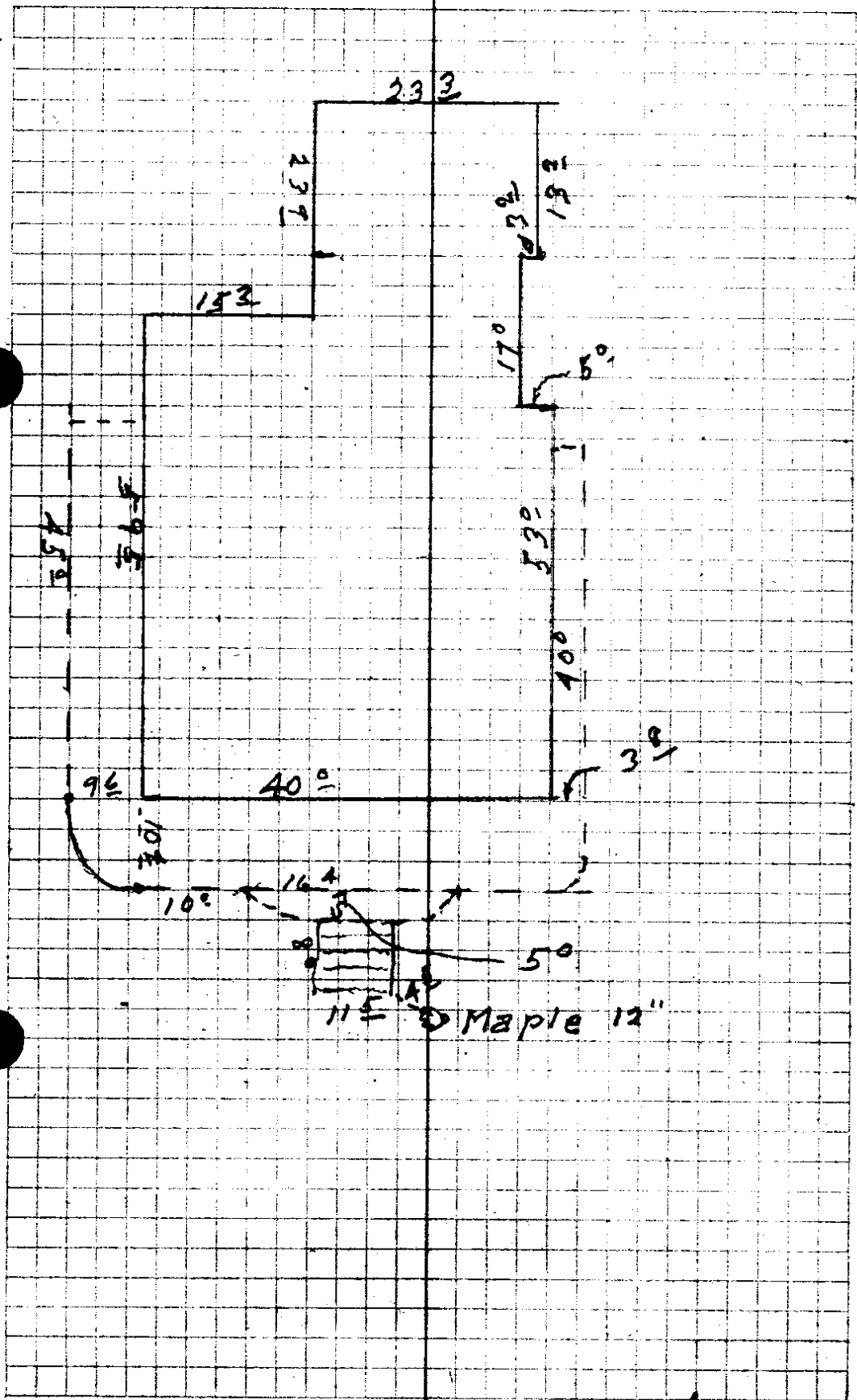

C. S. File No. 39/39

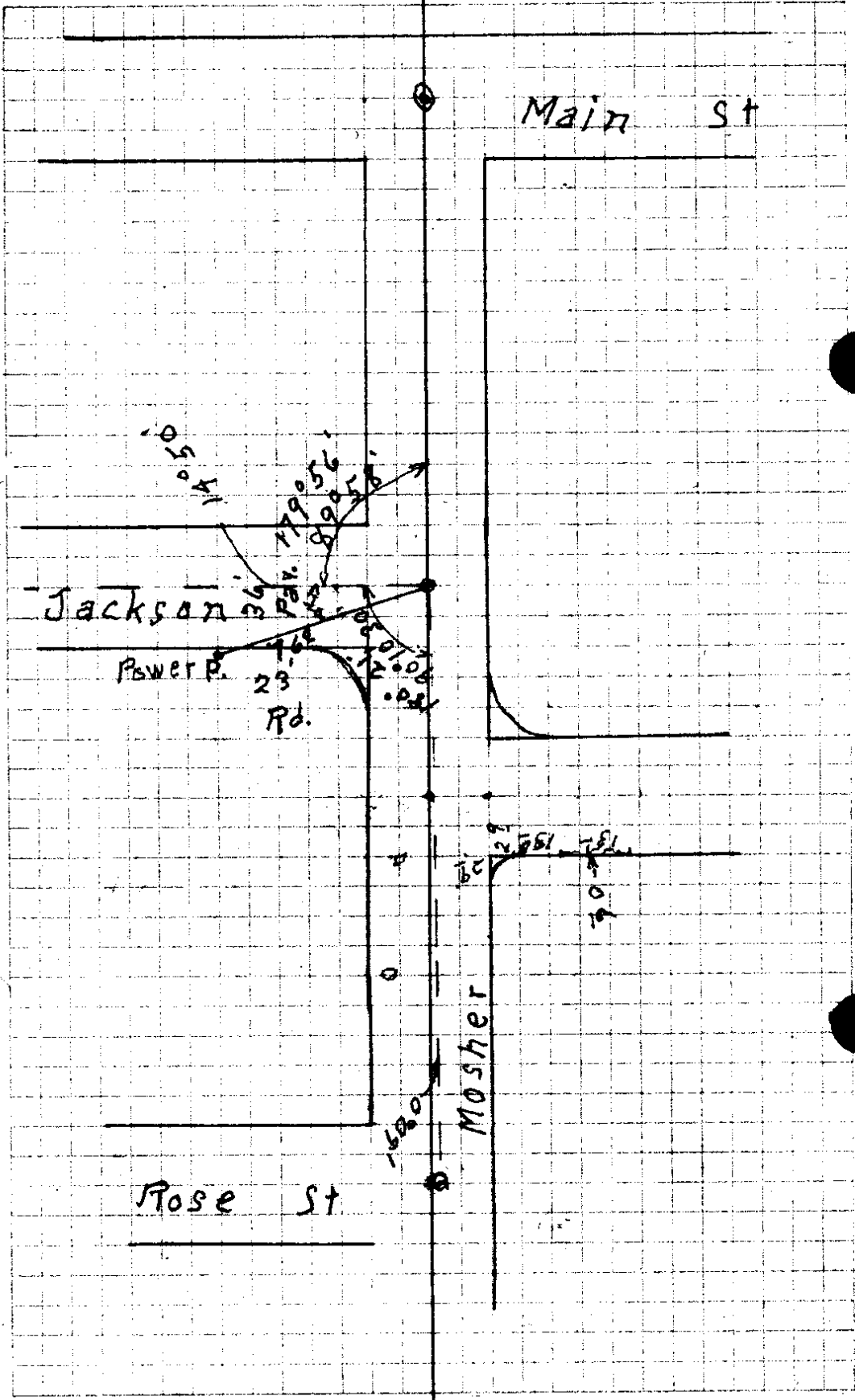

DEED DESCRIPTION

Beginning at an 1" iron pipe on the South line of Mosher St. and from which the Southwest corner of the intersection of Mosher St. and South Main St. bears S 62° 01' E 156.54 ft.

Thence S 29° 20' W 119.47 ft. to a 1½" iron pipe.

Thence S 39° 33' E 72.00 ft. to a 1" iron pipe.

Thence N 62° 00' W 28.75 ft.

Thence N 38° 00' E 193.22 ft.

Thence S 62° 01' E 3.55 ft. to the place of beginning.

BEN B. IRVING
County Surveyor

DEED DESCRIPTION

Beginning at a 1" iron pipe at the Southwest corner of the intersection of South Main and Mosher Streets in Roseburg, Oregon, and from which the monument at the intersection of the centerlines of said streets bears N 73° E 42.4 ft., and the Southeast corner of Block 59 of said city bears N 28° E 60 ft.;

Thence S 28° W 190.0 ft. along the West line of said South Main St. to an "x" chiseled in a concrete driveway.

Thence N 62° W 174.33 ft. to a 1" iron pipe in the easterly line of South Jackson St. in said city;

Thence along the easterly line of South Jackson St. N 39° 33' E 72.0 ft. and N 29° 20' E 119.47 ft. to its intersection with the South line of Mosher St. in said city; as marked by a 1" iron pipe;

Thence S 62° 01' E 166.45 ft. along the south line of Mosher St. to the place of beginning containing 0.70 acres, more or less, in Sec. 19, T 27 S, R 5 W, WM., and in Roseburg, Oregon. .

BEN B. IRVING
County Surveyor

June 26, 1947

Pacific Telephone & Telegraph
Portland, Oregon

Gentlemen:

Attention: Mr. V. H. Dankin

In accordance with instructions received from your Mr. Nichols, I have delivered to your local office 2 prints each of plats officially filed in the office of the County Clerk of Douglas County, Oregon, for the Roseburg and Sutherlin areas.

A list for each set of prints is included with them.

The bill for this printing is attached.

As additional plats are filed, prints will be supplied to your local office.

Very truly yours,

Ben B. Irving

2/29

September 6, 1946

Pacific Telephone and Telegraph Co.
730 SW Oak St.
Portland, Oregon

Gentlemen:

Attention Mr. W. G. Peterson

Under separate cover I am forwarding the original tracing and 1 print of the Young Property at Roseburg as you requested.

I believe that all of the information that you desired has been included. The grades of the streets were not indicated as such because they were rather irregular due to uneven settlement but the elevations to the center of the streets were shown so the information is available on the map.

When Mr. Young informed me that you wanted the original tracing forwarded I was sorry that I had not used tracing linen instead of the paper. I have printed a duplicate transparency for our records however so the information is still available if the paper tracing becomes worn out. A print was given to the Douglas Abstract Co., who are looking up the title of the property for you.

Very truly yours,

Ben B. Irving

3.17.46

mls

April 19, 1947

Whitehouse-Church-Newberry & Roehr,
220 Southwest Stark St.,
Portland 4, Oregon.

Gentlemen:-

In accordance with your request I am attaching hereto a report of conditions found in test pits dug at the site of the proposed new building for the Pacific Telephone and Telegraph Co. at Roseburg, Oregon.

As noted in my telegram to you, we started digging these holes April 12th. They were completed April 15th. Lacking an answer to my wire I dug these holes the full depth and did not use the soil auger. This was probably a good thing as it permitted a closer examination of sub-surface conditions. The digging operations were slower than anticipated as the material was very sticky and difficult to dig. Four men were used to dig these holes.

There are no indication of unusual water conditions at the site.

The test pits have not been filled. They are covered with loose boards. I thought to leave them in this manner for further observation and for inspection by your personnel or by the contractor who builds the structure. Should you desire that they be filled I shall have it accomplished.

Very truly yours,

Ben. B. Irving.

39/29

REPORT ON UNDERGROUND CONDITIONS AS SHOWN
BY TEST PITS AT THE
PROPOSED LOCATION OF THE NEW
BUILDING FOR THE PACIFIC TELEPHONE AND TELEGRAPH CO.
AT ROSEBURG, OREGON.

The top soil over the area to be occupied by the proposed new building for the Pacific Telephone and Telegraph Co. at Roseburg, Oregon, is known locally as "black mud". This is a "dobe" like material and composed of very fine black particles. When dry it tends to cement together in small irregular lumps or large chunks. When dry it can be picked and handled quite well. When wet or saturated it may be handled by spading and is a homogenous mass. When between these conditions it is very sticky and very difficult to handle.

This black mud is a very poor foundation material as it swells when wet and shrinks when dry. By its movement under varying conditions of moisture, it breaks building foundations and warps any structures built thereon. It should all be removed from the building area and from under any paved areas. If not removed from paved areas a crushed rock or gravel cushion should be laid between the black mud and the paving.

The black mud is underlaid with a yellow clay, residue from a decaying or disintegrating shale. This clay is very fine at the top but as it is penetrated has an increasing amount of fine to coarse shale rock fragments. As the number and size of these fragments increase, the amount

residual clay decreases. The shale fragments increase in size to one half to one cubic foot in size packed very tightly together.

In hole No. 1 some three or four of these larger size fragments were found and not exceeding one half cubic foot in size.

In Hole No. 2 none of this larger material was found.

In Hole No. 3 reached a layer of these larger fragments very tightly interlocked though a bar could be churned between them in a couple of soft spots.

Test pits dug in other locations in this vicinity, penetrating similar formations have reached a hard blue sedimentary rock. None of this material was found in these pits.

Water Conditions

When first dug no water was noted in Hole No. 1, though there was some in the hole the next day after digging was complete.

In hole No. 2 a small seepage was noted at about 6.0 ft. Over night the water would stand about three ft. deep.

No water was noted in hole No. 3 during the digging operations. An inspection some three days later disclosed some water in the bottom. Probably this was due to a storm which during the interval between inspections.

A 4" sewer line was found in Hole No. 3 running west from the old residence now occupying the site to the sewer on South Jackson St.

A box containing various samples of these materials is being sent for your examination.

**TEST PITS
PROPOSED
BUILDING SITE
PACIFIC TELEPHONE & TELEGRAPH CO.
ROSEBURG OREGON.**

Test Pits

No 1 No 2 No 3

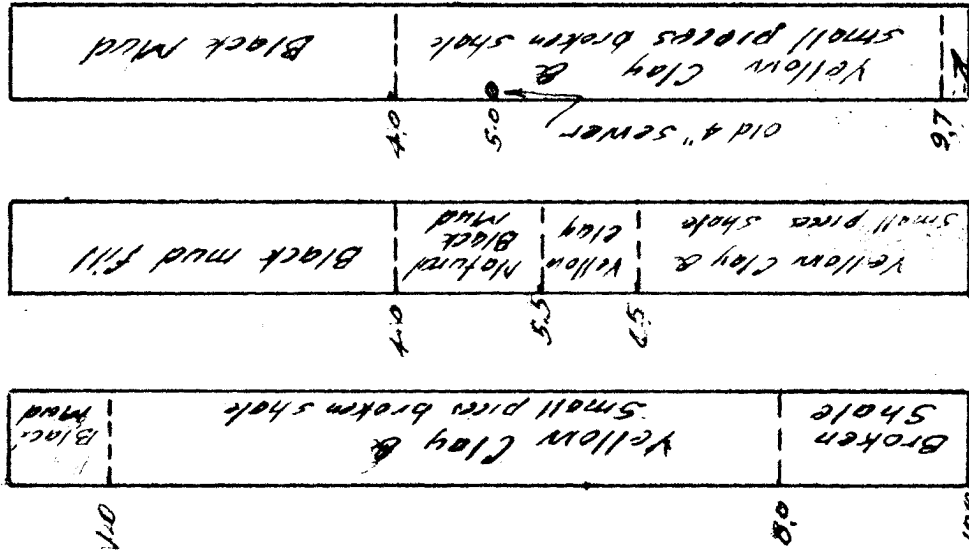

Large chunks shale

Scale 1" = 2'



WHITEHOUSE CHURCH-NEWBERRY-&-ROEHR
ARCHITECTS-320-SOUTHWEST-STARK-STREET
PORTLAND-4-OREGON-TELEPHONE-AT-1557

April 8, 1947

Mr. Ben B. Irving
County Surveyor
Roseburg, Oregon

Dear Sir:

We have been retained by the Pacific Telephone and Telegraph Co. to prepare plans for a new exchange to be located on the S. E. corner of Moser and Jackson St., Roseburg, Oregon.

As you prepared the survey for this property, we would like to know if you could dig some test pits for us in order that we can determine the soil bearing value for the footing.

We would like to have 3 pits dug as noted on the enclosed sketch with a log and samples from each pit.

Please let us know if you can do this work for us and when the information would be available.

Very truly yours,

WHITEHOUSE CHURCH NEWBERRY & ROEHR

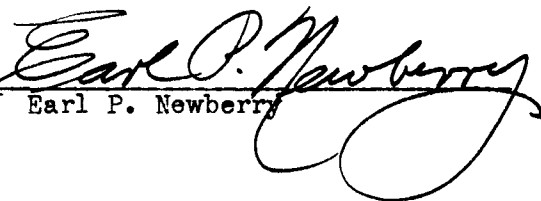
By 
Earl P. Newberry

EPN:am
Enc. 1

C. S. File No. 39/39

CS FILE FOLDER

CONTAINS

MORE

INFORMATION