

LAND DESCRIPTION

Beginning at a point marked by a $\frac{1}{2}$ " x $\frac{1}{8}$ " iron pipe from which the $\frac{1}{4}$ section corner between sections 2 and 11 T 26 S., R 3 W., WM., bears N 0°01'E 1786.2 ft.;

Thence S 89°59'E 175.2 ft. to an auto axle;

Thence S 0°01'W 97 ft. to the center of the county road;

Thence S 65°11'W 190 ft along the center of the county road to an iron belt;

Thence N 0°01'E 178.8 ft. to the place of beginning excepting therefrom that part of the above description lying within the right of way of the said county road, also excepting a strip of land 4 ft. wide across said tract in a northerly and southerly direction for a pipeline ~~xxxxxxxxxxxx~~ right of way as now constructed and existing; containing 0.42 acres more or less in said section 11, T 26 S., R 3 W., WM., and in Douglas County Oregon.

NOTE: This description was prepared from information contained in records of surveys made at various times and filed in the office of the County Surveyor of Douglas County Oregon and certain additional information supplied by Mrs Jessie Wallace for whom this description was made. No field survey was made.

October 30, 1946.

Ben. B. Irving
County Surveyor.

C.S. 37/128

←

Chas Cole

LINE

→

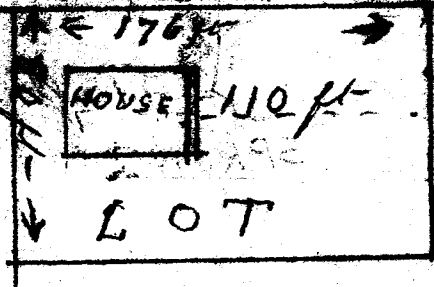

448 ft

SPRING

912 ft 6 in. LINE

Earl Vosburgh

448
 - 912

 1360

all measurements on Land Surface

G. S. File No. 37/28

Mrs. Jessie Wallace - Adleyd Park.

See File 37-168

- Deed description - mail

Beginning at a point marked by a 1/2" by 48" iron pipe, from which the 1/4 section corner between sections 2 & 11 in Township 26 South, Range 3 east of 2d. ~~the~~ Meridian bears N 0° 01' E. 1786.2 feet;

thence S 89° 59' E 175.2 feet to a point, marked by an auto axle;

thence S 0° 01' W 97° feet to a point in the center of the county road;

thence ~~S~~ 65° 11' ~~E~~ 190° feet along center of said county road to an iron bolt;

thence N 0° 01' E 178.8 feet to the place of beginning,

4 ft wide

Except - a right of way for a pipeline across said property in a northerly & southerly direction as it is now constructed &

also accepting ~~that~~ portion of the tract above described lying within the boundaries of the county road.

97°

$$\begin{array}{r} 178 \\ + 97 \\ \hline 275 \end{array}$$

$$\frac{137.5 \times 175.2 - 30 \times 190}{43560} = 422$$

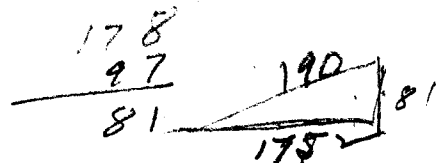

$$178 \times 81 = 14622$$

lot 50 1/2
N 65° 11' E

$$\begin{array}{r} 175.2 \\ \times 190 \\ \hline 33288 \\ 90766 \end{array}$$

