

N 89° 15' W 4356 els.

Mill St.

SW Cor DLC 60

W 1/2 Sec 3
T 11 N R 10 E

W 1/2 Sec 3
T 11 N R 10 E

Stephen

W 1/2 Sec 3
T 11 N R 10 E

306

So Mill

311

Douglas St.

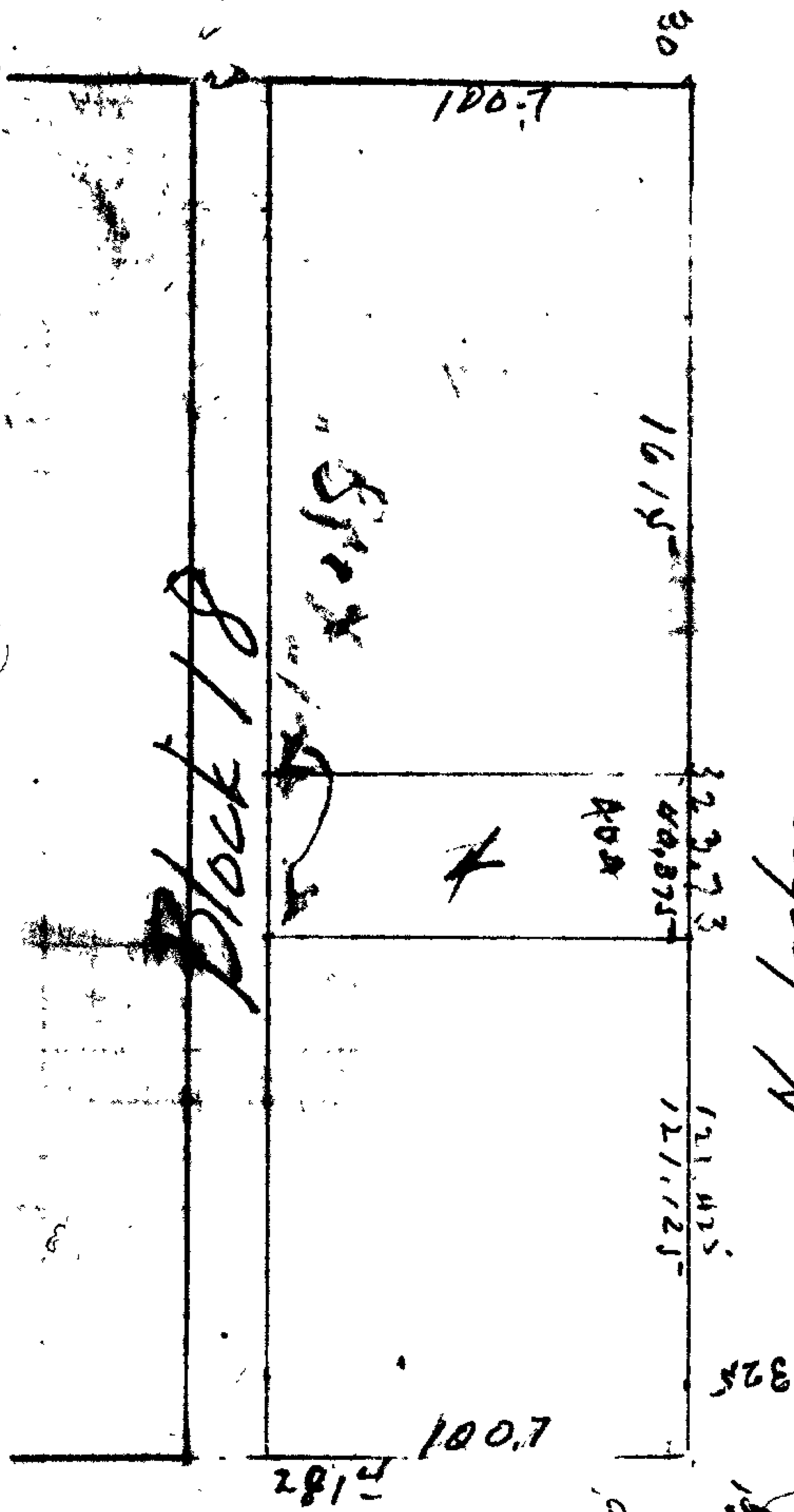

40.375

Washington St.

~~37/108~~

a.s. 37/108

Sta

Dist

L

cc

MC

Slope

Spr.

~~all wellbore
capped & resealed~~

6312

N 160° 11' W

N 78° 1' SW

169

18° 1'

70

level

300

18° 9'

122

18° 9'

Hub

N 50° 25' E
22° 43' R

121 1/2

N 39° W

1/4 Sec Cor

Jan 8 1927
BBI T
RLI HC.
LGMoxley RC.

