

37/35

C. S. File No. ~~32/25~~

20

10

20

35.00

24.50

10.50

160.00

30

24.50

5.50

Feb 28

Bill

7.50

Bob

7.50

15.00

35.50

15.

20.50

Jan 28 on lunch line

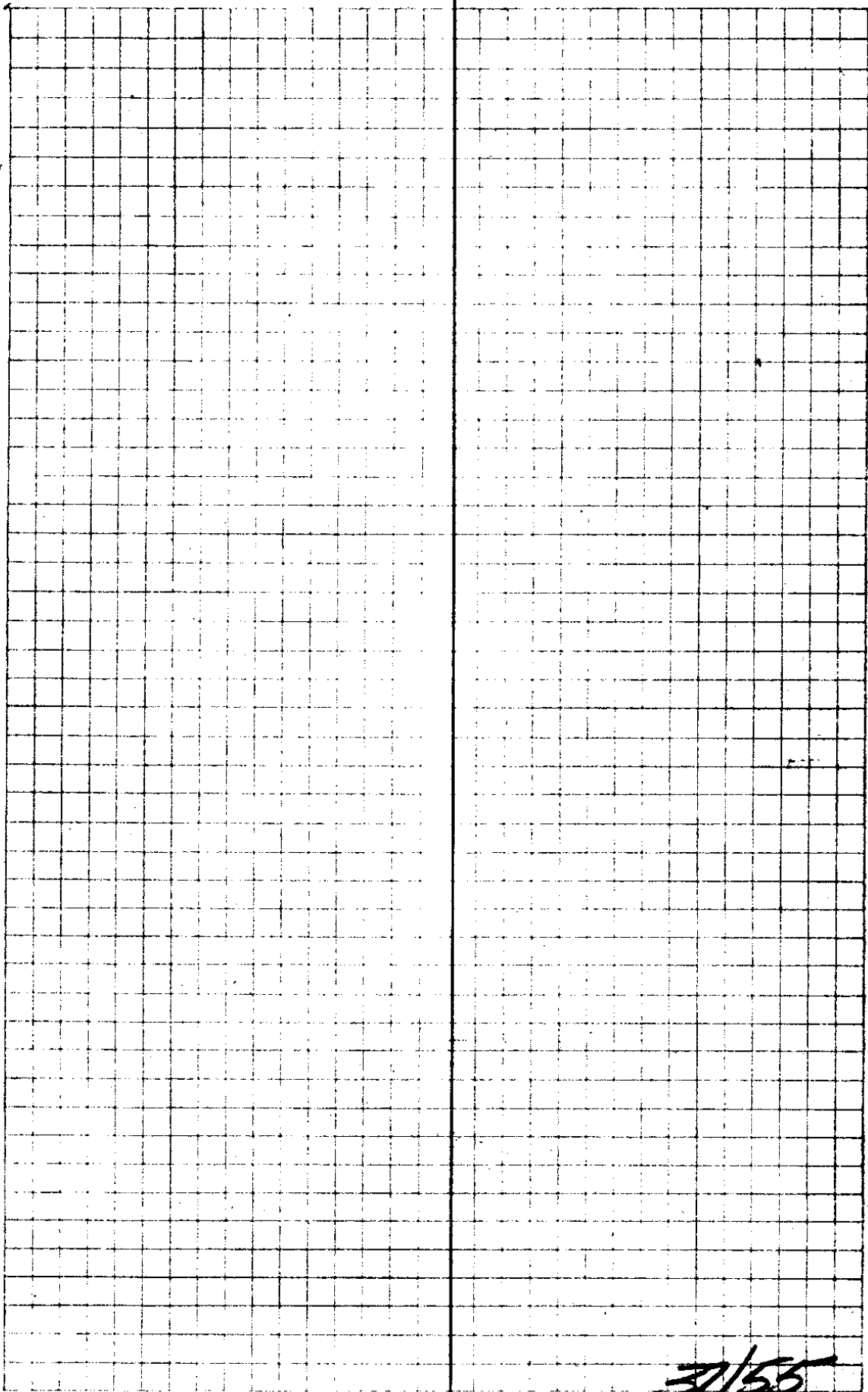

3/55

C. S. File No. ~~2015~~

Hub.	Cow Dist	Cree L	Irrigation CL	Ditch MC
	1461 ⁹			
1946 ¹ 7	1055		N 44° 0' W	N 44° W
1856 ⁴ 6	3512	31° 25' R	N 75° 25' W	
10404 ⁷ 5	2164	58° 47' L	N 16° 38' W	
888 ³ 4	2952	29° 2' R	N 45° 40' W	
493 ¹ 3	175	47° 52' R	586° 28' W	
3418 ¹ 2	225	24° 24' L	N 69° 8' W	
0493 ⁰ 1	930	9° 22' R	N 78° 30' W	N 78 3/4 W
End of Dam				
			Mag. Var. - 21° E	

Apr. 6 1928

Living T

R.L. T H.C.

Garrett R.C.

C.D. Garrett

Jacques } A.R.

Turnover line fence
at head of ditch 7

Ditch 30' L.

x 7

cross ditch
6

15' ahead of hub L

Bdy over ditch
25' R

50' ahead of hub on
line 5-6
Ditch 5' R
Break in ditch
Row Creek 15' left

5
25' R
25' R
25' R

20' old
drain
20' R
at Road Bdy.
Legs of an
15' ditch to River

x 15

x 15

Plus 100
Ditch 20' R.

37/55

Hub	Dist	L	CC	M.C.
34+27 ⁰ 17	445 1048		✓	
33+22 ⁵ 16	929	25°39' L	S 57°26' W	
32+29 ⁶ 15	225 ³	16°1' L	S 83°5' W	
30+24 ³ 14	274.2	0°22' R	N 80°54' W	
27+29 ⁶ 13	124 ²	17°37' R	N 81°16' W	
26+20 ⁵ 12	248 ⁸	15°46' L	S 81°9' W	S 81° W
23+26 ⁶ 11	181 ⁵	10°4' L	N 83°7' W	
21+27 ⁵ 10	112 ³	13°11' L	N 73°3' W	
20+28 ⁹ 9	3639	1°23' R	N 59°52' W	
16+28 ² 8	237 ⁰	8°9' R	N 61°15' W	
14+26 ² 7		25°24' L	N 69°24' W	N 69° W
	1965 ⁴		N 44° W	

Ditch 7' Lt

Ditch 6' Rt

Ditch 8' Rt

cross Ditch 103 back of Hub 15

Creek 12' ahead Hub 14 Ditch 20' Lt

Box of 13-10' Lt to
out edge of Box

3.7 x 3.6 x 7.75 long



Ditch 10' Lt

Ditch 12' Lt

Ditch 4' Rt

Ditch 10' Rt
5' back
erk from it

Cross ditch halfway between hubs
Pac. R.W. Fence 7' Ahead
Ditch 7' Rt MP 246 7' back + 2' Rt

Ditch 5' Rt of probable point of Direction

7 # 181 to ditch

37/58

Hub.	Dist	L	CC	MC
50+00 Turner's Bldg Fence				
46+59.5	25	340 ⁵	79°0' L	S 20° 21' E
44+58.5	24	206 ⁰	14° 4' R	S 58° 39' W
43+68.8	23	89 ⁷	45° 55' R	S 72° 43' W
42+52.7	22	116 ¹	10° 55' L	S 26° 48' W
39+52.3	21	298 ⁰	48° 27' L	S 37° 43' W
38+75.1	20	74 ⁶	18° 17' R	S 86° 10' W
37+98.0	19	77 ¹	50° 24' R	S 67° 53' W
36+19.0	18	179 ⁰	30° 10' L	S 17° 29' W
34+27.3	17	191 ²	9° 47' L	S 47° 39' W S 47 1/2 W
				S 57° 26' W

1372
58

292
485
346

15'-20"

20/150

3/4 ft / Sec.

10" deep

24 ft - 36 ft

at Feb. 18

5' x 45' x 7' long

This line down ditch Box 485 from Hub 25

Culvert 3' high x 5' covered

On end of Culvert 6' from end 1' RT of center ditch.

485
595
110

Ditch 5' RT

Ditch 5' RT

Ditch 7' RT

Ditch 5' RT

Cross Ditch 2 times this dist. Line touches N bank

Ditch 10' RT

Ditch 7' RT

30/65

Diversion pt for Mr Turner.
right at end of collect

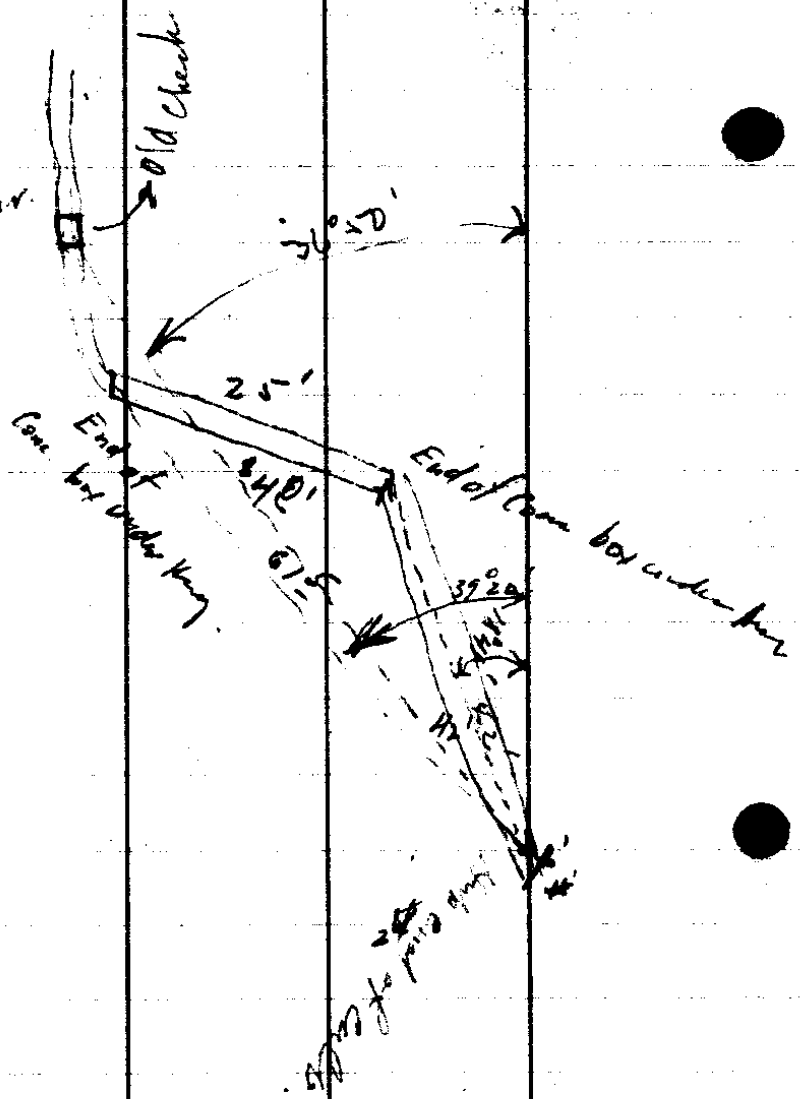

~~30 27
1.0 0
1.0 0~~

The page contains a large grid of graph paper. A vertical line runs down the center of the grid, dividing it into two equal halves. The grid is composed of small squares, with the vertical line acting as a central axis.

C. S. File No. ~~31/55~~

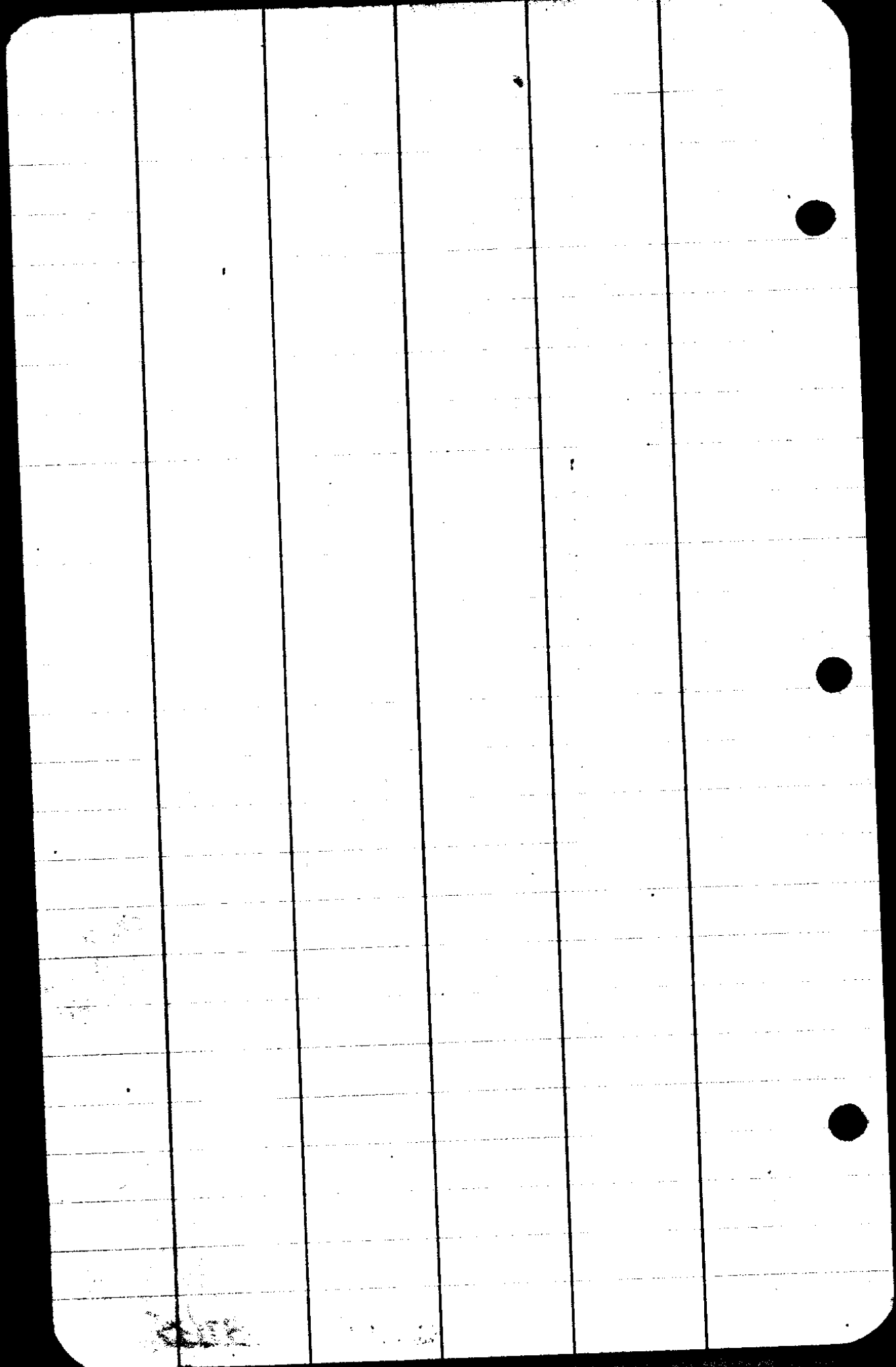

Levels

B.M. + HI - Elev. 500.00 Assumed

5.067 ~~502.047~~

9.46 495.61
 6.279 498.28
 8.47 496.60
 8.46 496.61
 8.77 496.30
 7.20 497.87
 6.579 498.48

T.P. 1 6.030 502.149

8.948 496.119
 3.63 498.52
 5.48 496.67
 4.88 497.27
 4.31 497.84
 3.61 498.54

T.P. 2 6.987 506.114

3.022 499.127
 9.91 496.14
 5.43 500.68
 4.54 501.57
 4.20 501.91
 5.21 500.90
 7.70 498.91
 7.76 498.35

S. end of Culv under Hwy. ⁵⁷⁰⁷ ~~Bottom of~~
Bottom Floor of Culv

Bottom of diversion box
Bottom of box containing Check for diversion
Lower diversion box Floor
Ditch along side below
Outlet above diversion box

On small bench. Lower edge
Diversion point under Hwy 19 + 20

Lower pt of field opp. Hwy 20
Bottom of Ditch between 19 + 20
Point in field

80.67
96.40

15.73

In Slough
High point between slough + ditch
In furrow next to ditch. Stake mtd 13 cut
Stake in furrow mtd 12 1/2 cut off outlet box
Floor of outlet box
Bottom of Check box at 64 ahead of 13
" " Ditch

	+	H1	-	Elev
TP 2	7169	506.296		499.127
TP 3	22949	506.110	3.135	503.161
			5.27	498.326
				500.84
				501.85
			6.02	500.09
				501.22
			6.65	499.46
				499.21
			8.66	497.45
				501.24
			6.63	499.48
				501.30
			6.57	499.54
				501.02
			6.853	499.26
				501.369
T.P. 4	482	504.191 504.152	6.506	499.610
				501.66
			4.90	499.53
				500.07
			7.12	497.31
				504.473
TP 5	3.935	508.408 506.649	1.718	502.714
				500.79
			7.032	498.62
				505.297
TP 6	6.810	512.107 510.348	3.111	503.538
				500.671
			11.436	498.912
				500.364
			11.843	498.505
				501.978
			10.029	500.219

Correct these elevations according to readings next page, add 17.79 to all elev.

see 34
 1000
 2500
 1000

500
 59

98.5
 97.2
 9
 9
 100

Floor of Lake under Hwy 25 x 50
 End stake in field mid cut
 Stake next to ditch old grade at Hub 8
 Bottom of ditch
 Low pt in ditch bank 21' back of hub 8
 " 24 paces back of Hub 8
 " 34 paces " " "

Low pt in bank 12' from Hub 6
 Bottom of Ditch above old Co Road Hwy at Hub 6

Dam in old channel under bridge old Co Road

Ditch Bottom below dam 152 ft
 " " 2" " 20'
 Top of Dam

9067
 9141
 1.66

37/65
 2/25

TP 3.

506.110

4567

506.543

TP 3

4567

507.728

503.164

8.627

~~479.101~~
~~502.050~~

TP 4

6.359

501.369

9.402

498.326

Bottom of Ditch

501.367

Floor of Culi

499.610

1.757

599.161

497.45

1.65

99.1

98.3

9

37/55

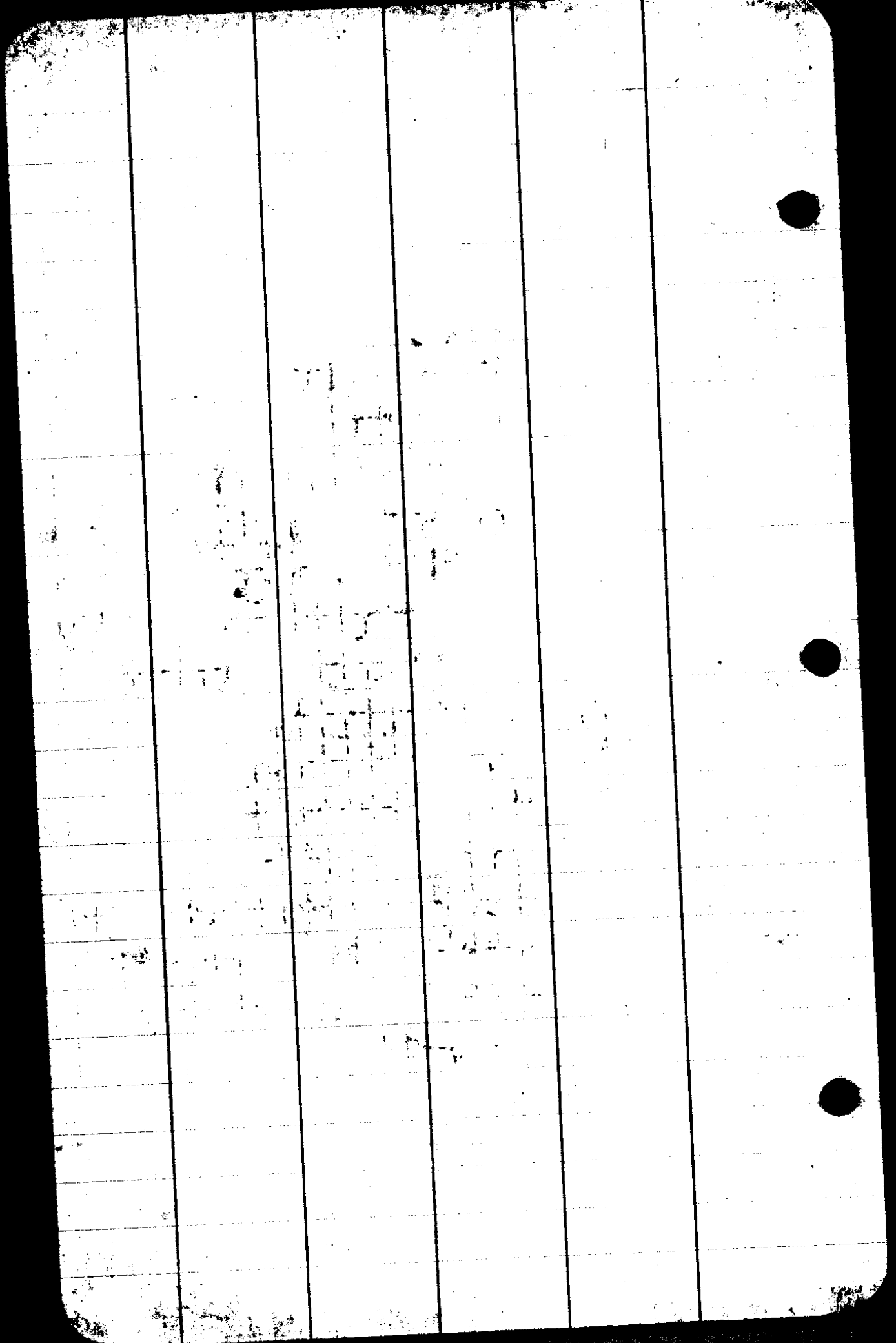

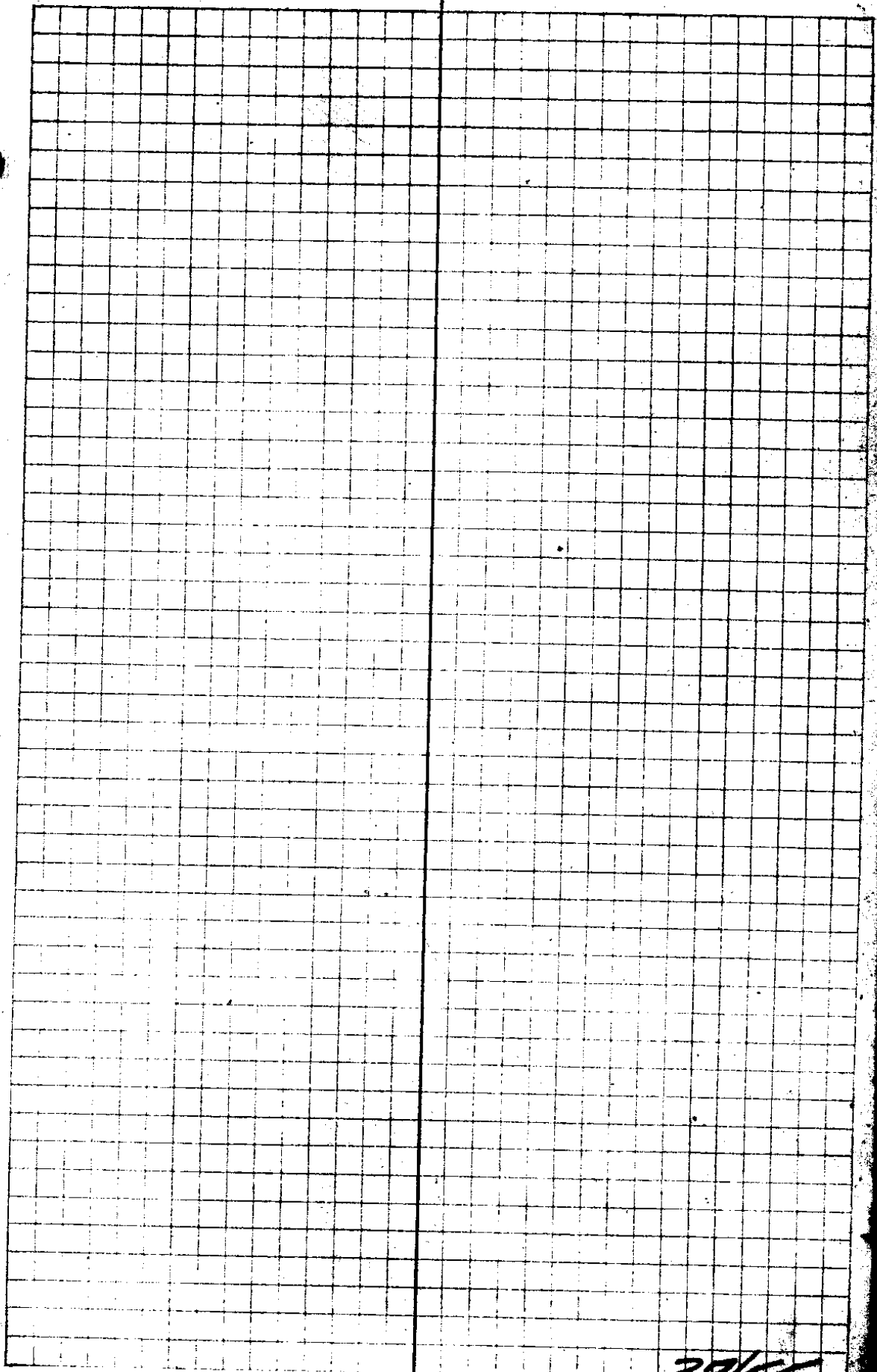

C. S. File No. *39/55*

Corners to Turn in

T 30 R 4

✓ SW + SE of C 44

(2)

T 26 R 2

✓ Sec. Cor. 10-11-14 & 15

" " 2-3-10-11

(2)

T 29 R 8

N 1/4 Cor. Sec. 20

SW Cor. C1 - Dyer

NE Cor. C1-42. Martindale

E 1/4 Sec. Cor.