

Sept, 29-1941

20 Wash. St.
 258
 47/425

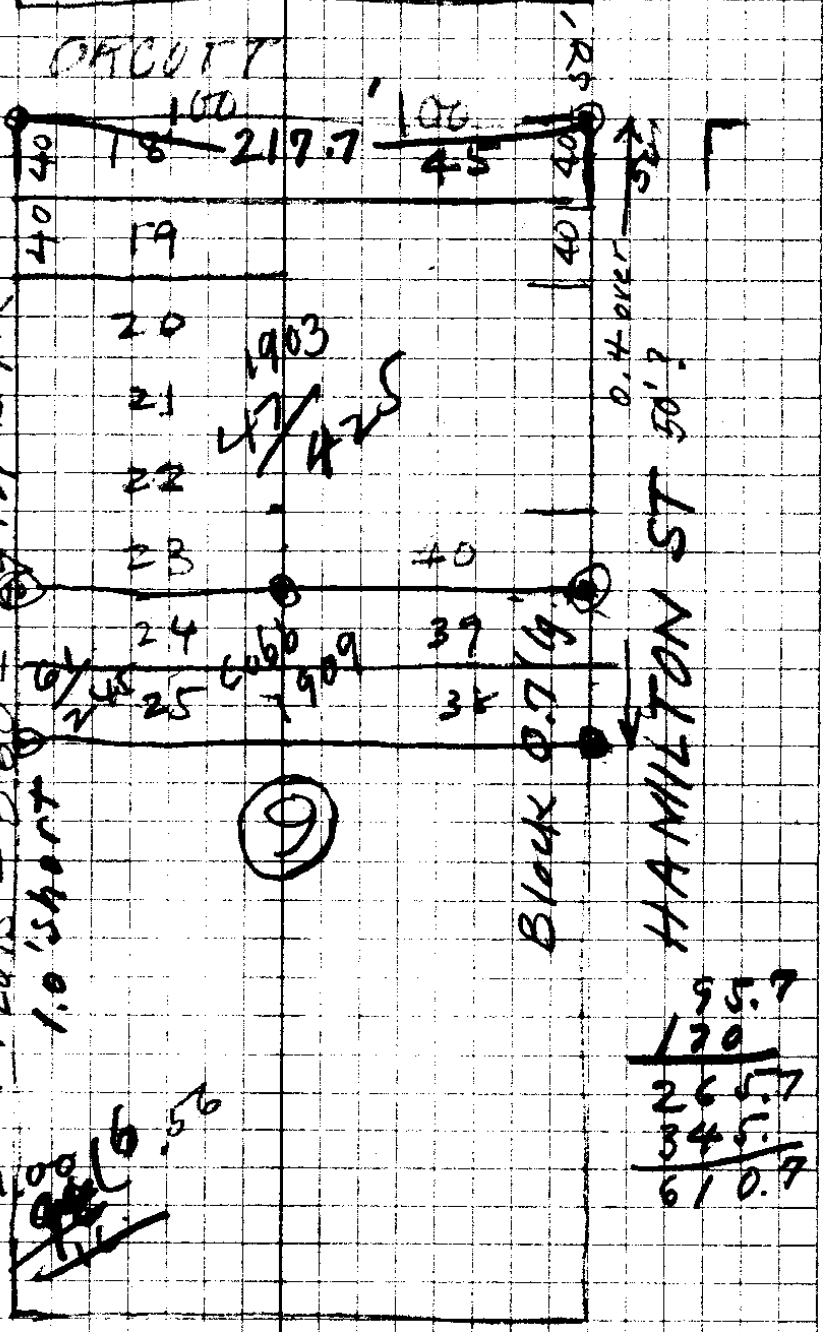

14
 40
 560
 50
 610

S. JACKSON 50'
 14 lots = 560 = 69th B/K
 1.0' short

14) 70 (or)
 70
 14
 70

14) 1000
 14
 14000

95.7
 170
 265.7
 345.
 610.7

{ 18 to 25 }
 { 38 to 45 }

WAITE 50'

84
 150
 264
 345
 609

Lot 30

27
 32
 33
 34
 35
 36 + 31

61
 245

P 35-48

Sept. 29th 1941

Mr W.M.Campbell, Supt city Schools,
Roseburg, Ore.

Dear Mr Campbell,

Enclosed is bill for survey of the original
Rose School property which was staked last Saturday.

After our conversation on this day, (Sat.) I referred to
the assessor's office to assure myself of the lots which were
included in the original school site; with Mr Stevenson I
found one reference in the county clerks records in vol. 20
and pg. 258 which read lots 18 to 23 incl. and 40 to 45 incl.
of Block 9, Waite's Add; later another deed was filed and
recorded in vol. 47, pg. 425, this latter deed was for lots
24 and 25 and 38 and 39, Blk. 9, the last deed was filed in
1908; you will note from the annexed sketch that these lots
make a rectangular piece of ground and not an "L" shaped one.

The south side of this group of lots is marked on the
ground, on the S.E. corner at Hamilton St., there is a steel
crank driven and at the garage which is on Mrs William's
property there is a 3/4 inch bridge bolt; on the brow of the
hill where the slope drops down onto Jackson St; there is
a wooden hub with a tack in it and on the sidehill just above
the curb line on Jackson st. there is a pipe, all these points
are on the south line of this original group of lots.

If you are unable to locate all these points you can phone
this office and someone can go out with you and locate them.

ORCUTT ST

Respectfully yours,

Arthur Boyer
Dep. Co Surveyor.

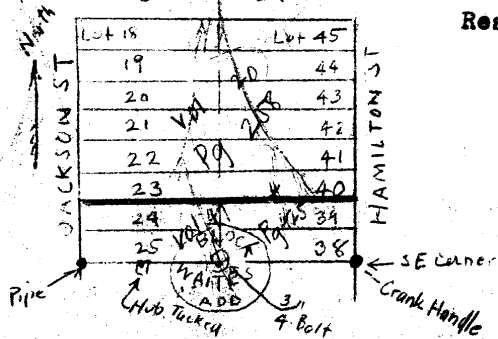

CS FILE FOLDER

CONTAINS

MORE

INFORMATION