

27/4

lake

35-23

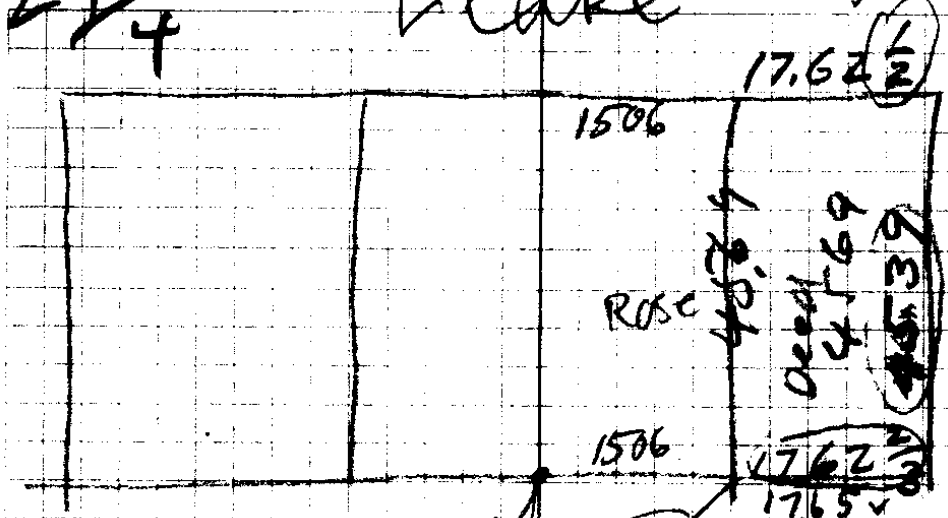

6" W.O. 58/26 26 Z
 5" W.O. 58/26 34 Z
 N 15 W 34 Z
 56.5 W 25 Z
 4" Laurel

1/4 CA 20-21

25" W.O. 58/26 420 Z

24" Dead 514 W 384 Z

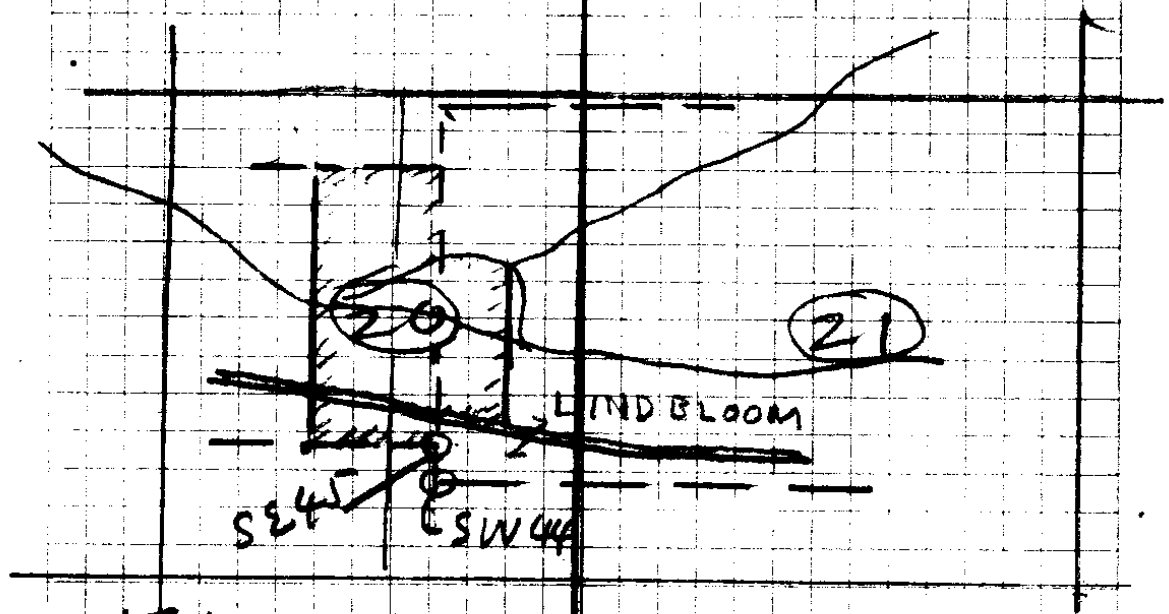

58/261 ✓

68/346 + 546

68/546 GUS L to S.W.L etux.

Bag out pt on N. Line Deer Cr

Rd 2.54 ch N of SE cor WNW

2 LC. 41-27/4 th S 79° E along

N. Line rd 12.2 ch S

th. N 26.22 ch S

W 11.97. "

S 22.9 " to bag = 30 ac

↙ 62 23

12.2
6.6
73.2
73.2
8.5.5

479.17
169.17
350.00

SE cor Willis D.L.C

12" B.O N 25W 26

18' " N 88° E 20 Z

N 10.65 = Creek 10 Z. CW. 179.9

N 19.65 = " 8 Z " = 129.69

N 33.15 = School 2 Z west = 2487.9

45.39 = NE cor D.L.C 45 - no adp

West 1726 = SE cor 46

SW cor 44 - 15" B.O N 75E 210 Z

14" " S 10° E 32 Z

North 15.00 cor Creek

24.00 " "

37.5 School 2 Z W
49.74 = NE cor 45

3/4 P. 9 = $\Delta = 0^{\circ} 51' R$

S&E { 194.5
137
305

NW Cor
Prop. 8
3/4 1.1 P.

S 81° E
 $\Delta 94^{\circ} 38' R$

N 42° E 270. + 1.9 = 271.9'
4° 35' = N 0° 04' W

7 $\Delta 89^{\circ} 51' R$ (36' N to Oak 20")

Record
6

West 435.0 = N 89° 54' W

~~$\Delta 90^{\circ} 43' L$~~ (or 89° 20' L)

North 66.8 = Δ Rd from #5 = N 34° W

(North 46.5 = S Line Co Rd = 3/4" 1.1 P)

$\Delta 89^{\circ} 47' R$

5 = SW Cor By Pass - (set up 4.3' W)

West 100' S 89° 39' W

SE Cor
By Pass 4

$\Delta 90^{\circ} 21' L$ \rightarrow N of DLC Cor = Int L Cor
= 470.2 (Note move point 3.5' E)

N 25.0

3 = 445.2

From No. 1 Set up

300' - $12^{\circ} 45' = 292.5 + 152.7 <$

2 = 169.75 N of DLC Cor = SW Cor This Survey

1

161.4 - 150 = 15.9'

8.5' E DLC Cor

SE Cor Willis DLC

LESS 3.2'

4569
66
 27414
27414
 301554

3015.5) 16.0000(.0053
150775
 92250
90465
 1785

975
3
 2925
1527
 4452
25
 4702
.0053
 14106
23510
 249206 = 2.5 + 1.0 = 3.5

96593
1614
 115589626

155.9
3.2
 152.7 + 17.0
.0053
 4581
7635
 50931

152.7
67
 169.75
0053
 5091
8485
 89941

155.9
966

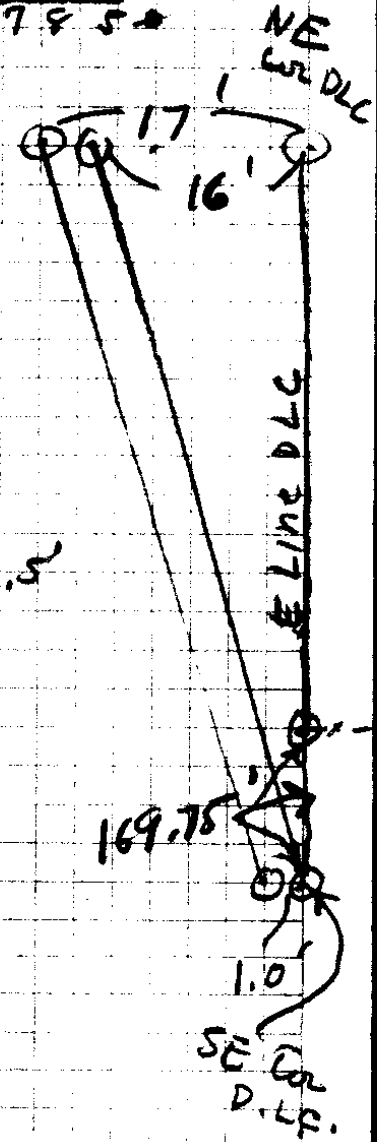

340.5
241.5
 8.5

35/23

8.5'

390
 90
 80
 60
 60.2

 680.2

655
 151.5

 806.5

C₁₂ = Bay
 $N 78^{\circ} W$ 806.5' $N 79^{\circ} 11' W$

13 = SE C₁₂ $\Delta 101^{\circ} 05' R$
 $S 1^{\circ} W$ on E Line Fence 680.2' $S 0^{\circ} 16' E$

\swarrow
 $\frac{3}{4}$ I.P. on Fence $\Delta 89^{\circ} 15' R$
 12 283.0 = NE C₁₂ on Fence
 $S 88^{\circ} E$ $S 89^{\circ} 31' E$

11 S Side C₁₂ $\Delta 11^{\circ} 53' L$
 $S 75^{\circ} E$, 143.3 $S 77^{\circ} 38' E$

10 $\Delta 6^{\circ} 57' R$
 $S 85^{\circ} E$ 270.3 - $S 84^{\circ} 35' E$

9

CS FILE FOLDER

CONTAINS

MORE

INFORMATION