

SW cor 33

- 12" Larch N10°E 13%
- 8" " N65W 80%
- 50" Sugar Pine S55W 90%
- 6" Fir S35E 16%

NW 4 23
 IRA MAY
 ADAMS
 &
 ERNEST
 STEWART

N bet 33-34

Sec 27-28-33-34
 Sec Cor

- 6" Cedar N25E 26% $\frac{26}{6} = 4.33$
- 12" Cedar N30W 36% $= 23.8$
- 30" Fir S45W 45% $= 29.7$
- 14" Yew S35E 17% $= 11.2$

N bet 27+28

- 40 = 30" Fir on E+W
- 6" ced S15E 36%
- 6" Fir N50W 20%
- 45, 50 = C.

W2S2E2S = Shepard

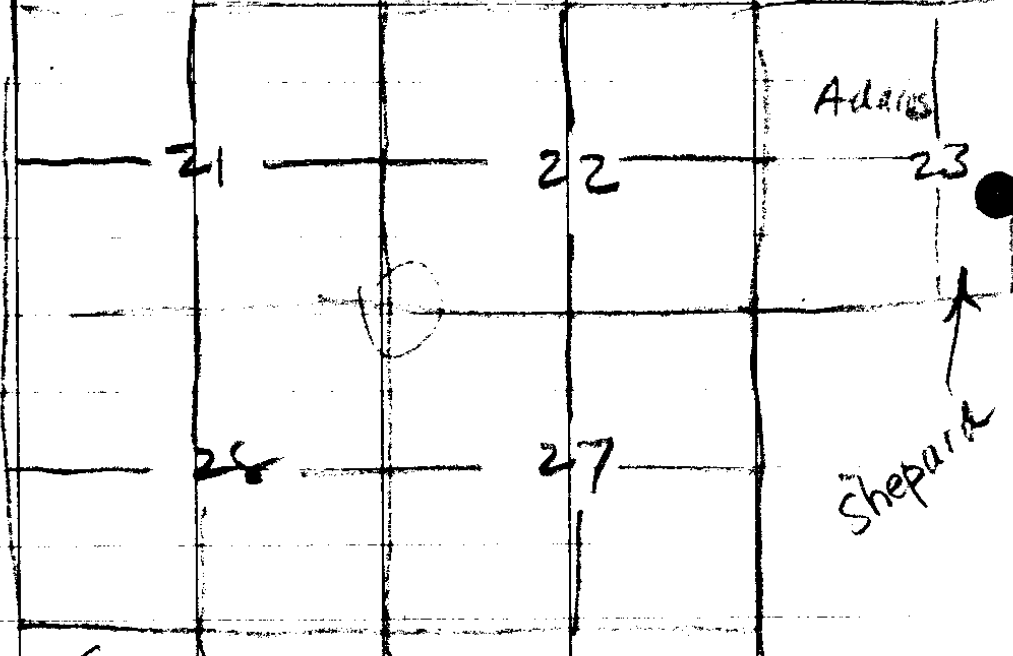

$$\begin{array}{r}
 66 \\
 36 \\
 \hline
 396 \\
 198 \\
 \hline
 23.76
 \end{array}$$

$$\begin{array}{r}
 45 \\
 66 \\
 \hline
 2270 \\
 220 \\
 \hline
 29.70
 \end{array}$$

$$\begin{array}{r}
 17 \\
 66 \\
 \hline
 1022 \\
 11.22
 \end{array}$$

35-19

5.3
6.6/4
3.15
3.1

E. bet 28+33 - Random

40 = Temp $\frac{1}{4}$ Cor

42.40 = Spring Branch 3 LKS wd. N88E.

45.3 = Rock Cr. 8 " C. S.E.

80.77 = Line 40 L N of Cor 27, 28, 33, 34

th N 89° 43' W on true line bet 28+33

40.8 = $\frac{1}{4}$ Cor. - Ced Post

24" Hem. S 35° E 10 L = 6.6

12" Fir N 35° W 12 L = 7.9

80.77 - Sec Cor.

N bet 28+29

8.65 = Cr.

13.2 = Summit

17 = Sp Branch C. East 1-1/2 mi

21.4 = Creek 2 L. wd C East

22.27 = Creek 4 " " C SE

30.5 = Summit

40 = Cedar tree Post $\frac{1}{4}$ Cor 12" MKD w. E. & W.

6" Hem N 5° W 20 L

10" Ced S 20° E 25 L

Indian Tr. to Bucks Peak

Spring Br. 1/2 mi. S 7 E

2404.4
406.6
2571.0

998 8
835 7/2
4990
2994
7984
83,333 0

35-19
Friday - Aug 8 - 1941

AM

Begin at Fence Cor = station 27
run W. $\frac{1}{2}$ mi less 41 paces ^{and} find
Cen Sec 27, 28, 33 & 34 abt 50's
of our line - Found all 4 trees
and found where Houser marked in red
the scribe marks in cedar in Sec 27
the Fir BT in 33 is bark blazed high
the cedar in 28 was not cut out
and the Yew in 34 shows blaze but
no scribe marks: this is the orig
sec cor loc'n. - Clay Darby and
Joe Murphy.

35/19

