

North Umpqua River

Kimball Tract.

S. 27° 1' E.
635.1
N 81° 55' E

Iron pipe

100 100 100 100

Garretson

Church

Ritter

787.7

Shoemaker
N. 764.7

Agnes Page



Tucker.

8 ft. Tr. of W.P.

Axel

S. 71° W. 614'

S. 71° E 391.6'

Myrtle St.

COUNTY ROAD

Tucker.

S. 87° E 464'

172.4

N. 76° 30' E.

Iron Pipe

Gun Barrell

N. 53° E.
450'

NW 1/4 SEC. 30 T26S R5W
J.W.B.

34/54

34/59

TUCKER

H. Eppstein
W. E. Richardson

March - 3 - 41.

C. S. File No.

~~34/59~~

Sta Dist AL AR CC M.E.

8 c

173.2 61-53 110°10'W N.4°W.

7 c

~~1674.6~~ 61°09' N 61°43' E N 62° E

6 c

1316.0 1°07' N 0-34E N 0°30'E

5 c

1544.1 2°53' N 0-33 W N 1° W

4 c

547.7 1°56' N 2-20E N 2° E

3 c

1065.1 7°41' N 0°24' E North

2 c

185.4 7°54' - N 7-17 W N 8³/₄ W

1 c

N 0-37 E N 1° W

18000
478.7

NW Cor 2278.7
Cl. 39

	Hor.	Vert	Time	M.E.
f	41°49'	30°10'	2-48	
d	42-37	30°32'	2-48-30	S43°W

Mar. 3-1941
 Taken at Hub. 3 N0°24'E
 Back Sight Hub 2

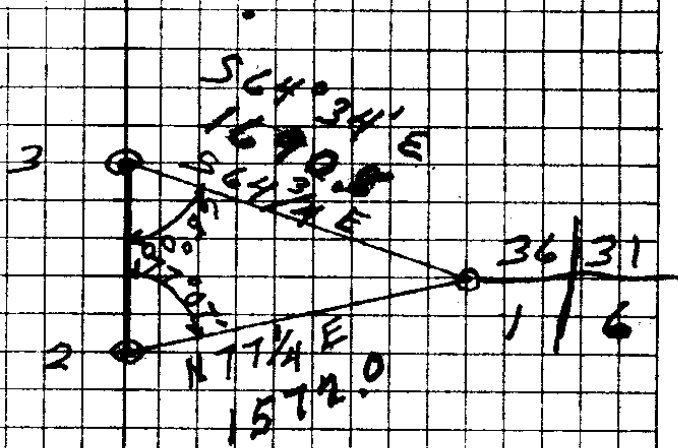

$$300 + 4^{\circ}00' = 299.3$$

$$180 + 4^{\circ}30' = 179.4$$

$$478.7$$

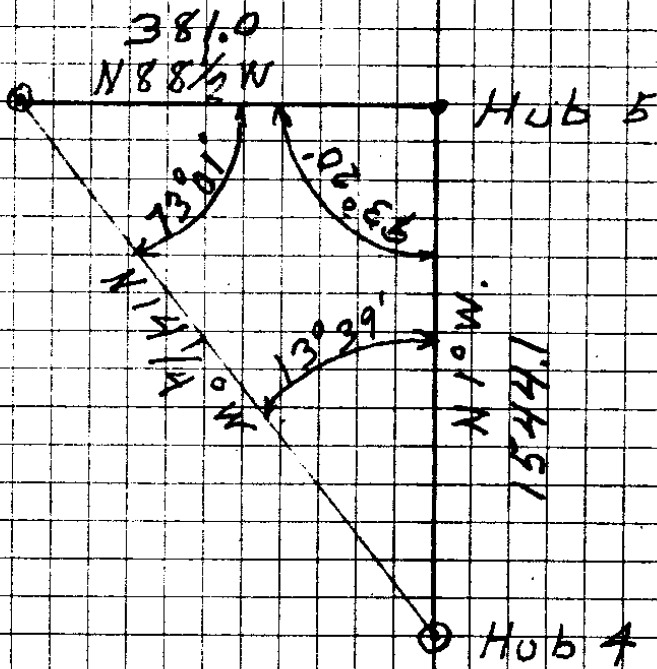

C. S. File No. 34/59

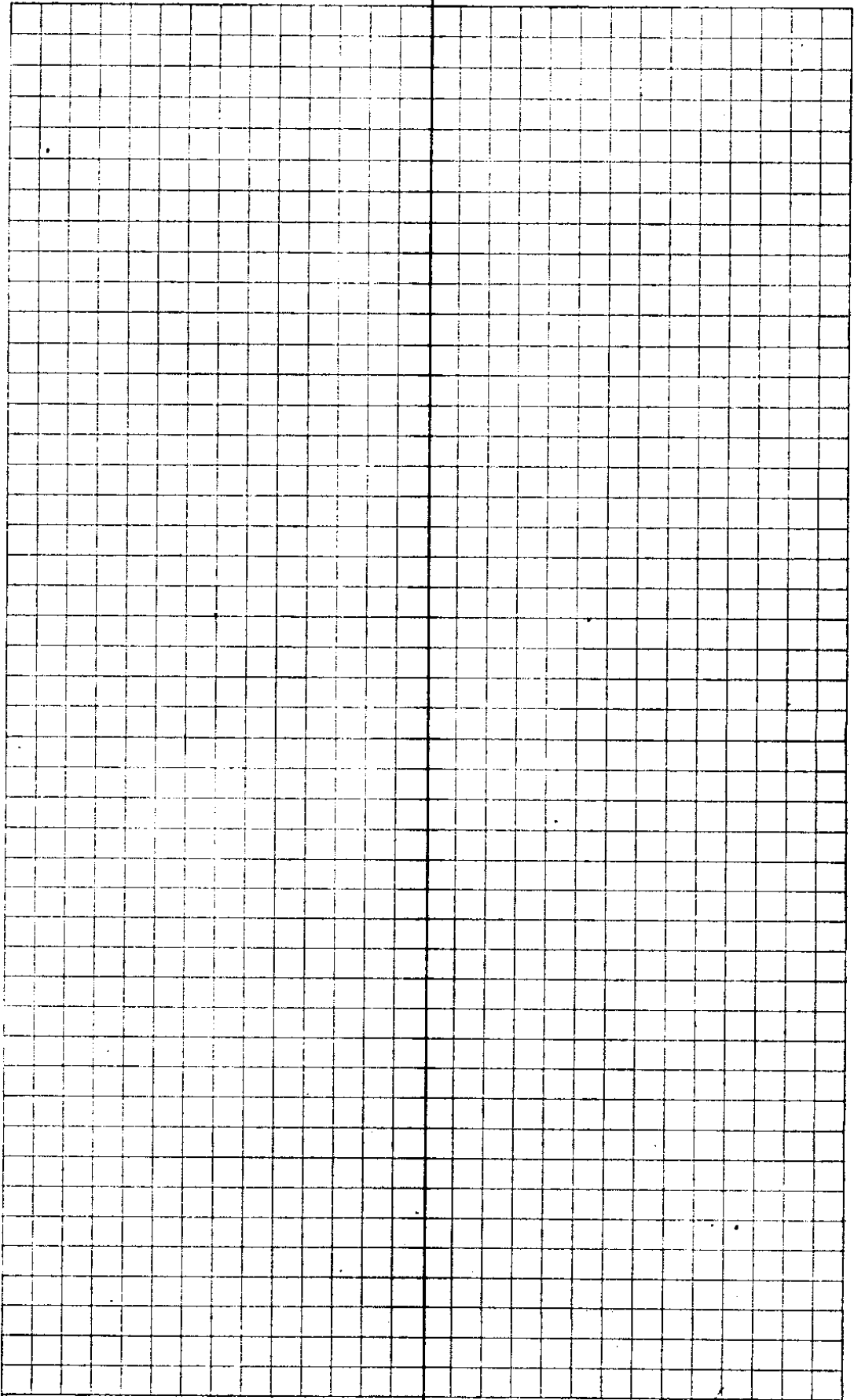

C. S. E. No 34/59

Sta Dist AL AR C.C. M.C.

SWCot.
Cl. 47

47.3 93°04' N83-27W N83³/₄W

16B
300.0
+14°12'

~~61.0~~
351.8

12°51' N9-37E N10³/₄E

15B
87.4
+14°12'

84.7 3°47'

N3-14W N2¹/₄W

14B
300.0
-9°55'

~~27.3~~
324.7 1°01'

N0-33E N2°E

13B
300.0
-22°10'

277.8 6°39' N1-34E N4¹/₂E

12B
164.0
+3°00'

163.8 9°41' N5-05W N4°W

11B
160.9
+3°14'

160.6 40°04' N4°36E N4¹/₂E

10B

105.7 47°06' N44-40E N46°E

Δ9B

88.7 8°14' S88-14E S87¹/₄E

Δ8B

N83-32E N85°E

Δ7B

8" W. Oak

1/8" S
12.1

S.W. Cor. D.L.C. 47
3" Oak Stake

Stake Marked



6" B. Oak
Scribed
RPX

Stake Marked D

91.2 + 13° 30'

C.S. File No. 34/59

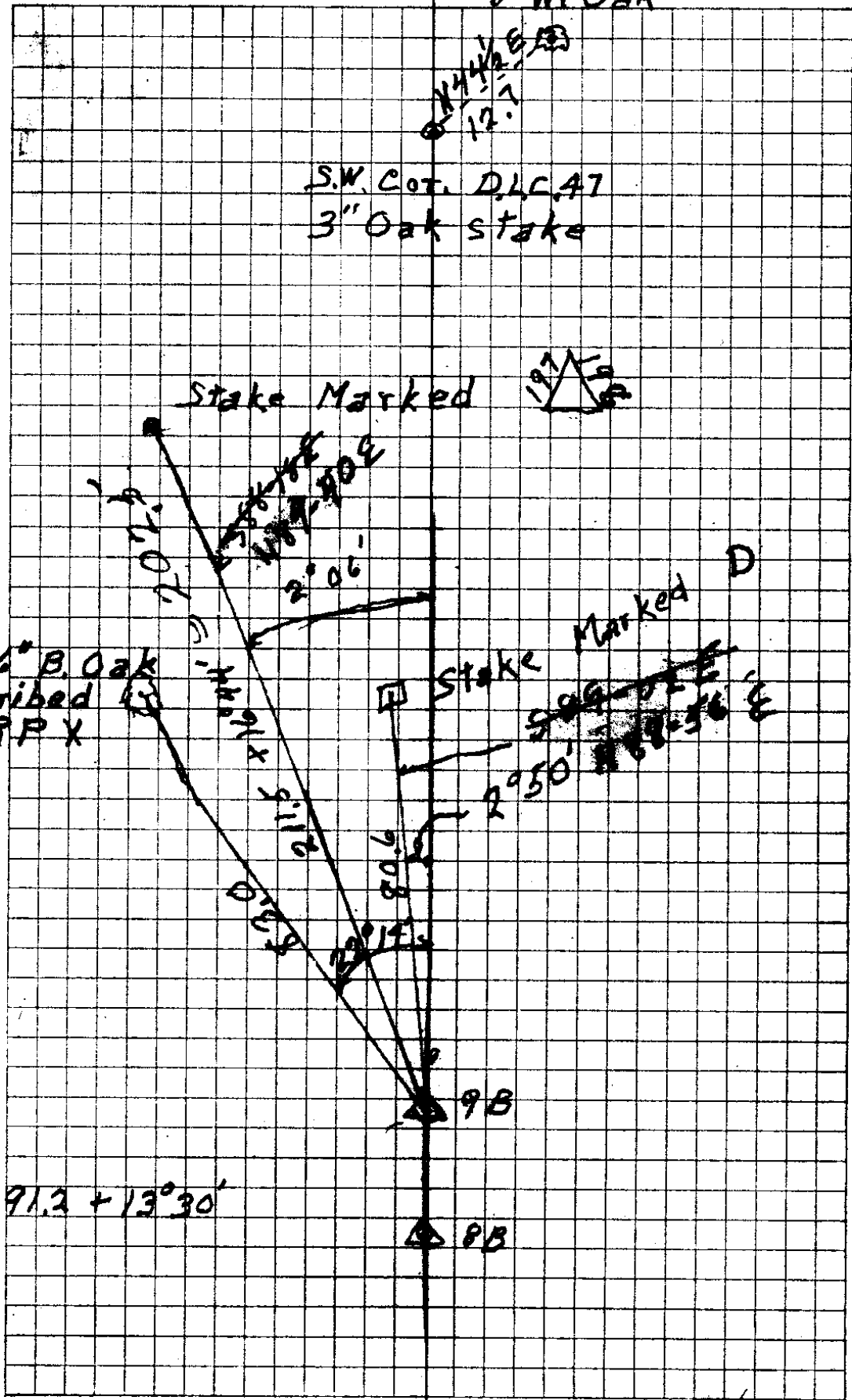

T

442.9 81°19'

S0°27'W

Hyb
1

404.7 15°06'

S81°46'W S83³/₄W

D2

325.6

7°36' N83°08'W N82³/₄W

D1

277.9 91°18'

S89°16'W S89W

6e

N0°34'E

5e

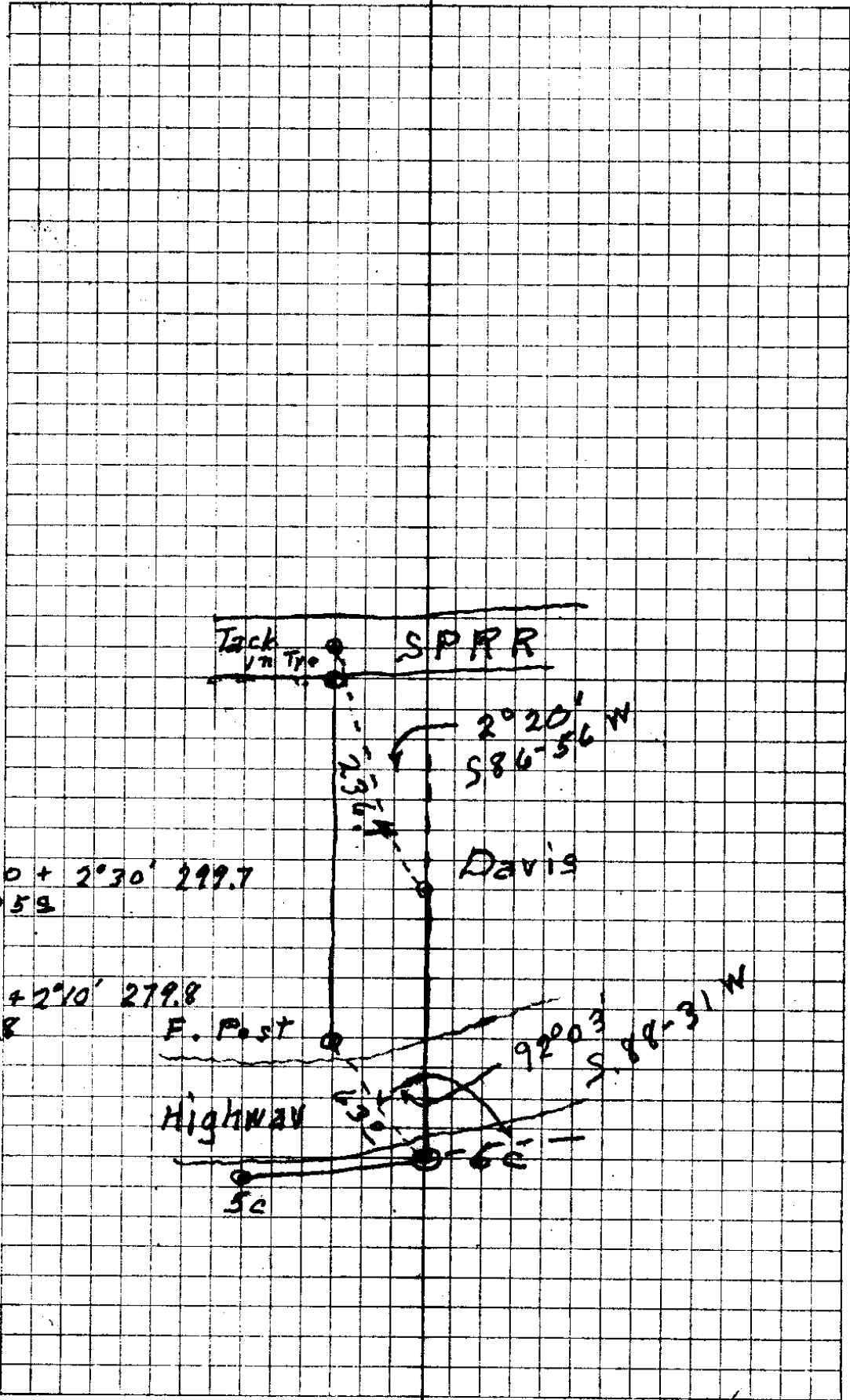

C. S. File No. 34/59

Sta Dist AL AR C.C. M.C.

Davis
Old Fence
Post

15.7

32°22' N7-54E

Davis
NE Cor

471.9

71-02 N24-28W N24°W

Davis
SE Cor

61.2

S84-30W

6 C.

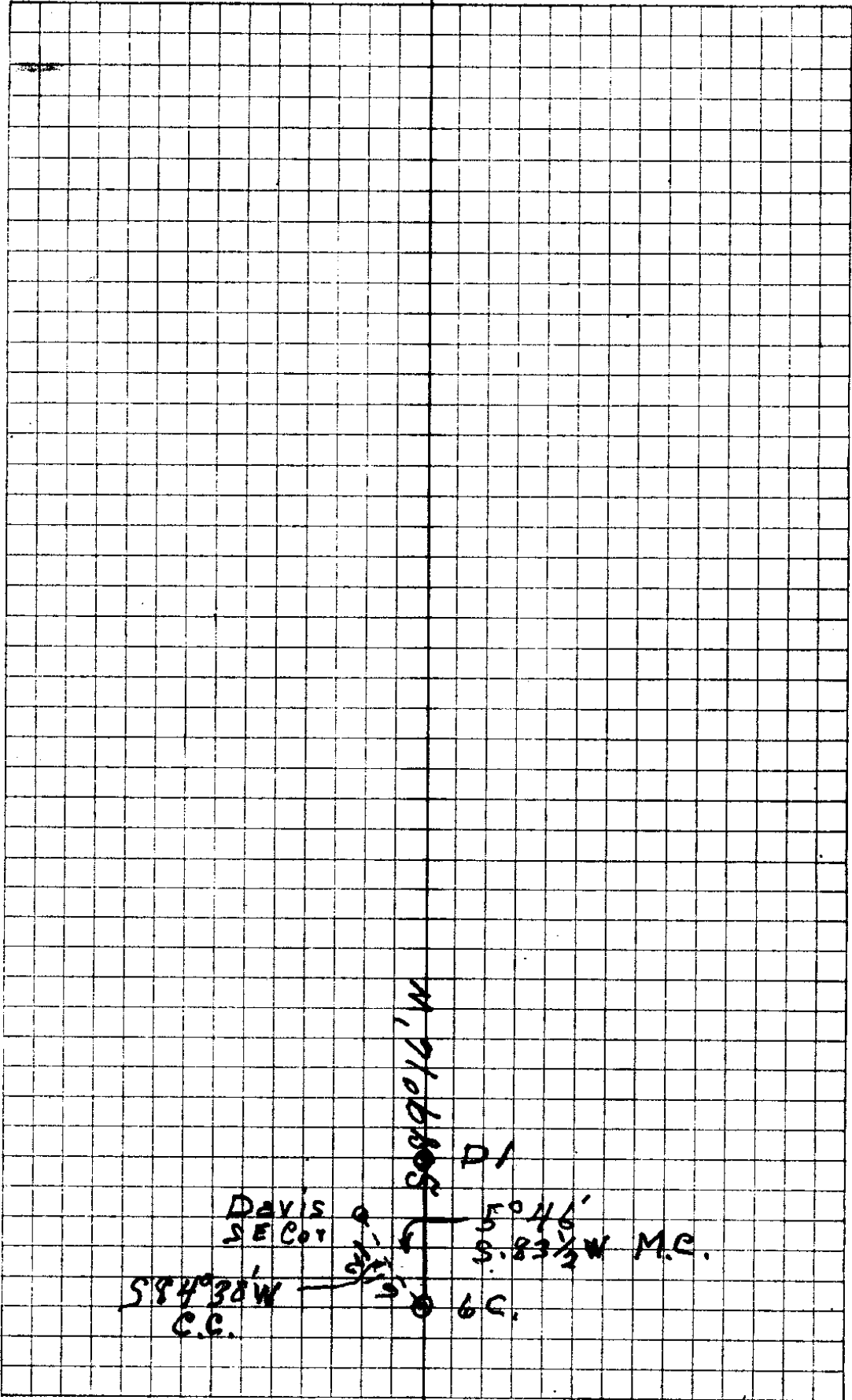

C. S. File No. 34/59

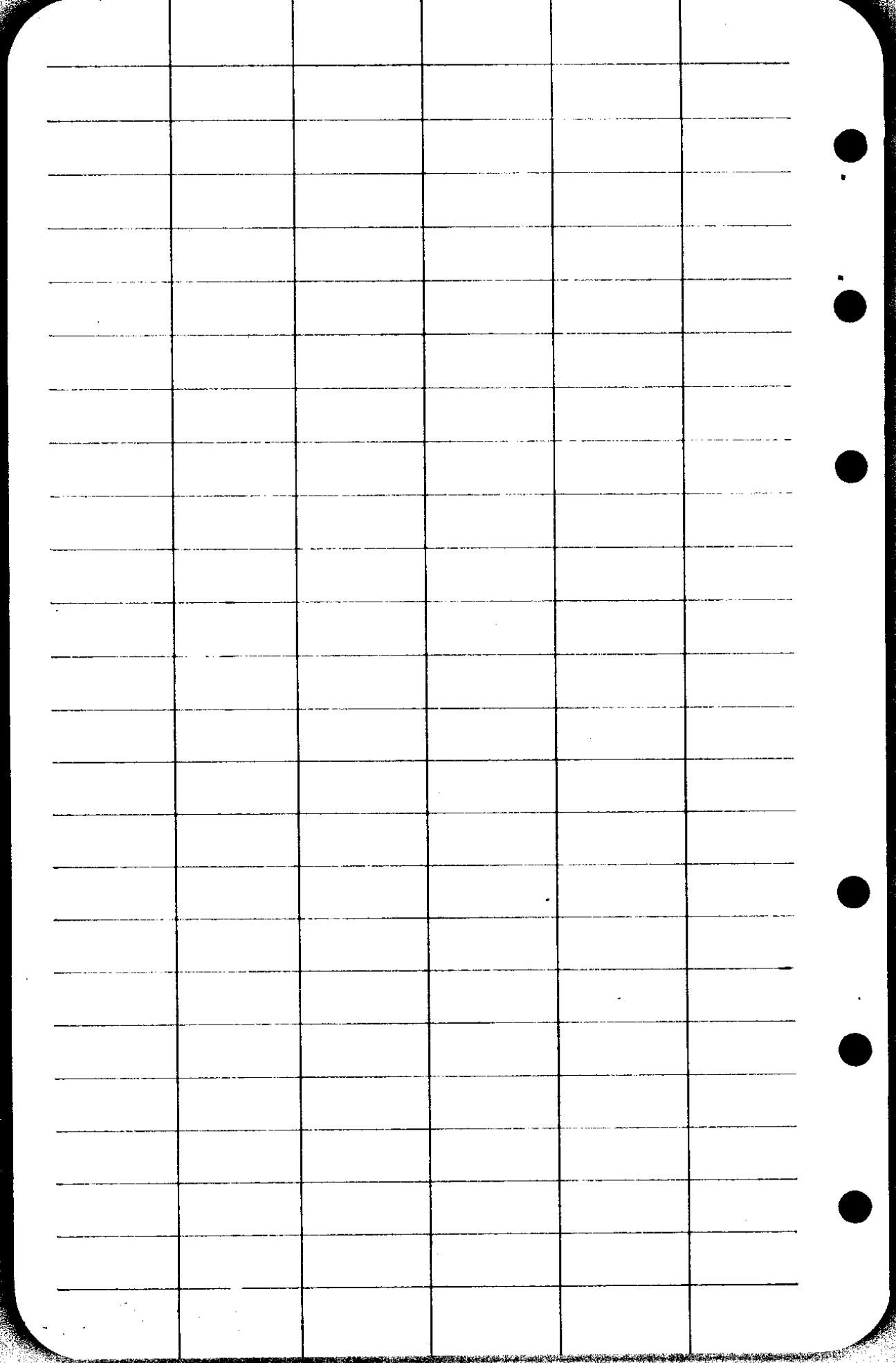

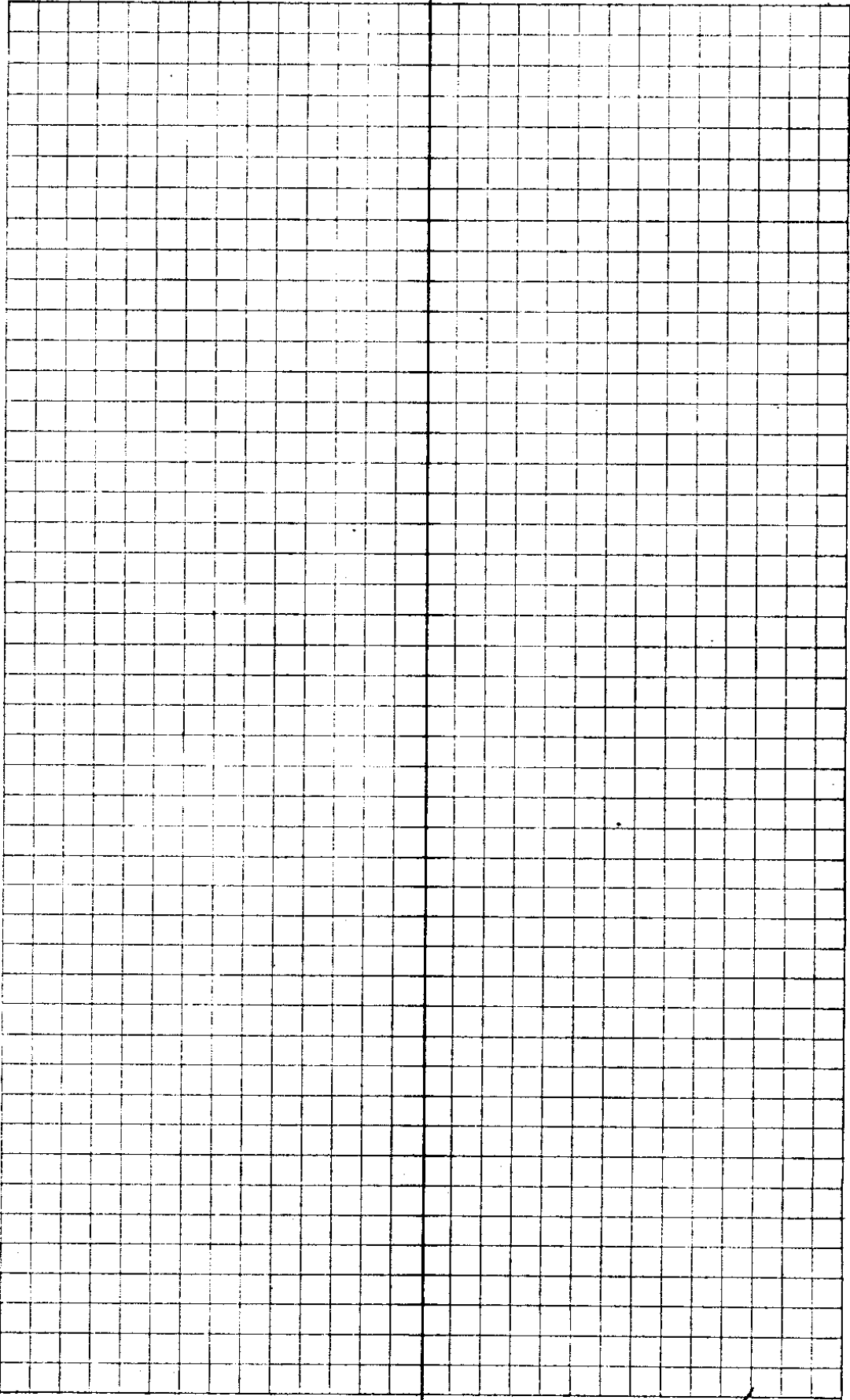

C. S. File No 34/59

Sta	Dist	AL	AR	C.C.	M.C.
I					
	125.6		2°05'	S13-37W	S16 ³ / ₄ W
H					
	100		3°52'	S11-32W	S13 ¹ / ₄ W
G					
	100		3°52'	S7-40W	S10°W
F					
	100		3°52'	S3-48W	S4 ³ / ₄ W
E					
	100		3°59'	S0-04E	S1°E
D					
	100		2°19'	S4-03E	S2°E
C					
	100		0°45'	S6-22E	
Tack B					
	419.3		111°40'	S7-07E	S14 ¹ / ₄ E
Cent. A SP Track					
	9.5	28-48		N61-13E	
7					
				S89-59E	
6					

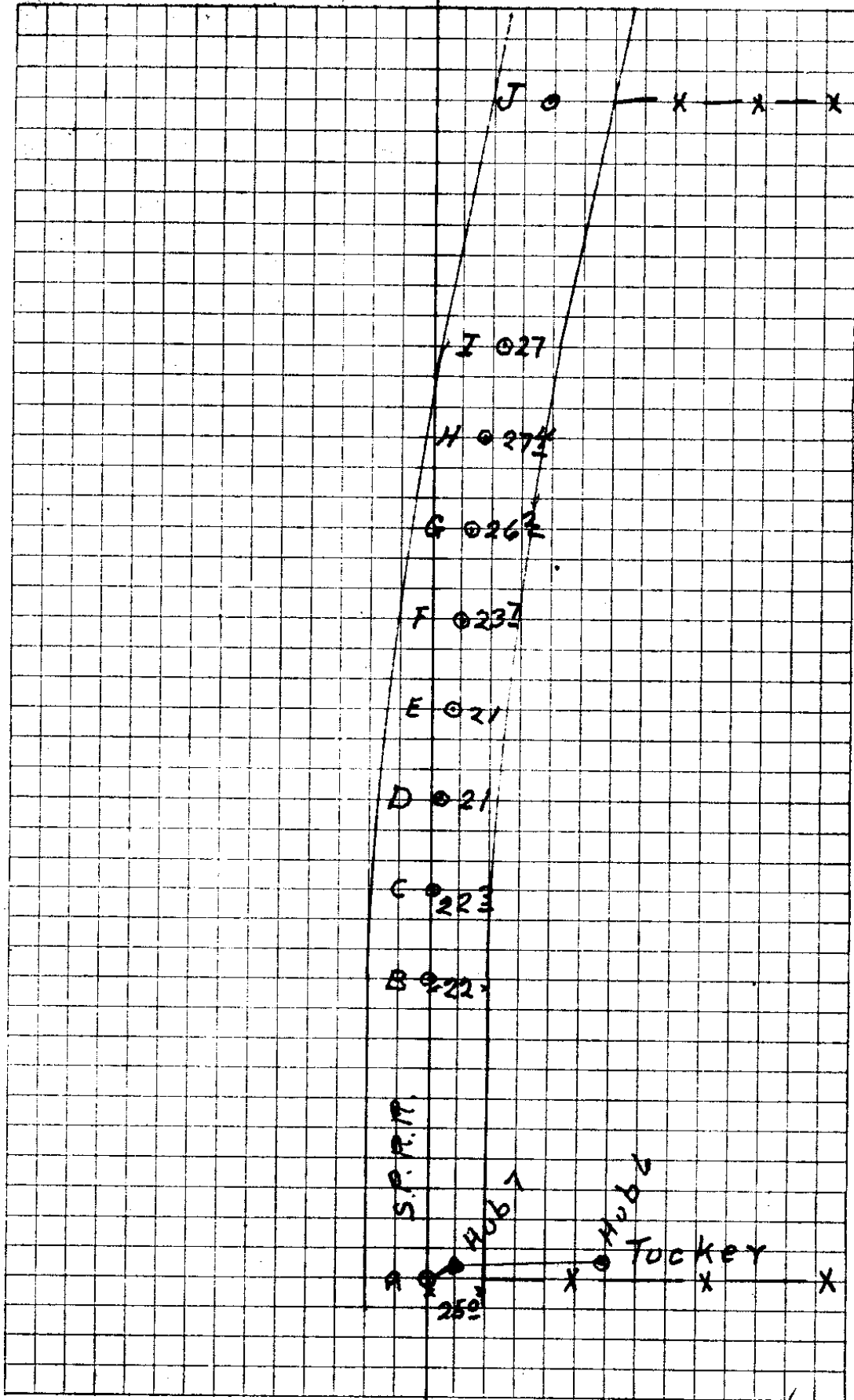

G. S. File No. 34/59

Hub
1

492.8

7°25'

S1-38W

K

598.9

74°49' S 89°03' W S 86° W

J

469.8

0°37' S 14-14W S 15½ W

I

300 - 205' - 99934
1930 Level

299.8
192.0

492.8

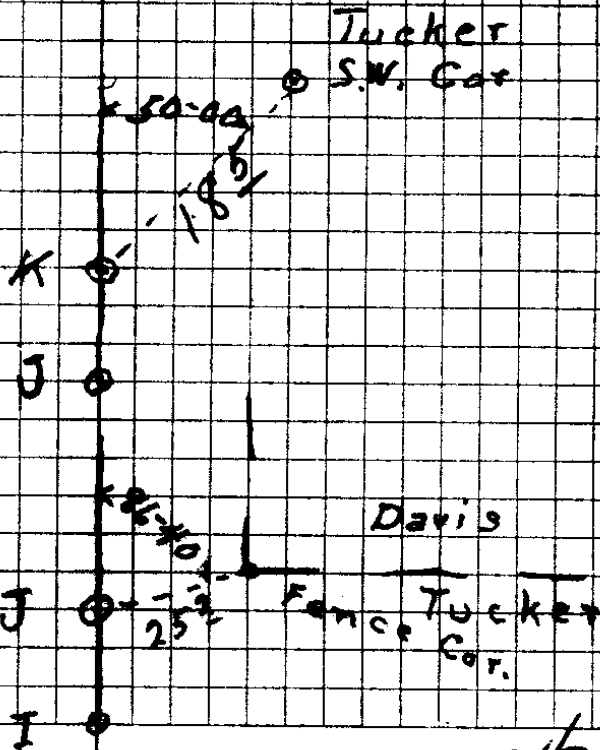

C. S. File No. 24/59

34/59

Tucker - Gilliam

T. 26 S. R. 6 W Secs. 25-36

H. L. Eppstein

N. E. Richardson

Harvey Eppstein

G. S. No. 34/59

Sta	Dist	L Δ	R. Δ	C.C.	M.C.
8	1523.3	97°10'		N 7-09 W	N 8½ W
7	287.8	1°50'		S 89-59 E	S 89¼ E
A 6	418.3		93°27'	S 88-09 E	S 87° E
Δ 5	494.0	3°11'		N 1-36 W	N 0°15' W
Δ 4	448.6		2°55'	N 1-35 E	N 3° E
Δ 3					
1/4 Cor. 25-36	134.3	79°16'		N 80-36 W	N 79° W
Δ 3	158.0	2°19' ^{10'}		N 1-20 W	North
Δ 2	1001.8			N 0-50 E	N 1¾ E
Δ 1					

C. S. File No. 34/59

5735.4
3977.1

13. 18

4725 - 693.76

1385
18.00
1385

+50 - 697.01

+75 - 700.25

28.9
13

4150
4155

5735.6 708.00^B

867
299
3.757

690

690
675

61.5

25
12
25
3.75

355.6
20
606
13
1618
606
7878
1624
25

2439 / 15.000
14.634

3660
2489
12210

3972
153

520
208

1530 - 6750

12750 676.34

2700 677.88

743.9
175
1532

2600

+25 679.42

+50 680.96

21.8
14.4
872

215
614
1090

+75 682.50

3200 684.03

218
2.267

218
1308

+25 685.57

+50 687.10

613
1.5
3075
1230

675
625
100

+75 688.64

32976 6900

15375
199

5 56
5

67015

675
97
665.3

10.00
770
2.80

1.25

67140

2.05
667.35

41
5
2.05
1.25

11.75

67265

28
670.15

1.25

6739

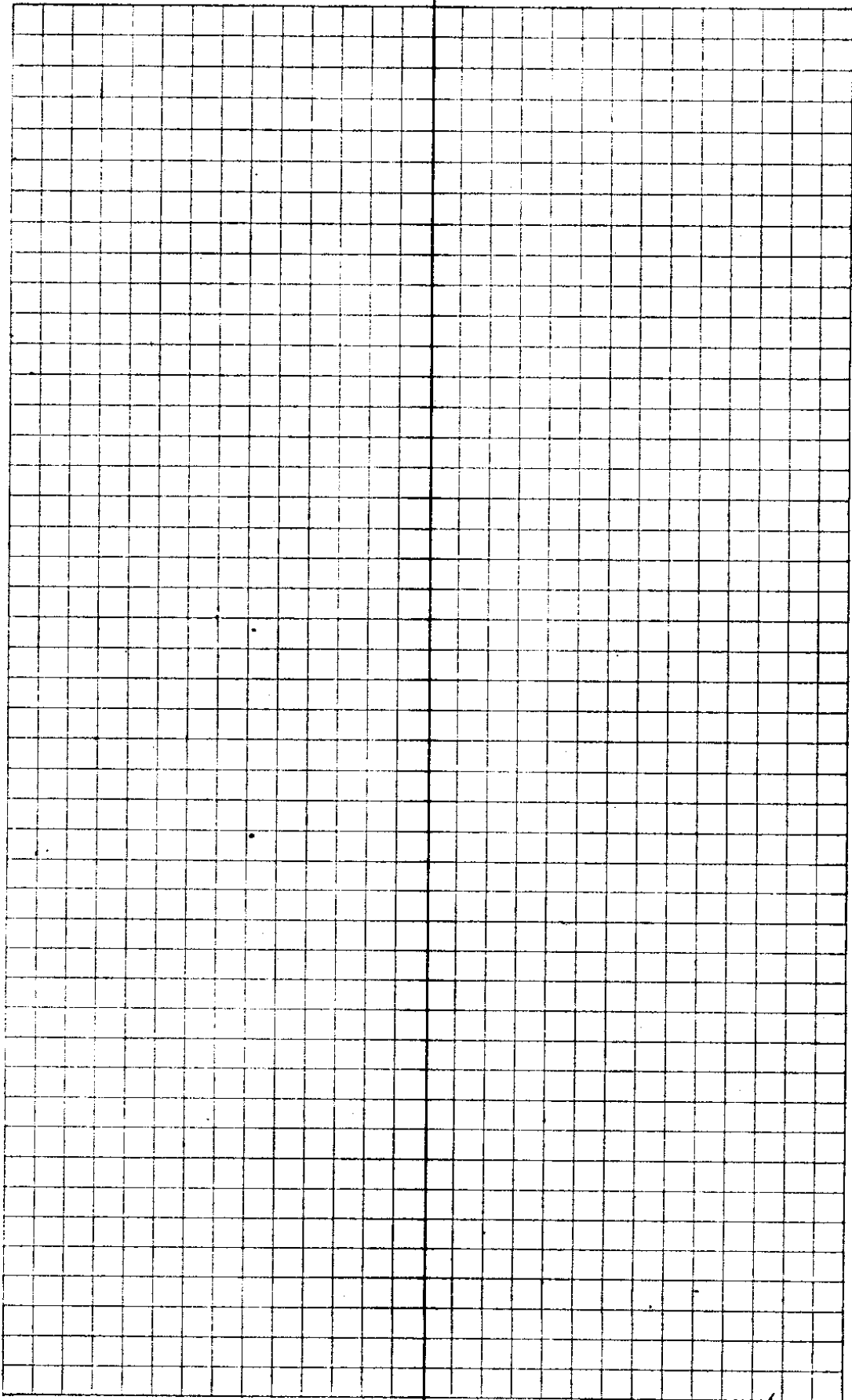

C. S. File No. 24/59

6' X 12' CULVERT

sta

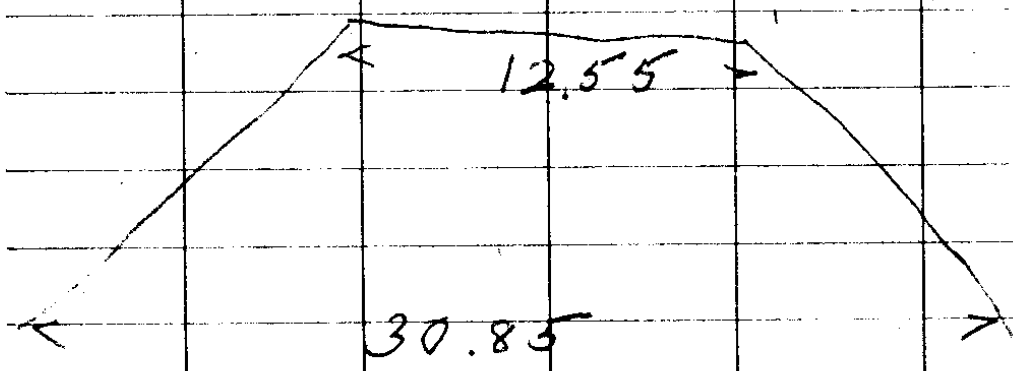

4+09.8

1+00

0+91.6

N-63W

0+00

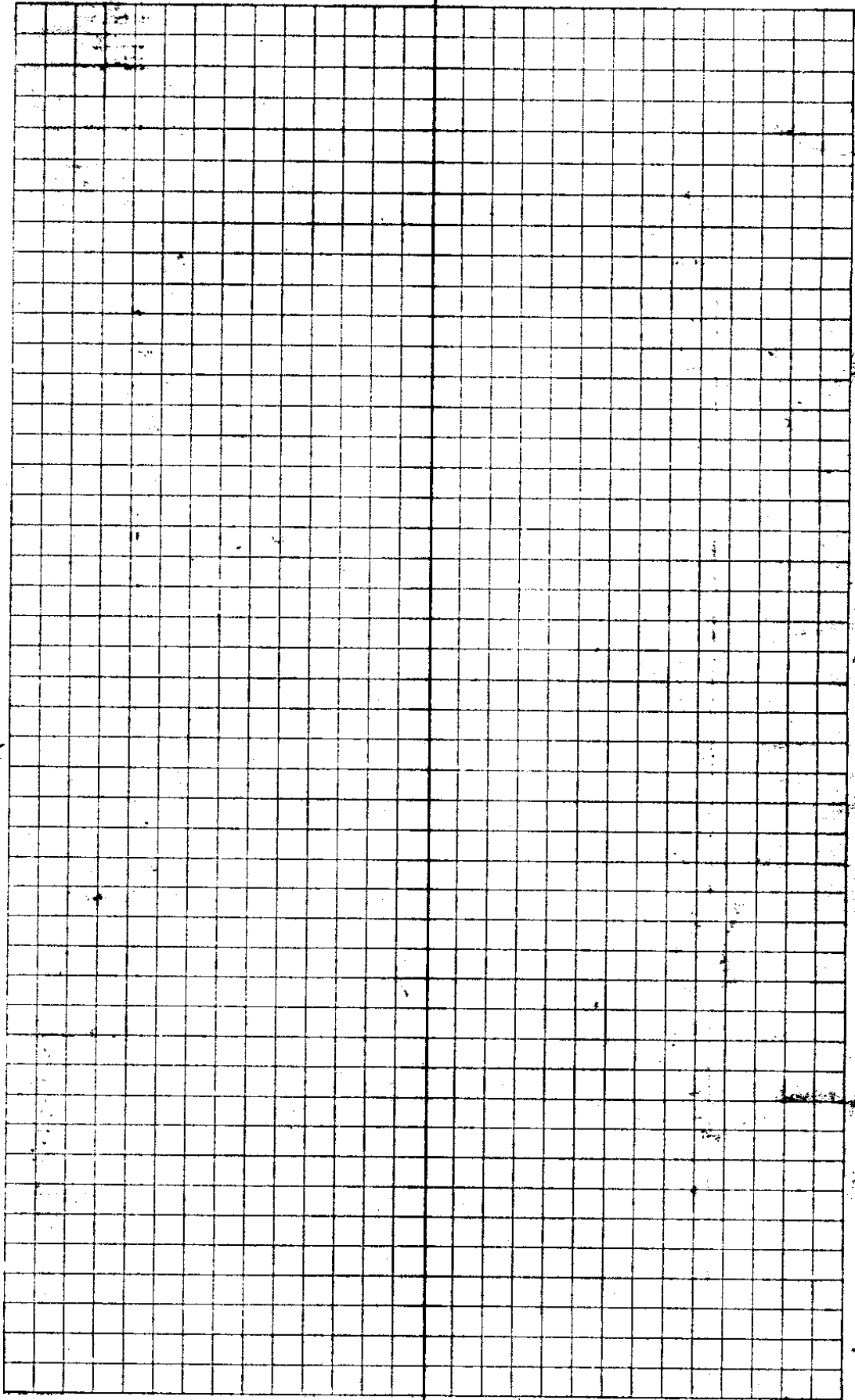

C. S. File No. 34/59

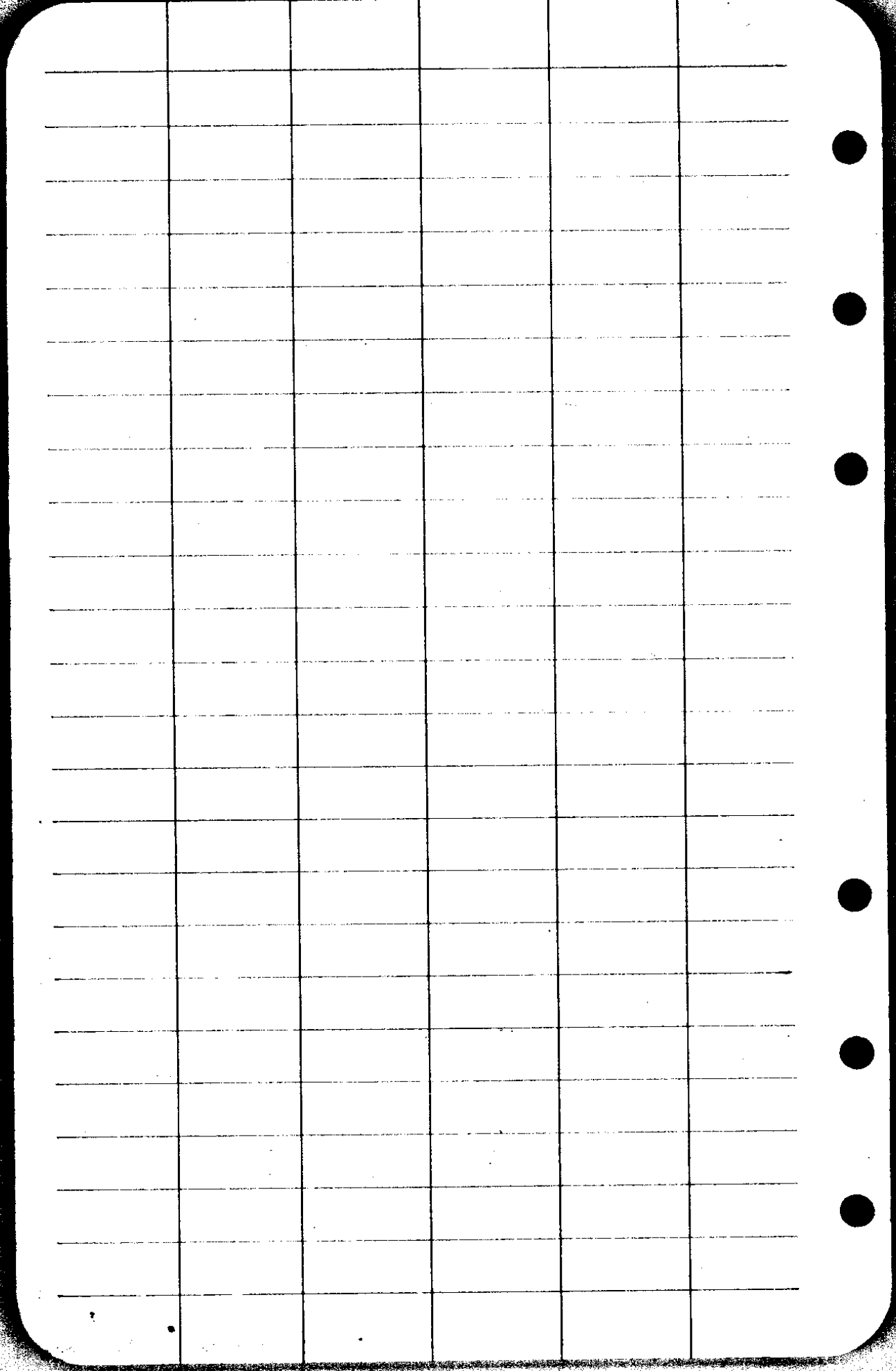

Amount

10.70

598.07

494.8

10.74

598.03

5.4 - 500.2

5700

750

6.0 - 494.2

6.5 493.7

76.5 - 500.2

7100

7.0 493.2

72.6 - 497.6

750

2.9 495.1

44.4 - 499.1

800

6.1 493.8

740 497.2

750

3.1 - 494.9

372 495.57

484 494.74

4154 - 494.76

3.97 - 494.32

4100 495.19

5130 498.99

5.00 494.29

C. S. File No. 34159

Cross Section

$$\begin{array}{r}
 4+19.5 \\
 \hline
 +2.6 \quad +0.9 \quad 0 \quad +0.3 \quad +1.6 \\
 \hline
 13.1 \quad 10.6 \quad 00 \quad 8.9 \quad 11.9
 \end{array}$$

$$\begin{array}{r}
 4+30 \\
 \hline
 +0.9 \quad +0.9 \quad -0.3 \quad -0.3 \quad +0.6 \quad +1.0 \\
 \hline
 12.7 \quad 7.4 \quad 2.7 \quad 00 \quad 5.3 \quad 8.6 \quad 12.3
 \end{array}$$

$$\begin{array}{r}
 4+75 \\
 \hline
 +1.2 \quad +0.1 \quad -0.2 \quad -0.5 \quad 0.7 \quad 0.0 \quad -0.9 \\
 \hline
 12.2 \quad 10.5 \quad 5.5 \quad 2.4 \quad 00 \quad 2.2 \quad 5.7 \quad 11.9
 \end{array}$$

$$\begin{array}{r}
 5+00 \\
 \hline
 +0.8 \quad +0.8 \quad -1.0 \quad 1.3 \\
 \hline
 12.2 \quad 8.2 \quad 00 \quad 6.9 \quad 11.6
 \end{array}$$

$$\begin{array}{r}
 5+25 \\
 \hline
 0.0 \quad +0.4 \quad -1.3 \quad -1.3 \quad -0.2 \\
 \hline
 12.2 \quad 6.2 \quad 00 \quad 3.5 \quad 9.2 \quad 12.2
 \end{array}$$

$$\begin{array}{r}
 5+50 \\
 \hline
 +1.8 \quad +1.3 \quad -0.8 \quad -0.5 \quad +1.9 \\
 \hline
 12.2 \quad 4.5 \quad 2.1 \quad 00 \quad 8.5 \quad 11.9
 \end{array}$$

$$\begin{array}{r}
 5+75 \\
 \hline
 +1.3 \quad 0.0 \quad +0.5 \quad -1.2 \quad -0.3 \quad 0.2 \\
 \hline
 12 \quad 7.2 \quad 2.7 \quad 00 \quad 1.2 \quad 7.3 \quad 12
 \end{array}$$

$$\begin{array}{r}
 +75 \\
 \hline
 +1.5 \quad +1.0 \quad +0.6 \quad 4.0 \\
 \hline
 12.2 \quad 8.3 \quad 7 \quad 12
 \end{array}$$

$$\begin{array}{r}
 +50 \\
 \hline
 24.6 \quad +1.5 \quad +0.7 \quad 0.0 \quad +4.6 \\
 \hline
 12 \quad 9.1 \quad 4.8 \quad 6.9 \quad 12
 \end{array}$$

$$\begin{array}{r}
 +25 \\
 \hline
 +4.3 \quad +1.3 \quad 0.0 \quad -0.6 \quad +4.2 \\
 \hline
 12 \quad 10.4 \quad 0 \quad 6.5 \quad 11.9
 \end{array}$$

$$\begin{array}{r}
 +11 \\
 \hline
 +3.3 \quad +2.0 \quad -0.3 \quad +1.4 \quad 24.4 \\
 \hline
 11.9 \quad 9.6 \quad 5.3 \quad 8.7 \quad 12
 \end{array}$$

$$\begin{array}{r}
 +44 \\
 \hline
 +1.6 \quad +0.6 \quad 0 \quad +0.0 \quad +4.0 \\
 \hline
 12 \quad 9.5 \quad 4.9 \quad 8 \quad 12
 \end{array}$$

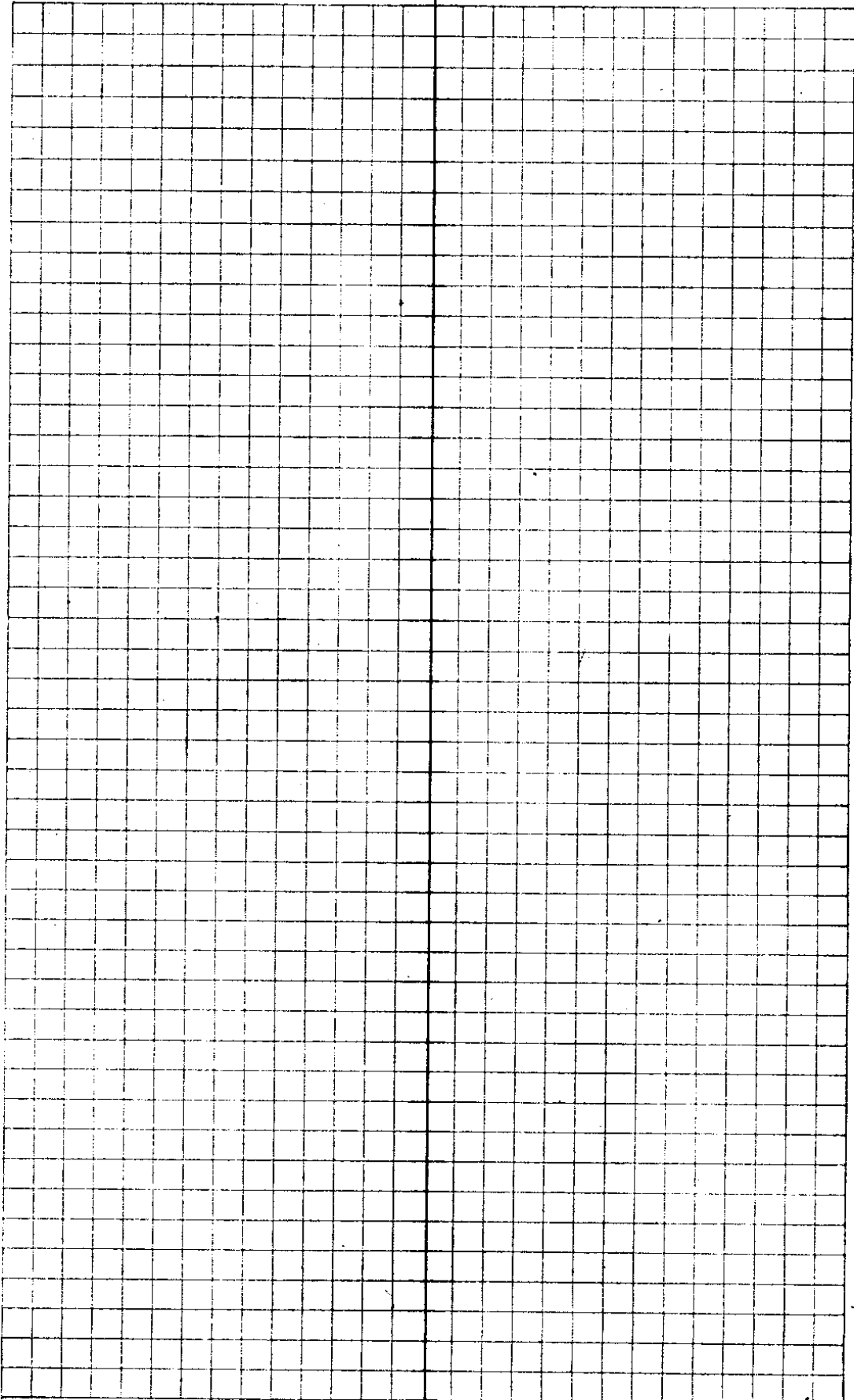

C. S. File No. 34/59

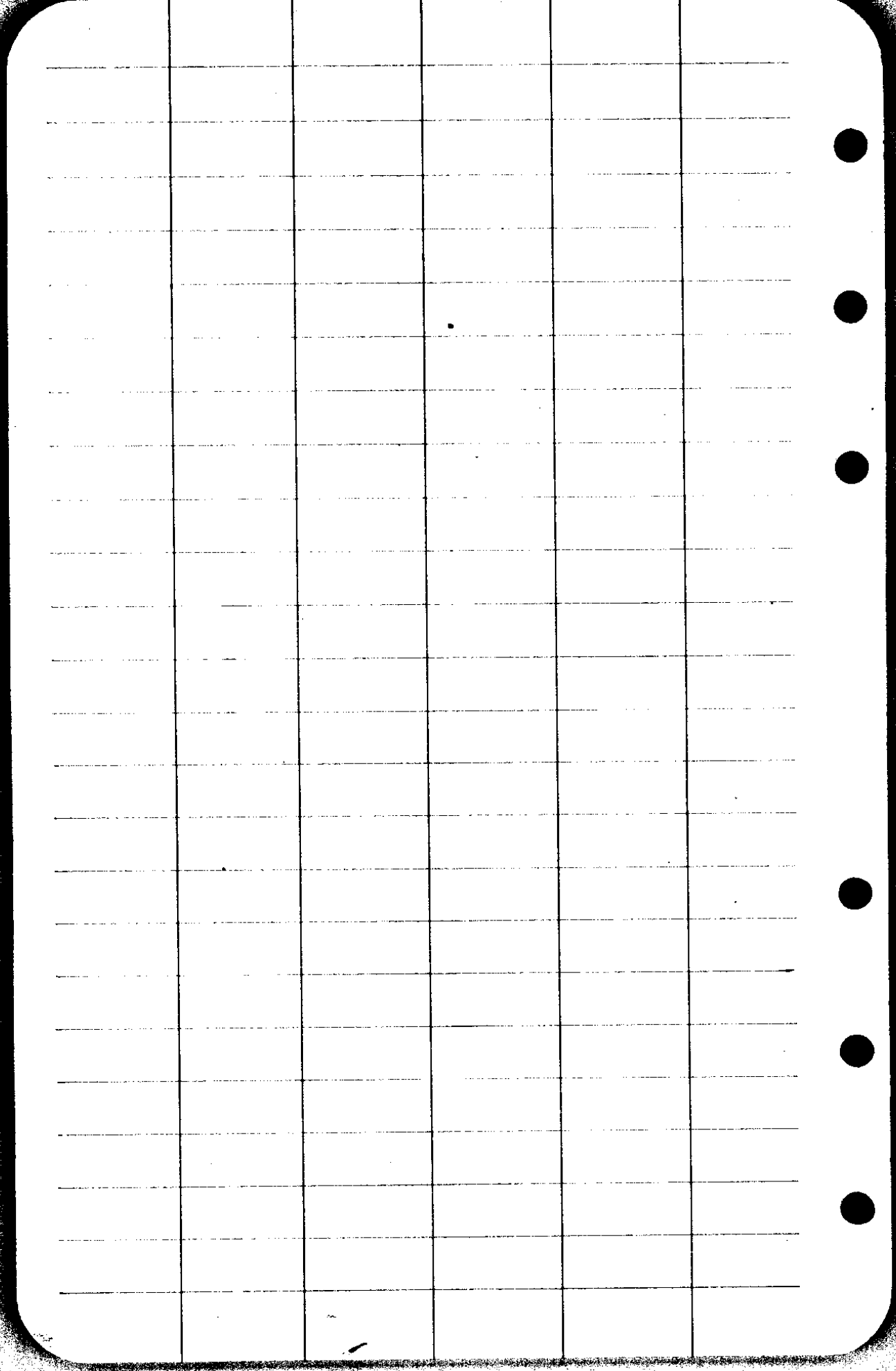

Fence Cor.

52°45'

Fence Cor.

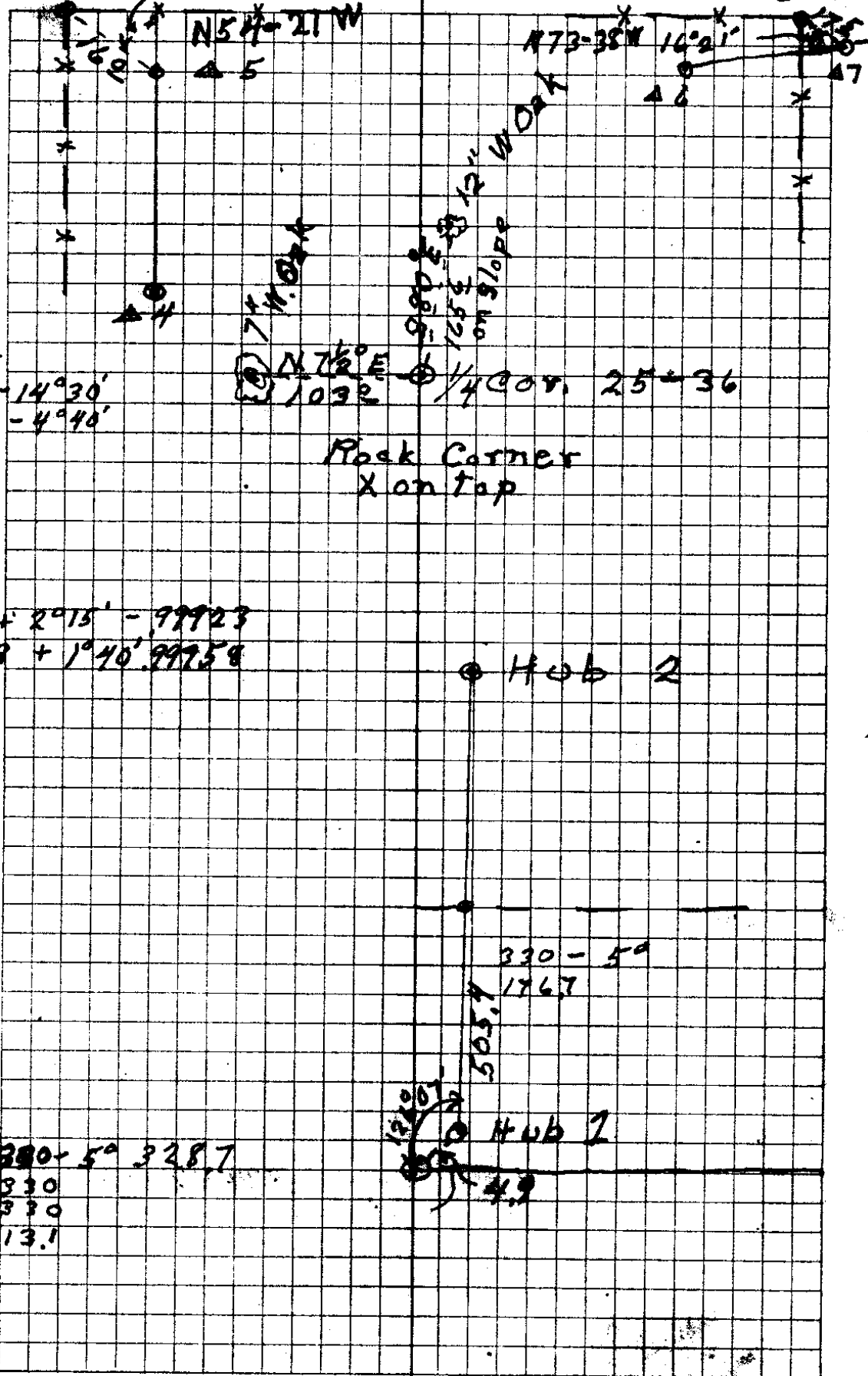

C.S. FILE NO. 34/59

Pearson
Nance

471.5 72°15' 589.56W

9

288° 10°32' N17-41W N19½W

8

$$266.4 + 11^{\circ}28'$$

$$117^{\circ} + 26^{\circ}44'$$

$320 + 4^{\circ}12'$	329.1
$330 + 11^{\circ}47'$	323.0
$330 + 19^{\circ}$	312.0
$177 + 30^{\circ}05'$	153.2

C. S. File No. 34/59

Sta	Dist	L Δ	R Δ	CC	M.C.
8 B					
218.9 +22°51'	201.7	6°42'		N83-32E	N84¼E
7 B					
202.3 +13°6'	197.0		4°13'	S89-46E	S89°E
6 B					
208.7 +17°42'	198.8	6°52'		N86-01E	N88°E
5 B					
210.0 -4°40'	100.0 289.3 301.3		4°53'	S87-07E	S85¾E
4 B					
213.3 -20°45'	199.5	2°51'		N88-00E	East
3 B					
97.0 -17°19'	92.6		41°26'	S89-09E	S87½E
2 B					
	89.2	40°58'		N49-25E	N46¾E
Δ 1 B					
	3480.7			S89-31E	
Δ 1					

Iran Pin on DLC Line

C.S. File No. 34/59

Sta	Dist	ΔL	ΔR	CC	MC
$\Delta 6A$	261.1		$1^{\circ}22'$	N73-57W	N75 $^{\circ}$ W
$\Delta 5A$	129.1		$7^{\circ}03'$	N75-19W	N77 $\frac{1}{4}$ W
$\Delta 4A$	91.7		$2^{\circ}03'$	N82-22W	N82 $^{\circ}$ W
$\Delta 3A$	104.5		$8^{\circ}32'$	N84-25W	N85 $^{\circ}$ W
$\Delta 2A$	1117.3		$89^{\circ}10'$	S87-03W	S89 $\frac{1}{2}$ W
$\Delta 1A$	14.9	$2^{\circ}57'$		S2-07E	S1 $^{\circ}30'E$
$\Delta 1$				S0-50W	
$\Delta 2$					

92152

97398 + Next. Hor. Time ME.

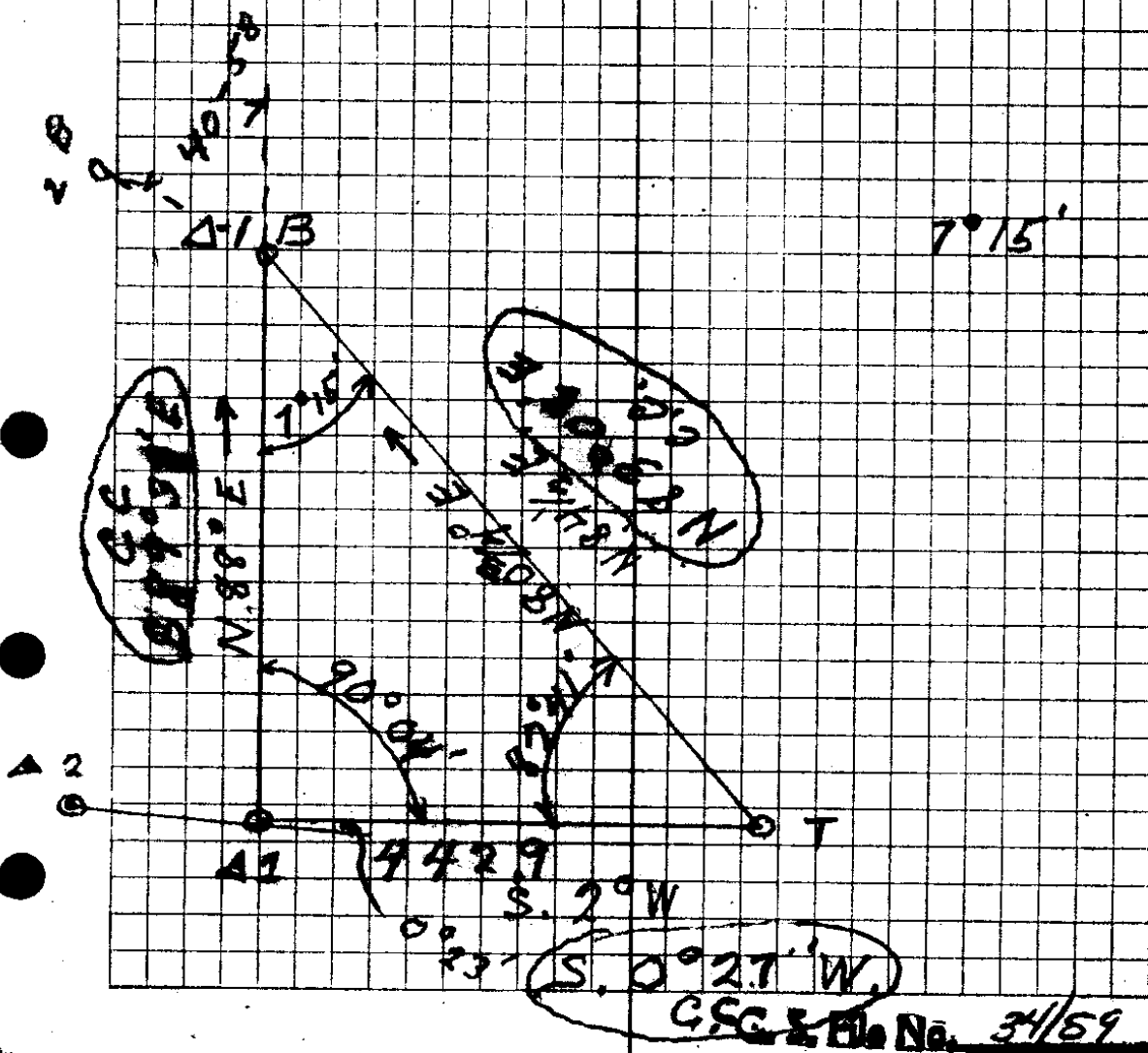

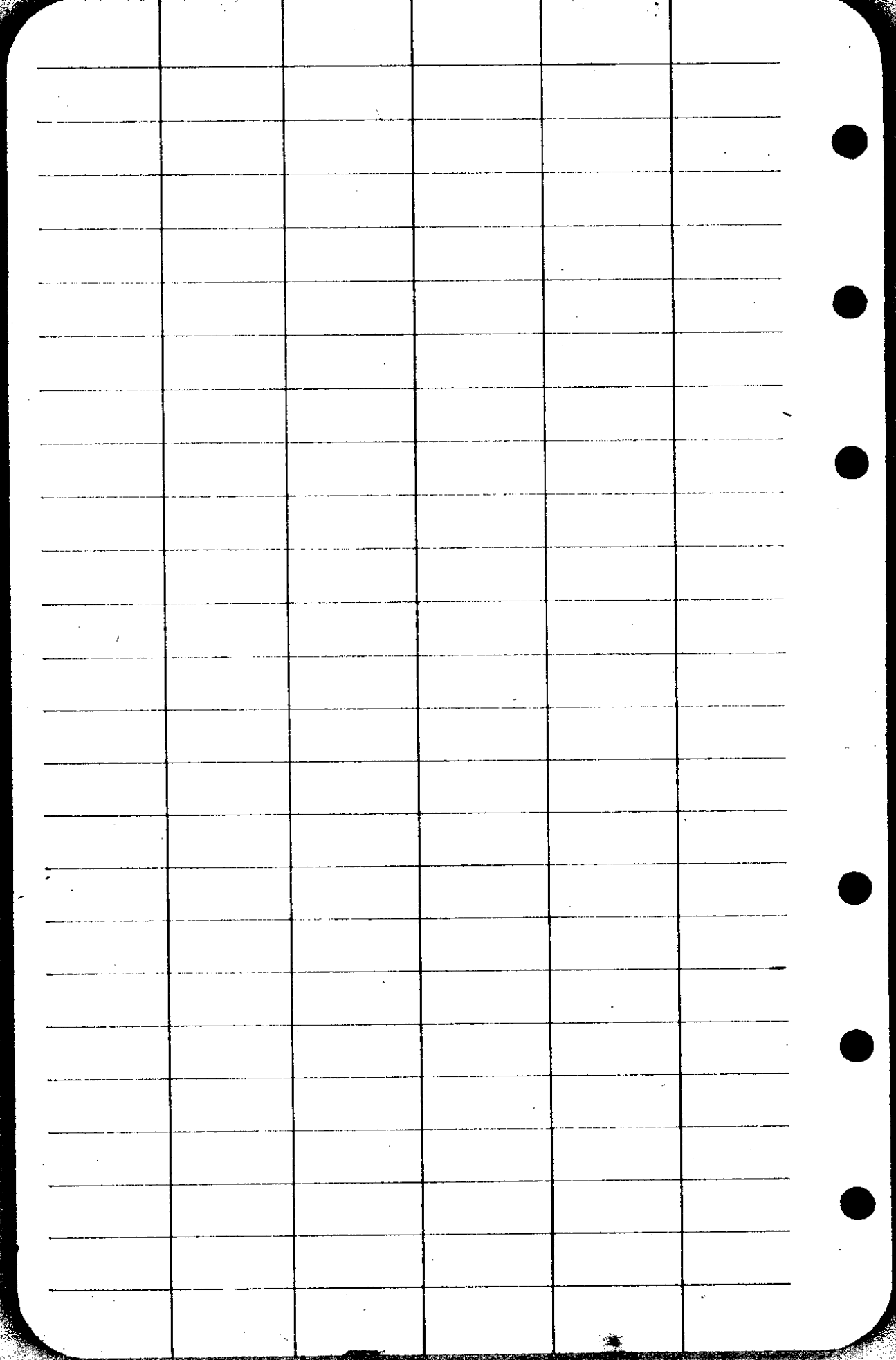

36
52
16
52
36" High
52" Wide

~~N 83° 51' W~~

~~E 20° 17'~~ 94.460

135.8
60
195.8

Δ 5

S 89° 13' W

Δ 6

143.5

1/4 ac 29/30

S 11° 29' W

192

S 10° 59' E

462.4

Δ 7

330
1.5
345 North

336.4
336.4

N

672.8
15
687.8 South

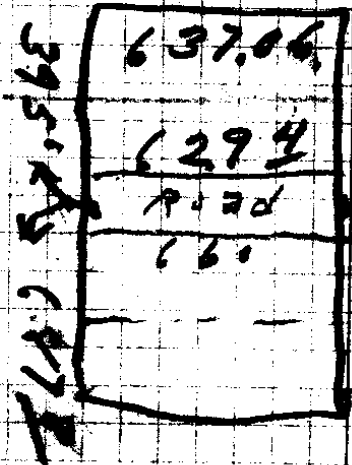

Road

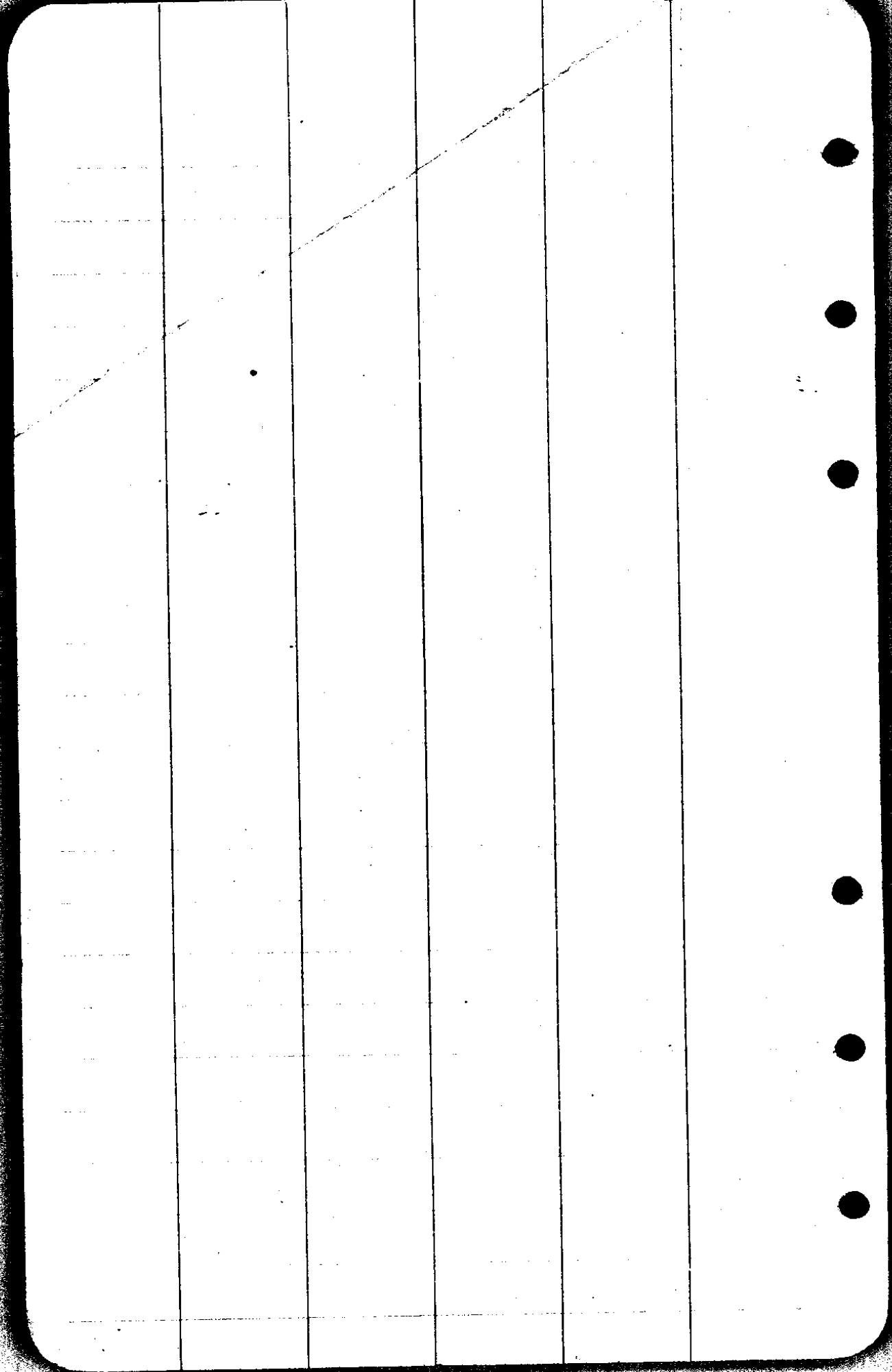

CS FILE FOLDER

CONTAINS

MORE

INFORMATION