

May 14-1941
 A. Boyer
 Jim Adams
 G.W. Woolfolk

G.S. File No. 34/50

At this pt. is NE cor 5A tract River 76's

5 = 1/4" Rein Steel = NW cor Stat H. wy 25
 S 76° W 252.0

4 = N Side Hy Prop Δ 78° 44' R = L Bar
 S 32° E 325.4' + 6.0' along fence

4.5's
 Fence Rod
 2" Rod

3 = Fence Cor Δ 74° 45' R
 S 78° E 191.5

202
 191
 11

2 Δ 7° 34' L

S 73° E 236.5'

1 Δ 0° 26' L

S 71° 47' E 300'

cap. 3 - 17.0 = 835.3 use this

1/2" Pipe NW cor Property S side Hy on
 98.1 F B Line DLC 37

4 on N Rail

115.7 F

3

113
 25
 25
 10
 10
 52

277.0 13° 974 - 269.7

2

74° F

1

South 286° - 50' x 996 = 284.8

0 to DLC Cor = NE cor Robt Phipps #37
 was in skin

~~5 AC Tract~~

" 5 AC Tract goes S to Iron Pin
which is $\frac{1}{4}$ Sec Line abt 80 Pnts
South. - go $\frac{1}{2}$ way^S thru homestead
of Jim Adams (S)

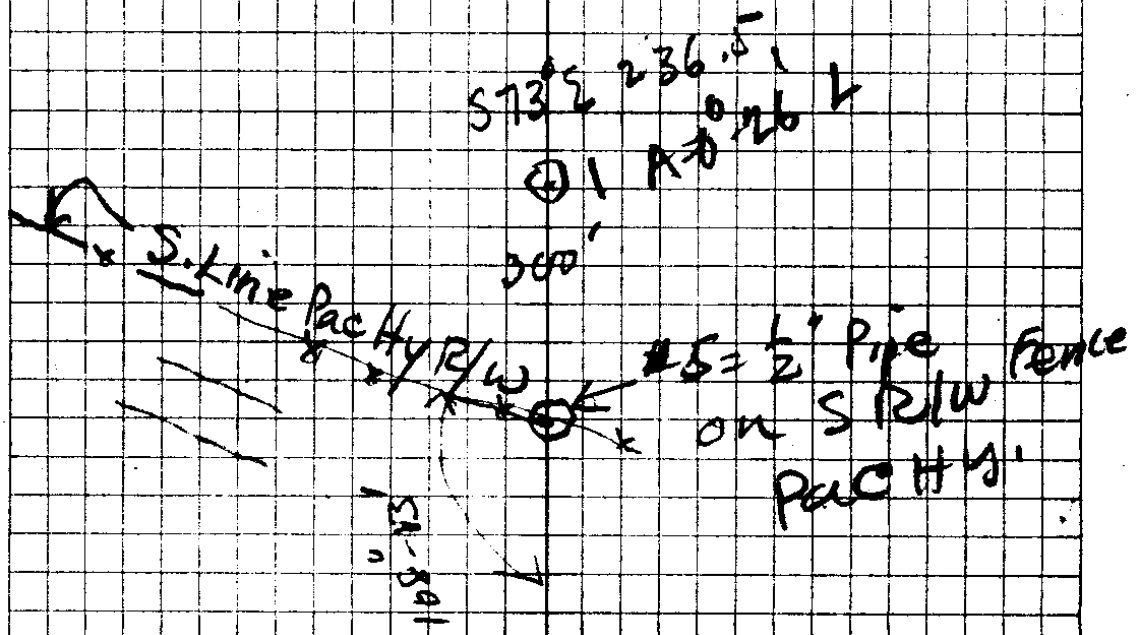

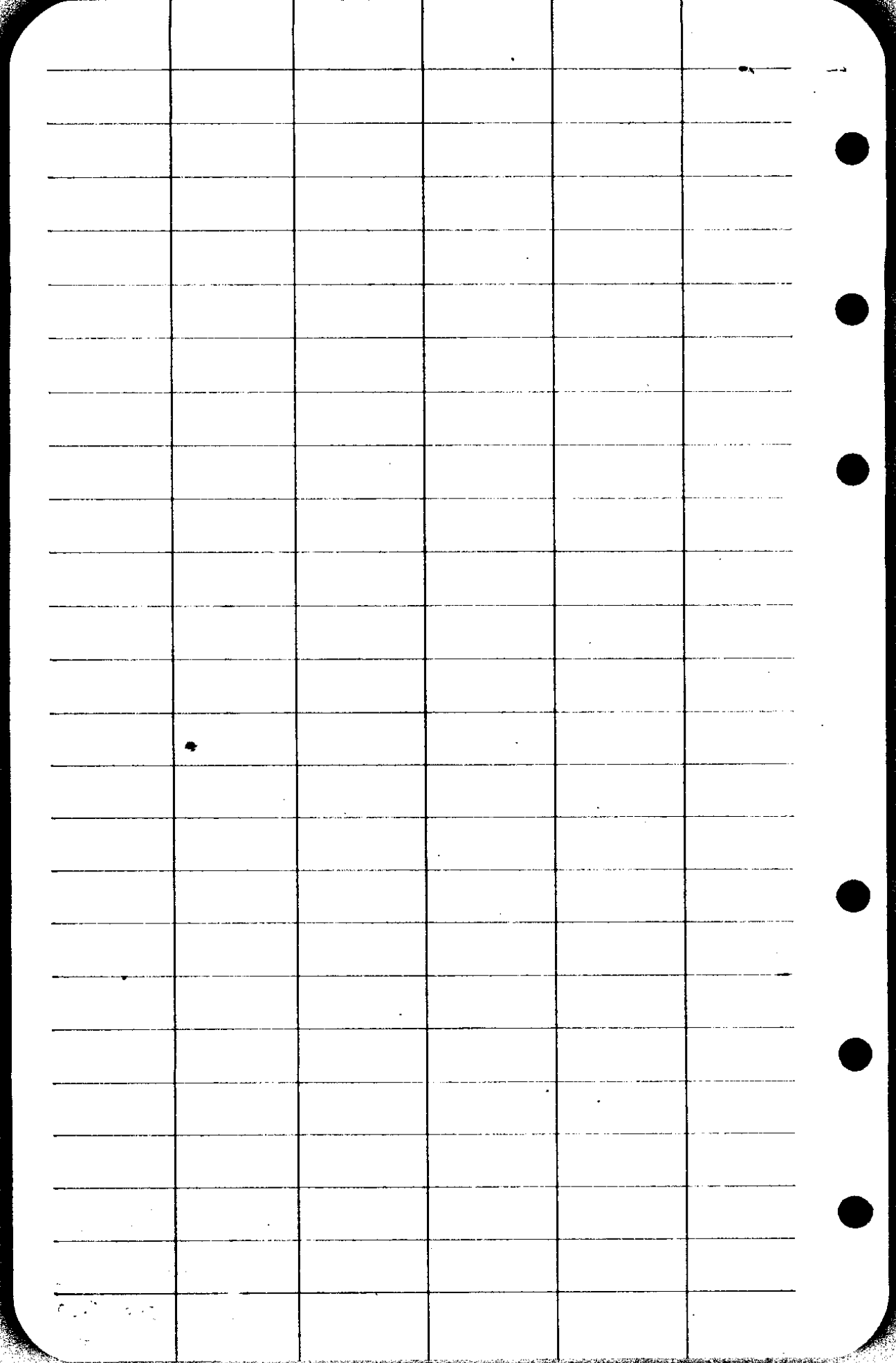

NW Co Tract

N 579' 0

ON DLC Line

$\Delta 75^{\circ} 53' R$

$\frac{1}{2}$ " Pipe \swarrow "Leonards" NW Co
ON-DLC Line - at Leonards N Line $\left\{ \begin{array}{l} 67' N: \\ DLC \\ line \end{array} \right.$

WEST 190.0

$\Delta 4^{\circ} L$

\swarrow $\frac{1}{2}$ " Pipe = Leonards NE Co Hmpstead
6" NW Co 5 AC = NTS Mid Sec Line 3?

N 86 W 284.0

$\Delta 18^{\circ} 55' R$

5 -

300	16 1/2	284	284
250	40	660	1320
		17040	5680
		1704	854
			284
			374880

579

43530	374880
	368480

1000
3
5/200
114
1000
1000

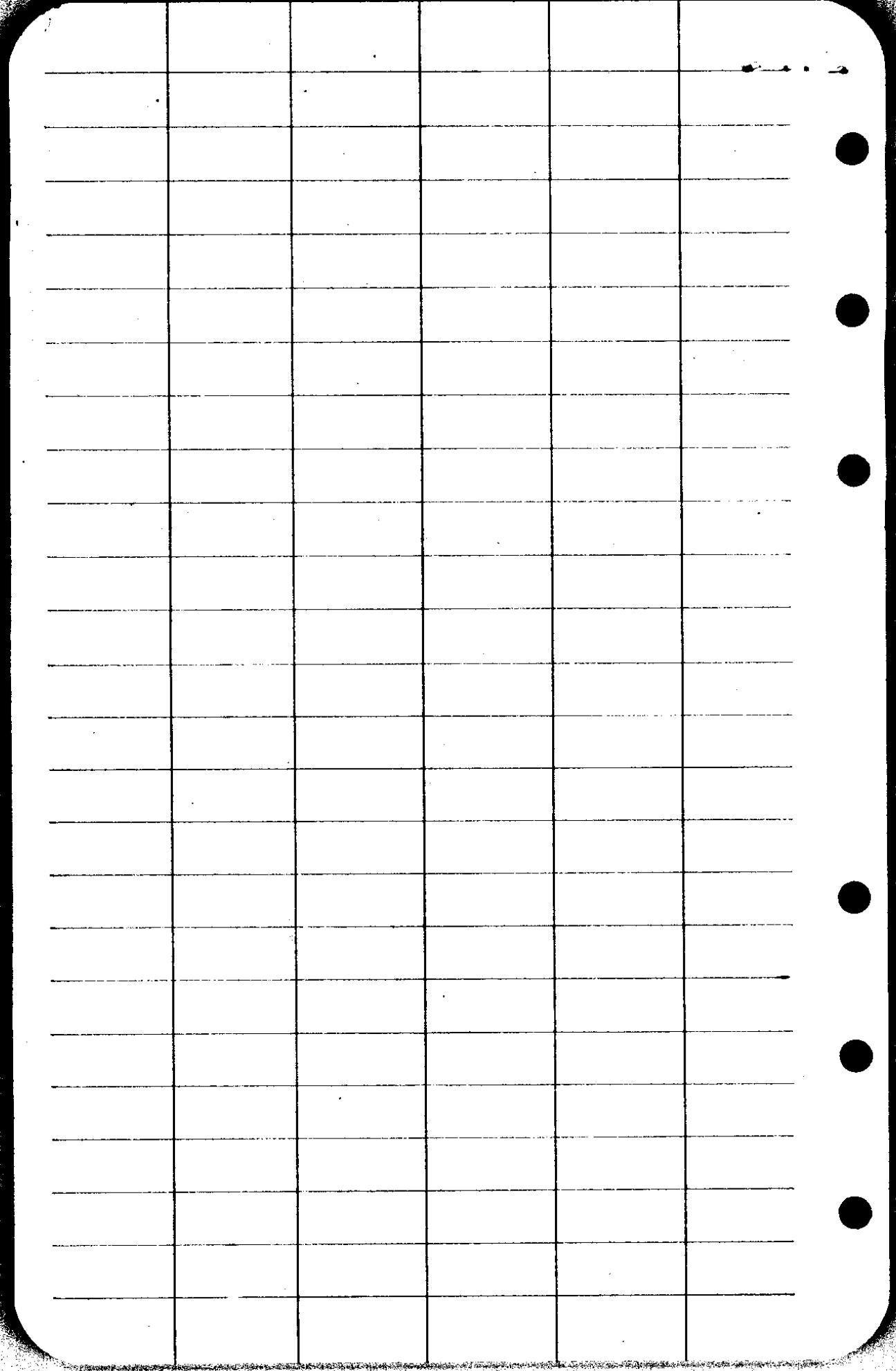

CS FILE FOLDER

CONTAINS

MORE

INFORMATION