

~~38/23~~
33/23

64	92
66	64
324	572
387	572
4224	60.7

N/S

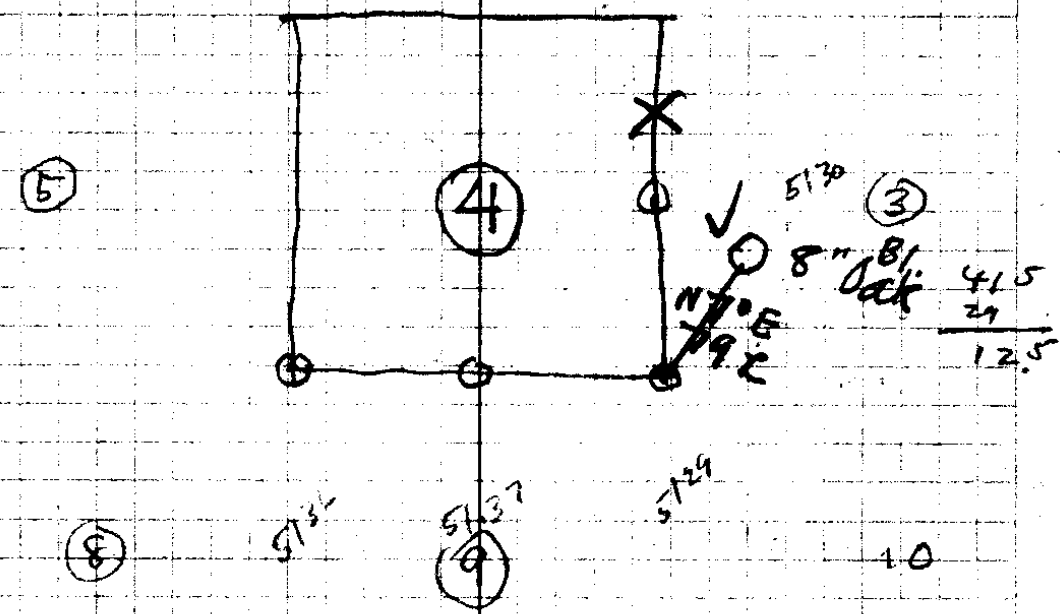

N bet 3 + 4 random
 S 12-14' E on true line
 6.5 = top hill
 24.5 foot "
 29. creek C S 80 E
 41.55 = 44m { 8" L. S 17 1/2 E 64 Z
 { 8" y. Oak S 81 W 92 Z = 60.7
 42.5 = top ascent
 55.5 = ravine
 64.5 top ridge
 81.55 = ca

 n bet 9 + 10
 78 = bed stream C SE
 50 = ca. - 3 + 9 10
 24" y. o
 8 17 1/2 E 187
 9" W. O. S 23 1/2 W 180 Z

10" y. o n 78 1/2 E 260
 11" Z. n 77 3/4 W 234

N 89-40 E bet 4+9 random

S 89 6 43 W on time line

2.0 = Creek

15. Top account

31.25 = ravine

35.2 top

40.01 = 4 cor

16" y.o n 55 W 55 L

14" " S 22 2 89 L

48 top

65 first hill

68.25 Creek

72 valley

80.02 = creek

n 0-09 W bet 5+9

71 = Creek

80 = cor

10" y.o n 54 W 20

15" L. n 80 E 69

5" y.o S 80 E 37

36" Pine S 79 W 138

157 10
 66
 11 22
 11 22
 12342

"A"
opp cor
Δ 9

WARE BRUS
S 044

THURS
June 9-44

0.1
0.47 = 41
1.0 +22° .927

~~1.33~~
1.4 Total

Δ 8 3.0 F

Δ 7 0.36 F

Δ 6 1.0 +26 0.899

2.0 F

Δ 5 0.53 F

1.0 +19° -0.945

1.0 F

Δ 4 0.705 +23 0.920

1.0 +31° = 0.857

3Δ = 180°
3.0 F

2 3/4 S x 0
0 5/8 N x 0
0 5/8 E x 0
→ 2Δ 180°

1.0 F

1 Δ 180°

0.47 F

1.0 F

1.0 -19 .945

1.0 -19 .945

1.0 -20 .939

1/16 cor = 1/4 mi S of N E cor Sec 4 27/3

57
238
788

9
79

9

7.8

1.4
927
473

12.5
11.8
1.4

3.0
859
920
945
.53
2.899
3.36

13.511
2.38
11.13

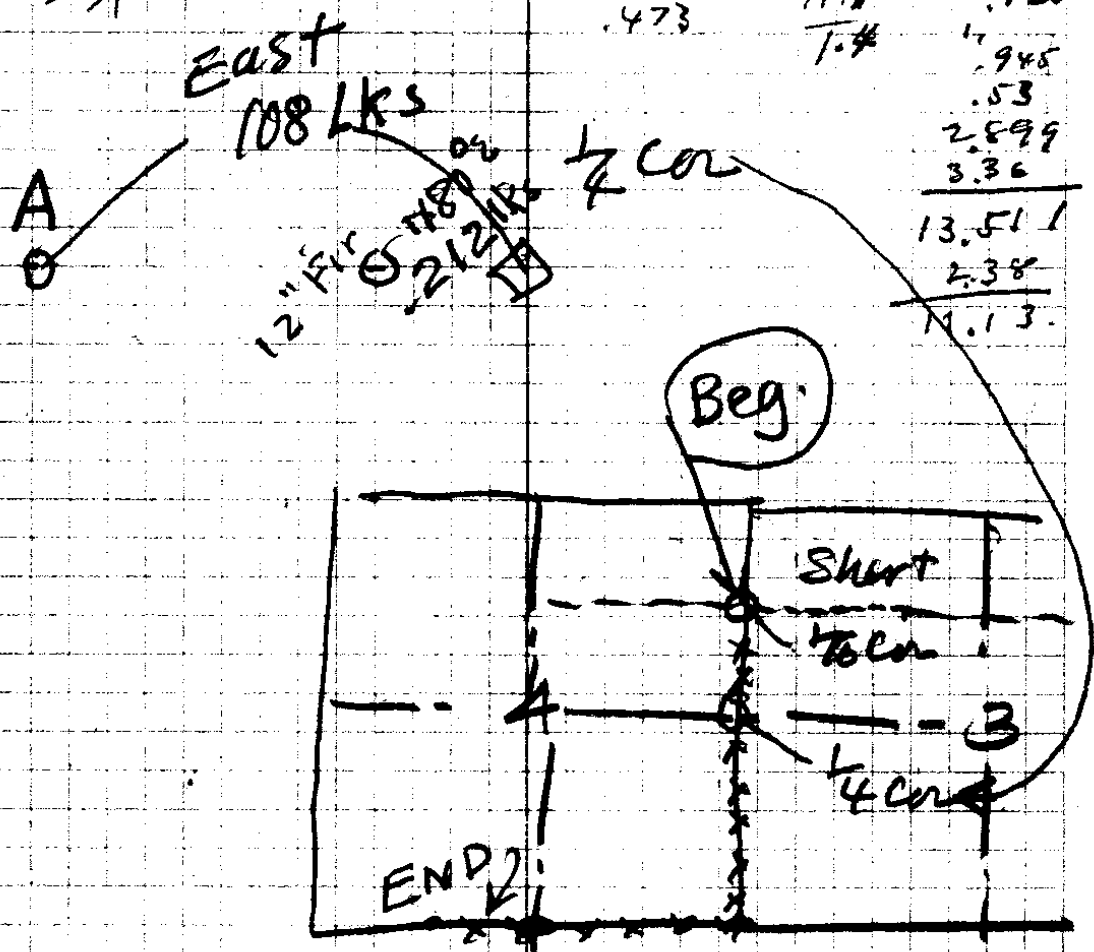

South

$\Delta 10 = 25.136$

2.0

$\Delta 9$

4.0 F

$\Delta 8$

1.0 F

1.0 $+21^\circ$ 933

2 Flat

$\Delta 7$

1.665 F

Ditch
at C South
6

2.125

$\Delta 5$

2.5 F

$\Delta 4$

3.0 F

$\Delta 3$

4.0 F

$\Delta 2$

1.0 F

1 Top Ascent

1.0 $+24^\circ$ 913 ✓

4:40
P.M.

det 384

19.913	4
19.5	6
2.125	1
1.665	2
2.	6
.933	7
7	
<hr/>	
25.136	

$\Delta 16 = 40 \text{ Ch } 3 \text{ } \left. \begin{array}{l} \text{of } 1/4 \text{ cu} \\ 123 \end{array} \right\} \begin{array}{l} \text{THIS DT IS} \\ 519^\circ \text{E } 77 \text{ Ks} \\ \text{from cor.} \end{array}$

$\left. \begin{array}{l} 1.0 \text{ } 21 \text{ } .933 \\ 1.0 \text{ } 22 \text{ } .927 \end{array} \right\} 1.86$

$\Delta 15$

$\left. \begin{array}{l} 1.0 \text{ } -21 \text{ } .933 \\ 1.0 \text{ } -17 \text{ } .952 \\ 1.0 \text{ } -21 \text{ } .933 \end{array} \right\} 2.82$

$\begin{array}{r} 4.68 \\ 23 \\ \hline 4.91 \end{array}$

$\Delta 14$

0.39 F
 $1.0 \text{ } -21 \text{ } .933$
 $1.0 \text{ } -17 \text{ } .952$

$\Delta 13$

$1.0 \text{ } -20^\circ \text{ } .940$
 $1.0 \text{ } -18^\circ \text{ } .951$

$\Delta 12$

$1.0 \text{ } -15 \text{ } .966$
 $1.0 \text{ } -23^\circ \text{ } .920$
 $1.0 \text{ } -22^\circ \text{ } .927$
 $1.0 \text{ } -20^\circ \text{ } .940$

10739

$\Delta 11$

$0.905 \text{ } -19^\circ \text{ } .855$
 $1.0 \text{ } -16^\circ \text{ } .961$
 $1.0 \text{ } \text{F}$

$\Delta 10 = 25.134$

100
32



.945
9.05
4725
8505
855225

1.000 1
.961 7
.855
.940 4
.417
.920 2
.966 3
.951 6
.940 4
.956 2
.933 6
.390 3
10.739

25.136
10.739
35.875

40.98
35.87
4.91

218155
40.78

933 933 491
952 927 282
933 1860 209
2822 156
23

2 1/2 W.
 ↓

(8) 13.339
 W 0.564
 W 1.0 F

7/15

(7)
 W 0.905
 W 1.0 +16° .961
 W 1.0 +18° 951

(6)
 W 0.745

(5)
 W 2.44 F

(4)
 W 0.695 F
 W 1.0 +18° 951

(3)
 W 0.13 F
 W 1.0 +21° 933
 W 1.0 +25° 906

(2)
 W 1.0 +30° .866
 W 1.0 +23° .920
 W 1.0 +33° .838

(1)
~~W 0.23~~
 W 1.73

Sec Cn -3-4-9-10

1.736	2	
.838	(1)	
.920	2	
.866	(2)	
.906	(6)	
.933	(4)	
.130	(4)	
.452	(6)	
.695	(2)	
.244	+	
.745	7	
.951	6	
.961	7	(1)
.925	5	
<u>1.564</u>	7	
<u>13.839</u>		

West

14

13

1.56 F

2.315 F

(12)

*

0.13 F

1.0 +20

940

(11)

0.55 +32₇₄₅

.466

1.0 +32°

.848

creek →

1.0 F

1.0 F

1.0 F

1.0 F

1.0 F

1.0 F

1.0 -8°

.990

1.0 -13

.974

1.0 -16

.961

*

1.0 -17°

.952

1.0 -15°

.966

(10)

3.765

(9)

1.91

(8)

12.339

$$\begin{array}{r} 828 \\ .55 \\ \hline 4240 \\ \hline 46640 \end{array}$$

(2)

$$\begin{array}{r} 13339 \\ 1910 \\ 3765 \\ .966 \\ .958 \\ .961 \\ 974 \\ 990 \\ 6. \\ 848 \\ .466 \\ 940 \\ .130 \\ 2315 \\ 1560 \\ \hline 1075 \\ 36.020 \end{array}$$

1
2
3
3
2
1
2
6
2
7
4
4
2
3

(3)

$$\begin{array}{r} 40 \\ 361 \\ \hline 3.9 \\ 2235 \\ \hline .665 \end{array}$$

6

W	0.89	-240	913 = 0.81
W	1.0	-230	.920
W	1.0	-210	933
W	1.0	-210	933

5

W 1.34

4

W 1.53

3

W	0.775	+17	0.74 956
W	1.0	+22	.927
W	1.0	+28	.883
W	1.0	+14	.970

②

W 1.812

①

W 0.37

~~W~~

W 1.0 +190 .945

1/4 C₂

15

W 2.235

14

.775	(1)	.913	(5)
.946	(2)	6.89	
4650		5217	
3875		7304	
6975		<u>85257</u>	
<u>748900</u>			

15 / N15°E
 97 links
 1/4 Cor



C. S. File No. 33/22

9

0.72 F & Road on S Line Sect 4

1.0 -22 927

1.0 -25 906

1.0 -24 913

1.0 -24 913

27
5

8

3.0 F

7

W 1.96 F

W 1.0 -29 874

6

		.945
		.37
		1.812
0.945		.970
0.37	1	.883
1.81	1	.927
.97	7	.956
.883	1	1.53
.927		1.34
.74	2	.933
1.53		.933
1.34	8	.920
.933	6	.913
.933	6	.874
.920	2	1.91
0.81		3.0
.874	1	.913
1.91	1	.913
3.0	3	.906
.913	4	.927
.913	4	1.72
.906	6	
.927		
.72		
<u>64</u>		
23.264		

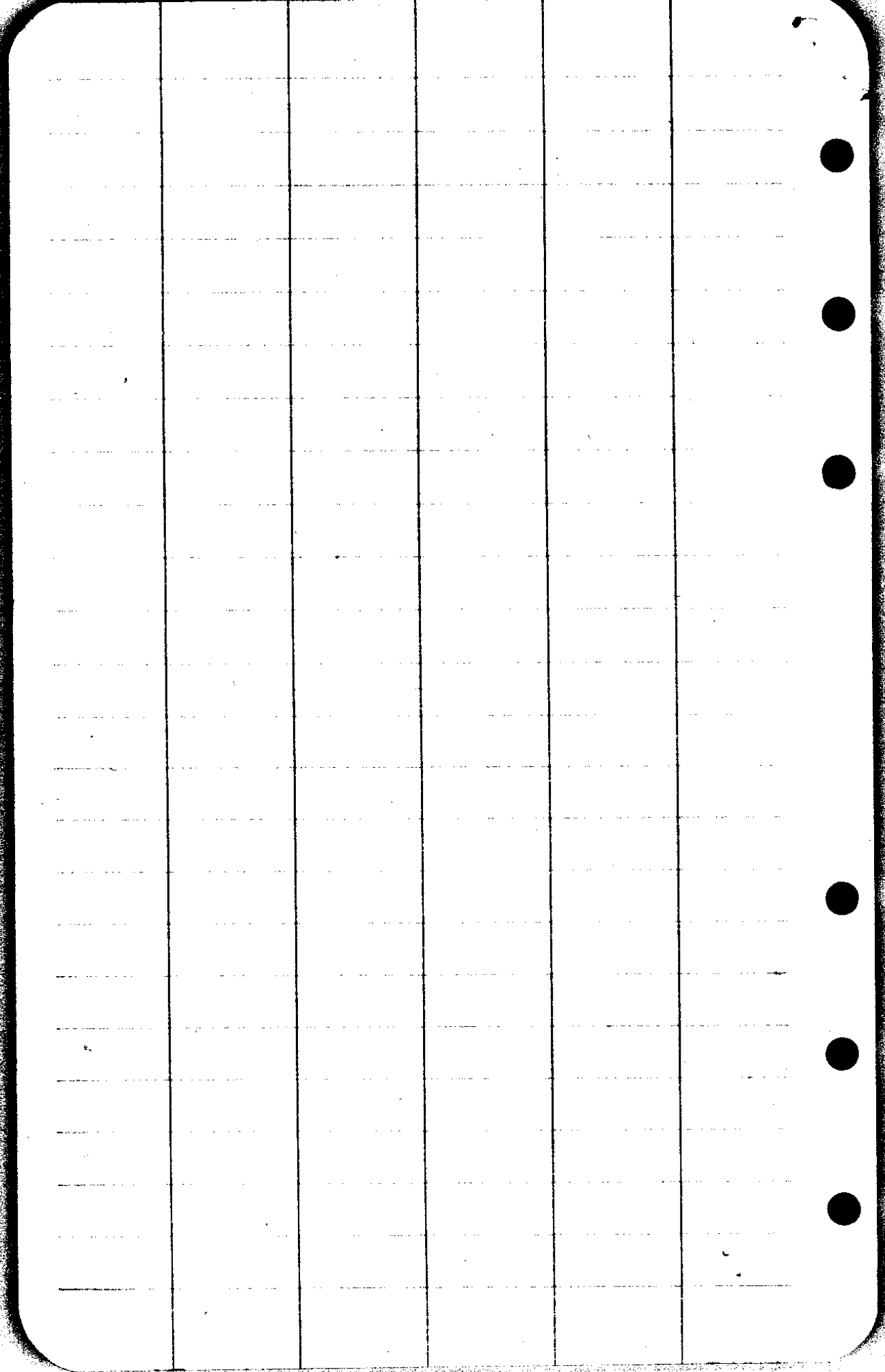

Darley + Gordon Ware

324
352
320
326.80

240
43.24
43.56
326.80

640
353
340
328
312
653.37

480
43.53
43.4
43.28
43.14
653.37

728.7
326.8
653.4
1708.9

$E^{\frac{1}{2}}$ Sec 5 } of Twp 27 S R 5 W W.M.
all-of " 4 }

and that part of Secs 32 + 33 T 26 S R 5 W. W.M.

which is described as follows:- Beg. at the S $\frac{1}{4}$ cor of said sec 32, thence running north along the center of said section

1405.9 ft thence N $37^{\circ}-38'E$ 359.3 ft;
N $62^{\circ}-38'E$ 423.2 ft., N $55^{\circ}-35'E$ 358.8 ft., N $65^{\circ}-37'E$ 906.7 ft;
N $50^{\circ}-02'E$ 586.9 ft., N $21^{\circ}-34'E$ 461.5 ft., N $20^{\circ}-57'E$ 305.6 ft.,
N $55^{\circ}-55'E$ 2344.3 ft and N $61^{\circ}-06'E$ 1081.6 ft to the N $\frac{1}{4}$ corner of said section 33, thence running East $\frac{1}{2}$ mile to the N E corner of said section 33, thence South one mile to the S E corner of said sec. 33, thence West $1\frac{1}{2}$ miles to the place of beginning containing 1708.9 acres more or less

Shirley S. Calhoun

That part of sections 3 + 10 T27S R5W
Beginning at the section corner of sections

3, 4, 9 + 10 Twp 27S R5W., Wm. Thence
running north $\frac{3}{4}$ th of a mile to the SW
corner of Lot 4 said Sec. 3, thence East
 $\frac{3}{4}$ th of a mile to the S.E. corner of Lot 2
along the East line of the W $\frac{1}{2}$ of the E $\frac{1}{2}$ said sec 3
said section 3, thence South to the
westerly line of county road no. 58
thence running along the westerly
side of said county road as
surveyed by Frank Cain County Surveyor
on March 7, 1915 to the South line of
the N $\frac{1}{2}$ Sec 10, said Twp. 27S Rq. 11
thence leaving said road and running
West along the south line of the
N $\frac{1}{2}$ said Sec 10 to the W $\frac{1}{4}$ Sec corner
of said sec. 10, thence north along
the West side of the NW $\frac{1}{4}$ said Sec 10
to the place of beginning - Also
the N $\frac{1}{2}$ of the NE $\frac{1}{4}$, the NE $\frac{1}{4}$ of the NW $\frac{1}{4}$
and lots 3, 4 + 5 of section 9
said Twp. + Rq. containing 779.63
acres, more or less

which is described as

John S. Calhoun

106
349

104
575

7692
8375
4317

6163
262
2738