

Randolph
Master line
(in sections)

Bear Dist Slope

309 -240

80.

265.0

265.0

300. 0

all Nov 21 '14

93. 5

144.0 0

106.0 0

113.0 0

166.0 0

118.0 0

250.0 0

over back
a hole of 1/2 in

down about
a small deep
mark had

Starting at a previously set
mark post on the Randolph -
Whitaker line.

∴ S. File No. 33/5

Bear Dist Slope

alt. N on 21 day

2659.0 Sec line, 925' W to

see cor.

106.0' mid sec line 21

191.0

130.0

177.0

197.0

~~17/16
20/21~~

~~82510~~ with ~~1/4~~ Cor. 20/21

Sta. Bear Post

40.0 to a w. of tree

300.0

171.0

N

~~240.0~~
751

starting

a "pair" from which to

[Faint handwritten notes]

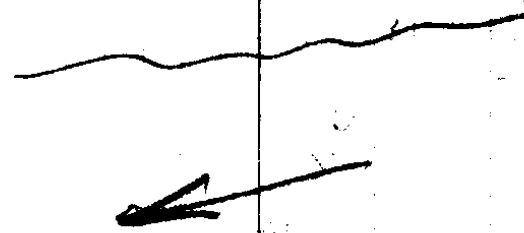

W.O. 30" PC.
North
Prop. Cor
Randolph +
Manufactors.

Dec 50 ✓

17	16
20	21

 Bears W 825.0 ft

C. S. File No. 33/5

Bear Pit Slope

70. +20°

to P.C. at

~~135~~ +22°
927

96.0 +28°
832

191.3

~~121.0~~ +28°

all S. on 21° Vg.

138.1 +21°

120.0 0

188.0 +20°

925.0

180.0 +20°

~~184.0~~ +20°
9396

153.0 0

180.0 +12°
978

176.0

158.0 0

1808.8

↑

161.0 0

then run w. 1086 to
establish, Johnson line.

oak stake
40 BT 8" w.o.
RP, PC, CS.

x 7
V V
540 w.
14° N 0°

BT, RP, PC, CS.
10" w.o.

South, PC.
Randolph +
Masters.

825
- 275

1100
1086

~~U.S. File No. 33/5~~

Memorandum

on the N-S line Randolph
starting at the mark set
previously set on app. E.W. see list

33/5

HAL L

Randolph Ave

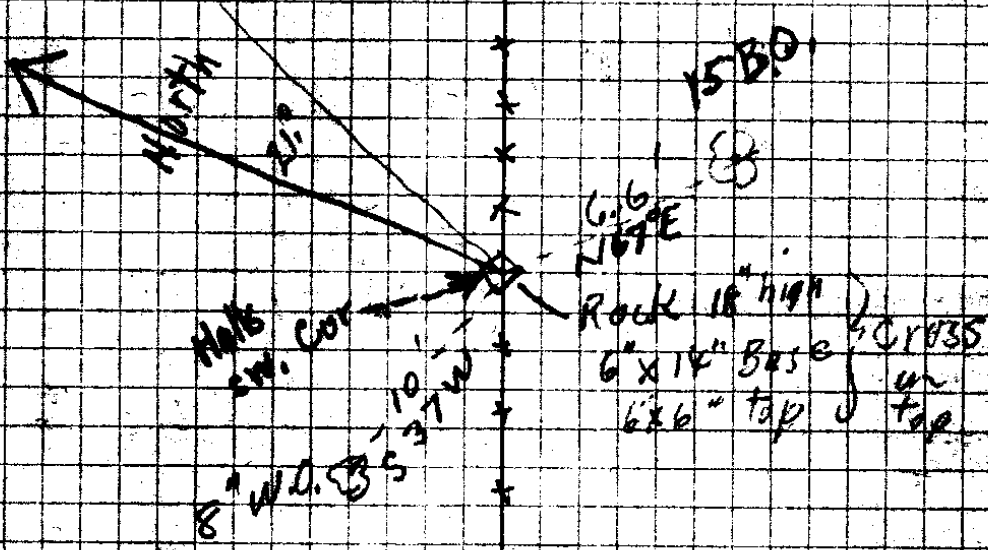

SEPT 28 44

Jones Estate - Hall Portion

10		164.0	-112.00	= 161.0	
9					
	N	138.0	FLIT		
8					
	N	238.0	-18	226.3	
7		= 1094.1	.951		9626.8
		78.0	F	78.0	
6		= 878.2	-18	137.9	
			.951		
		218.0	-30°	188.7	
5			.866		
		143.0	-26°	128.5	
4			.899		
		137.8	-21°	128.5	
3			.933		
		128.5	-19	121.4	
2			.945		
	N	220.0	-12°	= 215.1	
1			.978		
	N.	96.0	F		
Halls SW cor		0+0			

Boyer
Morgan
Church

96.	6	978	6
215.1		320	
		1956.0	
121.4	8	1956	
128.5	7	215.160	
128.5	7		
188.7	6	128.5	
		945	
878.2	7	6425	
2159		5140	
		11565	
1097.1		1214326	

137.8	6
933	
4134	
4134	

145.0	12402
	128,5678

951	899	8
238	143	1
7608	2697	
2453	3196	
1902	599	
226338	128.557	

982	866	7
164	218	4
3928	6928	
5392	866	
952	1732	
161048	188.788	

951	6
145	
4775	
3804	
954	
137895	
78	
215.9	

⊙ Halls
Srd on
on fence
Tub Ridge
s. No. 33/5

21

300.0

20

196.0 +5°

Leave Flat

19

285.0

18

335.7 F

17

287.0

16

$\left. \begin{array}{l} 583 \\ 300.0 \end{array} \right\} -F$
 -90°
 296.1
 .987

15

300.0 F

14

283.5 F

13 (25' N of Creek)

230.0 F

12

187.5 F

11

$243.0 -10^\circ$
 239.3
 .985

10

L.S.P.

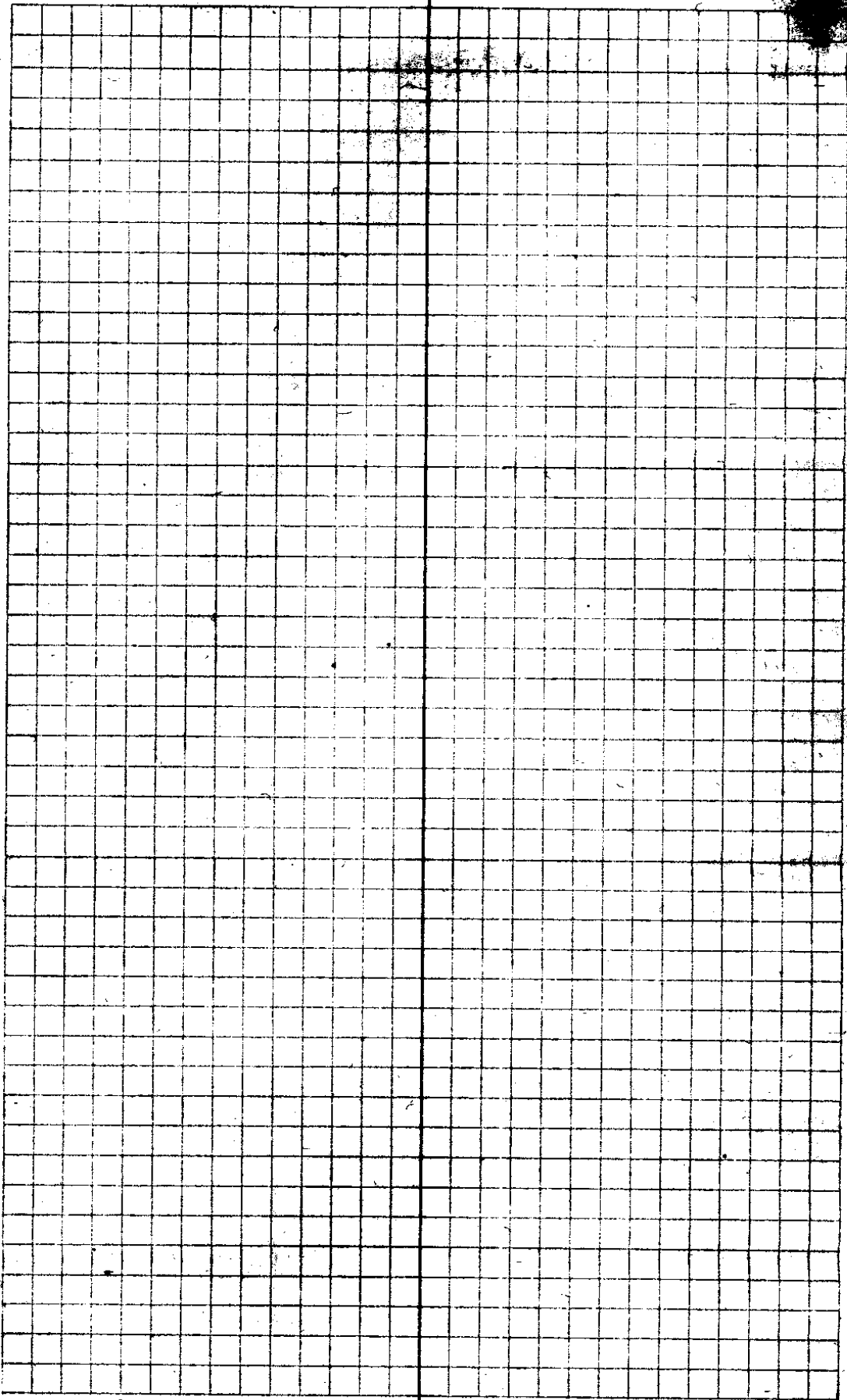

File No. 33-5

29

114.0 F

28

78.9 F

27

300.0 F

26

235.0 -6°

25

266.0 -5°

24

300.0 -8°

23

275.0 -8°

22

300.0

21

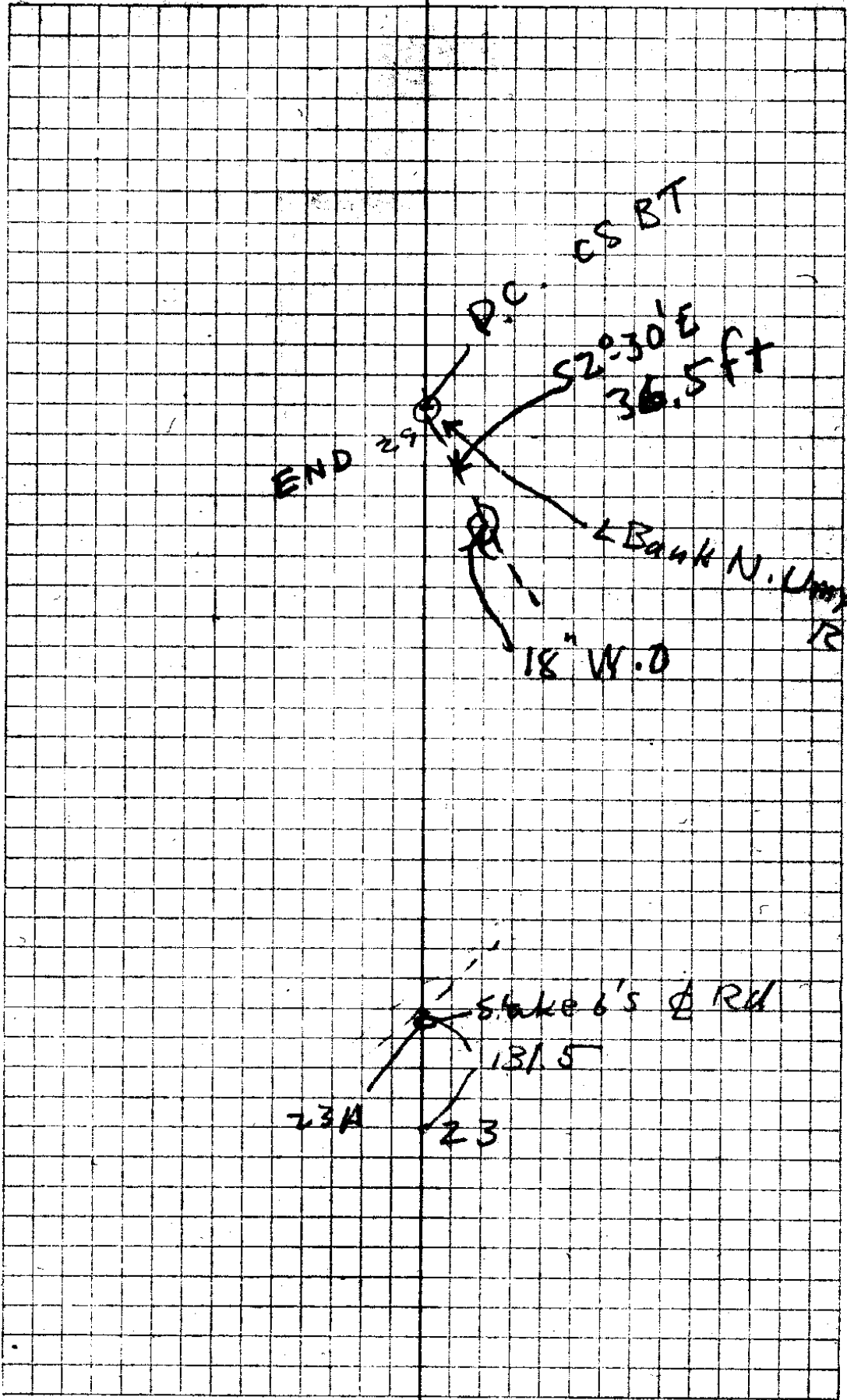

Bear Dist	Slope	
160	$-.99$ -20°	150.14
108	0	
170	0	
191	$-.913$ -24°	174.3
209	$-.94$ -20°	195.5
166	0	
300	0	
300	0	
217	0	
140	0	
300	$-.99$ -20°	282.

N on $21^\circ E$

... ..

between Gilherson's Master
starting at the S.P.F.

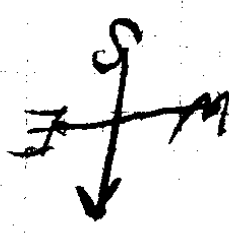

N30° E 10" B.O. marked R.P.C. C.S.

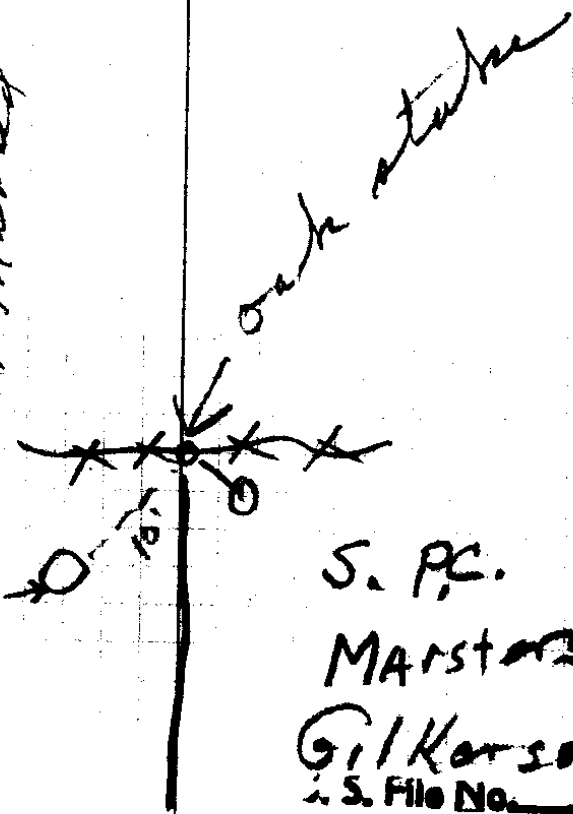

S. P.C.
MARSTERS -
Gilkinson
S. File No. 335

Beam	Pist	Slope	
	60.		
	300	⁹⁵¹ -18°	285.3
	110	0	
	300	⁹⁹² -7°	299.
	300.	0	
	300.	⁹⁹⁴ +6°	299
	205	⁹⁷⁸ -12°	200.5
	168.	⁹⁵¹ -18°	159.7
	110.	0	
	248.	⁹⁷⁸ +12°	242.5
	226.	0	
	218.	0	
	178.0.	⁹⁵¹ -18°	175.9

All N. on 21° E VA.

to a pt on the EXW
mid sec line 275' W
of the 4 cor 20/21

4889.1

Ben J's slope

on 21° V.R.

36. 0

232. 0

273. 0

~~591~~

2363.0 0

260.0 0

~~see line~~
275.0 E tr
see. cov.

4889
36
1289

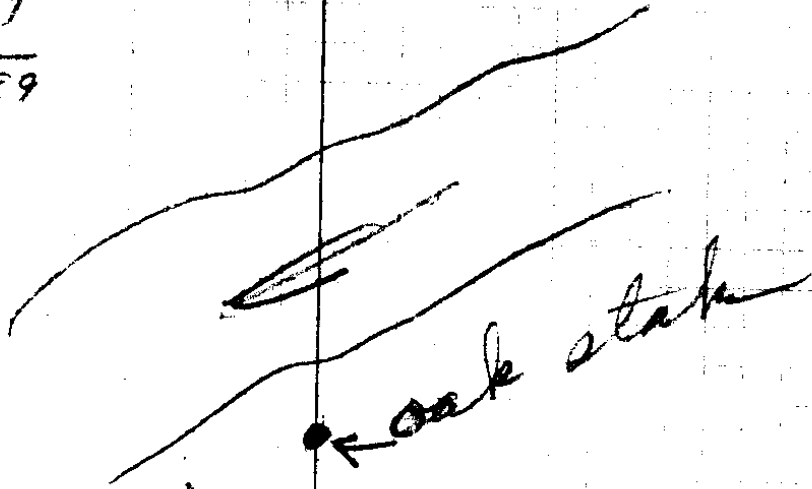

North
13.0

8" Black O,
* BT. R.P. P.C. CS

N.P.C.
Marsden - Gilkerson

To Prop Cor set
oak stake on
Riv. bank

~~all a line~~ 17/16
open field, scattered oak

1/4 cor 20/21

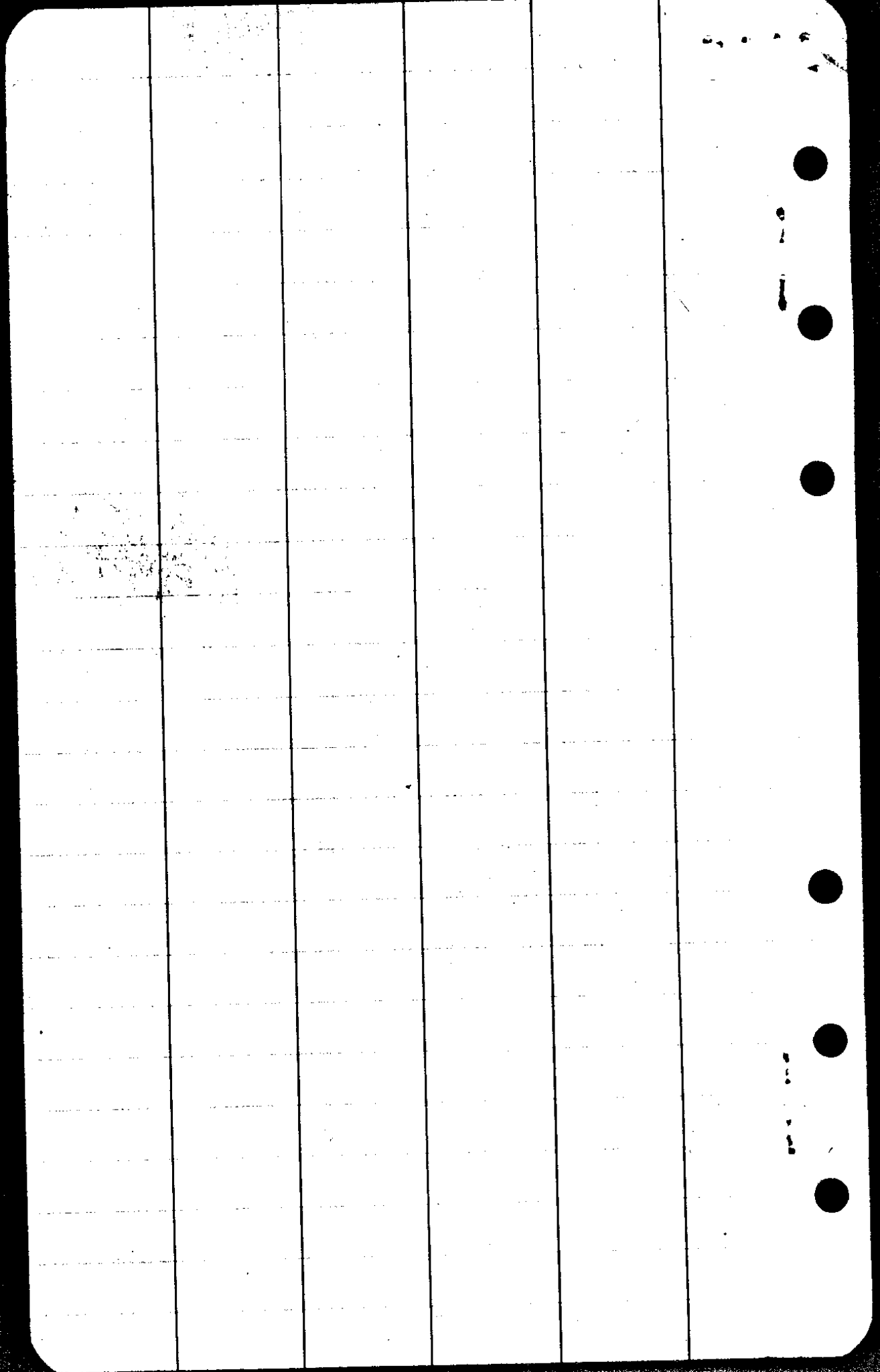

ROY AGEE, COUNTY CLERK
CLIFF THORNTON, SHERIFF
OLIVER L. JOHNSON, TREASURER
BARTON HELLIWELL, ASSESSOR
LULA C. GORRELL, SCHOOL SUPT.
H. C. STEARNS, CORONER
F. C. FREAR, ROAD MASTER
H. L. EPPSTEIN, SURVEYOR
AGNES M. PITCHFORD, PROB. OFFICER

D. N. BUSENBARK, COUNTY JUDGE
H. B. ROADMAN, COMMISSIONER
J. R. HUTCHINSON, COMMISSIONER
J. V. LONG, DISTRICT ATTORNEY

DOUGLAS COUNTY
ROSEBURG, OREGON

COUNTY COURT
FIRST WEDNESDAY
OF EACH MONTH

A LINE BEGINNING at the quarter section corner between Sections 28 and 33, T.26 S; Rg. 5 W; W.M., and running thence
S.61°-06'W. 1031.5 ft.
S.55°-55'W. 2344.3 ft. to a point on top of a ridge from which
a 22 inch fir tree marked Δ bears N.75°W.
11.0 ft., thence,

S.20°-57'W. 305.6 ft.

S.21°-34'W. 451.5 "

S.50°-02'W. 586.9 "

S.65°-37'W. 908.2 "

S.55°-35'W. 358.8 "

S.62°-33'W. 423.2 "

S.37°-38'W. 359.3 ft.

and
to a $\frac{1}{2}$ " pipe on a fence line or on the North
and South mid-section line of section 32,
Twp. 26 S; Rg. 5 W; Willamette Meridian, from
which a 7 inch white oak tree, marked with an
"X" bears N.22°E. 8.5 ft., said point being \pm
1405.9 ft. North of the quarter section cor-
ner which is on the south side of section 32,
said township and range, all of the above
line being in sec. 32 and 33.

Mar. 5, 1943

A.B.

To Mr Geo Jones, Attorney,
Perkins Bldg; Roseburg, Ore.