

33-1

Vic. Phipps
T. 28 S. R. 6 W
H. Eppstein
N. E. Richardson

C. S. File No.

33/1

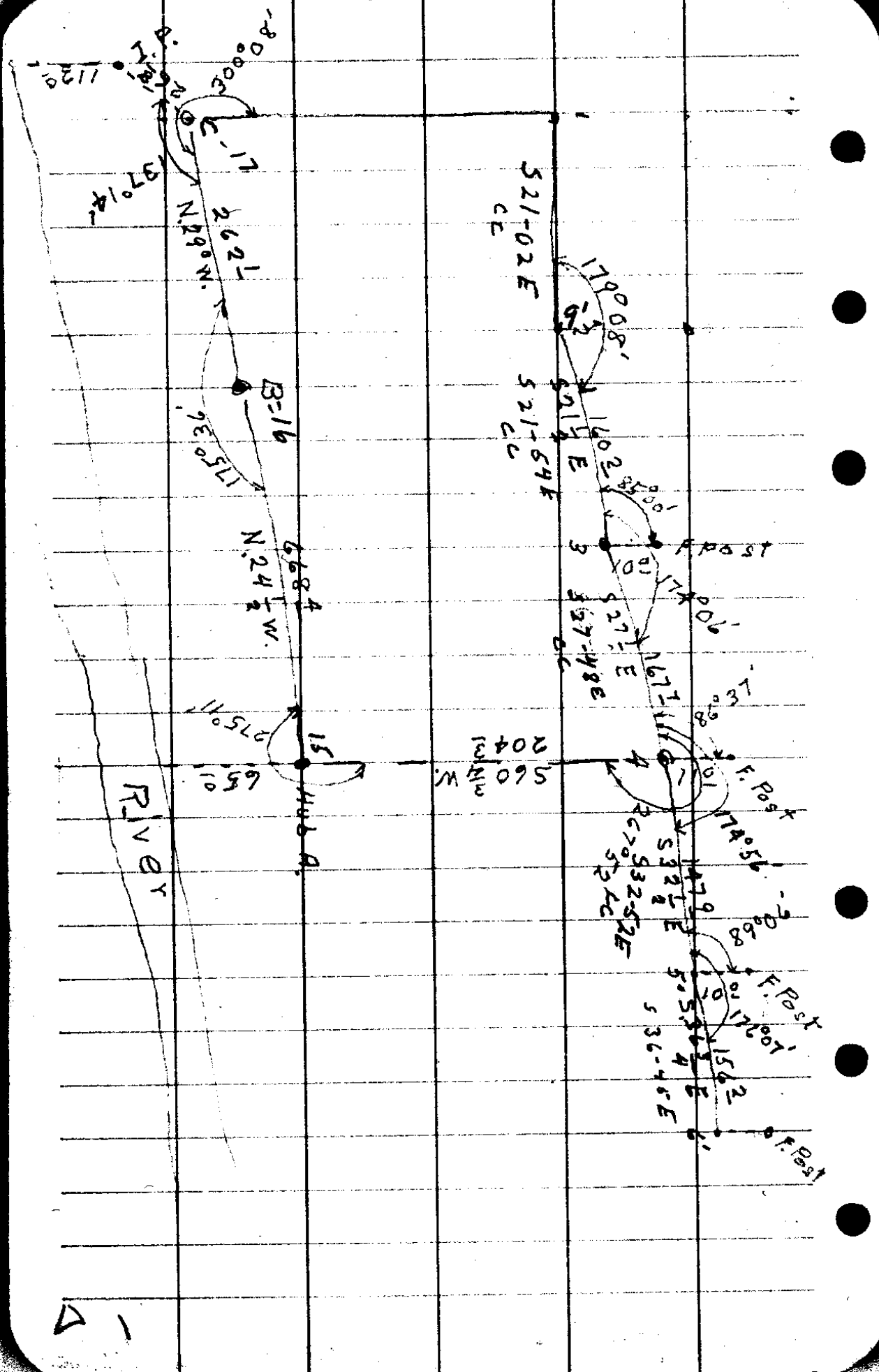

1

NE Bolt on signal on South side

R.R. Grade +.2 970 to Roschburg

$$69 \times 33 = 2277$$

$$\begin{array}{r} 499.52 \\ 4.55 \\ \hline 495.02 \end{array}$$

69 Feet

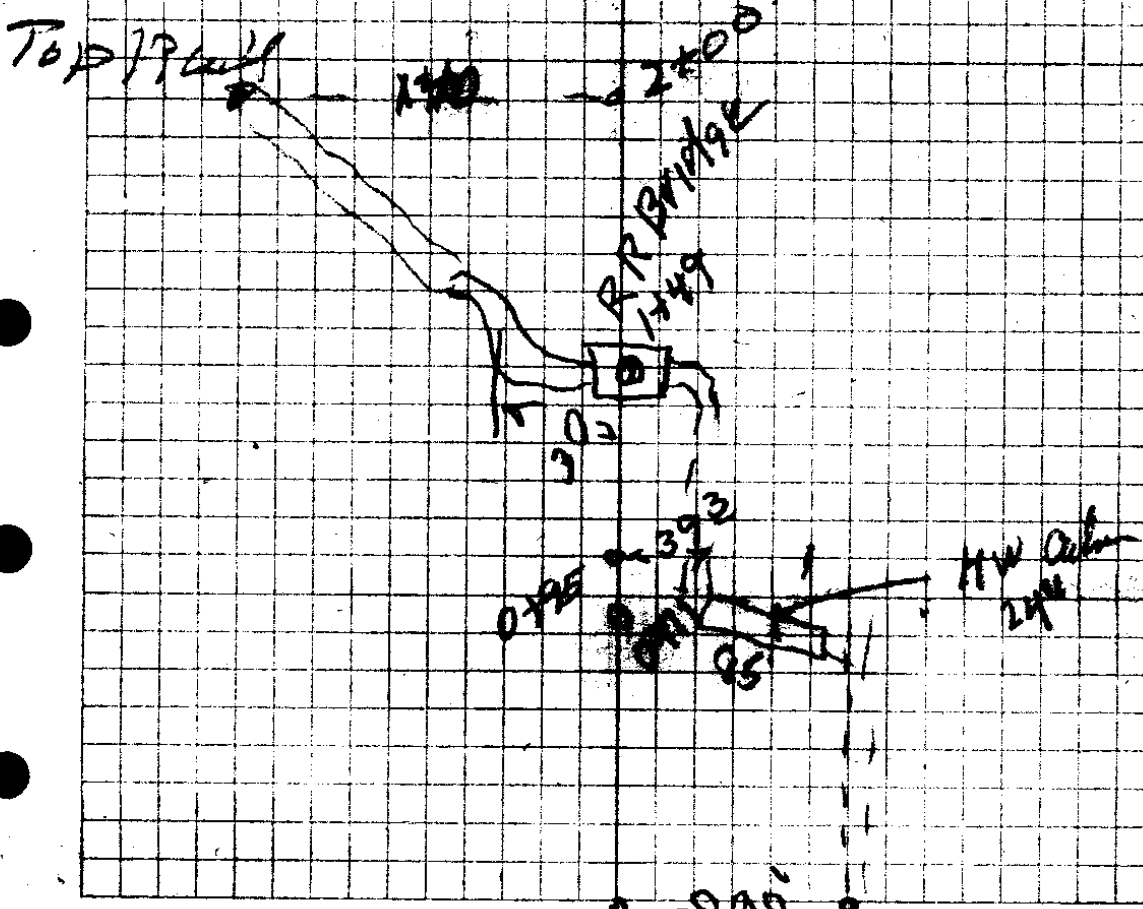

0+00 90'
C. S. File No. 33/1

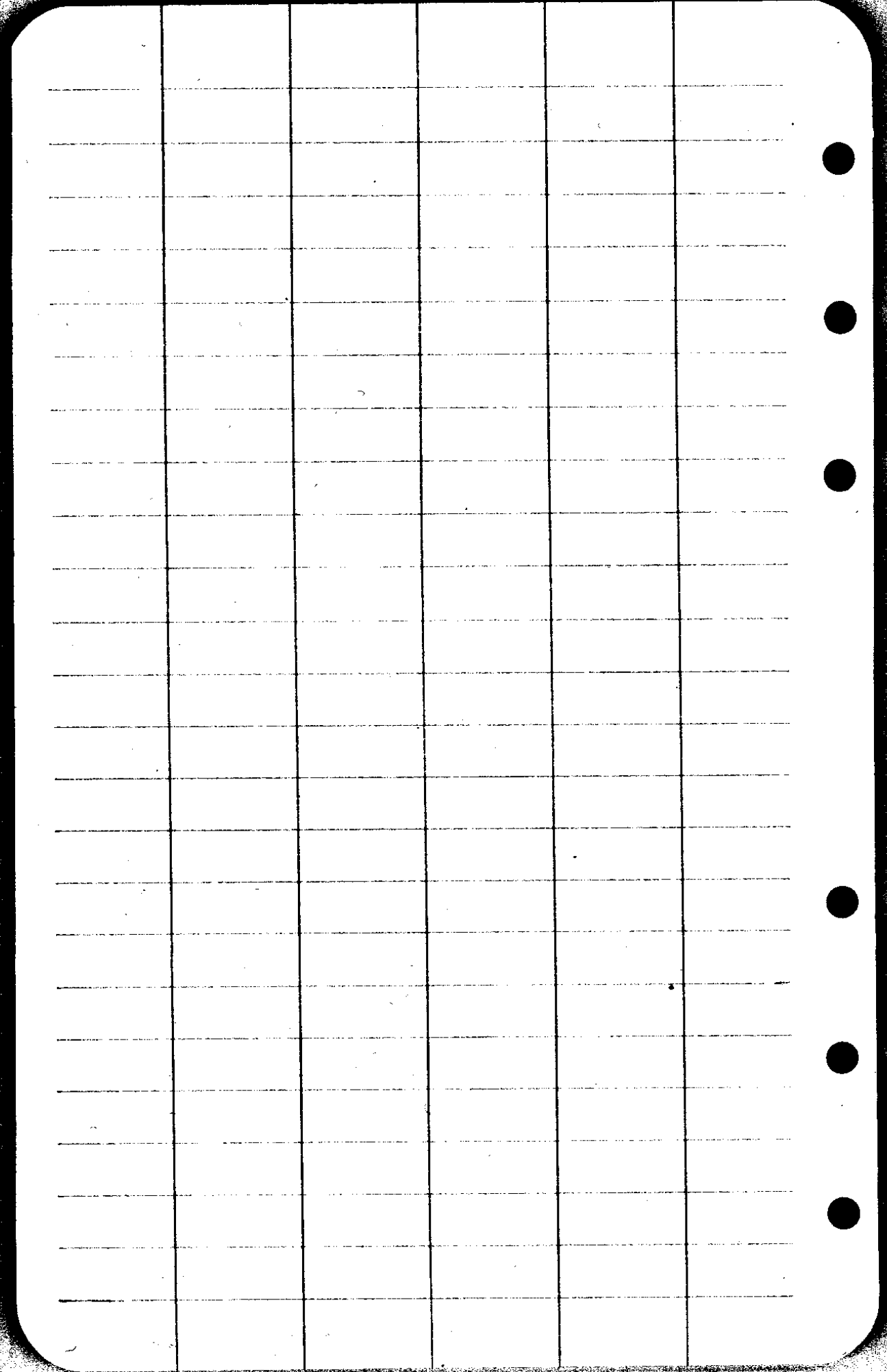

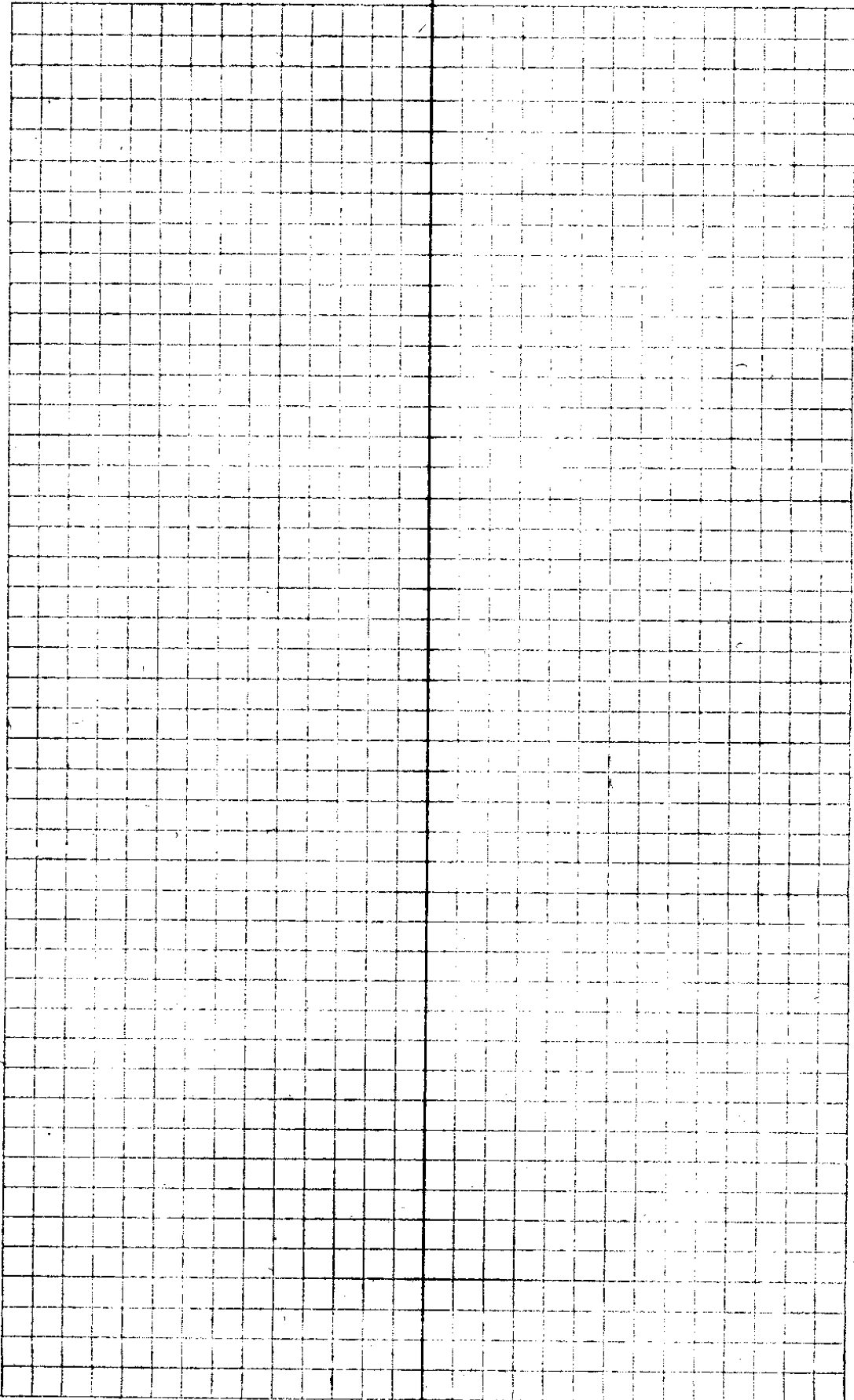

C. S. File No. 33/1

Sta Dist L R M.C.

3

501 2

15° 47'

N 15 44 W

2

575 8

12° 16' N

N 31 31 W

1

671 8

3° 43'

N 49 $\frac{3}{4}$ ° W N 43 47 W

A

Back Sight

17° 41'

Tack A
On Track

319 7 21° 50'

S 65 $\frac{1}{2}$ ° E.

8

7

28" B.O.

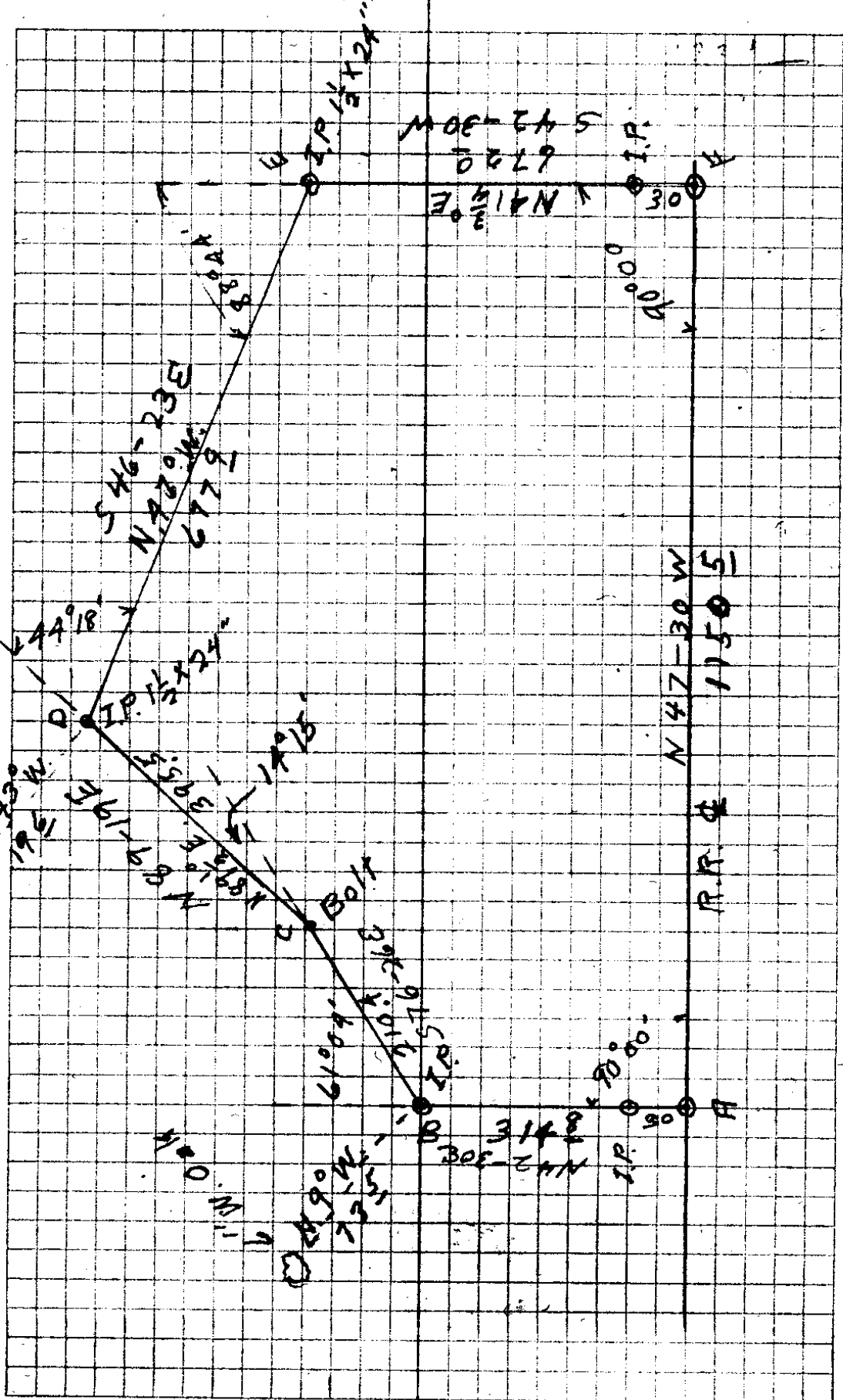

C. S. File No. 33/1

T285 RGW

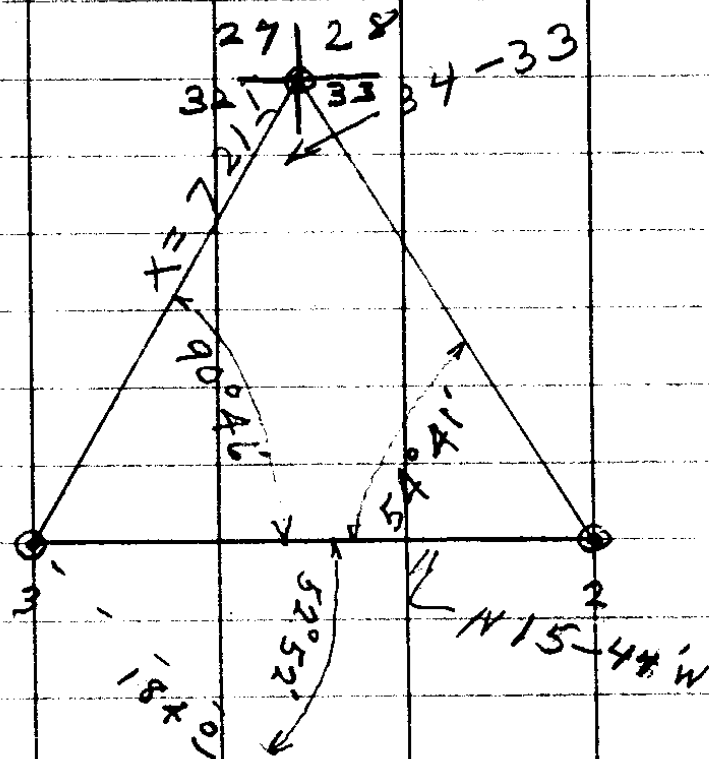

.56713

$$\frac{\sin 37-33}{\sin 54-41} = \frac{50.12}{x} = 721.1$$

81597

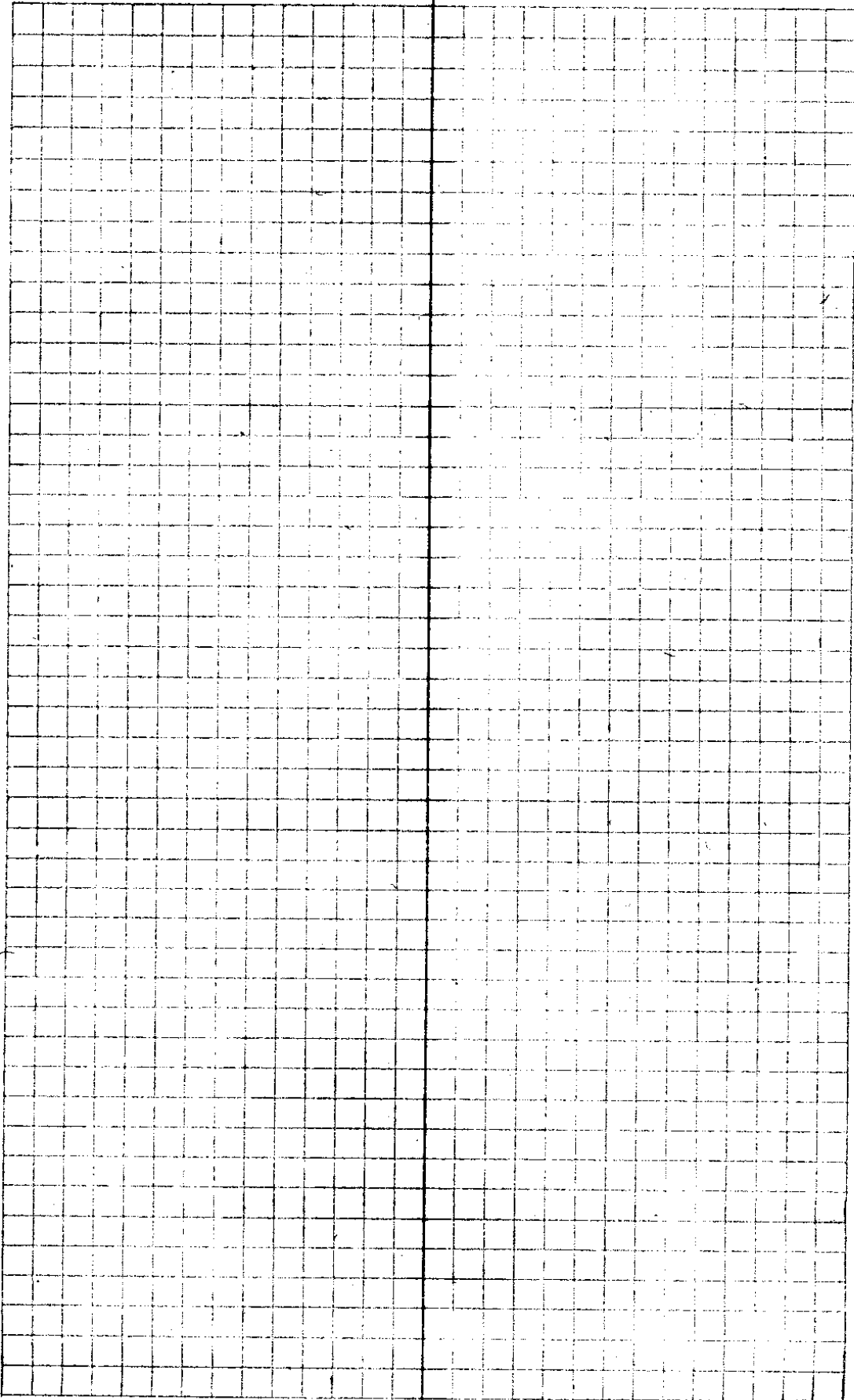

C. S. File No. 33/1

	+	∞	-	R	
	295	502.95			M 13 500 ^W

0+00 Ditch				11 ⁵	491.45
S End Culvert				11 ⁶	491.35
N E Culvert				11 ⁷	491.25
RR BV Smith				10 ⁵	492.45
N Finner RR Floor				9 ⁷	493.25
Surface water				9 ¹	493.85
2+00 Top Rail				2.98	499.97
0+00 " "				3.41	499.57

1.80 496.80 Bridge Railroad 495⁰

N Finner RR Right of Way				9.8	487.0
Oak Tree North of Ditch 500 ⁰ North				1.0	495.8
6 Rail West of Bridge				9.5	487.3
N End Highway Bridge HW				11 ⁰	485.8
S Right of way line HW				11 ⁷	485.1

3

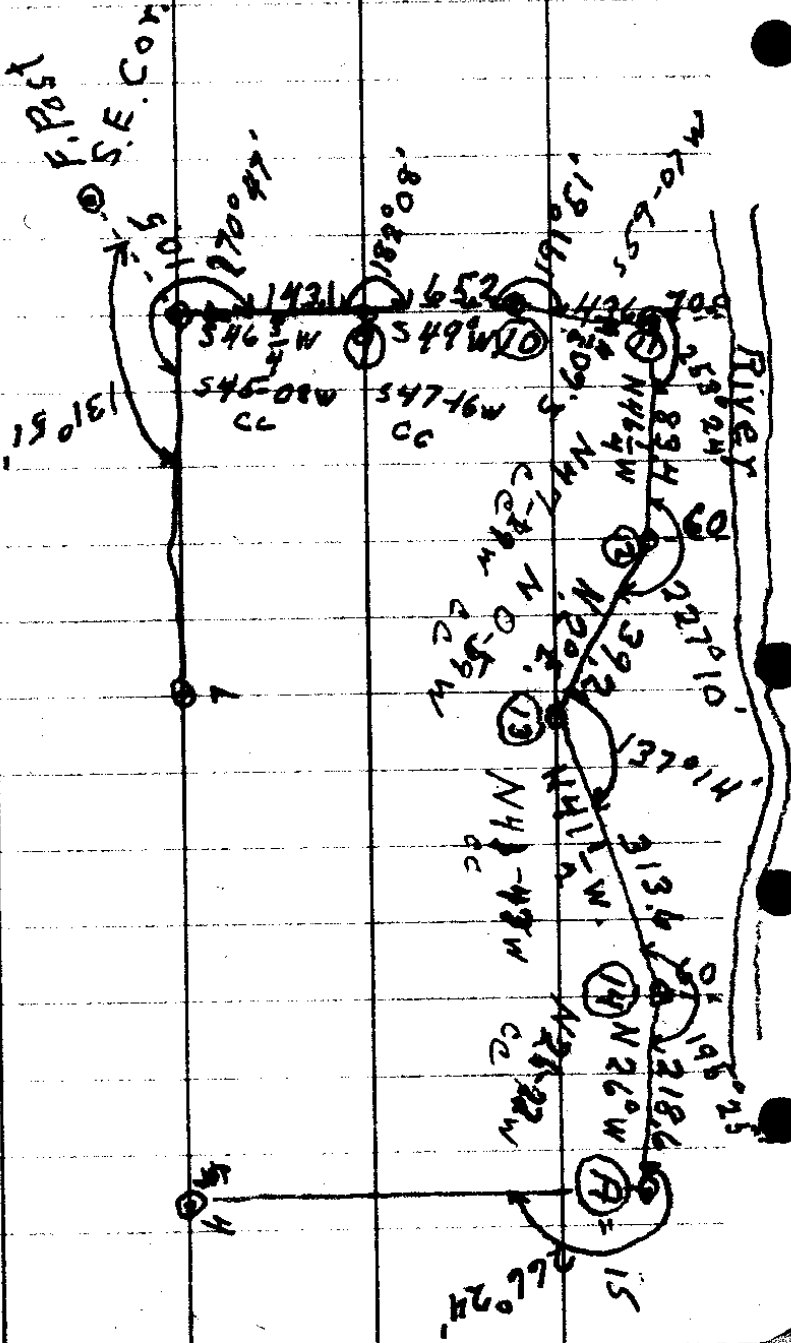
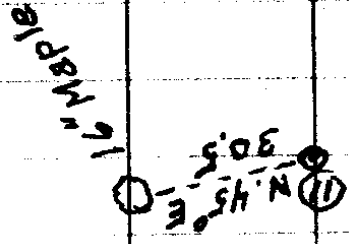
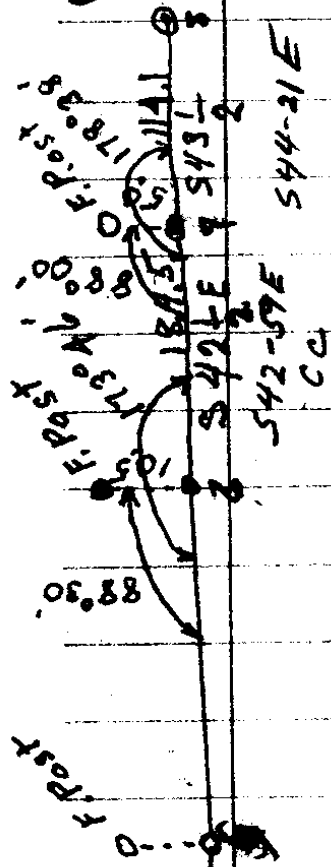

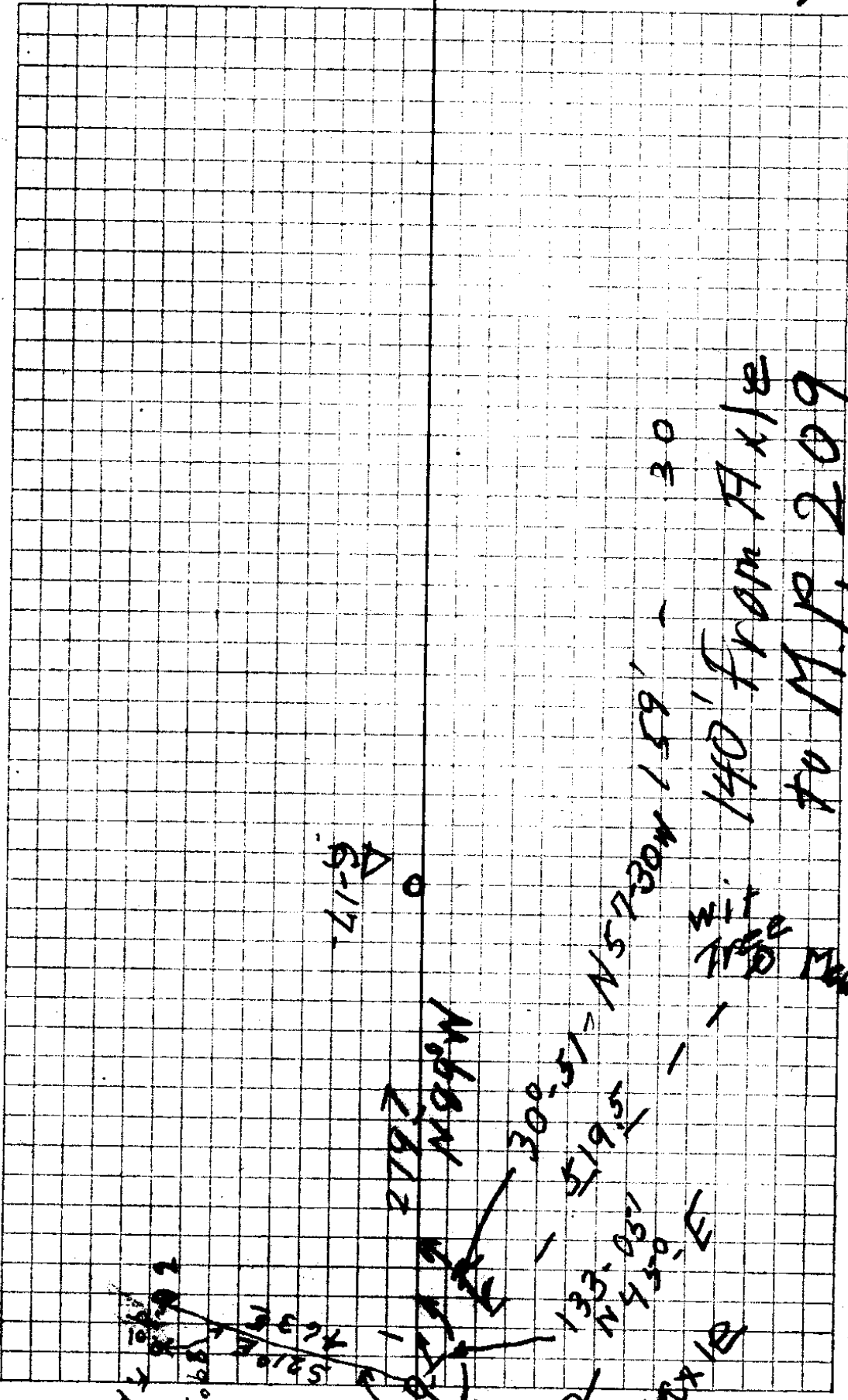

100' x 100' Plot
 15.65
 2470.58

A-17

279
 N 30° 51' W 19.5

300.51
 519.5

133° 05'
 N 140' from A x 1/8
 4.50

30

mit
 100' Menge

140' from A x 1/8
 to M.P. 209

No. 33/1
 S. Pl. No.

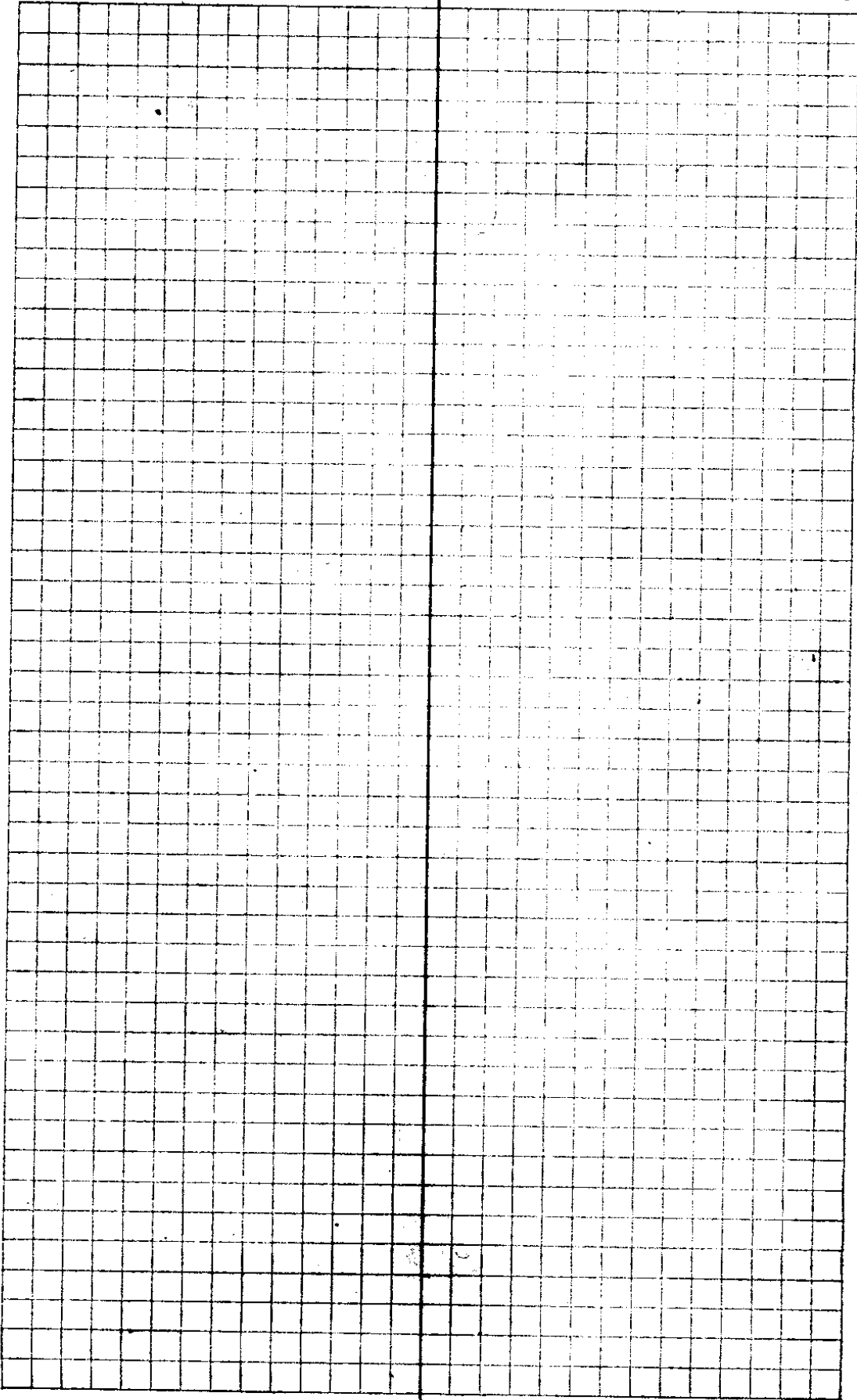

Sta	Dist	Ext Angle	MC	CC
12				
5.6 cu 11	83.4	253-24	N46 $\frac{1}{4}$ W	N46-11W
	43.6	191-51	S60 $\frac{3}{4}$ W	S60-25W
10				
	65 $\frac{2}{2}$	182-08	S49 W	S48-34W
9				
	114 $\frac{1}{2}$	270-47	S46 $\frac{3}{4}$ W	S46-21W
8				
	114 $\frac{1}{2}$	178-38	S43 $\frac{1}{2}$ E	S44-21E
7				
	184 $\frac{5}{5}$	173-46	S42 $\frac{1}{2}$ E	S42-59E
6				
	156 $\frac{2}{2}$	176-07	S36 $\frac{3}{4}$ E	S36-45E
5				
	147 $\frac{9}{9}$	174-56	S32 $\frac{1}{2}$ E	S32-52E
4				
	167 $\frac{7}{7}$	174- 56	S27 $\frac{1}{2}$ E	S27-48E ^v
3				
	160.2	179-08	S21 $\frac{1}{2}$ E	S21-54E ^v
2				
	463 $\frac{5}{5}$	247-58	S21-E	S21-E ^v
1				

7

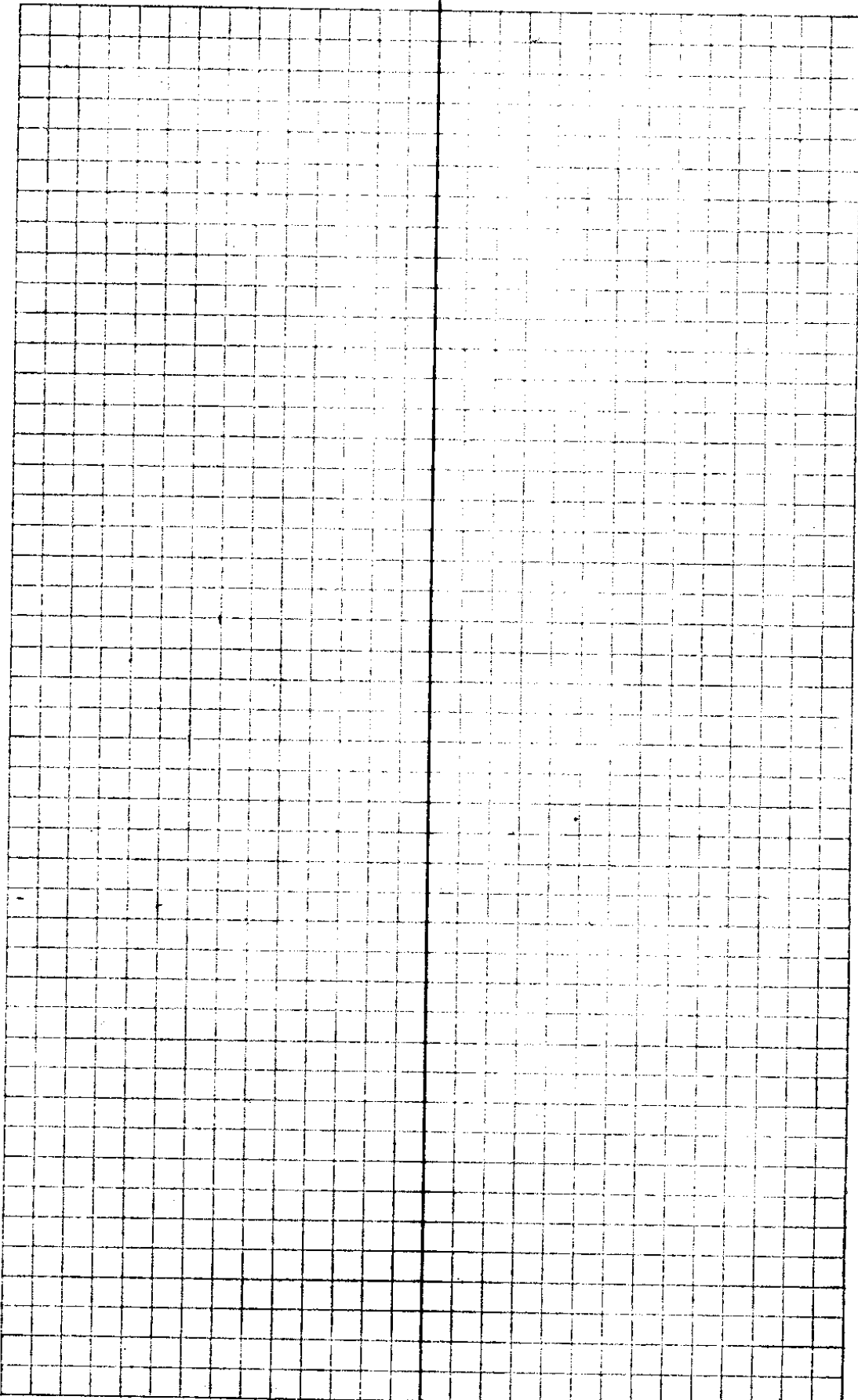

C. S. File No. 33/1

Sta ^⑨	Dist	Ext Angles	MC	CC
1	279 ²	300-08	S89E	S89-03E
C-17	262 ¹	175-36	N29W	N29-11W
B-16	268 ⁴	181-35	N24½W	N24-47W
A-15	218 ⁶	195-25	N26W	N26-22W
14	313 ⁶	137-14	N41½W	N41-47W
13	39.2	227-10	N2E	N0-59E
12				

PHIPPS 10

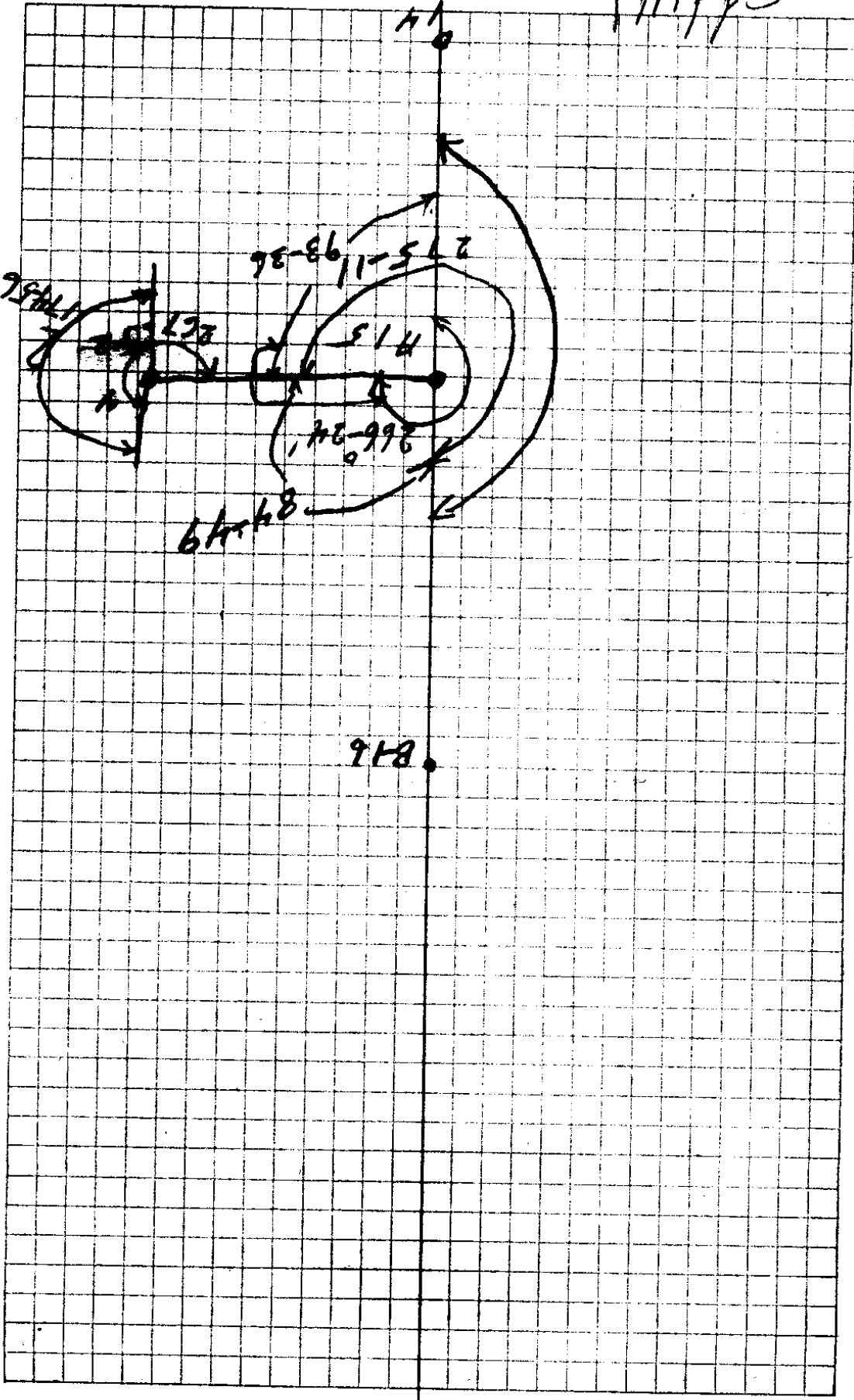

H 10

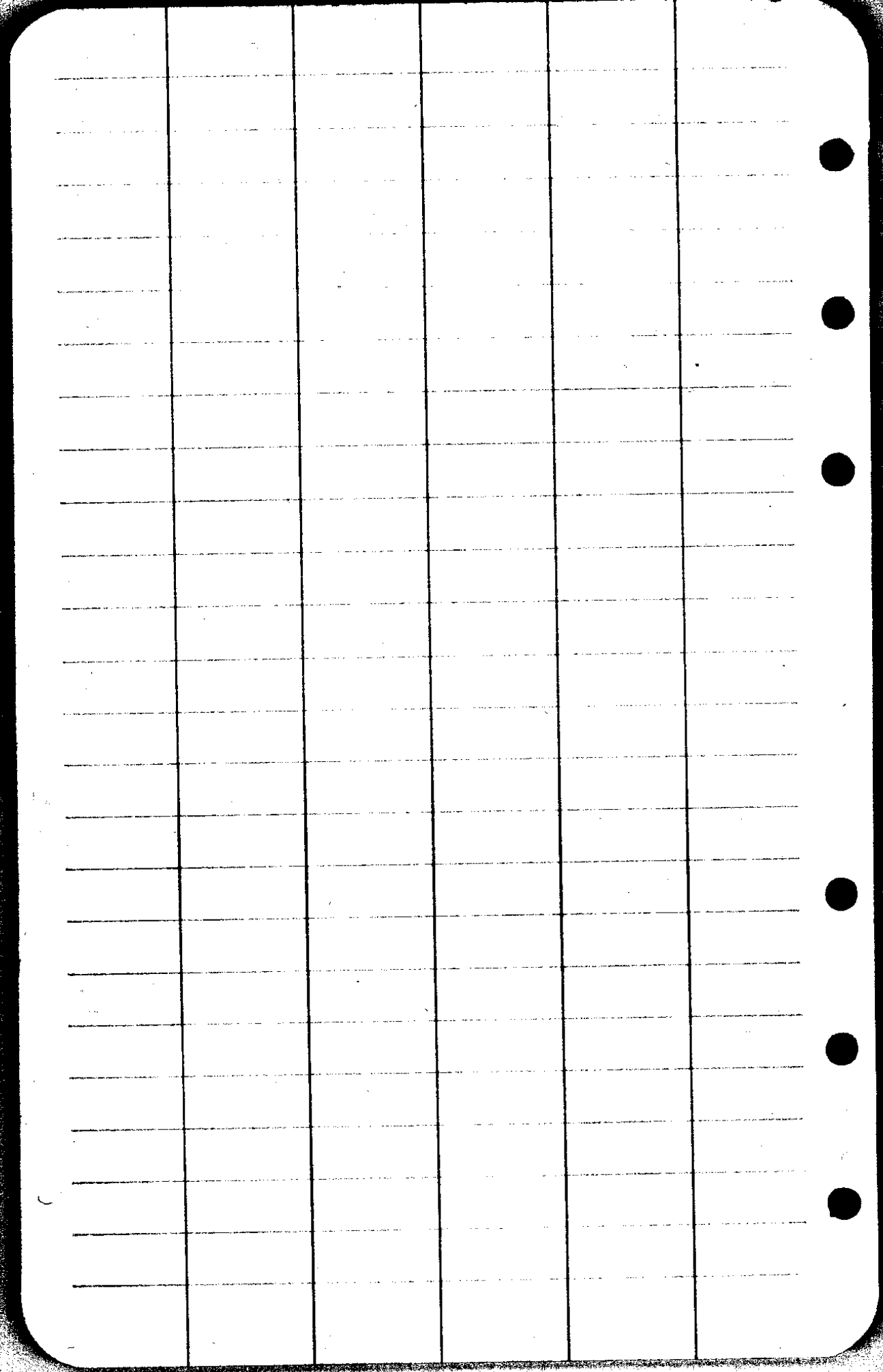

CS FILE FOLDER

CONTAINS

MORE

INFORMATION