

MISS FISHER SURVEY
 June 29
 1938
 County Surveyors Office
 A. B. [unclear]

6/29/1938

Buyer
Shellenbarger

I.P.

I.P.

I.P.

I.P.

I.P.

I.P.

I.P.

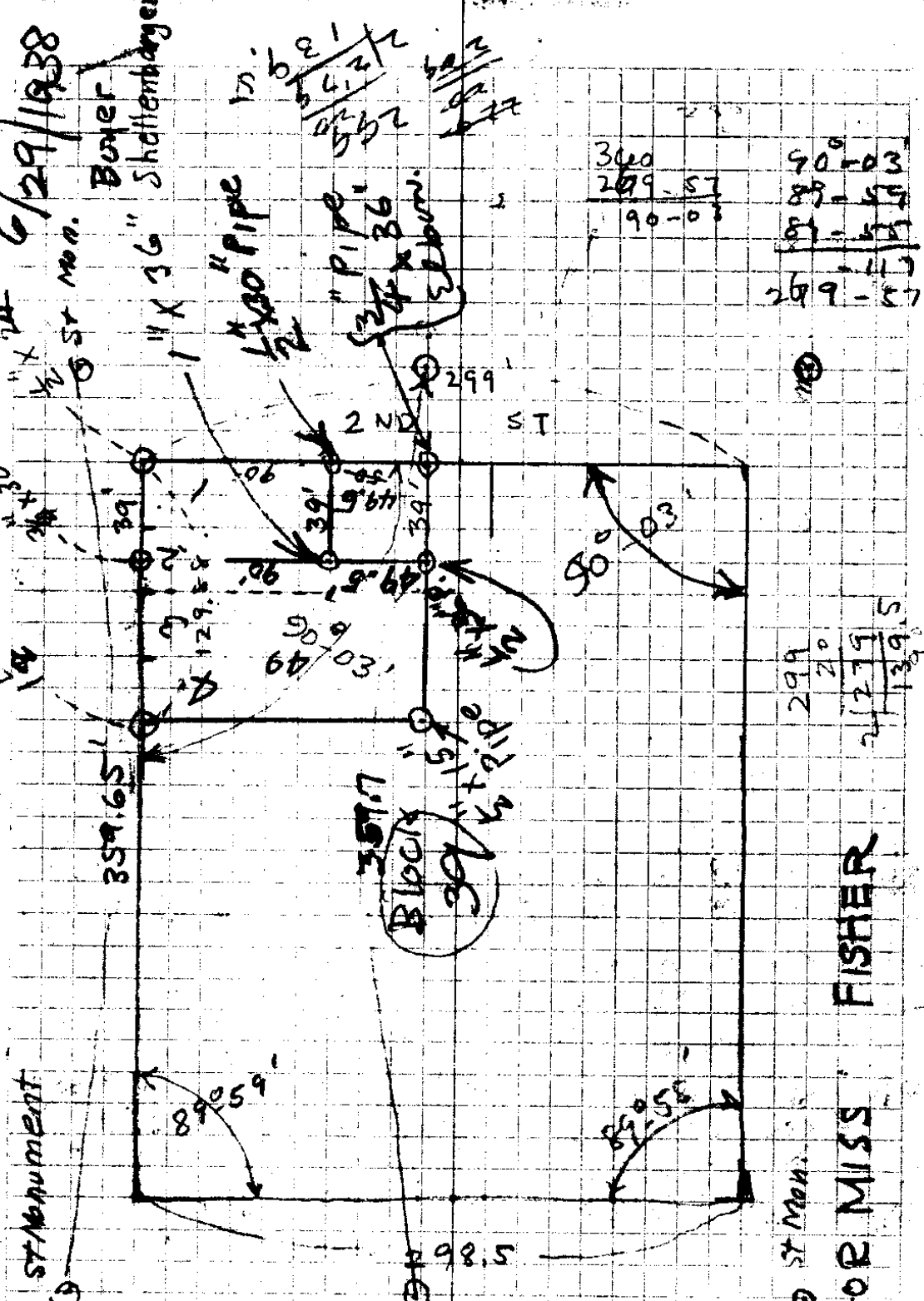

ST Monument

ST Mon.

SURVEY FOR MISS FISHER

340
279 - ST
90 - 03

90° - 03'
89 - 59'
87 - 57'
279 - 57

299
20
279
139.5
49.5

129.5
29
40.5

e. B. 31/60

All of Lots 3 & 4 $\frac{9}{16}$ of the West 1/4 of Lot 2 of Block 39, Kinneys Imp Plat.

39 x 90 ft Lot

That Portion of Lots 1 $\frac{9}{16}$ & 2 Block 39 Kinneys Improved Plat to the City of Resberg, Ark

which is described as follows beginning at the N.E. Corner of said lot 1, which is indicated by a $\frac{1}{2}$ " x $\frac{1}{4}$ " iron pipe, thence

S 2° 56' W 90' along the East line said lot 1 on a line parallel to

any 30' W of the Center of East Fourth St. to a $\frac{1}{2}$ " x 30" pipe, thence

N 67° 04' W 39.0 ft to a line parallel to the $\frac{1}{2}$ " x 30" pipe, thence

to a 1" x 36" Pipe thence N 2° 56' E on a line parallel with the East line

of Lot 1, 90.0 ft to a $\frac{1}{2}$ " x 30" Pipe on the North Line of Lot 2 thence ~~S 2° 56' E~~

along the North line of Lots 1 & 2, S 87° 04' E 39.0 ft to the place of beg

39' x 49.5 ft Lot

That portion of Lots 1 & 2 Block 39 Kinneys Improved Plat to the

City of Resberg, Ark, which is described as follows: beginning at

the SE Corner of said Lot 1, indicated by a $\frac{3}{4}$ " x 36" pipe, thence

the S. Line of said lots 1 & 2 N 87° 04' W 39.0 ft to a $\frac{1}{2}$ " x 36" Pipe

thence N 2° 56' E on a line parallel with the East line of

Lot 1 to a 1" x 36" Pipe thence S 87° 04' E 39.0 ft to a $\frac{1}{2}$ " x 30" Pipe

on the East line Lot 1, thence S 2° 56' W along the East line of

Lot 1, to the place of Beginning 49.5 ft

39. ft by 90 ft. Lot

That portion of Lots 1 and 2, Block 39, Kinneys Improved Plat to the City of Roseburg, Oregon, which is described as follows,- Beginning at the N.E. corner of Lot 1 Block 39, of said Kinneys Improved Plat, which is indicated by 3/4 inch by 24 inch pipe, thence S. 2*-56°W, 90 ft. along the east line of said Lot 1, to a 1/2 inch by 30 inch pipe, thence on a line parallel to the North line of said Lots 1 & 2, N. 87*-04°W, 39.0 ft. to a 1 inch by 36 inch pipe, thence on a line parallel to the East line of said Lot 1, N. 2*-56°E, 90.0 ft. to a 3/4 inch by 30 inch pipe on the North line of said Lot 2, thence along the North line of Lots 1 and 2, S. 87*-04°E, 39.0 ft. to the place of beginning.

39 ft. by 49.5 ft lot

That portion of Lots 1 and 2, Block 39, Kinneys Improved Plat to the City of Roseburg, Douglas County, Oregon, which is described as follows,- Beginning at the S. E. corner of Lot 1, Block 39, of Kinneys said Improved Plat, which is indicated by a 3/4 inch by 36 inch pipe, thence along the South line of Lots 1 and 2 of said Block 39, N. 87*-04°W, 39 ft. to a 1/2 inch by 36 inch pipe, thence on a line parallel with the East line of Lot 1, to a 1 inch by 36 inch pipe, thence on a line parallel with the South line of said Lots 1 and 2, S. 87*-04°E, 39.0 ft. to a 1/2 inch by 30 inch pipe on the East line of Lot 1, thence along the East line Lot 1, S. 2*-56°W, 49.5 ft to the place of beginning.

Portion remaining of the four lots (Lots 1, 2, 3 and 4) after the two above tracts are deducted from them.

All of Lots 3 and 4 and the West 11 ft. of Lot 2 of Block 39, Kinneys Improved Plat to the City of Roseburg

All the three above descriptions in Douglas County, Oregon.

Descriptions for Miss Fisher
County Surveyor's Office, Roseburg, Ore
June 29, 1938
By Arthur Boyer, Dep. Co Surveyor.

50
39
11

CS FILE FOLDER

CONTAINS

MORE

INFORMATION