

31-56

The image shows a page of graph paper with a grid pattern. A vertical line runs down the center of the page, dividing it into two columns. The grid consists of small squares. There are several circular punch holes along the left edge of the page. The page is otherwise blank, with only a few minor dark specks visible on the grid.

Wreck

H.L. Eppstein  
N.E. Richardson  
Nov. 27-43

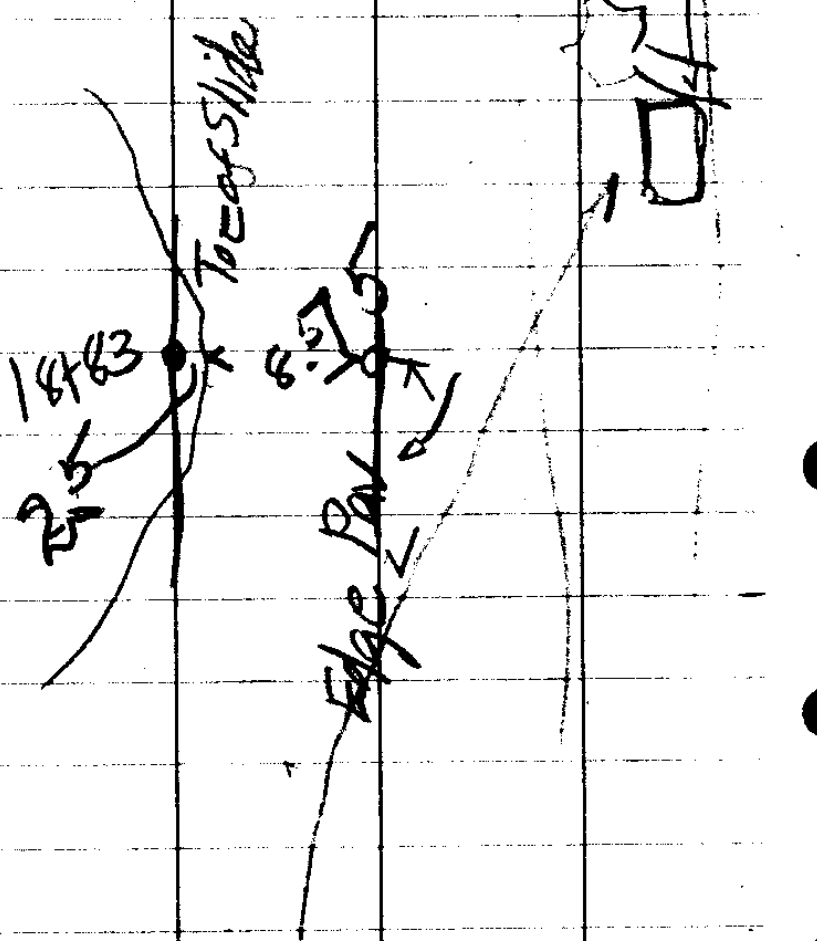

Cam  
sign 0 158 2141

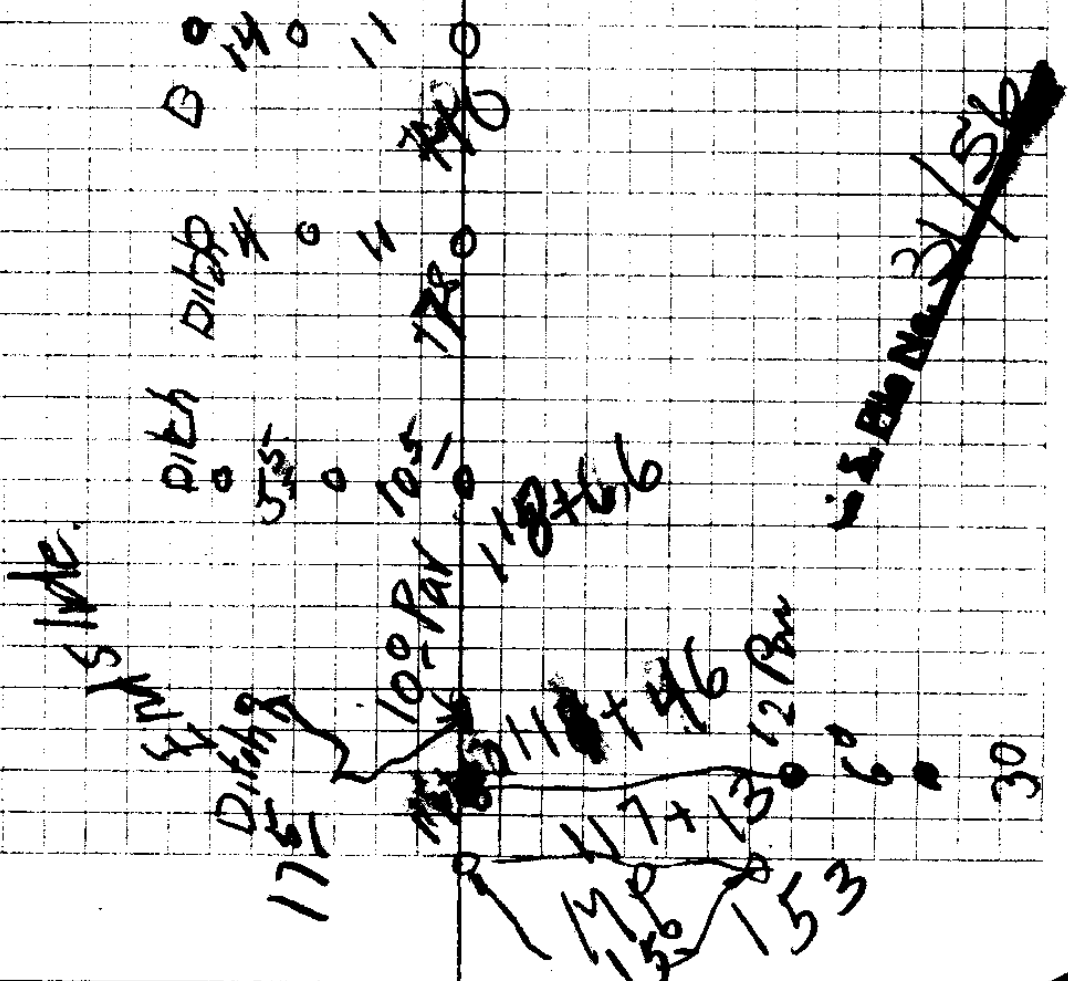
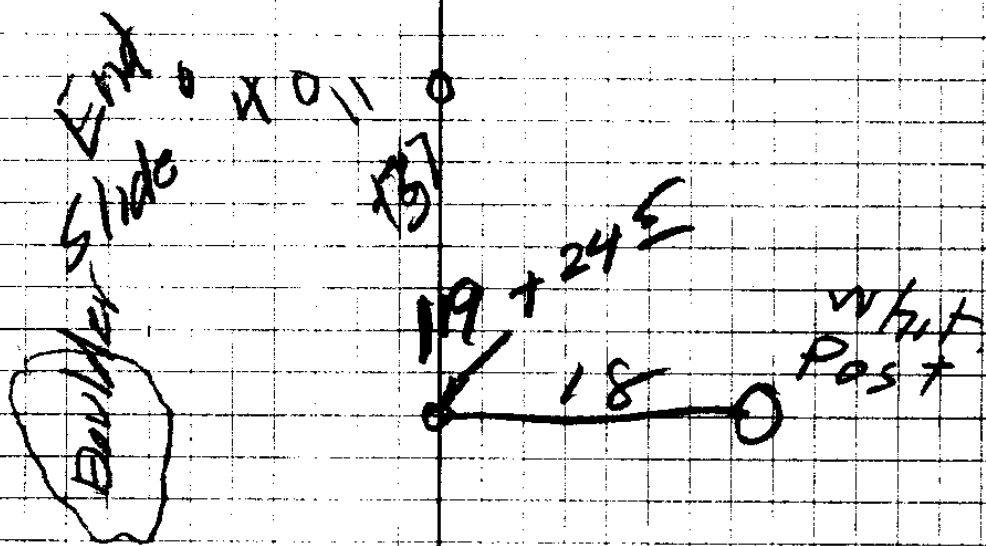

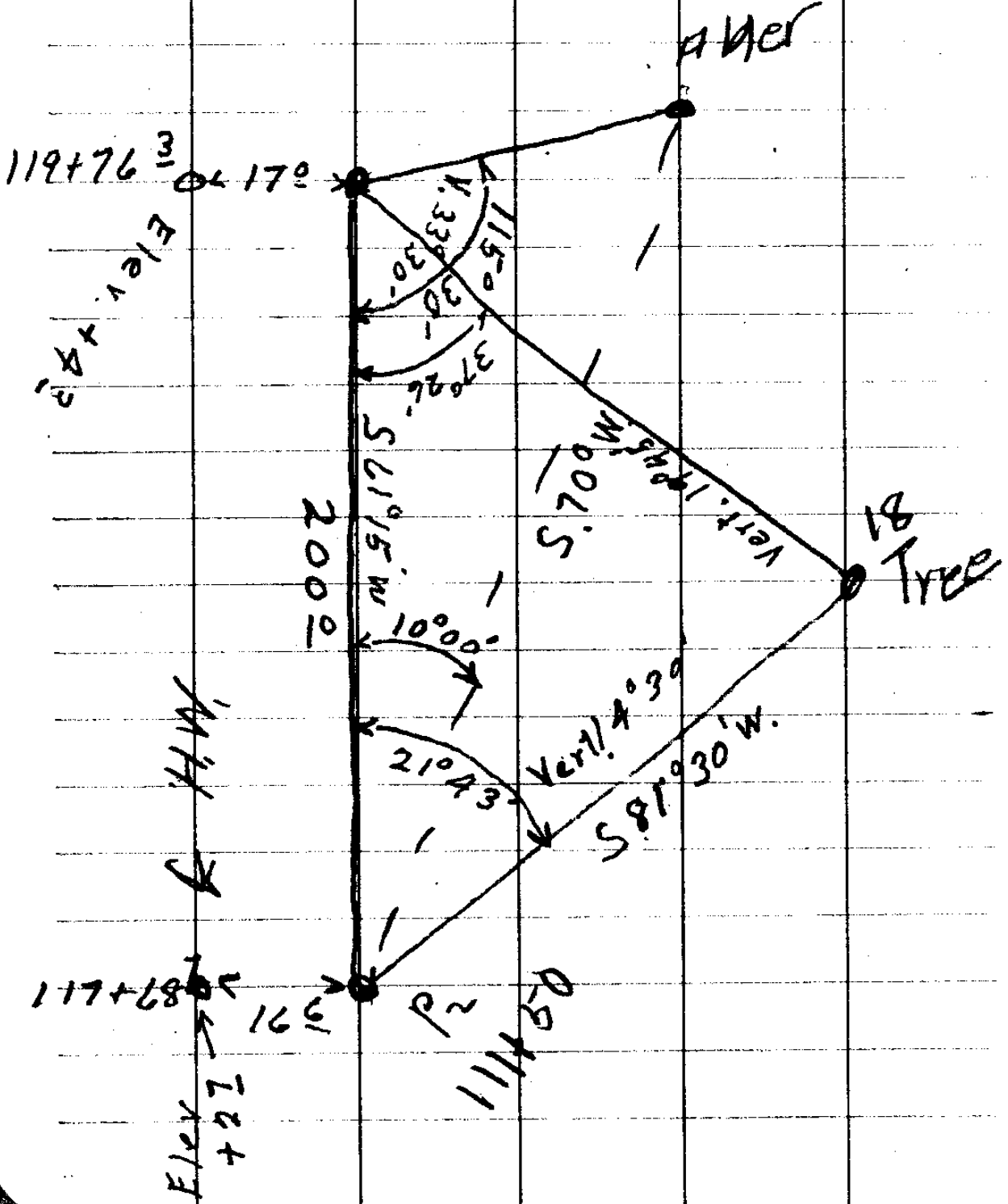

Elev +27  
 117+27

H.W.

2000

5619.5 W

210°43

P2  
 11150

S 81°30' W  
 Vert 4°30

S 70°15' W  
 Vert 1°30

10000

115°0

S 37°26' W

S 33°30' W

Elev +27  
 119+76

A Mer

18 Tree

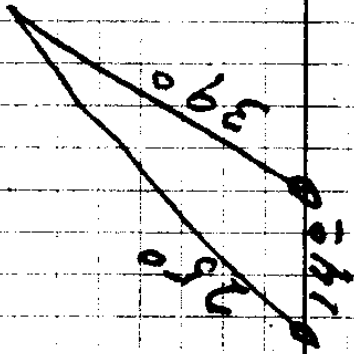

H.I. 45

19410 H.I. 53

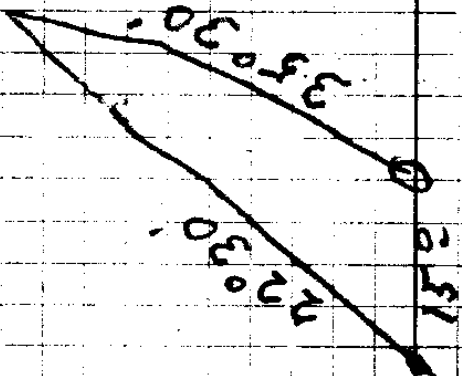

H.I. 45

18478 H.I. 59

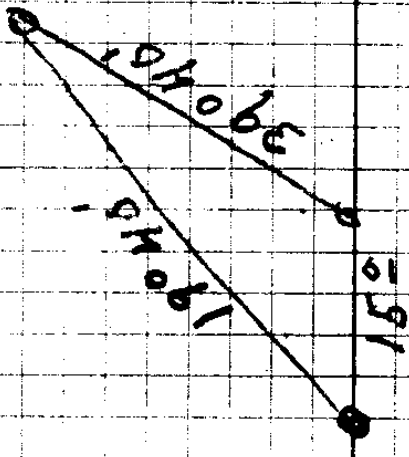

18466

St

T

K

-

~~2.22~~ 102.22

100.0

Top MP  
153

115

1.5

100.7

116

2.9

99.3

17

4.0

98.2

+13

4.3

97.9

+50

5.0

97.2

118

5.8

96.4

+50

7.2

95.0

+66

7.7

94.5

+78

8.1

94.1

119

8.9

93.3

+10

9.2

93.0

+37

10.2

92.0

+50

10.6

91.6

76.3

11.5

90.7

120

12.3

89.9

+50

13.8

88.4

121

15.3

86.9

+50

16.4

85.8

122

17.0

85.2

117 +68.7

5.3

96.7

$$\begin{array}{r} 12 \\ 115 \\ \hline 7 \end{array}$$

$$\begin{array}{r} 1002 \\ 852 \end{array}$$

$$\begin{array}{r} 7 \overline{) 1155} \\ \underline{14} \phantom{5} \\ 15 \phantom{5} \end{array} \quad \begin{array}{l} \sqrt{22} \\ \times 2 \end{array}$$



