

Roseburg
Airport

Prof. & X Sections
for grading runway.

Apr. 1936

Boyer
Jr.

①

Apr 16-36
Bull
Mass.

Airport Levels

Sta	+S	H1	-S	Elev	BM.
Edge				Marked	
R/W.	3.37	503.37		500.0	USGS.
0+0		503.70	9.1	500.33	493.2
0+50					
1+00					
+50					
2+00					
2+50			4.77	498.93 Top	498.60 stake
2+50	3.76	502.69			
		502.36			
3+00					
+50					
4+00					
+50					

Grade - 1.0%

L

±

R

(1)

B.M. USGS. "Abt 2 mi N. Roseburg on SP RR
 1/2 mi N. Edenbower Sta. 20' W. of track
 near fence - Iron Post stamped 500B 1903

Elev 500.334

99.2	4.5	92.2	5.9	92.5	7.4	96.3	94.6	93.2	93.2	93.0	95.9
152	67.0	100	65.3	50	63.5	91.1	61.6	0.0	10.7	93.0	93.7
								50.	100	105	152.

98.7	97.5	96.5	95.4	93.0	93.2	95.9
50	6.2	7.2	93.5	93.0	93.2	50.00
152	100	50.	61.4	61.4	61.4	152

98.4	97.5	96.8	96.5	96.4	97.3	98.6
5.3	6.2	6.9	94.0	94.2	94.9	94.8
152	100	50.	62.2	62.2	62.2	152

97.6	97.4	97.5	97.3	97.3	96.9	95.8
6.1	6.2	6.1	94.5	94.7	95.0	95.3
152	100	50	62.6	62.6	61.9	60.5

Ground Surf
 Grade →

96.6	97.2	97.9	98.0	97.9	96.8	94.1
7.1	6.5	5.8	95.0	95.3	95.5	95.8
152.	100	50.	63.0	62.6	61.3	61.9

2+50

95.7	96.9	98.0	98.4	98.2	96.5	93.7
7.0	5.8	4.7	95.5	95.7	96.9	96.2
152	100	50	62.9	62.3	60.8	62.5

95.6	96.3	97.5	98.3	98.3	97.0	94.8
7.1	6.4	5.2	96.0	96.2	96.5	96.8
152.	100.	50	62.3	62.1	60.5	62.0

95.5	95.9	97.3	97.9	98.0	96.9	95.1
7.2	6.8	5.4	96.5	96.8	97.0	97.3
152	100.	50	61.4	61.2	60.1	62.2

95.6	96.1	97.2	97.9	97.7	96.3	94.3
7.1	6.6	5.5	97.0	97.3	97.5	97.8
152	100.	50.	60.9	60.4	61.2	63.5

96.1	96.3	97.4	98.1	98.0	96.8	94.3
6.6	6.4	5.3	97.5	97.7	98.0	98.3
152	100.	50.	60.6	60.3	61.2	64.0

23-48

Airport Levels

4-16-36
Bayer
not a #

②

Sta	+ S	HI	- S	Elev	
5+00		502.36 502.69			
+50					
6+00					
+50					
7+00					
7+50	⊙	508.71 508.38	1.63	501.06 509.73	Top Stake
7+50	7.65				
8+00					
+50					
9+00					
+50					
+75	S. Face of				} No X Sec's.
9+94	S " Hangar				
10+00					

L.

Q

R.

(20)

(Ground

Surf → 963
Grade → 973
6.4 F1.0
152

967
977
977.7
5.0 F0.8
50.004

985
980
2 C0.5

984
98.3
4.3 C0.1
50

973
98.5
5.4 F1.7
100

958
98.8
6.9 F2.3
152

970
978
5.7 F0.8
152

973
980
5.4 F0.7
100

986
985
1 C0.1

982
98.7
4.5 F0.5
50

972
99.0
5.5 F1.8
100

952
99.2
7.0 F4.0
152

976
983
5.1 F0.7
152

979
985
4.8 F0.6
100

984
99.0
3 F0.6

981
99.3
4.6 F1.2
50

973
99.5
5.4 F2.7
100

952
99.8
7.5 F4.6
152

981
98.7
4.6 F0.6
152

985
99.0
4.2 F0.5
100

992
99.5
5 F0.3

991
99.8
3.6 F0.7
50

979
100.0
4.8 F2.1
100

956
100.3
7.1 F4.7
152

985
99.3
4.2 F0.8
152

990
99.5
3.7 F0.5
100

997
500.0
3.0 F0.3

500.2
500.0
2.7 F0.7
50

499.0
500.5
3.7 F1.9
100

496.5
500.8
6.2 F4.3
152

99.3
99.8
9.4 F0.5
152

499.5
500.0
9.2 F0.5
100

500.4
500.5
8.3 F0.1

500.6
500.7
8.1 F0.7
50

499.9
501.0
8.8 F1.1
100

497.6
501.2
11.1 F3.6
152

499.8
500.8
0.9 F0.5
152

500.2
500.5
8.5 F0.3
100

501.2
501.0
7.5 F0.7

501.6
501.3
7.1 F0.3
50

501.3
501.5
7.4 F0.4
100

499.2
501.8
9.5 F4.3
152

500.7
500.7
8.0 F0.0
152

501.2
501.0
7.5 F0.2
100

502.0
501.5
6.7 F0.5

502.3
501.8
6.4 F0.5
50

502.3
502.0
6.4 F0.3
100

501.8
502.2
6.9 F0.4
152

501.6
501.3
7.1 F0.3
152

501.8
501.5
6.9 F0.3
100

502.7
502.0
6.0 F0.7

502.8
502.3
5.9 F0.5
50

503.2
502.5
5.5 F0.7
100

503.7
502.7
5.0 F1.0
152

501.4
501.4
6.8 F0.1
152

502.3
502.0
6.4 F0.3
100

503.0
502.5
5.7 F0.5

503.3
502.8
5.4 F0.5
50

503.6
503.0
5.1 F0.6
100

503.9
503.2
4.8 F0.7
152

502.6
502.3
6.1 F0.3
152

503.0
502.5
5.7 F0.5
100

503.5
503.0
5.2 F0.5

503.7
503.2
5.0 F0.5
50

504.1
503.5
4.6 F0.6
100

504.4
503.6
4.3 F0.8
130

504.5
503.7
4.2 F0.8
140

23-48

✓

w face Hungary

(3)

Airport

Apr 16-36

Sta	+S	HI	-S	Elev
-----	----	----	----	------

10+50		508.71 508.22		
-------	--	-----------------------------	--	--

79 N. Face Hanger.

11+00

11+06

11+50

12+00

+50

13+00	152'	Top stake	2.09	506.62 506.29
	7.32	513.94 513.61		

13+00

+50

14+00

+50

15+00

+50

Ground Surfs Always Shown Above Grade Elev.

(3)

	L	Center	R
Ground			
Surf	5032	5036	5041
Grade	5027	5030	5035
	5.5	5.1	4.6
	152	100	50
	5038	5042	5046
	5033	5035	5040
	4.9	4.5	4.0
	152	100	50
	5041	5045	5051
	5037	5040	5045
	4.6	4.2	3.6
	152	100	50
	5050	5049	5055
	5042	5048	5050
	3.7	3.8	3.1
	152	100	50
	5055	5058	5062
	5048	5050	5055
	3.2	2.9	2.6
	152	100	50
	5059	5065	5071
	5053	5058	5060
	8.0	7.4	6.8
	152	100	50
	5063	069	072
	5058	060	062
	7.6	7.0	6.1
	152	100	50
	5069	074	079
	5063	065	068
	7.0	6.5	6.0
	152	100	50
	5069	077	081
	5068	070	072
	7.0	6.2	5.8
	152	100	50
	5071	077	082
	5073	075	078
	6.8	6.2	5.7
	152	100	50
	073	073	084
	078	087	082
	6.0	6.0	5.5
	152	100	50

face
hang
No stake

11+00

11+50

12

12+50

13

14

15

Sta	+S	HI	-S	Elev	Grade
		513.61 + 513.94			
16+00					
+50					
17+00	152' L	Top stake	5.00	508.94 508.94	T.P
	7.63	516.57 516.24			
17+00					
17+50					
				516.66 511.5 <hr/> 511.5	
18+00					
+50					
					511.5
19+00					0.50
+50					
					0.5384790
20+00					0.50
+50					

L

Q

R

Ground
Surf
Grade

507.5 508.3 F0.8	08.1 08.5 F0.4	08.7 08.7 00	09.5 09.0 C0.5	09.6 09.3 C0.3	09.6 09.5 C0.1	09.9 09.8 C0.1
6.4	5.8	5.2	4.4	4.3	4.3	4.0
152.	100	50		50.	100	152
508.0 508.8 59 F0.8	08.5 09.0 F0.5	09.2 09.2 00	510.0 509.5 C0.5	510.1 509.7 C0.4	510.3 510.0 C0.3	510.7 510.2 C0.4
	5.4	4.7	3.9	3.8	3.6	3.2
152	100	50.		50	100	152.

508.5 509.3 F0.8	09.1 09.5 F0.4	09.7 09.7 00	510.4 510.0 C0.4	10.5 10.2 C0.3	10.8 10.5 C0.3	511.1 510.8 C0.3
8.1	7.5	6.9	6.2	6.1	5.8	5.5
152.	100	50.		50.	100	152
508.8 509.8 7.8 F1.0	09.3 09.2 F0.7	10.0 10.3 F0.3	510.6 510.3 C0.1	10.7 10.7 00	11.3 11.2 C0.3	511.6 511.3 C0.3
	7.3	6.6	6.0	5.9	5.3	5.0
152	100	50		50	100	152

509.1 510.8 7.5 F1.2	09.7 10.5 F0.8	10.4 10.8 F0.4	10.9 11.0 F0.1	11.2 11.2 00	11.8 11.8 C0.3	512.4 511.8 C0.6
	6.9	6.2	5.7	5.4	4.8	4.2
152	100	50		50.	100	152

508.9 510.8 7.7 F1.9	09.9 11.0 F1.1	10.7 11.2 F0.5	511.5 511.5 1.00	11.8 11.8 00	12.4 12.0 C0.4	513.0 512.3 C0.7
	6.7	5.9	5.1	4.8	4.2	3.6
152	100	50		50	100	152.

508.9 510.5 7.7 F1.6	09.9 10.7 F0.8	10.9 11.0 F0.1	11.8 11.2 C0.6	12.5 12.5 C1.0	12.7 11.7 C1.0	513.4 512.0 C1.4
	6.7	5.7	4.8	4.1	3.9	3.2
152	100	50		50	100	152

508.7 510.2 7.9 F1.5	09.9 10.5 F0.6	11.1 11.8 C0.7	512.4 511.0 C1.4	12.9 11.3 C1.6	13.6 11.6 C2.0	513.7 511.7 C2.0
	6.7	5.5	4.2	3.7	3.6	2.9
152	100	50.		50	100	152

508.5 510.0 8.1 F1.5	10.0 10.2 F0.2	11.4 10.4 C1.0	512.7 510.7 C2.0	13.2 10.0 C3.2	13.5 11.2 C2.3	513.9 511.3 C2.6
	6.6	5.2	3.9	3.4	3.7	2.7
152	100	50.		50	100	152

508.5 509.7 8.1 F1.2	10.5 09.9 C0.6	11.8 10.2 C1.6	513.0 510.4 C2.6	13.4 10.6 C2.8	13.7 10.9 C2.8	513.8 511.2 C2.6
	6.1	4.8	3.6	3.2	2.9	2.8
152	100	50.		50	100	152

Apr 16 '36

Airport

Sta	+S	#1	-S	Elev
		510.24 516.57		
21+00				
+50				
22+00			3.68	512.89 512.56
	2.83	515.72 515.57		
22+00				
+50				
23+00				
+50				
24+00	①		13.40 11.99	503.73
	8.15	511.88 511.55		
24+00				
+50				

0.5384790
- 0.590

L

±

R

Gr. Surf → 508.5
Grade → 509.5
F 1.0

8.1
152

510.7
509.7
C 1.0

5.9
100

512.1
509.9
C 2.2

4.5
50

3.7

512.9
510.2
C 2.7

3.2
50

513.4
510.4
C 3.0

2.9
100

513.7
510.7
C 3.0

2.9
152

508.4
509.2
F 0.8

B.2
152

10.7
09.4
C 1.3

5.9
100

12.0
09.7
C 2.3

4.6
50

12.8
09.9
C 2.9

3.8

13.4
10.1
C 3.3

3.2
100
50

13.6
10.4
C 3.2

3.0
100

13.7
10.7

2.9³⁰
152

508.5
508.9
F 0.4

7.2
152

10.6
09.1
C 1.5

5.1
100

11.9
09.4
C 2.5

3.8
50

512.5
509.6
C 2.9

3.2

13.2
09.8
C 3.4

2.5
50

13.4
10.1
C 3.3

2.3
100

513.5
510.4
C 3.1

2.2
152

09.1
08.6
C 0.5
6.6
152

10.7
08.8
C 1.9
5.0
100

11.7
09.1
C 2.6
4.0
50

12.6
09.3
C 3.3
3.1

12.9
09.5
C 3.4
2.8
50

13.1
09.8
C 3.3
2.6
100

512.9
510.1
C 2.8
2.8
152

08.7
08.4
C 0.3
7.0
152

10.2
08.6
C 1.6
5.5
100

11.0
08.9
C 2.1
4.7
56

511.8
509.1
C 2.7
3.9

12.1
09.3
C 2.8
3.6
50

12.2
09.6
C 2.6
3.5
100

511.1
509.9
C 1.2
4.6
152

07.9
08.1
F 0.2
7.8
152

09.4
08.3
C 1.1
6.3
100

09.7
08.6
C 1.1
6.0
50

510.2
508.8
C 1.4
5.5

510.2
509.0
C 1.2
5.5
50

09.9
09.3
C 0.6
5.8
100

505.0
509.6
F 4.6
10.7
152

500.6
507.8
F 7.2
11.3
152

07.0
08.0
F 1.0
4.9
100

06.3
08.3
F 2.0
5.6
50

03.5
08.5
F 5.0
8.4

04.2
08.7
F 4.5
7.7
50

03.4
09.4
F 5.4
8.5
100

503.7
509.3
F 5.6
8.2
152

498.9
507.6
F 8.7
13.0
152

499.9
507.8
F 7.9
12.0
90.0

501.2
508.1
F 6.9
10.9
50

501.3
508.3
F 7.0
10.6

Airport Levels

Apr 16-36

Sta +S HI -S Elev.

511.88
511.55

25+00

508.0



27+00 on ϕ

0.59 511.29 ✓
~~511.29~~

Apr 17-36

27+00 ϕ

511.29

2.40 513.69 ✓

25+50

+1.0%

26+00

26+50

10.3

27+00

9.95 521.24 ✓ 511.29

27+00

27+50

28+00

+1.0%

+50

Ground
surf 499.1
Grade 507.3
F 8.2
25+00
12.8
152

L

498.7
507.7
F 9.0
Trench
132
50.

Q

5032
508.0
F 4.8
8.7
on Hill

R

502.7 501.4
508.5 508.8
F 5.8 F 7.4
9.2 10.5
100 152
25+00

25+50

499.9	4986	501.1	501.0	5006	503.5	505.2
507.8	508.0	505.3	508.5	508.7	509.0	509.2
F 7.9	F 9.4	F 4.2	F 7.5	F 8.1	F 5.5	F 4.0
13.8	15.1	12.6	12.7	13.1	10.2	8.5
152	100	50		50	100	152

26

499.9	4988	994	5024	5034	049	5070.1
508.3	508.5	08.8	509.0	509.2	09.5	509.8
F 8.4	F 9.7	F 9.4	F 6.6	F 5.8	F 4.6	F 2.8
13.8	14.9	19.3	11.3	10.3	8.9	6.7
152	100	50	50	50	100	152

26+50

4969	5018	032	042	057	078	510.0
508.8	509.0	09.2	09.5	09.7	10.0	510.3
F 11.9	F 7.2	10.5	F 5.3	F 4.0	F 2.2	F 0.3
16.8	11.9	10.5	9.5	8.0	5.9	3.7
152	100	50		50	100	152

27+00

506.6	510.2	09.5	510.7			
509.2	509.5	09.8	510.0			
Fill - 2.6	C 0.7	F 0.3	C 0.7			
7.1	3.5	4.2	3.0			
152	100	50				

27+00

512.5	13.7	14.0	514.9	16.1	17.1	516.9
509.8	10.0	10.3	510.5	10.7	11.0	511.3
C 2.7	C 3.7	C 3.7	C 4.4	C 5.4	C 6.1	C 5.6
8.7	7.5	7.2	6.3	5.1	4.1	4.3
152	100	50		50	100	152

512.1	14.6	15.7	516.4	17.2	18.0	518.5
510.3	10.5	10.7	511.0	11.2	11.5	511.0
C 1.8	C 4.1	C 5.0	C 5.4	C 6.0	C 6.5	C 7.5
9.1	6.6	5.5	4.8	4.0	3.2	2.7
152	100	50		50	100	152

509.6	5026	152	516.7	17.5	18.3	
510.8	511.9	11.2	511.5	11.7	12.0	
F 1.2	F 1.6	F 4.0	F 5.2	F 5.8	F 6.3	
11.6	8.6	6.0	4.5	3.7	2.9	
152	100	50		50	100	

Airport

Apr 17

Sta +S HI -S Elev

521.24

29+00

+50

30+00 ✓

+50

31+00

+50

32+00

32+00 ⊕ on ϕ 5.2⁷ 51597 ✓

8.24 524.21 ✓

32+50

3+00

+1070

Ground surface

	L		R				
29	5054	09.8	03.3	515.7	17.3	18.3	19.3
	<u>511.3</u>	<u>11.5</u>	<u>11.8</u>	<u>512.0</u>	<u>12.3</u>	<u>12.5</u>	<u>12.8</u>
	F5.9	F1.7	F8.5	E3.9	C5.0	C5.8	C6.5
	15.8	11.4	7.9	5.5	3.9	2.9	1.9
	<u>152</u>	<u>100</u>	<u>50</u>	<u>50</u>	<u>100</u>	<u>152</u>	
29+50	506.1	07.0	511.0	513.9	515.9	17.4	518.8
	<u>511.7</u>	<u>12.0</u>	<u>511.3</u>	<u>512.5</u>	<u>512.8</u>	<u>13.0</u>	<u>513.2</u>
	F5.6	F5.0	F0.3	C1.4	C3.1	C4.4	C5.6
	15.1	14.2	10.2	7.3	5.3	3.8	2.4
	<u>152</u>	<u>100</u>	<u>50</u>	<u>50</u>	<u>100</u>	<u>152</u>	
30	09.4	508.0	09.0	511.7	13.6	15.8	17.5
	<u>12.3</u>	<u>512.5</u>	<u>12.8</u>	<u>511.7</u>	<u>13.2</u>	<u>13.5</u>	<u>13.8</u>
	F2.9	F4.5	F3.8	F2.3	7.6	5.4	3.7
	11.8	15.2	12.5	9.5	7.6	5.4	3.7
	<u>152</u>	<u>100</u>	<u>50</u>	<u>50</u>	<u>100</u>	<u>152</u>	
30+50	511.2	10.4	10.1	510.5	12.0	14.3	516.2
	<u>512.7</u>	<u>13.0</u>	<u>13.3</u>	<u>513.5</u>	<u>13.8</u>	<u>14.0</u>	<u>514.2</u>
	F1.5	F2.6	F3.7	F3.0	9.2	6.9	5.0
	10.0	10.8	11.1	7.7	9.2	6.9	5.0
	<u>152</u>	<u>100</u>	<u>50</u>	<u>50</u>	<u>100</u>	<u>152</u>	
31	512.0	12.1	13.4	14.2	13.8	12.7	14.9
	<u>513.3</u>	<u>13.5</u>	<u>13.8</u>	<u>14.0</u>	<u>14.2</u>	<u>14.5</u>	<u>14.9</u>
	F1.3	F1.4	F0.4	C0.2	F0.4	F1.8	C0.0
	9.2	9.1	7.8	7.0	7.4	8.5	6.3
	<u>152</u>	<u>100</u>	<u>50</u>	<u>50</u>	<u>100</u>	<u>152</u>	
31+50	512.5	12.8	13.6	514.9	516.0	16.1	516.0
	<u>513.8</u>	<u>14.0</u>	<u>14.3</u>	<u>514.5</u>	<u>514.8</u>	<u>15.0</u>	<u>515.3</u>
	F1.3	F1.2	F0.7	C0.4	C1.2	C1.1	C0.7
	8.7	8.4	7.6	6.3	5.2	5.1	5.2
	<u>152</u>	<u>100</u>	<u>50</u>	<u>50</u>	<u>100</u>	<u>152</u>	
32	512.7	13.4	14.6	15.5	17.0	18.1	18.8
	<u>514.3</u>	<u>14.5</u>	<u>14.8</u>	<u>15.0</u>	<u>15.3</u>	<u>15.5</u>	<u>15.8</u>
	F1.6	F1.1	F0.2	C0.5	C1.7	C2.6	C3.0
	8.5	7.8	6.6	5.7	4.2	3.1	2.4
	<u>152</u>	<u>100</u>	<u>50</u>	<u>50</u>	<u>100</u>	<u>152</u>	
32+50	513.5	14.4	15.5	517.0	518.3	19.2	19.9
	<u>514.8</u>	<u>15.0</u>	<u>15.3</u>	<u>515.5</u>	<u>515.8</u>	<u>16.0</u>	<u>16.3</u>
	F1.3	F0.6	C0.2	C1.5	C2.5	C3.2	C3.6
	10.7	9.8	8.7	7.2	5.9	5.0	4.3
	<u>152</u>	<u>100</u>	<u>50</u>	<u>50</u>	<u>100</u>	<u>152</u>	
33	14.3	15.5	16.5	517.6	18.8	19.6	20.8
	<u>15.3</u>	<u>15.5</u>	<u>15.8</u>	<u>518.0</u>	<u>16.3</u>	<u>16.5</u>	<u>16.8</u>
	F1.0	C0.0	C0.7	C1.6	C2.5	C3.1	C4.0
	9.9	8.7	7.7	6.6	6.4	4.6	3.4
	<u>152</u>	<u>100</u>	<u>50</u>	<u>50</u>	<u>100</u>	<u>152</u>	

Airport

Apr 17 '34

Sta	+S	HI	-S	Elev
		524.21		
33+50				
34+00				
34+50				
35+00				
+50				
36+00				
+50				
37+00				
+50				
38+00				
+50				

524.21

33+50

34+00

34+50

35+00

+50

36+00

+50

37+00

+50

38+00

+50

+ 1.070

v

519.00

- 0.5070

518.0

L

E

R

Ground
Surf. →

Grade →

	514.6	516.0	516.9	518.2	519.3	20.1	21.6
	515.8	516.0	516.2	516.5	516.8	17.0	17.3
	F 1.2	00	C 0.7	C 1.7	C 2.5	C 3.1	C 4.3
	9.6	8.2	7.3	6.0	4.9	4.1	2.6
	152	100	50	50	50	100	152
	515.0	16.5	17.4	18.7	19.9	21.1	522.4
	516.3	16.5	16.8	17.0	17.2	17.5	517.8
	F 1.3	00	C 0.6	C 1.7	C 2.7	C 3.5	C 4.6
34	9.2	7.7	6.8	5.5	4.3	3.1	1.8
	152	100	50	50	50	100	152
	515.7	16.7	18.2	519.3	20.2	21.4	522.6
	516.7	17.0	17.2	517.5	17.7	18.0	518.2
	F 1.0	F 0.3	C 0.1	C 1.8	C 2.5	C 3.4	C 4.4
34+50	8.5	7.5	6.0	4.9	4.0	2.8	1.6
	152	100	50	50	50	100	152
	515.9	16.8	18.0	519.3	20.5	21.8	523.0
	517.3	17.5	17.8	518.0	518.2	18.5	518.8
	F 1.4	F 0.7	C 0.2	C 1.3	C 2.3	C 3.3	C 4.2
35	8.3	7.4	6.2	4.9	3.7	2.4	1.2
	152	100	50	50	50	100	152
	515.6	16.8	18.0	519.4	20.9	22.2	521.4
	517.8	18.0	18.3	518.5	18.7	19.0	519.3
	F 2.2	F 1.2	F 0.3	F 0.9	C 2.2	C 3.2	C 2.1
35+50	8.6	7.4	6.2	4.8	3.3	2.2	0.8
	152	100	50	50	50	100	152
	515.5	16.7	18.2	519.7	20.8	22.2	523.2
	518.3	18.5	18.8	519.0	19.2	19.5	519.8
	F 2.8	F 1.8	F 0.6	C 0.7	C 1.6	C 2.7	C 3.4
36	8.7	7.5	6.0	4.5	3.4	2.0	1.0
	152	100	50	50	50	100	152
	515.4	516.5	17.8	519.4	20.9	22.1	23.4
	518.0	518.2	18.5	518.75	18.9	19.2	19.4
	F 2.6	F 1.7	F 0.7	C 0.7	C 2.0	C 2.9	C 4.0
36+50	8.8	7.7	6.4	4.8	3.3	2.9	0.8
	152	100	50	50	50	100	152
	514.4	16.1	17.6	519.1	20.7	22.2	523.3
	517.8	18.0	18.3	518.5	18.7	19.0	519.3
	F 3.4	F 1.9	F 0.7	C 0.6	C 2.0	C 3.2	C 4.0
37	9.8	8.1	6.6	5.1	3.5	2.0	0.9
	152	100	50	50	50	100	152
	513.8	515.2	16.5	518.7	20.6	22.0	522.8
	517.5	517.7	16.0	518.25	18.4	18.7	519.0
	F 3.7	F 2.5	F 0.5	C 0.5	C 2.2	C 3.3	C 3.8
	10.4	9.0	7.7	5.5	3.6	2.2	1.4
	152	100	50	50	50	100	152
	513.5	15.1	16.3	518.1	519.8	21.0	521.2
	517.2	17.5	17.8	518.0	518.2	18.5	518.7
	F 3.7	F 2.4	F 1.5	C 0.1	C 1.4	C 2.5	C 2.5
	10.7	9.1	7.9	6.1	4.4	3.2	2.0
	152	100	50	50	50	100	152

Airport

Apr 17-36

Sta	+S	H ₁	-S	Elev	
		524.21			
33+00	152R Top Stake (0.6 up)		2.86	521.35	✓
R, R Spike	6.80	528.15			✓
			2.33	525.82	✓
	0.56	526.38			✓
			9.29	517.09	✓
	2.86	519.95			✓
			8.37	518.58	✓
	0.93	512.57			✓
			5.64	506.87	✓
	1.56	508.43			✓
BM at Beg.			7.95	500.48	✓
				500.48	check
				500.33	0.15 diff

Length Dr. Ditch W. Side Field
is 1677.1'

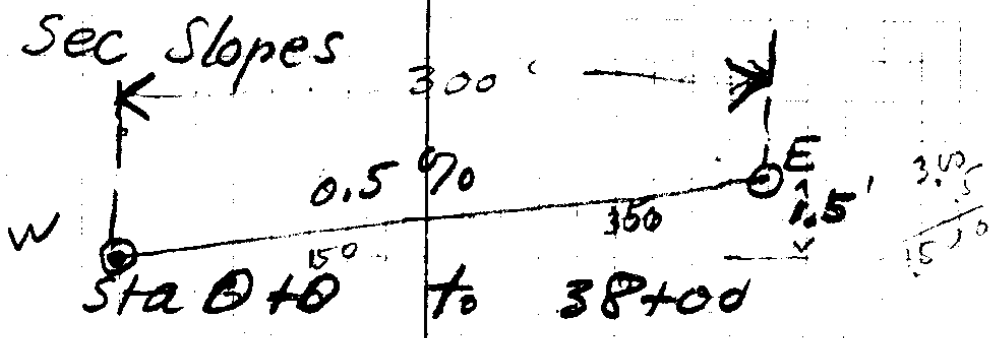

X Sec of Runway

Blank lined page with punch holes on the left side.

Blank grid page.

23-48

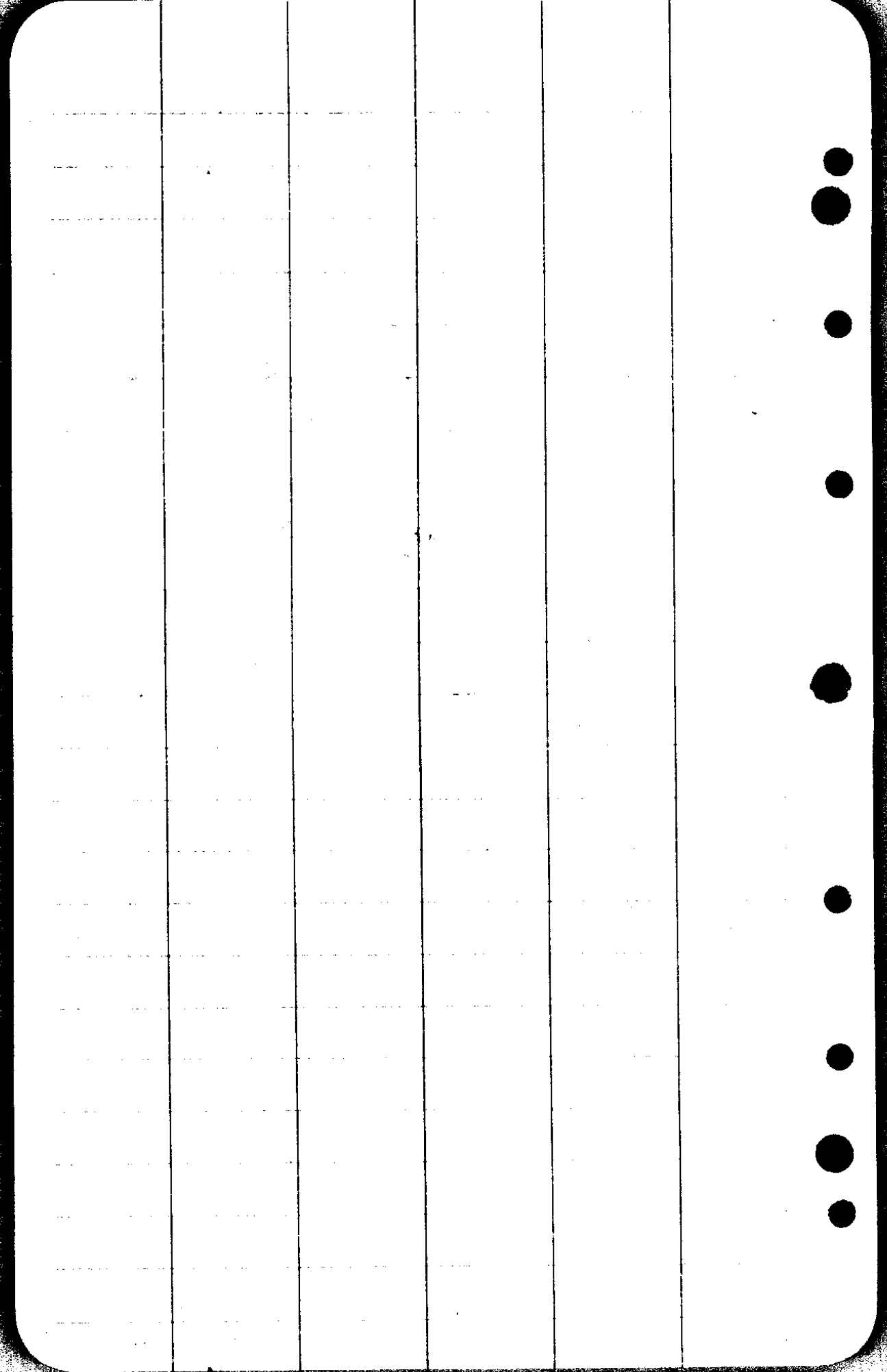

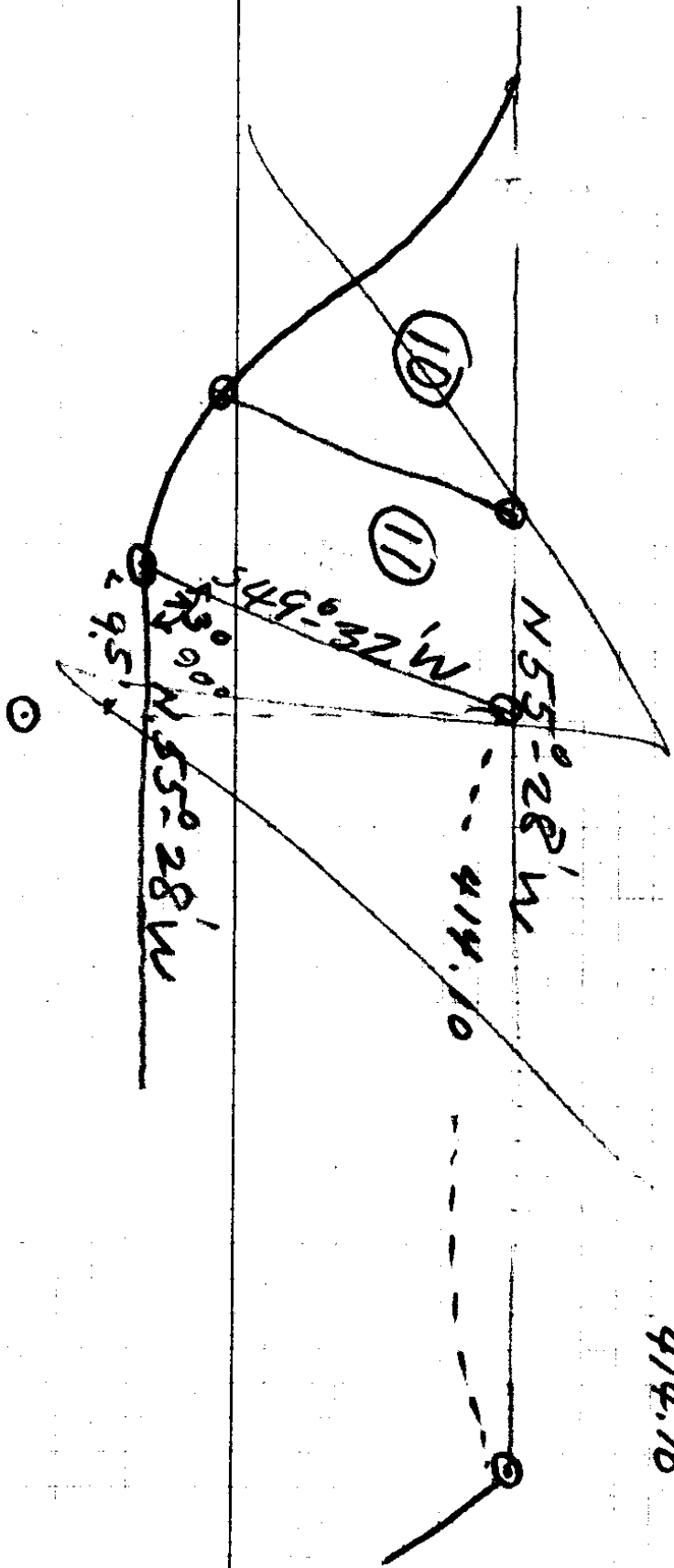

$$\begin{array}{r} 41.41 \\ \hline 414.10 \end{array}$$
 65.36

8/1/20

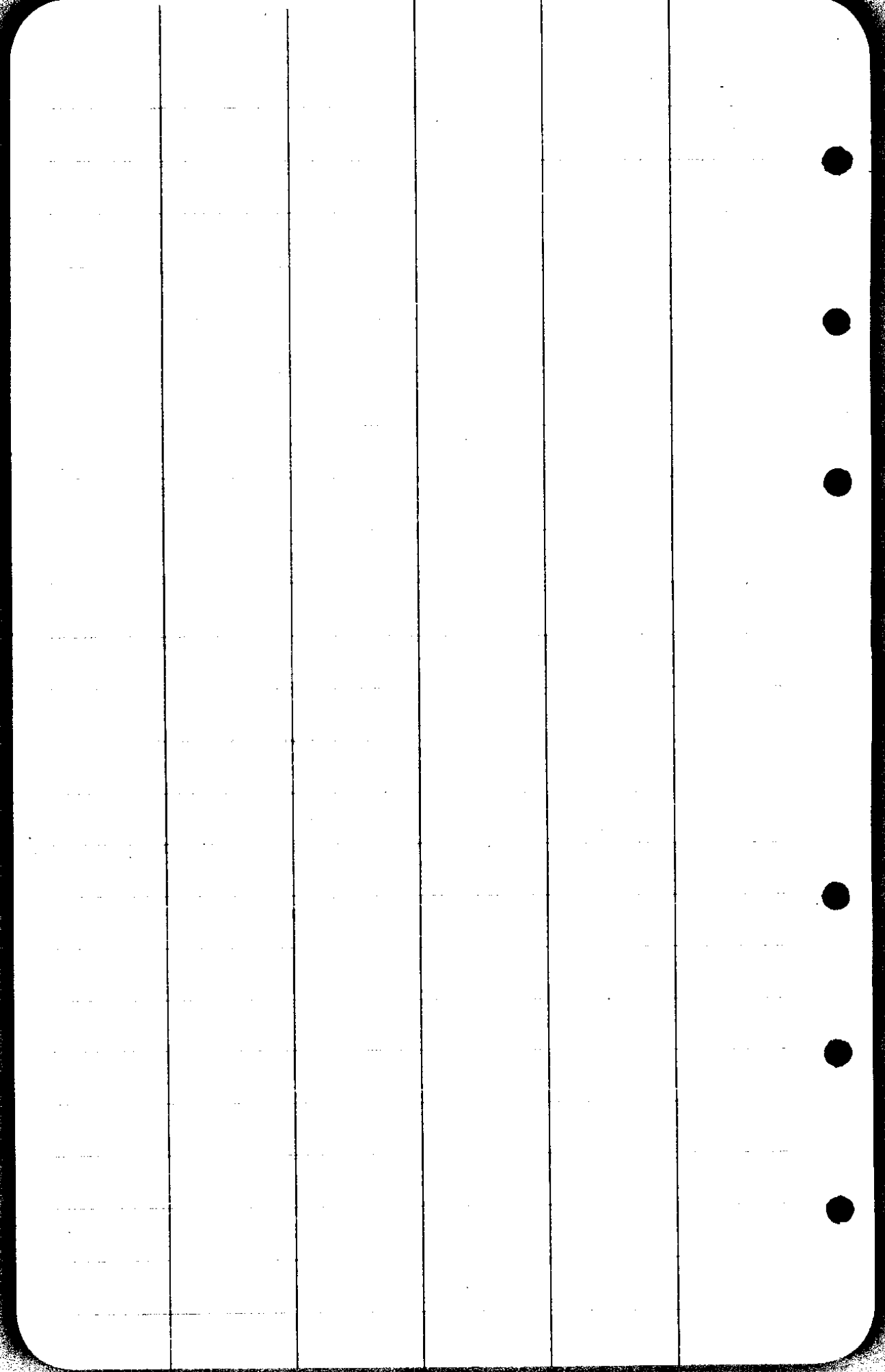

Note: Grade prev. figured
from 0+0 to 18+50 on
a 10% slope did not fit
well so the following
grades have been figured
on a 0.9% slope, as
shown.

23/48

① Sta + S H I - S ELEV E. Grade
0+0 AIRPORT 494.85

0+50

1+00

1+50

2+00

2+50

3+00

3+50

4+00

4+50

5+00

5+50

6+00

6+50

Figured on $G + 0.9\%$ grade

	152'	100'	50'	0'	50'	R. 1	152'
0+0 Ground	99.2 94.2 C 5.0	97.8 94.3 C 3.5	96.3 94.5 C 1.8	94.6 94.85 F 0.25	93.2 95.1 F 1.9	93.0 95.3 F 2.3	95.9 95.55 E 0.4
0+50	98.7 94.5 E 4.2	97.5 94.8 C 2.7	96.5 95.0 C 1.5	95.4 95.3 C 0.1	95.1 95.8 F 0.5	970 95.8 C 1.2	500.0 496.0 C 4.0
1+00	98.4 95.0 C 3.4	97.5 95.3 C 2.2	96.8 95.5 C 1.3	96.50 95.75 C 0.7	96.4 96.0 C 0.4	973 96.3 C 1.0	98.6 96.5 C 2.1
1+50	97.6 95.5 C -2.1	97.4 95.8 C 1.6	97.5 96.0 C 1.5	97.3 96.2 C 1.1	97.3 96.5 C 0.8	96.9 96.7 C 0.2	95.8 96.9 F 1.1
2+00	96.6 95.9 C 0.7	97.2 96.2 C 1.0	97.9 96.2 C 1.5	98.0 96.65 C 1.35	97.9 96.9 C 1.0	96.8 97.2 F 0.4	94.1 97.4 F 3.3
Ground	95.7	96.9	98.0	98.4	98.2	96.5	93.7
Grade	96.4	96.6	96.9	97.1	97.4	97.7	97.9
	F 0.7	C 0.3	C 1.1	C 1.3	C 0.8	F 1.2	F 4.2
3+00	95.6 96.8 F 1.2	96.3 97.0 F 0.7	97.5 97.3 C 0.2	98.3 97.55 C 0.8	98.3 97.7 C 0.6	97.0 98.0 F 1.0	94.8 98.3 F 3.5
4+00	95.5 97.2 F 1.7	95.9 97.4 F 1.5	97.3 97.7 F 0.4	97.9 98.0 F 0.1	98.0 98.3 F 0.3	96.9 98.5 F 1.6	95.1 98.7 F 3.6
5+00	95.6 97.6 F 2.0	96.1 97.9 F 1.8	97.2 98.2 F 1.0	97.9 98.45 F 0.5	97.7 98.7 F 1.0	96.3 98.9 F 2.6	94.3 99.1 F 4.8
5+50	96.1 98.1 F 2.0	96.3 98.4 F 2.1	97.4 98.7 F 1.3	98.1 98.9 F 0.8	98.0 99.1 F 1.1	96.8 99.3 F 2.5	94.3 99.6 F 5.3
6+00	96.3 98.6 F 2.3	96.7 98.9 F 2.2	97.7 99.1 F 1.4	98.5 99.35 F 0.8	98.4 500.6 F 2.2	97.3 500.8 F 3.5	95.8 500.1 F 4.3
6+50	97.0 99.1 F 2.1	97.3 99.3 F 2.0	97.8 99.5 F 1.7	98.6 99.8 F 1.2	98.2 100.2 F 2.0	97.2 100.5 F 3.3	95.2 100.7 F 4.5
7+00	97.6 99.5 F 1.9	97.9 99.7 F 1.8	98.2 500.0 F 1.8	498.4 500.25 F 1.8	498.1 500.6 F 2.5	497.3 500.8 F 3.5	95.2 501.0 F 5.8
8+00	98.1 99.9 F 1.8	98.5 500.2 F 1.7	98.9 500.5 F 1.6	499.2 500.7 F 1.5	99.1 501.0 F 1.9	497.9 501.3 F 3.4	495.4 501.5 F 5.9

GRADE = 0.9%

(2)

7+00

7+50

8+00

8+50

9+00

9+50

10+00

10+50

11+00

11+50

12+00

12+50

Grade = + 0.9%

Left

4

Right

(2)

	152'	100'	50'		50	100	152
7+00	498.5 <u>500.4</u> F 1.9	499.0 <u>500.6</u> F 1.6	499.4 <u>500.9</u> F 1.5	499.7 <u>501.15</u> F 1.5	500.0 <u>501.4</u> F 1.4	499.0 <u>501.7</u> F 2.7	496.5 <u>501.9</u> F 4.4
	499.3 <u>500.9</u> F 1.6	499.5 <u>501.2</u> F 1.7	500.0 <u>501.4</u> F 1.4	500.4 <u>501.6</u> F 1.2	500.6 <u>501.9</u> F 1.3	499.9 <u>502.2</u> F 2.3	497.6 <u>502.4</u> F 4.8
8+00	499.8 <u>501.3</u> F 1.5	500.2 <u>501.5</u> F 1.3	500.7 <u>501.8</u> F 1.1	501.2 <u>502.05</u> F 0.8	501.6 <u>502.3</u> F 0.7	501.3 <u>502.6</u> F 1.3	499.2 <u>502.8</u> F 3.6
8+50	500.7 <u>501.8</u>	501.2 <u>502.2</u> F 1.0	501.4 <u>502.4</u> F 1.0	502.0 <u>502.5</u> F 0.5	502.3 <u>502.7</u> F 0.4	502.3 <u>503.0</u> F 0.7	501.8 <u>503.3</u> F 1.5
9+00	501.6 <u>502.2</u> F 0.6	501.8 <u>502.5</u> F 0.7	502.1 <u>502.9</u> F 0.8	502.7 <u>502.95</u> F 0.2	502.8 <u>503.3</u> F 0.5	503.2 <u>503.5</u> F 0.3	503.7 <u>503.7</u> 0.0
	501.9 <u>502.6</u> F 0.7	502.3 <u>502.9</u> F 0.6	502.7 <u>503.1</u> F 0.4	503.0 <u>503.4</u> F 0.4	503.3 <u>503.6</u> F 0.3	503.6 <u>503.9</u> F 0.3	503.9 <u>504.1</u> F 0.2
Ground 10+00	502.6 <u>503.0</u> F 0.4	503.0 <u>503.2</u> F 0.2	503.3 <u>503.5</u> F 0.2	503.50 <u>503.85</u> F 0.3	503.7 <u>504.0</u> F 0.3	504.1 <u>504.3</u> F 0.2	130' out 504.4 <u>504.5</u> F 0.1
	503.2 <u>503.5</u> F 0.3	503.6 <u>503.7</u> F 0.1	503.9 <u>503.9</u> 0.0	504.1 <u>504.3</u> F 0.2	504.1 <u>504.5</u> F 0.4	504.4 <u>504.7</u> F 0.3	130' out 504.5 <u>505.0</u> F 0.5
11+00	503.8 <u>504.1</u> F 0.3	504.2 <u>504.3</u> F 0.1	504.3 <u>504.5</u> F 0.2	504.6 <u>504.75</u> F 0.1	504.7 <u>505.0</u> F 0.3	504.6 <u>505.3</u> F 0.7	130' 152' 504.6 <u>505.4</u> F 0.8 505.0 <u>505.6</u> F 1.0
	504.1 <u>504.5</u> F 0.4	504.5 <u>504.7</u> F 0.2	504.5 <u>504.9</u> F 0.4	505.1 <u>505.2</u> F 0.1	505.1 <u>505.5</u> F 0.4	505.4 <u>505.7</u> F 0.3	505.2 <u>506.0</u> F 0.8
12+00	505.0 <u>505.0</u> 0.0	504.9 <u>505.2</u> F 0.3	505.1 <u>505.4</u> F 0.3	505.5 <u>505.65</u> F 0.1	505.6 <u>505.9</u> F 0.3	505.7 <u>506.2</u> F 0.5	505.5 <u>506.5</u> F 1.0
Ground 12+50	505.5 <u>505.3</u> 0.2	505.8 <u>505.6</u> 0.2	505.9 <u>505.9</u> 0.0	506.2 <u>506.1</u> 0.1	506.1 <u>506.3</u> F 0.2	506.1 <u>506.6</u> F 0.5	505.8 <u>506.8</u> F 1.0

③

Airport.

13+00

13+50

14+00

14+50

15+00

15+50

16+00

16+50

17+00

17+50

18+00

18+50

O.K.

Grade = + 0.9 070

Left

Right

	152'	100'	50'	4'	50'	100'	152'
13+00	505.9 <u>505.9</u> 00	506.5 <u>506.1</u> 00.4	506.6 <u>506.3</u> 00.3	507.10 <u>506.55</u> 0.6	07.0 <u>06.8</u> 00.2	507.0 <u>507.0</u> 00	506.8 <u>507.3</u> 01.5
	506.3	506.9	07.2	07.8	07.6	07.5	07.4
13+50	506.3 <u>00</u>	506.5 <u>00.4</u>	06.7 <u>00.5</u>	07.0 <u>00.8</u>	07.2 <u>00.4</u>	07.5 <u>00</u>	07.8 <u>00.4</u>
	506.9	07.4	07.9	08.5	08.4	08.3	08.1
14	506.6 <u>00.3</u>	06.9 <u>00.5</u>	07.2 <u>00.7</u>	07.45 <u>01.1</u>	07.6 <u>00.8</u>	07.9 <u>00.4</u>	08.1 <u>00</u>
Ground	06.9	07.7	08.1	08.7	08.7	08.7	08.6
Grade	07.1	07.4	07.6	07.9	08.2	08.4	08.6
	F 0.2	00.3	00.5	00.8	00.5	00.3	00
	07.1	07.7	08.2	09.0	08.9	08.9	09.0
15+00	07.5 <u>F 0.4</u>	07.7 <u>00</u>	08.0 <u>00.2</u>	08.35 <u>00.7</u>	08.5 <u>00.9</u>	08.7 <u>00.2</u>	09.0 <u>00</u>
	07.3	07.3	08.4	09.2	09.2	09.2	09.6
	08.1 <u>F 0.8</u>	08.3 <u>F 1.0</u>	08.5 <u>F 0.1</u>	08.8 <u>00.4</u>	09.0 <u>00.2</u>	09.2 <u>00</u>	09.6 <u>00</u>
	07.5	08.1	08.7	09.5	09.6	09.6	09.9
16+00	08.5 <u>F 1.0</u>	08.8 <u>F 0.7</u>	09.0 <u>F 0.3</u>	09.25 <u>00.3</u>	09.4 <u>00.2</u>	09.6 <u>00</u>	09.9 <u>00</u>
Ground	08.0	08.5	09.2	10.0	10.1	10.3	10.7
Grade	09.0	09.3	09.5	10.0	10.0	10.3	10.5
	F 1.0	F 0.8	F 0.3	00.3	00.1	00	00.2
	08.5	09.1	09.7	10.4	10.5	10.8	11.1
17+00	09.5 <u>F 1.0</u>	09.7 <u>F 0.6</u>	09.9 <u>F 0.2</u>	10.15 <u>00.3</u>	10.4 <u>00.1</u>	10.8 <u>00</u>	11.0 <u>00</u>
	08.8	09.3	10.0	10.6	10.7	11.3	11.6
17+50	09.8 <u>F 1.0</u>	10.2 <u>F 0.9</u>	10.4 <u>F 0.4</u>	10.6 <u>00</u>	10.8 <u>F 0.1</u>	11.0 <u>00.3</u>	11.3 <u>00.3</u>
	509.1	09.7	10.4	10.9	11.2	11.8	12.4
18+00	510.3 <u>F 1.2</u>	10.5 <u>F 1.2</u>	10.7 <u>F 0.3</u>	11.0 <u>F 0.1</u>	11.2 <u>00</u>	11.5 <u>00.3</u>	11.8 <u>00.6</u>

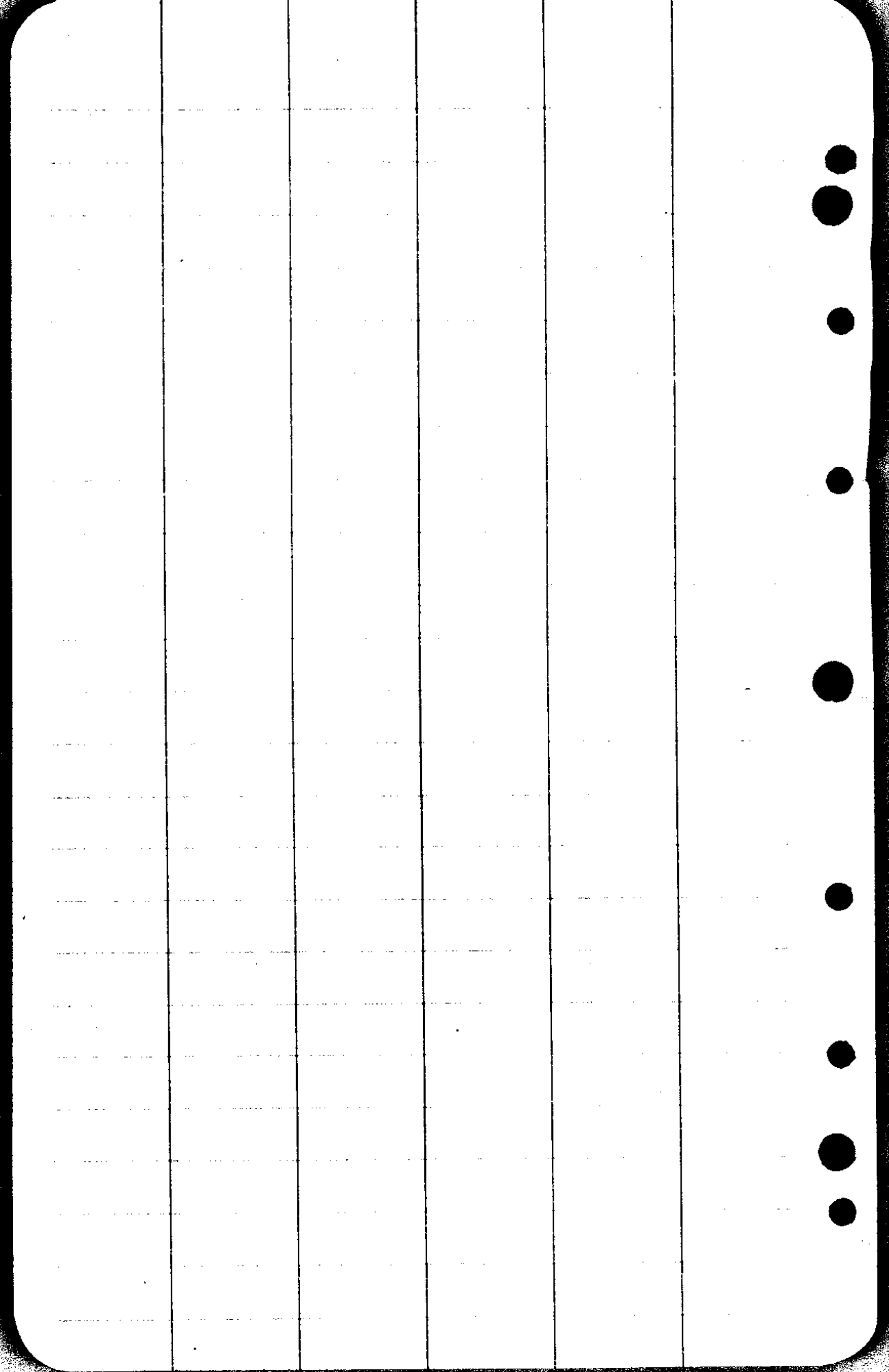

July 1936.

No grading done up to now
Planes have been landing
& taking off & all stakes
(almost) have been destroyed,
bet conc culvert & S End of
field.

23/48

