

Boyer, Oscar Olsen Axc, Roy Coon
R. chain 15

Found Pile Rocks & stump for 1 big Tree

Note: - After chaining thru on
E+W Line and finding the NE
Cor. D.L.C. 38. 49.3' South of Survey,
back up and set points (all) over
to the South by proportional
measurement.

Vault 23
Env. 30

Note: This eye bar is orig D.L.C. Cor. Loc'n

Survey for Harold Bellows Adm. May 9-1936
for See Culver Estate. - N. Line DLC 38/29/7

22+14.8 = Point 49.3' N of NW cor DLC 38
East 165.5 F

22+49.3
East 300.0 Flat

17+49.3
East 251.0 Vert. L = 9 1/2 247.5

15+01.8
East 29.8 F

14+72
East 291.7 F

11+86.2
East 260.4 F

8+19.9
East 137.5 F

7+52.4
East 21.6 F

7+60.8
E East 199.5 F

5+66.8
East 251.2 Flat

3+15.1
250.2

0+64.9
64.9 East 71.8

0+0 = Eye Bar = NW cor DLC 38

Vert L = 225.25 250.2

Vert L = 257.0 64.9

T 29 S
R 2 W

Set pipe

All 3/4" 20' x 18'

Set Pipe

Set Pipe

Set Pipe

Set by Frear

Survey H. Bellows - Geo Culvert Est.

opp. 49.4' N VERT L Dist

CORR
Dist $\sqrt{23/30}$

D 20+49.3

165.5 F. ✓
300' F. V

456 S

17+49.3

251.0 $9\frac{1}{2}^\circ$ 247.5 V

15+01.8 V

B. Big Hub

29.8 F

14+72 X

ON SNACK IN CK

291.7 F.

11+80.3 ✓

A

260.4 Fl.

9+19.9 V

E Side CK

137.5 Fl

7+82.4 V

W Side CK

21.6 Flat

7+60.8 ✓

194.5 Fl.

5+66.3 V

251.2 Fl.

3+15.1 X

270.8 $22^\circ 25'$ 250.2 V

E

71.8 $25^\circ 20'$ 64.9 X

Eye Bar = NW corner OLC 38 $29/7$

2' offset

May 9-36

Oscar Sizer, Roy Coon

Boyer 23/30

493 - Cur

165.5
 300
 247.5
 29.8
 291.7
 260.4
 137.5
 21.6

 1454.0
 334
 1

194.5
 251.2
 250.2
 449

 760.8

904
 718

 7232
 904

 6328

 64,9072

1454
 760.8

 2214.8 ✓

Note: After chaining
 an E-W line and finding
 the corner points over
 up and set points over
 corners by proportional
 measurement.

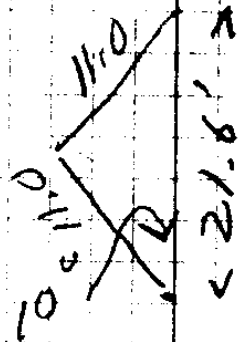

270.8
 924

 10832
 5416

 29372
 7502192

270.8
 924

 10832
 5416

 24372
 2502192

986
 251

 986
 4930

 1972
 247486

23/30

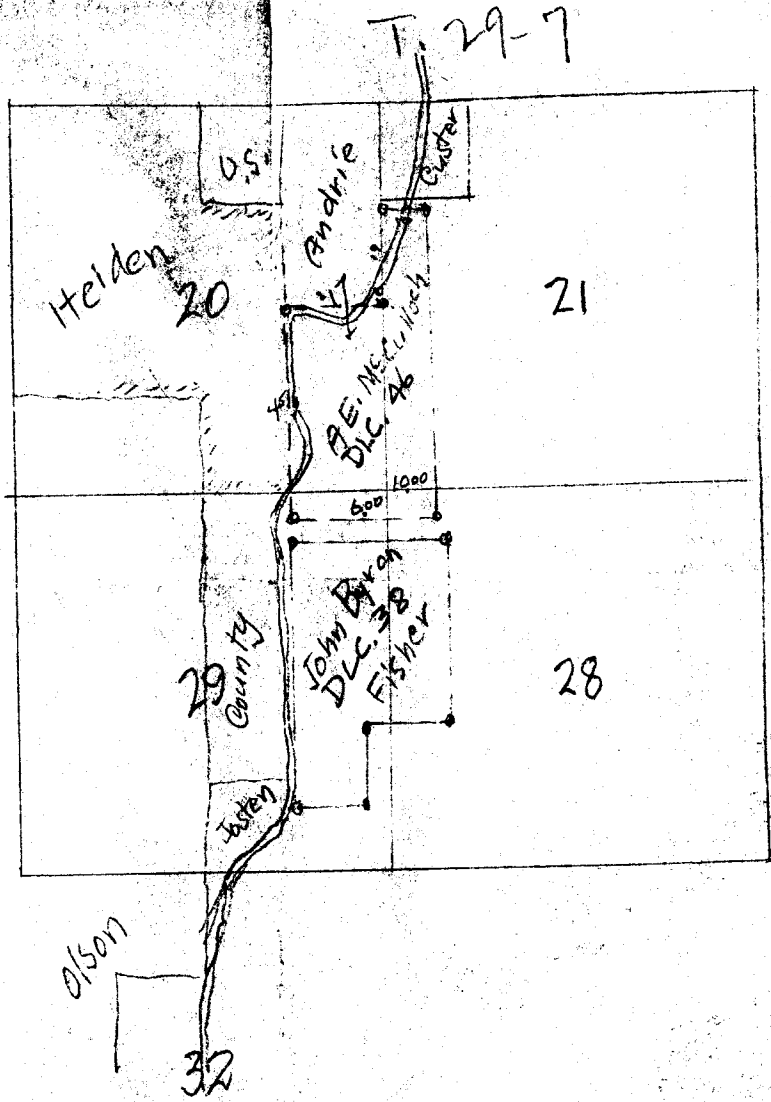

N. E. Cor C. 46 - 30" Fir - S. 34 fks.
6" Ash - E. 10 "

W. 10.00 - Allalla Cr.
Det Post Fir 10" - S. 40 W. - 16 1/2
Jamel 8" - S. 50 W - 38 "

SOUTH.
19.00 - 1/4 Cor 20-21
* 20.00 - Post. Fir 30" - S 20 E, 40 fks.
a.w.o. 10" - S 60 W, 44 "

WEST
21.00 - Post. Pine 14" N. 45° W. 312 fks. - 2059
Ash 14" S. 10° W 334 " - 2204

SOUTH
11.50 N. 7 K. Allalla Cr 25 fks c E
* 45.00 Post a.w.o. 5" N. 45° E 42 fks.
no other trees Stone Md.

* N.W. Cor C. 38 - Post - a.w.o. 8" - N. 20° W. 154 fks. 101°
South 57.00 Post. a Yellow Pine 18" - N. 60° E 393 fks.
a.w.o. 18" - N. 49° E 486 "

* 1/4 Cor 20-21 - a Jamel 8" S. 10° E, 85 fks
R. Fir. 10" N. 20° E 68 "

45
60
270
2970

29

0.9
1.0
2.0

DLC 46

25

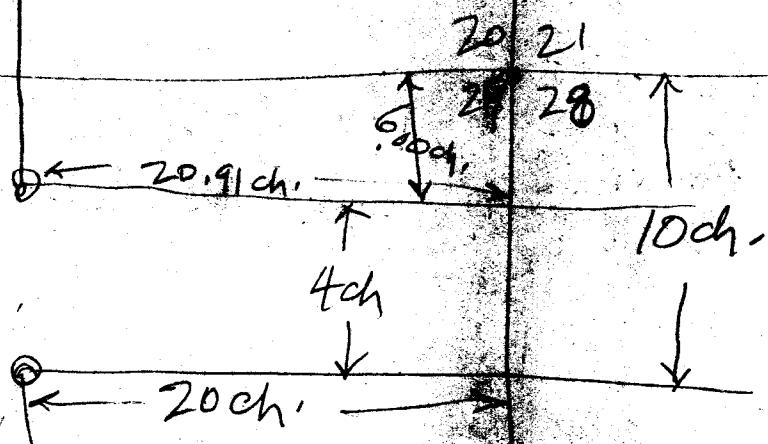

DLC 38

NW Cor Jno Byron DLC 38 - Found 1 old BT
 Drove 1" x 30" I. Bar
 12" Fir S 56-45 E 5.0'
 12" " N 83 W 8.9'
 36" Cedar - S 25 1/2 W 18'
 old BT 14" N. O. N 20 W

beg NW cor
 S-57 = Post { 4 P. 18" N 60 E 343 kS
 W. O. - 18" N 49 E 486 "

East
 North 39.50 Set Post from wh. - 20" B.O. N 70 W 23 kS
 12" " " N 5 W 31 "

W 13.76 = Line bet 28/29 10 ch S. of NE cor 29

13.76
 20
 33.76

3.376
 66
 202.56
 202.56
 2228.16

(3)

23
 23
 138
 1576

C1-48

Begin at Pt 6^o Ch S + 10 Ch E of SE cor
Sec 20 set Post for wh.

8" W.O. brs 570 W 10 lks

14" " " 530 W 17 "

N-6 Ch S = Line sec 21 & 28 10 Ch S 29
52 Ch 20

128
33

384
344
4744
2112

250.2
64.9

315.1
251.2

56.9
194.5

760.8
782.4

7782.4
137.5

919.9
260.4

1180.3
291.7

1472.0
29.8

1501.8
251

1752.8
35.2

165)22146.34
564
290
680

15701.8
247.5

17449.3
3

2049.3
165.5

2214.8

7295
R27W

Station survey from the NW corner of Sec 20 38
which is a 1 inch eye bar, removed by
J.C. & found on tree, from ^{East} ^{on}
random line, 2214.8 ft to a point
49.3 ft N. of the N.S. corner of sec 20
38 which is designated by a rock and
the stump of the leaning tree which is
N 70° W 23. Pines from the corner. Offsets
were then measured ^{by proportionate distances}
from the transit line ^{to the} true line

For the N line of D.C. 38 was ~~the~~
~~set~~ in this manner - 3/4 inch iron pipe
were set at ^{points} 64.9 ft, 315.1 ft, 566.3 ft
and 760.8 ft ^{from} the N.W. corner
of the ^{section} claim on the north line
of the claim