

**MAP TO ACCOMPANY**  
**RIDDLE, ORE. SCHOOL DIST NO. 70**  
**APPLICATION FOR WATER RIGHT OUT OF COW**  
**CREEK; DIVERSION IN NW<sup>4</sup>SW<sup>4</sup> AND**  
**AREA TO BE IRRIGATED IN SW<sup>4</sup>NW<sup>4</sup> 24, T.30S.; R.6W;**  
**DOUGLAS COUNTY, ORE.**

Scale, 1" = 800 ft.

Apr. 1936

Survey & Map by Arthur Boyer Prof. Eng'r Lic. 1581

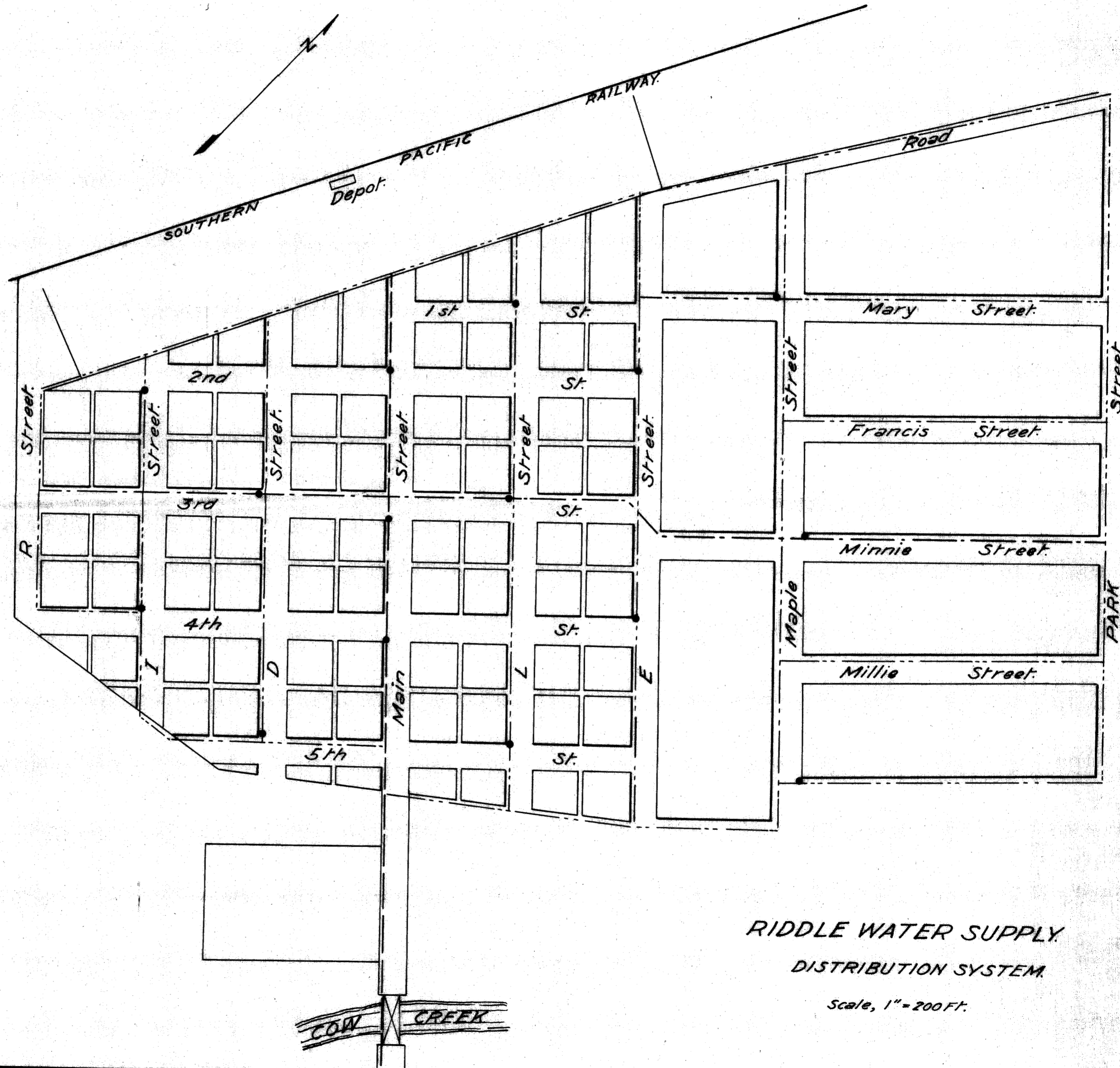

**LEGEND**

- 8" Water Pipe.
- - - 6" " "
- · - 4" " "
- Hydrants

**RIDDLE WATER SUPPLY  
DISTRIBUTION SYSTEM.**

Scale, 1" = 200 FT.

[Faint, illegible text on the left page of a notebook, possibly bleed-through from the reverse side.]

[Faint, illegible text on the right page of a notebook, possibly bleed-through from the reverse side.]

Riddie School Dist No 70 4/11  
Water Right from Cow Ck 1936

A Boyer

NE Richardson

Diversion - L. Bank Ck abt 50' E Co Rd  $\frac{R}{W}$

$N55^{\circ}59'W$  340.0

S. Side Fence on S. or Rt Bank Cow Ck.

$N51^{\circ}59'W$  287.0

Pt at NE Cor Ackert's Hs.  $\Delta = 66^{\circ}46'R$

$S61^{\circ}15'W$  1200.0'

$N50^{\circ}45'W$  112.0

SE Cor  
Vanderbosch D.L.C. # 47

In Sec 24, T30S R6W

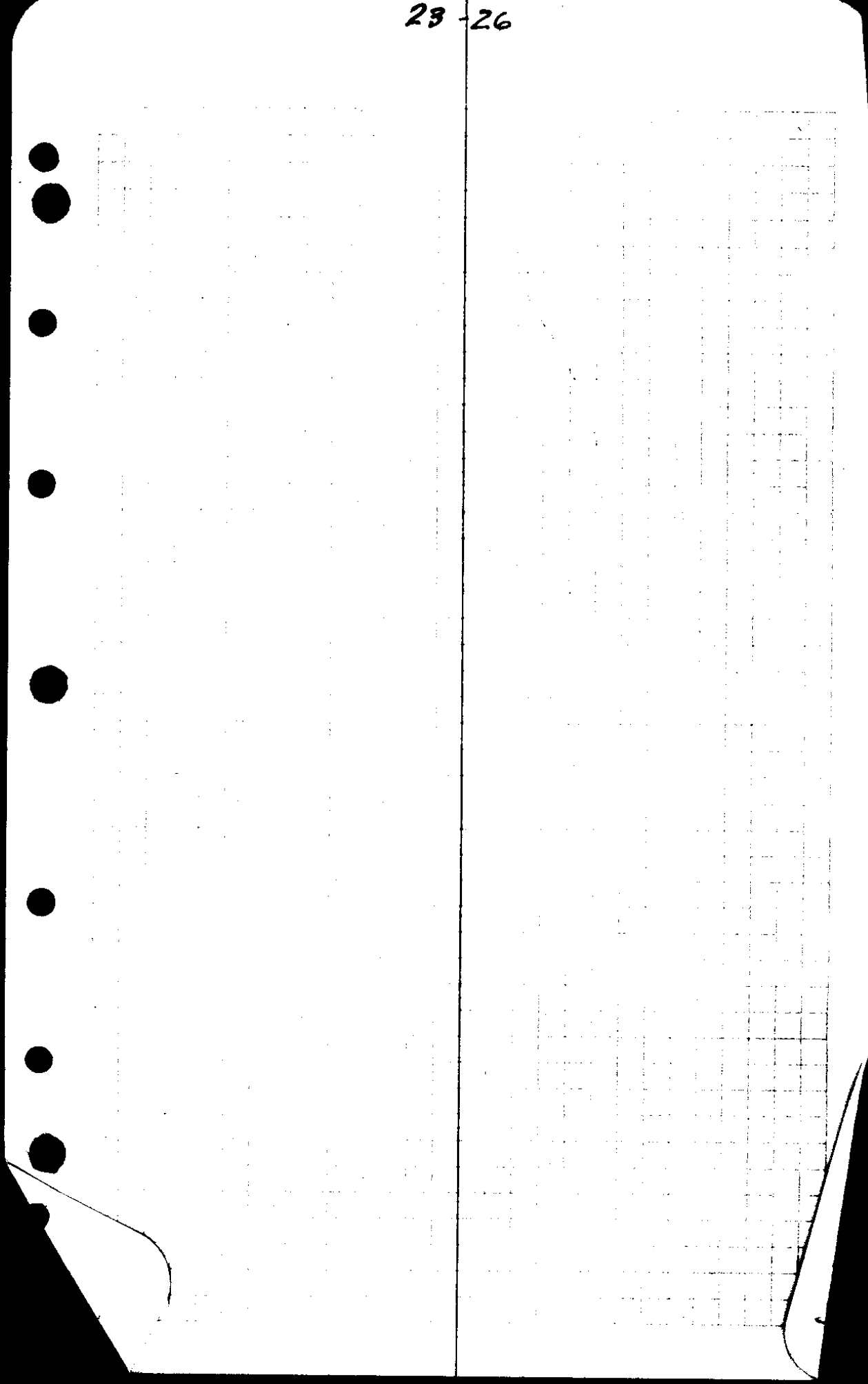

Riddle School Dist # 70

Pump  
Similar to Denning Oil  
Pite Pumping Unit Type  
"DA" Cap 2000 gal per hr  
4 x 2" Cylinder - 2" Suction

L Bank  
 CK  
 DIVERSION  
 $\Delta 4^\circ L$   
 N57 $\frac{1}{2}$ W 340.0'

$\frac{70.0}{80} = 0.875$   
 $340.0 \times 0.875 = 297.5$

N53 $\frac{1}{2}$ W 287.0'

Pt at NE CORNERS  $\Delta = 66^\circ 46' RT$   
 S61 $\frac{1}{4}$ W 1200.0'

50 $^\circ$  45'  
 N 57 $^\circ$  W. 112.0

SE COR DLC Vanderbosch

Abt Cen of  
School Grounds

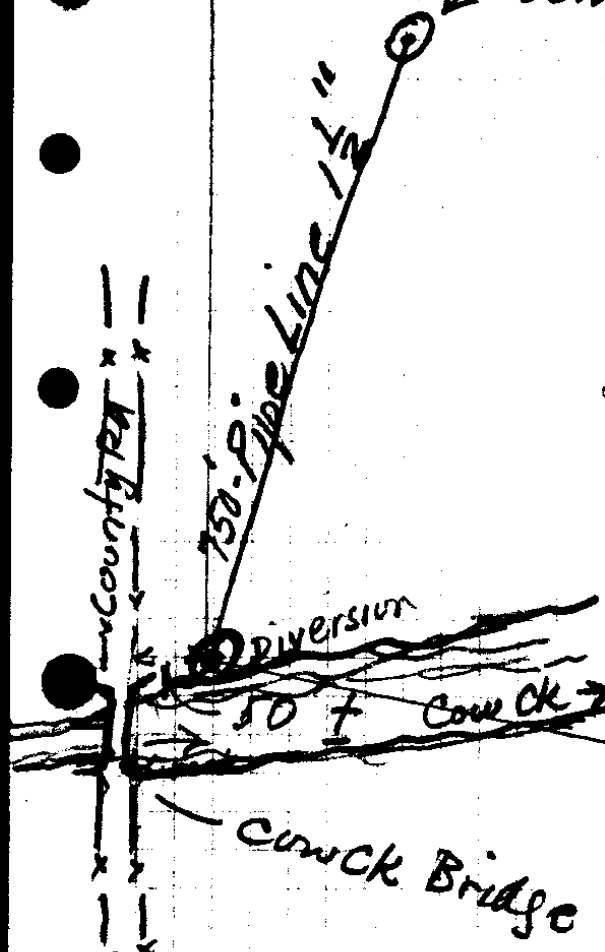

Pump to be used  
similar to Deming  
Oil Rite Pumping  
Unit Type "DA"  
Cap 2000 gal per hr.  
4" x 4 1/2" Cylinder  
2" Suction (1 1/2" disch)

S85-07 W 1636'

SE COR  
D.L.C. 47  
30/6

