

Sec 30 Sec 29
T.28S. R.7W.

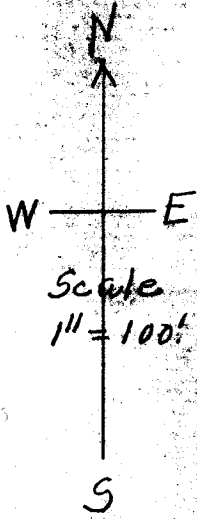

N 0°-16' W
772.2 feet

Christopherson's

1" x 18" I.P.

8" W. OAK
N 66°-30' E
172.0'

Hill Side

N 88°-52' E
4333'

10" F.I.
N 53°-30' W
233.8'

N 49° E 22.5'

Road

SECTION 30
SECTION 29

14" x 31"
U 110° 15'
65.78'

58°-20'
58.20'

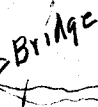

shields
5.116 Acres

Albro's

N 0°-08' W
561.4'

51°-18' W
124.8'

57°-02' W
101.8'

52°-40' W
177.5'

COUNTY

1" x 18" I.P.

N 89°-01' W
311.2'

Ward's

Christopherson's East line

Moss

Christopherson
Shield

| Sta | Dist | Angle | Bear |
|------------------|-------|-----------|-------------|
| Δ 11 | | | |
| S.E. Cor Δ 10 | 177.5 | 64° 20' L | N 27° 30' E |
| | 267.2 | Tan | S 88° E |
| Δ 9 | | | |
| S.W. Cor Δ 8 | 44° | 97° 19' L | S 87° E |
| | 36' | 8° 45' R | S 82° 53' E |
| | 45' | 0° 39' L | S 89° 01' E |
| Δ 7 | 300° | 51° W | S 89° 01' E |
| | 192.6 | 9° 32' R | S 89° 01' E |
| | | 52° N | S 89° 01' E |
| | | 51-20 W | S 89° 01' E |
| | | 50-12 W | S 89° 01' E |
| Δ 6 | | | |
| N.W. Cor Δ 5 | 29.4 | 98° 13' L | S 8° 30' E |
| | 85° | Tan | S 8° 30' E |
| | | W | S 8° 30' E |
| | | West | S 8° 30' E |
| Δ 4 | | | |
| V=8' 30" | 183° | Tan | S 88° 52' W |
| | 181° | | |
| Δ 3 | | | |
| | 167.3 | | W |
| Δ 2 | | | |
| Cor Δ 1 | 82° | Tan | West |

SE
10

Feb 10 1934

Q
Hor 2°-15
Ver 27-25
Time 2-15 PM
Hor 1° 51
of ver 27-55
Needles 30W

SW
NE
10" W.O.

Δ6 - 85° ft. 56° W - Long Shed 8" W. Oak.

17°
S N 66° 30' E

Δ3 - 50° ft N. to Creek

Δ1 - 12.7° ft to Creek

C. S. Pto No. 18/44

3

29-30

Cor. (1884)

V-430' 189° 7°15' L N4° W N3-43W

Δ D

V-830' (150!) 151° 8' 4°53' R N3° E N3-32E

Δ C

V-130' 133° 5' 5°44' L N1°15' W N1-21W

Δ B

V-1° 162° 2°14' R N4°30' ~~W~~ N4-23E

Δ A

V-930' (139.3) 141° 2' 92°09' R N2° ~~W~~ N2-09E

N.W. Cor.
Δ 5

Δ 4

29-30
 1/4 Oct.

26-7
 Rec.

25° 10" W Oak
 S 27° 30"

Δ 17 - 49° H to Creek

G.S. File No. 18/44

5

$\Delta 2$
COP. 1

93°28' L W

65° 11°15' L N3°15' E N3-27 E N25-20 E

$\Delta 14$

128° 12°17' R N14°30' E N14-42 E N13-35 E

$\Delta 13$

(124°)

V-7°

125°?

1°49' L N2° E N2-25 E N1-18 E

$\Delta 17$

(101°)

V-3°30'

102°

23°33' L N4°30' E N4-14 E N3-07 E

$\Delta 11$

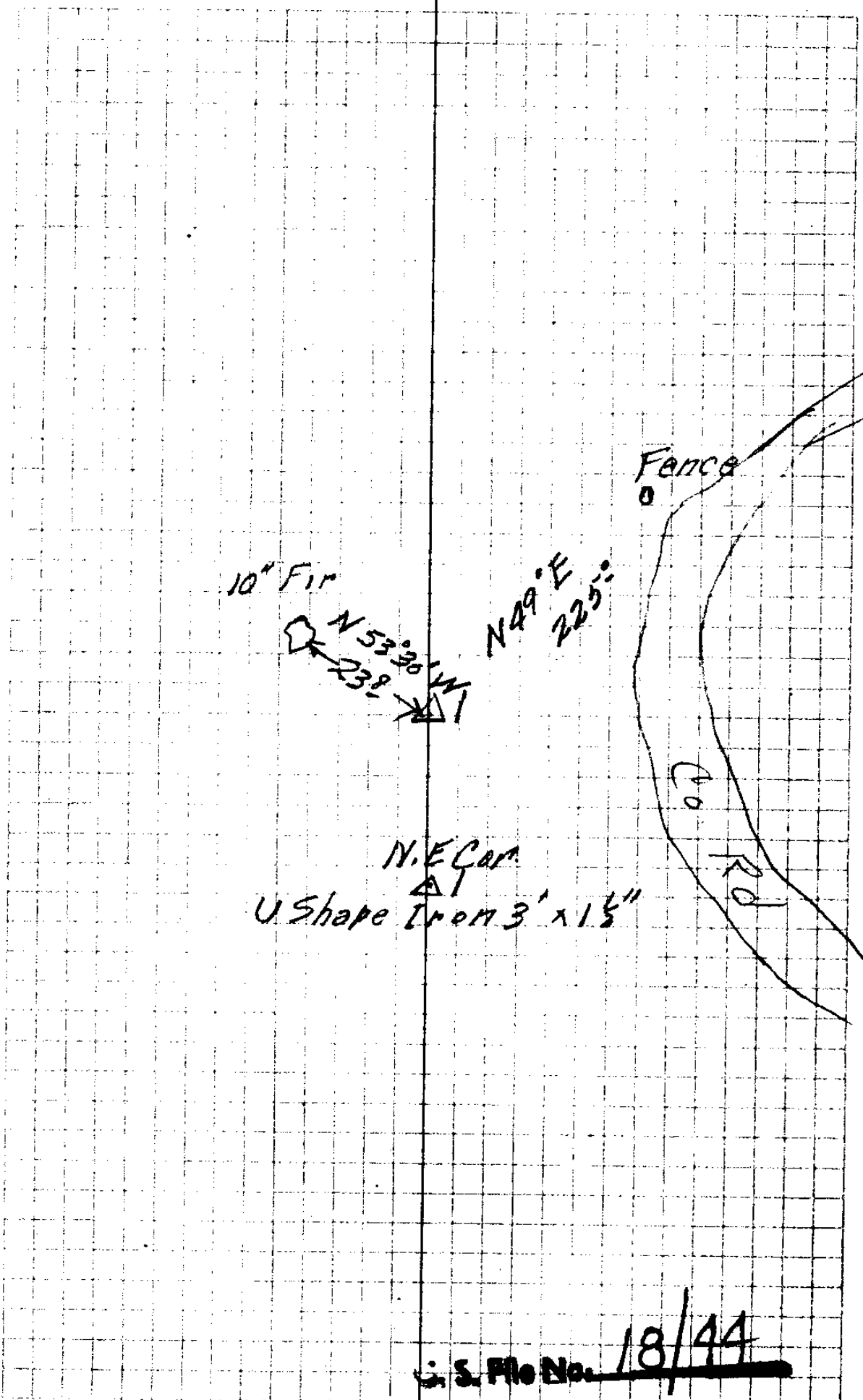

S. Plo No. 18/44

CS FILE FOLDER

CONTAINS

MORE

INFORMATION