

18-10A

Ground's Roseburg
Senior High School

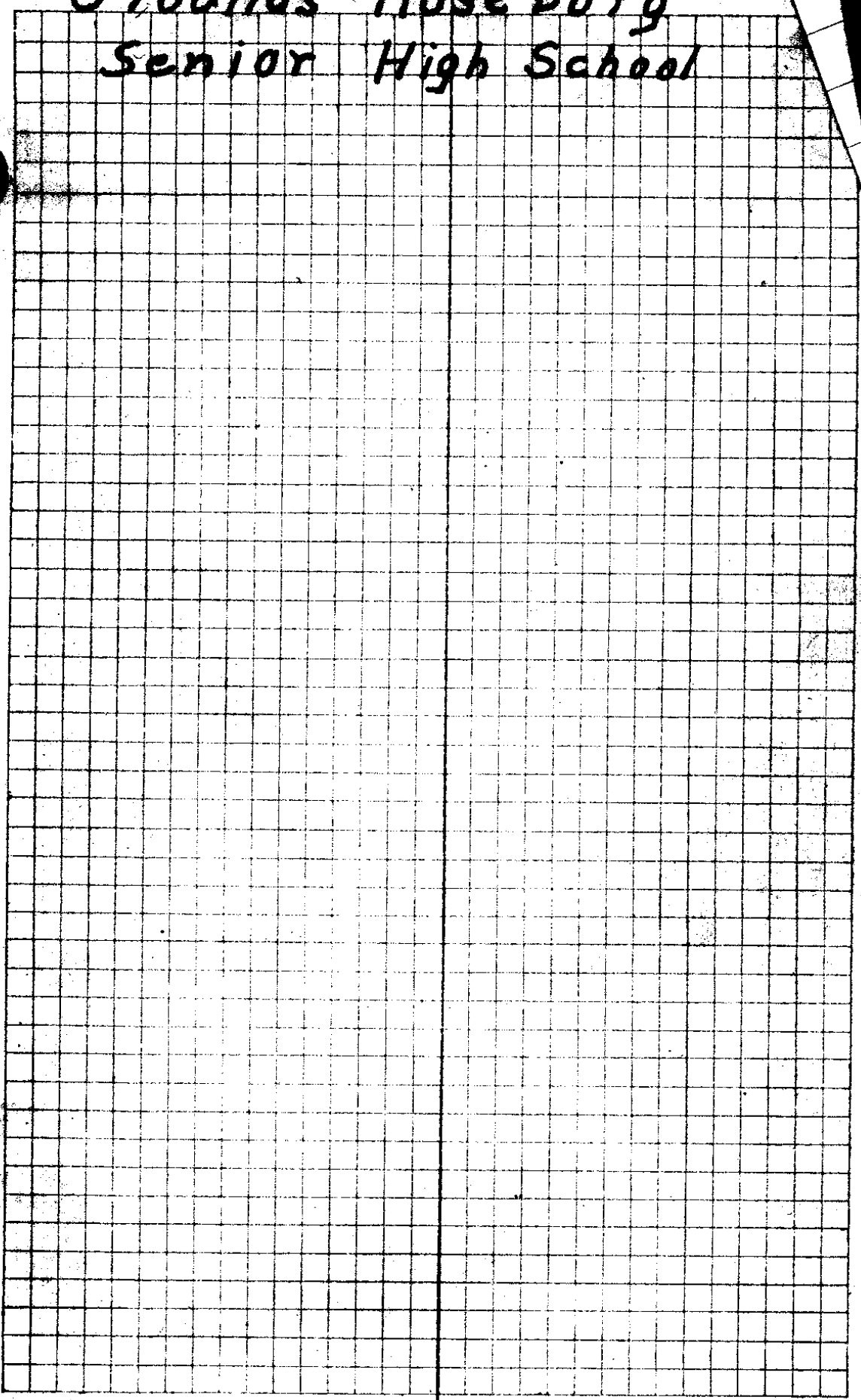

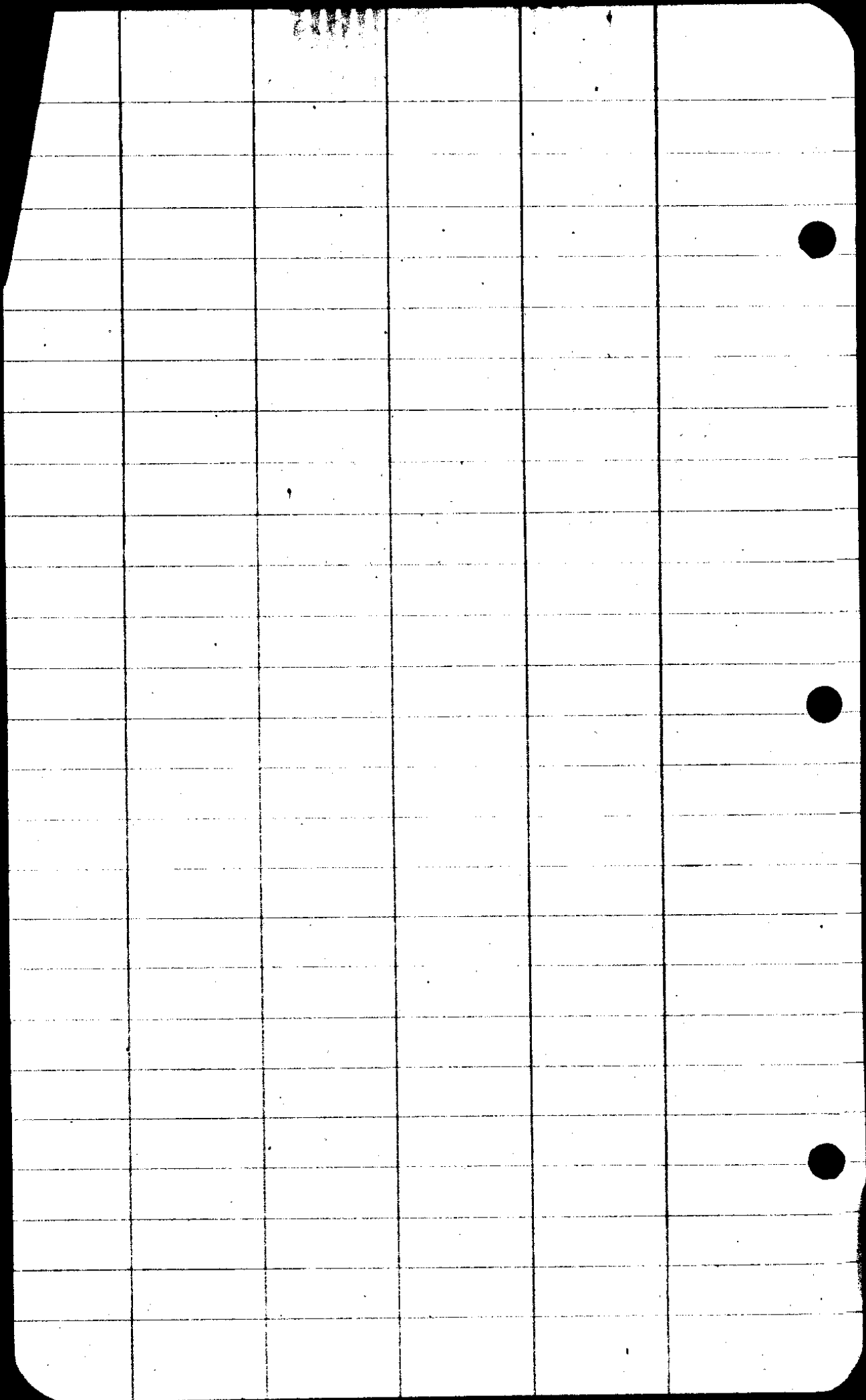

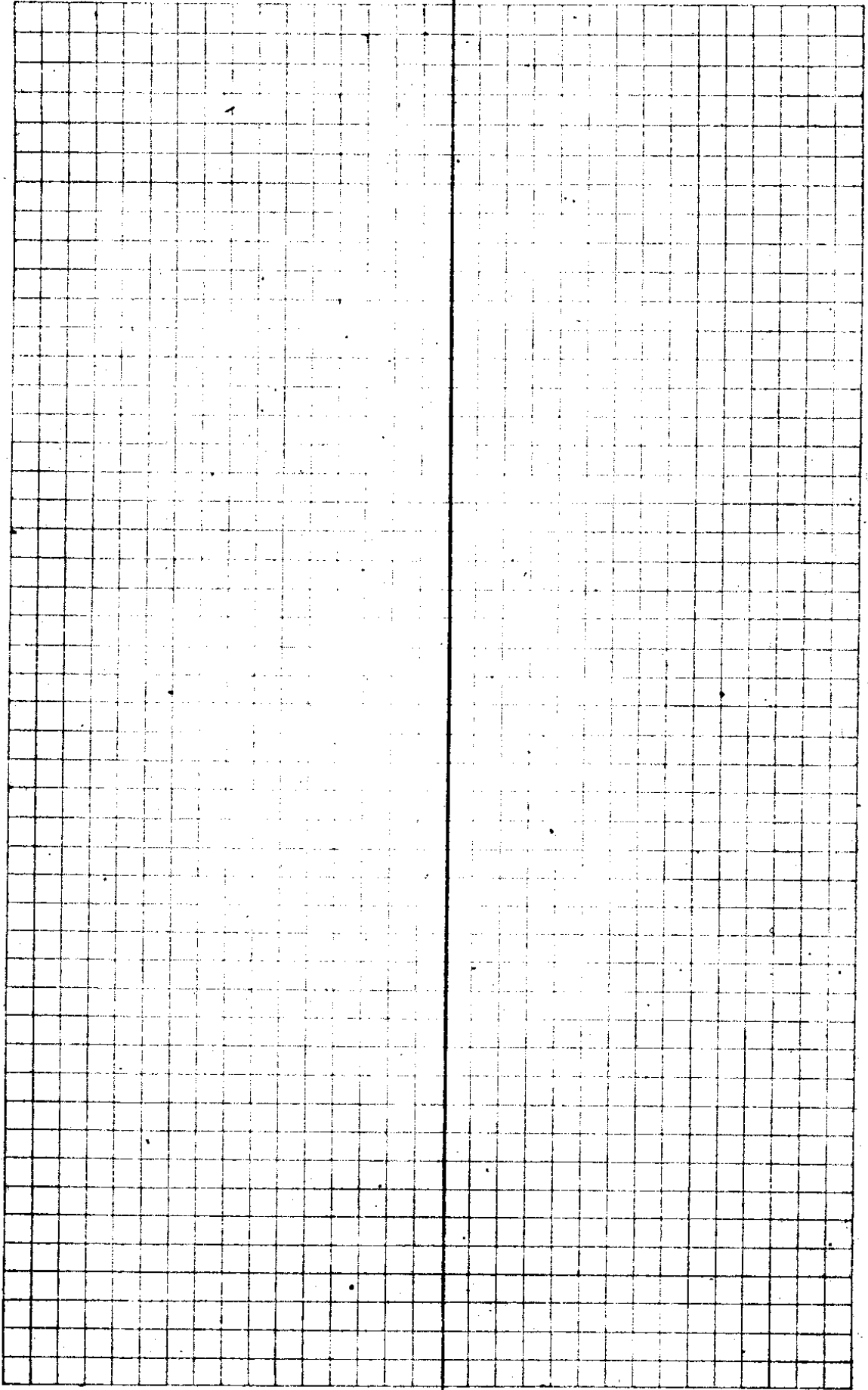

12/10A

HIGH SCHOOL ~~1/4~~ M TRACK

3+65.8

~~66.49° C.Lt
67.92° C.Lt = 67° 55'~~

~~$\Delta = 77^{\circ} 37' L - 77.62$~~

~~$R = 84.486.1$~~

~~$T = 69.3'$~~

~~$L = 115.7$~~

~~116.7.~~

2+49.1 = BC

1+28.7 BC

~~131° 04' C.Lt~~

~~$\Delta = 38^{\circ} 14' L$~~

~~$T = 15'$~~

~~$R = 44.7$~~

~~$L = 29.2$~~

0+99.5 B.C

0+54.5 BC

0+43

0+33 = 15° 00'

0+23.9 = 10° 00'

0+13.9 = 5° 00'

0+03.9 BC

170° CL

$\Delta = 50^{\circ} 37'$

$T = 27.1$

$R = 59.29$

$L = 50.6$

Apr. 6, 1981 } Boyer &
 } Epstein

0703.9
50.6

545

69.3

SE Car Tennis Court = 11287

18/10/81

High School $\frac{1}{4}$ Mi Track

32° C Lt.

$\Delta = 88.02$

275.09 = ST

850

~~840.49~~

~~90° C L~~

~~$\Delta = 88.52 L = 88.67^\circ$~~

~~ST = 62.4~~

~~R = 63.7~~

~~L = 98.7~~

7+062 = BC

EC

5+218-8°-17'

5+00-6°-37'

4+75-4°-45'

4+50-2°-53'

4+25-1°-01'

4+11.3 = BC.

15° C L

$\Delta = 16.35 L$

755.7'

L = 100.5'

Apr-6-1931

Eppstein

Byer

09

56

$$P1 \text{ to } 040 = 367.2$$

$$1023.4 = P1 \text{ to } 5A$$

18/10A

High School Track 7 mi
 As finally adopted +
 track laid on this alignment

¹
~~1958~~ EC ^{42°} 57'

+90 40°-30'

+80 36°-00'
 3

+70 31°-30'

+60 27°-00'
 30

+50 22°-30'
 31

+40 18°-00'
 30

+30 13°-30'
 30

+20 9°-00'

+10 4°-30'

0+0 BC

$\Delta = 85.55$

90° C

T 59.2

~~L 90.4~~

95.8

Apr 15, 1931.

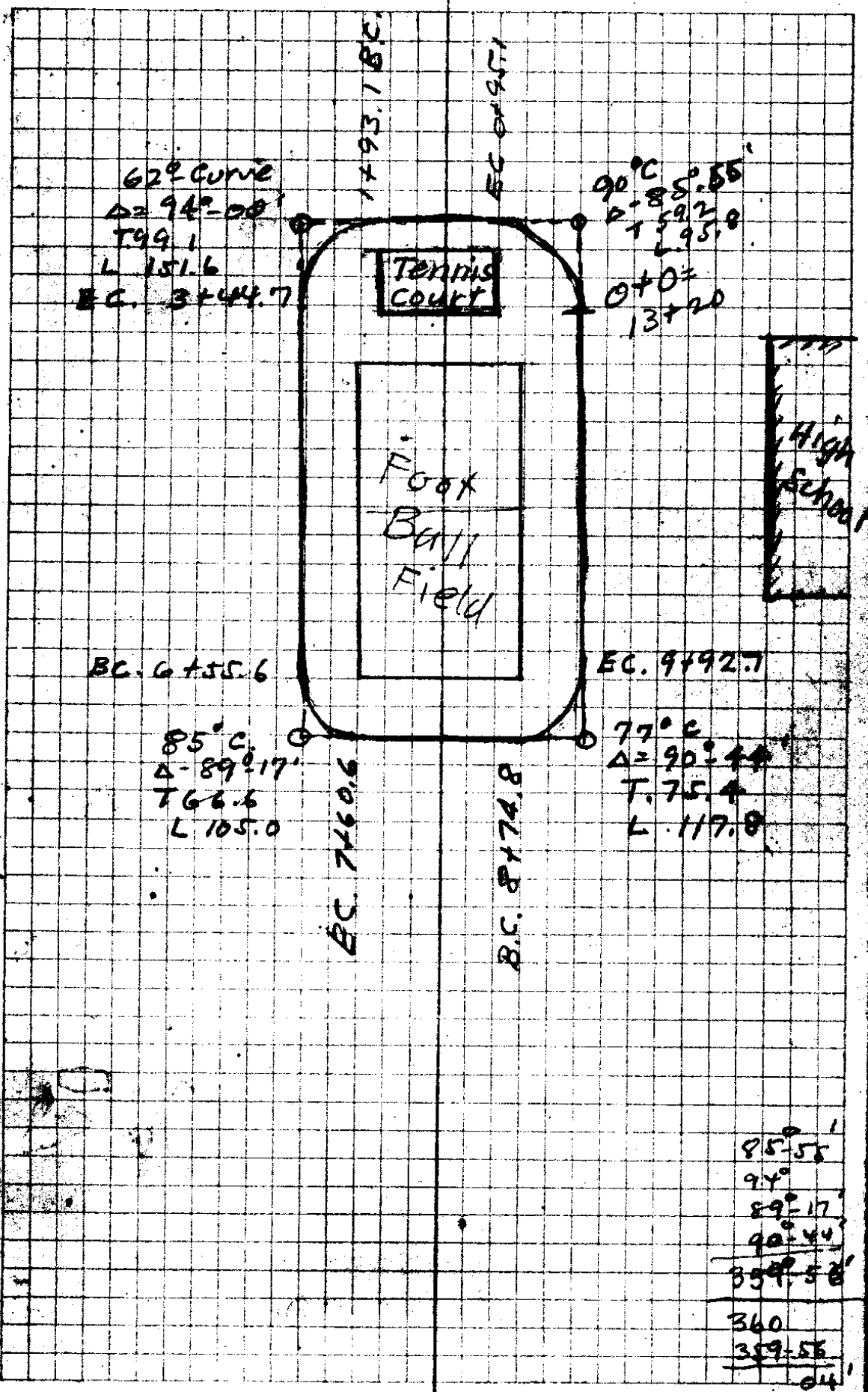

62° Curve
 $\Delta = 94^{\circ} - 00'$
 $T = 99.1$
 $L = 151.6$
 $BC = 3 + 44.7$

BC 1793.1

EC 0 + 95.1

90° C
 $\Delta = 85^{\circ} - 55'$
 $T = 59.2$
 $L = 95.0$
 $O + O = 13 + 20$

BC 6 + 55.6

EC 9 + 92.7

85° C
 $\Delta = 89^{\circ} - 17'$
 $T = 66.6$
 $L = 105.0$

EC 7 + 60.6

BC 8 + 74.8

77° C
 $\Delta = 90^{\circ} - 44'$
 $T = 75.4$
 $L = 117.0$

85-55'
 94'
 89-17'
 90-44'
 359.56'
 360
 359.56'
 04'

11/100

High School $\frac{1}{2}$ mi Track Apr 15, '31

1

+44.7 = EC

+40 1° - 2.7

+30 4-33
3-06

Back
in
curve

+20 7°-39°
3-26

+10 36°-14'

3+00 33°-08'

+90 30°-02'

+80 26°-56'

+70 23°-50'

+60 20°-44'

+50 17°-38'

+40 14°-32'

+30 11°-26'
3 06

62°-curve

$\Delta = 94-00'$

T = 99.1

L = 151.6

+20 8°-20'
3 06

+10 5°-14'
3 06

2+00.0 2°-08'
3 06

6.9'

3°-06'

+93.1 = BC.

0.5

$$\begin{array}{r} 175 \\ 18.1 \\ \hline 193.1 \end{array}$$

$$\begin{array}{r} 1193.1 \\ 1251.6 \\ \hline 3244.7 \end{array}$$

18.6

$$\begin{array}{r} 3206 \\ 2 \\ \hline 6012 \\ 1207 \\ \hline 7219 \end{array}$$

18/100

High School 1/2 mi Track

Apr 15, '31

~~42° Curve~~

~~$\Delta = 90^{\circ} 44'$~~

~~$138.2 = \text{Tan}$~~

~~$216 = L.$~~

9+78.6 P.I.

$2^{\circ} 06' - 10'$

$$\begin{array}{r} 4-12 \\ 1-15 \\ \hline 6-07 \\ 4-12 \\ \hline 10-19 \\ 4-12 \\ \hline 14-31 \end{array}$$

90 16°-19'

8+70 6°-07'

1+50 1°-55'

8+40.4 = BC

~~EC~~
~~1+50 21°-55'~~

~~1+40 37°-02'~~

~~1+30 32°-08'~~

~~1+20 27°-14'~~

~~1+10 22°-20'~~

7+00 17°-26' 98° Curve

1+90 12°-32' $\Delta = 89^{\circ} 17'$

80
6+60 7°-38' 7.57.7

70
6+50 2°-58' $L = 91.1$

BC 6+64.4

$4^{\circ} - 54'$ per 10'

7+22 = P.I.

28) 23 38.2 (3)

4750
19.6

674
694

$$\frac{80}{24} = \frac{10}{3}$$

3)

5.40

$$\frac{1170}{90} = 13$$

7.74

18

6

2

38

72.2

2.40

3.04

1.71

7.12 7.15 7.18

7.12

7.15

7.18

7.22

1.4

2.0

1.10

1.18

1.24

1.54

5

1.15

1.18

15/100

$13+20=00$

High School $\frac{1}{4}$ mi Track

Apr. 16

7
9492 EC

+90 44°21'

+80 40°30'

+70 36°39'

+60 32°48'

+50 28°57'

+40 25°06'

+30 21°15'

+20 17°24'

+10 13°33'

9+00 9°42'

+90 5°51'

8+80. 2°00'

8+74.8 = BC.

7+60.6 E.C.

+50 40°04'^{7'}

+40 35°52'

+30 31°37'

+20 27°22'

+10 23°07'

7+00 18°52'

+90 14°37'

+80 10°22'

+70 6°07'

+60 1°52'

BC.6+55.6

77° curve

 $\Delta=90°44'$

75.4'

117.8 L

P. 1.9+50.2

85°c.

 $\Delta=89°17'$

766.6

L 105.0

4° 15'

7 + 22.2
64.6

6 + 55.6
61.6

7 + 0.6

60 | 170 (28
120

500
480

20

85 | 59.28 (10.50
45

428

420

300

11/10/79

HIGH SCHOOL & MI. TRACK

Apr 16/31
Eppstein
Buyer
B.M.
SE Cor
Corey + Har-
vara

	FS	HI	-S	Elev
				449.54
	4.94	454.48		
T.P.			6.40	448.08
	2.22	450.30		
			6.79	443.51
	7.04	450.55		
12+00			6.50	444.05
11+75			6.53	44.02
18+50			6.51	44.04
11+25			6.51	44.04
11+00			6.51	44.04
10+75			6.40	44.15
+50			6.40	44.15
+25			6.55	44.00
10+00			6.68	43.87
9+92? E.C.			6.65	43.90
9+90			6.65	43.90
9+80			6.67	43.88
9+70			6.65	43.90
9+60			6.59	43.96
9+50			6.47	44.08
9+40			6.41	44.14
9+30			6.32	44.23
9+20			6.29	44.26

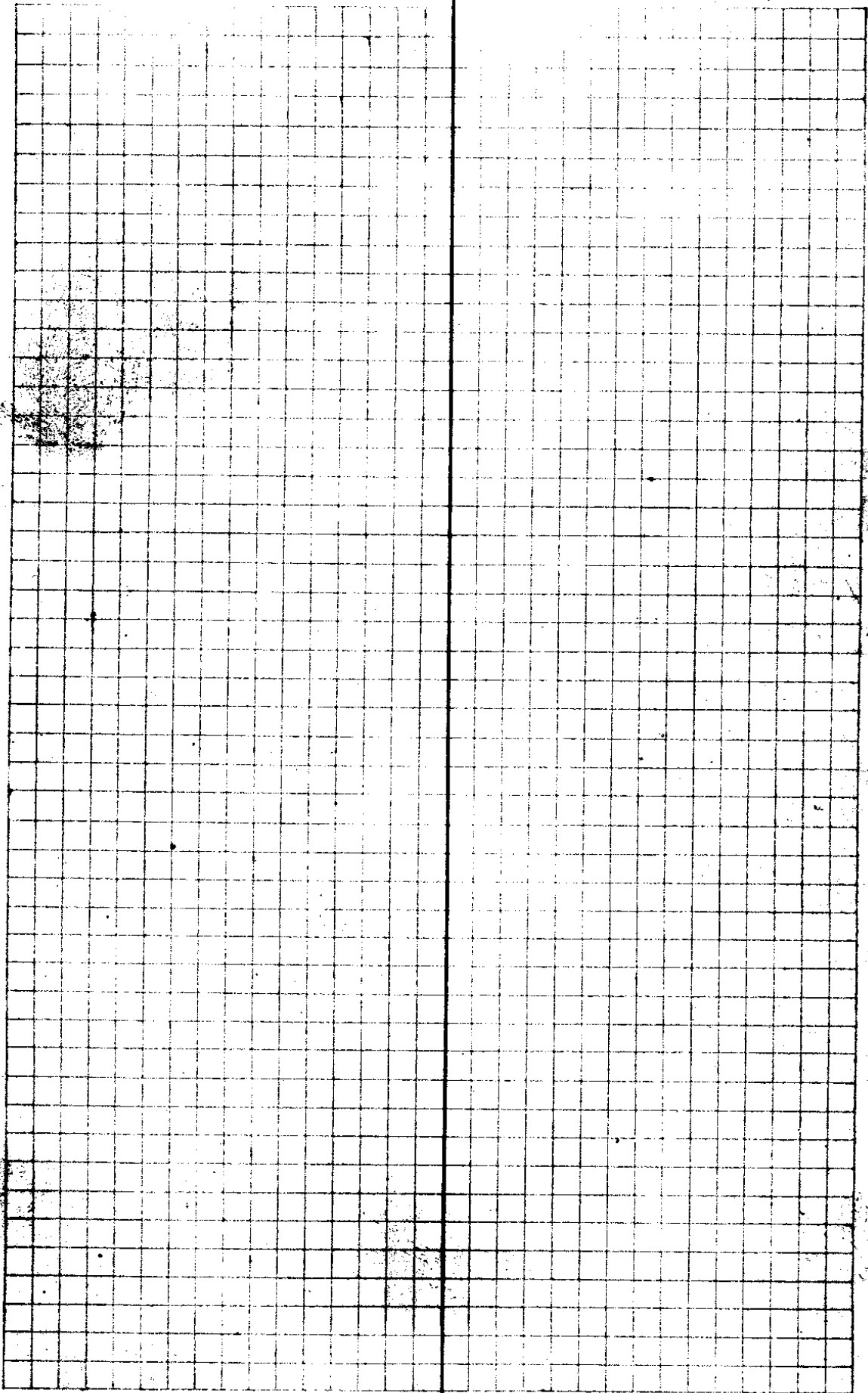

18/109

High School & mi Track

Apr 16
Eppstein
Bayer

	FS.	H.I.	-S	Elev
9+10		450.55	6.21	44.34
9+00			6.18	44.37
8+90			6.21	44.34
8+80			6.15	44.40
8+74 ⁸ B.C.			6.17	44.38
8+50			5.92	44.63
8+25			5.61	44.94
8+00			5.36	45.19
7+75			5.62	44.93
7+60 ⁶ E.C.			5.76	44.79
7+50			5.84	44.71
7+40			5.88	44.67
7+30			5.90	44.65
7+20			5.87	44.68
7+10			5.84	44.71
7+00			5.89	44.66
6+90			5.95	44.60
6+80			5.93	44.62
6+70			5.93	44.62
6+60			5.93	44.62
+55 ⁶ B.C.			5.90	44.65
6+50			5.92	44.63
+25			5.88	44.67
6+00			5.82	44.73

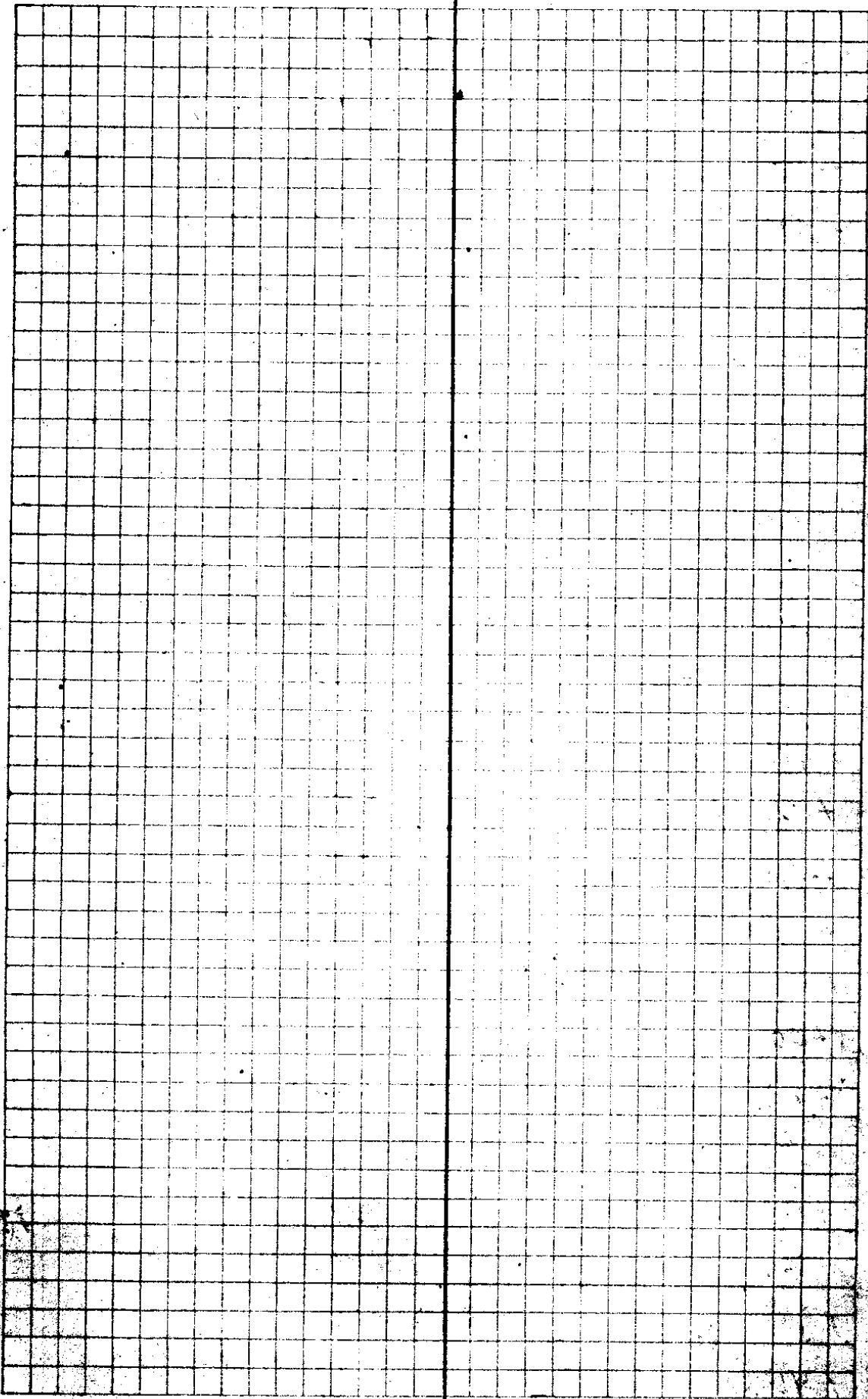

18/109

High School 2 mi Tract Apr 16/1931

Byler
Eppstein

Sta.	HS	H1	S	Elev
		450.55		
5+75			5.75	44.80
+50			5.73	44.82
+25			5.76	44.79
5+00			5.73	44.82
4+75			5.75	44.80
+50			5.76	44.79
4+25	T.P.		5.73	44.82
	5.38	4450.20		
4+00			5.32	44.88
3+75			5.25	44.95
+50			5.30	44.90
+44.2	EC		5.26	44.94
+40			5.27	44.93
3+30			5.22	44.98
+20			5.26	44.94
+10			5.32	44.88
3+00			5.31	44.89
2+90			5.25	44.95
+80			5.20	45.00
+70			5.01	45.19
+60			4.96	45.24
+50			4.95	45.25
+40			4.90	45.30

By [unclear] [unclear]

1/10 3 1/2

1/10 3 1/2

1/10 3 1/2

1/10 3 1/2

1/10 3 1/2

1/10 3 1/2

1/10 3 1/2

HIGH SCHOOL TRACK

APR 1931
BOYD
EPPSTEIN

Sta	H.I.	→	Elev	
2+30	4450.20	4.45	45.75	
+20		4.54	45.66	
+10		4.60	45.60	
2+00		4.59	45.61	
1+93.1 B.C.		4.59	45.61	
1+75		4.66	45.54	
+50		4.92	45.28	
+25	2.80	5.18	45.02	
1+00		4.36	45.84	
+95.1 B.C.		4.60	45.60	
+90		3.78	46.42	
+80		5.06	44.44	
+70 T.P.		5.29	44.91	
	9.18	449.09		
2+60		4.38	44.71	
+50		3.82	45.27	
+40		3.78	45.31	left of Tree
+30		4.26	44.83	
+20		4.70	44.39	
+10		4.28	44.81	High
0+0 = 13+20		4.49	44.60	
13+06		4.82	44.27	should be grade
12+75		4.83	44.26	
+50		4.89	44.20	
+25		4.82	44.27	
12+00		5.03	44.06	B. at top
		4.74	44.35	conc. drain

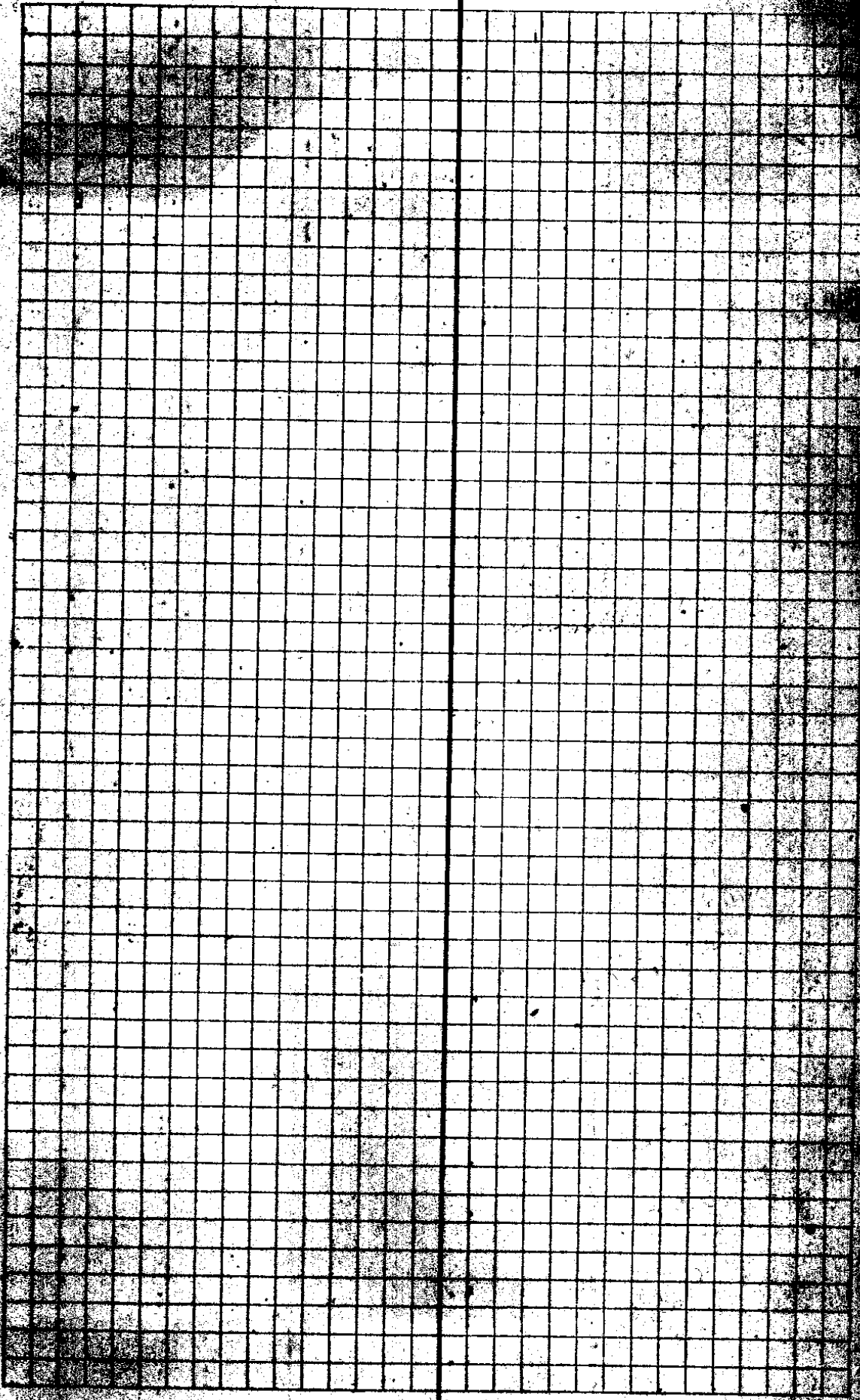

12/10/00

School

