

105.12
72.38

6'
263.01 W
~~72.38~~
10-23 W

5201
~~146~~
4102

94.4

38

Survey for Gen. Pet. Corp. for
S. End Service Sta. Property, Roseburg

N 57° 51' W

S 28° 10' W

28-10	180
89-51	118-01
118-01	61-59

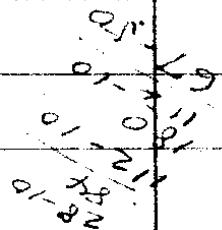
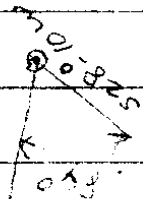
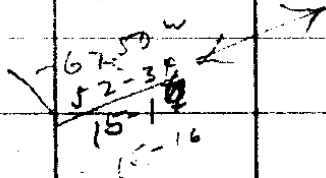

June 7, 1931.
H. L. Eppstein

①

Bert Lane
Gene Richardson
A Boyer.

70
28-10
27-18
52

Prop. Cor.
Iron Bolt in
from prev. survey.

Stephens

Monument in
Rice St

102.1'
S 28° 10' W

S 28° 10' W

R. P. B. C. B. N. S. I. S. 1916
N 70° W
84'
S 28° 10' W
S 27° 10' W
S 25° 10' W
S 23° 10' W
S 21° 10' W
S 19° 10' W
S 17° 10' W
S 15° 10' W
S 13° 10' W
S 11° 10' W
S 9° 10' W
S 7° 10' W
S 5° 10' W
S 3° 10' W
S 1° 10' W

P.C. - in Center Stephens
Monument in
St

S 28° 10' W
S 27° 10' W
S 25° 10' W
S 23° 10' W
S 21° 10' W
S 19° 10' W
S 17° 10' W
S 15° 10' W
S 13° 10' W
S 11° 10' W
S 9° 10' W
S 7° 10' W
S 5° 10' W
S 3° 10' W
S 1° 10' W

Prop. Cor.
30'

Stephens

15/7

Gen Corp

6-7-31

45 Pine

Tack set by
BPP Stein
part of 1931
spring

⊕ Flood St

⊕ Tack
Sykes

⊕ Monument in
set up here
Burk St

Sta	Dist	Gen L	Corp M.B.	Pet C.B
-----	------	-------	-----------	---------

J	202.5 ²	61° 59' 52" LT	N 28° 00' 00" E	
---	--------------------	----------------	-----------------	--

I	142.3		East	
---	-------	--	------	--

H	60'		N 10° 05' W	N 10° 23' W
---	-----	--	-------------	-------------

SW Cor		53° 01' RT		
Prop	73.4	52° 35' R		N 63° 01' W

6-7-31

(3)

	SIN	COS	
N 27° 18' E - 18.7'	.45865	.88862	8.576 N - 16.417 E
N 67° 50' W - 84.1'	.92609	.37730	33.45 N 77.79 W
S 84° 32' W - 144.1'	.99545		- 09.527
S 64° 12' W - 154.4'	.90032		- 43.523
N 63° 01' W - 73.4'	.89101		- 45.398

Charred Hub = J TIE

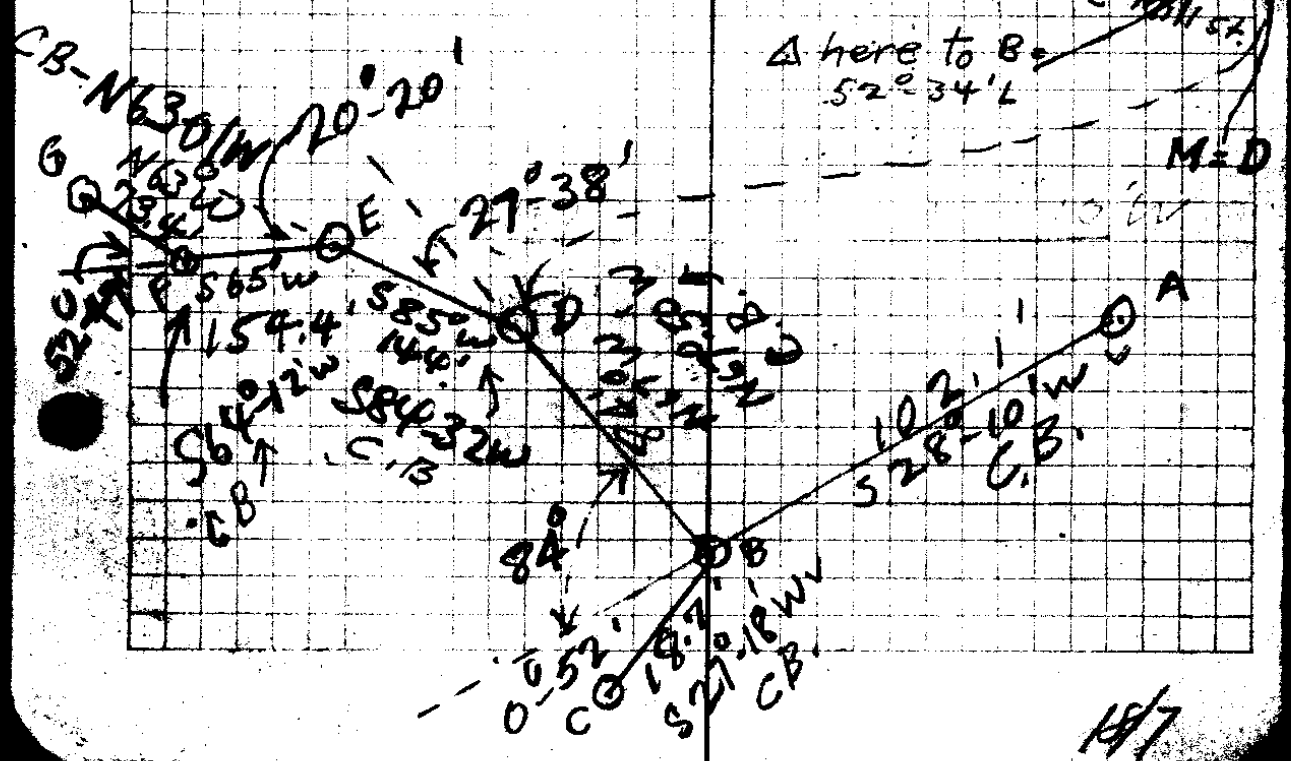
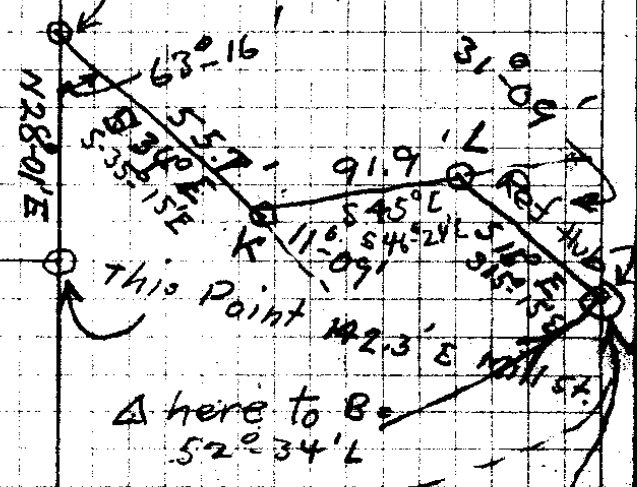

187

Set up	F.S.	Gen Ret Corp R	L	Dist	Shot No
B.	D.		1'		
"	"		12°-45'	14.2'	B. 1
			4°-48'	60.6'	B 2
					B 3.
		83°-43'		31.9	B.4
		51°-00'		50.6	B.5
		23°-17'		37.0	B.6
		38°-00'		78.0	B.7
		40°-00'		72.0	B.8
		14°-30'		66.0	B.9
		111°-06'		57.0	B.10
		92°-26'		102.7	B.11.
					B.12
		79°-04'		69.0	B.13
D	E		106°-30'	8.4	D.1
			72°-30'	37.0	D2
			53°-34'	56.	D3
			37°-42'	70.0	D4
			26°-20'	82	D5
			15-50	75.5	D6

6-7-31

(4)

NE Cor Garage

SE " " 12' N " C "

NW " "

Middle Bldg

SE Cor Island - Elev Prev Taken

Conc Post for Air Service

Surf Grnd

" "

Flag Pole

SE Cor Lunch Room

Not taken

Surf Grnd

NW Cor Wood Shed

S Pipeline

"

SE Cor Cottage

NE " "

18/7

Gen Pet Corp

Setup	F.S	R	L	Dist	Shot No
D	E		22°-26'	59.0	D7
			40°-00'	41.0	D8
			2°-22'	64.3	D9
			2°-22'	30.0	D10
			Several Shots Not taken		D. 11 Out of range
			77°-53'	81.5	D15
			89°-22'	64.5	D.16
			76°-00'	28.0	D.17
			142°-00'	45.0	D18
			115°-00' 65°-00'	45.0	D19
			159°-00'	117.8	x
			149°-00'	101.0	D21
			141°-00'	70.0	D22
			138°-30'	86.4	D.23
			122°-20'	67.0	D24
			116°-30'	111.5	D25
			116°-30'	87.0	D26
			104°-34'	117.5	D27
			95°-30'	97.0	D28
			97°-14' 82°-46'	80	D29
			86°-26'	94.0	D30
			90°-45'	107.	D31

6-7-31

(5)

Ground

77.53

SE Cor Bldg

Surf. Gend.

9.5

1.20

97.73

82.45

SE Cor Row of Cottages

cen. Flower Bed

Ground

SE Cor Store - No Level Shot

SW Cor Store

Store NW Cor Haywire for distance or sur angle

Back Side Cottages

Stake
Pipe on Prop Line - Kimball Survey Lot

Front Cottage Row in line with N^W Fence

187

Set
up
E

F.S.
F.

Gen Pet Corp

R

L

Dist

Shot No

172°-00'

52.8'

E 4 Dist?

110°-06'

19.8

E 5

191-22

30.0'

E 6

150°-00'

44.0

E 9

124°-34'

26.0

E 10

90°-00'

15.0

E 11
Alder tree

157°-00'

37.0

E 12

156°-15'

33.0

E 13

153°-22'

32.0

E 14

151°-39'

19.0

E 15

147°-50'

25.0

E 16

146°-50'

32.5

E 17

138°-40'

53.0

E 18

136°-42'

46.0

E 19

131°-45'

36.0

E 20

134°-55'

57.5

E 21

126°-18'

Avg 59.4
Dist

E 22-E 27

3°-00'

20.5'

E 23

72°-12'

35.0

E 24

69°-00'

51.5

E 25

104°-47'

36.5

E 26

27°-10'

E 27-E 22

27°-10'

44.0

E 28

16°-00'

36.5

E 29

6-7-31

6

Cor Bldg NW Cor

Hydrant

SE Cor Conc. Heating Plant - Dugout

S. W. " " " "

Surf Ground.

On Prop Line

Fork in Sewer Lines Y

Prop Line

18/7

set
ap
E

Gen Pet Corp

F.S	R	L	Dist	Shot No
F	56°-00'		34.5	E 30
	87°-16'		47.5	E 31
	110°-14'		62.0	E 32
	103°-12'		81.0	E 33
	101°-00'		50.0	E 34
	86°-24'		67.0	E 35
	68°-10'		53.0	E 36
	43°-00'		49.0	E 37
	16°-13'		49.0	E 38
		8°-14'	61.5	E 39
	1°-44'		87.0	E 40
	17°-00'		74.0	E 41
	32°-28'		69.0	E 42
	45°-00'		76.8	E 43
	48°-25'		65.0	E 44
	64°-36'		73.0	E 45
	79°-55'		82.5	E 46
	41°-18'		95.0	E 47
	32°-00'		94.0	E 48
	21°-40'		95.0	E 49
	13°-06'		105.0	E 50
	24°-30'		120.0	E 51
	38°-41'		119.0	E 52

6-7-31

7

Manhole for Sewer.

Prop Line:
Prop. Line

← On Δ "I" Prop Cor.

On Y. For Sewer to ^S NW Cor Cabin which is
furthest S + W

Prop Line (close to)

sewer

Prop Line

187

Gen Pet Corp

Set Up	FS	R	L	Dist	Shot
K	L	74°-00'		89.2'	K.6
		83°-20'		100.0	K.8
		86°-24'		76.0	K.9
		92°-50'		53.0	K.10
		102°-40'		35.0	K.11
		133°-50'		20.0	K.12
	x	198°-00'		20.0	K.13
	x	209°-49'		33.0	K.14
	x	194°-38'		50.0	K.15
	x	191°-08'		55.7	K.16
	x	188°-51'		56.8	K.17
		168°-34'		39.0	K.18
		168°-34'		51.0	K.19
		138°-43'		43.0	K.20
		143°-08'		54.0	K.21
		118°-00'		54.0	K.22
		118°-00'		68.0	K.23
		105°-00'		75.0	K.24
		108°-14'		87.2	K.25
		112°-08'		82.5	K.26
		92°-55'		85.0'	K.27
		101°-47'		106.0'	K.28
x	L				x'

6-7-31

9

SW Cor Cottage Row

On Hub ^{" "}J (Charred Hub by Prev Survey)
On Iron Pipe - prev survey

Poplar tree
On Prop Line

△
Note X = point 24.7' ahead of K on line
from K to L

18/7

10

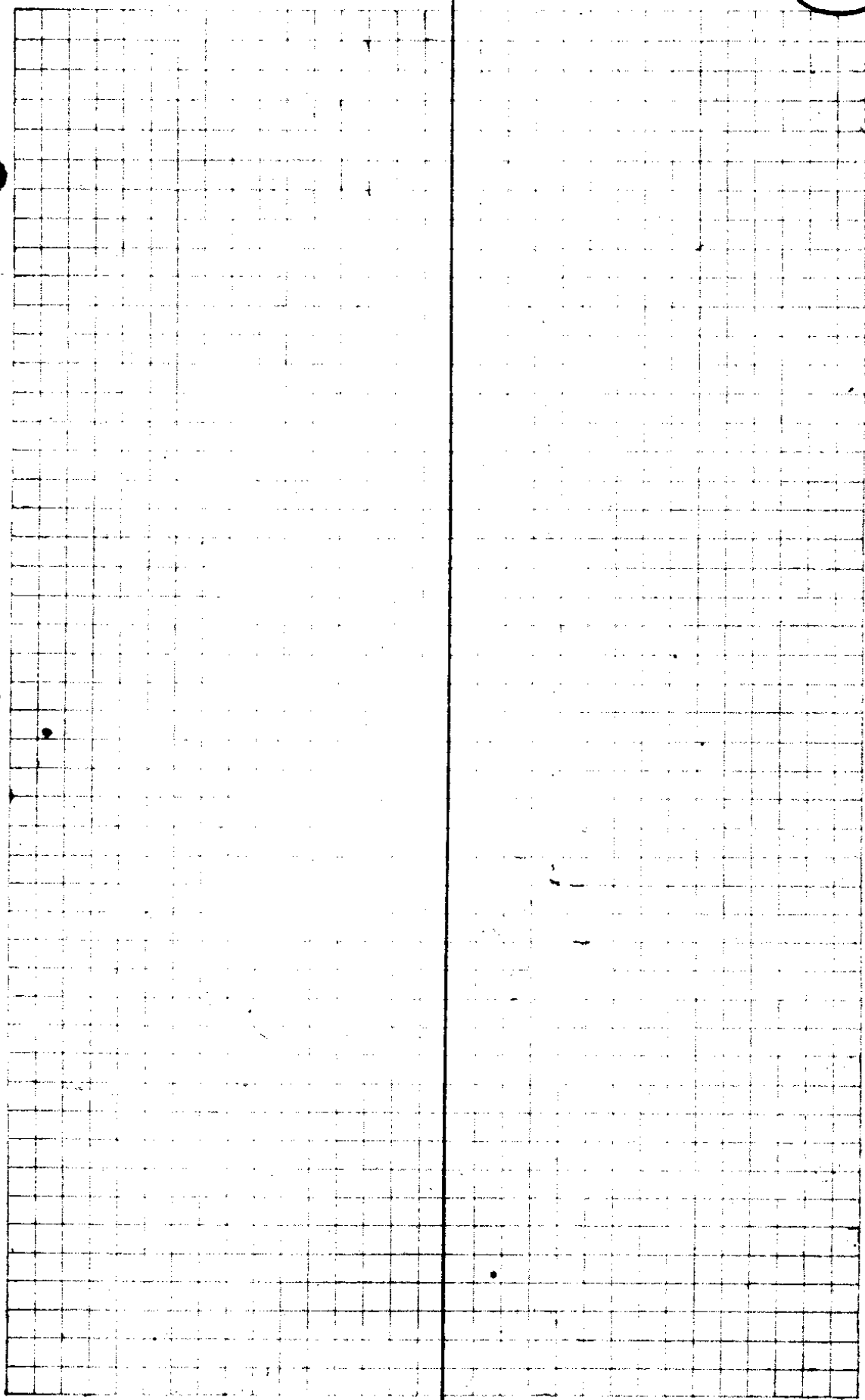

18/7

Set
up
X

FS.
L

Gen Pet Corp

R

L

DIST

		37°-25'	28.6	X2	
		4°-12'	28.0	X3	
		8°-45'	47.0	X4	
		28°-24'	49.5	X5	
		21°-10'	35.5	X6	
		8°-30'	50.5	X7	
		38°-50'	24.0	X8	
		86°-11'	21.5	X9	
		130°	130°-00'	10.2	X10
			118°-00'	28.5	X11
		41°-00'	47.0	X12	
		58°-52'	41.5	X13	
		80°-51'	41.5	X14	
		78°-38'	58.0	X15	
		65°-40'	59.0	X16	
		50°-30'	63.5	X17	
		56°-39'	82.0	X18	
		65°-33'	80.0	X19	
		79°-20'	83.0	X20	
		78°-22'	93.0	X21	
		68°-00'	95.0	X22	
		67°-08'	106.0	X23	
		58°-46'	95.0	X24	

6-7-31

(11)

Near Prop Line

NE Cor Heating SE Cor Cottage Row.

NE Cor Heating Plant

18/7

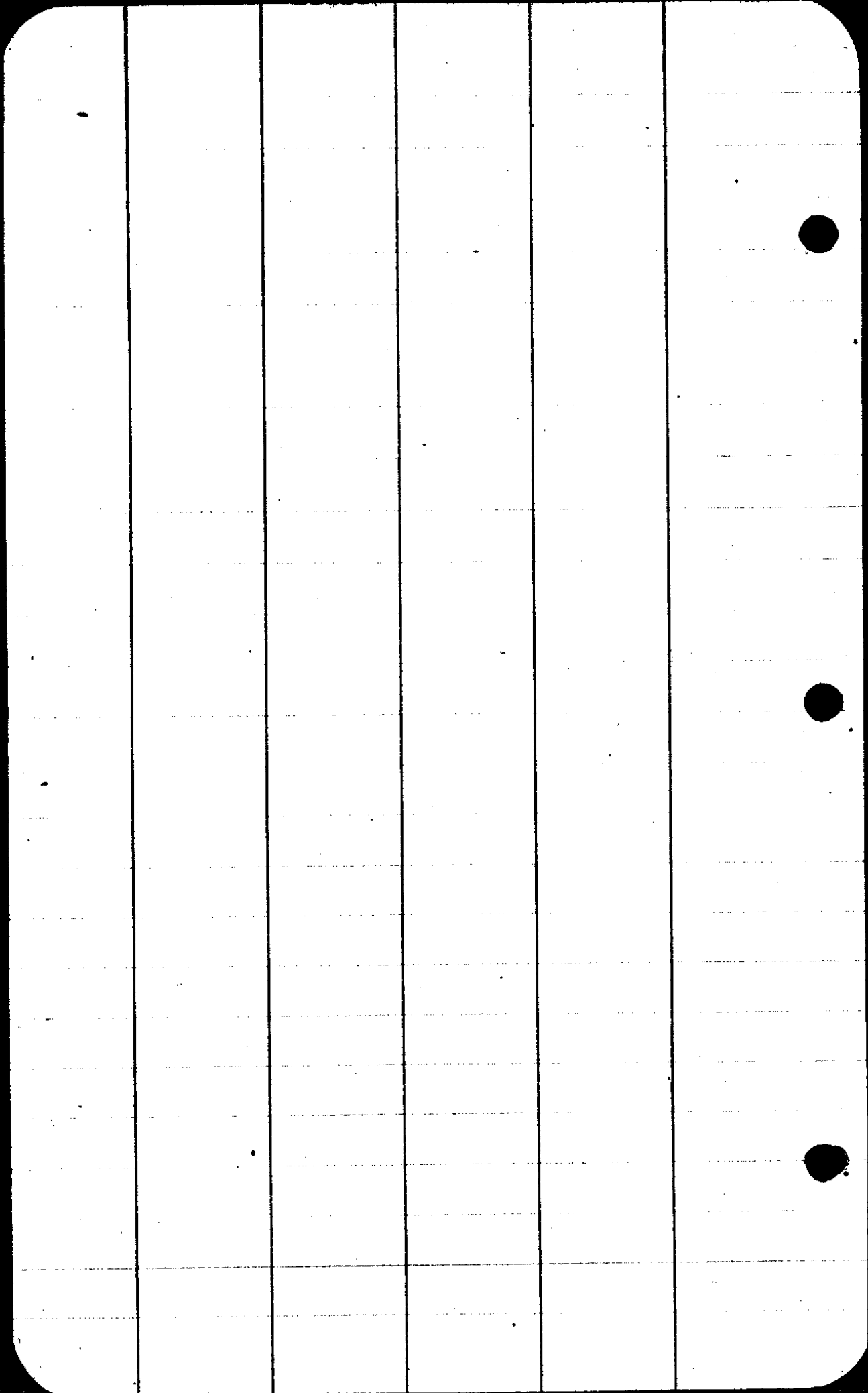

11

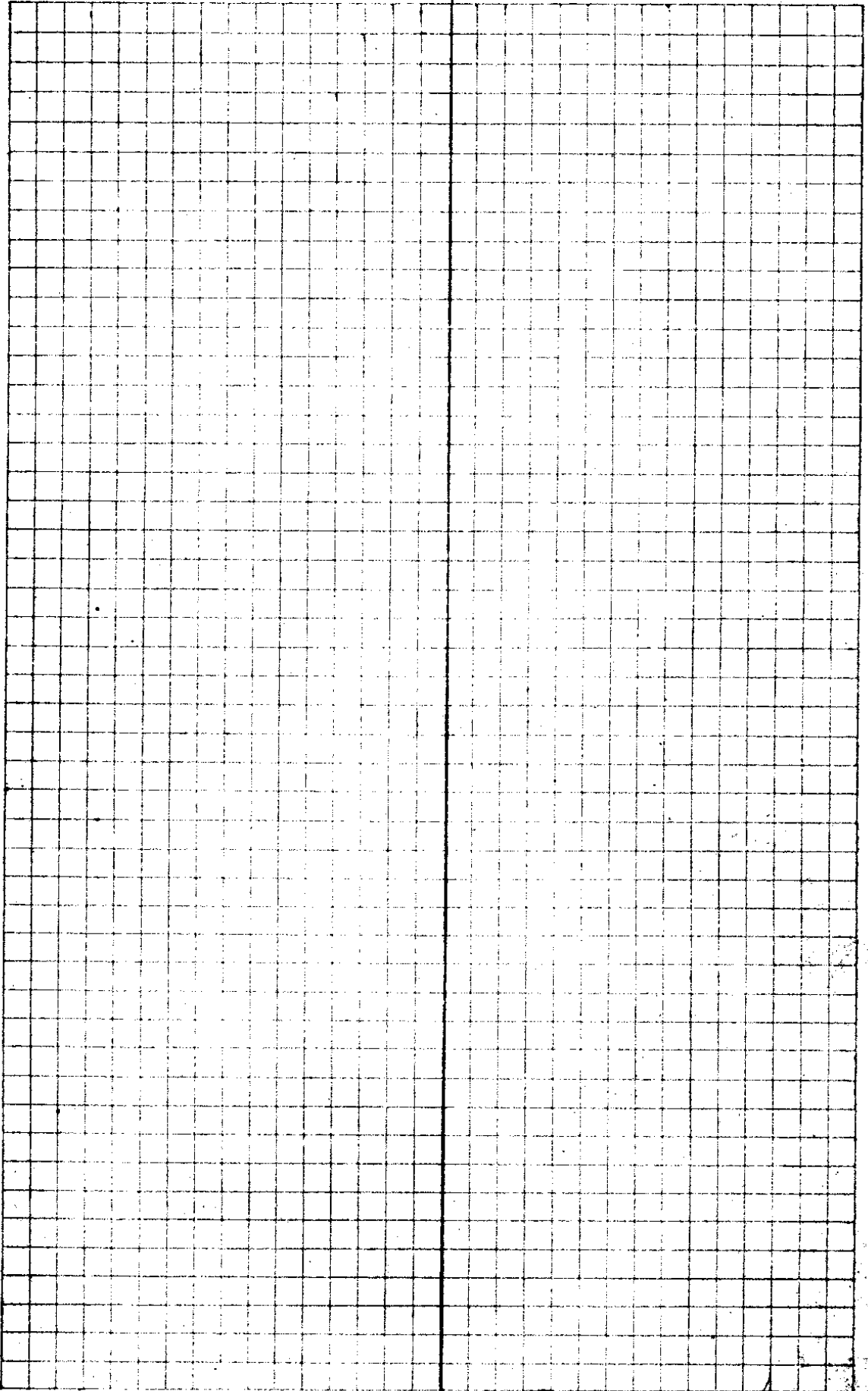

18/7

Gen Pet Corp

sta	t	A	-	R	Elev
	3.40	499.03			495.63
TP			3.59		495.44
	6.46	501.90			
TP			3.08		498.82
	4.48	503.30			
TP			9.81		493.49
	3.05	496.54			
1	3.51			3.51	493.03
2				4.61	491.93
A					
20'S. A on W. Side Stephens.			3. 4.7		492.84
" E St			3.9		492.64 E St.
40'S. W Side St			5.2		491.34
E St			4.3		492.24
60'S. W Side St			5.6		490.94
E St			4.8		491.74
80'S			5.59		490.95

6-8-1931

(12)

Center Pavement ups N E Corner
N E Cor.

SE St

SE. Cor Stone
Island GP
Station

18/7

Sta	TS	Gen	Pet	Corp	Elev
		H 1	-5		
		496.54			
80's	A. W Side		6.1		490.44
	St		5.3		491.54
A.P.	A+102.1 = B		6.7		489.84
Top Monument	-P.C. Curve		6.1		490.44
"Plug in"	" "		6.25		490.29
SE Cor	Property		7.5		489.04
opp P/C			6.7		489.84
			7.6		488.94
		*			
T.P.	4.32	494.84	6.02		490.52
B.1.	N 2. Cor Cravage		5.7		489.14
B.2	NW Cor Guy		8.4		486.44
B.3			6.7		488.14
B.5			5.7		489.14
B.6			6.1		488.84
B.8.			5.3		489.54
B.9			7.4		487.44
B.10	Flag Pole		3.3		491.54

6-8-31

13

Point B

Street

Point C

ST

BM Top Conl. Monu. for
Air Service

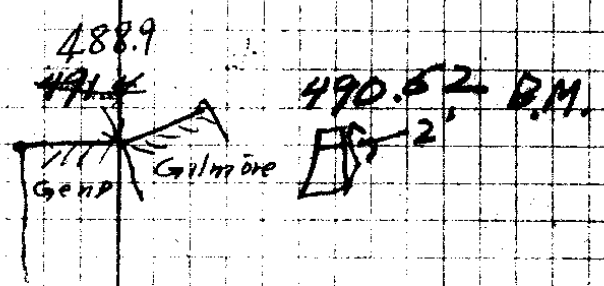

1/2

18/7

Gen Pt

Sta	#	T	-	R	Elev
B.11	NE COR	494.84	Lunch Room	3.3	491.54
B12	SE "	"	"	3.5	491.34
B13				4.2	490.64
TP	1.6	492.12			
D.1	NW shed		Back Garage	6.8	485.32
D.2	SW "	"	"	8.4	483.72
D3	Prop line			10.9	481.22
D4	"	"		12.9	479.22
D5	corse		Cottage	15.4	486.72
D6				14.7	477.42
D7				12.9	479.22
D.8				10.5	481.62
D.9	SE cor		of Cottage	12.7	479.42
D10				10.0	482.12
D11				11.5	481.02
D12				9.8	482.32
D13				8.4	483.72
D14				7.1	485.02
D15				6.7	485.42
D16	Flower Bed			5.6	486.52
D17	"	"		6.9	485.22
D18	"	"		7.0	485.12
D19	Center Drive			5.0	487.12

14

From B.M. on Air Block ^{BM} 490.52

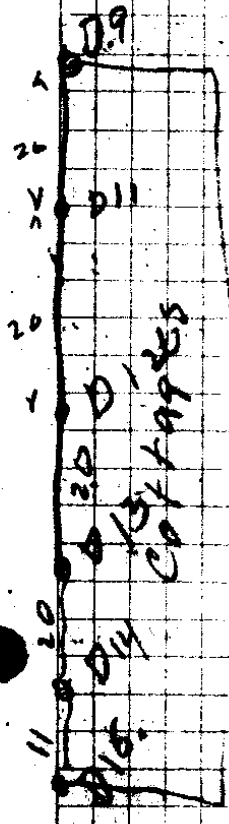
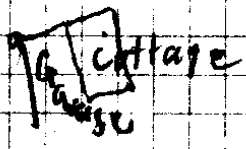

18/7

Sta	T	R	Elev
D23	SE Cor Toilet	2.2	489.92
D22		2.9	489.22
D24		3.9	488.22
D25	North Prop Line	2.9	489.22
D26		3.5	484.62
D27	I.P. Prop Line	3.0	489.12
D28		4.2	487.92
D29		4.6	484.62?
D30		5.5	486.62
D31		5.0	487.12
T.P.	Hub "L"	6.26	485.86
		→ 10.03	482.09
T.P.	0.41	482.50	
E 1	Jogin Building	0.8	481.70
E 2		3.0	479.50
E 3		4.7	477.80
E 4	SE Cor Cabins	5.2	477.30
E 5	NW Cor Cabins	10.2	472.30
E 6		8.1	474.40
E 7		8.4	474.10
E 8		6.5	476.00
E 9	Water Hydrant	6.7	475.80
E 10		9.2	473.30

137

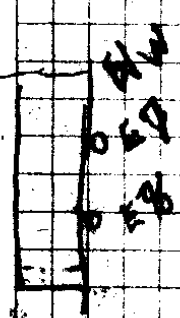
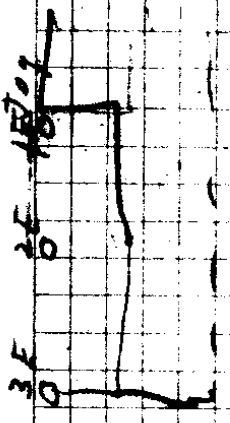

18/7

Sta	t	π	-	R	Elev
T.P. ^{E23}			13.57		468.93
	5.85	474.78			
E24				6.2	468.58
HobE				4.0	470.78
E25	sewer fork.			7.1	467.68
E26				3.7	471.08
E27	SW cor Heater House.			0.4	474.38
E28	Prop Line			8.9	466.38
E29				7.8	466.98
E30				6.6	468.18
E31				5.2	469.58
E32				3.4	471.38
E33				3.3	471.48
E34				3.9	470.88
E35				5.5	469.28
E36				7.2	467.58
E37				8.4	466.38
E38				9.2	465.58
E39	Prop Line			9.4	465.38
E40	" "			12.5	462.28
E41				11.1	463.68
E42				10.6	464.18
Hub = E43				10.24	464.50
E44	sewer			9.9	464.88

5 Prop Line

16

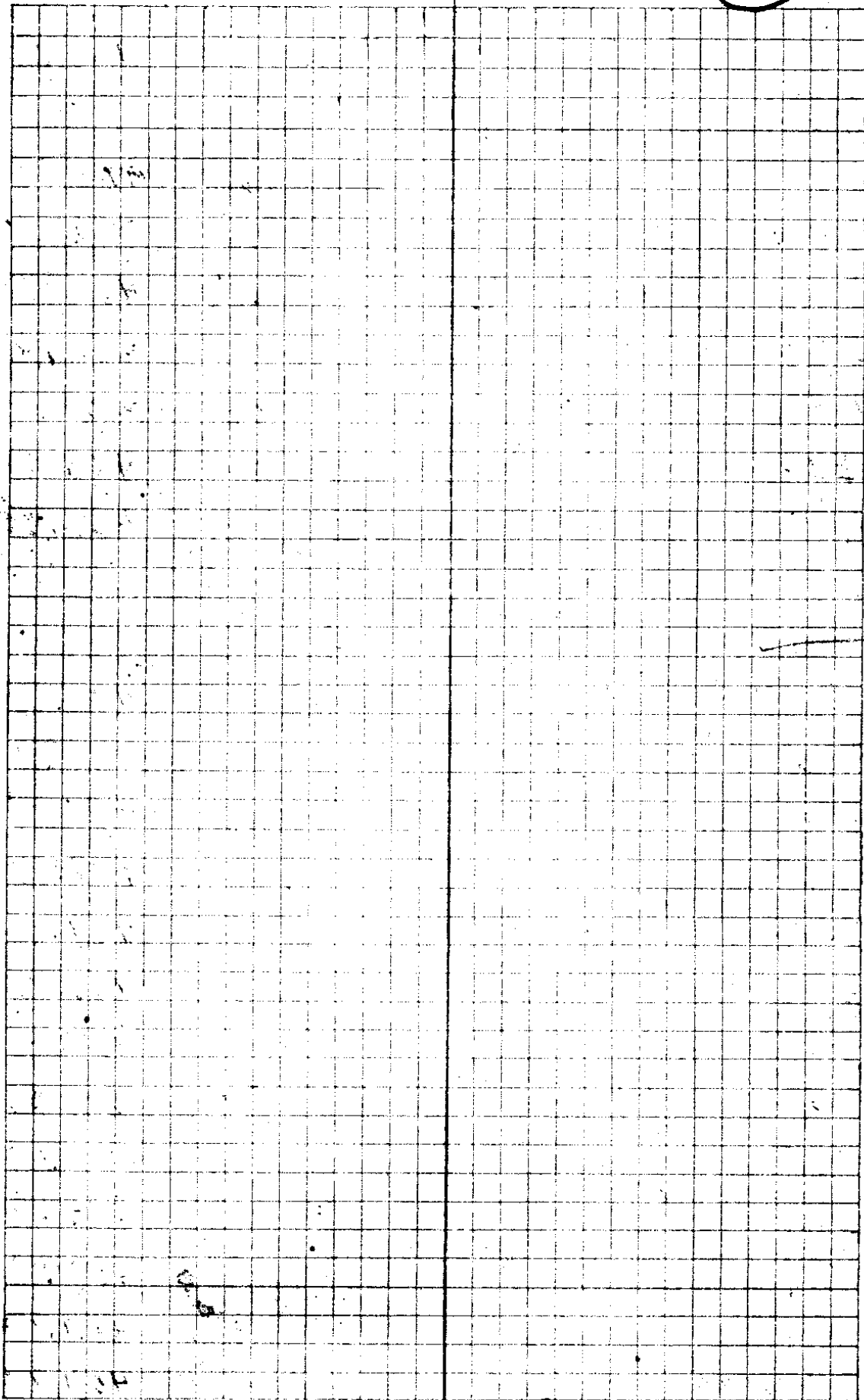

18/7

Sta	T	A	-	R	
E45	Prop Line	474.78		8.8	465.98
E46	"			7.6	467.18
E47	" " West			11.8	462.98
E48	ONSEWER			12.2	462.58
E49				12.7	462.03
E50				12.6	462.18
E51				14.5	460.28
E52				14.8	459.98
T.P.			16.12		458.66
	2.67	461.33			
G 1	Prop Line			3.2	458.13
2	" " } North			5.1	456.23
3	" " }			6.8	454.53
G 4 =	Hob H.			8.4	452.93
5				5.0	456.33
6	Sewer Pipe			5.1	456.23
7				4.5	456.83
8				4.1	457.23
Hub G - G 9				5.0	456.33
G 10				6.7	454.63
G 11				7.1	454.23
G 12				8.9	452.42
G 13	Q St Mill			4.3	457.03
G 14				4.3	457.03
B.M. 1	Rail road spire in tree		3.82		457.51

12

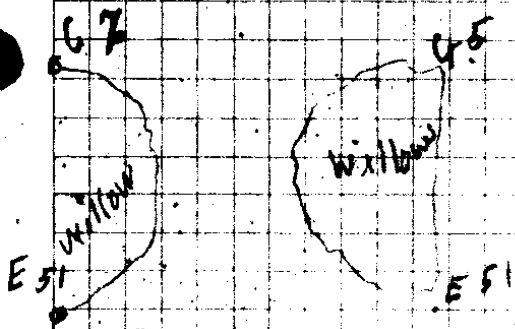

Scout
 170
 Lind
 05/13

B.M.
 SE of H.

18/7

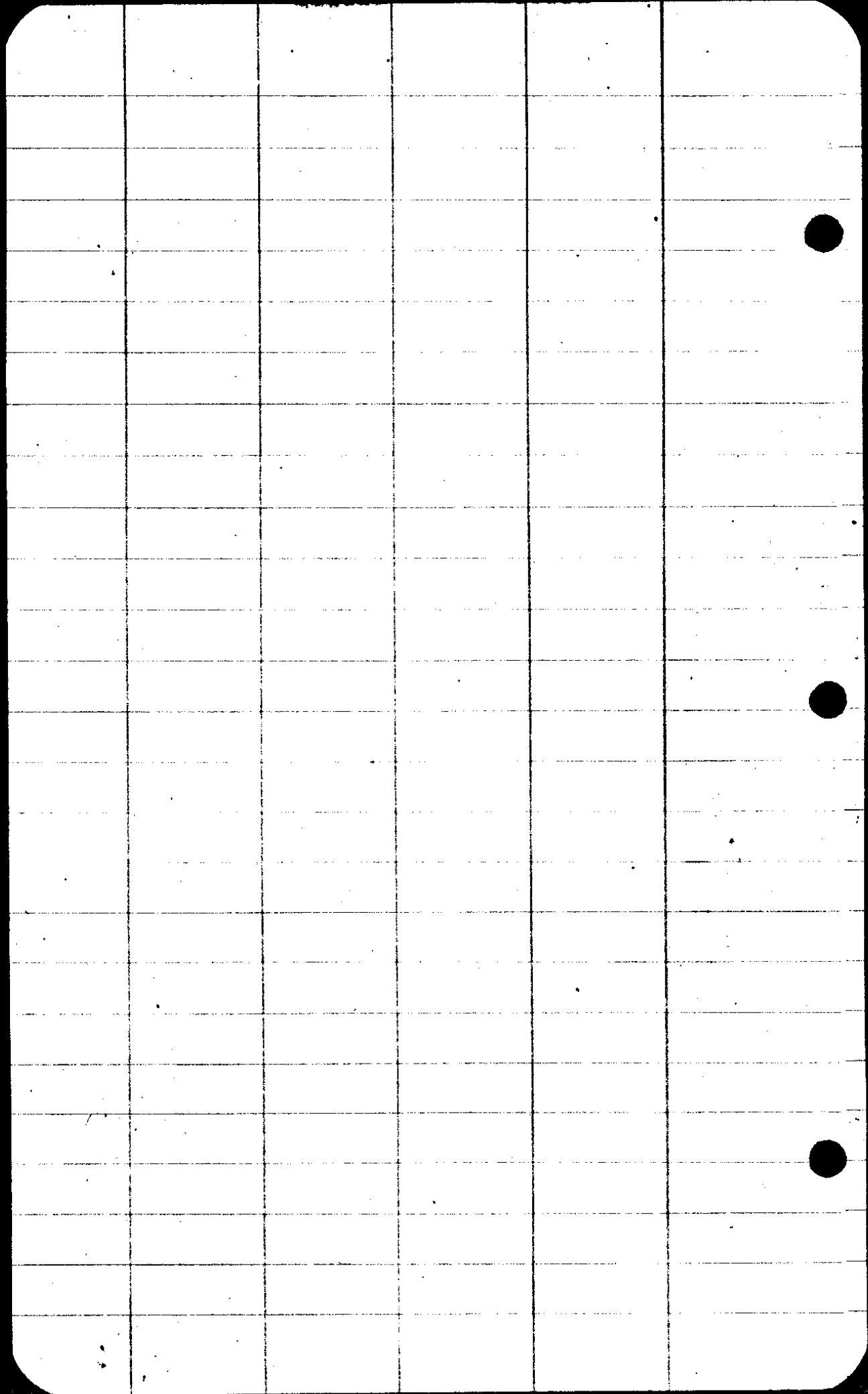

18

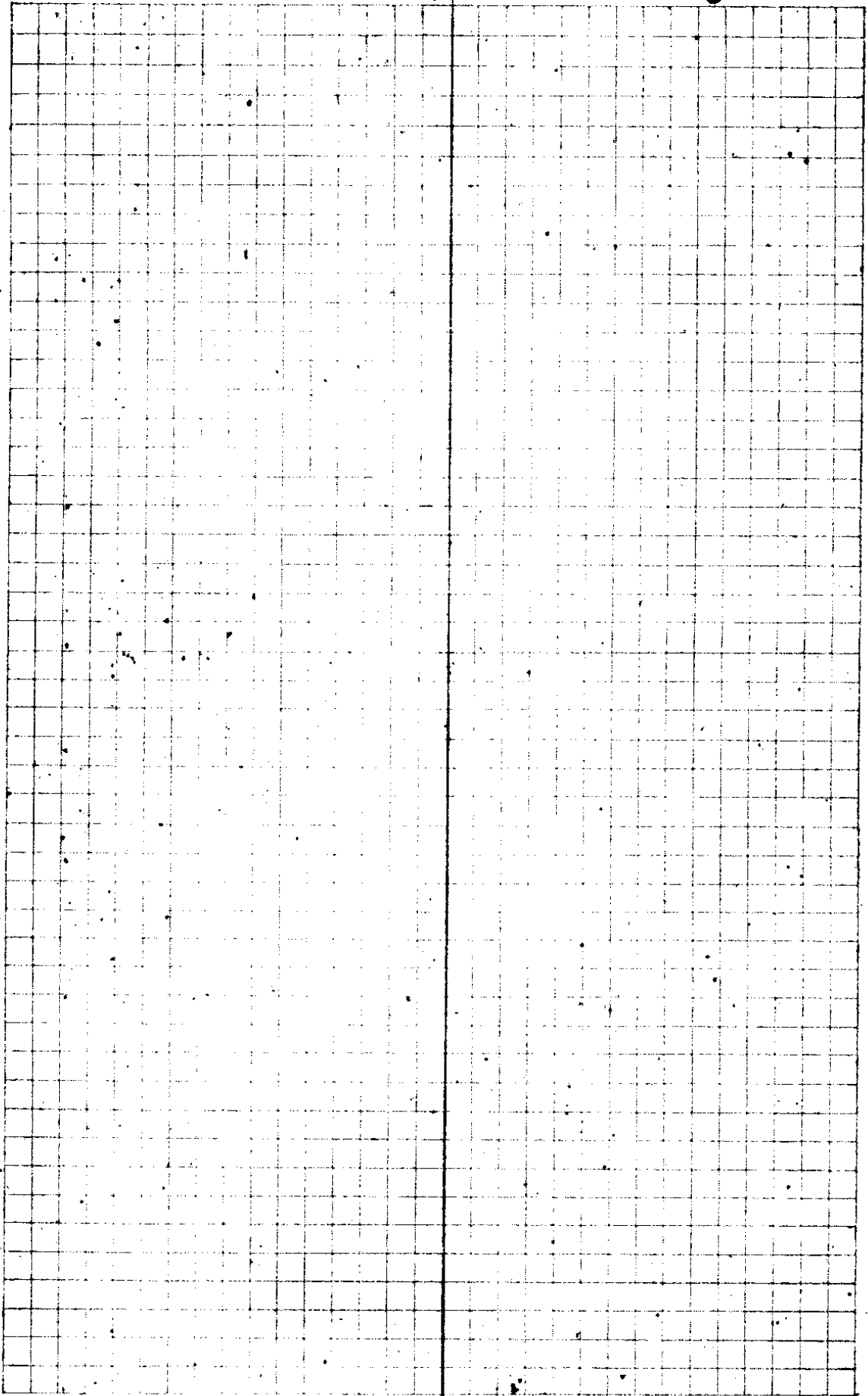

18/7

Sta	+	π	-	R	Elev
	1.9	487.76			485.86
K1				5.5	482.26
K2				4.6	483.16
K3				6.4	481.36
K4				7.1	480.66
K5				8.2	479.56
K6				10.7	477.06
K7	116 ft			9.7	477.86
K8	on Fill Dirt			10.3	477.46
K9				9.2 ?	488.56
K10				7.9	479.86
K11				7.0	480.76
K12				6.6	481.16
K13				5.9	481.86
K14	Prop Line Orig Ground			6.2	481.56
K15	Fill			6.7	481.06
Hub J = K16				8.7	479.06
Iron Pipe K17				10.08	477.68
K18				6.2	481.56
K19				11.4	476.36
K20				6.8	480.96
K21				11.6	476.16
K22				8.0	479.76
K23				13.2	474.56

See station L for E1cy

Cabin
 K1
 K2
 M3
 S4
 W5
 1/6

Sta	T	Δ	-	R	Elev.
K24		487.76		9.6	474.16
K25	TREE.				
K26	PROP LINE			16.8	470.96
K27	END FILL			10.1	477.66
K28				18.0	469.76
TP	2.74	488.60			485.86
X1				2.65	485.95
X2				3.3	485.30
X3				3.8	484.80
X4				3.0	485.60
X5				2.3	486.30
X6				4.8	483.80
X7				3.8	484.80
X8				5.3	483.30
X9				6.6	482.00
X10				5.3	483.30
X11				4.9	483.70
X12				5.6	483.00
X13				6.4	482.20
X14				7.6	481.00
X15				8.8	479.80
X16				8.0	480.60
X17				7.1	481.50
X18				9.0	479.60

Sighted on "L" For Elev

Prop. Line

Prop. L.

Sta	+	\bar{A} 488 $\frac{1}{2}$	-	R	Elev
X 19				9.5	479.10
X 20				10.4	478.20
X 21				10.4	478.20
X 22				10.8	477.80
X 23				11.6	477.00
X 24				9.7	478.90

20

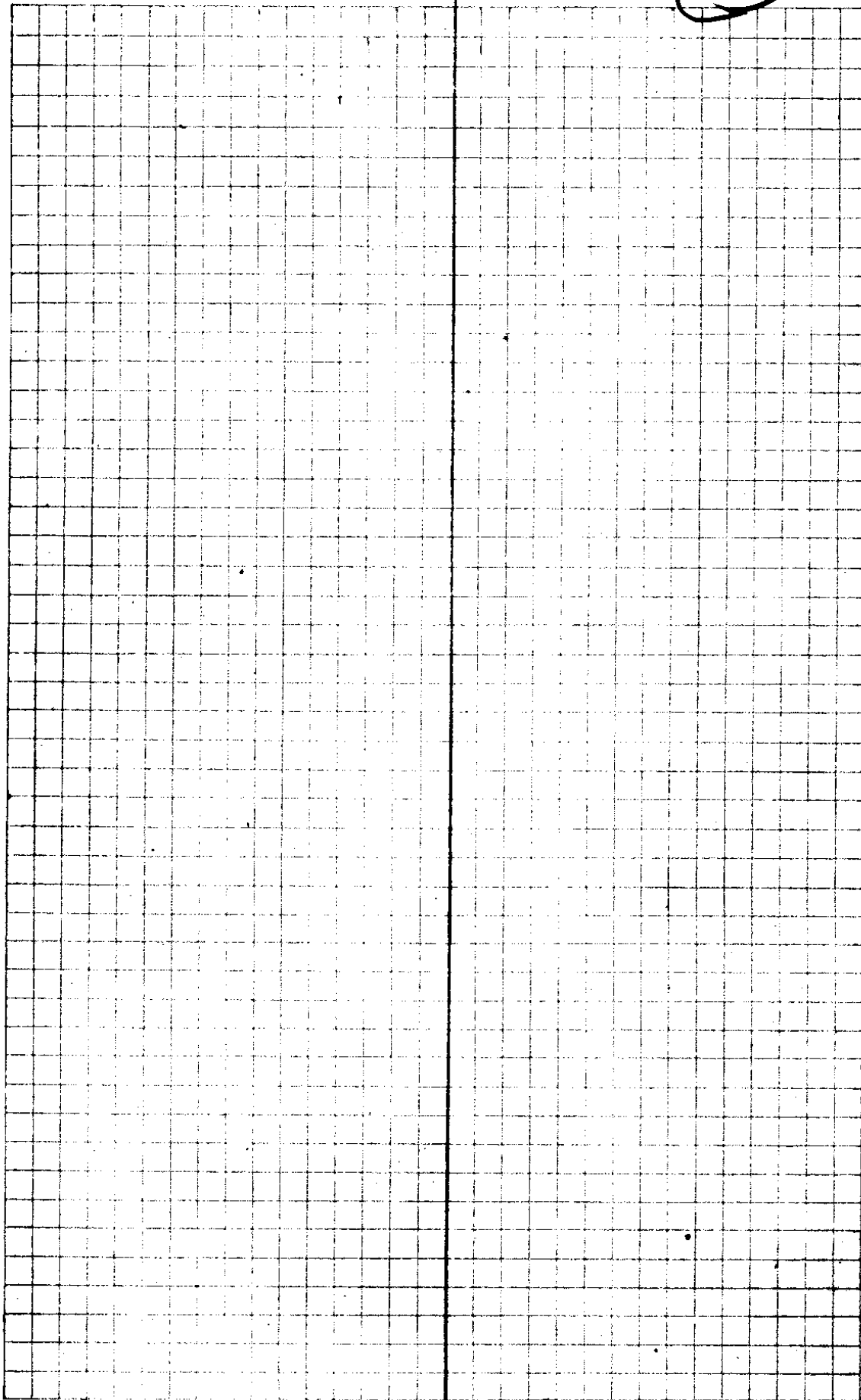

18/7

169
Flowers

Flowers

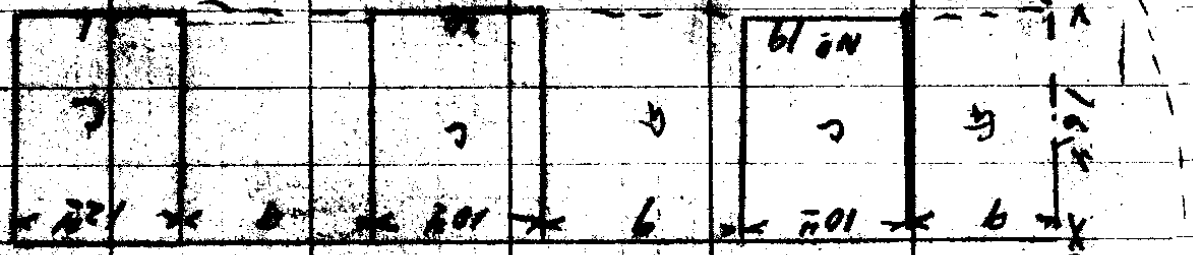
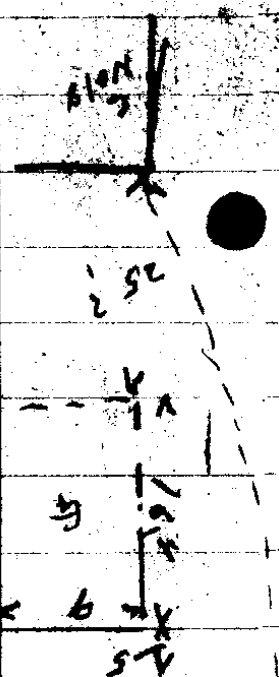

SOUTH PROPERTY LINE

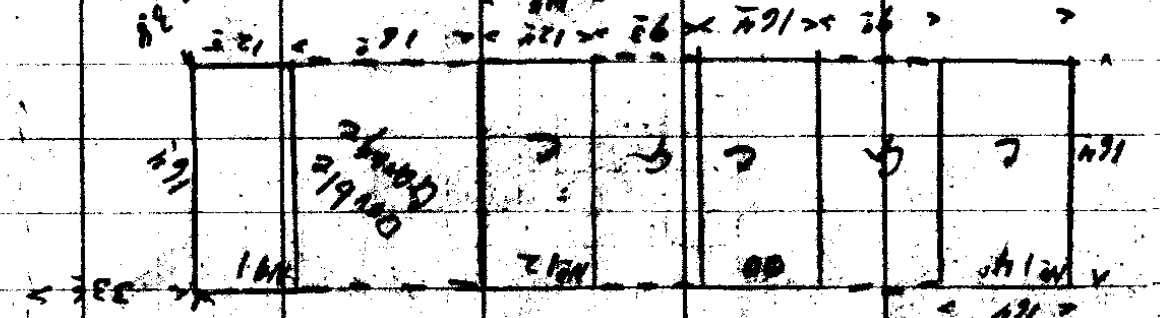
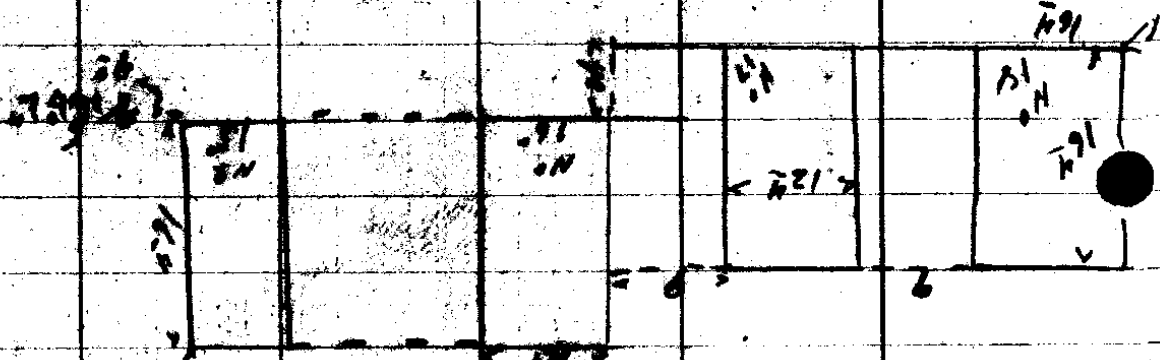

DOUBLE GANGE

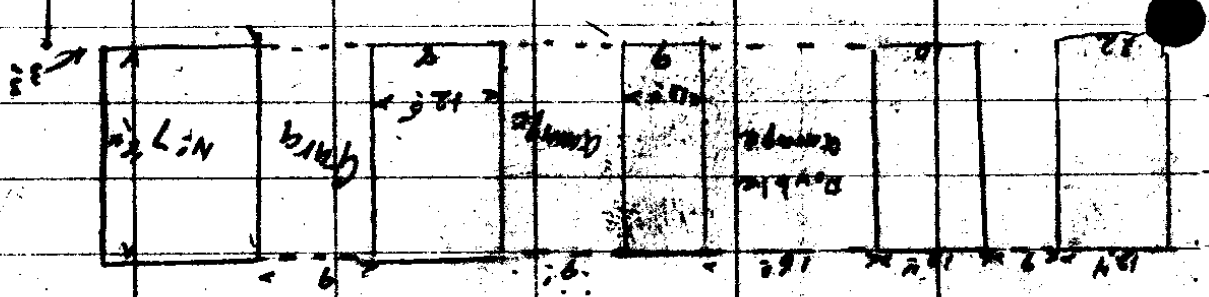
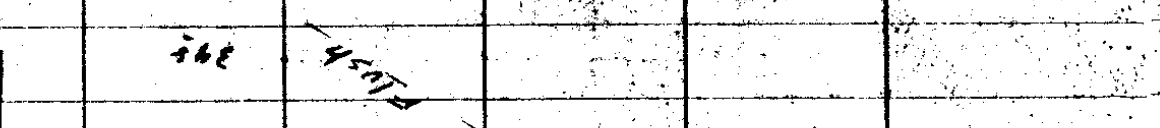

DOUBLE GANGE

DOUBLE GANGE

DOUBLE GANGE

21

NECOY H.P.

18/7

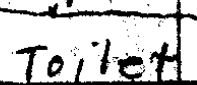
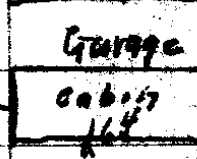
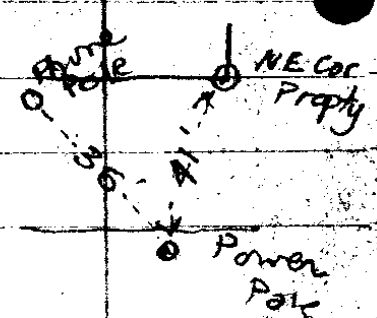
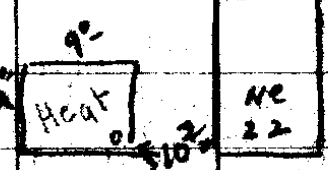
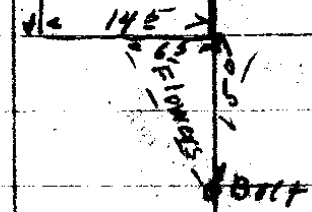
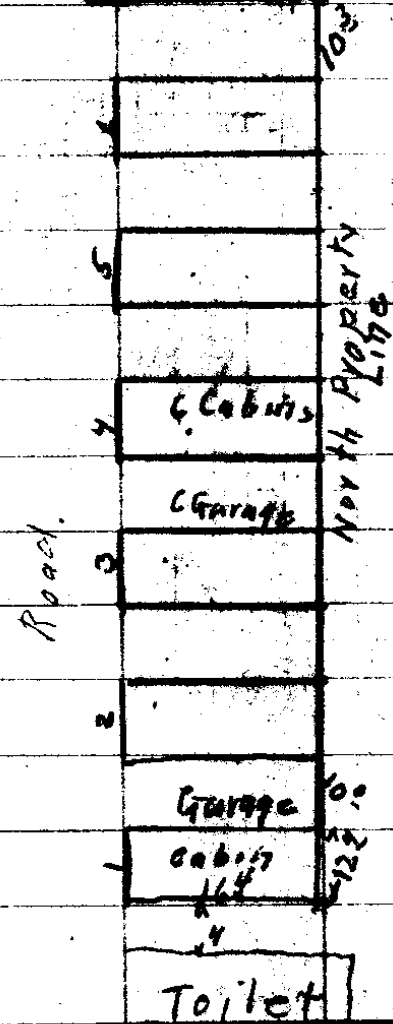
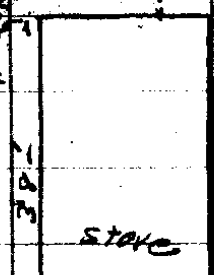
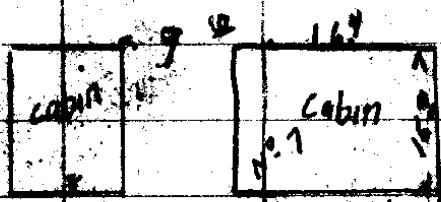
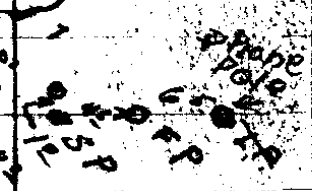
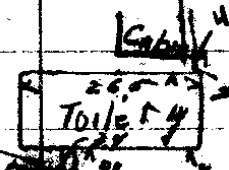
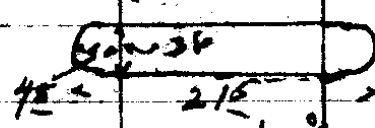
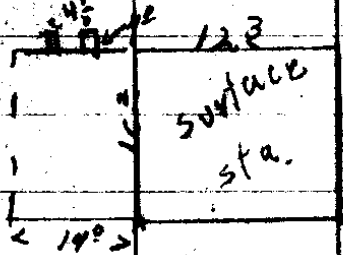
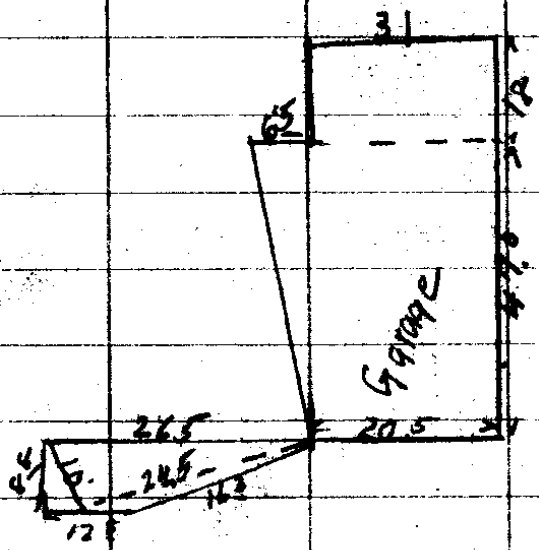

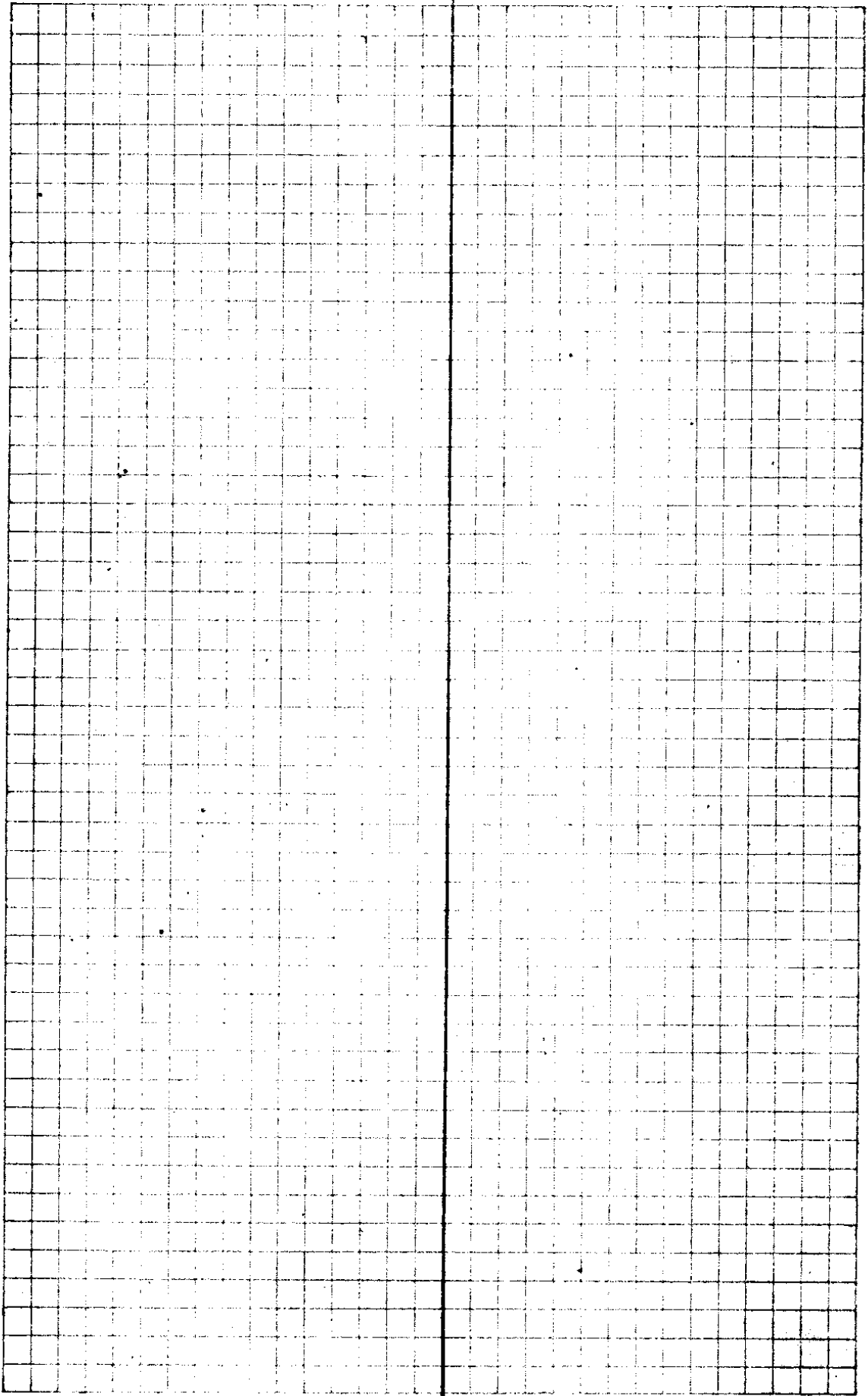

18/7

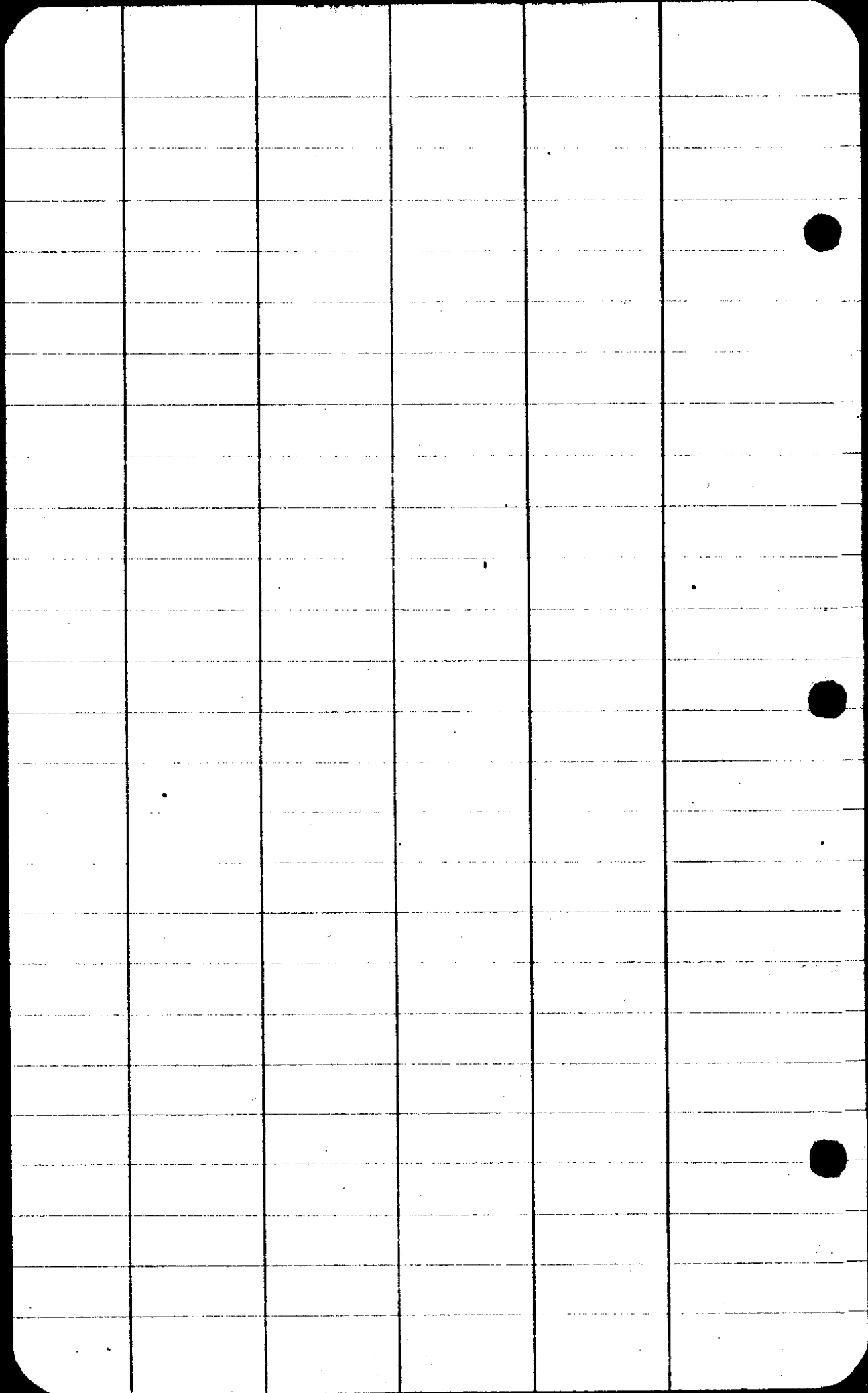

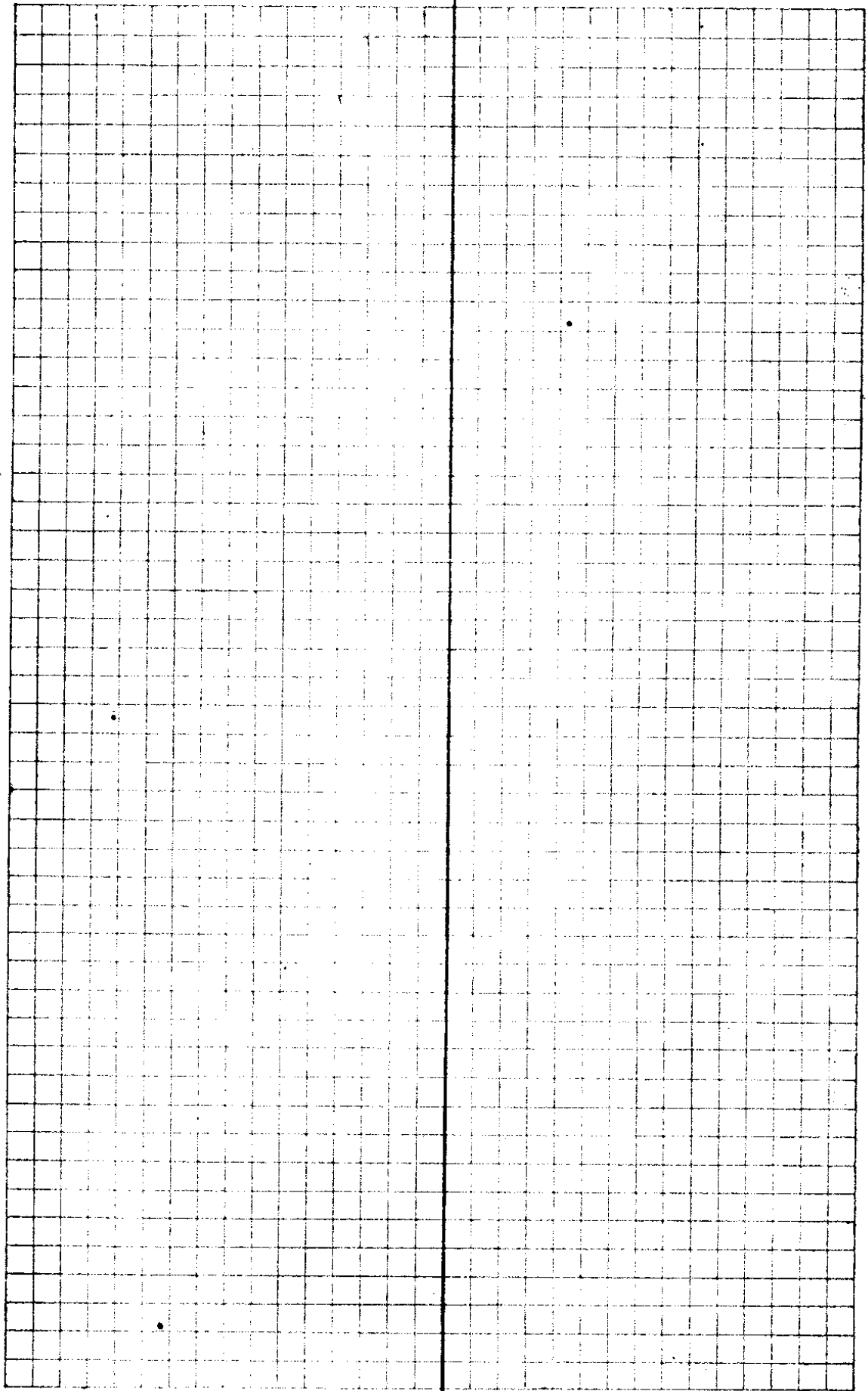

18/7

June-13, 1931
Boyer
Lane

Top copper pin Pt A (in conc)
" " " B. (" ")
" " " C (" ")

Top copper pin Pt J.

Top copper pin Pt I

Top copper pin Pt. H

Silver Property.

Gen. Ret. Corp. - Johnson Camp Gdsite

Sta TS H-1 -S Elev 490.52
B.M. top Conc Form for Air

3.79 3.79 491.86 489.60
6.05 6.72 488.83 485.88
9.78 9.78 485.88 1 on hub Pt L

1.38 487.2* 5
T.P. 0.61 472.16 7
8.58 8.58 478.68 7 where Chard Hub was
15.69 471.54 7

8.06 464.18 1
1.20 465.38 7
T.P. 2.73 462.08 7
5.97 459.88 4

4.62 457.74 Spike Tree
5 Check on
8.67 457.51
8.67 453.38 40 Pt H
5.76 452.38 1 Pt G

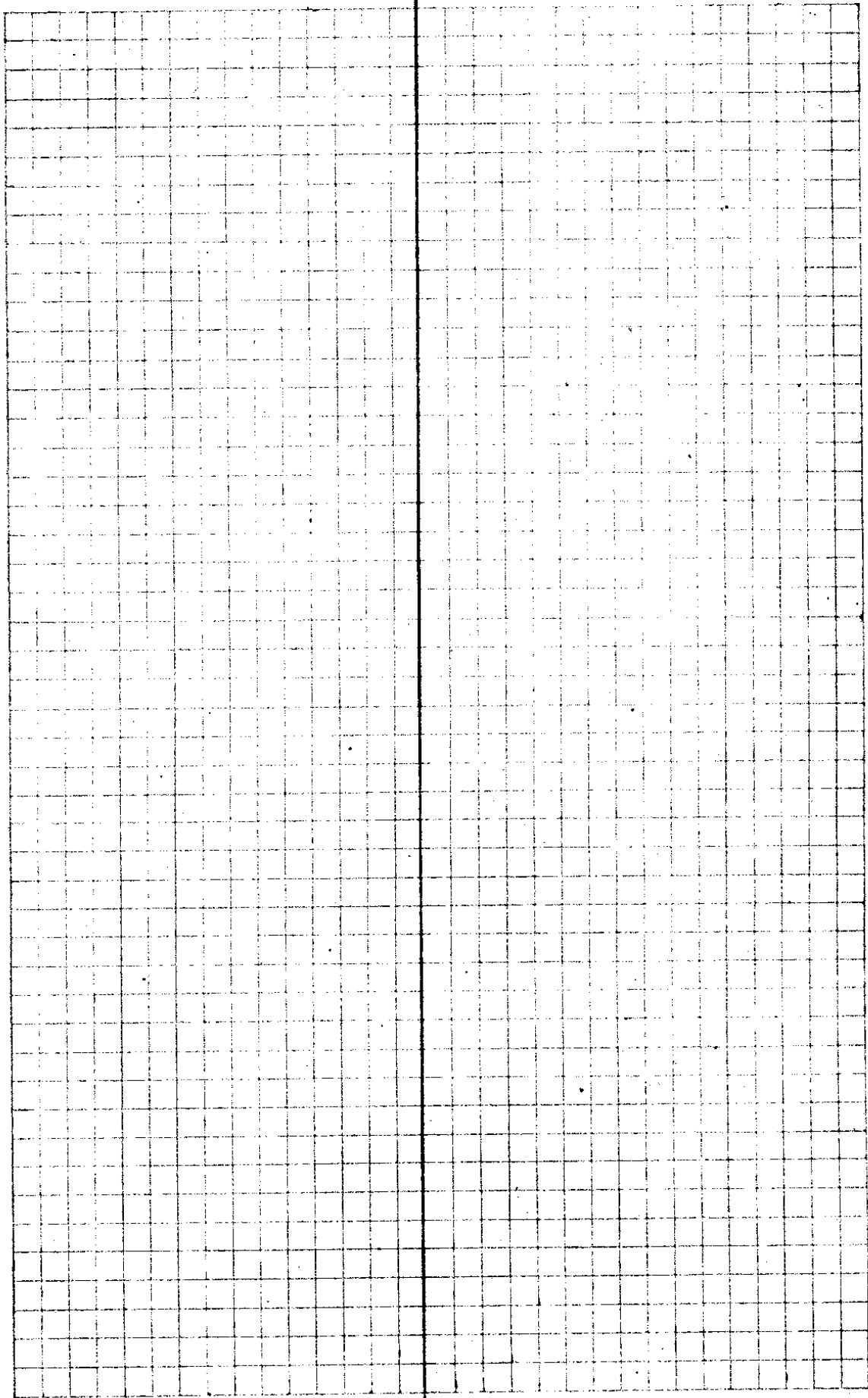

Gen Pet Corp

Johnson Prop.

Pipe Lines

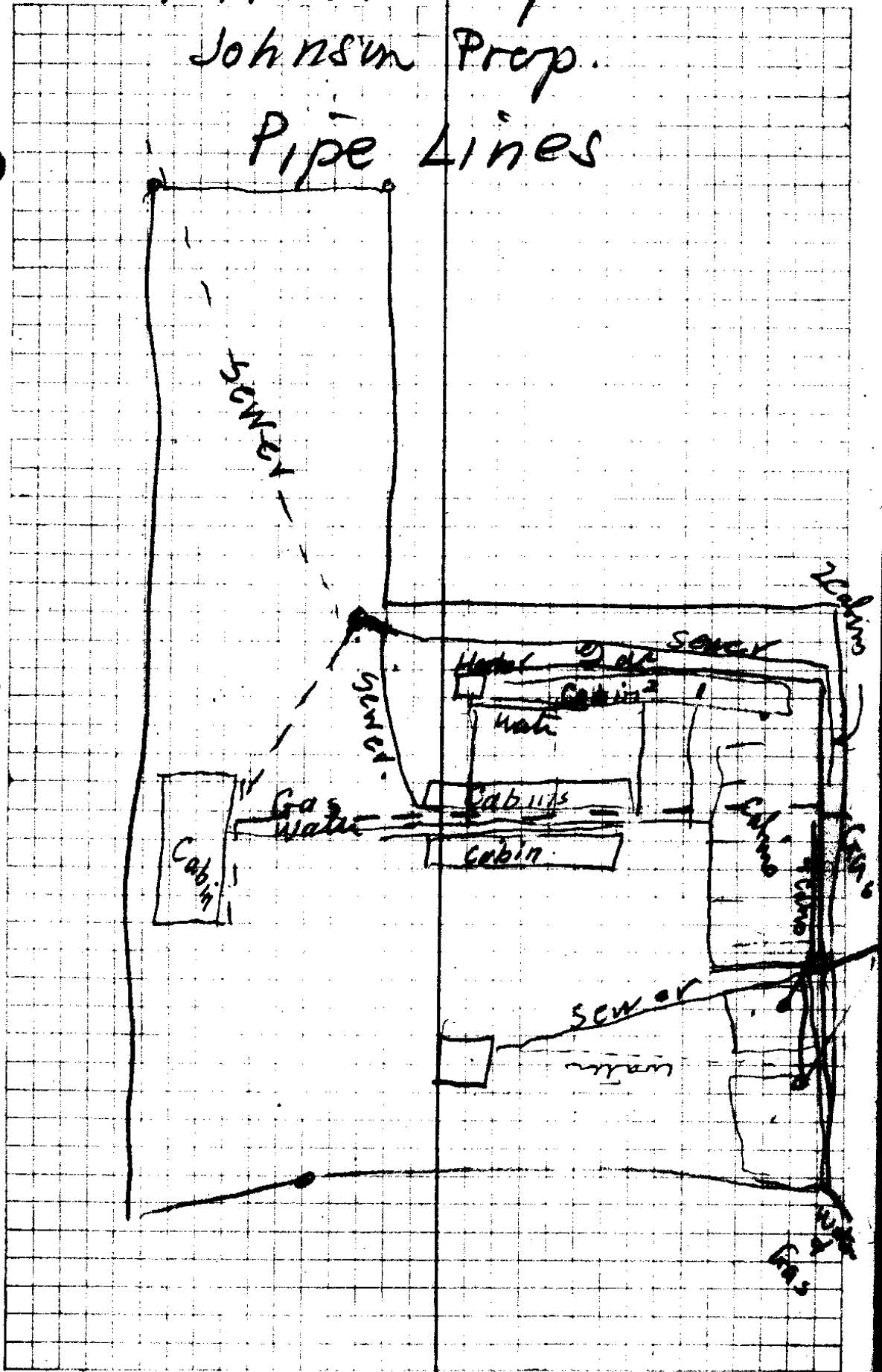

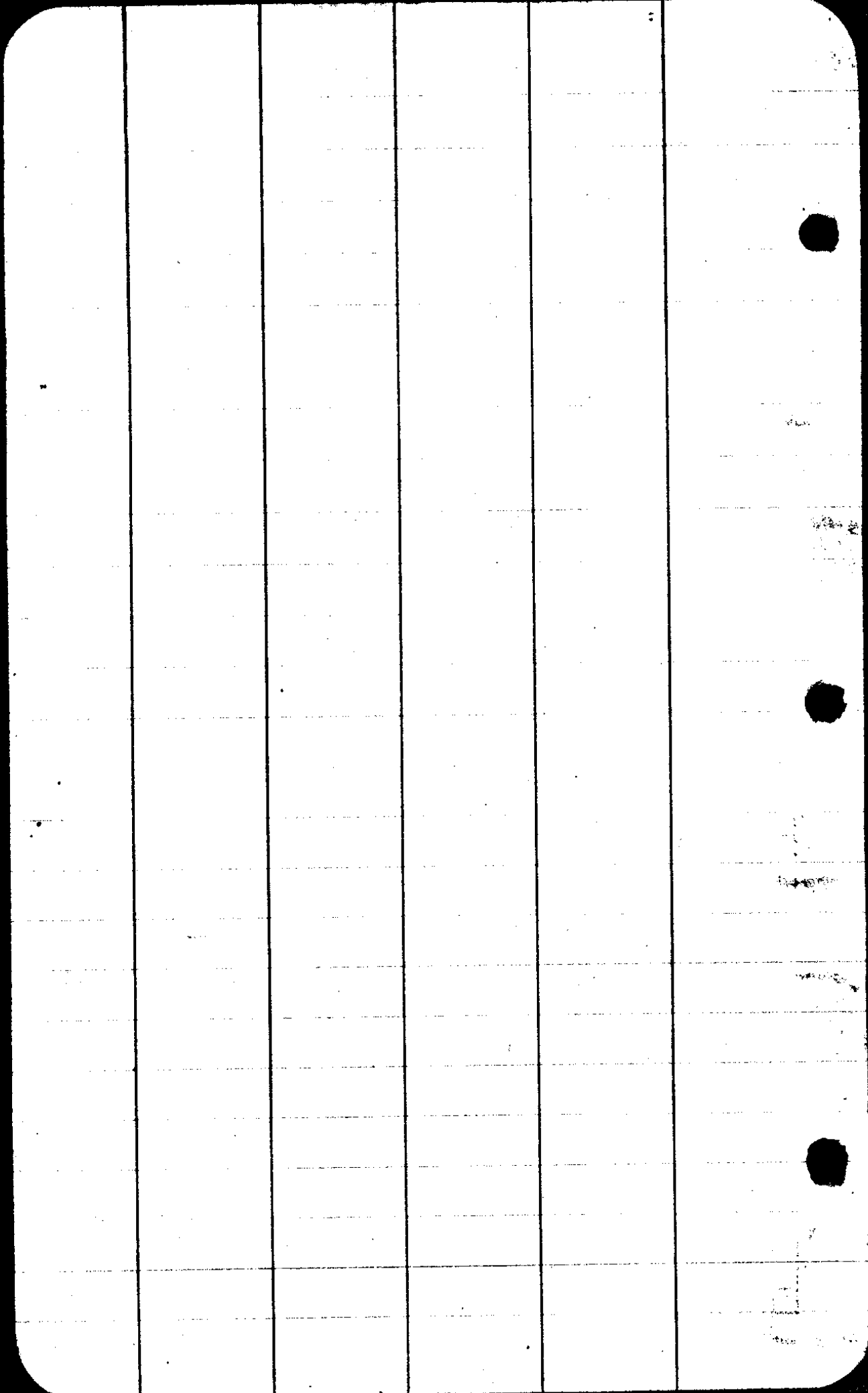

CS FILE FOLDER

CONTAINS

MORE

INFORMATION