

The image shows a two-page spread of a notebook. Both pages are covered in a grid pattern. The pages are mostly blank, with some faint markings and a small tear at the bottom left. The notebook has three binder holes on the left edge.

17/51

Rice & Rice

1				
Δ13				
11	252 ²	247 ⁶	3-26	6-53 L S88-17W
Δ12				
x8-15	218 ^L	215 ⁸	11-28 ¹	22-57 R N88-17W N83-32W
Δ11				
18 ⁰	181 ⁰	172 ^L	20-25 ^L	4-51 L S80-15W S84W
Δ10				
12-15	322 ^E	322 ^E	12-16 ^L	24-32 S82-40W S84-32W
33 ⁰	171 ³			
17 ⁰				
17 ⁰				
Δ9				
		85 ⁵	60-05 ¹	12-11 ¹ R N85-04W N82 ⁰ W
Δ8				
x19-30	65 ⁶	61 ⁸	0-42 ^L	1-24 L S88-51W S88-30W
Δ7				
		363 ³	50-34 ^R	101-08 R S89-33W N88-30W
Δ6				
		378 ⁹	10-06 ^R	20-16 S38-57W S41W
Δ5				
		488 ⁰	90-04 ¹	18-68 ¹ L S28-51W S31-30W
Δ4				
		240 ⁴	12-26 ^R	12-39 ¹ S37-55W S40-30W
Δ3				
		685 ⁸	65-04 ^R	130-04 S25-35W S29W
2Δ				
		148 ²	38-47 ^R	77-32 R S39-29E S36E
1Δ				
				S75E S78-16E

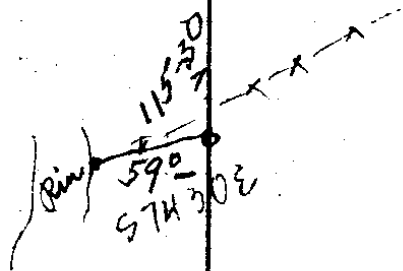

- At on NE corner of road
 Back sight on nail in Road

17/51

3

Rice & Rice

~~108-40~~

Δ 1

6467

1-23 R
2-46 R

S77-51E S75-30E

Δ 23

NE school

304

tan

Δ 22

Rice wine north ME cor.

1249

tan

2.1 Δ NW school

6108

0-13' R

S79-14E

20 Δ

<1500

S79-2E

Δ 19 NW cor

12225

6-20 L
12-40

N 2°-30 W N 13 W

Δ 18

76-40
330
11-30
12-30

928
6324

52-32 R

105-04 N 3-50 E N 1°-E

Δ 17

7-15
1494

1479

23-49 L

47 39 L N 48-42 W N 47-30 W

Δ 16 Tophill

12-30
1049

1048

2-28

4-56 R N 24-53 W N 23 W

Δ 15

11-25
1899

1861

70-06

140-12 R N 27-21 W

Δ 14

11-30
1565

1560

5-44

11-28 L S 82-33 W S 86 W

Δ 13

44-13
76-59
58-50
77-12
46

4

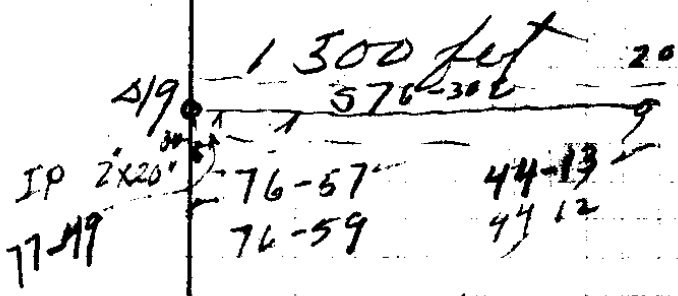
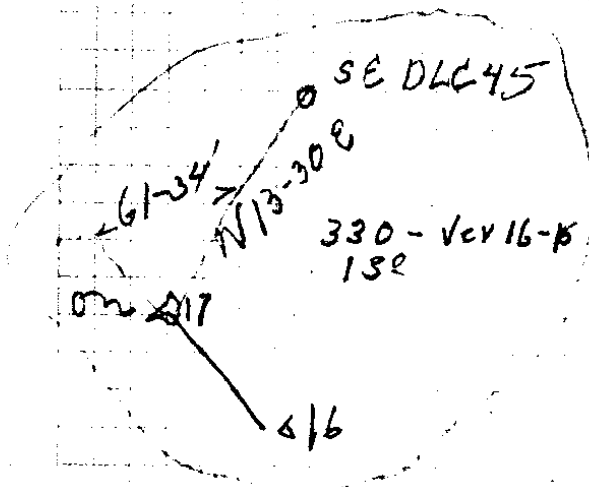

1222

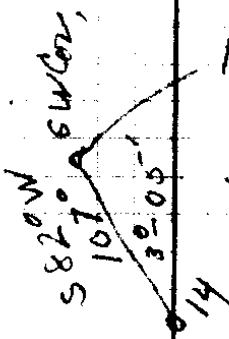
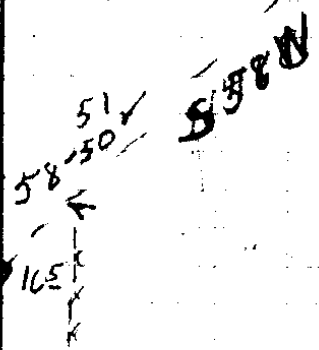

Part 2" X 20" I Pipe
Found O.B.T
30" W.O. N 44° 30' E
150 lb.

17/51

5

Rice & Rice

NW Cor

89-16R

N 2nd Cor

313⁸

179-54
89-57R

N 13 E

SE Cor

165⁵

183-38
91-49L

578 E

SW Cor

316⁰

91-08 R

512 W

21
NW Cor - chaf

H

Δ 23⁵ chaf

162-31

N 75-30W / N 78-16W

Δ 1 Field

85H

193-38

N 63-30W / N 60-47W

Δ 5

371³

162-34R

N 70-30W / N 74-25W

Δ 4

229H

121-58R

N 58-30W / N 56-59W

Δ 3

1350⁰

N 2 E / N 1⁰-03 E

Δ 2 Road

301^L

N 85 W / N 85-13 W

Δ 1

149⁰

S 81 W / S 81-37 W

SE Cor
Dunnham

6
Aug. 7. 1929

⊙ Hor 13° 04'
Ver 39° 40'
Time 9.00 AM.

⊙ Hor 13° 46'
Ver 40.23'
Time 9.01 AM.

M.C. S 60° E
Lat = 44°
Long = 123°

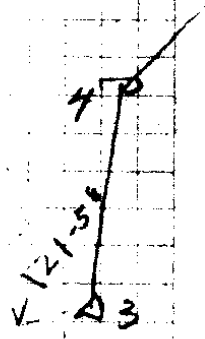
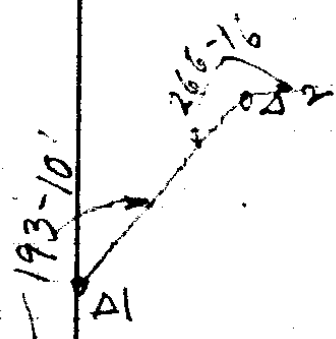
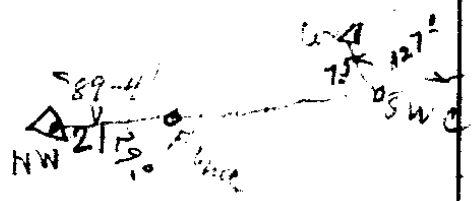
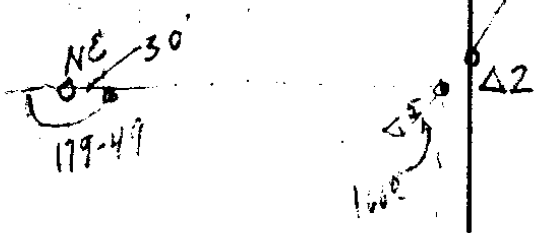

True bearing

17/51

70

Rice Run

Δ 11

154° 66-36

S4-30E S4-11E

Δ 10 within 39 ft back

274° 191-38

N71W N70-47W

Δ 9

1082° 186-59

N83W N82-25W

Int L
WOC 1-55

107° 163-03

West N89-24W

8

1188° 108-40

N73W N72-27W

Δ 7

1414° 183-49

N2W N1-07W

372°

Δ 6

270° 174-58

N54W N4-54W

Δ 5

536° 183-02

N1E N0-08E

Δ 4

351° 177-43

N3W N2°-54W

Δ 3

597° 87-41

N0-30W N0-37W

Δ 2

179° 250-12

S1E S89-18E

Δ 1

553° 98-11R

N19E N21-30E

Wail
SW Cape 22Δ

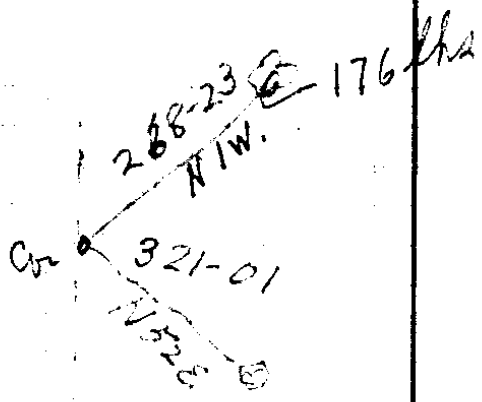

centerline

200

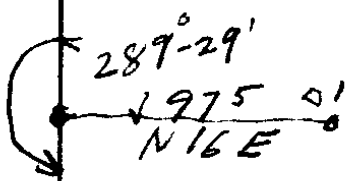

North

Δ4	1289	194-38	N13E
Δ3	947	175-51'	N2W
Δ2	746	166-47	N3E
Δ1	975 -	289-29 -	N16E
CON			

81231
 1122
 1730
 1730

35-55
 390
 222

9

Rice & Rice

Nail

576-20 E

Δ20

116-18

576 E 576-33 E

Δ19 old tri

43⁶

167-44

513 E 512-51 E

Δ16

1942⁷

193-57

50-45 E 50-35 E

Δ15

122³

161-39

514-30 E 514-32 E

Δ14

152⁸

182-11

54 W 53-49 W

Δ13

409²

182-43

5-2 W 51°-38 W

Δ12

929⁶

183-06

51 E 51°-05 E

Δ11

Harry Jacoby

10

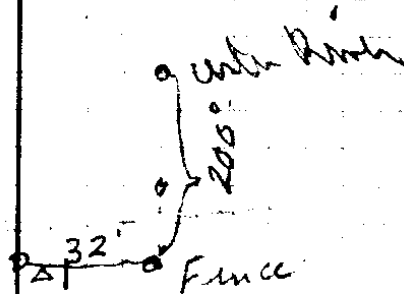

251-12

Δ 1

9664

251-12-N

10Δ

17/51

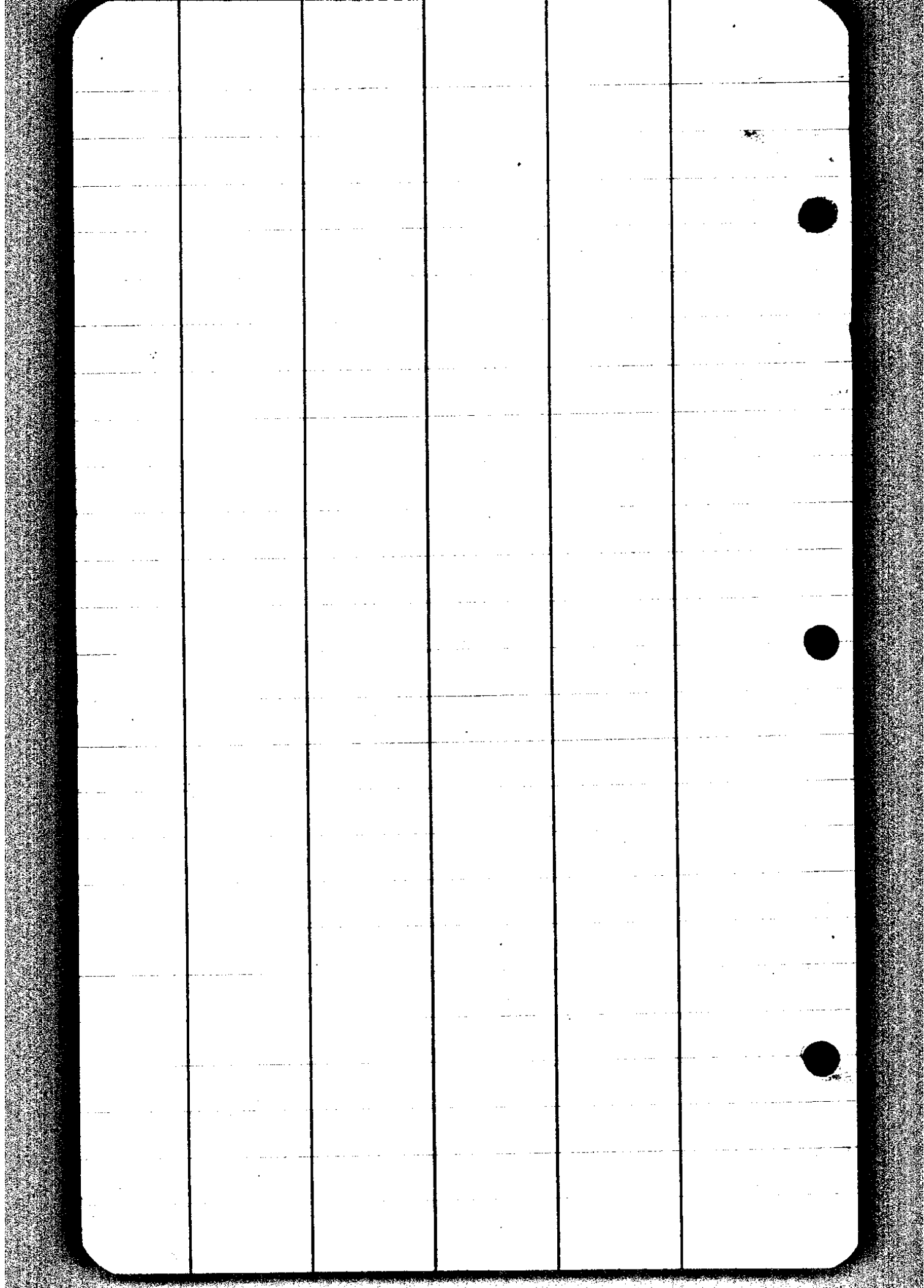

CS FILE FOLDER

CONTAINS

MORE

INFORMATION