

Pearson

I Began at 2" I.P. at SW cor
 lot 20, BLK. 14 of the now vacated
 Townsite of Winchester, Douglas Co Ore
 as recorded in Clerk's office, Ks by
 on 15th day May 1890; th
 S 35° 45' W 187²/₂ ft to a stake
 th. N 30° 20' W 121²/₂ ft. To I.P.
 th N 15° W 116²/₂ ft To I.P.
 The next cor. being inaccessible I
 run a Traverse To Point P.

	Traverse From "A" To P		N 30° 20' W
A			
	12° 05' R	$\frac{99.9}{65.2}$ 165.3	N 18° 15' W
	85° 43' R	41°	N 67° 32' E ✓ N 67° 28' E
P			
P	102° R No tree	30" B.D. tree 51° center	19° E S 10° 32' E
P.	To I.P. in		
	24° 47' R	12°	S 22° E S 87° 45' E
M			17-15

N 67° 28' E "P"

1651
228
512/879

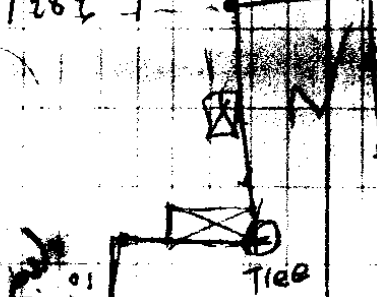

1422
3
1459

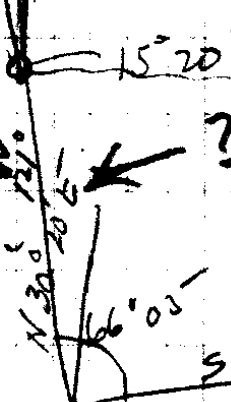

S 35° 45' W
1879

SW cor Lot 20
BIR 14

N 30° 20' W
1203
1815
8543
1815
6728
102
1629
S 10° 22' E
1403

N 67° 28' E
2139
179
9205
8755

M	59°36' R	N 52°	S 28° E	S 87° 46' E	S 28° 10' E
C	109° 55' L	63 ⁵	N 42° E	N 41° 55' E	
D	83° 58' R	75°	S 53° E	S 54° 10' E	
Beq	89° 49' L			S 35° 47' E	
				= S 35° 45'	

Beq. at SW cor lot 20 Blk 14 etc
 from which the 1/4 cor lot 25 + 36
 in T. 76 S R 6 W bears S 0° 32' E
 3732² ft.

H.F. Pearson

17/43

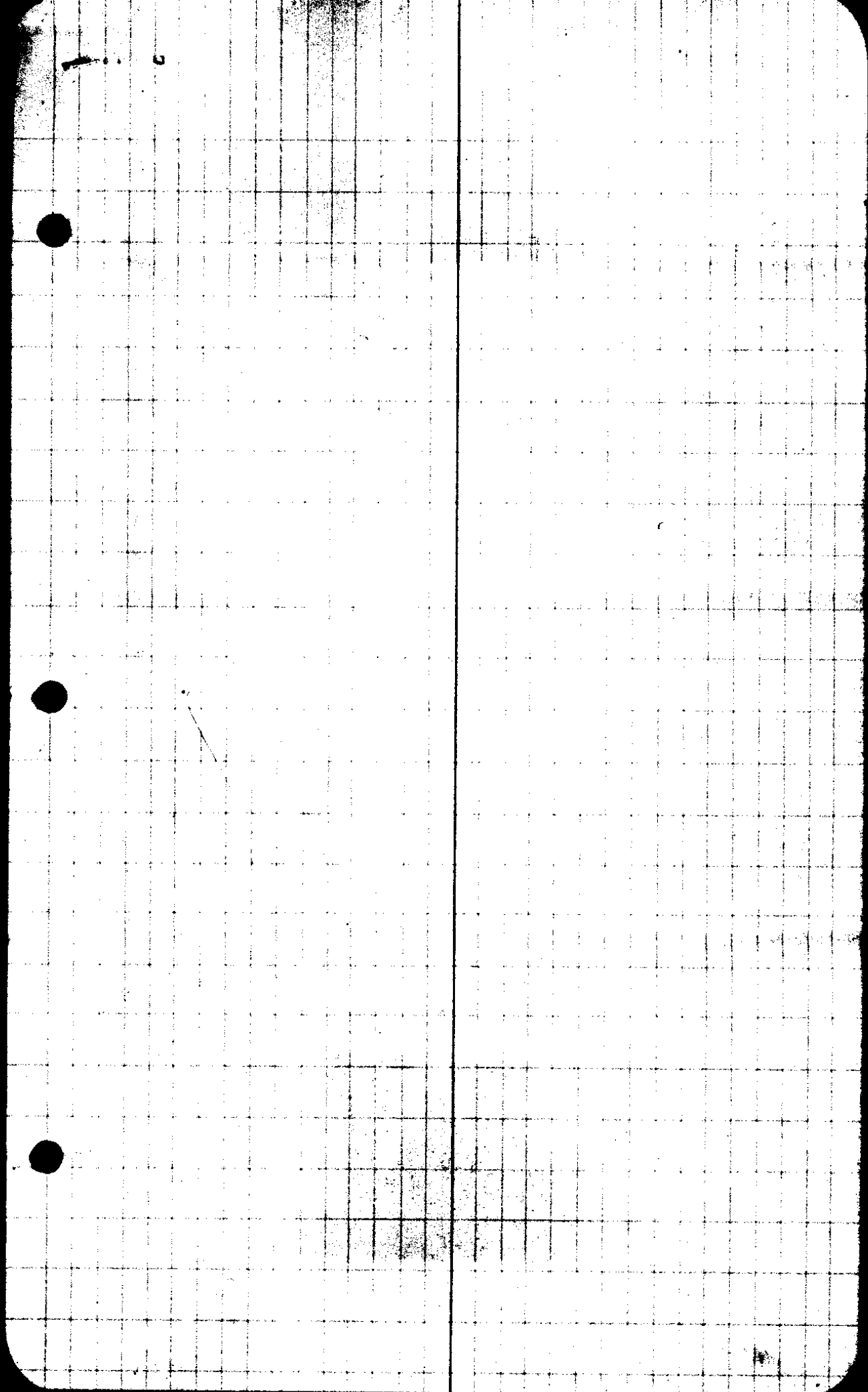

CS FILE FOLDER

CONTAINS

MORE

INFORMATION