

170.17
34.4

186.13 W
30.5

(Nichols)

Now
Travelers Ins to
Jno Lander Jr.

Herman
McC L.

34.4' N
30.5' W } of
44x46.3'

15

31.5'
N42°23'E

14

3.46

54°38'E
3.1

22

Sec
Corner 23

23

48.17
42.23
91.20
11.0

Sec 15

46+48.6
178.3
N47°37'W
252.2
N48°57'W

N41°38'W 46 } 34.4 N
30.5 W

44+46

1" = 200'

Joe
Porter.

Sec. 22

Sec. 23

16-61

28/5

28

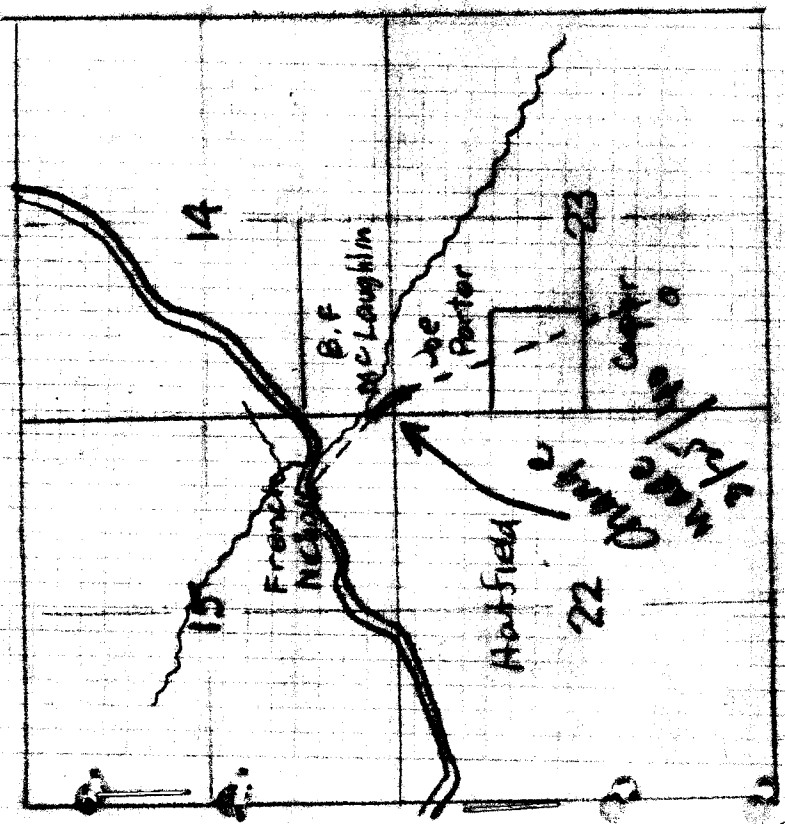

G & File No. 110/61

FIG 61 DRAWING 16

HERMAN Mc. LAUGHLIN *Munmouth, Ore*

Right of Way Description for
ditch for Roberts Creek Water Dist.

A strip of land seven feet wide the center line of which is described as follows,- BEGINNING at a point on the south side of section 14, T.28 S; R. 5 W; W.M.m which is 4.7 ft. East of the S.W. corner of said section 14, thence N.41°-38'W. 3.5 ft. and N.47°-37'W. 3.2 ft. to a point on the west side of said section 14 which is 4.7 ft North of aforesaid section corner, all the above being situate in the S $\frac{1}{4}$ of the SW $\frac{1}{4}$ of section 14, T.28 S; R. 5 W; Willamette Meridian, Douglas County, Oregon.

To B.L.Eddy Esq.
Mar 27, 1940
Co. Surv. Ofc
A.B.

Henry J. and Helen L.Chandler

Right of way description for Water pipe Line
and tract for Reservoir Site
for Roberts Creek Water Dist.

A strip of land seven feet wide the center line of which is described as follows, BEGINNING at a point on the east side of Lot 5, Fisk Fruit Farms, Douglas County, Oregon, 135.0 ft South of the N.E. Corner of said Lot 5, which is also 1537.0 ft North and 265.0 ft West of the section corner common to sections 10, 11, 14 and 15, T.28 S; R. 6 W; W.M., thence $S.84^{\circ}-16'W$; 275.2 ft. to a point on the east side of reservoir site which is 1514.8 ft. North and 529.2 ft. West of said section corner, thence following around reservoir site as follows, South 11.0 ft., West 20.0 ft; North 20.0 ft., East 20.0 ft; and South 9.0 ft to above mentioned point on the east side of reservoir site; all the above being situate in Lot 5, Fisk Fruit Farms, in section 10, T.28 S; R. 6 W; Willamette Meridian, Douglas County, Oregon.

To Mr B.L.Eddy, Esq.
March. 27, 1940
Co. Surv. Ofc.
A.B.

(FRENCH NICHOLS) Travelers Ins Co Foreclosed
To Jno B. Lunder Jr.

Right of Way description
for ditch for Roberts Creek Dist.

Rosebrg

A strip of land seven feet wide the center line of which is described as follows,- BEGINNING at a point on the east side of section 15, T.28 S; R. 5 W; W.M., which is 4.7 ft. North of the South East corner of said section 15, thence running through the south east quarter of said section 15,

N.87°-37'W. 203.4 ft
N.66°-40'W. 253.2 "
N.70°-02'W. 55.2 "
N.70°-43'W. 758.2 "
N.65°-39'W. 148.8 "
N.67°-36'W. 124.4 "
N.70°-33'W. 369.2 "
N.81°-18'W. 165.6 "
S.54°-36'W. 119.8 "
S.46°-52'W. 138.5 "
S.51°-10'W. 43.5 " to the

south right of way fence line of the Dixonville-Carnes County Road No. 16, thence S.51°-10'W. 78.0 ft across said county road to the north right of way fence, thence

S.51°-10'W. 36.0 ft.
S.60°-46'W. 188.3 "
S.59°-19'W. 260.8 ft. to a

point on the west line of the S.E. $\frac{1}{4}$ of said section 15 which is 281.1 ft. North of the South Quarter corner of said section 15, excepting from the above that portion of the ditch line which designates the crossing of county road No. 16 or the Dixonville-Carnes road; all the above being situated in the the S.E. $\frac{1}{4}$ of section 15, T.28 S; R.5 W; Willamette Meridian, Douglas County, Oregon.

To B.L. Eddy Esq.
Mar. 27, 1940
Co. Surv'r. Ofs.
A.B.

CS FILE FOLDER

CONTAINS

MORE

INFORMATION