

14-65

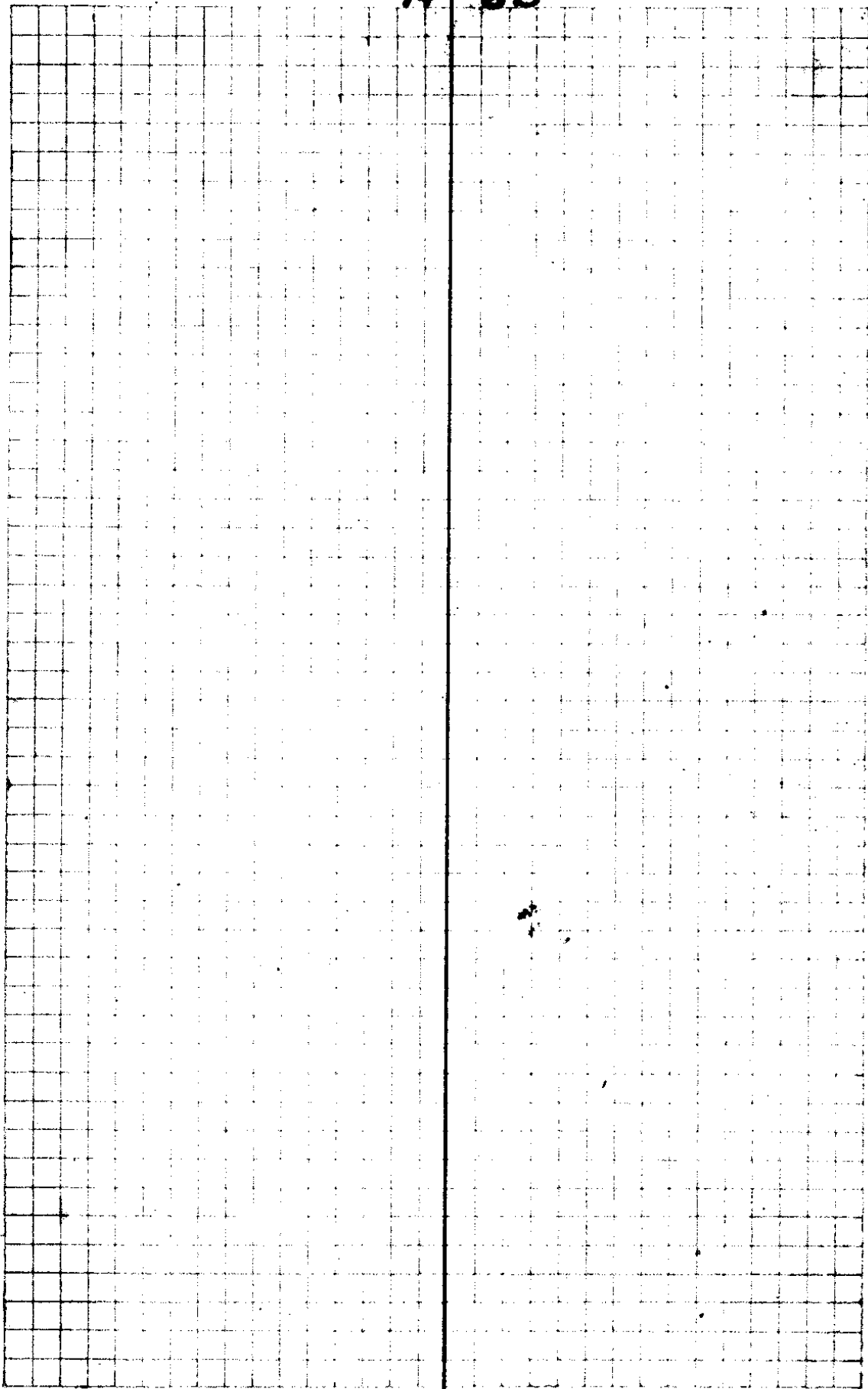

	Dist	Course				
	102	S 5 E	101	996	9	087
	308	S 20 W	289	939	105	342
	218	S 10 E	214	984	38	173
	302	S 15 W	292	965	76	258
	192	S 10 W	181	984	33	173
	388	S	388		<del>388</del>	
	355	S 40 W	272	766	228	642
	648	S 35 W	530	819	371	573
	89	S 20 W	84	939	35	342
BBL	139	S 10 W	137	484	23	173
54	958	S 10 W	<del>943</del>	984	<del>169</del> W	173
	185	S 20 E	174	939	70 E	342
	228	S 20 W	214	939	80	342
	328	S 55 W	194	573	377	819
	192	S 15 W	185	965	50	258
Old Fence	617	S 40 W	473	766	396	642
	259	S	259		-	
(2)	804	S 40 W	576	<del>866</del>	516	642
	116	S 70 W	39	342	109	939
	275	S 50 W	176	642	211	766
	693	S 80 W	129	173	684	984
	548	S 60 W	274	500	474	866
	190	W			190 W	E

324  
45

225  
61  
228  
1368  
13908

3528  
3186  
34888

50  
50  
957  
16  
5728  
367  
15328

1185  
1110  
11225

819  
338  
26552  
2457  
276822

1609  
3226  
4824  
576168

46  
66  
2  
169

3702  
3704  
4317  
472622

3064  
3064  
5628  
596504

696  
7076

1234  
3702  
396114

55  
702

3288  
3288  
4384  
472568

192  
235  
950  
576  
6710

385  
3850

1079  
5851  
693  
128889

048  
4084  
1719  
193674

1650  
1650  
19250  
210650

4158  
693  
11088

77  
76

550  
1100  
1650  
176556

1000

419 S 2 1/2 E  
213 S 1/2 E  
261 S 7 1/2 W  
370 S 60 E

3567  
418 999 18 043  
209 984 37 173  
259 991 34 130  
185 500 820 865

1024

12.

CLERK 11/15



Sec. 29 T24S R3W.

A F Stearns - Oakland.

August 10-11-13-14

1928.

Crew . B. D. Irving T  
 Chas. Jewell H.C.  
 Ed Stearns R.C. + Flag  
 Royal A been Ace.

Weather fair + warm

Topography E + W hillsides  
 sloping steeply to creek  
 bottom 15 chs. wide. Cover  
 dense fir + cedar reproduction  
 in old, logged off areas. Lots  
 down logs + thick brush.

Sta	Chs.		Sec 29 T 24 S R 3 W	MC	Slope
2438	1459	17.50 8°55' R	N 81° 18' W	N 81° 2' W	1578 - 16° 0'
9	1999	0° 12' 0° 6' R	S 89° 54' W	N 88° 3' W <del>S 70° 3' W</del>	2025 - 9° 20'
20712 8	2800	40 0° 20' R	S 89° 48' W	N 89° 3' W <del>S 89° 3' W</del> N 89° 3' W	282 - 7° 20'
48982 7	2768	1.8 0° 3' R	S 89° 28' W	N 89° W	2805 - 9° 20'
6	<del>4830</del> <del>2228</del>	14 0° 7' R	S 89° 54' W	S 89° 3' W	4955 - 12° 55'
5	682	1.35 0° 47' R	S 89° 47' W	S 89° W	
10702 4	2771	9.2 4° 12' L	S 88° 00' W	S 89° W	
3	4102	2.32 1° 16' R	N 87° 24' W	N 87° W	4.176 + 10° 50'
505 2	3101	7.57 3° 59' R	N 89° 04' W	N 88° 2' W	3110 - 4° 20'
0.21 1	2730		S 86° 51' W	S 89° W	2.745 - 6° 0'

NE Cor. Sec. 29

Mar. 21

56  
54  
52  
50  
48  
46  
44  
42  
40  
38  
36  
34  
32  
30  
28  
26  
24  
22  
20  
18  
16  
14  
12  
10  
8  
6  
4  
2

643  
114  
525  
57

True Nor 208° E

Aug 11 1928 (2)

102  
2  
81  
96126

98676

99182

98676

97470

98218

99714

99452

81  
2  
69

9258  
47  
89153

99182  
28  
1963  
793456  
179364  
27969324  
3192  
29  
-8002

9747  
4955  
48785  
48785  
87733  
38998  
48276495

98676  
4805  
493980  
7874089  
147352  
272786180

98218  
4176  
589308  
687524  
98215  
372672  
410159068

Crew Irving A  
Chas Jewell EC  
Ed Stearns EC  
Roy Abeer AXE

1st day looking for corner  
found NE Cor. Sun 29 7 PM

855  
26  
21  
9  
64  
28  
209  
11

855  
26  
20  
34  
7  
47  
116  
359  
375  
110  
275  
16  
11  
57  
11  
3  
99452  
27  
497  
397802  
27664  
14840  
2729957

Set for Corner 5" square Yellow Wood stake

- Scribed
- 99714 Nor DT. 36" Cedar S84° E 46 lks.
- 10" Yew N44° W 26 lks.
- 8" Fir N52° E 15 lks.
- 99452 6" Fir S63 1/2° W 60 lks

Identified this corner from following DT's  
 " Cedar S84° E 46 lks Cedar Stake S43° W 28 lks  
 10" Yew down 1/2 mile from NE W 16 lks.  
 Fir down 1/2 mile N 35° E 11 lks  
 Cedar post scribed distances all check original  
 Bearing on SE & SW Not quite check

S. F. B. R. L. A. Co.

3

Setup, Hub 7  
BS - Hub 6

Solar Observ.

Aug. 11 1928

44.51 1/2  
14824  
47961  
50448  
480  
8124.5

	A.	Hor. L. & M.C.	Time
1	42°-38'	158-00 S 69 1/2 W	2:20 PM
2	42-16	158-32 S 69 W	3-2 3
3	42-5	158-48 S 69 W	3-2 4
4	41-57	158-58 S 69 W	3-2 5
5	41-45	159-16 S 69 W	3-2 6

	1	2	3	4	5
A	42°38'	42°16'	42°5'	41°57'	41°45'
Ref. -	1'4"	1'4"	1'4"	1'4"	1'4"
Para 7	6	6	6	6	6
A	42°37'	42°15'	42°4'	41°56'	41°44'
log. Cos.	9.866812	9.869360	9.870504	9.871528	9.872885
Log Tan.	9.963828	9.958247	9.955454	9.953421	9.950371

d = N 15° 16' 33.2"  
 diff hor = -44.51  
 11 1/2 hrs = 8' 24.5"

Lat = 43° 27'  
 Log Cos. 9.860922  
 Log Sin 9.976491

d = N 15° 8' 8.7" Sin d = 9.416751

Log Cos A	9.866819	Log Sin d	9.416751	Log Tan A	9.963828
Cos L	9.860922		9.727741	L	9.976491
	9.927741		9.689010		9.940319

48867  
 87° 29' E  
 87° 29' E

Log Cos A	9.869360	Log Sin d	9.416751	Log Tan A	9.958247
Cos L	9.860922		9.730282	L	9.976491
	9.730282		9.686469		9.934738
	9.730282		48581		86048
	9.730282		568° 31' W		48681
					.37367

$\cos A = \frac{51}{\cos L \cos A} - \tan L \tan A$

#3

$\begin{array}{r} 9870504 \\ 9860922 \\ \hline 9731426 \end{array}$	$\begin{array}{r} 9416751 \\ 9731426 \\ \hline 9685325 \\ 48454 \end{array}$	$\begin{array}{r} 9955454 \\ 9976491 \\ \hline 9931945 \\ 85496 \\ 48452 \\ \hline 37042 \end{array}$
---	--	---

N 89° 28' E

159° 16' W  
568° 16' W  
590° 32' E

#4

$\begin{array}{r} 9871528 \\ 9860922 \\ \hline 9732450 \end{array}$	$\begin{array}{r} 9416751 \\ 9732450 \\ \hline 9684301 \\ 49341 \end{array}$	$\begin{array}{r} 9953421 \\ 9976491 \\ \hline 9929912 \\ 85099 \\ 48341 \\ \hline 32758 \end{array}$
---	--	---

N 89° 28' E

159° 16' W  
568° 16' W  
590° 32' E

#5

$\begin{array}{r} 9872885 \\ 9860922 \\ \hline 9733807 \end{array}$	$\begin{array}{r} 9416751 \\ 9733807 \\ \hline 9682944 \\ 48189 \end{array}$	$\begin{array}{r} 9950371 \\ 9976491 \\ \hline 9926822 \\ 84501 \\ 48189 \\ \hline 36312 \end{array}$
---	--	---

N 89° 26' E

159° 16' W  
568° 42' W  
590° 34' E

89 26  
 89 27  
 89 28  
 89 29  
 89 31  
 89 31  
 89 28.4

Use 89° 28' W

C. E. No. 14115

Sta	Chs	L	CC	MC	Slope
7067 20	1,588		✓ S 87° 52' W	S 88° 3/4 W	1605 18° 15'
19		31' 0° 15' L			
	1,125		S 88° 7' W	S 88° 1/2 W	1,192 + 19° 18'
18		46.2' 23° 16' L			
	<del>4,049</del> 2,046		N 68° 43' W	N 68° W	2,121 + 15° 0'
17		83.05' 41° 33' R			
	2,308		S 69° 44' W	S 70° W	2,374 + 9° 28'
16		63.32' 31° 46' R			
	908		S 37° 58' W	S 38° 1/4 W	
15		56° 52' 28° 28' R			
	1,543		S 90° 30' W	S 90° W	
14		173.27' 86° 47' L	✓		
	2,599		N 83° 46' W	N 85° W	
13		7.16' 3° 38' R			
	5,578		N 87° 21' W	N 86° 1/2 W	
30,070 12		19.54' 9° 57' L	✓		
	3,259		N 79° 27' W	N 76° 1/2 W	
		1.46'			
26.8 11		0° 50' L			
	2,572		N 76° 37' W	N 76° 1/2 W	2,584
10		9.9' 4° 34' R			
24,239			N 81° 11' W		

C

69 44  
41 33  
~~77 50~~  
111 17  
~~68 43~~  
23 10  
~~17 50~~  
87 7

98965

98965  
~~1605~~  
4948 25  
5937900  
98965  
~~159938925~~

9488 6  
1192 4  
18876  
84942 6  
103818  
~~11250096~~

94380

96593

98638  
~~234~~  
~~344552~~  
~~195914~~  
~~147216~~  
~~23081292~~

9653 5  
~~2125~~  
115836  
19306 7  
~~2046436~~

8644 28 28  
2310 31 48  
15 41 33  
1109 101 47  
10147  
9 22  
9340  
~~13200~~  
49 02

83 46  
46 44  
~~75 30~~  
170 30  
7 30

End of work 8-11-28  
8-13-28 Begin here Same Count  
6:15 PM

395 1  
~~255 1~~  
398 1 4  
796 3 2  
477 0  
1909  
~~257 1~~ 136

99540 1  
81 44  
~~77 27~~

4467  
2025  
~~493380~~  
197353  
197353  
~~19981890~~

9642 6 6  
1518 6  
769 00 8  
861 26  
480 63 0  
061 84  
~~175919268~~

C. S. File No. 19/63

7) Hub	Chs.	L	CC	ML	Slope
30	2162		588°49'W	589½'W	2163 -2°5'
29	2,275	3.06 1°33' L	N 89°38' W	N 89° W	2,349 +14°25'
28	3790	2°54' R 1 27	S 88°55' W	S 88½' W	3792 +4°35'
27	1112	5.24 2°42' L	N 88°23' W	N 87¾' W	1131 +10°35'
26	107	20.15 10 7' R	S 81°30' W	S 82° W	
25	2309	18.54 9 27 L	N 89°½' W	N 89° W	2,311 +1°20'
24	1828	1.57 0°59' R	S 89°58' W	N 89' W	1,838 -6°5'
23	727	4.32 2°16' L	N 87°46' W	N 87½' W	
22	935	6.58 3°25' R	S 88°44' W	N 89½' W	1072 +24°15'
21	2,548	1.34 0°47' L	S 89°36' W	N 89¾' W	
20		3.27 1°44' R	S 87°52' W		
7067					

Cos

99934

96851

99680

Dr. Log.  
98325

Opp Cedar Mt 11 T.

99973

99437

87250

99934

299802  
 599604  
 99934  
 199868  
 216157242

96825  
 2131  
 96325  
 292975  
 1091575  
 111205575

99973  
 2316  
 99973  
 299919  
 99946  
 23093763

96851  
2349

871659  
 387404  
 290553  
 193702  
 227502999

37923  
 99680  
 30336  
 22752  
 24128  
 34128  
 37923

893  
 927  
 7830  
 8120  
 994375  
 18382

795496  
 298311  
 795496  
 99437  
 182965206

87254  
 10721  
 17450  
 61075  
 87250  
 9353200

8855  
 127  
 7463  
 90  
 8938  
 133  
 7963  
 9111  
 8847

17960  
 9137  
 8720  
 212  
 174  
 5855

8926  
 87  
 8449  
 325  
 7374  
 8746  
 212

40

9

Hub Chs. L CC MC Slope

This sec Cor. 1. identify by 3 OBTs bearing  
scribe mks. partly legible - Also down log rolled also  
rolled song in location of hemlock sat by winter 1885  
as sec. cor. B.Ts standing check for bearing  
Sec Cor. ~~11-20~~  
~~5.77~~

	570		N 41° 53' E		
36		61° 10' R	/		
	2,495		N 19° 17' W	N 20° W	2,547 + 11° 35'
37		<sup>3 10</sup> 7° 35' R			
	2,688		N 20° 52' W	N 20° W	2,683 - 1° 5'
36		<sup>186</sup> 69° 1' R	/		
79.672	1179		N 88° 53' W	N 88 1/2° W	1,215° + 10°
35		<sup>33 11</sup> 16° 35' R			
78.476	1,240		74° 32' W	75° W	1,265° + 11° 30'
34		<sup>35 28</sup> 17° 44' L			
70.536	2,044		N 87° 44' W	N 86 2/3° W	2,183 + 10° 50'
33		<sup>1 2</sup> 0° 31' L			
74.192	3,386		N 87° 13' W	N 87 1/4° W	3,383 + 6° 55'
32		<sup>4 22</sup> 2° 11' R	/		
69.528	2,651		N 89° 24' W	N 89° W	2,662 + 5° 15'
31		<sup>1 5</sup> 0° 33' L			
67.77	1,786		N 88° 51' W	N 89 1/4° W	1,798 - 6° 45'
30		<sup>4 40</sup> 2° 20' R			
65.77			S 88° 49' W		

Los.

and dist. This cor. is at top of spar approx 6 ds from Davis Coker Byers Notes of 1871 show cor 15 lks N of ckr

8849
240
8609
919
8457
33
8924
211
8713
31
8744
1740
12960
10528
7430
1635
15460
717
8853
681
2052

5.25

97963
685741
391852
489815
95926
249511761

2685

78
464
2683
4929

00.049

Begin here Aug. 15 1928

98481
1215
1477215
1181772
119654415

97942
1263
48980
48952
58705
1175700
1254400
1239598

98218
2183
242654
785744
93218
186436
20440989

99437
5
3383
498311
745496
278311
278311
3343983
7.2
99807
1397
7
794456
893763
695149
99307
178553986

99580
2662
19916
59748
59748
14916
16508196

Begin here Aug 14 1928 Same crew.

(11)

Witnesses - Ed Stearns  
Royal Abben  
Chas. Jewell } 8-15-28

Set 7" x 7" x 48" cedar post  
for section corner as a reestablishment  
of the corner for sections 19-20-29+30  
as set by Laban H Wheeler in 1883.

Set this post in center of old  
hemlock stump or snag which he  
used as his corner.

Post marked

T24S S. 20 on NE face.

R3W S 19 on NW "

S 29 CS on SE "

S 30 on SW "

2 notches on So. and 5 on East.

New BTs. (all measurements along slopes)

24" Hemlock N 57° E 109 lks. T24SR3W S 20 CS BT

36" Cedar N 80° W 179 lks T24SR3W S 19 " "

30" Fir S 15° E 161 lks T24SR3W S 29 " "

24" Fir S 37° W 164 lks T24SR3W S 30 " "

Also inked with keil as follows. on SW face

"This post renews the sec. cor as set by Laban H  
Wheeler 1883 to restore orig. cor which he  
records as destroyed by fire."

On NW face "Set from original bearing trees

B.B. Irving dep. cor. surv. 8-15-28.

337  
173  
164

50 29 28 17 26 25  
31 32 33

230  
84  
161

12

906  
5  
4530

U.S. ENCL 14/105

Hem  
Gator Stump possible BT

	.41		N 89° 15' E	N	
41		99° 10' R			
	2.683		N 70° 55' W	N 9° W	3.31 - 34° 50'
40		2° 55' R			
	1.908		N 19° 50' W	N 11 W	2.29 - 33° 35'
39		56° 4' L			
<del>37</del>	0.59		N 43° 14' E	N 43 1/2 E	
38		62° 31' E			
			N 19° 17' W		

187  
63

79 10  
9 56  
89 15

In Davis Crk. 3ft from C old cedar stump destroyed by fire

81072

81072  
331

53308  
249  
749772  
166616  
46616  
19077532

81072  
243216  
243216  
26834832

C. S. File No. 19165



U. S. DEPARTMENT OF AGRICULTURE  
 FOREST SERVICE  
 RECONNAISSANCE MAP SHEET

*Judge Stearns  
 Oakland, Cal.*

T. \_\_\_\_\_ R. \_\_\_\_\_ Sec. \_\_\_\_\_ Subdiv. \_\_\_\_\_ N. F. \_\_\_\_\_  
 Mapped by \_\_\_\_\_ Corrected by \_\_\_\_\_ Scale \_\_\_\_\_ inches=1 Mile  
 191 \_\_\_\_\_

*Survey W H Byars 3 1871*

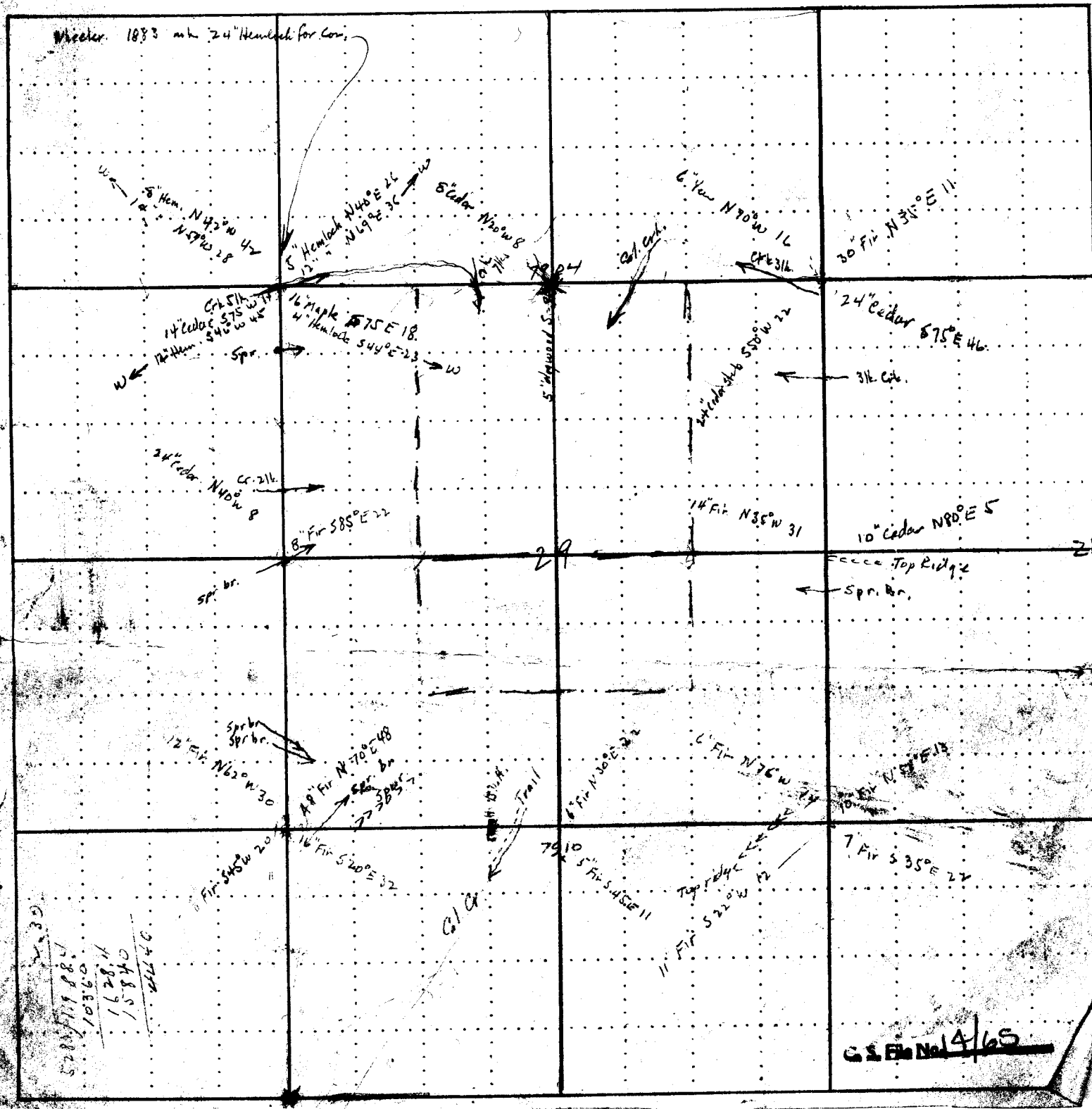

**G. S. F. No. 4/65**

List of All the Registered Voters in ..... Precinct, in ..... County,  
 Oregon, for the Special Election to be held in said precinct on the twenty-eighth day of June, 1927.

SURNAME AND GIVEN NAME

VOTED

PARTY

BALLOT NUMBER

REMARKS

1  
2  
3  
4  
5  
6  
7  
8  
9  
10  
11  
12  
13  
14  
15  
16  
17  
18  
19  
20  
21  
22  
23  
24  
25  
26  
27  
28

*Jdg* Stearns

*C. +  
Herr*

*see 29  
T24-3*

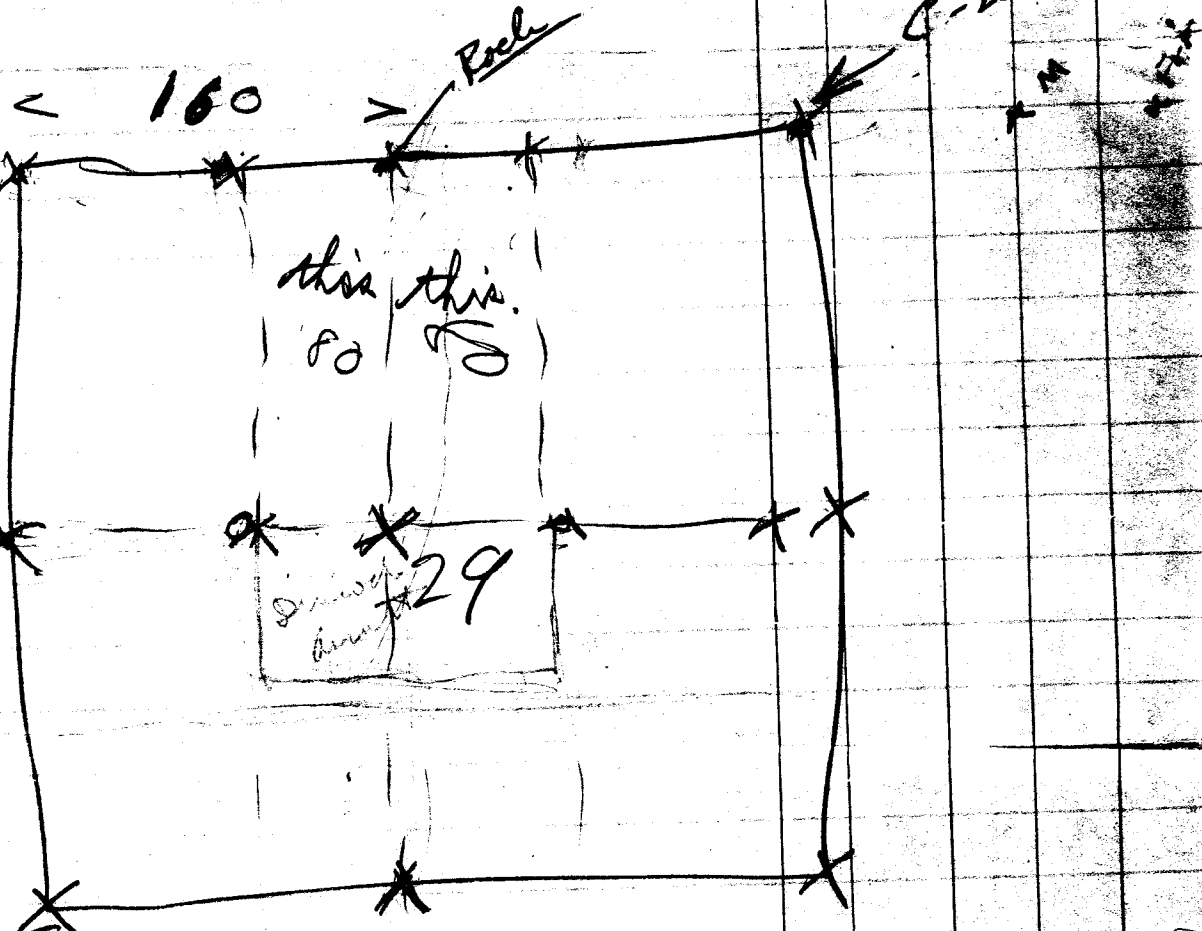

*14 20 NE  
IF30*

*Fir*

*1920  
McMullen*

*S. File No. 11165*

ROY AGEE, COUNTY CLERK  
V. T. JACKSON, SHERIFF  
J. E. SAWYERS, TREASURER  
FRANK L. CALKINS, ASSESSOR  
EDITH S. ACKERT, SCHOOL SUPT.  
H. C. STEARNS, CORONER  
F. C. FREAR, ROAD MASTER  
H. L. EPPSTEIN, SURVEYOR  
AGNES M. PITCHFORD, JUV. OFFICER

W. S. HAMILTON, COUNTY JUDGE  
HURON CLOUGH } COMMISSIONERS  
R. A. BUSENBARK }  
GUY CORDON, DIST. ATTORNEY

# DOUGLAS COUNTY

COUNTY COURT

FIRST WEDNESDAY OF EACH MONTH

Roseburg, Oregon

March 4, 1930

Judge A. F. Stearns  
Oakland, Oregon

Dear Sir:

Regarding the survey which I started for you  
a year ago last summer.

I have tried on numerous occasions to get  
with you and Ed to complete this job, but it has  
been postponed by you on each occasion. You have  
paid \$30.00 toward the amount due me leaving a  
balance due for work already done of \$26.25.

Owing to certain of my own accounts being due  
I am requesting that you send me a check for this  
balance after deducting the amount due the store  
for certain pipe I purchased last Fall.

Yours very truly,

*Bert Johnson*  
DEPUTY CO. SURVEYOR

BBI:BR

*Attach*

*Int. Subm*  
*AGS*

*26.25*  
*15.40*  
*10.85*