

14/61

The image shows a blank ledger page with a grid layout. A vertical line runs down the center of the page, dividing it into two columns. The grid consists of small squares, with the vertical line acting as a separator between the two main columns. There are three binder holes on the left side of the page. The page is otherwise empty of any text or data.

# T. F. Powers

$\Delta 12$		1578 <sup>2</sup>	11.9
$+24-30$	157 <sup>2</sup>	1506	
$\Delta 11$	onking	1391 <sup>6</sup>	10.8
$+12+30$	100 <sup>4</sup>	980	
$\Delta 10$		1299 <sup>6</sup>	10.0
30	503	10 R	
$\Delta 9$			
50 <sup>3</sup>	503	5 L	
$\Delta 8$		1219 <sup>0</sup>	
$+7-16$	166 <sup>4</sup>	165 <sup>2</sup>	
$\Delta 7$		1033 <sup>1</sup>	
$+3-2$	217 <sup>3</sup>	216 <sup>9</sup>	
$\Delta 6$		896 <sup>4</sup>	
$+4-15$	253 <sup>2</sup>	252 <sup>5</sup>	
$\Delta 5$		5639	
$+3-20$	205 <sup>0</sup>	204 <sup>2</sup>	
$\Delta 4$		359 <sup>2</sup>	
$+4-30$	69 <sup>3</sup>	69 <sup>6</sup>	
$\Delta 3$			
$+14$	137 <sup>0</sup>	131 <sup>9</sup>	
$\Delta 2$			
$+6$	142 <sup>2</sup>	141 <sup>9</sup>	
$\Delta 1$			
	15 <sup>8</sup>		
1/4			North

14-61

Sept 9 1930

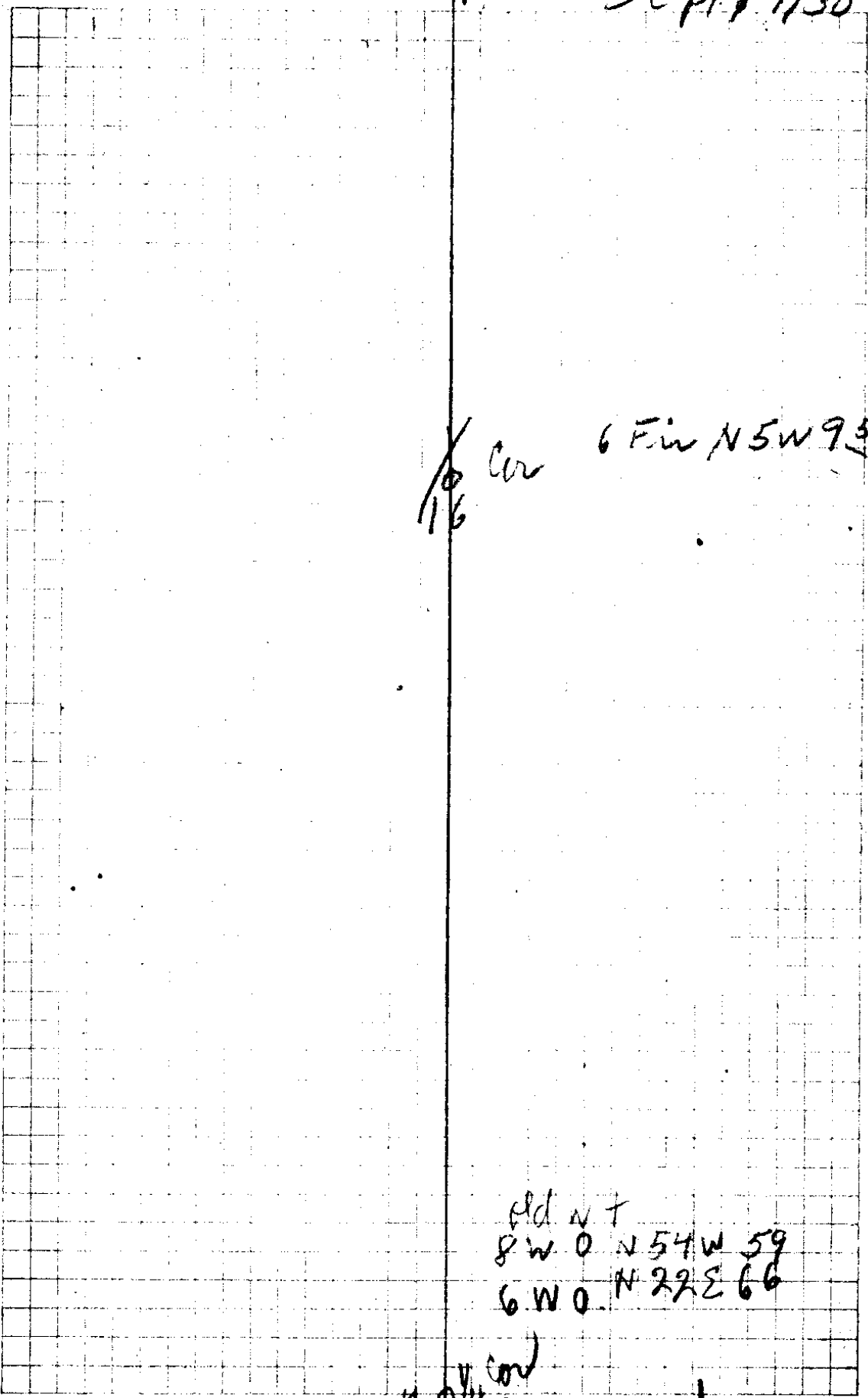

$\frac{1}{16}$  Cor 6 Fin N5W95

fld N T  
 8 W 0 N54W 59  
 6 W 0 N22E 66

4 0 14  
 3

S. File No. 14/61

# Powers

Δ 21		26492	Fall 16.5 West of low
14 178 <sup>5</sup>	173 <sup>5</sup>	90h	
Δ 20			
	14	90R	
Δ 19		2475 <sup>2</sup>	19 feet East
11-39 96 <sup>2</sup>	94.2		
Δ 18		2381 <sup>5</sup>	18.3
110-45 168	165 <sup>0</sup>		
	16	2216 <sup>5</sup>	17 <sup>0</sup>
8-30 300	19-220	514 <sup>0</sup>	
15		1702 <sup>5</sup>	13 <sup>1</sup>
110-15 16 <sup>0</sup>	746	90R	North
14			
	10	90L	
13		16279	125
117-20 83 <sup>4</sup>	797		
12			

12-21  
Powers

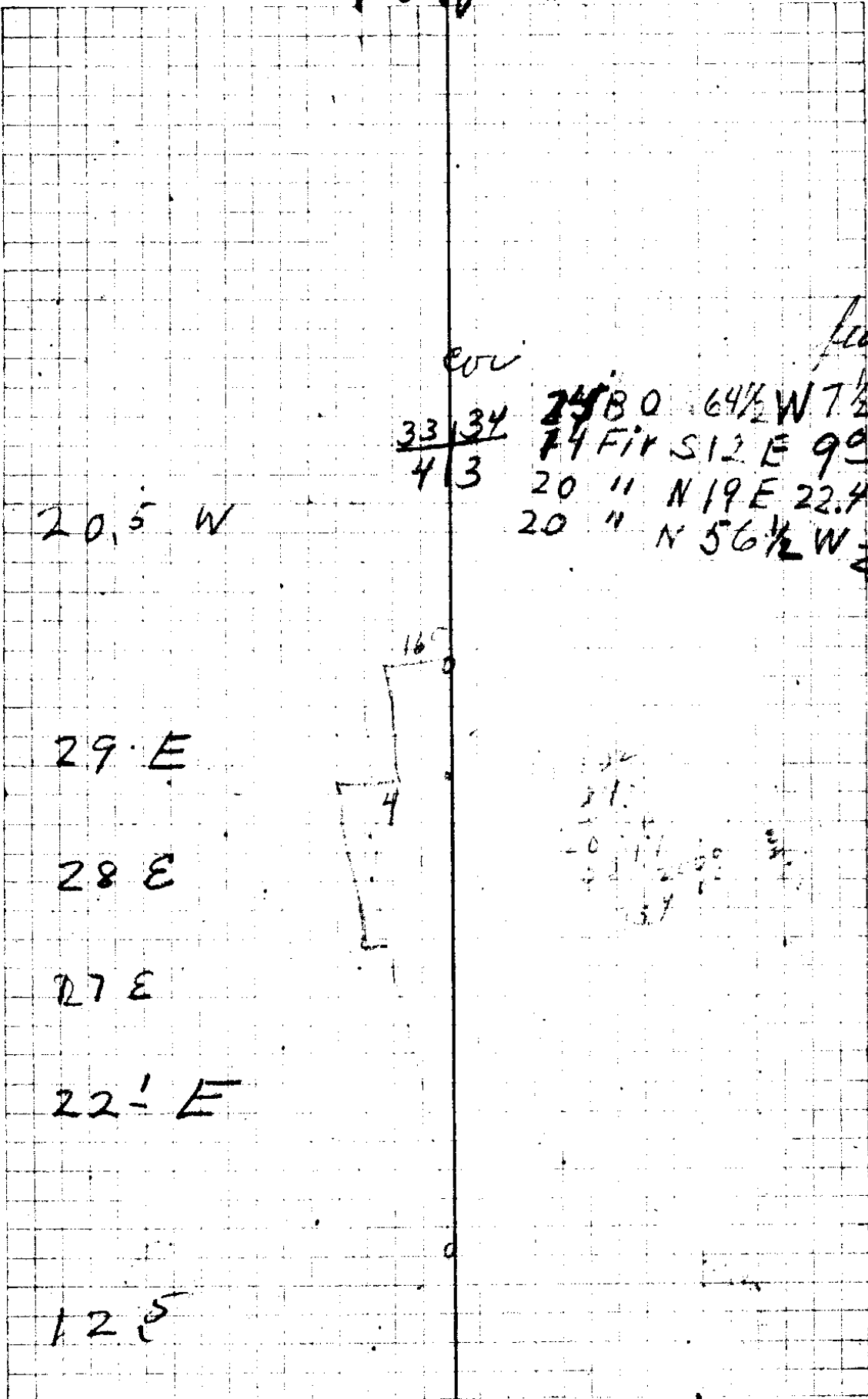

20.5 W

29 E

28 E

27 E

22 E

12.5

EOW  
33 34  
4 3

24 B O 64 1/2 W 7 1/2  
74 Fir S 12 E 90  
20 '' N 19 E 22.4  
20 '' N 56 1/2 W 25

feet

G. S. File No. 14/61

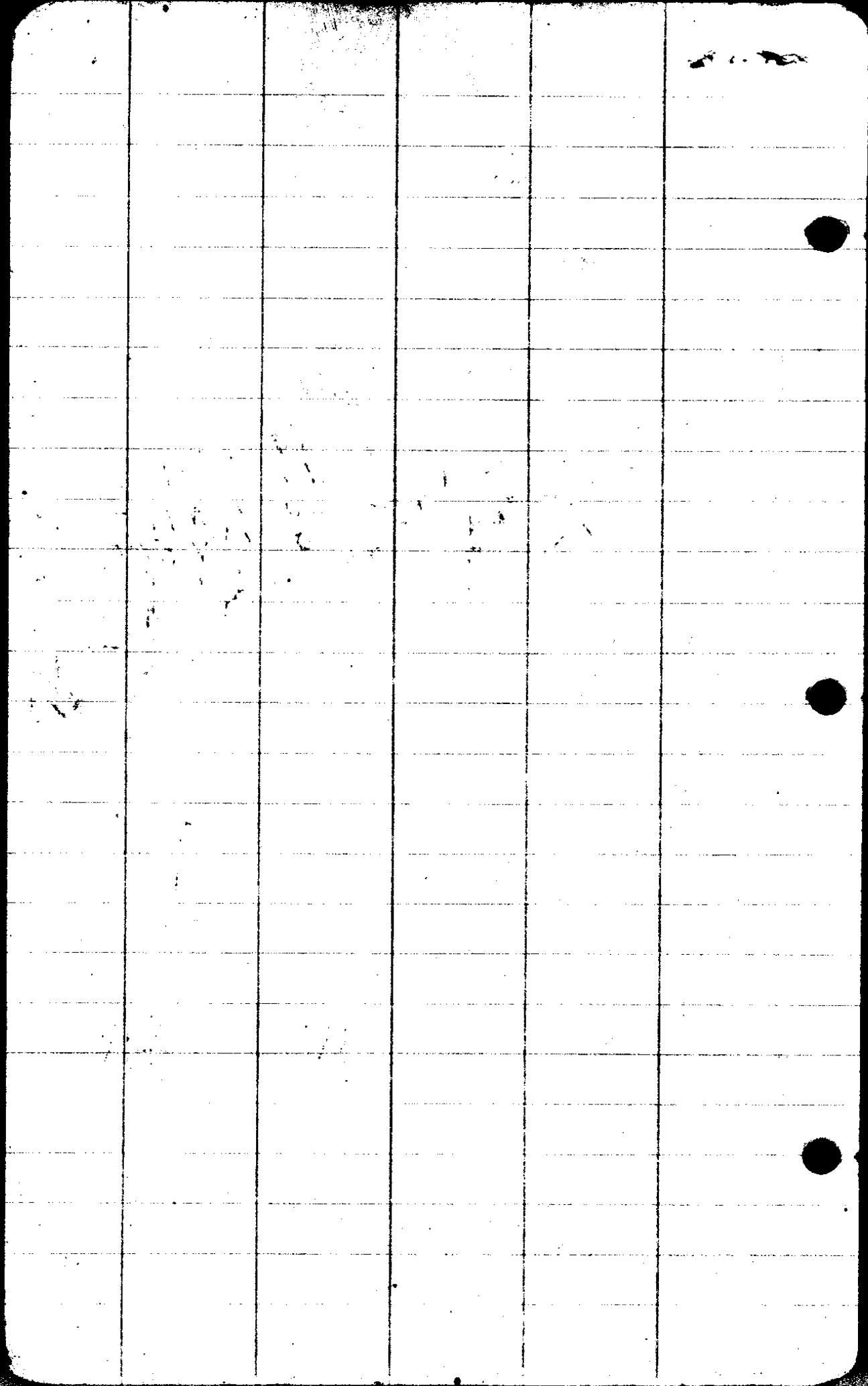

CS FILE FOLDER

CONTAINS

MORE

INFORMATION