

14-55

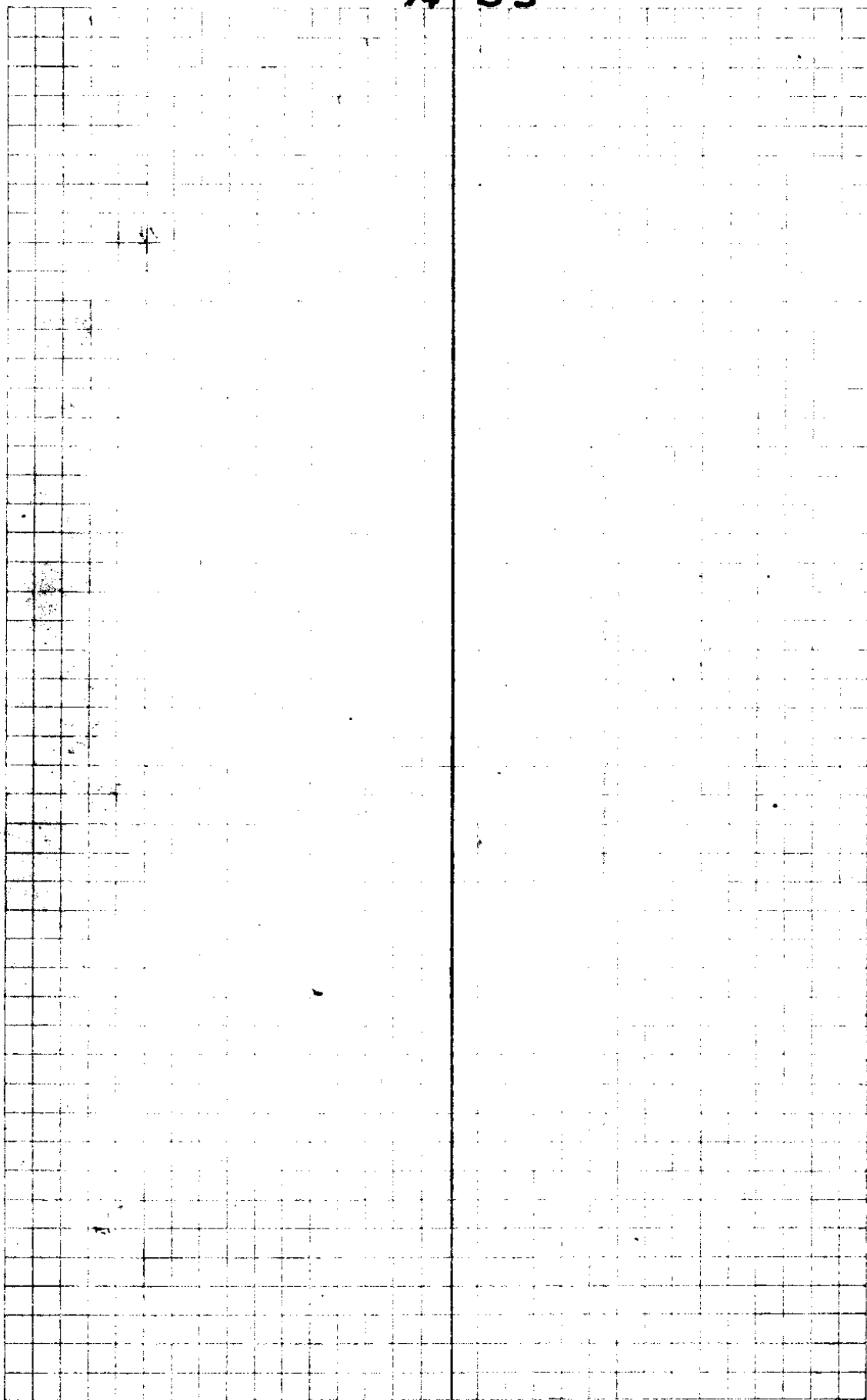

①

7 ΔA

8336 33-24L

N17-54E N1730E

6 ΔA

1859 14-58L

N51-16E

5 ΔA

415L 21-48L

N66-16E

~~4 ΔA~~

~~3 ΔA~~

252

720°

↘

↘

2 A

91-36

N88-04E

↘

Δ6 A

+30°

692

Δ6

252

Δ5

202

Δ4

1312

Δ3

2486

Δ2 A

11762

2 A

252

Δ1

232

90R
90R

90-20E
50-19
South

587-12V
80-48E

W

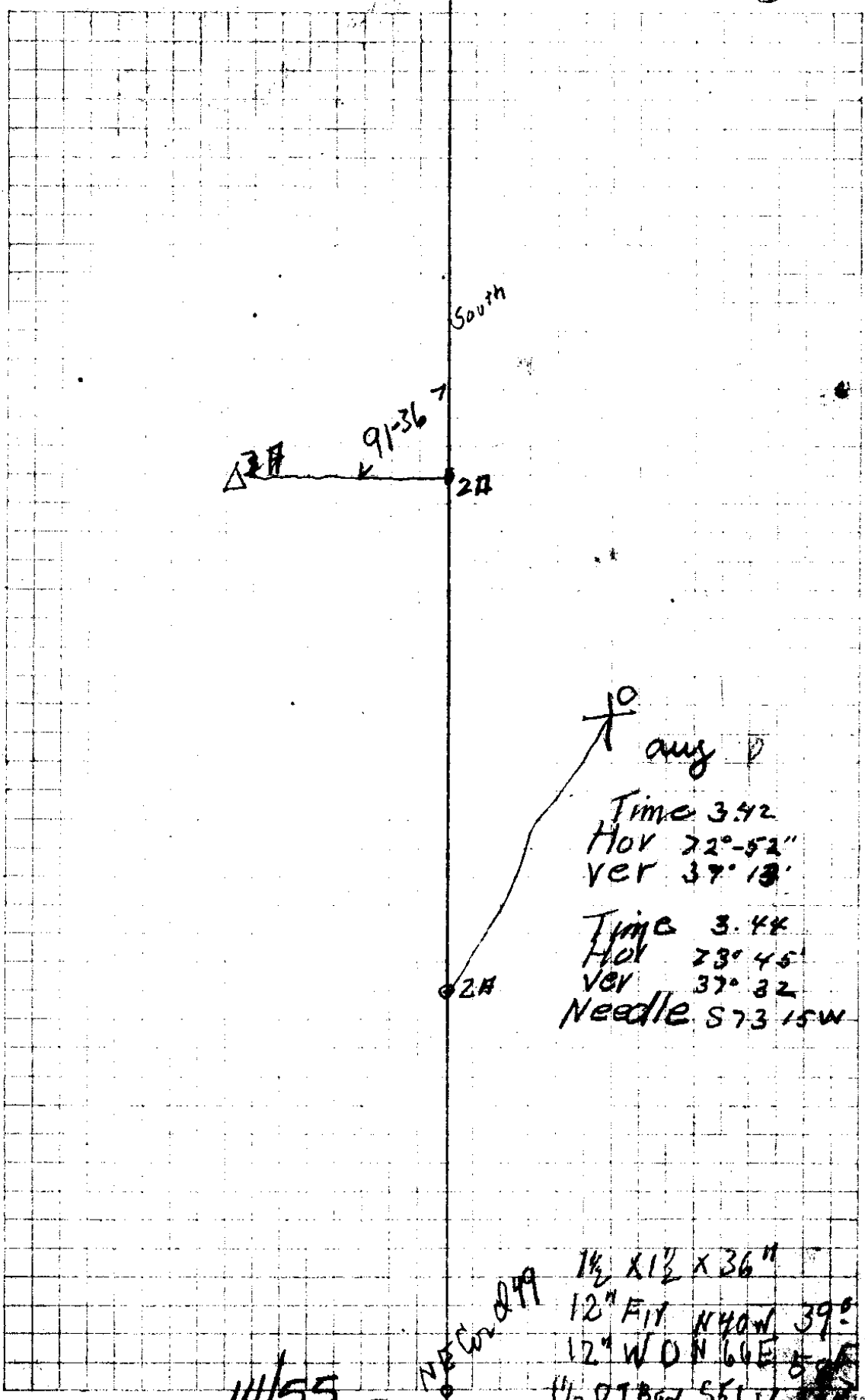

10
+
any

Time 3.42
Hor 72°-52"
Ver 37°-13'

Time 3.44
Hor 73°-45'
Ver 37°-32'
Needle S73 15W

NE corner

1 1/2 x 1 1/2 x 36"
12" FIT N40W 39°
12" WDN 66E 8-1/2
11/20 LBGW S61W 53°

C. S. File No. 14/55

Δ 7 A

41-15 L

8 A
Δ 19

68.9

87-39 R

225°-46' inter

N49-30W
west

Δ 18

39.7.4

174-53 inter

Δ 17

1128

76-03 inter

Δ 16 in Creek

31°

64-04 ext

Δ 15

228°

231°

64-04 inter

Δ 14

91.8
66.8
51.1

147
522
66.8

50-03 inter

N26-42W

Δ 13

334

50-43R

S76-45E

Δ 12

curved creek

127
478

115-56 R

S26-02E

S26-42E

Δ 11

2021 direction
228.9

11-59 L

38-02E

Δ 10 = 13A

1128

R5-07

N50-01E

9A Hub

155.4
27.2
8A
Hub

421.4

45-46 L

N44-54E

285.5

short spot
R71-46

N89-40E East

7A Δ

(4)

194 feet lock from
from 7A to fence

Needle S 88° W

71
1
22 45-46' 19
18 Wuf

15 31 16
64-04

002
477
N 26-42W
52'
50-03
12
13

6A'

10 aug 20
Time 4-0-20
Hov 57-28
Vcr 32-05
Time 4-1
Hov 58-15
Vcr 32-20

7A

Needle S 75° W

C. S. File No. 14/55

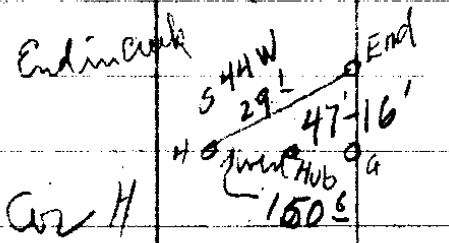

Cor H

285⁵ 71-46 R

Cor G

833⁶ 33-24 L

Cor F 15" Oak S 14 E 40 feet

185⁹ 14-22 R

Cor E N 84 E 97' 15" Oak

66-31 R

2D Cor

see oth page R

Δ D

361⁵ 90 R

Δ C

30 90 L

Δ B

Cor A

358⁵

17¹

D 2

5

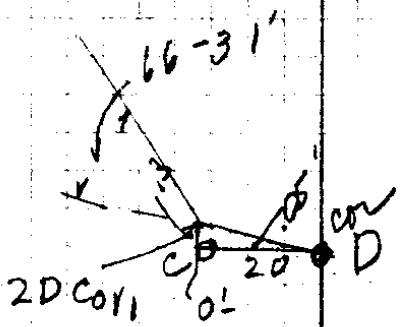

10" WO
 52° E 395 feet

I Bolt 1.5 inch from
 2

Thiel 3.5 North
 1.5 West

Frisk 2H 17 1/2 F

0
 20 900 001
 70

720
 3545

17-206
 2H 89-40

C. S. File No. 14/55

Sutherland

⑨

Cor	13 ⁸	82-33	83-30E
15	16 ²		
+10-45 Δ14 173 ⁰	170 ⁰		
+17-45 Δ13 261 ⁰	248 ⁶	1100 ⁵	
+9-30 Δ12 159 ⁰	158 ⁴		
Δ11		824 ¹	
	78 ⁸		
+11 Δ10 133 ⁰	130 ⁶		
+10-30 Δ9 100 ⁰	98 ⁷		
Δ8			
	81 ⁵		
+14-45 Δ7 207 ¹	200 ³		
+24-45 Δ6 114 ¹	103 ⁶		
Δ5			
			50-20E South

2894.1

1943

SE on 4149 old Tree
8" Cedar N 43-30 E 62 ft
15" C True Cedar N 74-30 W 56 "

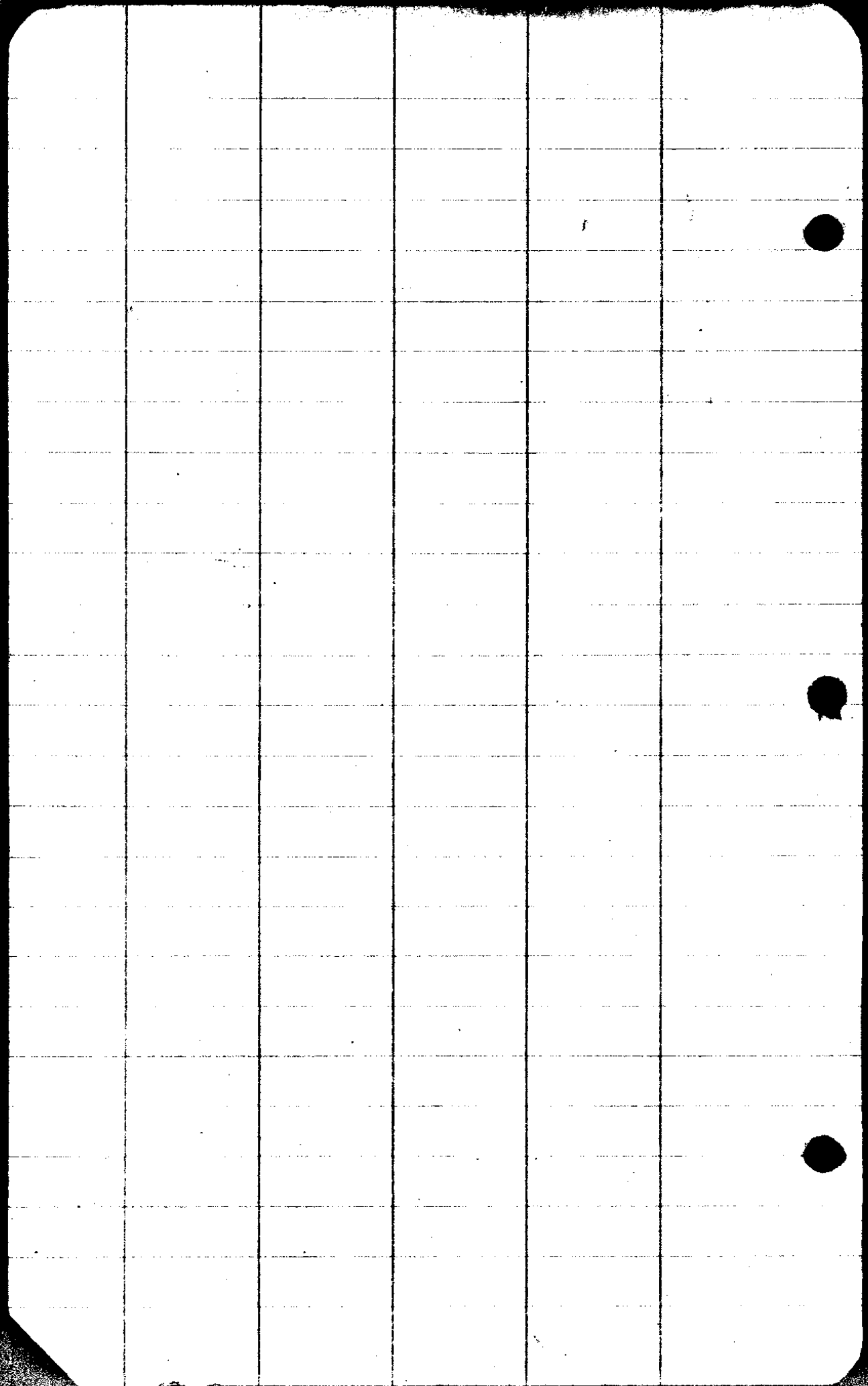

CS FILE FOLDER

CONTAINS

MORE

INFORMATION