

V. N. Poole Irrigation System.  
 In Sec. 30 T. 30 S. R. 3 W. W. M.  
 Douglas County Oregon

OFFICE OF  
 F. C. FREAR  
 County Surveyor and Roadmaster  
 December 1921.

**CERTIFICATE OF SURVEYOR**

*I, G. G. Stewart, of Roseburg, Ore, do hereby certify that this map was made from notes taken during an actual survey made by me Dec. 15 1921, and that it correctly represents the works described in the accompanying application together with the location of streams in the immediate vicinity.*

*G. G. Stewart*  
 Deputy County Surveyor.

① G. Stewart Dep Dec. 15-1921

Survey For V.D. Poole Days Creek  
" Irrig. Ditch.

I started at 1/4 post bet sec  
398 ~~30~~ T 30 S. R. 3 W. This post  
was pointed out to me by V.D. Poole  
as corner. The post was scribed "1/4"  
No. B.T. standing. Several trees down & rotten.

Reset cor. put in I.P.

a 16" Maple N69°W 24°

30" Fir S46°E 60°

Statement of V.D. Poole that this cor-  
was previously set from B.T.s by surveyor-

cor  
1

24°30 59<sup>5</sup> S67°W S67°W

1-2

45°19R

2°30

703<sup>3</sup>

N67°30'W

N67°41'W

2-3

21°33L

N89°W

N89°14'W

2=0+00

21°33L

N89°E

N89°14'W

3+11<sup>7</sup>

1°52R

N87°22'W

~~1+74<sup>3</sup>~~

1+91<sup>6</sup>

C.S. 1/26

# Back Water

| +    | + 1  | -   | Elev              |
|------|------|-----|-------------------|
| 12.5 | 22.5 |     | Creek Bed at 10.0 |
| 8.2  | 29.0 | 1.7 | Dam 20.8          |
|      |      | 7.6 | 21.4              |
|      |      | 8.5 | 20.5              |

354 ft back

10 ft dam

## Dif. Elev. Dam and Flat. by River which is end of ditch

|      |       |   | Dam.    |
|------|-------|---|---------|
| 5.0  | 105.0 |   | 100.0   |
| 4.7  | 107.1 | ✓ | 102.4 ✓ |
| 6.0  | 104.7 | ✓ | 98.7 ✓  |
| 5.4  | 106.1 | ✓ | 100.3 ✓ |
| 7.4  | 108.8 | ✓ | 105.4 ✓ |
| 3.6  | 104.2 |   | 100.8   |
| 0.5  | 98.6  |   | 98.1    |
|      |       |   | 90.4 ✓  |
| 32.6 |       |   |         |

42.2  
32.6

9.6 Dif Elev.

1+11 7  
6 3 5  
1 7 4 2

7-26

(2)

+ H.I - Elev  
0+00 Take in for Ditch 104' 4' 100.0'

C.S. 7/26

(3)

V. N. Poole

|                    |                                 |                       |             |
|--------------------|---------------------------------|-----------------------|-------------|
|                    | 46°32' R                        | N 40½° W              | N 40°50' W  |
| 2+98 <sup>4</sup>  | 15°18' R<br><del>14°44' R</del> | N 25°30' W<br>N 27° W | N 25°32' W  |
| 3+23 <sup>4</sup>  |                                 |                       |             |
|                    | 53° 40' L                       | N 70° W               | N 79° 12' W |
| 3+90 <sup>9</sup>  |                                 |                       |             |
|                    | 12° 26' L                       | S 88° W               | S 88° 22' W |
| 4+62 <sup>0</sup>  |                                 |                       |             |
|                    | 21° 42' R                       | N 70° W               | N 69° 56' W |
| 5+03 <sup>7</sup>  |                                 |                       |             |
|                    | 44° 59' R                       | N 24½° W              | N 24° 57' W |
| 6+13 <sup>2</sup>  |                                 |                       |             |
|                    | 8° 52' R                        |                       | N 18° 05' W |
| 6+37 <sup>L</sup>  |                                 |                       |             |
|                    | 50° 53' R                       | N 10° W               | N 10° 12' W |
| 7+31 <sup>7</sup>  |                                 |                       |             |
|                    | 8° 47' R                        | N 10° W               | N 10° 25' W |
| 8+49 <sup>0</sup>  |                                 |                       |             |
|                    | 27° 31' L                       | N 28½° W              | N 28° 56' W |
| 9+63 <sup>5</sup>  |                                 |                       |             |
|                    | 33° 31' L                       | N 63° W               | N 62° 27' W |
| 9+94 <sup>9</sup>  |                                 |                       |             |
|                    | 30° 09' L                       |                       | S 87° 24' W |
| 11+08 <sup>9</sup> |                                 |                       |             |

1068  
1916  
2984

3 2 0 7-26 100.4  
675 28.4  
3909 71.1

3-909  
717  
4+620  
467  
5037

(4)

|                      | Elev.                 | H. I.   |      | Hub.  |
|----------------------|-----------------------|---------|------|-------|
| 0+00 + 4.1           | 104.1                 | -       |      | 100.0 |
| 0+50                 | <del>104.1</del>      | 3.7     |      | 100.4 |
| 1+00                 |                       | 2.8     |      | 101.3 |
| 1+11 <sup>7</sup>    |                       | 4.2     |      | 99.9  |
| 1+50                 |                       | 5.9     |      | 98.2  |
| 1+74 <sup>2</sup>    |                       | 4.7     |      | 99.4  |
| 1+91 <sup>6</sup>    |                       | .9      |      | 103.2 |
|                      |                       | Top stk | 10.6 |       |
| 2+50                 | 3 <sup>00</sup> 104.4 | 2.7     |      | 101.2 |
| 2+98 <sup>4</sup>    |                       | 2.8     |      | 101.6 |
| 3+23 <sup>4</sup>    |                       | 1.7     |      | 102.7 |
| T.P                  | 9 <sup>1</sup> 108.2  | 5.2     |      | 99.2  |
| 3+90 <sup>9</sup>    |                       | 5.8     |      | 102.9 |
| 4+62 <sup>0</sup>    |                       | 6.4     |      | 101.8 |
| T.P. Tree            | 3 <sup>2</sup> 105.7  | 6.3     |      | 101.9 |
| 5+03 <sup>7</sup>    |                       | 2.8     |      | 102.9 |
| 5+50                 |                       | 3.9     |      | 101.8 |
| 6+13 <sup>2</sup>    |                       | 3.6     |      | 102.1 |
| 6+37 <sup>1</sup>    |                       | 4.0     |      | 101.3 |
|                      |                       | T.P.    | 2.9  | 102.8 |
| TP 7+31 <sup>7</sup> | 4 <sup>0</sup> 103.1  | 6.6     |      | 99.9  |
| 8+00                 |                       | 5.9     |      | 97.2  |
| +49                  | OS 7/2                | 7.0     |      | 96.1  |

(5)

V. M. Poole

Tie To other Fork (for Location of Intake)

8 + 49<sup>0</sup>

N1°25'W

91°29' R

3°40'

187<sup>5</sup>

S89½°E

S89°56'E

7°29' L

0

71<sup>6</sup>

N82°30'E

N82°35'E

2°53' R

2°

85<sup>3</sup>

S89°E

N85°28'E

0 + 100

9°07' R

7°30'

90<sup>2</sup>

S85°E

S85°25'E

140°53' L

N46°W

N46°18'W

0 + 33<sup>5</sup>/<sub>517</sub>

25°38' R

N70°40'W

0 + 85<sup>2</sup>

44°20' L

N65°W

N65°W

1 + 96<sup>2</sup>

34°38' R

N30°W

N30°22'W

3 + 10<sup>2</sup>/<sub>316</sub>

37°46' L

N68°W

N68°08'W

4 + 41<sup>8</sup>

108°00' R

N39°52'E

7 + 41<sup>8</sup>

(6)

TP 8<sup>5</sup>  
 9+63<sup>5</sup> 7<sup>3</sup>  
 9+94<sup>9</sup>  
 10+47<sup>3</sup>  
 11+08<sup>9</sup>

103<sup>4</sup>  
~~104<sup>5</sup>~~  
 103<sup>3</sup>

7<sup>1</sup> 96<sup>0</sup>  
 8<sup>5</sup> 96<sup>0</sup>  
 6<sup>2</sup> 97<sup>2</sup>  
 7<sup>1</sup> 96<sup>2</sup>  
 7<sup>5</sup> End 95<sup>2</sup>

Location Takeout.

Continuing Ditch Survey from Takeout

End Ditch

Lateral.

as 7/26

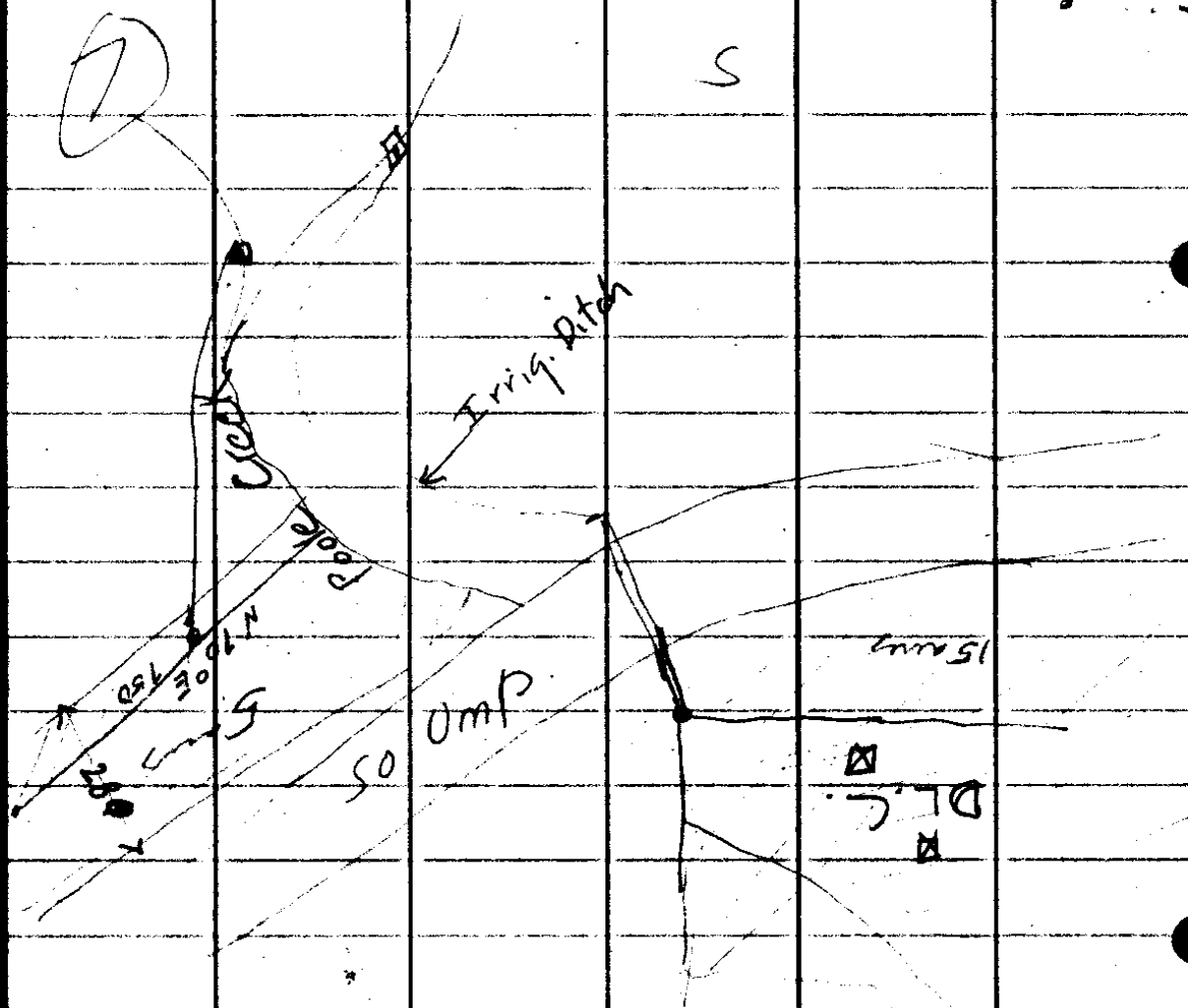

$$\begin{array}{r} 11 \\ 25 \\ \hline 75 \end{array}$$

North

7-26

Born

Dist. for Pipe

(8)

8°02'

Sq. River

X

44°51'

127°07'

11+089

9+949

114.0

$$\frac{X}{\sin 44^{\circ}51'} = \frac{114.0}{\sin 8^{\circ}02'}$$

.7053                      .1397

$$\frac{80.404}{.1397} = 575.5ft$$

C.S. 7/26



CS FILE FOLDER

CONTAINS

MORE

INFORMATION