

N

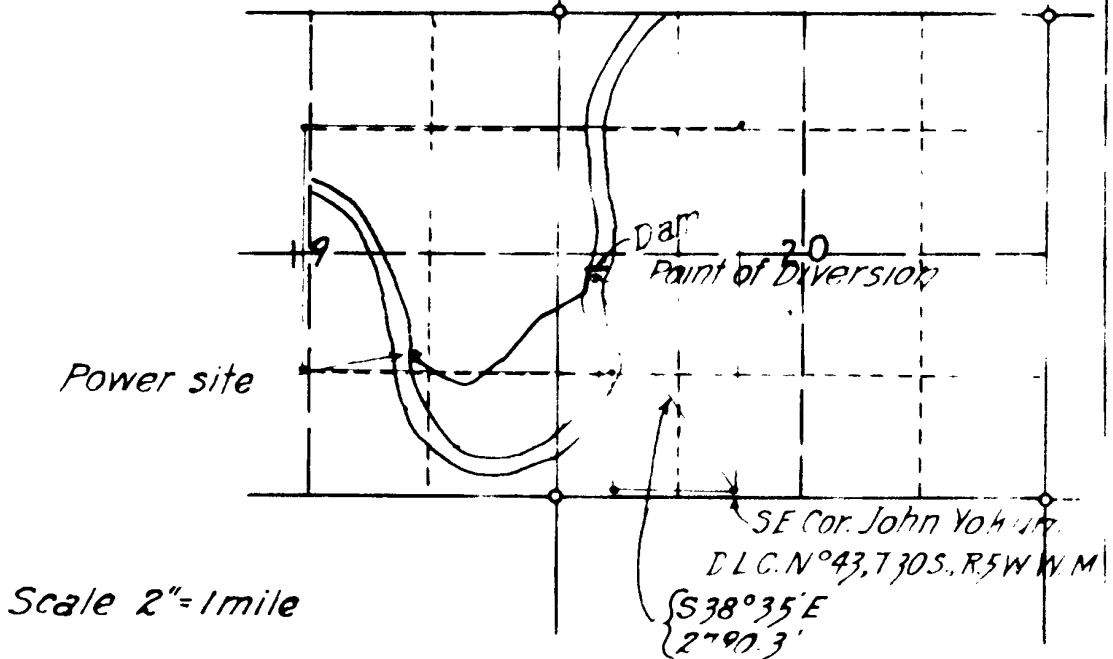

MAP OF RIDDLE POWER CO. SITE

IN

SECTIONS 19 & 20 TWP 30 S., R. 5 W. W. M.

DOUGLAS COUNTY OREGON

OFFICE OF
H. L. EPPSTEIN
County Surveyor
April 1922

CERTIFICATE OF SURVEYOR

H. L. Eppstein of Roseburg, Oregon, do hereby certify that this map was made from notes taken during an actual survey made by me April 16, 1922, and that it correctly represents the works described in the accompanying application, together with the location of streams in the immediate vicinity

H. L. Eppstein
County Surveyor

CS FILE FOLDER

CONTAINS

MORE

INFORMATION