

X

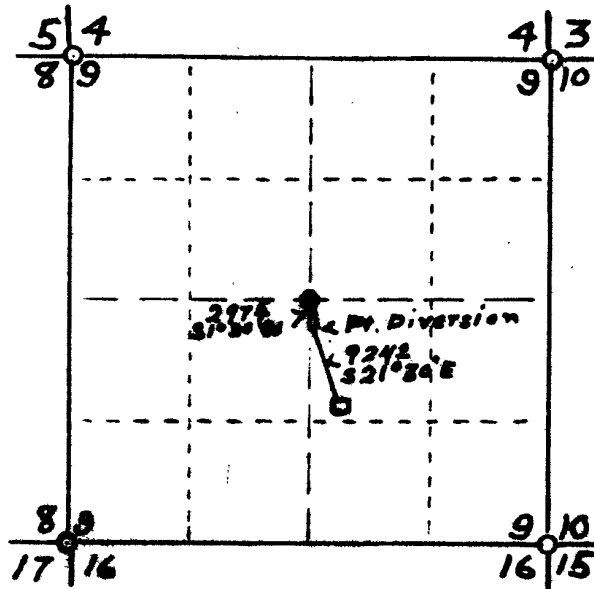

Scale
2" = 1 mile

WATER FILING FOR H.C. WOOD

Located in Sec. 9 T26S. R9W. W.M.
DOUGLAS CO. ORE.

CERTIFICATE OF SURVEYOR

I, H.L. Eppstein, of Roseburg, Ore., do hereby certify that this map was made from notes taken during an actual Survey made by me and that it correctly represents the works described in the accompanying application together with the location of streams in the immediate vicinity. June 6, 1929.

H.L. Eppstein.

REGISTERED PROFESSIONAL ENGINEER
LICENSE NO. 1011. NOV. 8, 1920

6-62

1



1111



H C. Wood

810			
9-40 168 C-sec 9	1655	R 8°-10	888-452
3.9		R 83-34	N 83-E
Δ9		2083.1	E 3.9
7-30 249 7-30 2679	346.3		
Δ8		1736.8	E 3.1
7-30 2679	256.6		
Δ7		1480.2	E 2.7
11-30 1111	108.4		
Δ6		1371.5	E 2.5
21° 86	80.3		
Δ5		1291.2	E 2.3
11-30 3924	3849		
Δ4		906.3	E 1.6
14-30 1264	122.4		
Δ3		783.9	E 1.4
20° 2895	289.3		
Δ2		494.6	E 1.6 Ma
	3.091		
Δ1		185.5	E 1.3 Ma
	1.8555		
9 1/2 1659			
	.81		N 0°-30W
API PR.			

1.9 lbs N

10" B.O. N49W 8 lb
C# 59 10" B.O. S20 E 7 lbs

26' marks

○ S 1/16 S. 9 18 G. dar N44E 9 lb
Marked S 1/16 S. 9. B.T.

S 9
A.P. 10
P.R.

6-62

3

H.C. Wood,

Δ 22A

3741²

.582

1B-1B

East

Δ 21A

~~3685~~

649³

⁸⁷
17-13

N80E

N78-47E

Δ 20

3048^L

5 270³

269³

Δ 19

2778⁸

⁶³⁰
197³

196²

Δ 18

2582⁸

209

Δ 17

on km -

2373⁸

1002^L

Δ 16

Road

1371.7

¹⁸⁻¹⁵
225³

223⁸

Δ 15

1147.9

¹²⁻²⁰
143¹

139.7

90R

Δ 14

10 lpa

90L

Δ 13

1008²

¹⁷⁻²⁰
161

153⁵

Δ 12

854.7

^{14⁰}
420²

407.7

Δ 11

447.0

¹⁵⁻²⁵
272²

281.5

East

Δ 10

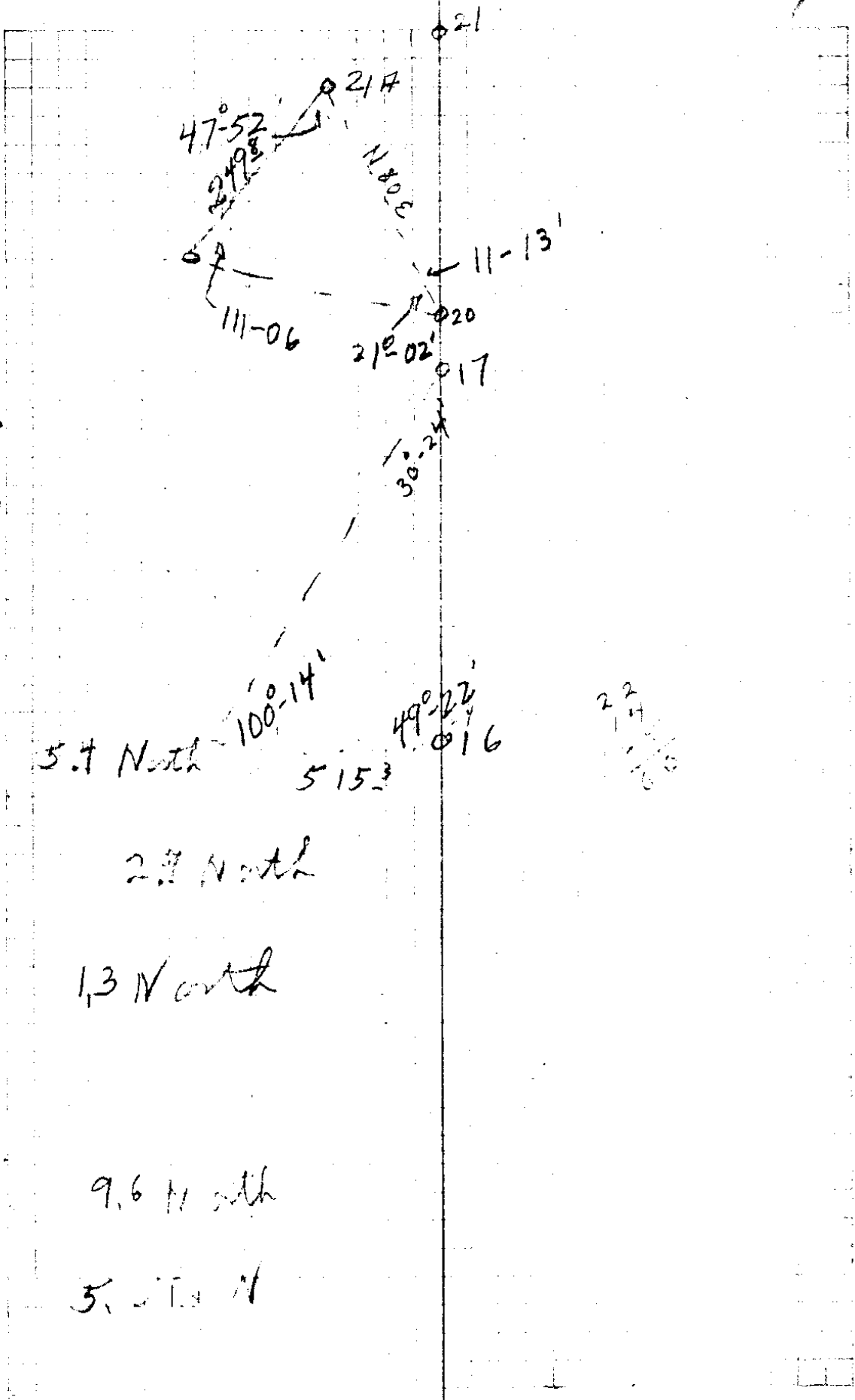

5.4 North

5153

49°-22'

22
14
16

2.7 North

1.3 North

9.6 North

5.5 North

5

N C Wood

Δ 23
2° 45'
14970

25LK
4507
4757

4° - 52'

53° E

22A

105⁵-

90° - 14' R

50 - 14 W

H C Wood

6

9 y¹⁰ 8 Fin N27E 11 lba
12 " N65W 16 "

my line Fall 32 lba with

6-62

