

C. S. File No. 6/44

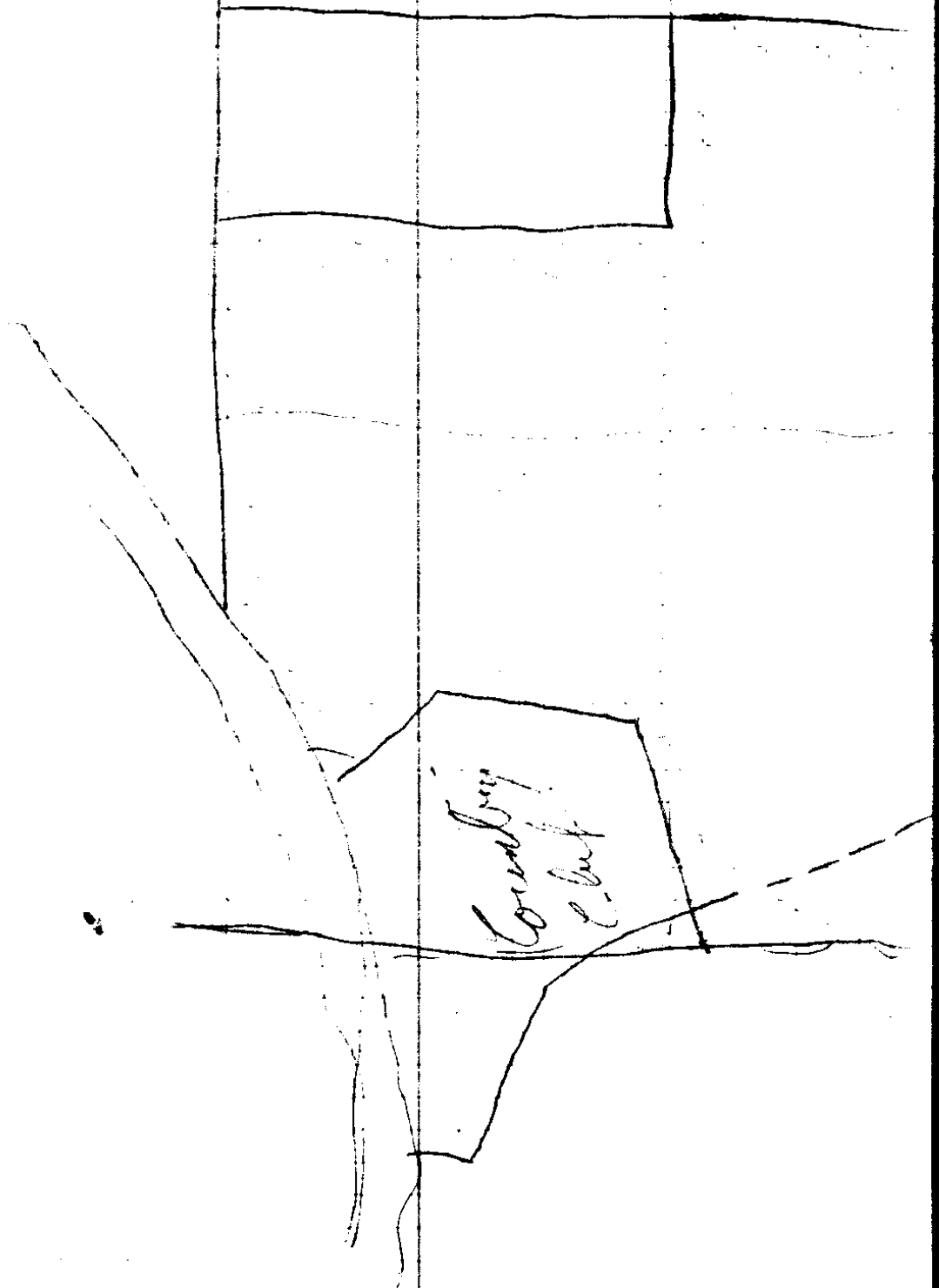

C. S. File No. 6/44

Bogard - Curry  
Sec. T27S

Survey  
R6W

# 9	375.0		S 4° 30' E	55-54 E ●
# 8	230.5	R 84° 30'		N 89-36 E
# 7	1600 <sup>00</sup>	R 0° 05'	S 88° 45' E	N 89-31 E
# 6	338.0	L 70° 13'	S 19° E	S 20-16 E
# 5	1675.0	L 1° 04'		S 19-12 E
# 1	1323.6	R 0° 03'	S 19 E	S 19-15 E ●
# 2				
# 4	384 ±			N 81-55 E
# 3	704 <sup>0</sup>	16-36 R 8-18	N 73° 30' E	N 19-31 E ●
# 2		185° + 6' R 92° 52'	N 19° W	N 19-15 W
# 1				



# 19

330°

S 86 E

S 87 3/4 E ●

# 18

R 0° 52'

150°

S 88 E

N 89-30 E

# 17

L 0° 33'

899 1/2

S 87 1/2 E

S 89-57 E

# 16

R 0° 18'

195.8

S 88 1/2 E

N 89-45 E

# 15

R 1° 01'

314.0

N 84-15 E

N 88-44 E

# 14

L 8° 21'

131.7

S 87 E

S 82-55 E ●

# 13

R 6° 34'

154.6

N 86° E

S 89-29 E

# 12

R 0° 40'

450°

N 89-30 E

N 89-51 E

# 11

L 89° 59'

601 1/2

S 0° 30' W

S 0-10 E

# 10

L 0° 26'

V 600°

S 4° W

S 0-16 W ●

# 9

R 6° 10'

375°

S 5-54 E ●

# 8

Stake with  
2 2 1/2" on Sides (?)

Iron Pipe  
in  
fence.

#18

#17

← 1537

#16 is 4' S of Fence.

#15

#14

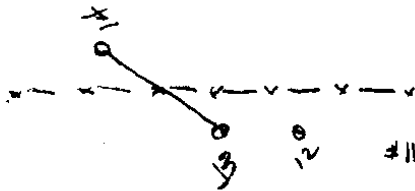

Stone  
D.L.C. Cor. of  
SE Cor. of  
Way Claim?

#11 is 4' East  
& 3' N of Cor.

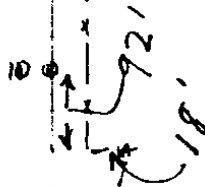

Ridge

#9

#8

C. S. File No. 6/44

# 30

229<sup>8</sup>

N10° E N6-49E

# 29

R12°05'

113<sup>6</sup>

N4¼W N5-16 W

# 28

L1°32'

129<sup>0</sup>

N4½W N3-44W

# 27

L4°29'

156<sup>0</sup>

N2½E N0-45E

# 26

L3°48'

128<sup>8</sup>

N3°E N4-33E

# 25

R12°21'

203<sup>4</sup>

N11°W N7-48W

# 24

L103°17'

255<sup>5</sup>

S86-E S84-31E

# 23

R14°05'

210<sup>2</sup>

N82E N81-24E

# 22

L7°59'

185<sup>5</sup>

S89°E N89-23E

# 21

R91°41'

383<sup>1</sup>

N4°W N2-18W

# 20

L6°02'

204<sup>8</sup>

N3½E N3-44E

# 19

L86°38'

S89-38E

Edge Grove

In groove

Edge Grove

On ridge

On ridge

corner

#24 is 3' W & 3' N of Fence Corner  
4x4 scribed oak post in corner

#21 is - 3' E & 3' S of  
Stone with X &  
4' E & 4' S of Lot Stake

Stake - 

Plat A	1
Plat B	9-10

#19 - 3' S & 3' E of  
Fence corner

C. S. File No.

6/44

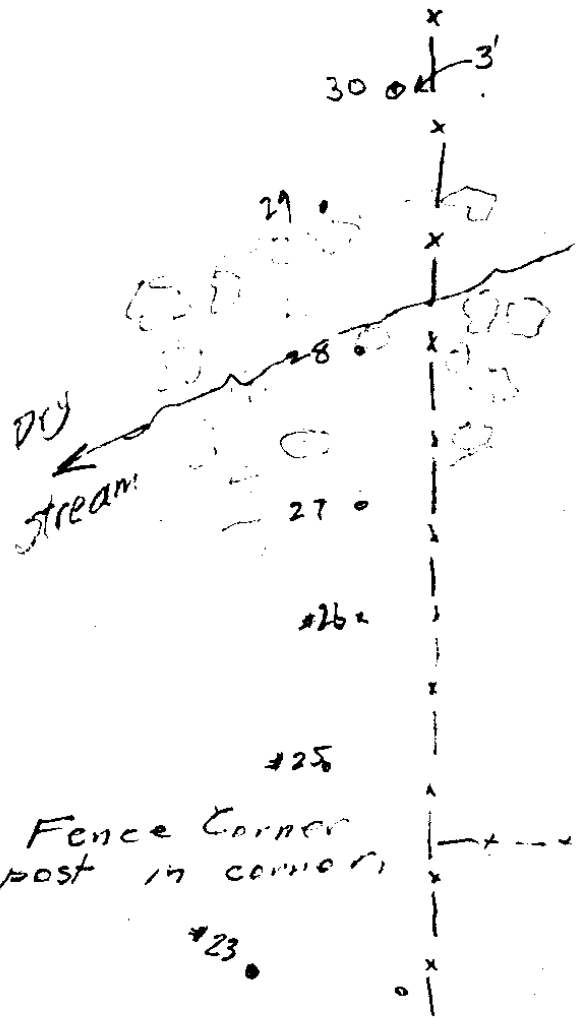

# 40  
230.9  
+3°05'

230.6

N6°W

N7-28W ●

# 39

L4°33'

186.7

N1-30W

N2-55W

# 38

R0°20'

150.9

N2°W

N3-15W

# 37

L3°30'

390.1

N2°E

N0-15E

# 36

L5°41'

98.1

N8°E

N5-60E

# 35

R6°48'

382.5

N1°E

N0-52W ●

# 34

R1°41'

-8°20'  
278.5

275.6

N2°30W

N2-33W

# 33

L6°10'

114.7

N4°E

N3-37E

# 32

R2°52'

54.2 L 1°10'  
300 + 8°50'

54.2  
296.4  
350.6

N1°30'E

N0-45E ●

# 31

R5°03'

213.5  
-4°20'

212.9

N3 3/4 W

N4-18W

# 30

R11°07'

N7°E

N6-49E

x  
x  
x 3'

C. S. File No. 6/44

#52 -11°35' 161.3	158.0		S82°30W	S84-15W
#51 181.9 -14°05'	176.4	R0°45'	S84W	S83-30W ●
#50	182.4	L5°31'	N89½W	S79-0W
#49	136.3	L1°55'	N87½W	N89-04E
#48 -10°20' 205.9	202.6	L66°29'	N22W	N22-35W
#47 193.0 -13°45'	187.5	L21°19'	N	N1-16W
#46 -12°20' 122.8'	120.0	L7°50'	N7°E	N6-34E ●
#45 -4°15' 112.3	112.0	R12°05'	N5°30W	N5-31W
#44 +12°05' 210.	205.3	L5°58'	N3°E	N0-27E
#43 110° +17°	105.9	L4°30'	N5-45E	N4-57E
#42 164.2 +16°20'	157.6	R5°09'	N0°45'E	N0-12W ●
#41 338.3 -11°30' 300 +15°	331.5 298.8 630.3	L2°29'	N3°30'E	N2-17E
#40		R9°45'		

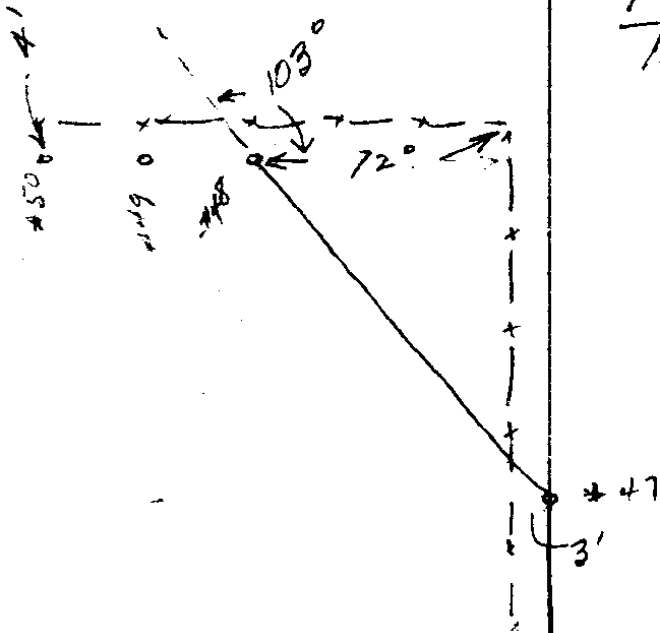

N 22-35 W  
 + 103  
 -----  
 N 80-25 W

2.8  
 1.6  
 ---  
 7.2

C. S. File No. 6/44

#62 -8° 30' 139.1	137.5	R 1° 19'	N 5 1/2 W	N 2-23'
#61 -8° 45' 128.8	127.3 ✓	R 3° 57'	N 7 1/2 W	N 3-22 W
#60 170.1 + 6° 30' 300' - 7°	466.8 ✓	L 8° 07'	N 2° E	N 1-39 W
#59		L 4° 06'	N 6° E	N 0-28 E
458	83.9		N 6° E	N 4-3 1/2 E
+7° 40' 235.9	233.8	R 7° 49'	N 2 1/2 W	N 3-15 W
#57		L 5° 42'	N 6° E	N 2-27 E
	216.0			
#56 220 + 6° 10' 224 - 2° 19'	442.7	R 3° 07'	N 0-30 W	N 0-40 W
#55 + 7° 40' 183.9	182.3	R 0° 30'	N 0° 30' E	N 1-10 W
54 143° - 12° 45' 300 - +7°	139.5 297.8 <u>437.3</u>	R 72° 42'	N 72° W	N 73-52 W
53		R 15° 23'		
1252.5	1252.5			
300 - 9° 45'	295.7 <u>1548.2</u>		West	N 89-15 W
#52		R 6° 30'		
				S 84-15 W
#51				

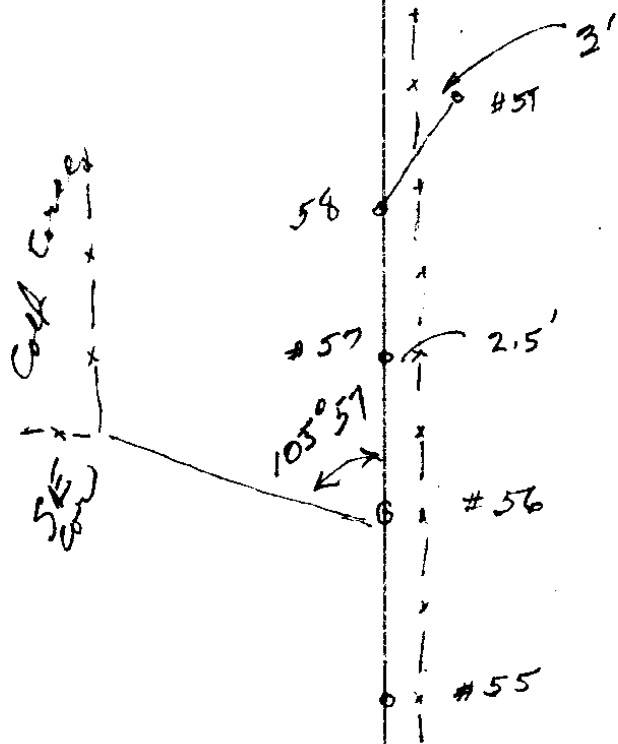

2.5 S & 2.5 W of Fence Cor.  
 + x + Oak Post 9' ft. East of Fence Cor.  
 2' S of Fence Cor.

C. S. File No. 6/44

#73  
-4°

143.5

143.1

N88°30'W

N88-13W ●

#72  
-14°40'

162.6

157.3<sup>1</sup> 0°00'

N86°30'W

N88-13W

#71  
-23°

181.2

166.8<sup>1</sup> 0°00'

West

N88-13W

#70  
-22°04'

114.0

105.4<sup>1</sup> 0°00'

N89°30'W

N88-13W

#69  
-18°34'

90.3

85.6<sup>1</sup> 87°20' Lt

West

N88-13W

#68

100°

N2°W

N0-53W ●

#67  
+18°

62.9

59.8<sup>1</sup>

N0-30E

N0-53W

#66  
+19°

111.8

105.7 0°00'

North

N0-53W

#65  
+18°30'

159.6

151.4<sup>1</sup> 1°01' Rt.

N0°10W

N1-54W

64  
167.8

+16°30'

160.9<sup>1</sup> L1°07'

N0°30W

N0-47W ●

#63  
+6°25'

173°

171.9<sup>1</sup> R1°36'

N1°W

N2-23W

#62

Cont of 40 Is.

63

62  
C. S. File No.

6/44

#83				
	300.0 300.0 21.8 <u>21.5</u>	47°51' LT	554° N	553-20 W ●
#82				
	316.4	9°52' RE	N 80° W	N 78-49 W
#81				
-14°45'				
149.2	144.3	2°00' LT	S 89° W	N 88-41 W
#80				
-11°15'				
113.6	111.4	3°13' LT	N 87° W	N 86-41 W
#79				
+6°50'				
241.4	239.7	7°59' RE	N 83°30' W	N 83-28 W
#78				
300.0°0°45'	325.6	26°12' RE	N 89° W	S 88-33 W ●
1/4 Cor				
	45.7	1°18' Lt	S 58°30' W	S 62-21 W
#76				
	173.1	7°49' Lt	S 64°30' W	S 63-39 W
#75				
-19°30'				
74.1	69.8	1°08' Lt	S 74° W	S 71-28 W
#75				
-11°20'				
86.0	84.3	19°11' Lt	S 71°45' W	S 72-36 W ●
#74				
-14°				
240.0	232.9	0°00'	N 89° W	N 88-13 W
#73				

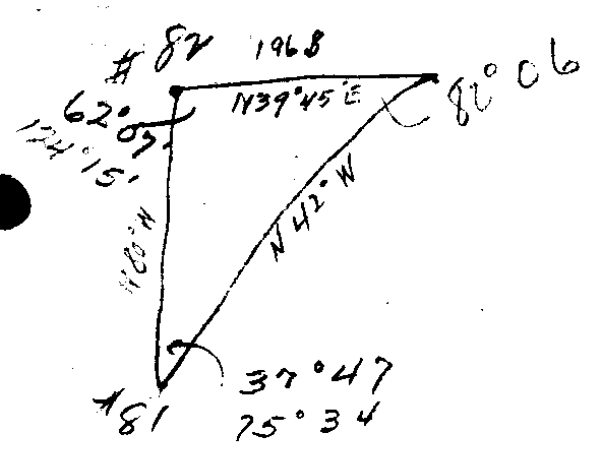

#82 Edgewater

1/4 Cor 27 & 34

W. Oaks 46°30' W 8" 13.9 ft.

W " N4°00' W 6" 12.7 ft.

C. S. File No. 6/44

#3

0°46' RE

S82° W 582-02 W

#92 = 4

82.7 71°12' RE

S83° N 581-16 W

#91

487.2 2°10' RE

S10°30' W 510-04 W

-90

493.2 37°21' RE

S7° N 57-54 W

#89

-4°25'

300.0

#88

280.2

880.2

30°23' RE

S30° E 529-31 E

+7°20'

202.4

#87

200.7 68°44' L

S59°30' E 560-00 E

+31°50'

77.4

#86

+15°20'

65.7 16°58' RE

S8°45' W 58-44 N

77.8

75.0 8°57' RE

S12°30' E 58-14 E

#85

+15°00'

81.2

78.4 97°58' L

S18°30' E 517-11 E

#84

119.2

119.2 27°27' RE

S79° W 580-47 W

#83



A1

Time  $\pm 3:40:30''$   
HOV  $3^{\circ}14' Lt$   
VcY  $43^{\circ}17'$   
Needle  $S 80^{\circ} W$

A92

Time  $\pm 3:41:10''$   
HOV  $2^{\circ}23' Lt$   
VcY  $43^{\circ}40'$   
Needle  $S 80^{\circ} W$

#91 - 2' So. on line of fence Cor

#90 - 9' E Fence

#88 - 1' NE Fence

#87 2' N. of Cor fence

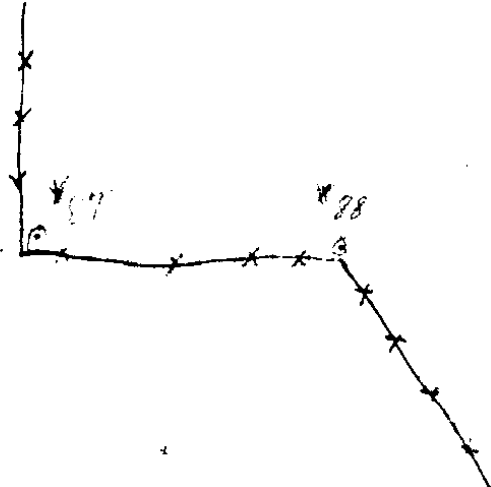

#85 Iron pipe

#84 3' East of Fence - 509. 13. 11. 12

C. S. File No. 6/44

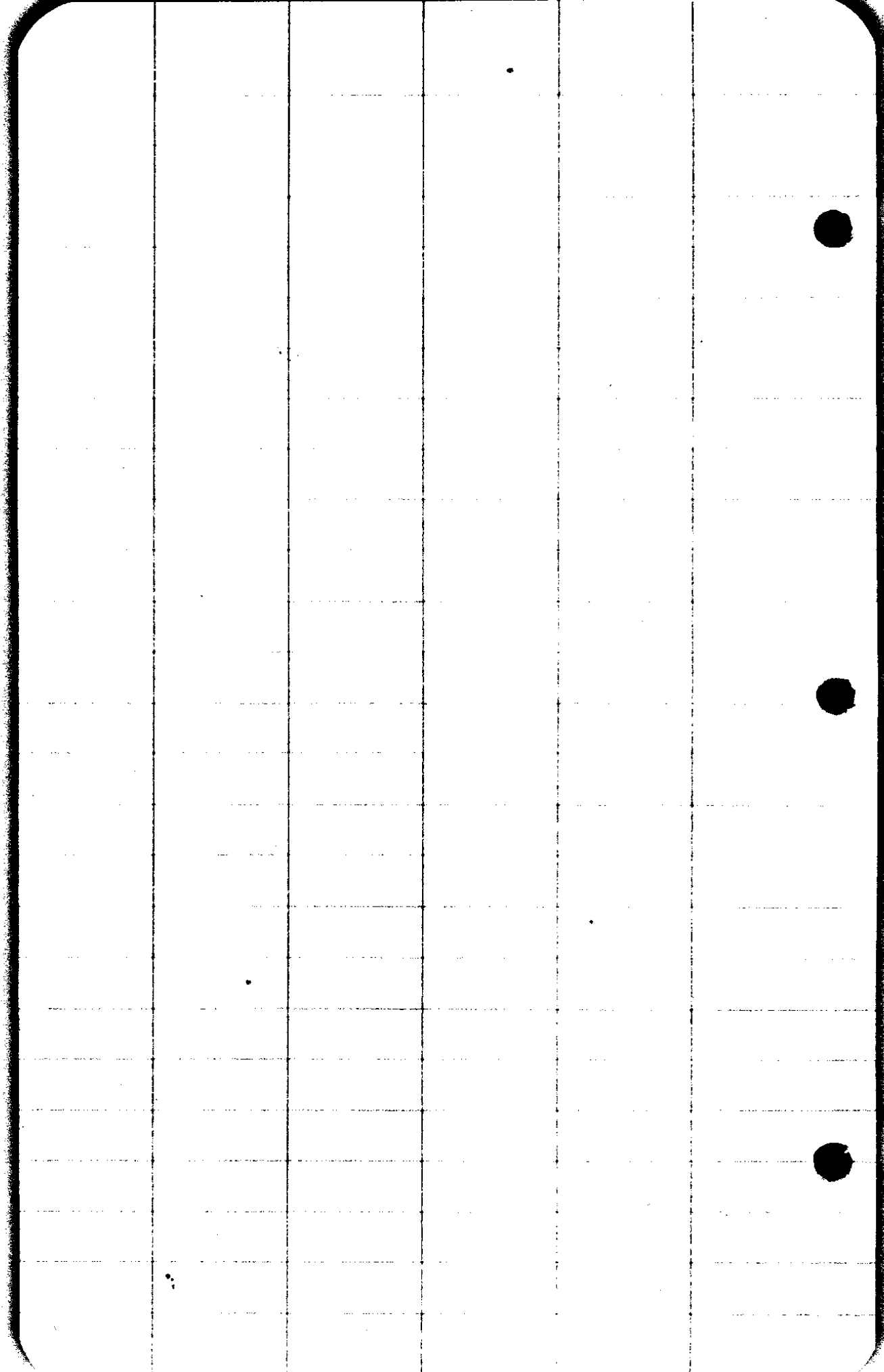

C. S. File No. 6/44

10A	54.0 200.0 300.0		West	West
9A	50.1 300.0	16°22' Rt	S 75°30' W	S 73-38 W
8A -16°30'	195.1 203.5	69°20' Rt.	S 5°30' W	S 4-18 W
7A -13°20'	257.4 264.5	0°00'	S 5° W	S 4-18 W
6A -10°15'	180.5 183.4	0°00'	S 7° W	S 4-18 W
5A	196.9	0°00'	S 9°30' W	S 4-18 W
4A -5°00'	298.9 80.5 379.4	7°49' Lt	S 17° W	S 12-07 W
3A	954.9	0°45' Rt	S 14°30' W	S 11-22 W
2A	53.3	78°05' Lt		S 89-27 W
1A Low	34.9	1°15' Lt		N 89-18 W
1A +5°30'	298.6 66.0 384.6		N 89° W	West
#53		16°58' Lt		N 73°52' W
#54				

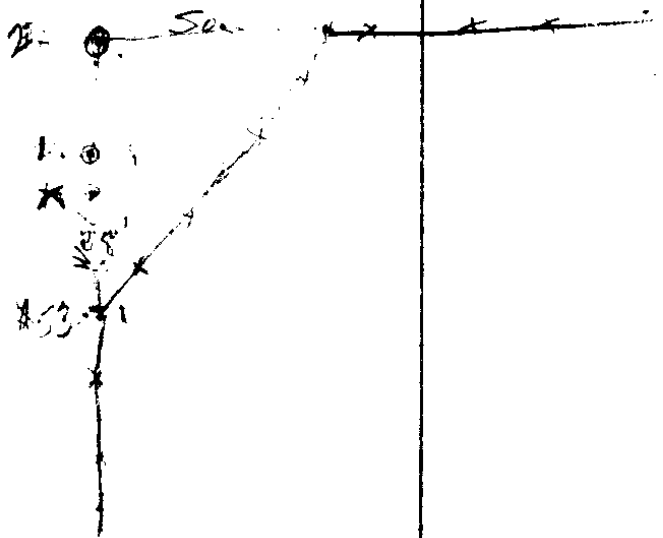

C. S. File No. 6/44



Curry Estate,  
Deed for South Tract of Land lying East of the Road.

Beginning at the N.E. Corner of the Way D.L.C. No. 51,  
in T 27 S, R 6 W, W.M. Douglas County, Oregon, Thence  
S 0° 46' E, 2590.1 feet to the S.W. Corner of D.L.C.  
No. 45, thence S 89°54'E 2642.7 feet to the S.E. Corner  
of B.L.C. No. 45, thence North on D.L.C. Line 583.6 feet,  
thence N 89° 48'E 656.0 feet, to the NE Corner of Lot  
3, of Section 2 in T 27 S, R 6 W, W.M., thence N 0°22'W  
5,330.9 feet, thence S 89°23'W 2,675.3 feet to the SW Cor.  
of the SE $\frac{1}{4}$  of the NE $\frac{1}{4}$  of Sec. 34, T 26S, R 6 W, W.M.,  
thence N 89°22'W 53.3 feet, thence S 11°49'W 920.4 feet,  
thence S 17°38'W 374.6 feet, thence S 4°38'W 771.9 feet,  
thence S 74°14'W 349.3 feet, thence West 1319.0 feet,  
thence S 86°02'W 781.5 feet to the County Road, thence  
S 19°19'E 1173.4, to the North line of D.L.C. No. 51,  
thence N 89°32'E 1839.1 feet to the place of beginning  
containing 478.9 acres more or less.

Curry Estate

Deed for North Tract of Land Lying East of the Road

Beginning at the 1/4 corner between Sections 34 and 27,  
Twp 26 S, R 6 W, W.M., Douglas County, Oregon thence West  
1121.7 feet to the North Umpqua River thence downstream  
along the river S 60°11'W 570.7 feet, and N 48°32'W 191.8  
feet, thence S 11°35'E 224.0 feet, ~~thence S 59°53'E 210.0~~  
~~feet~~ to an iron pipe, thence S 59°53'E 210.0  
feet, thence S 29°32'E 1178.3 feet, thence S 7°59'W 978.2  
feet, thence S 81°06'W 1281.6 feet to the County Road,  
thence following the County Road S 19°19'E 2291.8 feet,  
thence N 86°02'E 781.5 feet, thence East 1319.0 feet,  
thence N 74°14'E 349.3 feet, thence N 4°38'E 771.9 feet,  
thence N 17°38'E 374.6 feet, thence N 11°49'E 920.4 feet,  
thence S 89°22'E 53.3 feet, to the SW Corner of the  
SE $\frac{1}{4}$  of the NE $\frac{1}{4}$  of Sec. 34, T 26 S, R 6 W, W.M., thence  
N 0°57'W 2621.3 feet, thence West 1224.9 feet to the  
place of beginning containing 293.4 acres more or less.

CS FILE FOLDER

CONTAINS

MORE

INFORMATION