

MAP OF
DIVERSION POINT
of
WATER APPLIED FOR.

By J. M. THOMPSON

Camas Valley, Ore Dec. 31 1920

Scale 1 inch to 40 Ch's

Surveyors Certificate

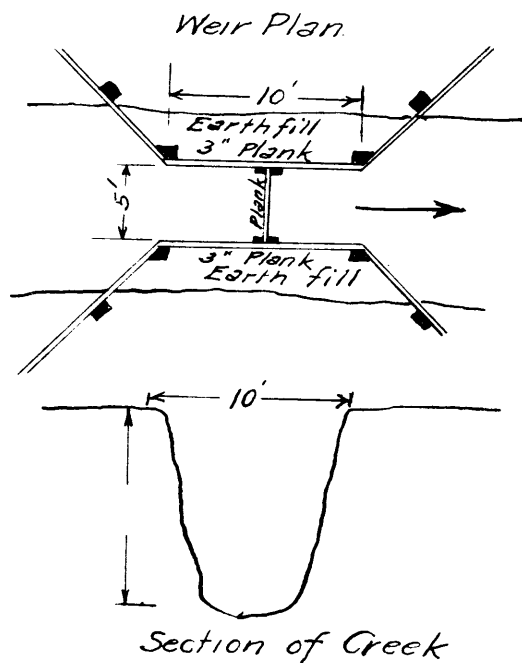
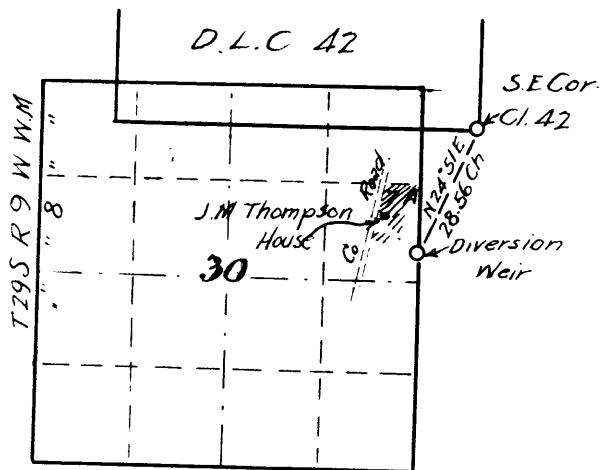

I. F. C. Frear of Roseburg Ore. do hereby certify that this map was made from notes taken during an actual Survey made under my immediate Supervision on., Dec 30 1920 and that it Correctly represents the works described in the accompanying application, together with the location of the streams in the immediate vicinity.

F. C. Frear.