

~~C. L. File No. 6/4~~

OCT 25-1926

Drake.

C. Gray
F.C. Drake
G.A. Naas

Time 3
Wor
Vur
Nudle

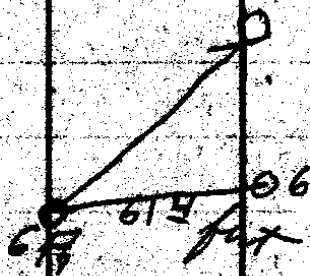

Δ 7
1016
1-616 WDA.

3° 01' to Right let Pt on line

Δ 6
26
495.7

Δ 5
107.8
95.6

Δ 4
73.6
69.6

Δ 3
138
131.2

Δ 2
179.9
173.8

Δ 1

61.4 East

31.8 wht 10 East of line

22.4
9.4

25.6 East

22.4 East

13.5 East

318.9

505.5

1-3-37

4-8-N

06039

52.808

22.248

50.552

North

C. S. File No.

6/4

Frank D rake

set on # 6 Hub. B.S. to # 5 hub
sight M.P. on River Bank.

$51^{\circ}10'R$

Mag. $S1^{\circ}10'E$
 $S48'W$ $S50'W$

C. S. File No. 6/4

①

Survey For Frank Drake
Legal Survey. Nov. 28-21

From old B.T.s I reset $\frac{1}{4}$ cor
bet. $\frac{21}{28}$. according to distances
from B.T. Set 1" I.P. for cor.

0 24" B.O. Bears N41°W 34½ links
8" W.O. " S 38°E 112 links

Set in Presence.

H.M. Ootman.

Frank Drake

Jim Dunnivan

Jack Black.

Thence from this cor I run

W. Var 21° 15' (No sun)

Sta	H.A	V. A	S. Dist	Mag.	CC.
1		18° 10'	224 ^E	S 89° W	S 89° W
2	2° 13' R	0°	170 ⁹		N 83° 43' W
3	1° 05' R	24° 15'	288 ⁵	S 87° 35' W	N 87° 42' W
4	9° 05' L	13° 20'	242 ⁷	S 83° W	S 83° 13' W
		0			
Triony. Base	77° 41' R	0	186 ⁰	N 18° 45' W	N 19° 06' W
4-5	18° 59' R	0	523.7		N 72° 48' W

(3) Frank Drake 21-29-S

B.S. /	H. I.A.	V. A.		N 77° 25' W	N 77° 48' W
5	8° 06' L	20° 30'	230 ⁶	N 85° 30' W	N 85° 50' W
6	34° 32' L	22° 50'	268 ⁸	S 60° W	S 59° 34' W
	24° 41' R	28° 50'	291 ⁶	S 84° 30' W	S 84° 15' W
	0° 11' L	29° 30'	65 [?]		S 84° 00' W
^{TO 21 21} _{20 29}	32° 40' R	0	47 ⁸		N 63° 16' W

Length = 2176² ft. Bear. S 89° 17' W

Cor. consisted of stk and Pile Rocks

2 old B.T. Found - (one on ground, other

cut out and rotten. Position of stake

checked with Field Notes, so I set 1'

I.P. for Cor. set ²⁰⁻²¹/₂₀₋₂₉ Marked New B.T.

12" Fil S 83° 30' W 7² ft

18" " S 15° W 15² ft

12" " S 63° E 17⁰

12' " N 35° 30' E 34²

Same party present as at
setting 1/4 cor.

④

216⁰ ✓

~~2482~~ ✓

2554 ✓

57' ✓

478 ✓

C. S. File No. 6/4

⑤ Frank Drake

21 T 29-5

Fog - & Rain

Went to Sec Cor 20-21-16-17

Found 1 B.T. a 36' Pine N45° E

Other B.Ts gone. Set $\frac{3}{4}$ " I.P. for

Cor 55' from B.T. S45° E P. or

Mound Rocks around Cor.

30" Pine S3°30' W 100' ft

36" Pipe N5°30' W 252' ft

30' Pine N45° E 55'

Mound Rocks S49° E 36'

witness: Frank Drake
 Tim Purman
 Jack Blais

Sec Cor	H.A.	V.A	S. Dist	Mag	
1.	0	6°15'	223°		Fast
2	0	8°00'	253°		"
	0	14°30'	120 ¹	N89°15' E	N89°15' E
		21°00'	299°		
3.		11°00'	186 ⁵		
	35°28' R	16°30'	300°	S51° E	S50°32' E
4		0	128 ⁹		
	120°59' L	9°10'	285 ⁸	N4° E	N4°29' E
5					
A-6		0	1440.4		N78°30' E

N

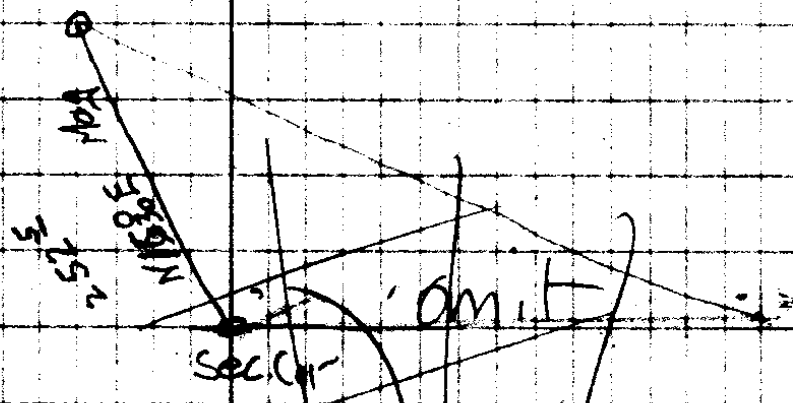

227.7
251.3

OSI

76° 35' 30"
153° 12' 30"
229° 50' 0"

116.3
279.3

STK 183.4
out of hill

189° 26'
94° 43'

287.6) 416.5
128.9

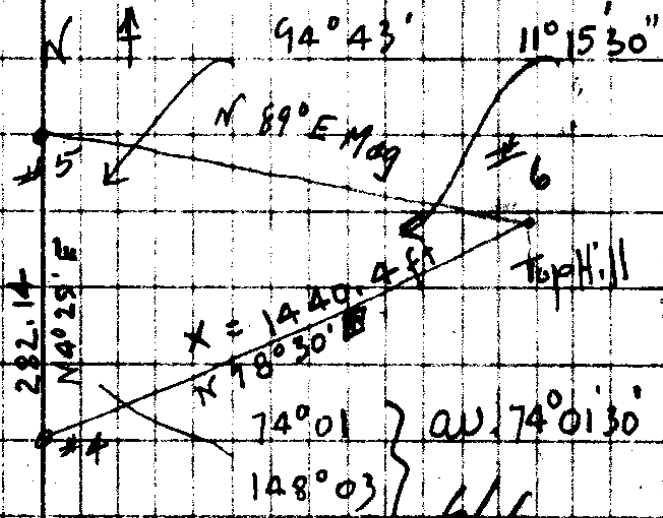

282.24

$$\frac{282.14}{\sin 94^{\circ} 43'} = \frac{x}{\sin 11^{\circ} 15' 30''}$$

" 85° 17'

x = 1440.4 ft
N 89° E Mag
N 78° 30' E
74° 01'
148° 03'

av. 74° 01' 30"

G. S. File No. 6/4

8

C. S. File No. 6/4

⑥ Frank Drake - 29-5W

V.A

6-4				N77°E	N78°30'E
	24°36'R	16°	118 ²	S78°30'E	S76°54'E
7					
	36°36'L	10°30'	295 ³	N65°E	N66°30'E
8					
	27°15'R	6°	130 ³	S88°E	S86°15'E
9					
	4°12'L	16°0'	155 ³	N88°E	N89°33'E
10					
	35°05'R	22°20'	82 ⁸	S57°30'E	S55°22'E
11					
	27°36'R	23°0'	175 ⁴	S29°30'E	S27°46'E
12					
	51°29'L	11°30'	65 ²	S81°E	S79°15'E
13					
	9°48'L	29°45'	144 ⁹	N89°E	S89°03'E
14					
	11°28'L	34°30'	298 ⁴	N77°E	N79°29'E
15					
	13°31'R	32°0'	297 ²	East	S87°06'E
16					
	1°58'L	18°30'	197 ⁰	N89°E	S88°48'E
17					
	0	10°	65 ⁹	"	"

6 - Top hill

114 ¹/₂

290 ⁴/₂

129 ⁶/₂

149 ³/₂

76 ⁶/₂

161 ⁵/₂ ✓

64 ⁴/₂

125 ⁸/₂

245 ¹/₂

252, 3

{ 186 ⁸/₂ ✓
65 ⁹/₂

Note. Could find No Evidence of ¹/₄ cor. between 21 & 16. Frank Drake, Jack Black, Jesse Davenport Myself. Looked ¹/₂ day for corner. So I ran on East To sec. corner.

Frank Drake 21-29-5
 (11)

					S 88° 58' E
18	4° 05' L	17° 30'	224 ⁵	N 84° E	N 86° 57' E
19	11° 40' R	28° 0'	209 ³	S 83° 30' E	S 81° 23' E
20	26° 02' R	4° 30'	87° 0'	S 57° E	S 55° 21' E
21	15° 50' L	10° 0'	67 ²	S 73° E	S 71° 01' E
22	22° 10' L	3° 0'	140 ⁴	N 85° E	N 86° 39' E

Sec. Cor. ¹⁵⁻¹⁶ 21-22 Set cor. from 10" Pine B.T.

49⁵ ft S 5° W. Put in 1/2" I.P.

Set 16 6" Fir. N 78° W 30° ft

22 12" " S 86° E 31°

21 12" Pine S 5° W 49⁵ old B.T.

No other suitable trees

Witness Frank Drake, Jesse Davenport
 GG Stewart Dep.

12

214.1

184.8

86⁷

66²

139⁸

C. S. File No.

6/4

Front Drake in 29 S 5 W

(13)

accor
#1 top

H.A. V.A. S. Dist Mag C.C
20° 135⁵ S 95° W N 46° 41' E

42° 19' L 16° 20' 198⁶ S 2° 30' W N 4° 22' E

10 25' R 0 139⁸ S 4° W N 5° 47' E

8° 43' L 14° 30' 99² S 5° E N 2° 56' W

18

18-19 78° 27' L 28° S 83° 30' E S 81° 23' E

19 Traverse from SEC. COR

15-16-21-22 To old line

(Backed in) See Trav. sheets

Weather Heavy Rain.
DEC. 1-21

Makes Bearing Sec line bet $\frac{16}{21}$

N 82° 11' E Length 4912⁰ ft.

Set $\frac{1}{16}$ cor. on this true line

1228 ft from sec. cor - $\frac{3}{4}$ " I.P.

18" W.O. S 18° E 40⁰ ft

10" W.O. N 26° W 56⁰ ft

(14)

H. Dist

127.3

1906

1392

972
hub on old line.

From old line hub to old line hub ahead

C. S. File No. 6/4

(15)

Frank Drake

Site #5

N 72° 04' E

Set on 1/6	114° 24' R	12° 0'	224 ⁶	S 5° 45' W	S 6° 28' W
------------	------------	--------	------------------	------------	------------

1

	2° 57' L	20° 30'	132 ⁶	S 4° 30' W	S 3° 29' W
--	----------	---------	------------------	------------	------------

2

	2° 06' L	13° 30'	181 ⁴	S 1° 45' W	S 1° 23' W
--	----------	---------	------------------	------------	------------

3

	44° 08' R	2° 30'	133 ⁴	S 46° W	S 45° 31' W
--	-----------	--------	------------------	---------	-------------

4

	41° 06' L			S 6° W	S 4° 25' W
--	-----------	--	--	--------	------------

5

S 45° 31' W

4

	23° 06' R	2° 40'	300 ⁰	S 70° W	S 68° 36' W
--	-----------	--------	------------------	---------	-------------

5

	0		54 ²		
--	---	--	-----------------	--	--

S 7° 09' 40" E

6

	16° 03' L	3° 40'	279 ⁰	S 18° 30' E	S 17° 13' E
--	-----------	--------	------------------	-------------	-------------

7

	0°	4° 0'	299 ⁶	S 19° E	"
--	----	-------	------------------	---------	---

8

	0		212 ⁸		
--	---	--	------------------	--	--

219 ²/₂

124 ¹⁴/₁₄

176 ¹⁴/₁₄

133 ¹³/₁₃

$$x = \frac{353.9 \times 9883}{.0972} = 3416.2$$

S 40° 35' W
3416.2

299 ⁷/₅₄
353.9

Bot. hill

278 ⁵/₅

298 ⁹/₂₁₂
11.7

#7. Top
140 ²/₂

R.R. Track

50

50. Amp

5° 34' 40"

S 10° 09' 40" E

110° 15'

220° 28'

Average =

110° 14' 20"

S 68° 34' W
3539

64° 11'

128° 2'

Rev. 64° 12'

Average 64° 11'

8

S 17° 13' E

9

~~134° 56' L~~
~~224° 53' L~~

18° 30'

83 ³/₄

N 7° E

N 27° 51' E

10

66° 56' R

24°

S 87° E

S 85° 13' E

Equation in angles ~~at~~ 2° 29'

To set M.P. No. side S. Imp.
on $\frac{1}{16}$ line. The $\frac{1}{16}$ cor comes into
RIVER

Set at #3 hub. B.S. to #2.

S 87° 42' R

Must run 441' West of #3. To be
on line

Turn L at 2° 18'

S 89° 17' W Bear sec. line
N 87° 42' W

3° 01' Left

+ 41'

160' Eft V.A. 16° H.D. = 163° ft set M.P.

278.1 E of $\frac{1}{16}$ cor

Bearing ~~90°~~ S 17° 17' W. Turn Left, set

M.P. 23 ³/₄ ft So.

Needle Bear. N. Sun.

Then I run North (Independent traverse)

7° 00'

300°

North

6°

155 ³/₄

90° L

17° 50'

221 ⁷/₈

West

90° R

0

90°

North.

H. Dist

old Line hub 78⁹
Top hill - old line

Note. Tied into
hub # 3. on 1st line
run or on line on So
Side Sec. 21.

Computed length from this data.
= 4749.3 from No. line to So. Line
Center of sec. = 2374.6 ft. or
2374.6 - 571.5 = 1803.1 from M.P. to
center of sec. or NE cor. of SW¹/₄ SW¹/₄.

approx. only. as the M.P. was set
571.5 ft due North of So. Sec. line.
Needle reading.

Making M.P. going No. 571.5 North
542⁰ ft. of ¹/₁₆ cor.
~~209.3~~

297⁵
154⁵

452.0
90.0 230.8

542.0 016
295

571.5 209.3

278'
209.

68.9

C. S. File No. 6/4

I Marked M.P. with Bolt
and piled rocks around it. Blazed

A 16" W.O. Bears S86°E 56°

1 24" B.O. " N14°W 50⁵ft

witness

Frank Drake

Jack Black

Jesse Davenport.

Frank Drake

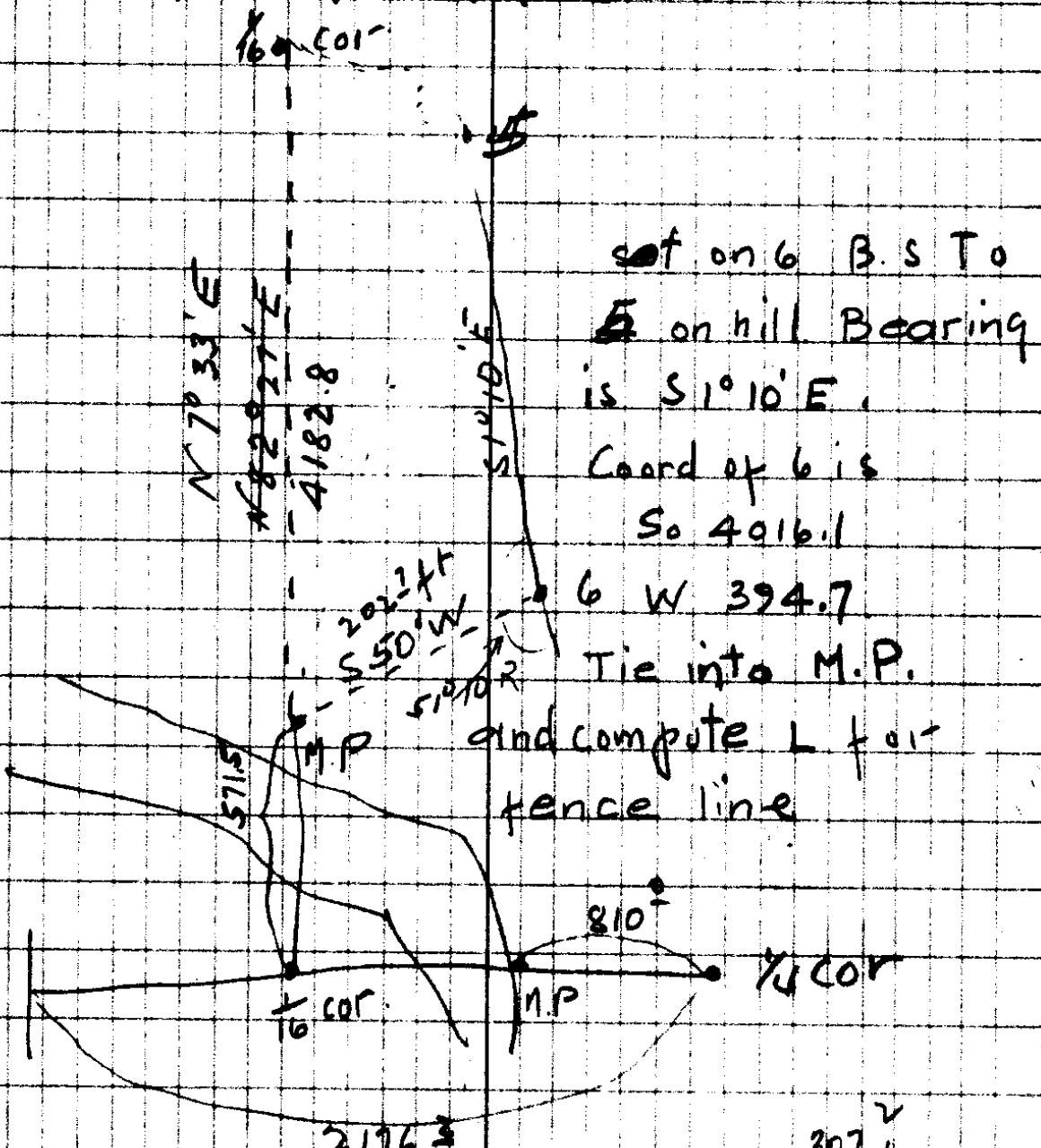

S 50° W

Lat: S 130.3

Dep W 155.3

4016.1
130.3

4146.4
550.0

394.7
155.3

550.0

Bearing Line = $82^{\circ} 27' E$

set M.P. side 6, Turn $82^{\circ} 27'$ left

C.S. File No. 6/1

307.2
66

184.32
184.32

202.752

568

~~3108~~
~~3108~~

~~167~~
~~874~~

~~668~~
~~1169~~
~~1336~~

~~1459~~

5
①

~~275~~
~~62~~
~~1650~~
~~1650~~
~~18150~~



~~217~~
~~874~~
~~1288~~
~~1694~~
~~185288~~

~~18~~
~~80~~
~~1460~~
~~160~~
~~1414~~
~~1744~~

300
~~2259~~

230

2210

N 60° W

~~838~~
~~1768~~
~~663~~
~~1768~~
~~185148~~
~~1815~~
~~31~~

~~874~~
~~170~~
~~6128~~
~~874~~
~~148288~~

~~7060~~
~~462~~
~~4460~~
~~16~~



~~48~~
~~93~~
~~444~~
~~482~~
~~4264~~

B.O. Δ 83° W 342 ft.
28" diam. MR Co. cl 37

June Best.

Gas for us + J. D. Wright,
Wright's So. Pine.

~~163~~
~~74.3~~
~~88.7~~

N 86° 06' W

~~14130~~
~~360~~
~~22736~~
~~180~~

~~141330~~
~~8606~~
~~22736~~
~~180~~
~~1736~~