

T 28 31825 ans

M Freeman Cl 49.

at pt 150 ch W y 1/4 Sec just

25 & 26. 9.30.24 on 35° W 392

39.38 x line bet 23 & 26. 2.07 W

of sec 23-24-25-26.

42. Enter prairie.

68.75 B.O. 26" S 60° W 820

W 3500 enter creek bet

3880 Looking glass creek.

55.4 Begin ascend hill

77.23 x line bet 23 & 22, 1150

ch. 9 y 1/4 cor.

80.56 just. 20" faunel S 60° E

30 Bank.

South. Begin to descend steep hill

8" enter bet.

14.4 Looking glass creek

20.2 a 12" B.O. N 34° E 88 chs

East.

3.27 x line 22 & 23, 5.50 N y

sec. cor of 22.

40.2 enter prairie

48.2 a W.O. 14 N 29° E 54

Freeman's house S 65° W 20 ch

South

805 X line bet 23 + 26
1585 E of 1/4 just
20

48.75. set just, W.O 9" N85°E 76
East

10° enter prairie, a curve
32.22 To top

1/4 bet 23 + 26.

40.27. W.O 6" S60°E 30

" " 13" N65°W 18

14-15-22-23

10" B.O. S53°E 50

8 " S25°W 38

" 20" W.O. N63°W 200

6" W.O. N27°E 33

1/4 bet 22 + 23

40° 20" B.O. S77°E 80

24" " S85°W 185

1/4 25 + 26. 10" B.O. S11°W 125

8" " N40°E 75

825

495

1529

1696

1153

$$\begin{array}{r}
 2943 \\
 1763 \\
 \hline
 1213
 \end{array}$$

155

$$\begin{array}{r}
 23920 \\
 1417 \\
 \hline
 903
 \end{array}$$

50 5/25

①

Went to Inner L cor.
C1 49.

Set From O.B.T. Hat calls for
N 29° E + is N 29° W.

Drove I. ~~Side~~

(Rec)

Marked a 10' 13.0 S 83 1/2° E 197 ft
N 29° W O.B.T. 18" W O 35 1/2 ft

Cor

140°

300°
210°

Nov 2030

West

1°

20° 34' R

300°
300°

N 69° 30' W N 69° 26' W

2

0° 40' R

600°

N 69° W

N 68° 46' W

3

5° 40' R

600°
300°
330°

N 60° 20' W

N 63° 06' W

4

34° 36' L

333°

S 82° W

S 82° 48' W

5

24° 30' L

600°
124°

S 57 1/2° W

S 57° 41' W

6

28° 35' L

245°

S 29° W

S 29° 06' W

7

{ 291' #1
2-10³

N 31° E 17' H

P.C. 1235+00 C Bay Highway

600R

C.S. 5/25

②

S29°06'W

7

33°57' L

130

75°

55 1/2° E

S4°51'E

Cor.

Cl. 49

SW of T L

Rec

Get Pointed Rock for Cor.

from O. B. T. badly rotted

Marked a 12" Fir N75 1/2° E 33' ±

12" Fir N32° E 64 1/2' ±

Johnston, R. L. Swan, D. (Ingram)

73'

51
18

73

139
745
645

C.S. $\frac{5}{25}$

$$\begin{array}{r} 913 \\ \hline 157 \\ \hline 248 \\ \hline 265 \\ \hline 513 \end{array}$$

$$\begin{array}{r} 5412 \\ \hline 2485 \\ \hline 2927 \end{array}$$

$$\begin{array}{r} 412 \\ \hline 13 \\ \hline 27 \end{array}$$

C.S. $\frac{5}{25}$

④ Corners not recorded

T 28 S R 7. May 1 - 1922

Found O.B.'s for 23-24-25-26

set I.P. Marked

8" B.O	N 42° 15' W	36 ²	23
6" W.O	S 54° W	32 ⁵	
8" W.O	S 41° E	27 ⁵	

W.G. Johnston; R.W. Swan; D.C. Ingram witness

207 used
Cor

1		14°	147 ⁴	North	N 0° 46' W
2	2° 34' R	~	201 ⁰	N 2 3/4 E	N 1° 48' E
3	3° 20' L	6°	156 ⁹	N 0° 15' W	N 1° 32' W
4	1° 0' R	3°	213 ⁵	N 45° E	N 0° 50' E
5	2° 22' R	13° 14 1/2°	300 ⁰ 175 ² 5 ⁰	N 1° 50' E	N 1° 50' E
6	7° 01' L	10° 1/2	212 ⁶	N 5 1/2 W	N 5° 11 W
	5° 40' R	Top hill -	94 ⁸	N	N 0° 29' E
7					

176¹²
145
21

158
125
32

~~177
129
28.5~~

143⁰

201⁰

~~156⁰~~

~~500
47
594~~

~~213⁰~~

292.3 ✓
170.1 ✓

209¹ ✓

94²

C.S. 5/25

⑤

7

3°03' R

9°

154 ⁸/₉

N 0° 29' E

N 3° 32' E

8

10° 45' R

9°

171 ⁷/₂₁

N 14 1/2° E

N 14° 17' E

9

23° 20' L

17 1/2

121 ²/₂

N 9° 03' W ✓

10

COV

33 W
65

Set NE cor. D.L.C. # 49.

Set from intersection of East line
of Cl. + ~~fraction~~ var. 21° 15'

a 36" W.O. Remains of Tree
bears S 60° W 5594 ft.

Mr. W.S. Johnston stated that 29 yrs
ago this Tree was marked.

Set I. Bar.

Marked 12" W.O. S 65° W 152 ft
6" B.O. N 77 1/2° E

(TR)

W.S. Johnston - R.L. Swan

D.C. Ingram

I 30 S R

Found O.B.T for 1/4 bet 21-212
of 20' B.O. Remarked it.
Set I. Pipe 234³ ft S 20°E from
this tree

115³

118⁰ @ 25'

~~234
106
127.8
117.2~~

Prove I Pipe 6" below Ground
Marked a 8' Prune Tree S 71¹/₂° W 14² ft
20' B.O. N 20° W 234³ ft
8' Prune Tree N 62° E 31⁰ ft

A. L. Dubell

Walter Gregory Witness

10
4
752
152
152
2400

Can
Hanging
off

8
6
5
4
3
2
1

C.S. 5/25

⑥

1/4 Cor

$$\begin{array}{r}
 202 \\
 60 \\
 \hline
 1212 \\
 1212 \\
 \hline
 1732
 \end{array}$$

$$\begin{array}{r}
 300 \\
 16 \\
 \hline
 136
 \end{array}$$

$$\begin{array}{r}
 829^{\circ} \\
 \hline
 900^{\circ}
 \end{array}$$

Var 21° 15
West

1

0° 0'

461⁹ 588° W

2

$$\begin{array}{r}
 362 \\
 16 \\
 \hline
 18 \\
 216 \\
 \hline
 36 \\
 594
 \end{array}$$

Solar ~~89° 10' E~~
S 89° 10' W

Var = $\frac{21^{\circ} 15' E}{20^{\circ} 08'}$
Var = 22° 33'

12909 S 89° 10' W .0145'

0145

64545
51636

12909
1871805

SW corner 48.

10" B.O. $\eta 70^{\circ} W$ 77 lbs

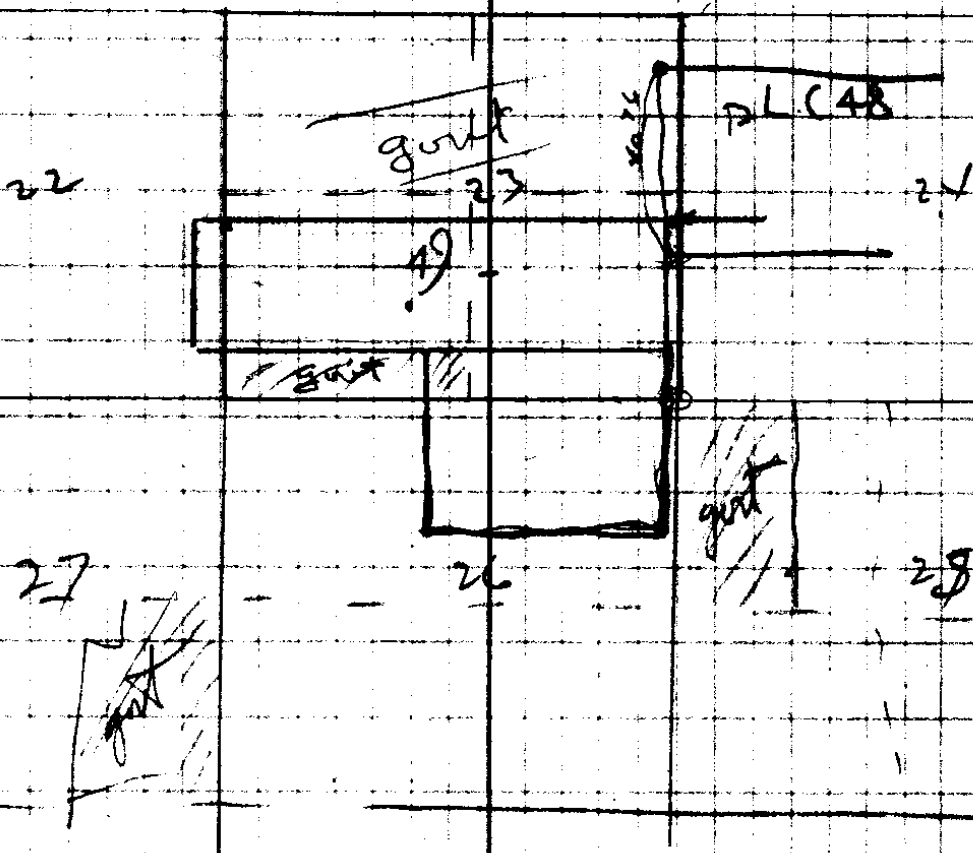

C.S. 5/25

⑦

300
122

177.3

1625
24

38.5

S 30° W

23-26 (1/4) - 22-23

14-15-22-23 10' B.O. S43°E 50'
8' B.O. S25°W 38: W.O. 20' N63°W 200

22-23-26-27. 18" W.O. S23°E 95: B.O. 18"
S44°W 160: 10" B.O. N33°W: 102 lbs: 30" B.O.
N65°E 104 lbs.

23-24-25-26 W.O. 16" S10°E 144. W.O. 14"
N80°E 186: 16" N14°W 202: 18" S73°W 62
$$\begin{array}{r} 66 \\ 116 \\ \hline 122.76 \end{array}$$
$$\begin{array}{r} 66 \\ 372 \\ \hline 438 \\ \hline 40.42 \end{array}$$

15-16-21-22 B.O. 24" N45°W 75
14" B.O. S14°W 32 lbs: B.O. 36" N49°E 128
B.O. 8' S29°E 125 lbs

1/4 lot 23-26. 40²⁷ W.O. 6' S60°E 30 lbs
13' N65°W 18 lbs.

1/4 22-23. B.O. 20" S77°E 80
" 24" S85°W 185

C.S. 5/25

(8)

21-22-27-28

U.O. 36" N 68° W 255

B.O. 28" S 46° E 207

" 12" N 70° E 138

100

91 ³/₅

" 22-27 U.O. 20" N 30° W 160

" " S 5° E 1150

Remarks

22-23-26-27.

Dump pile for 150

a.s. 3/25

⑨

T 28 S R 7 W

Oct 19 - 1922

Went to 1/4 cor bet 25 & 26
set I.P. from O.B.T.

Remarked O.B.T. 18" B.O S 11° W 82⁵
12" W.O N 34° E 5⁰ ft.

~~Footnote~~ Cor. Cl. 49 from O.B.T.

~~Set~~ I. Pipe as per Cl. B.T.

Marked 12" Fir S 41° W 33⁸ ft
O.B.T. 36" B.O N 35° W 258⁵

V. Johnson, M. Crocker witness

The 1/4 cor bears N 85 1/2° E 201⁵ @ 11° = 197⁵

Cl. Cor 49 (Below)	83	-	8°	N 7° W	N 8° 55' E
1	299 ²	11 1/2°			
2	59° 15' L	-	77 ⁶	N 51 1/2° W	N 50° 20' W
3	44° 31' R	-	514° 284 ²	N 6° 50' W	N 5° 49' W
4	17° 45' R	11° 50'	70 ⁷		N 11° 54' E
5	18° 28' L	15°	124 ⁸	N 7 1/2° W	N 6° 34' W
6	0° 56' W	-	300° 384	N 8 1/2° W	N 7° 30' W
7					

20
1985
2015

1
2
3
4
5
6
7
8
9
10
11
12
13
14
15
16
17
18
19
20

7
8
9
10
11
12
13
14
15
16
17
18
19
20

2
3
4
5
6
7
8
9
10
11
12
13
14
15
16
17
18
19
20

141 @ 63
70 @ 15
46 @

67.6
46
140
~~25~~
258
20

8 }
2932 }

776

7982

692

1205

3384

C.S. 5/25

10

6

N7°30'W

28°08'R

-

231⁹

N19½°E

N20°38'E

7

2°04'L

176³

N18°E

N18°34'E

8

5°39'L

105⁻

N12°E

N12°55'E

9

9°49'L

3°

250⁶

N2½°E

N3°E

10

3°00'L

-

151⁵

N0°40'W

N0°06'E

11

0°19'L

166⁰

-

N0°13'W

12

old hub #1

0°33'L

Tie x Angle

N1°30'W

S 6°
N0°46'W

1

old

So Line Cl.

cord w ent to old cor site #1

S 10°

N8°55'E

90°41'R

3⁵

231⁶

N81°20'W

N80°24'W

1

7°42'L

5½°

300⁰

N89°05'W

N88°06'W

4½

300⁰

300⁰

2

9½

208⁵

43°32'R

N4½°E

A Side Line To L cor

231⁹

299⁶
68
231⁶

250³

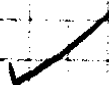

~~231²~~

~~298⁶~~

~~300²~~

~~299¹~~

~~205⁶~~

~~1103⁵~~

C.S. 5/25

⑩ D. E. Ingram Legal Survey Oct 9-22

	✓	Along So. line Cl. 49			N88°06'W
Survey		12°01' L	4 1/2	229°	
			17°40	219°	S79°W 579°53'W
So. line	3				
	✓	10°26' R	17°	261°	N89°41'W
So. line					
		1°08' L	14°40'	116°	S88°4'W S89°11'W
	5	By approx SW cor Cl 49			
West line		9°34' R			
	6		19°40'	120°	N0°40'W N0°15'W
		2°03' R	25°1/4	75°	N1°48'E
West line	7		10 1/2	300° 297° 126°	
		2°37' L	9 40		N2°40'W N0°49'W
	8		7 1/2		
		1°19' R	6 3/4	218°	N0°30'E
	9				
		8°36' R	—	140°	N8 1/2°E N9°06'E
	10				
		13°33' L	10°40'	191°	N5 1/2°W N4°27'W
	11	top hill		35 1/4	
		1°16' R	—	285°	N3°11'W
	12				
		5°40' L	—	117°	N8°51'W
	13				
		11°01' R			N1 1/2°E N2°10'E ✓
	14				

~~133~~
 228
 213

3122
 19332
 19332
 2126.52

250

113

"L" cord 49

14

4039'

113
 68
 245
 288
 125

1440
 N 99° 14' 30" E
 N 30° 10' E
 V.A. = 5 1/2

216

140

11682

87° 53'
 175° 45' } 87° 52 1/2

188

87° 29'
 174° 57' } 87° 28 1/2

285

13-14
 sin 87° 28 1/2
 19903

11682
 sin 4039' = 1439 5/8

C.S. 5/55

(12)

R C Ingram

N2°10' E

14

77°30' L

N75° W N75°20' W

#15 on line run West

14

73°38'
147°10'

A

Set 16 site A

87°6' N71°31' W

44°28' L

579^b

S62° W S64° 01' W

1

11°22' L

529^f

S51° W S52° W

2 creek to No 100 yd

52°48' L 6⁴⁰

157^b

S1° E S0° 09' E

3 Cl. Cor S W

Flouse across West End Mou. belt 1° 09'

sat 7, site 1

S52°39' W

183°37' L

338⁸

N52° E N49° 02' E

4

82°48' L

300⁰
181⁰

N35° W N33° 46' W

5

25° 01' R

29° 40'

185⁰
196³

N9¹/₂ W N8° 45' W

6

~~1° 54' L~~

~~24³/₄ 41⁷~~

~~N10° 39' W~~

7

279
96
183

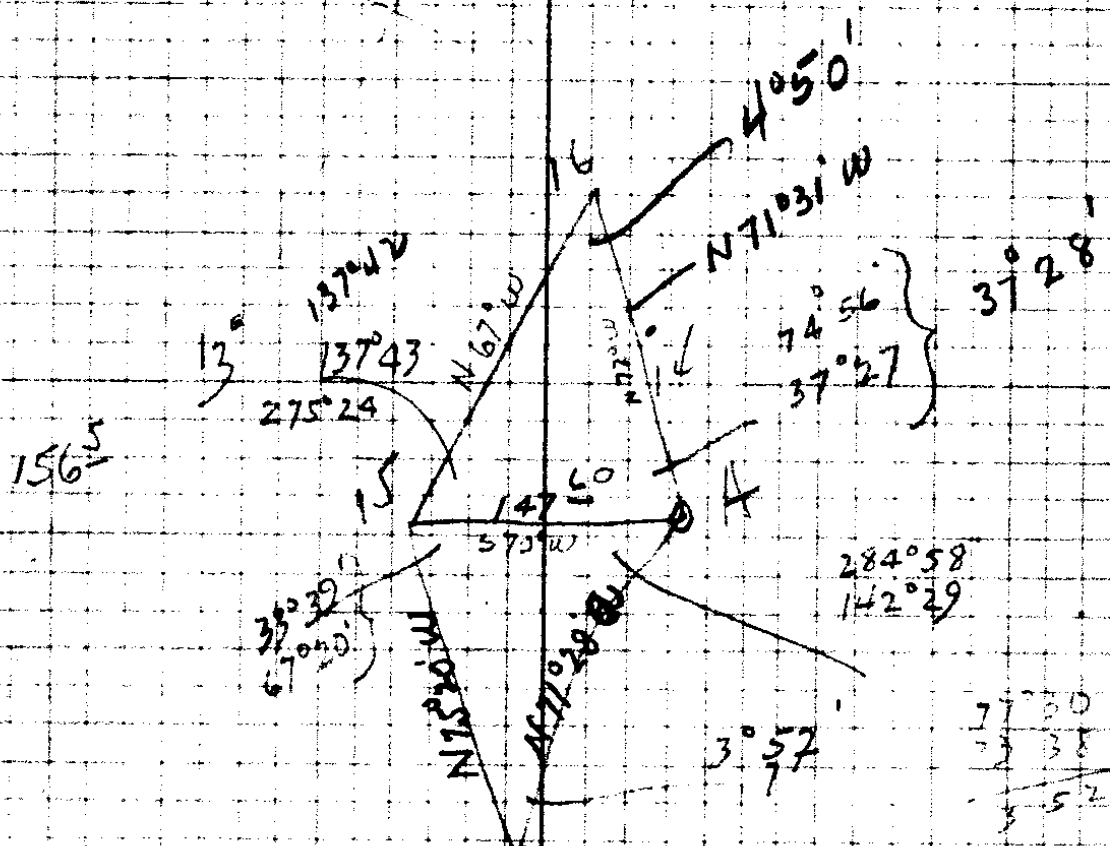

156.5

185.5
120.5

$$\frac{14-15}{\sin 33^{\circ} 39'} = \frac{147.6}{\sin 3^{\circ} 52'} = 1212.9 \checkmark$$

$$\frac{A-16}{\sin 42^{\circ} 18'} = \frac{147.6}{\sin 4^{\circ} 50'} = 1178.2 \checkmark$$

C.S. 5/25

(13)

D.C. Ingram Oct 17-22

7

~~11°07' 10' 35"~~

8

~~16°45' R 22 3/4 298~~

N 16°45' W

6

29°35' R 29 1/2 177 ⁶/₁₅ N 20° E N 70°56' E

7-8 4°11' L 25° 58" N 16° E N 16°39' E

cor

NW cor Cl. 49. Found Laurel BT
Rotted out, old line blaze checks.
Set I.P. Marked

16" B.O. N 86° E 9 8

18" B.O. N 8 1/2° W. 18 5

(R)

~~North line Cl. 49.~~

Set # 5 site 4

N 33° 46' W

99°54' R 772 ⁵/₁ N 65° E N 60°08' E

1

5°01' R 279 ¹/₁ N 70° E N 71°09' E

2

16°57' L 178 ²/₁ N 54°12' E

3

3°00' L 183 ¹/₁ N 50°4' E N 51°12' E

4

15 30

C.S. 3/25

14

4

6° 46' R

298°
70

N57° E

N51° 12' E
N57° 58' E

5

89° 55 }
44° 57 R }

S77° 04 1/2' E

A

Set 6 site 5

39° 42' L 20

144°

N59° E

S80° 48 1/2' E
N59° 30' E

7

13° 33' R

170°

N72° E

N73° 03' E

8

6° 29' R

288°

N79° 32' E

9

15° 58' L

170°

N63° E

N63° 34' E

10 N.E. Cor Cl 49

To Set SW cor Cl. Reg

Set #5 go

N 10° E
E 2°

= 3.856

9011² ft

N 14° 33' E

Marked

8" Fir

N 82 1/2° E

22° ft.

5" W.O.

N 71° W.

18³

W

S Johnston

W Innes

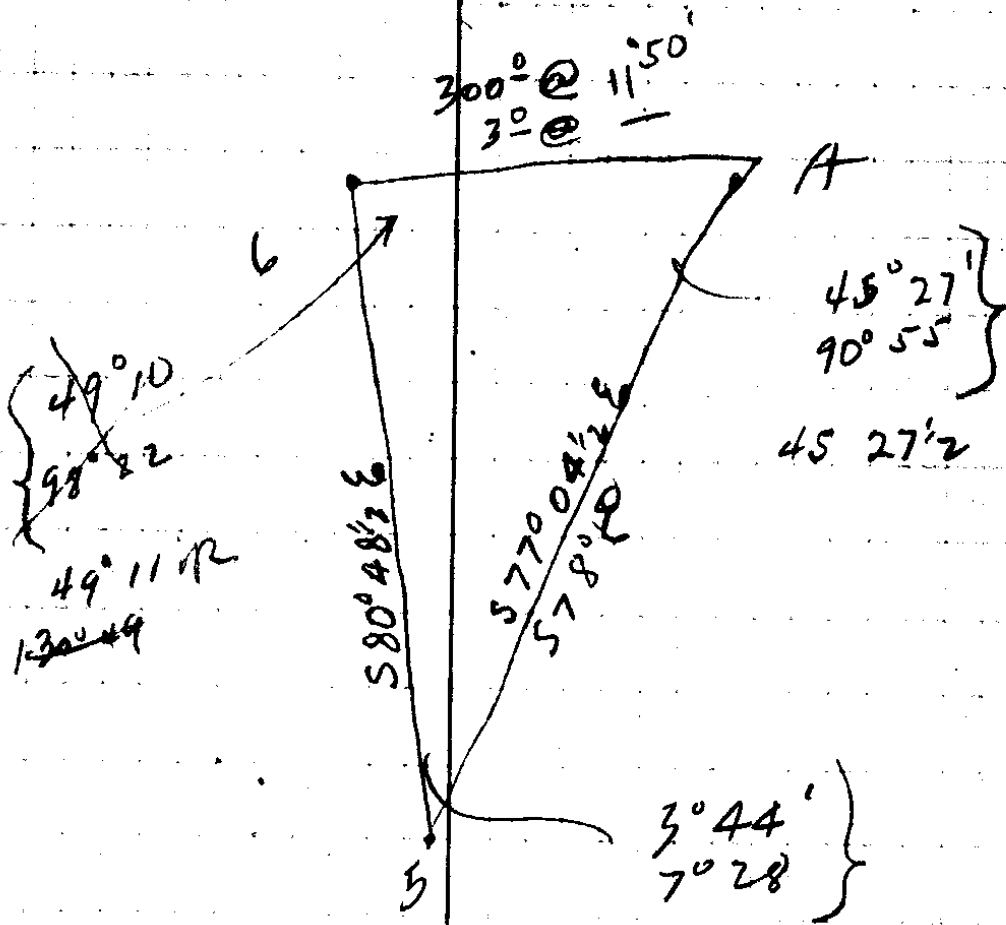

$$\frac{5-6}{\sin 45^\circ 27' 2''} = .71274$$

$$= \frac{296.62}{\sin 3^\circ 44'} = .06511$$

$$\text{Sine } 3247 \frac{0}{14} 2 \checkmark$$

C.S. 5/25

(15)
Set I. Bar 24^s ft No. of SW E of L
cor. for dividing line bet Johnson
& Ingram. Marked 10" Fir S30°E 10⁰ ft

On compass line from S.W. cor.
to inner "L" cor. miss "L" corner
by 102° North. = 1°45'

CS FILE FOLDER

CONTAINS

MORE

INFORMATION