

#1 To A. 4-12 9.A.M SEPT 1855

S 60° E Bear Lane

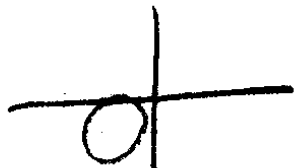

S 90° 06' 30" E bearing



V.A. 34° 14'

W. 75° 50'

34° 02'

25° 44'

av. V = 34° 06' 35"

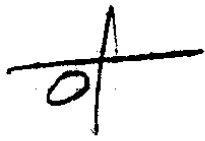

W. 26° 51' 26" 26° 56' 26" 34° 58' 26"

26° 47' 34° 46' 1/2

~~S 90° 05' 20" E bearing~~

av. V = 34° 50' 50"

299<sup>3</sup>  
25  
---  
274<sup>3</sup>

Bearing line N 89° 54' E

#1 site ✓  
tie 90° 30' W  
NW cord. 56.

874<sup>3</sup>

N1° W

8789° 54' E  
N0° 36' W

NW corners  
83° 57' W

Cem. 38°

at #1  
N5½ E

N5° 57' E

56° 40' R

6<sup>3</sup>

S33½ E

S33° 14' E

corner of  
SPK.

121° 49' R

15<sup>2</sup>

S31½ W

S31° 43' W

#1-2  
#2-site 1.

253<sup>8</sup>

S89° 54' W

90° 14' W

34<sup>9</sup>

NW corner Cem.

71.

N0° 20' W

2

92° 26' 2R

300°

S3½ W

S2° 30' 2W

3

4° 06' L

436<sup>7</sup>

S1° E

S1° 35' 2 E

Decor Panel

across 50' end

757<sup>8</sup>

3

31° 46' R

501<sup>8</sup>

S30° W

S29° 15' 2 W  
S75° 10' 2 W

4-12 2497  
163  
136

Interior Lat  
St. car set  
previously set  
90°37' 151°

12 15

Lower limb Sun 53°29' N  
53°28' R

alt Sun 53°28' 30"  
15 53

~~53°44' 23"  
48~~

~~53 43 35  
6 59 01~~

~~46 43 35  
46 44 34~~

~~43 01 26~~

Lat

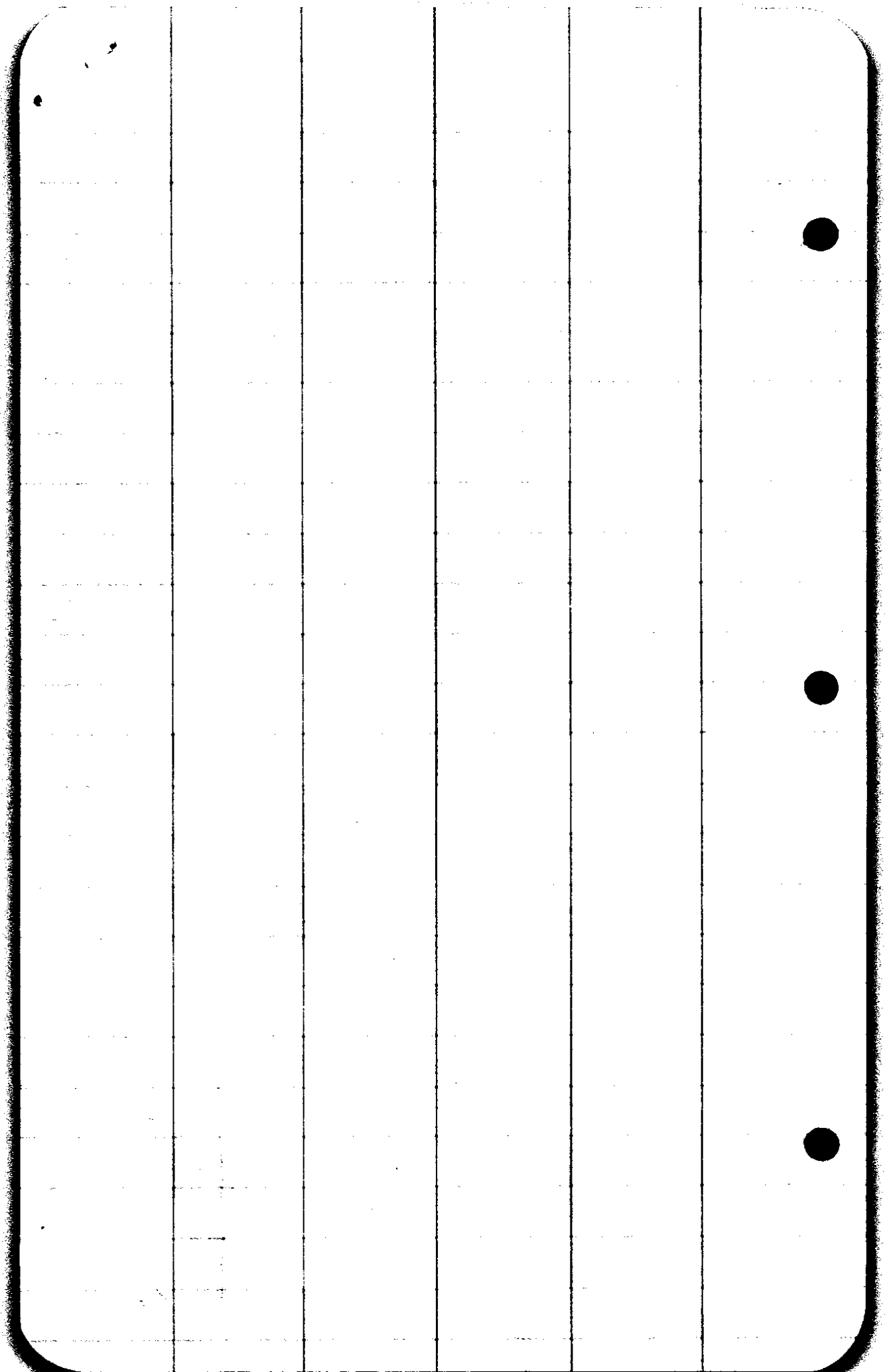

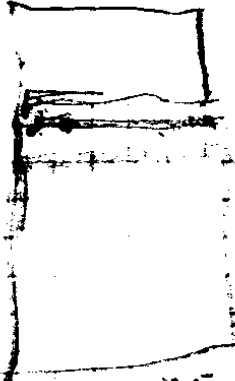

R-75 Fir Wit.  
256  
Decor

VE 1290

C. S. File No. 4/12

|                       | Dist         | AL                 | AR               | H.    | Distance     |
|-----------------------|--------------|--------------------|------------------|-------|--------------|
| Δ 21                  | 338°         | 0-03'<br>0-06'     |                  | 358°  | ✓ 824° 14' W |
| ? Δ 20<br>Ver. 3° 0'  | 300<br>574 E | 6°-45'<br>13-30    |                  | 273°? | 874° 17' W   |
| Δ 19<br>Ver 1°        | 2862         |                    | 0-55'<br>1-50'   | 2862  | 831° 02' W   |
| Δ 18<br>Ver. 4°-0'    | 2,380<br>119 |                    | 4°-59'<br>9-58'  | 3864  | 820° 07' W   |
| Δ 17                  | 6989         | 65-48'<br>131-34'  |                  | 6989  | 875° 08' W   |
| Δ 16                  |              | 73-46'<br>147-32   |                  |       | ✓ 829° 05' W |
| Δ 15<br>Ver 23°       | 1138         | 7° 42'<br>3-51'    |                  | 1046  | 815° 19' W   |
| Δ 14<br>22-30<br>0/0  | 3000<br>139  | 34°-58'<br>17°-29' |                  | 4161  | 811° 28' W   |
| Δ 13<br>Ver 27<br>0/0 | 3000<br>4205 |                    | 7° 19'<br>14-38' | 6878  | 806° 01' E   |
| Δ 12<br>Ver 12°-30'   | 1947         | 1°-16'<br>2-32     |                  | 1901  | 81° 18' W    |
| Δ 11<br>6° 00'<br>02  | 3000<br>3165 | 40-12<br>20-06     |                  | 6148  | 80° 02' W    |
| Δ 10                  |              |                    |                  |       | 870° 04' E   |

C. S. File No.

4/12

# Dent 4-12

| Sta                     | Dist                            | L A               | R A                | M.C.                            |                                    |
|-------------------------|---------------------------------|-------------------|--------------------|---------------------------------|------------------------------------|
| Δ 10                    | 59.2                            |                   | 30°-41'<br>61°-22' | 59 <sup>2</sup> / <sub>N</sub>  | N 70° 04' E ✓                      |
| Δ 9<br>vel 10°<br>0/0   | 300°<br>18°                     | 9-11<br>18-22'    |                    | 313 <sup>4</sup> / <sub>-</sub> | N 10° 38' W                        |
| Δ 8<br>vel 15-45<br>0/0 | 300°<br>220°                    | 12-15<br>24-30    |                    | 608 <sup>2</sup> / <sub>-</sub> | N 1° 27' W                         |
| Δ 7<br>vel.<br>16-30    | 296 <sup>6</sup> / <sub>-</sub> | 98-46'<br>197-32' |                    | 284 <sup>4</sup> / <sub>-</sub> | N 10° 48' 1/2 E                    |
| Δ 5<br><del>Δ 5</del>   |                                 |                   |                    |                                 |                                    |
| Δ 6 = Cor. act.         | 49 <sup>3</sup> / <sub>-</sub>  |                   | 99°-52'            | 49 <sup>3</sup> / <sub>-</sub>  | S 27° 26' W                        |
| Δ 5<br>vel.<br>8-30     | 249 <sup>5</sup> / <sub>-</sub> |                   | 34°-04'<br>68-08'  | 246 <sup>6</sup> / <sub>-</sub> | S 70° 25' 1/2 E x                  |
| Δ 4<br>vel 02           | 299 <sup>5</sup> / <sub>-</sub> |                   | 26-36'<br>132-18'  | 299 <sup>5</sup> / <sub>-</sub> | N 75° 30' 1/2 E ✓                  |
| Δ 3,<br>vel.<br>14      | 81 <sup>3</sup> / <sub>-</sub>  | 32-37'<br>65°-14' |                    | 78 <sup>9</sup> / <sub>-</sub>  | N 62° 12' 1/2 E ✓                  |
| Δ 2<br>vel.<br>16-45    | 235 <sup>6</sup> / <sub>-</sub> |                   | 9-58'<br>19-56'    | 225 <sup>6</sup> / <sub>-</sub> | S 85° 10' 1/2 E ✓                  |
| Δ 1<br>vel.<br>49       | 108°                            | 8-16'<br>4°-08'   |                    | 94 <sup>4</sup> / <sub>-</sub>  | N 14° 51' 1/2 E<br>N 88° 59' 1/2 E |
| 106 x                   |                                 |                   |                    |                                 |                                    |

J. Strader Ch. 42, Precy No. Cor  
L. 42 = "4 bet 4+9.

• West on 71 line C 42 - on line  
bet 4+9. 3966 To cor 4-5-8-7  
6948 cor at L in NW E boundary  
C 42. set post on side hill  
18" B.O. S 85° E 143.

71 on E boundary C 42

40' To 7 1/2 cor C 42  
5" B.O. S 30° W 24  
9" W.O. N 25° E 22

• W on NW boundary C 42  
30' NW cor cor C 42  
12" B.O. S 40° E 78

do. on W line C 42

4056 X line 5+8, 1995 ch  
west from 1/4 cor.

60' SW cor.  
10" B.O. N 62° E 17  
14" " S 75° W 3

East 60° X 8+9 20' 08" NW from 1/4 cor

1000 No. cor C 42  
5" same N 35° W 11

2042 To beg.  
18" " N 87° E 40

4/12

4-12

J. Simmons Ch. 1

began 34<sup>50</sup> E - 20<sup>0</sup> S of 4

bet 3 + 4. 3 mounds

th West 65<sup>50</sup> To just reaches

th South 38<sup>50</sup> To govt line

7<sup>98</sup> E of "4 cor bet 4 + 9.

55<sup>50</sup> To cor. 7" B.O. 77<sup>50</sup> E 139

th East

31<sup>50</sup> foot line 16<sup>25</sup> S of 3-4-9-10

42<sup>0</sup> cor. 24" W.O. 71<sup>65</sup> W 119 lks

th NW  = 78<sup>5</sup> ft

16<sup>73</sup> To govt line 70" B.O. 57<sup>0</sup> W 125

th East

23<sup>18</sup> cor. 6" B.O. W 20 lks

th N

38<sup>15</sup> place Reg.

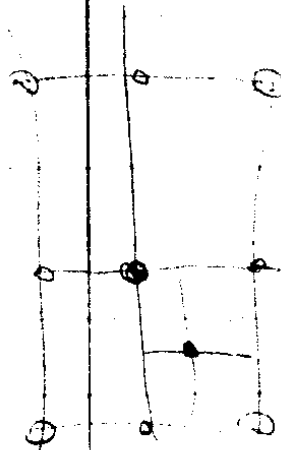
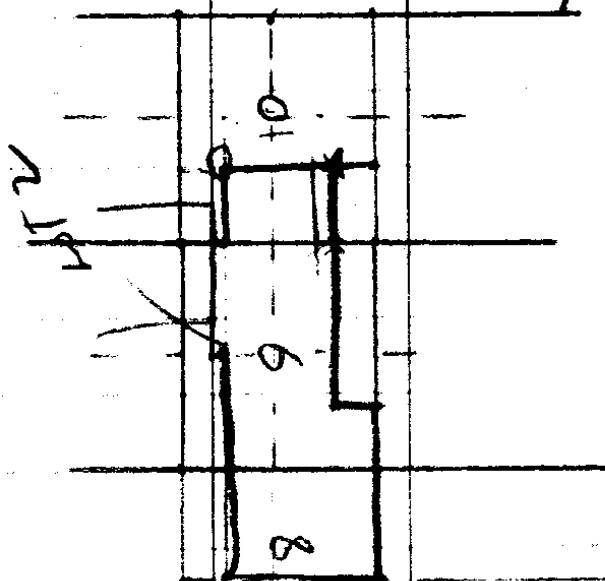

4-12

Deed  
From E.E. Dent  
To Frank L Strader

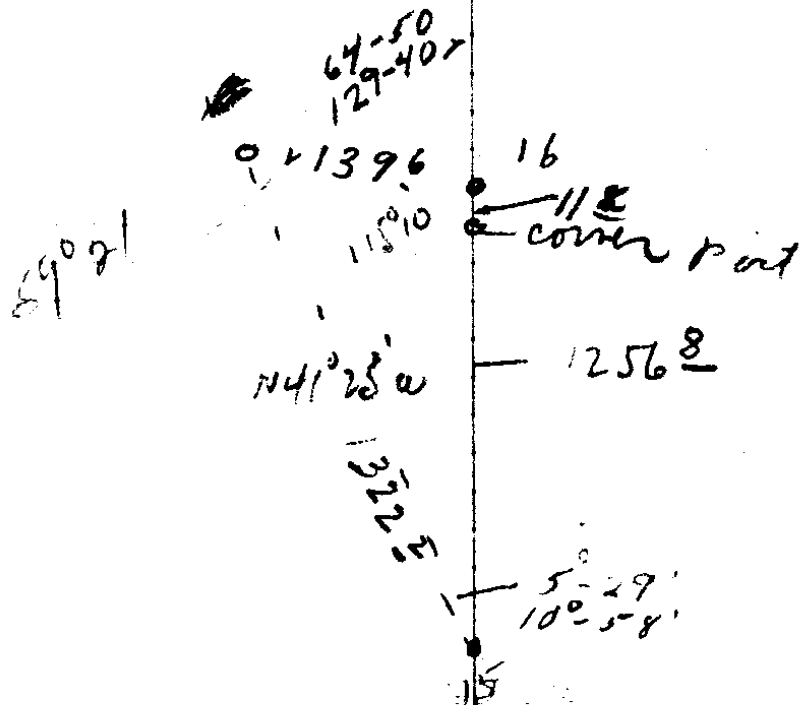

15 supposed to be corner, a  
 singleton and this corner  
 is about 30 feet <sup>East</sup> above  
 here look for fence  
 survey for Mathew

30 ft Fence

Dent

Sta Dist LA RA

Street  
Hub

Hub  
Street

~~D23~~ Hub, 1695

642.5

Δ 22

618.5

Δ 21

123-09

29°-02'

21°-34'

19°-19'  
38°-38'

= S 86°55' E  
S 87°01' E

S 36°08' W

S 65°10' W

S 43°36' W

S 24°14' W

C. S. File No. 4/12

4-12

C.S. No. 4/12

C. S. File No.

McClintock

20°10' L  
40°20'

48°10' R  
96°20'

35°08' 2L  
70°17'

0°0'

Manchester

Park St

65°50' R

Cor lot

✓  
N20°00' ●

N28°00' ⊕

N7°08' 1/2 W

N7°08' 1/2 W ●

435

3282

N88°E N88°42'E

40 15  
30  
74 15

30  
40 15  
2007  
9 0.22

89°40'

Mr. C. R. Fream, 522 So. Stephens

137 So Pine St

CS FILE FOLDER

CONTAINS

MORE

INFORMATION